

Attachment E - Site

Environmental Management Plan

**ADVERTISED
PLAN**

This copied document to be made available for the sole purpose of enabling its consideration and review as part of a planning process under the Planning and Environment Act 1987. The document must not be used for any purpose which may breach any copyright

General Notes:

1. Any excess soil from site earthworks must be placed in a designated fill spot as directed by the RMB. Under no circumstances is excess soil to be stockpiled on the site.
2. Clean fill is not permitted to be brought to the subject land.
3. All machinery and equipment brought to the resort must be washed down off site in an approved wash-down facility to remove soil and weed seeds.
4. The site manager is to regularly inspect the site for threatened species. If found, Nick Vlahandreas of Mountain Planning must be contacted immediately.
5. No vegetation is permitted to be impacted beyond the construction zone shown.
6. Prior to any storm events the site manager must inspect the management obligations of the Site Environment Management Plan to ensure that all matters are implemented.
7. Prior to the removal of any native vegetation and excavation works a pre-clearance survey must be undertaken by a qualified ecologist.
8. If any fauna is found during the pre-clearance survey it must be relocated to the satisfaction of the RMB.
9. If the load capacity of Hot Plate Drive is exceeded, all machinery and material access to and from the subject sites must be via Playground Trail, north-east of Hot Plate Drive.

Excess soil must be placed in skip bins within the construction zone and removed and disposed of to the satisfaction of the RMB.

Extent of area to be disturbed during construction

This copied document to be made available for the sole purpose of enabling its consideration and review as part of a planning process under the Planning and Environment Act 1987. The document must not be used for any purpose which may breach any copyright

ADVERTISED PLAN

Construction vehicles must be parked within Hotplate Drive or the Playground Trail and car parking must ensure that a safe trafficable width is obtained along both roads



Site Environmental Management Plan
Lot 29 Hotplate Drive, Mt Hotham

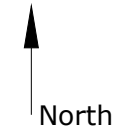

Mountain Planning
e. nickv@mountainplanning.com
m. 0409 723 259
w. www.mountainplanning.com

Drawn by: Nick V
Date: 27 June 2023
Ref: Lot 29 Hotplate Drive SEMP
Rev: 0
Scale: Not to Scale

Legend:



Area to be rehabilitated with *Poa Fawcettiae* and *Poa Hothamensis* at the rate of 8/m². The pot size must be tube stock.

Notes for Landscaping

The site must be cleared and all construction activity must have ceased before rehabilitation.

All weeds must firstly be eradicated from the site.

The contractor must ensure that there is adequate soil across the site to support the proposed species.

All disturbed areas must be stabilised with either weed free straw or approved Jute mat to minimise erosion and sedimentation.

The soil must be moist before planting.

Planting must be undertaken prior to 30 April.

Plants must be ordered 3-6 months in advance from the Alpine Nursery in Ovens.

Planting density must be in accordance with this plan.

Plants must be protected from vermin.

Plants must be monitored for 12 weeks and any plants that do not survive the first winter must be replaced.

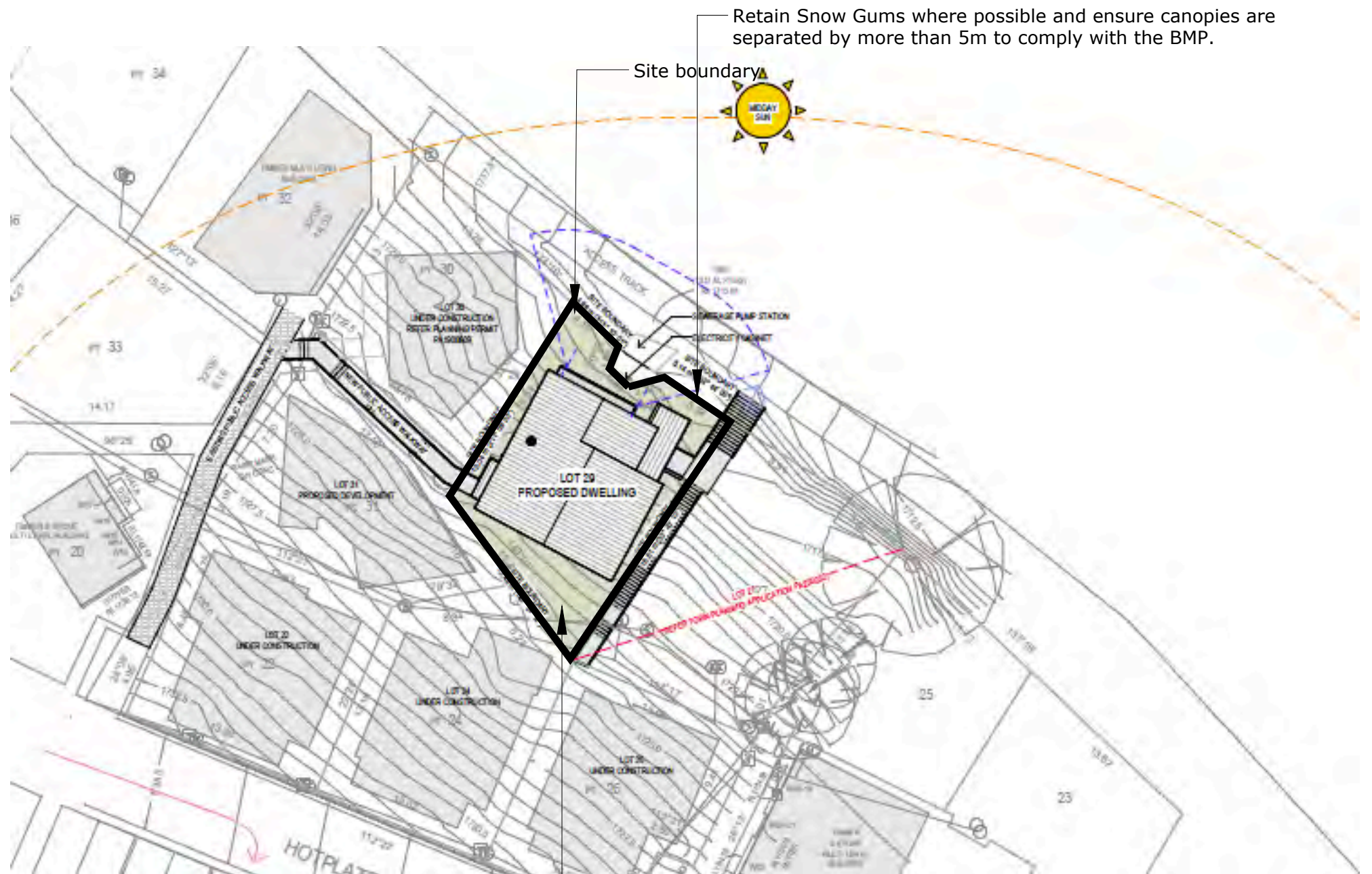

This copied document to be made available for the sole purpose of enabling its consideration and review as part of a planning process under the Planning and Environment Act 1987. The document must not be used for any purpose which may breach any copyright

ADVERTISED PLAN

Reinstate all disturbed areas with *Poa Fawcettiae* and *Poa Hothamensis*



Mountain Planning
e. nickv@mountainplanning.com
m. 0409 723 259
w. www.mountainplanning.com

Site Environmental Management Plan
Lot 29 Hotplate Drive, Mt Hotham

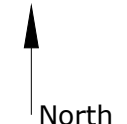

Drawn by: Nick V
Date: 8 November 2023
Ref: Lot 29 Hotplate Drive SEMP Rev A
Rev: A
Scale: Not to Scale