

Copyright State of Victoria. No part of this publication may be reproduced except as permitted by the Copyright Act 1968 (Cth), to comply with a statutory requirement or pursuant to a written agreement. The information is only valid at the time and in the form obtained from the LANDATA REGD TM System. None of the State of Victoria, its agents or contractors, accepts responsibility for any subsequent publication or reproduction of the information.

The Victorian Government acknowledges the Traditional Owners of Victoria and pays respects to their ongoing connection to their Country, History and Culture. The Victorian Government extends this respect to their Elders, past, present and emerging.

REGISTER SEARCH STATEMENT (Title Search) Transfer of Land Act 1958

VOLUME 08114 FOLIO 747

Security no : 124090955285N
Produced 05/07/2021 10:28 AM

LAND DESCRIPTION

Lot 8 on Plan of Subdivision 004852.
PARENT TITLE Volume 03475 Folio 832
Created by instrument A146989 27/04/1956

REGISTERED PROPRIETOR

Estate Fee Simple
Sole Proprietor
TRUSTEES OF EDMUND RICE EDUCATION AUSTRALIA of 9 THE VAUCLUSE RICHMOND VIC
3121
AL972028L 22/06/2015

ENCUMBRANCES, CAVEATS AND NOTICES

MORTGAGE AL972030A 22/06/2015
THE ROMAN CATHOLIC TRUSTS CORPORATION FOR THE DIOCESE OF BALLARAT

Any encumbrances created by Section 98 Transfer of Land Act 1958 or Section 24 Subdivision Act 1988 and any other encumbrances shown or entered on the plan or imaged folio set out under DIAGRAM LOCATION below.

DIAGRAM LOCATION

SEE TP655844C FOR FURTHER DETAILS AND BOUNDARIES

ACTIVITY IN THE LAST 125 DAYS

NIL

-----END OF REGISTER SEARCH STATEMENT-----

Additional information: (not part of the Register Search Statement)

Street Address: "ST PATRICKS COLLEGE" 1431 STURT STREET NEWINGTON VIC 3350

DOCUMENT END

Delivered from the LANDATA System by GlobalX Terrain Pty Ltd

**This copied document to be made available
for the sole purpose of enabling
its consideration and review as
part of a planning process under the
Planning and Environment Act 1987.
The document must not be used for any
purpose which may breach any
copyright**

TITLE PLAN	EDITION 1	TP 655844C
-------------------	------------------	-------------------

<p>Location of Land</p> <p>Parish: BALLARAT Township: BALLARAT Suburban Section: 2 Crown Allotment: 4 (PT) Crown Portion:</p> <p>Last Plan Reference: LP 4852 Derived From: VOL 8114 FOL 747 Depth Limitation: NIL</p>	<p style="text-align: center;">Notations</p> <p>ANY REFERENCE TO MAP IN THE TEXT MEANS THE DIAGRAM SHOWN ON THIS TITLE PLAN</p>
---	--

Description of Land / Easement Information

All that piece of Land, delineated and coloured red on the map in the margin being Lot 8 on Plan of Subdivision No.4852 lodged in the Office of Titles and being part of Crown Allotment 4 Suburban Section 2 Township and Parish of Ballaarat County of Grenville - Together with a right of carriage way over Wanliss Street coloured brown on the said Plan of Subdivision

THIS PLAN HAS BEEN PREPARED FOR THE LAND REGISTRY, LAND VICTORIA, FOR TITLE DIAGRAM PURPOSES AS PART OF THE LAND TITLES AUTOMATION PROJECT

COMPILED: 17/10/2000
 VERIFIED: C.L.

COLOUR CODE

R = RED

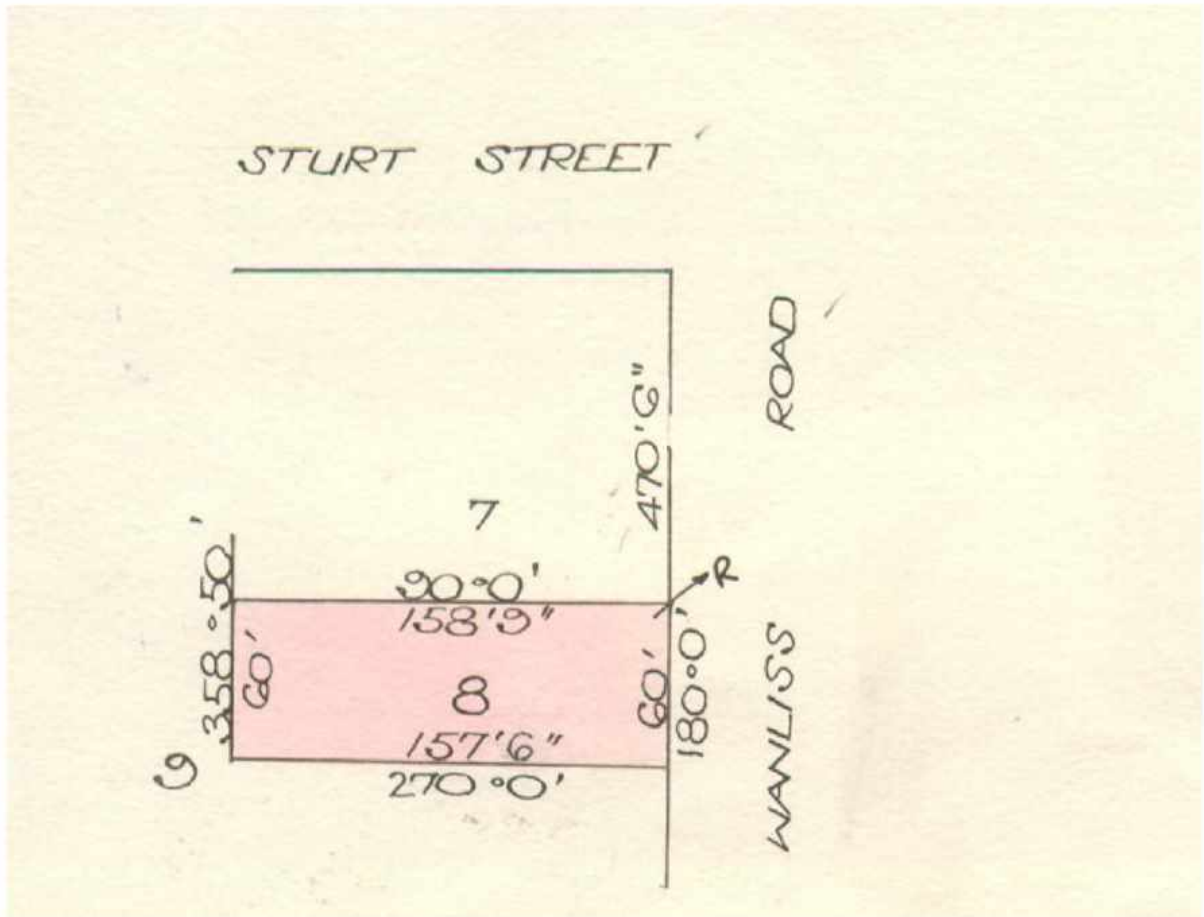

This copied document to be made available for the sole purpose of enabling its consideration and review as part of a planning process under the Planning and Environment Act 1987. The document must not be used for any purpose which may breach any copyright