

# Imaged Document Cover Sheet

The document following this cover sheet is an imaged document supplied by LANDATA®, Secure Electronic Registries Victoria.

Document Type	<b>Plan</b>
Document Identification	<b>TP739984T</b>
Number of Pages (excluding this cover sheet)	<b>2</b>
Document Assembled	<b>06/11/2023 16:40</b>

**Copyright and disclaimer notice:**

© State of Victoria. This publication is copyright. No part may be reproduced by any process except in accordance with the provisions of the Copyright Act 1968 (Cth) and for the purposes of Section 32 of the Sale of Land Act 1962 or pursuant to a written agreement. The information is only valid at the time and in the form obtained from the LANDATA® System. None of the State of Victoria, LANDATA®, Secure Electronic Registries Victoria Pty Ltd (ABN 86 627 986 396) as trustee for the Secure Electronic Registries Victoria Trust (ABN 83 206 746 897) accept responsibility for any subsequent release, publication or reproduction of the information.

The document is invalid if this cover sheet is removed or altered.

**This copied document to be made available for the sole purpose of enabling its consideration and review as part of a planning process under the Planning and Environment Act 1987. The document must not be used for any purpose which may breach any copyright**

**ADVERTISED  
PLAN**

TITLE PLAN	EDITION 1	TP 739984T
------------	-----------	------------

<p><b>Location of Land</b></p> <p>Parish: TARRENGOWER</p> <p>Township:</p> <p>Section: 12</p> <p>Crown Allotment: 32C</p> <p>Crown Portion:</p> <p>Last Plan Reference:</p> <p>Derived From: VOL 10552 FOL 051</p> <p>Depth Limitation: 15 m</p>	<p style="text-align: center;"><b>Notations</b></p> <p>SUBJECT TO THE RESERVATIONS EXCEPTIONS CONDITIONS AND POWERS CONTAINED IN CROWN GRANT VOL. 10552 FOL. 051 AND NOTED ON SHEET 2 OF THIS PLAN</p> <p>ANY REFERENCE TO MAP IN THE TEXT MEANS THE DIAGRAM SHOWN ON THIS TITLE PLAN</p>
--	---

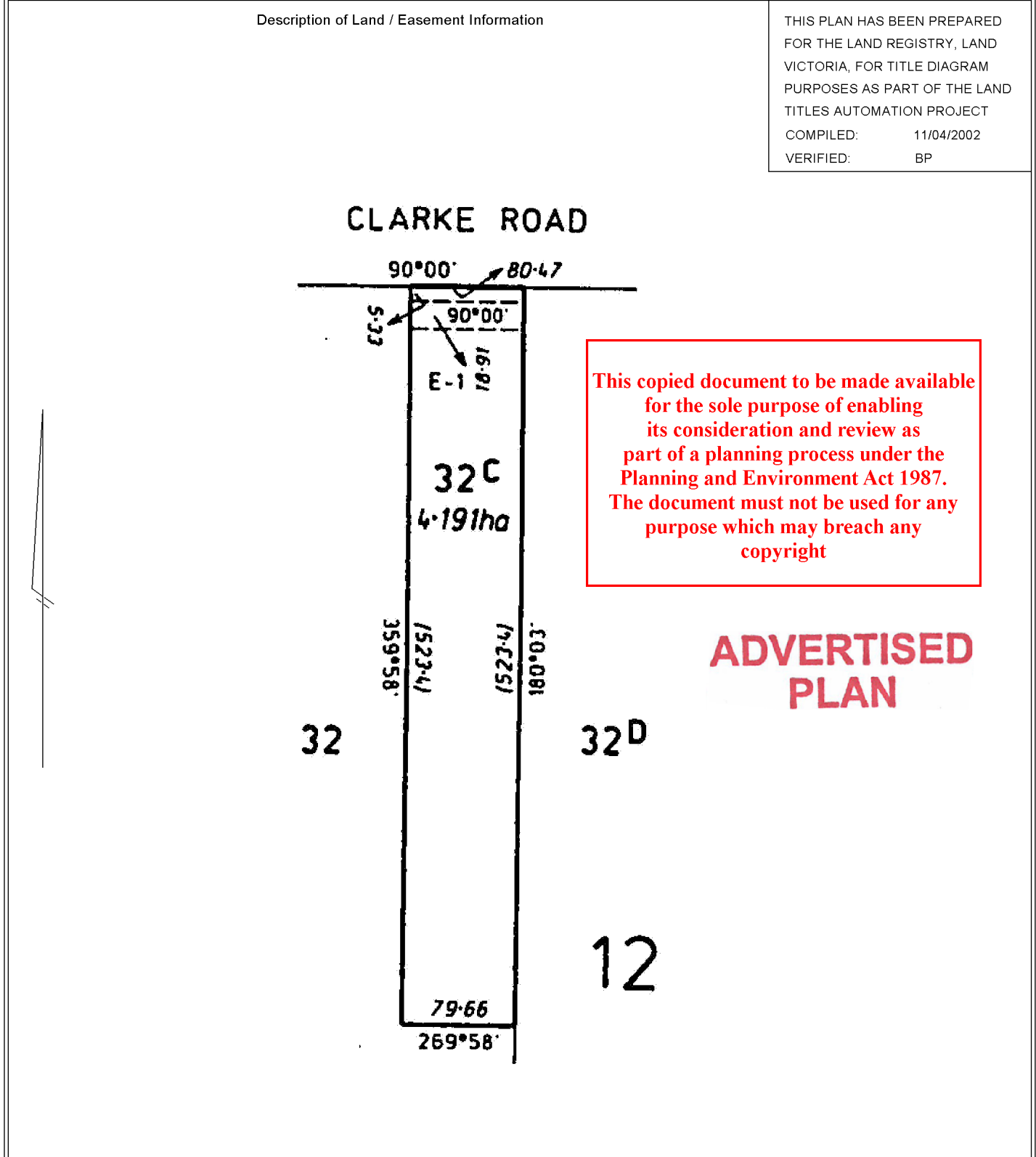

LENGTHS ARE IN METRES	Metres = 0.3048 x Feet Metres = 0.201168 x Links	
-----------------------	---	--

TITLE PLAN

TP 739984T

## LAND DESCRIPTION INCLUDING RESERVATIONS EXCEPTIONS CONDITIONS AND POWERS SHOWN ON THE CROWN GRANT

all that piece of land in the said State being Allotment 32<sup>U</sup> of Section 12 in the Parish of **TARRENGOWER** and being the land shown enclosed by continuous lines in the map hereon and identified by that allotment number

**PROVIDED** that this Grant is made subject to -

- (a) the reservation to Us Our heirs and successors of -
- (i) any minerals within the meaning of the *Mineral Resources Development Act 1990* and petroleum within the meaning of the *Petroleum Act 1958* (hereinafter called "the reserved minerals");
  - (ii) rights of access for the purpose of searching for and obtaining the reserved minerals in any part of the said land;
  - (iii) rights for access and for pipe-lines works and other purposes necessary for obtaining and conveying on and from the said land any of the reserved minerals which is obtained in any part of the said land;
- (b) the right to resume the said land for mining purposes pursuant to section 205 of the *Land Act 1958*;
- (c) the right of any person being a licensee under the *Mineral Resources Development Act 1990* or any corresponding previous enactment to enter on the said land and to do work within the meaning of that Act and to erect and occupy mining plant or machinery thereon in the same manner and under the same conditions and provisions as those under which such a person has now the right to do such work in and upon Crown lands provided that compensation as prescribed by Part 8 of that Act is paid for surface damage to be done to the said land by reason of doing such work on it.
- (d) the full and free right and liberty to and for any electricity corporation or distribution company as defined in the *Electricity Industry Act 1993* or the holder of a licence under Part 12 of that Act and for any of their employees agents or contractors to enter on the land delineated and marked E-1 and carry out thereon such works as are necessary or incidental to the transmission supply or distribution of electricity through over along across or under the said land and for that purpose without compensation to the grantee to exercise all or any of the powers conferred on the those parties by Section 47(1) of that Act.

**This copied document to be made available  
for the sole purpose of enabling  
its consideration and review as  
part of a planning process under the  
Planning and Environment Act 1987.  
The document must not be used for any  
purpose which may breach any  
copyright**

## ADVERTISED PLAN

LENGTHS ARE IN  
METRES

Metres = 0.3048 x Feet  
Metres = 0.201168 x Links

Sheet 2 of 2 sheets