

**REGISTER SEARCH STATEMENT (Title Search) Transfer of  
Land Act 1958**

VOLUME 11229 FOLIO 348

Security no : 124132246114B  
Produced 17/02/2026 04:00 PM

**LAND DESCRIPTION**

Lot 4 on Plan of Subdivision 533382K.  
PARENT TITLE Volume 10848 Folio 486  
Created by instrument PS533382K 04/10/2010

**ADVERTISED  
PLAN**

**REGISTERED PROPRIETOR**

Estate Fee Simple  
Sole Proprietor  
ROMAN CATHOLIC TRUSTS CORPORATION FOR THE DIOCESE OF SANDHURST of 174 MCCRAE  
STREET BENDIGO VIC 3550  
AL496528S 19/11/2014

**ENCUMBRANCES, CAVEATS AND NOTICES**

Any encumbrances created by Section 98 Transfer of Land Act 1958 or Section 24 Subdivision Act 1988 and any other encumbrances shown or entered on the plan set out under DIAGRAM LOCATION below.

**DIAGRAM LOCATION**

SEE PS533382K FOR FURTHER DETAILS AND BOUNDARIES

**ACTIVITY IN THE LAST 125 DAYS**

NIL



-----END OF REGISTER SEARCH STATEMENT-----

Additional information: (not part of the Register Search Statement)

Street Address: ELLEN MCDONALD DRIVE BARANDUDA VIC 3691

DOCUMENT END

**This copied document to be made available  
for the sole purpose of enabling  
its consideration and review as  
part of a planning process under the  
Planning and Environment Act 1987.  
The document must not be used for any  
purpose which may breach any  
copyright**

PLAN OF SUBDIVISION		STAGE No.	LR USE ONLY <b>EDITION 1</b>	<b>PS533382K</b> 02/03/2006 \$702.50 PS 						
LOCATION OF LAND PARISH: BARANDUDA TOWNSHIP: _____ SECTION: 5 CROWN ALLOTMENT: 8 (PART). CROWN PORTION: _____ LR BASE RECORD: TITLE REFERENCES: VOL. 10848 FOL.486 LAST PLAN REFERENCES: PS 521514M (LOT 2) POSTAL ADDRESS: BOYES ROAD (At time of subdivision) BARANDUDA 3691 AMG Co-ordinates (of approx centre of land in plan) E 494 800 N 5 996 785 ZONE: 55		COUNCIL CERTIFICATION AND ENDORSEMENT								
VESTING OF ROADS AND/OR RESERVES <table border="1" style="width:100%; border-collapse: collapse;"> <tr> <th style="width: 20%;">IDENTIFIER</th> <th>COUNCIL/BODY/PERSON</th> </tr> <tr> <td>ROAD R1</td> <td>WODONGA CITY COUNCIL.</td> </tr> <tr> <td>RESERVE No.1</td> <td>WODONGA CITY COUNCIL.</td> </tr> </table>		IDENTIFIER	COUNCIL/BODY/PERSON	ROAD R1	WODONGA CITY COUNCIL.	RESERVE No.1	WODONGA CITY COUNCIL.	COUNCIL NAME: WODONGA CITY COUNCIL REF:3013 <del>1. This plan is certified under Section 6 of the Subdivision Act 1988.</del> 2. This plan is certified under Section 11(7) of the Subdivision Act 1988. Date of original certification under Section 6. <u>02/02/2006</u> 3. This is a statement of compliance issued under Section 21 of the Subdivision Act 1988. OPEN SPACE (i) A requirement for public open space under Section 18 of the Subdivision Act 1988 <del>has</del> /has not been made. <del>(ii) The requirement has been satisfied.</del> <del>(iii) The requirement is to be satisfied in Stage .....</del> _____ Council Delegate _____ Council Seal Date / / Re-certified under Section 11(7) of the Subdivision Act 1988. _____ Council Delegate _____ Council Seal Date <u>16/09/2010</u>		
IDENTIFIER	COUNCIL/BODY/PERSON									
ROAD R1	WODONGA CITY COUNCIL.									
RESERVE No.1	WODONGA CITY COUNCIL.									
		NOTATIONS								
		STAGING This <del>is</del> is not a staged subdivision. Planning permit No. 2003/155/A DEPTH LIMITATION 15 METRES BELOW THE SURFACE APPLIES TO ALL THE LAND IN THE PLAN. LOTS 1 AND 3 ARE OMITTED FROM THIS PLAN OTHER PURPOSE OF PLAN: REMOVAL OF EASEMENT E-5 PS521514M BY PLANNING PERMIT 2003/155/A								
		ADVERTISED PLAN								
		SURVEY. THIS PLAN IS <del>IS NOT</del> BASED ON SURVEY THIS SURVEY HAS BEEN CONNECTED TO PERMANENT MARKS No.(s) 30, 35, 63, 92, 97, 104, 105 & 106. IN PROCLAIMED SURVEY AREA No. 42								
EASEMENT INFORMATION		LR USE ONLY								
LEGEND E - Encumbering Easement, Condition in Crown Grant in Nature of an Easement or Other Encumbrance A - Appurtenant Easement R - Encumbering Easement (Road)		STATEMENT OF COMPLIANCE/ EXEMPTION STATEMENT RECEIVED <input checked="" type="checkbox"/>								
Easement Reference	Purpose	Width (Metres)	Origin	Land Benefited/In Favour Of						
E-1 & E-4 E-1 & E-4	SEWERAGE SEWERAGE	3 3	PS 311391X THIS PLAN	RURAL CITY OF WODONGA NORTH EAST REGION WATER AUTHORITY.						
E-2	DRAINAGE	SEE DIAGRAM	PSS21514M	WODONGA RURAL CITY COUNCIL.						
E-2	SEWERAGE	SEE DIAGRAM	PSS21514M	NORTH EAST REGION WATER AUTHORITY.						
E-3 E-3	DRAINAGE SEWERAGE	6 6	PSS21514M PSS21514M	WODONGA RURAL CITY COUNCIL NORTH EAST REGION WATER AUTHORITY.						
E-4 E-5	DRAINAGE SEWERAGE	3 3	PSS21514M THIS PLAN	WODONGA RURAL CITY COUNCIL NORTH EAST REGION WATER AUTHORITY.						
 EDM Group PLANNERS SURVEYORS & ENGINEERS OFFICES 99 HUME ST PO Box 317 WODONGA 3689 Ph (02) 6057 8578 Fax (02) 6056 2392 info@edmgrup.com.au ABN 37 437 501 349		LICENSED SURVEYOR (PRINT) RUSSELL JOHN DOUTHAT SIGNATURE _____ DATE 20 / 08 / 10 REF 050082 VERSION 05		DATE 21/07/10 PLAN REGISTERED TIME 11:28am DATE 4 / 10 / 2010 G Venn Assistant Registrar of Titles SHEET 1 OF 3 SHEETS DATE 16/09/2010 COUNCIL DELEGATE SIGNATURE _____ ORIGINAL SHEET SIZE A3						

This copied document has been made available for the sole purpose of enabling its consideration and review as part of a planning process under the Planning and Environment Act 1987. The document must not be used for any purpose which may breach any copyright.

<b>PLAN OF SUBDIVISION</b>	STAGE No.	PLAN NUMBER <b>PS533382K</b>
----------------------------	-----------	---------------------------------

ADVERTISED  
PLAN

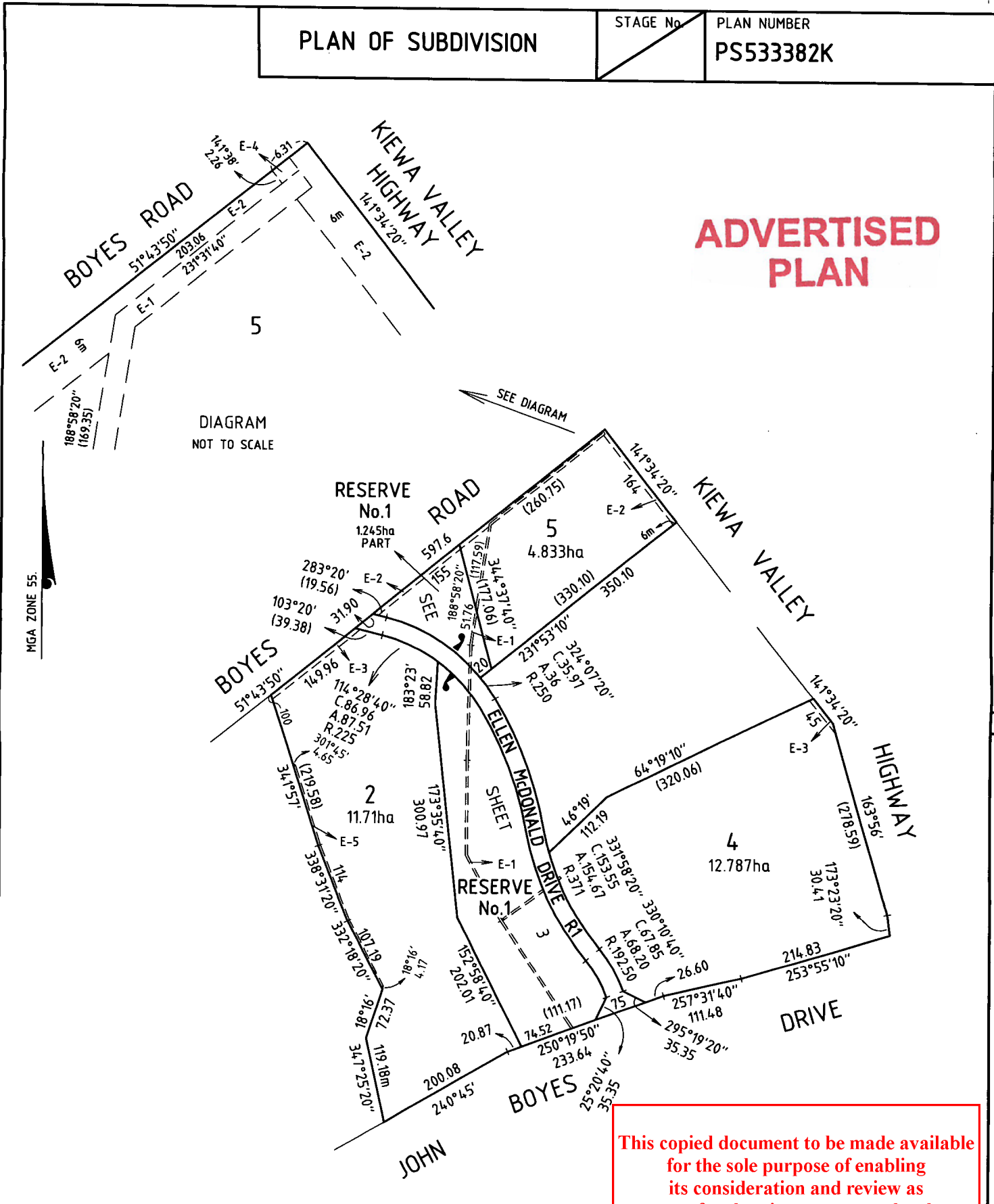

This copied document to be made available for the sole purpose of enabling its consideration and review as part of a planning process under the Planning and Environment Act 1987. The document must not be used for any purpose which may breach any copyright

**EDM Group**  
 PLANNERS SURVEYORS & ENGINEERS  
 OFFICES 99 HUME ST  
 PO Box 317 WODDONGA 3689  
 Ph (02) 6057 8578  
 Fax (02) 6056 2392  
 info@edmgroupp.com.au  
 ABN 37 437 501 349

ORIGINAL

SCALE

1:5000

SHEET SIZE

A3

LENGTHS ARE IN METRES

LICENSED SURVEYOR (PRINT) RUSSELL JOHN DOUTHAT

SIGNATURE

REF **050082**

DATE 20 / 8 / 10

VERSION 05

SHEET 2 OF 3 SHEETS

DATE 16/09/2010

COUNCIL DELEGATE SIGNATURE

PLAN OF SUBDIVISION	STAGE No.	PLAN NUMBER <b>PS 533382K</b>
---------------------	-----------	----------------------------------

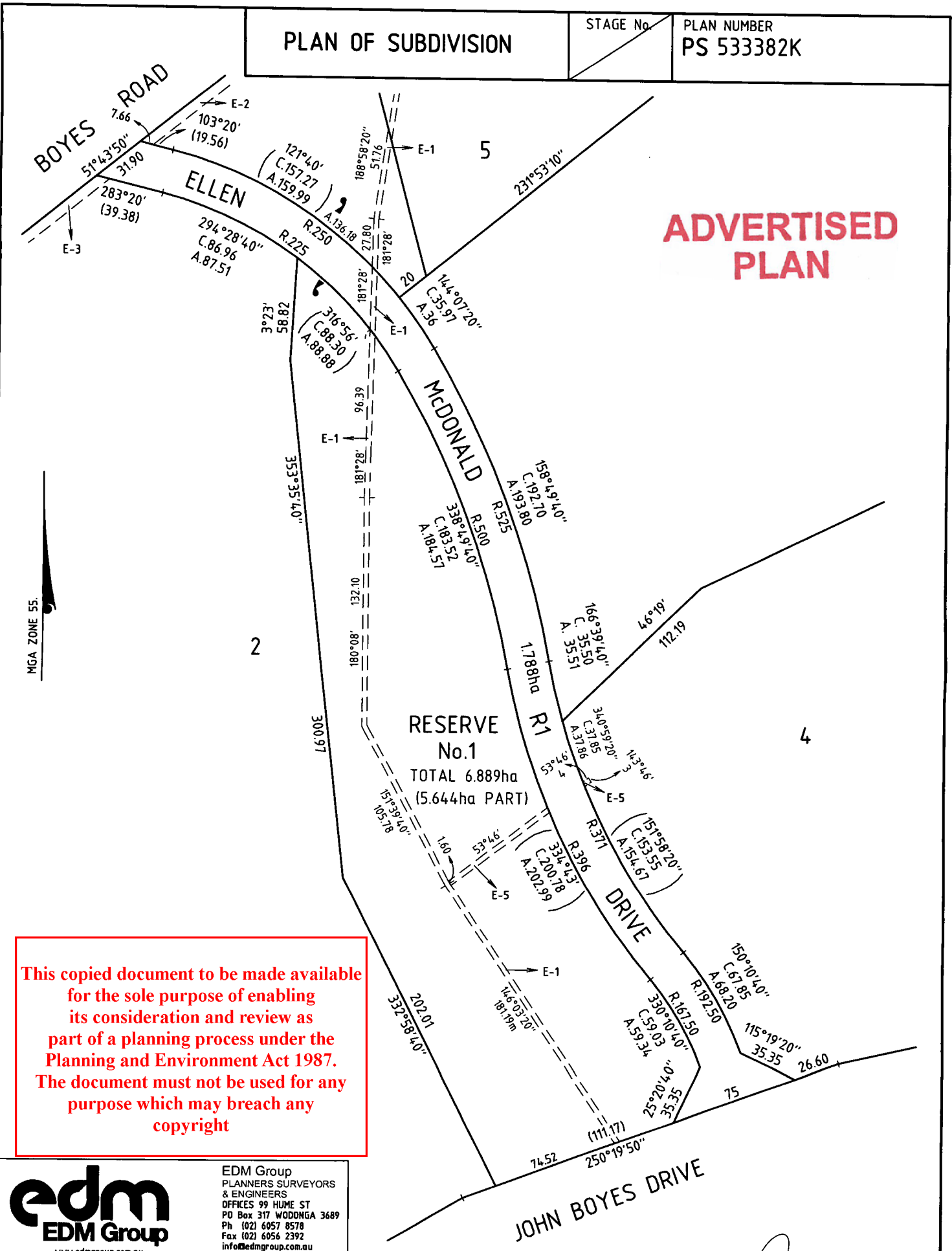

This copied document to be made available for the sole purpose of enabling its consideration and review as part of a planning process under the Planning and Environment Act 1987. The document must not be used for any purpose which may breach any copyright

www.edmgroup.com.au

**EDM Group**  
 PLANNERS SURVEYORS & ENGINEERS  
 OFFICES 99 HUME ST  
 PO Box 317 WODDONGA 3689  
 Ph (02) 6057 8578  
 Fax (02) 6056 2392  
 info@edmgroup.com.au  
 ABN 37 437 501 349

<p style="font-size: 0.8em;">LENGTHS ARE IN METRES</p>	<p style="font-size: 0.8em;">ORIGINAL</p> <p>SCALE 1:2000</p> <p>SHEET SIZE A3</p>	LICENSED SURVEYOR (PRINT)..... <b>RUSSELL JOHN DOUTHAT</b> SIGNATURE ..... REF <b>050082</b> VERSION 05	SHEET 3 OF 3 SHEETS DATE 20 / 08 / 10 DATE <b>16 / 09 / 2010</b> COUNCIL DELEGATE SIGNATURE
--	--	---	--