

STREET VIEW: NO. 104 ST GEORGES ROAD, TOORAK.

RE-ESTABLISHMENT RECOMMENDED



LEVELS ARE TO AUSTRALIAN HEIGHT DATUM
CONTOUR INTERVAL 0.20 METRES
SCALE 1:200 METRIC
(ORIGINAL SHEET SIZE A1)

LEGEND	
✱	SW PROPERTY INLET 312
□	SW PIT 310
○	SEWER MANHOLE 741
○	ELECTRICITY PIT 716
○	ELECTRICITY POLE 712
○	ELEC. POLE & LIGHT 713
○	STREET LIGHT 711
○	WATER VALVE 751
○	WATER HYDRANT 753
○	SEWER VENT / I/S 742
○	TELSTRA PIT 751
○	TREE 201
○	STREET SIGN 503
○	T.B.M. 002
○	GAS METER 751
○	WATER METER 754
○	W/HAB) HABITABLE ROOM
○	SHRUBS / FOLIAGE 203
○	WINDOW
H	H = HEAD
S	S = SILL

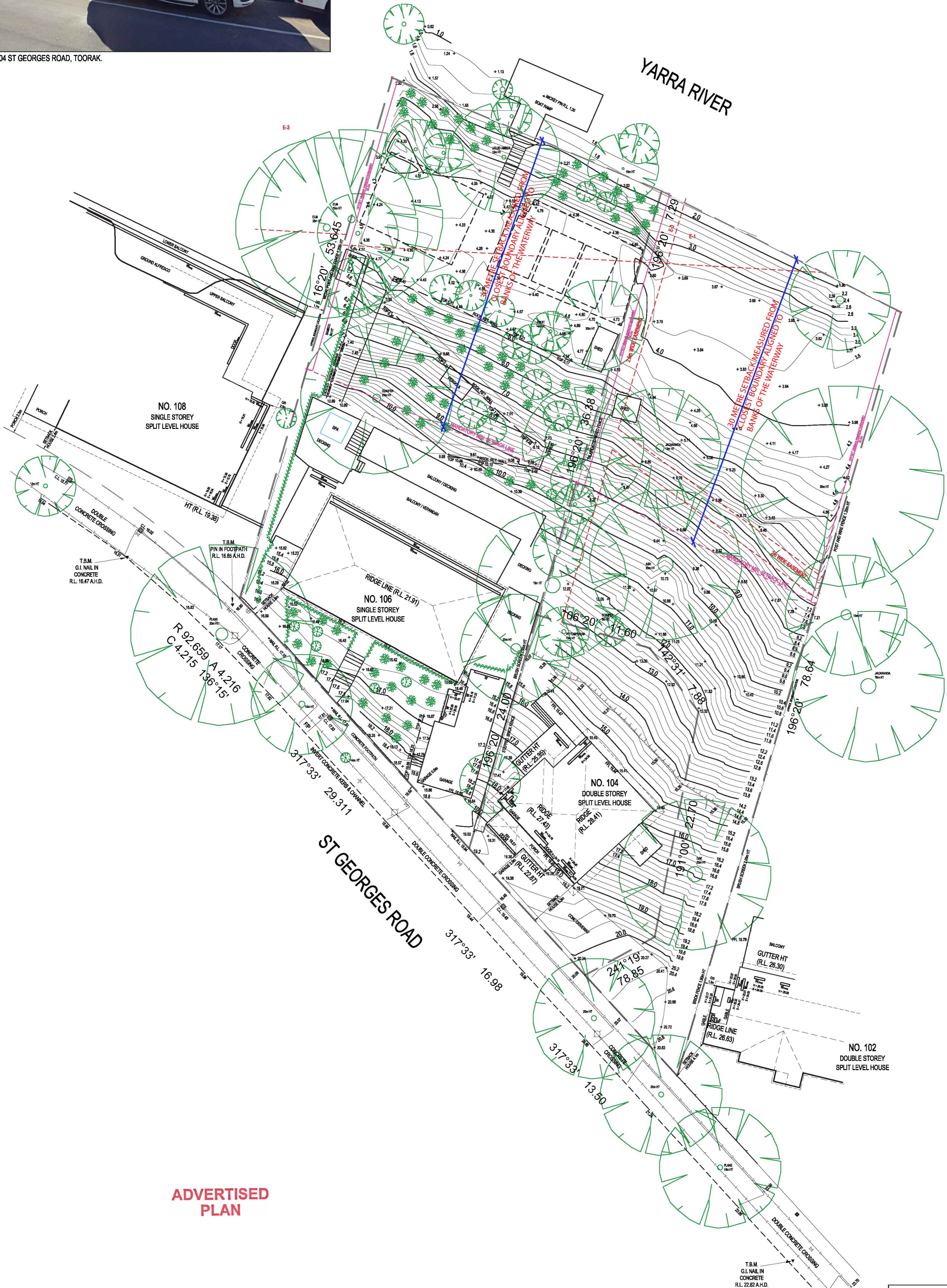

ADVERTISED PLAN

NOTES:
This survey is not a re-establishment survey of this site.
Location of this and relevant offsets are approximated from occupation. Property boundaries are unverified unless otherwise stated.
Only visible services have been located. For underground services the relevant servicing authorities should be contacted.
Only buildings within 5m have been located including the adjoining habitable windows facing subject property.
All trees are under 5m in height unless otherwise stated.
Levels are to Australian Height Datum, contour interval 0.20m.

PLAN OF FEATURE SURVEY

LOT 1 LP 146845
NO. 104-106 ST GEORGES ROAD
TOORAK



REF NO: 2207544 REV C
DATE: 08/12/2021
FW: GARY G.
DRAWN: TOM J.