

Copyright State of Victoria. No part of this publication may be reproduced except as permitted by the Copyright Act 1968 (Cth), to comply with a statutory requirement or pursuant to a written agreement. The information is only valid at the time and in the form obtained from the LANDATA REGD TM System. None of the State of Victoria, its agents or contractors, accepts responsibility for any subsequent publication or reproduction of the information.

The Victorian Government acknowledges the Traditional Owners of Victoria and pays respects to their ongoing connection to their Country, History and Culture. The Victorian Government extends this respect to their Elders, past, present and emerging.

REGISTER SEARCH STATEMENT (Title Search) Transfer of Land Act 1958

VOLUME 03062 FOLIO 211

Security no : 124118328745B  
Produced 17/09/2024 03:55 PM

LAND DESCRIPTION

Crown Allotment 20 Section 59 City of South Melbourne Parish of Melbourne South.  
PARENT TITLE Volume 03062 Folio 210  
Created by instrument E421215 13/06/1972

REGISTERED PROPRIETOR

Estate Fee Simple  
Sole Proprietor  
LANART PTY LTD of 151 PARK ROAD CHELTENHAM VIC 3192  
AV545308B 20/04/2022

ENCUMBRANCES, CAVEATS AND NOTICES

CAVEAT AX411684C 01/11/2023  
Caveator  
MIDDLETON LANE LAND PTY LTD ACN: 672241333  
Grounds of Claim  
PURCHASERS' CONTRACT WITH THE FOLLOWING PARTIES AND DATE.  
Parties  
THE REGISTERED PROPRIETOR(S)  
Date  
31/10/2023  
Estate or Interest  
FREEHOLD ESTATE  
Prohibition  
ABSOLUTELY  
Lodged by  
TISHER LINER FC LAW  
Notices to  
JONATHAN TISHER of LEVEL 2 333 QUEEN STREET MELBOURNE VIC 3000

For details of any other encumbrances see the plan or imaged folio set out under DIAGRAM LOCATION below.

DIAGRAM LOCATION

SEE TP386247U FOR FURTHER DETAILS AND BOUNDARIES

ACTIVITY IN THE LAST 125 DAYS

NIL

-----END OF REGISTER SEARCH STATEMENT-----

Additional information: (not part of the Register Search Statement)

Street Address: 19 DORCAS STREET SOUTH MELBOURNE VIC 3205

ADMINISTRATIVE NOTICES

NIL

**This copied document to be made available  
for the sole purpose of enabling  
its consideration and review as  
part of a planning process under the  
Planning and Environment Act 1987.  
The document must not be used for any  
purpose which may breach any  
copyright**

**ADVERTISED  
PLAN**

eCT Control 16089P NATIONAL AUSTRALIA BANK LTD  
Effective from 29/05/2023

DOCUMENT END

Delivered from the LANDATA System by Dye & Durham Terrain Pty Ltd

## ADVERTISED PLAN

**This copied document to be made available  
for the sole purpose of enabling  
its consideration and review as  
part of a planning process under the  
Planning and Environment Act 1987.  
The document must not be used for any  
purpose which may breach any  
copyright**

Copyright State of Victoria. No part of this publication may be reproduced except as permitted by the Copyright Act 1968 (Cth), to comply with a statutory requirement or pursuant to a written agreement. The information is only valid at the time and in the form obtained from the LANDATA REGD TM System. None of the State of Victoria, its agents or contractors, accepts responsibility for any subsequent publication or reproduction of the information.

The Victorian Government acknowledges the Traditional Owners of Victoria and pays respects to their ongoing connection to their Country, History and Culture. The Victorian Government extends this respect to their Elders, past, present and emerging.

REGISTER SEARCH STATEMENT (Title Search) Transfer of Land Act 1958

VOLUME 03066 FOLIO 057

Security no : 124118328749X  
Produced 17/09/2024 03:55 PM

LAND DESCRIPTION

Crown Allotment 19 Section 59 City of South Melbourne Parish of Melbourne South.  
PARENT TITLE Volume 03062 Folio 210  
Created by instrument 0509785 31/07/1905

REGISTERED PROPRIETOR

Estate Fee Simple

Sole Proprietor

ROTHCORP GROUP HOLDINGS PTY LTD of LEVEL 3 470 ST KILDA ROAD MELBOURNE VIC  
3004  
AH270519P 02/06/2010

ENCUMBRANCES, CAVEATS AND NOTICES

CAVEAT AX411688T 01/11/2023

Caveator

MIDDLETON LANE LAND PTY LTD ACN: 672241333

Grounds of Claim

PURCHASERS' CONTRACT WITH THE FOLLOWING PARTIES AND DATE  
Parties

THE REGISTERED PROPRIETOR(S)

Date

30/10/2023

Estate or Interest

FREEHOLD ESTATE

Prohibition

ABSOLUTELY

Lodged by

TISHER LINER FC LAW

Notices to

JONATHAN TISHER of LEVEL 2 333 QUEEN STREET MELBOURNE VIC 3000

**This copied document to be made available  
for the sole purpose of enabling  
its consideration and review as  
part of a planning process under the  
Planning and Environment Act 1987.  
The document must not be used for any  
purpose which may breach any  
copyright**

For details of any other encumbrances see the plan or imaged folio set out  
under DIAGRAM LOCATION below.

DIAGRAM LOCATION

SEE TP407298Q FOR FURTHER DETAILS AND BOUNDARIES

ACTIVITY IN THE LAST 125 DAYS

NIL

**ADVERTISED  
PLAN**

-----END OF REGISTER SEARCH STATEMENT-----

Additional information: (not part of the Register Search Statement)

Street Address: 21 DORCAS STREET SOUTH MELBOURNE VIC 3205

ADMINISTRATIVE NOTICES

NIL

eCT Control 17289A DOUROS JACKSON LAWYERS  
Effective from 26/05/2023

DOCUMENT END

Delivered from the LANDATA System by Dye & Durham Terrain Pty Ltd

**ADVERTISED  
PLAN**

**This copied document to be made available  
for the sole purpose of enabling  
its consideration and review as  
part of a planning process under the  
Planning and Environment Act 1987.  
The document must not be used for any  
purpose which may breach any  
copyright**

Copyright State of Victoria. No part of this publication may be reproduced except as permitted by the Copyright Act 1968 (Cth), to comply with a statutory requirement or pursuant to a written agreement. The information is only valid at the time and in the form obtained from the LANDATA REGD TM System. None of the State of Victoria, its agents or contractors, accepts responsibility for any subsequent publication or reproduction of the information.

The Victorian Government acknowledges the Traditional Owners of Victoria and pays respects to their ongoing connection to their Country, History and Culture. The Victorian Government extends this respect to their Elders, past, present and emerging.

REGISTER SEARCH STATEMENT (Title Search) Transfer of Land Act 1958

VOLUME 04220 FOLIO 837

Security no : 124118328754S  
Produced 17/09/2024 03:55 PM

LAND DESCRIPTION

-----  
Lots 1 and 2 on Title Plan 687121Q.

PARENT TITLES :

Volume 03509 Folio 677      Volume 03969 Folio 654  
Created by instrument 891928 27/06/1919

REGISTERED PROPRIETOR

-----  
Estate Fee Simple

Sole Proprietor

IZMARGAD PTY LTD of 27 DORCAS STREET SOUTH MELBOURNE VIC 3205  
AM789575R 19/05/2016

ENCUMBRANCES, CAVEATS AND NOTICES

-----  
Any encumbrances created by Section 98 Transfer of Land Act 1958 or Section 24 Subdivision Act 1988 and any other encumbrances shown or entered on the plan set out under DIAGRAM LOCATION below.

DIAGRAM LOCATION

-----  
SEE TP687121Q FOR FURTHER DETAILS AND BOUNDARIES

ACTIVITY IN THE LAST 125 DAYS

-----  
NIL

DOCUMENT END

Delivered from the LANDATA System by Dye & Durham Terrain Pty Ltd

**ADVERTISED  
PLAN**

This copied document to be made available for the sole purpose of enabling its consideration and review as part of a planning process under the Planning and Environment Act 1987. The document must not be used for any purpose which may breach any copyright

Copyright State of Victoria. No part of this publication may be reproduced except as permitted by the Copyright Act 1968 (Cth), to comply with a statutory requirement or pursuant to a written agreement. The information is only valid at the time and in the form obtained from the LANDATA REGD TM System. None of the State of Victoria, its agents or contractors, accepts responsibility for any subsequent publication or reproduction of the information.

The Victorian Government acknowledges the Traditional Owners of Victoria and pays respects to their ongoing connection to their Country, History and Culture. The Victorian Government extends this respect to their Elders, past, present and emerging.

REGISTER SEARCH STATEMENT (Title Search) Transfer of Land Act 1958

VOLUME 08399 FOLIO 303

Security no : 124118328750W  
Produced 17/09/2024 03:55 PM

LAND DESCRIPTION

Lot 1 on Title Plan 412247E (formerly known as part of Crown Allotment 18 Section 59 City of South Melbourne Parish of Melbourne South).  
PARENT TITLE Volume 03109 Folio 673  
Created by instrument B595829 11/02/1963

REGISTERED PROPRIETOR

Estate Fee Simple  
Sole Proprietor

LANART PTY LTD of 23 OLIVER ROAD TEMPLESTOWE VIC 3106  
AD549822V 11/04/2005

ENCUMBRANCES, CAVEATS AND NOTICES

MORTGAGE AH058741X 23/02/2010  
NATIONAL AUSTRALIA BANK LTD

CAVEAT AX411981V 01/11/2023

Caveator  
MIDDLETON LANE LAND PTY LTD ACN: 672241333  
Grounds of Claim  
PURCHASERS' CONTRACT WITH THE FOLLOWING PARTIES AND DATE.  
Parties  
THE REGISTERED PROPRIETOR(S)  
Date  
31/10/2023  
Estate or Interest  
FREEHOLD ESTATE  
Prohibition  
ABSOLUTELY  
Lodged by  
TISHER LINER FC LAW  
Notices to  
JONATHAN TISHER of LEVEL 2 333 QUEEN STREET MELBOURNE VIC 3000

Any encumbrances created by Section 98 Transfer of Land Act 1958 or Section 24 Subdivision Act 1988 and any other encumbrances shown or entered on the plan set out under DIAGRAM LOCATION below.

DIAGRAM LOCATION

SEE TP412247E FOR FURTHER DETAILS AND BOUNDARIES

ACTIVITY IN THE LAST 125 DAYS

NIL

-----END OF REGISTER SEARCH STATEMENT-----

Additional information: (not part of the Register Search Statement)

**This copied document to be made available  
for the sole purpose of enabling  
its consideration and review as  
part of a planning process under the  
Planning and Environment Act 1987.  
The document must not be used for any  
purpose which may breach any  
copyright**

**ADVERTISED  
PLAN**

Street Address: 23 DORCAS STREET SOUTH MELBOURNE VIC 3205

ADMINISTRATIVE NOTICES

-----  
NIL

eCT Control 16089P NATIONAL AUSTRALIA BANK LTD  
Effective from 23/10/2016

DOCUMENT END

Delivered from the LANDATA System by Dye & Durham Terrain Pty Ltd

**ADVERTISED  
PLAN**

**This copied document to be made available  
for the sole purpose of enabling  
its consideration and review as  
part of a planning process under the  
Planning and Environment Act 1987.  
The document must not be used for any  
purpose which may breach any  
copyright**

Copyright State of Victoria. No part of this publication may be reproduced except as permitted by the Copyright Act 1968 (Cth), to comply with a statutory requirement or pursuant to a written agreement. The information is only valid at the time and in the form obtained from the LANDATA REGD TM System. None of the State of Victoria, its agents or contractors, accepts responsibility for any subsequent publication or reproduction of the information.

The Victorian Government acknowledges the Traditional Owners of Victoria and pays respects to their ongoing connection to their Country, History and Culture. The Victorian Government extends this respect to their Elders, past, present and emerging.

REGISTER SEARCH STATEMENT (Title Search) Transfer of Land Act 1958

VOLUME 10224 FOLIO 394

Security no : 124118328741G  
Produced 17/09/2024 03:55 PM

LAND DESCRIPTION

Land in Plan of Consolidation 153719.  
PARENT TITLE Volume 09499 Folio 800  
Created by instrument T461866C 13/12/1994

REGISTERED PROPRIETOR

Estate Fee Simple  
Sole Proprietor

DORCAS ST DEVELOPMENT PTY LTD of LEVEL 6 189 FLINDERS LANE MELBOURNE VIC  
3000  
AU008622B 03/02/2021

ENCUMBRANCES, CAVEATS AND NOTICES

MORTGAGE AW008727T 29/08/2022  
MCH AGENCY SERVICES PTY LTD

Any encumbrances created by Section 98 Transfer of Land Act 1958 or Section 24 Subdivision Act 1988 and any other encumbrances shown or entered on the plan or imaged folio set out under DIAGRAM LOCATION below.

DIAGRAM LOCATION

SEE CP153719 FOR FURTHER DETAILS AND BOUNDARIES

ACTIVITY IN THE LAST 125 DAYS

NIL

-----END OF REGISTER SEARCH STATEMENT-----

Additional information: (not part of the Register Search Statement)

Street Address: 11-17 DORCAS STREET SOUTH MELBOURNE VIC 3205

ADMINISTRATIVE NOTICES

NIL

eCT Control 19234R MINTER ELLISON  
Effective from 29/08/2022

DOCUMENT END

Delivered from the LANDATA System by Dye & Durham Terrain Pty Ltd

**This copied document to be made available  
for the sole purpose of enabling  
its consideration and review as  
part of a planning process under the  
Planning and Environment Act 1987.  
The document must not be used for any  
purpose which may breach any  
copyright**

**ADVERTISED  
PLAN**



# Imaged Document Cover Sheet

The document following this cover sheet is an imaged document supplied by LANDATA®, Secure Electronic Registries Victoria.

Document Type	<b>Plan</b>
Document Identification	<b>CP153719</b>
Number of Pages (excluding this cover sheet)	<b>1</b>
Document Assembled	<b>05/07/2022 11:54</b>

**Copyright and disclaimer notice:**

© State of Victoria. This publication is copyright. No part may be reproduced by any process except in accordance with the provisions of the Copyright Act 1968 (Cth) and for the purposes of Section 32 of the Sale of Land Act 1962 or pursuant to a written agreement. The information is only valid at the time and in the form obtained from the LANDATA® System. None of the State of Victoria, LANDATA®, Secure Electronic Registries Victoria Pty Ltd (ABN 86 627 986 396) as trustee for the Secure Electronic Registries Victoria Trust (ABN 83 206 746 897) accept responsibility for any subsequent release, publication or reproduction of the information.

The document is invalid if this cover sheet is removed or altered.

**This copied document to be made available  
for the sole purpose of enabling  
its consideration and review as  
part of a planning process under the  
Planning and Environment Act 1987.  
The document must not be used for any  
purpose which may breach any  
copyright**

**ADVERTISED  
PLAN**

CP153719

CP153719

This copied document to be made available for the sole purpose of enabling its consideration and review as part of a planning process under the Planning and Environment Act 1987. The document must not be used for any purpose which may breach any copyright

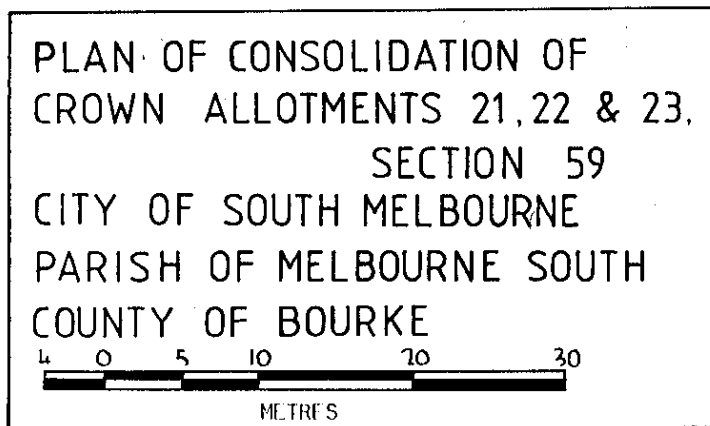

LITHO sheet 1. MELBOURNE SOUTH 32

**ADVERTISED  
PLAN** 20

9499 800

Vol 4141 Fol 105  
Vol 8899 Fol 600

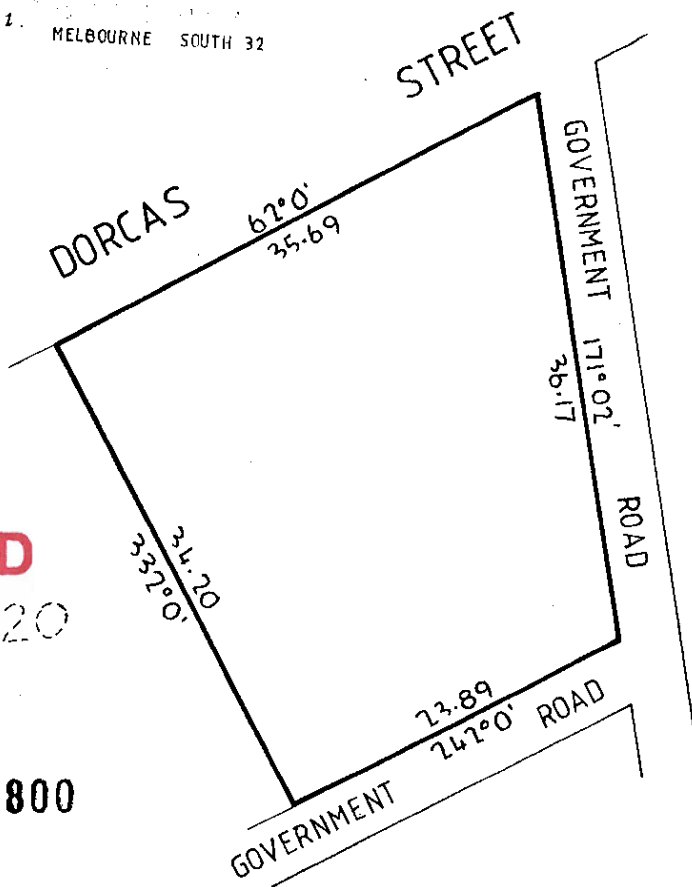

APPROVED

CONSENT OF COUNCIL	SURVEYOR'S CERTIFICATION
<p>This Plan of Consolidation was approved by the Council of the City of South Melbourne on 7th September, 1981, and has been sealed pursuant to Section 569AB of the Local Government Act.</p> <p>As witness whereof the ) corporate Seal of the ) Mayor, Councillors and ) Citizens of the City of ) South Melbourne was ) affixed hereto this ) Eighth day of September ) 1981 in the presence of )</p> <p>Mayor <i>[Signature]</i> Councillor <i>[Signature]</i> Chief Executive Officer and Town Clerk <i>[Signature]</i></p>	<p>I certify that this plan has been made by me or under my immediate supervision, accords with Title and is mathematically correct.</p> <p><i>[Signature]</i> Licensed Surveyor</p> <p>Date <u>14/7/1981</u></p>

# Imaged Document Cover Sheet

The document following this cover sheet is an imaged document supplied by LANDATA®, Secure Electronic Registries Victoria.

Document Type	<b>Plan</b>
Document Identification	<b>TP386247U</b>
Number of Pages (excluding this cover sheet)	<b>1</b>
Document Assembled	<b>03/07/2023 16:30</b>

**Copyright and disclaimer notice:**

© State of Victoria. This publication is copyright. No part may be reproduced by any process except in accordance with the provisions of the Copyright Act 1968 (Cth) and for the purposes of Section 32 of the Sale of Land Act 1962 or pursuant to a written agreement. The information is only valid at the time and in the form obtained from the LANDATA® System. None of the State of Victoria, LANDATA®, Secure Electronic Registries Victoria Pty Ltd (ABN 86 627 986 396) as trustee for the Secure Electronic Registries Victoria Trust (ABN 83 206 746 897) accept responsibility for any subsequent release, publication or reproduction of the information.

The document is invalid if this cover sheet is removed or altered.

**This copied document to be made available  
for the sole purpose of enabling  
its consideration and review as  
part of a planning process under the  
Planning and Environment Act 1987.  
The document must not be used for any  
purpose which may breach any  
copyright**

**ADVERTISED  
PLAN**

TITLE PLAN		EDITION 1	TP 386247U
<div>Location of Land  Parish: CITY OF SOUTH MELBOURNE PARISH OF MELBOURNE SOUTH Township: Section: 59 Crown Allotment: 20 Crown Portion:  Last Plan Reference: Derived From: VOL 3062 FOL 211 Depth Limitation: NIL</div>		<div>Notations  ANY REFERENCE TO MAP IN THE TEXT MEANS THE DIAGRAM SHOWN ON THIS TITLE PLAN</div>	
<div>This copied document to be made available for the sole purpose of enabling its consideration and review as part of a planning process under the Planning and Environment Act 1987. The document must not be used for any purpose which may breach any copyright</div>		<div>Description of Land / Easement Information  THIS PLAN HAS BEEN PREPARED FOR THE LAND REGISTRY, LAND VICTORIA, FOR TITLE DIAGRAM PURPOSES AS PART OF THE LAND TITLES AUTOMATION PROJECT COMPILED: 05/04/2000 VERIFIED: HG</div>	
<div><div><div></div></div><div></div></div>			
<div>ADVERTISED PLAN</div>			
LENGTHS ARE IN LINKS		Metres = 0.3048 x Feet Metres = 0.201168 x Links	Sheet 1 of 1 sheets

# Imaged Document Cover Sheet

The document following this cover sheet is an imaged document supplied by LANDATA®, Secure Electronic Registries Victoria.

Document Type	<b>Plan</b>
Document Identification	<b>TP407298Q</b>
Number of Pages (excluding this cover sheet)	<b>1</b>
Document Assembled	<b>03/07/2023 16:30</b>

**Copyright and disclaimer notice:**

© State of Victoria. This publication is copyright. No part may be reproduced by any process except in accordance with the provisions of the Copyright Act 1968 (Cth) and for the purposes of Section 32 of the Sale of Land Act 1962 or pursuant to a written agreement. The information is only valid at the time and in the form obtained from the LANDATA® System. None of the State of Victoria, LANDATA®, Secure Electronic Registries Victoria Pty Ltd (ABN 86 627 986 396) as trustee for the Secure Electronic Registries Victoria Trust (ABN 83 206 746 897) accept responsibility for any subsequent release, publication or reproduction of the information.

The document is invalid if this cover sheet is removed or altered.

**This copied document to be made available  
for the sole purpose of enabling  
its consideration and review as  
part of a planning process under the  
Planning and Environment Act 1987.  
The document must not be used for any  
purpose which may breach any  
copyright**

**ADVERTISED  
PLAN**

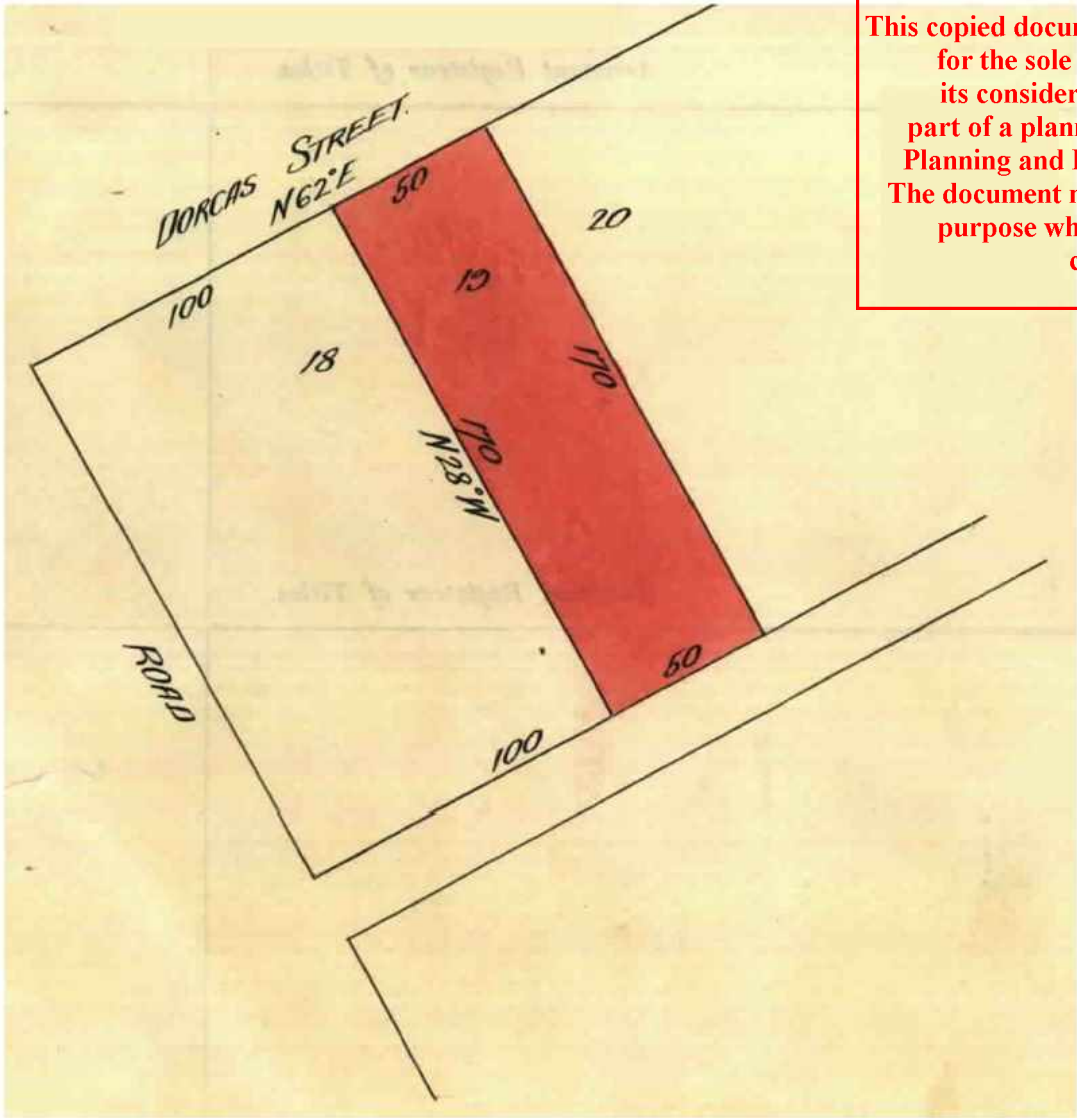
TITLE PLAN		EDITION 1	TP 407298Q
<p>Location of Land</p> <p>Parish: CITY OF SOUTH MELBOURNE PARISH OF MELBOURNE SOUTH</p> <p>Township:</p> <p>Section: 59</p> <p>Crown Allotment: 19</p> <p>Crown Portion:</p> <p>Last Plan Reference:</p> <p>Derived From: VOL 3066 FOL 057</p> <p>Depth Limitation: NIL</p>		<p>Notations</p> <p>ANY REFERENCE TO MAP IN THE TEXT MEANS THE DIAGRAM SHOWN ON THIS TITLE PLAN</p>	
<p>Description of Land / Easement Information</p> <p><b>ADVERTISED PLAN</b></p>		<p>THIS PLAN HAS BEEN PREPARED FOR THE LAND REGISTRY, LAND VICTORIA, FOR TITLE DIAGRAM PURPOSES AS PART OF THE LAND TITLES AUTOMATION PROJECT</p> <p>COMPILED: 17/04/2000</p> <p>VERIFIED: CL</p>	
			
<p>LENGTHS ARE IN LINKS</p>		<p>Metres = 0.3048 x Feet</p> <p>Metres = 0.201168 x Links</p>	Sheet 1 of 1 sheets

This copied document to be made available for the sole purpose of enabling its consideration and review as part of a planning process under the Planning and Environment Act 1987. The document must not be used for any purpose which may breach any copyright

# Imaged Document Cover Sheet

The document following this cover sheet is an imaged document supplied by LANDATA®, Secure Electronic Registries Victoria.

Document Type	<b>Plan</b>
Document Identification	<b>TP412247E</b>
Number of Pages (excluding this cover sheet)	<b>1</b>
Document Assembled	<b>03/07/2023 16:31</b>

**Copyright and disclaimer notice:**

© State of Victoria. This publication is copyright. No part may be reproduced by any process except in accordance with the provisions of the Copyright Act 1968 (Cth) and for the purposes of Section 32 of the Sale of Land Act 1962 or pursuant to a written agreement. The information is only valid at the time and in the form obtained from the LANDATA® System. None of the State of Victoria, LANDATA®, Secure Electronic Registries Victoria Pty Ltd (ABN 86 627 986 396) as trustee for the Secure Electronic Registries Victoria Trust (ABN 83 206 746 897) accept responsibility for any subsequent release, publication or reproduction of the information.

The document is invalid if this cover sheet is removed or altered.

**This copied document to be made available  
for the sole purpose of enabling  
its consideration and review as  
part of a planning process under the  
Planning and Environment Act 1987.  
The document must not be used for any  
purpose which may breach any  
copyright**

**ADVERTISED  
PLAN**



TITLE PLAN		EDITION 1	TP 412247E						
<b>Location of Land</b>  Parish: CITY OF SOUTH MELBOURNE PARISH OF MELBOURNE SOUTH Township: Section: 59 Crown Allotment: 18 (PT) Crown Portion:  Last Plan Reference: Derived From: VOL 8399 FOL 303 Depth Limitation: NIL		<b>Notations</b>     ANY REFERENCE TO MAP IN THE TEXT MEANS THE DIAGRAM SHOWN ON THIS TITLE PLAN							
<b>Description of Land / Easement Information</b>  <div>ADVERTISED PLAN</div>		<div>THIS PLAN HAS BEEN PREPARED FOR THE LAND REGISTRY, LAND VICTORIA, FOR TITLE DIAGRAM PURPOSES AS PART OF THE LAND TITLES AUTOMATION PROJECT COMPILED: 19/04/2000 VERIFIED: GB</div>							
<div><div><div></div></div><div></div></div>									
<table><tr><th colspan="2">TABLE OF PARCEL IDENTIFIERS</th></tr><tr><td colspan="2">WARNING: Where multiple parcels are referred to or shown on this Title Plan this does not imply separately disposable parcels under Section 8A of the Sale of Land Act 1962</td></tr><tr><td colspan="2">PARCEL 1 = CA 18 (PT)</td></tr></table>				TABLE OF PARCEL IDENTIFIERS		WARNING: Where multiple parcels are referred to or shown on this Title Plan this does not imply separately disposable parcels under Section 8A of the Sale of Land Act 1962		PARCEL 1 = CA 18 (PT)	
TABLE OF PARCEL IDENTIFIERS									
WARNING: Where multiple parcels are referred to or shown on this Title Plan this does not imply separately disposable parcels under Section 8A of the Sale of Land Act 1962									
PARCEL 1 = CA 18 (PT)									
LENGTHS ARE IN LINKS		Metres = 0.3048 x Feet Metres = 0.201168 x Links	Sheet 1 of 1 sheets						

This copied document to be made available for the sole purpose of enabling its consideration and review as part of a planning process under the Planning and Environment Act 1987. The document must not be used for any purpose which may breach any copyright



TITLE PLAN		EDITION 1	TP 687121Q								
Location of Land  Parish: CITY OF SOUTH MELBOURNE PARISH OF MELBOURNE SOUTH Township: Section: 59 Crown Allotment: 17, 18(PT) Crown Portion:  Last Plan Reference: Derived From: VOL 4220 FOL 837 Depth Limitation: NIL		Notations      ANY REFERENCE TO MAP IN THE TEXT MEANS THE DIAGRAM SHOWN ON THIS TITLE PLAN									
Description of Land / Easement Information		THIS PLAN HAS BEEN PREPARED FOR THE LAND REGISTRY, LAND VICTORIA, FOR TITLE DIAGRAM PURPOSES AS PART OF THE LAND TITLES AUTOMATION PROJECT COMPILED: 13/11/2000 VERIFIED: SO'C									
		ADVERTISED PLAN									
<table><tr><th colspan="2">TABLE OF PARCEL IDENTIFIERS</th></tr><tr><td colspan="2">WARNING: Where multiple parcels are referred to or shown on this Title Plan this does not imply separately disposable parcels under Section 8A of the Sale of Land Act 1962</td></tr><tr><td colspan="2">PARCEL 1 = CA 17</td></tr><tr><td colspan="2">PARCEL 2 = CA 18 (PT)</td></tr></table>				TABLE OF PARCEL IDENTIFIERS		WARNING: Where multiple parcels are referred to or shown on this Title Plan this does not imply separately disposable parcels under Section 8A of the Sale of Land Act 1962		PARCEL 1 = CA 17		PARCEL 2 = CA 18 (PT)	
TABLE OF PARCEL IDENTIFIERS											
WARNING: Where multiple parcels are referred to or shown on this Title Plan this does not imply separately disposable parcels under Section 8A of the Sale of Land Act 1962											
PARCEL 1 = CA 17											
PARCEL 2 = CA 18 (PT)											
LENGTHS ARE IN LINKS		Metres = 0.3048 x Feet Metres = 0.201168 x Links	Sheet 1 of 1 sheets								

This copied document to be made available for the sole purpose of enabling its consideration and review as part of a planning process under the Planning and Environment Act 1987. The document must not be used for any purpose which may breach any copyright