

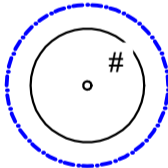

ADVERTISED PLAN

LEGEND

-  Existing Tree to be Retained
Tree Protection Zone (TPZ) Dashed Blue
Refer to Arborist Report by CHATEFIELD
Arboretists & Consultants dated 06.08.2025
-  Existing Tree To Be Removed
Refer to Arborist Report by CHATEFIELD
Arboretists & Consultants dated 06.08.2025

TREE PROTECTION NOTES

Tree Protection measures are to be in accordance with Australian Standard AS 4970 -2009 Protection of Trees on Development Sites

1. All trees to be retained are to be identified and fenced off prior to demolition and construction works commencing, or any heavy machinery entering the site. Tree protection fencing is to be established to create an exclusion zone around the tree at the distance from the trunk specified as the Tree Protection Zone (TPZ) or as indicated on the Landscape Plan. Once erected, these areas are to be maintained as 'no go' zones to limit trafficking through the TPZs and avoid inadvertent mechanical damage by construction vehicles and equipment during construction. Fencing is to remain in place until soft landscaping works commence as part of the final stage of site works.
2. If access or temporary relocation of protective fencing is required e.g. to allow for the demolition of existing structures, it must be with the approval and supervision of a Project Arborist. The appointed Project Arborist is to be an appropriately experienced and skilled professional with a minimum qualification of Certificate V (or equivalent) in Arboriculture.
3. Tree Protection fencing is to be constructed of temporary security fencing (or similar) securely fixed to block bases. No holes are to be dug for fence construction unless outside the specified TPZ. Fencing is to be of a minimum height of 1.8m and is to be secure, so as to deter easy entry. At least one weatherproof sign per side is to be attached to each fenced TPZ and is to clearly state "TREE PROTECTION ZONE. ENTRY RESTRICTIONS APPLY. DO NOT REMOVE FENCE. CONTACT THE CONTRACTOR IF ENTRY IS REQUIRED. NO EXCAVATING OR TRENCHING. NO STORAGE OF MATERIALS OR WASTE" and is to have the Contractor's (or appointed site foreman) and Project Arborist's contact details.
4. The ground within all TPZs within the site (both fenced and unfenced) and outside of the building footprints is to be maintained with a 50-100mm layer of coarse woodchips. Woodchips are to be well composted and are to be kept a minimum of 300mm back from the tree's trunk. The soil surface is to be thoroughly wet immediately prior to the installation of the mulch layer. Unless during water restrictions, irrigation is to be provided for each of the trees from December to March inclusive. A weed control program is to be implemented for mulched areas.
5. Any root and branch pruning requirements are to be carried out by the appointed Project Arborist and be in accordance with Australian Standard AS 4373-2007 Pruning of Amenity Trees. Where a root diameter of 20mm or greater is encountered during site works, these shall be cleanly pruned by hand, and never torn from the ground by machinery.
6. Throughout construction works the Project Arborist is to undertake regular inspections of trees and carry out remedial works as required to ensure trees retain good health and where necessary install additional trunk, branch or ground protection.
7. These general protection requirements apply throughout the development process:
 - No heavy machinery is to enter the fenced areas of the TPZ without the express permission of the Project Arborist (emergency service vehicles excluded);
 - No trenching or removal of soil is to take place. Existing levels must be maintained. Garden beds must be constructed using existing site soil;
 - No fill to a depth greater than 100mm is to be installed;
 - Any vegetation located within Tree Protection Zones is to be removed by hand so that no heavy machinery enters into TPZ;
 - No trenched services are to pass through the TPZ. If services are required they are to be bored beneath the root zone to a depth approved by the Project Arborist, or non-destructively excavated, such as hydro excavation, to retain significant roots in situ.
 - No drainage or subsurface irrigation lines are to be installed;
 - No fuel, oil dumps or chemicals shall be allowed in or stored on the Tree Protection Zone. The servicing and refuelling of equipment and vehicles must be carried out away from the root zone;
 - No storage of materials, equipment or temporary buildings will take place over the root zone;
 - No fixtures of any sort shall be attached to the trees for any reason;
 - The Project Arborist is to be consulted prior to heavy machinery accessing any of the fenced TPZ;
 - All machinery is to be kept clear of the tree canopy to prevent impact damage;
 - If damage of any sort is to occur to any tree on site, the Project Arborist must be contacted to take immediate remedial action.
 - Any changes to the building/landscaping design which alter surface or below ground works within the fenced TPZ are to be subject to the approval of the Project Arborist prior to proceeding.

This copied document to be made available for the sole purpose of enabling its consideration and review as part of a planning process under the Planning and Environment Act 1987. The document must not be used for any purpose which may breach any copyright

REVISION	DATE	BY
A Updated to latest architectural drawings	02.05.2026	BG
B Revised Town Planning Submission	13.05.2026	BG

CLIENT
Woolworths Pty Ltd.

DRAWING
Landscape Site Plan
for Town Planning

SCALE	1:500 @A1
DATE	13/05/2026
DRAWN	BG
CHECKED	KD
JOB NO	25-360-TP01-REV0
DWG NO	TP01
CAD FILE	25-360-TP01-Rev0.dwg

PROJECT
Woolworths Strathfieldsaye
17-23 Apsley Lane & 39 Blucher Street,
Strathfieldsaye, VIC, 3551



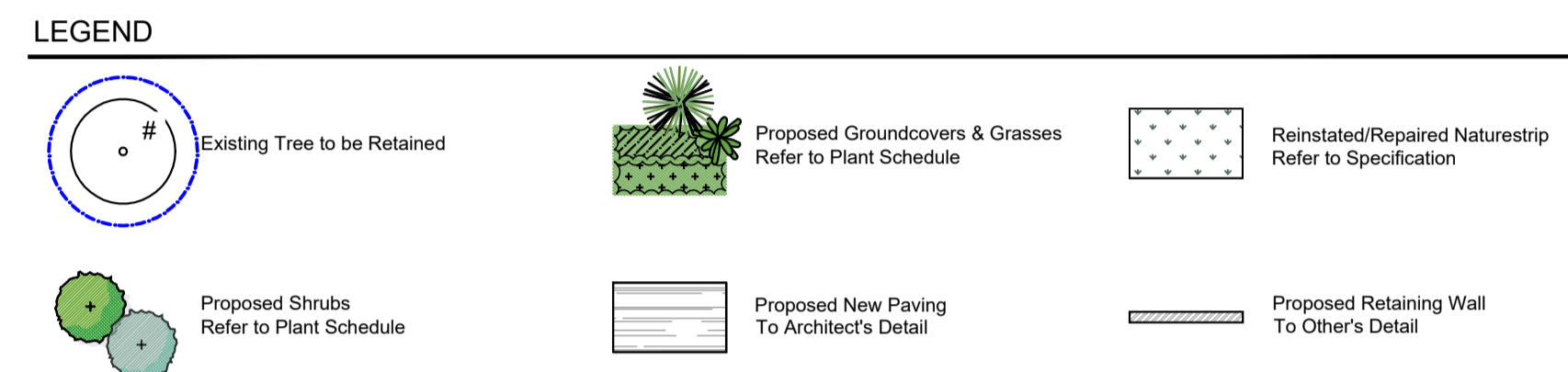
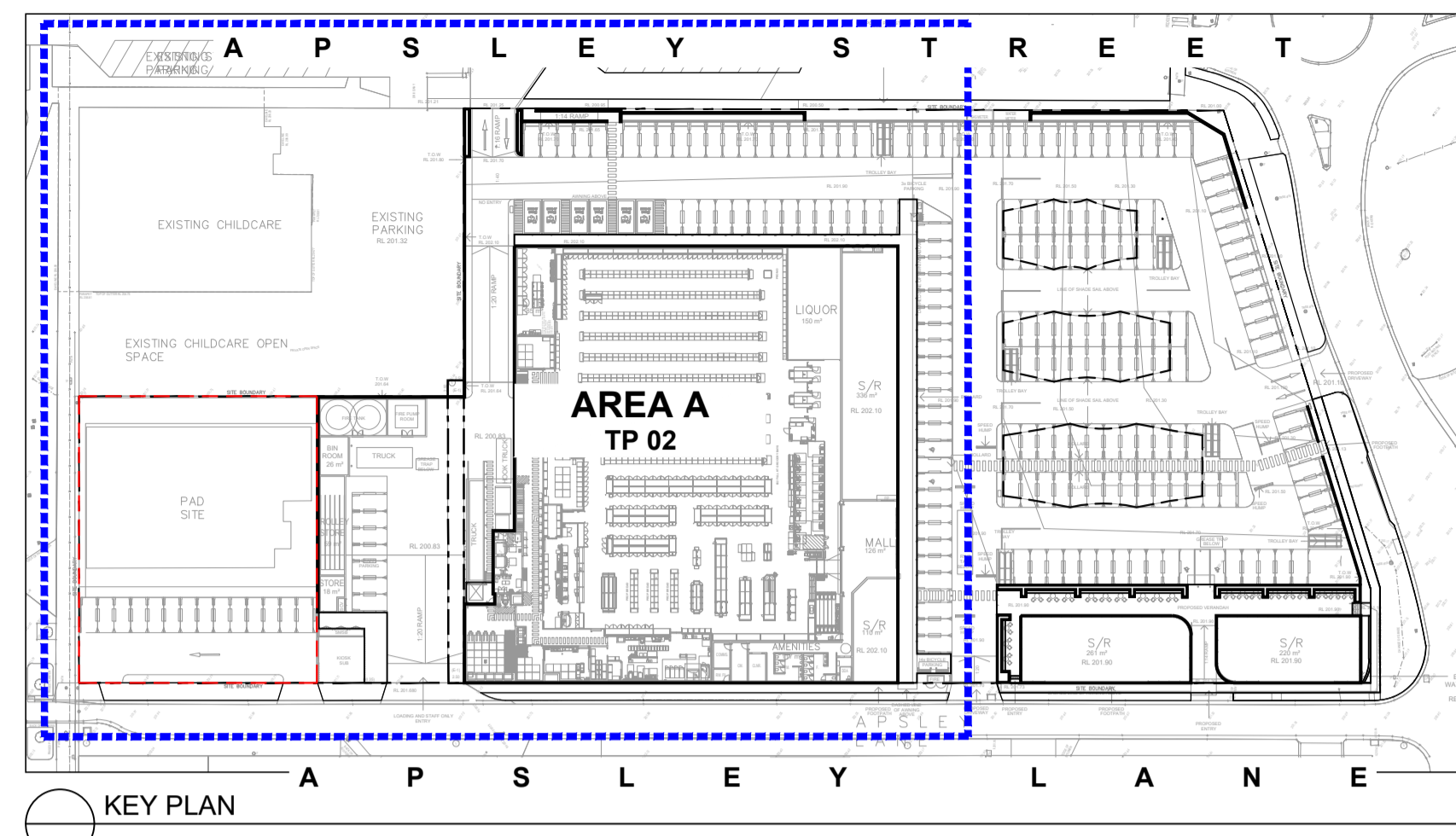

ADVERTISED PLAN

This copied document to be made available for the sole purpose of enabling its consideration and review as part of a planning process under the Planning and Environment Act 1987. The document must not be used for any purpose which may breach any copyright

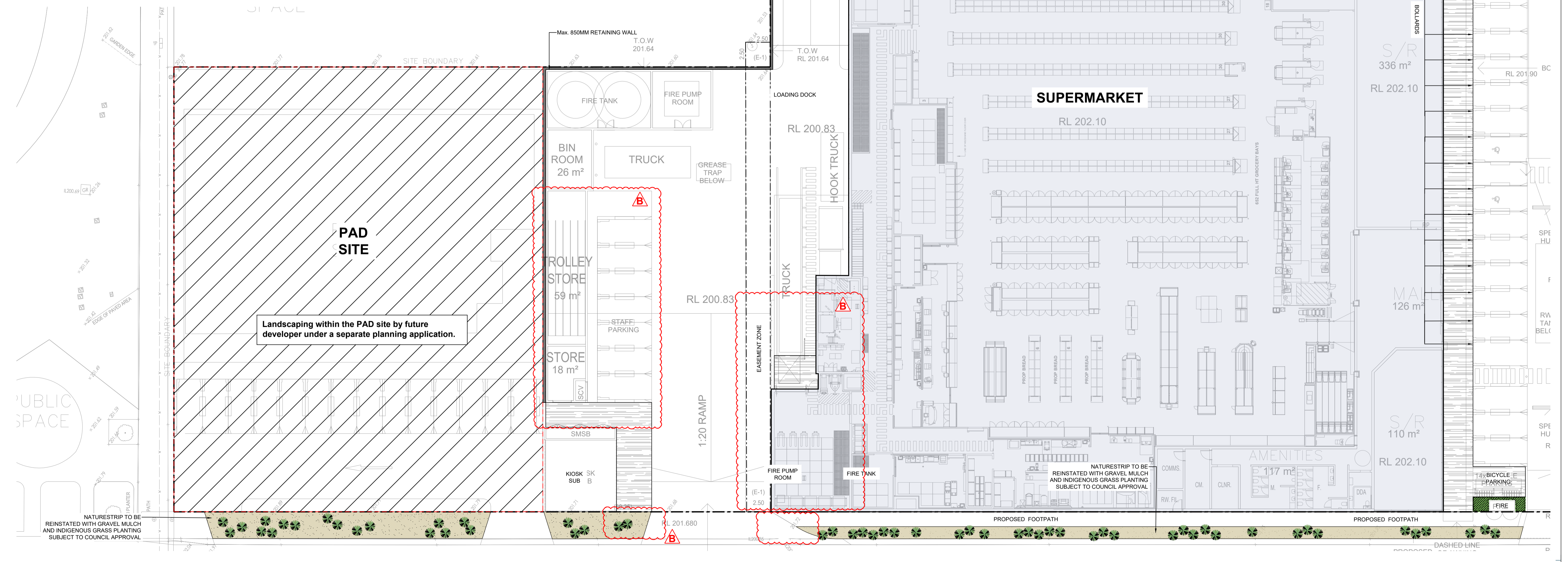

COPYRIGHT
This drawing must not be copied in whole or in part without the consent of John Patrick Landscape Architects Pty Ltd
Do not scale off drawings
NOT FOR CONSTRUCTION



JOHN PATRICK
JOHN PATRICK LANDSCAPE ARCHITECTS PTY LTD
324 Victoria Street, Richmond, VIC, 3121
T +61 3 942 94855 F +61 3 9429 8211
www.johnpatrick.com.au

REVISION	DATE	BY
A Updated to latest architectural drawings	02.05.2026	BG
B Revised Town Planning Submission	13.05.2026	BG

CLIENT
Woolworths Pty Ltd.

PROJECT
Woolworths Strathfieldsaye
17-23 Apsley Lane & 39 Blucher Street,
Strathfieldsaye, VIC, 3551

DRAWING
Landscape Plan -AREA A-
for Town Planning



SCALE	DATE	DRAWN	CHECKED	JOB NO	DWG NO	CAD FILE
1:200 @A1	13/05/2026	BG	KD	25-360-TP01-REV/B	TP02	25-360-TP01-Rev18.dwg

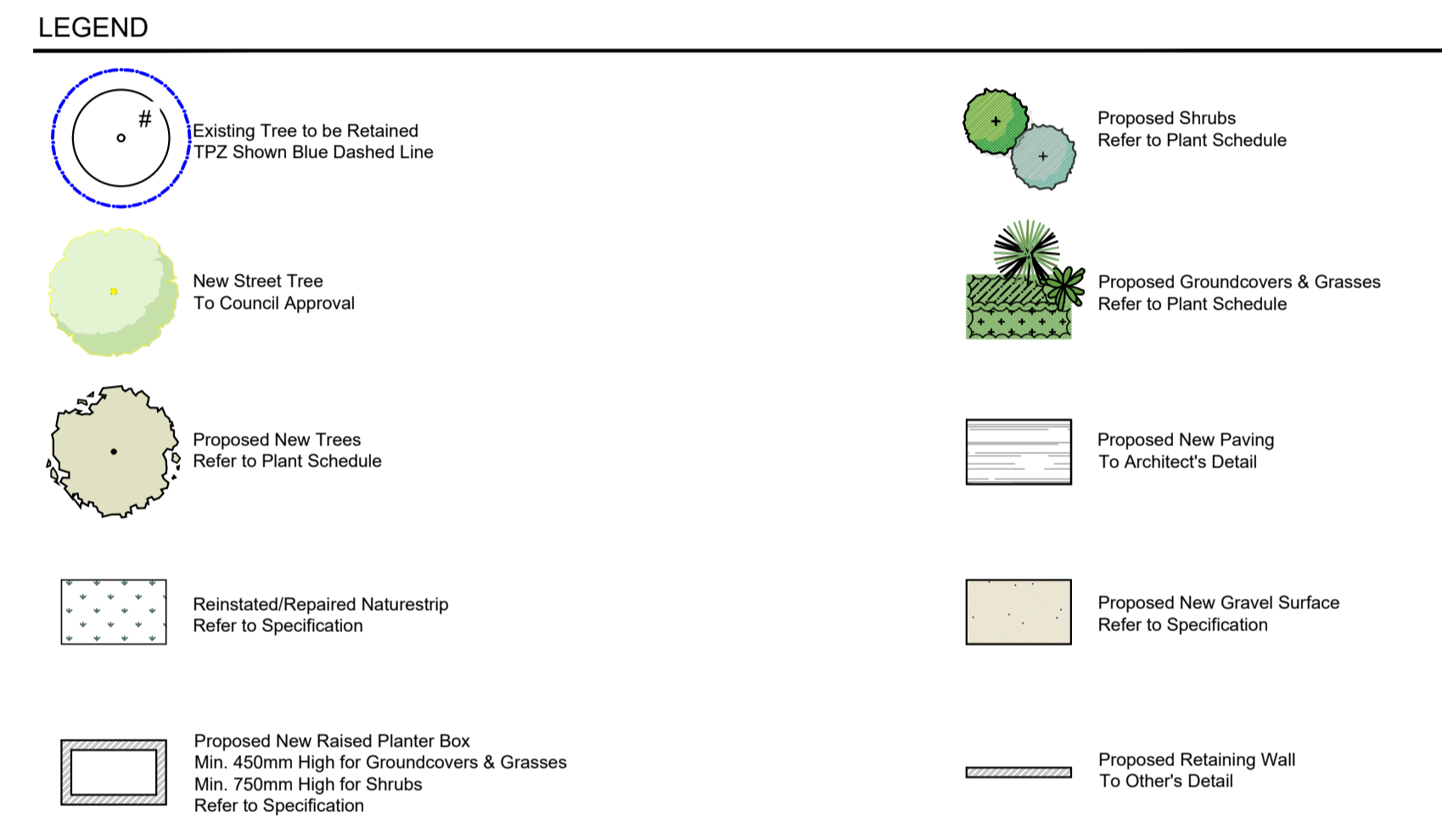
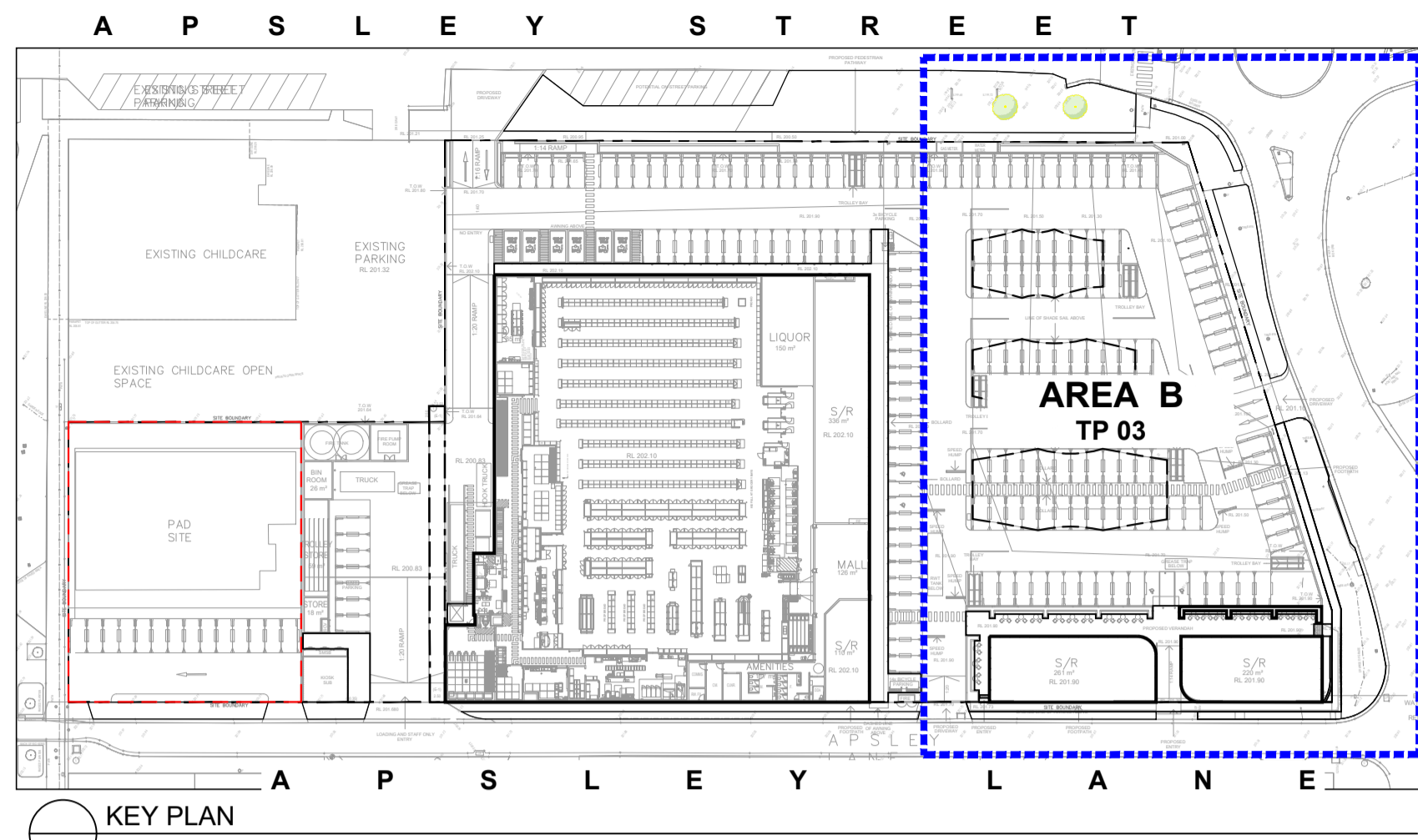

PLANT SCHEDULE

SYM	BOTANICAL NAME	COMMON NAME	D/E N/Ex*	HGHT X WIDTH AT MATURITY	MIN SUPPLY SIZE	QTY
TREES						
Bp	<i>Brachycthon populneus</i>	Kurrajong Tree	E/!	12 x 8m	50cm/2.0mH	8
TOTAL						8
SHRUBS						
Cg	<i>Correa glabra</i>	Rock Correa	E/!	1.2 x 1.2m	200mm pot	
Grcv	<i>Grevillea rosmarinifolia</i> 'Crimson Villa'	Crimson Villa Rosemary Grevillea	E/N	0.8 x 0.8m	200mm pot	
TOTAL						
GROUNDCOVERS						
Ae	<i>Austrostipa mollis</i>	Soft Spear-grass	E/!	0.8 x 0.8m	140mm pot	
Ca	<i>Chrysocephalum apiculatum</i>	Common Everlasting	E/!	0.5 x 0.8m	140mm pot	
Cm	<i>Caprirotus modestus</i>	Ireland Pigface	E/!	Spreading	140mm pot	
Et	<i>Enchlyaena tomentosa</i>	Ruby Saltbush (prostrate)	E/!	0.4 x 0.6m	140mm pot	
Lf	<i>Lomandra fluviatilis</i>	Lomandra Shara	E/N	0.5 x 0.5m	140mm pot	
Li	<i>Lomandra longifolia</i>	Spiny-headed Mat-rush	E/!	1 x 1.5m	140mm pot	
MpY	<i>Myoporum parvifolium</i> 'Yareena'	Creeping Bookhalla 'Yareena'	E/N	0.1 x 1m	140mm pot	
Pi	<i>Poa labillardieri</i>	Tussock Grass	E/!	0.8 x 0.8m	140mm pot	
Scv	<i>Scaevola 'Maue Clusters'</i>	Maue Clusters Fan Flower	E/N	0.3 x 0.6m	140mm pot	
Wm	<i>Westringia fruticosa</i> 'Mundi'	Groundcover Coastal Rosemary	E/N	0.4 x 1.5m	140mm pot	
TOTAL						

*D/E = Deciduous/Evergreen N/Ex = Native/Exotic

This copied document to be made available for the sole purpose of enabling its consideration and review as part of a planning process under the Planning and Environment Act 1987. The document must not be used for any purpose which may breach any copyright



COPYRIGHT
This drawing must not be copied in whole or in part without the consent of John Patrick Landscape Architects Pty Ltd
Do not scale off drawings
NOT FOR CONSTRUCTION



JOHN PATRICK
JOHN PATRICK LANDSCAPE ARCHITECTS PTY LTD
324 Victoria Street, Richmond, VIC, 3121
T +61 3 942 94855 F +61 3 9429 8211
www.johnpatrick.com.au

REVISION	DATE	BY
A Updated to latest architectural drawings	02.05.2026	BG
B Revised Town Planning Submission	13.05.2026	BG

CLIENT
Woolworths Pty Ltd.

PROJECT
Woolworths Strathfieldsaye
17-23 Apsley Lane & 39 Blucher Street,
Strathfieldsaye, VIC, 3551

DRAWING
Landscape Plan-AREA B-
for Town Planning



SCALE	1:200 @A1
DATE	13/05/2026
DRAWN	BG
CHECKED	KD
JOB NO	25-360-TP01-REV/B
DWG NO	TP03
CAD FILE	25-360-TP01-Rev/B.dwg

TYPICAL PLANTING DETAILS

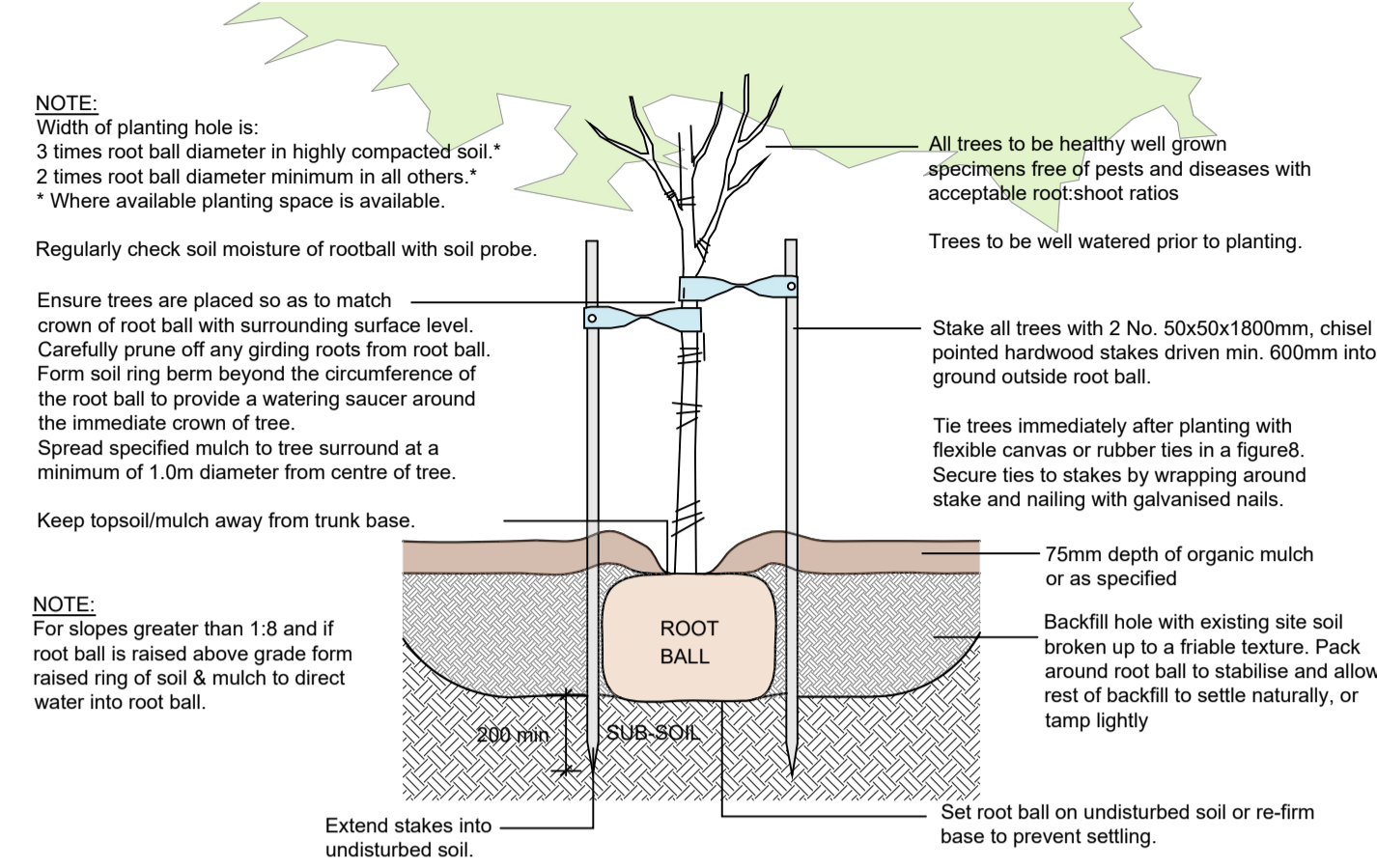

D1 TYPICAL TREE PLANTING DETAIL
Scale N.T.S.

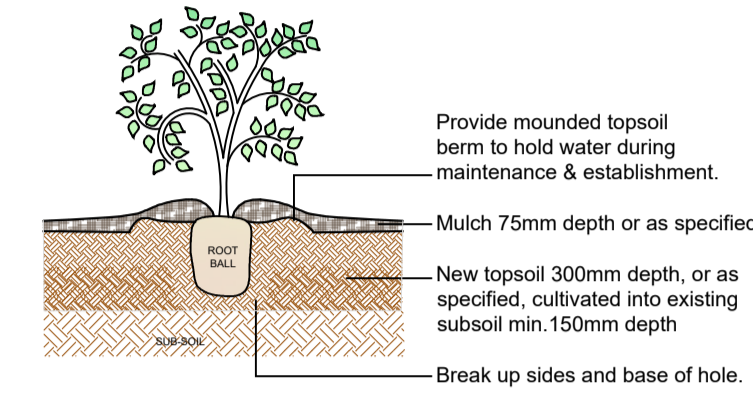

D2 TYPICAL SHRUB PLANTING DETAIL
Scale N.T.S.

- NOTE:
1. Dig hole twice as deep as root ball and allow at least 200mm around sides for backfilling with topsoil.
 2. Apply fertiliser in base of hole, cover with topsoil (type & rate as per spec.) Avoid root contact.
 3. Place plant in centre of hole, backfill with specified topsoil, firming progressively.
 4. Water well into saucer around crown of plant.
 5. Stake larger shrubs where necessary using 50x50x1200mm hardwood stakes.

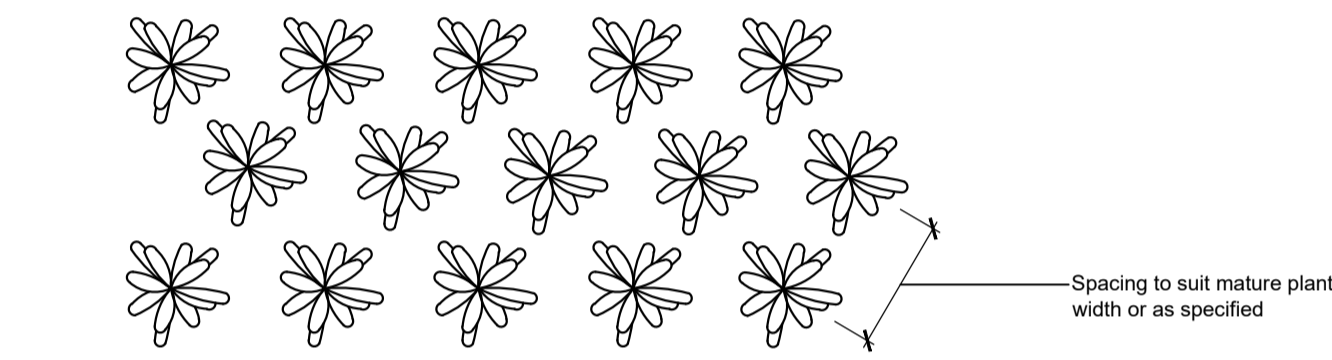

D3 TYPICAL PLANTING LAYOUT PLAN - Grasses & groundcovers
Scale 1:50

This copied document to be made available for the sole purpose of enabling its consideration and review as part of a planning process under the Planning and Environment Act 1987. The document must not be used for any purpose which may breach any copyright

Soil Preparation
Crushed rock, concrete spillage and any other material restrictive to plant growth (e.g. large rocks) shall be removed from the site of any planting beds and semi-advanced trees. All trees to be removed shall be stump ground and all rubbish/vegetative spoil is to be removed from site. Existing top soil in planting areas is to be preserved so that it does not receive additional compaction from site machinery and so that no rubble or building supplies are stored in these areas.

No imported top soil is to be used within the root zones of trees to be protected. Any preparation of existing soil for planting within these areas is to be done by hand only. Holes (e.g. as the result of plant removal) and uneven soil levels may be patched using topsoil as specified below.

Any imported topsoil is to be free of weeds, rubble and other materials damaging to plant growth and is to be of a medium texture (sandy loam) with a pH of 6.0-7.0. Top soil is to be laid over a prepared sub-base which has had any materials damaging to plant growth (e.g. rubble and large rocks) removed, spread to the appropriate depth and cultivated into the existing site soil to a minimum depth of 150mm.

Imported top soil is to be lightly and uniformly compacted in 150mm layers to a minimum depth of 100mm on lawn areas and 300mm on excavated planting beds.

Weed Removal
All weeds shall be thoroughly removed. All vegetative material, including roots and rhizomes of non-woody perennials and woody suckering weeds, is to be removed or appropriately controlled using chemical means. The stumps of non-suckering woody perennials are to be stump ground. All vegetative material shall be appropriately disposed of off site in a manner which will not allow their re-establishment elsewhere. Any chemical controls are to be used in accordance with manufacturer's instructions and standard occupational health and safety procedures.

Care must be taken to ensure that all trees to be retained are not damaged during weed removal. This also implies that any herbicides used are suitable for use around the vegetation to be retained.

Planting
Planting shall be carried out using accepted horticultural practices with all plants conforming to the species, size and quantities indicated on the Landscape Plan and Plant Schedule. Plants shall be thoroughly soaked through immersion in water prior to planting and if the planting soil is very dry then the planting hole is also to be filled with water and allowed to drain completely.

All plants shall be appropriately hardened off in the nursery. Use plants with the following characteristics: Large healthy root systems with no evidence of root curl or pot bound restriction or damage, vigorous, well established, free from disease and pests and of good form, consistent with the species or variety.

Planting holes for shrubs and groundcovers are to be of minimum size 75mm larger than the planting pot in all directions. Semi-advanced tree planting holes are to be the same depth as the rootball and 2-3 times its diameter, with the top of the rootball being at grade. A 75mm high berm is to be constructed at edge of rootball to hold water. All plants are to be thoroughly watered after planting and slow release fertiliser added at the quantities specified by the manufacturer.

Mulch
Mulch is to be supplied to all garden beds and is to be an organic type laid to a minimum depth of 75mm, consisting of fine dark coloured chipped or shredded pine bark or hardwood with not more than 5% fines content by volume (preferably zero fines). The average size of the woodchip must be approximately 10mm x 20mm x 5mm and the maximum length is not to exceed 30mm. Mulch shall be free of damaging matter such as soil, weeds and sticks and is to be stockpiled and thoroughly weathered prior to delivery. Mulch is to be kept back 100mm from the stems of all plants to prevent collar rot.

Aggregate Gravel Surface
Aggregate gravel is to be installed where shown comprising of a 50mm layer of gravel (7-14mm granite screenings or similar, no fines) over a base course of 75mm deep gently compacted Fine Crushed Rock. The subgrade is to be appropriately compacted.

Timber Edges
Provide 75 x 25mm treated pine edges to all borders between gravel mulch paths and garden beds using 75x25x300mm long treated pine stakes at 1200mm maximum centres. An additional stake is to be provided at joins in the plinth.

Raised Planter Boxes
Raised planter construction is to include, but not necessarily be limited to, the supply and installation of agricultural drains, drainage cells at base, filter fabric, planting medium, mulch and irrigation. Planter boxes must be effectively tanked and lined with corecrete to prevent leaking.

Drainage cells are to be provided at the base of the planter and are to be covered with a layer of filter fabric. A drainage outlet is to be installed in the base of the planter with the floor of the planter sloped towards it. Provide a root anchor if trees are to be planted in a windy location.

Supply and spread evenly a special lightweight planter mix. (to be advised) Compact evenly in 100mm layers. Avoid differential subsidence and excess compaction and produce a finished surface that is graded evenly and ready for planting. Allow for 50mm layer of specified mulch to top of beds and a finished level 25-50mm below the planter rim. Drip irrigation as specified is to be installed beneath the mulch layer.

Irrigation
An approved drip irrigation system is to be supplied to all landscape areas. An approved pop-up spray system is to be supplied to all lawn areas. It is the responsibility of the contractor to ensure that all irrigation meets manufacturers specifications. The system is to be connected to mains supply and include a rain-shut off device. All dripline is to be buried with approx. 50mm of topsoil cover and shall be anchored at regular intervals to ensure the tubing cannot be dislodged.

Repair/Restoration of damaged Nature-strips
Nature strips are to be restored to current grades with any depressions filled with topsoil to specifications above and lightly compacted in 150mm layers. Areas are then to be re-seeded using an appropriate and matching turf type and the area fenced off to allow the re-establishment of lawn. Re-seeded areas are to be well irrigated and the area supplied with a slow release fertiliser at the quantities recommended by the manufacturer.

Any areas of lawn which have failed to germinate (achieve an evenly green 95% covering of a consistent height) are to be re-seeded within one month of original sowing date.

Plant Establishment Period
There shall be a 13 weeks Plant Establishment Period following the approval of Practical Completion by the responsible authority. During this period the landscape contractor shall make good all defects in his/her scope of works. Maintenance and Establishment means the care and maintenance of the contract area by accepted horticultural practices, as well as rectifying any defects that become apparent in the work under normal use. This shall include, but shall not be limited to watering, fertilising, weeding, pruning, pest and disease control, cultivation, re-staking and replacement of any plants that fail with plants of the same species and size.

ADVERTISED PLAN

