

CIVIL DRAWINGS

TARIS, FALLS CREEK 3699

1-SURVEY

SURVEY DATUM	THESE PLANS ARE BASED UPON THE EXISTING CONDITIONS SURVEY PREPARED BY FORESIGHT. LEVELS SHOWN ARE TO A.H.D.
SETOUT	THE CONTRACTOR SHALL SETOUT THE WORKS FROM THE NOMINATED DESIGN LINES. SURVEY BENCHMARKS AND CONTROL POINTS SHOWN ON THE PLANS AND TO THE SPECIFIED DETAILS.
DIMENSIONS	ALL DIMENSIONS ARE TO LIP OF KERB OR OUTER EDGE OF LINEMARKING WHERE APPLICABLE.
REFERENCES PROTECTION	THE CONTRACTOR SHALL MAINTAIN AND PROTECT THE PEGS AND SURVEY MARKS FOR THE DURATION OF THE WORKS.

2-EARTHWORKS

GENERAL	EARTHWORKS SHALL BE CARRIED OUT TO THE FINISHED SURFACE LEVELS SHOWN ON THE PLANS AND CROSS SECTIONS. CUT BATTERS SHALL NOT EXCEED 1 IN 6 AND FILL BATTERS SHALL NOT EXCEED 1 IN 6 SLOPE UNLESS INDICATED OTHERWISE.
SITE STRIP	THE CONTRACTOR SHALL STRIP ALL AREAS SUBJECT TO BULK EARTHWORKS. PAVEMENT CONSTRUCTION OR BUILDING WORKS OF ALL ASPHALT, TOPSOIL AND OTHER DELETERIOUS MATERIAL. THE SITE STRIP SHALL INCLUDE REMOVAL OF ALL DELETERIOUS MATERIAL (150mm DEPTH) TO EXPOSE THE SILTY CLAY SUBGRADE (CBR 2).
COMPACTION TO AS1289	THE CONTRACTOR SHALL OBTAIN 98% STANDARD MINIMUM DRY DENSITY COMPACTION ON ALL FINISHED SUBGRADES AND FORMATIONS WITHIN + 2% OF OPTIMUM MOISTURE CONTENT. ALL SERVICE TRENCH BACKFILL COMPACTION TO BE DONE USING LIGHTWEIGHT EQUIPMENT TO ENSURE NO DAMAGE IS DONE TO INSTALLED SERVICES.
FILLING	PRIOR TO THE COMMENCEMENT OF FILLING THE SITE SHALL BE STRIPPED AS NOTED. FILLING IS TO BE CARRIED OUT IN STRICT ACCORDANCE WITH THE SPECIFICATIONS AND AS3798. APPROVED MATERIAL WON FROM SITE OR APPROVED COMPACTED FILL SHALL BE MOISTURE CONDITIONED IN ACCORDANCE WITH THE RECOMMENDATIONS OF THE GEOTECHNICAL REPORT PRIOR TO BEING PLACED IN UNIFORM HORIZONTAL LAYERS OF 200mm MAXIMUM DEPTH AND COMPACTED AS SPECIFIED. ALL FINISHED SURFACES SHALL ACHIEVE A MINIMUM COMPACTION OF 98% STANDARD DRY DENSITY WITHIN + 2% OF OPTIMUM MOISTURE CONTENT. COMPACTION TESTING OF ALL FILL SHALL BE CARRIED OUT IN ACCORDANCE WITH THE REQUIREMENTS OF AS 3798.
REINSTATEMENT	THE CONTRACTOR SHALL REGRADE, SHAPE, TOPSOIL AND GRASS ALL ADJACENT EXISTING GRASSED AREAS THAT ARE DISTURBED OR ALTERED AS A CONSEQUENCE OF THE PROPOSED WORKS.

5-DRAINAGE

PIPES	DRAINAGE PIPES ABOVE 225mmØ TO BE MINIMUM OF CLASS 2 REINFORCED CONCRETE. FRCP OR SRCP (RUBBER RING JOINTED) UNLESS OTHERWISE SPECIFIED. DRAINAGE PIPES UP TO 2000 TO BE SEWER QUALITY UPVC (RUBBER RING JOINTED). COMPACTED CLASS 2 FOR BACKFILL SHALL BE INSTALLED TO PIPES UNDER ROAD PAVEMENTS AND BUILDING SLABS. TRENCHES IN LANDSCAPE AREAS CAN BE BACKFILLED WITH SELECTED CLAY FILL. ALL STORM WATER PIPES ARE TO BE TESTED IN ACCORDANCE WITH AS3500.3 SECTION 10.
EXISTING PIPES	ALL EXISTING PIPES THAT WILL NOW BE BENEATH NEW ROAD PAVEMENT SHALL HAVE THE EXISTING BACKFILL REMOVED AND REPLACED WITH A CRUSHED ROCK BACKFILL COMPACTED TO 98% STANDARD.
PITS	DRAINAGE PITS TO BE CAST IN-SITU CONCRETE PITS AS DETAILED OR APPROVED PRECAST CONCRETE COMPLYING WITH THE RELEVANT AUSTRALIAN STANDARDS. ALL PITS DEEPER THAN 1.0m ARE TO BE PROVIDED WITH APPROVED STEP IRONS AT 300 MAX. CENTERS. PROVIDE CLASS D PIT COVER TO ALL PITS THAT ARE SITUATED ON A ROAD AND CLASS B PIT COVERS TO ALL OTHER AREAS UNLESS NOTES OTHERWISE.
DOWNPIPES	REFER TO ARCHITECTURAL DRAWINGS FOR DOWNPIPE DETAILS. ALL IN GROUND DOWNPIPE CONNECTIONS ARE TO BE 100Ø UPVC OR EQUAL TO THE DOWNPIPE SIZE. WHICHEVER IS GREATER, UNLESS SHOWN OTHERWISE. DOWNPIPE CONNECTIONS TO THE MAIN STORMWATER DRAINAGE SHALL BE VIA A 45° OBLIQUE JUNCTION OR BANDAGE JOINT AS DETAILED OR DIRECT TO A STORMWATER PIT. SUSPENDED DOWNPIPE CONNECTIONS WITHIN THE BUILDING ARE TO BE SUPPORTED WITH APPROVED HANGERS AT 1.2m CENTRES. THE ALIGNMENT OF SUSPENDED DRAINS IS SCHEMATIC ONLY. THE FINAL ALIGNMENT IS TO COMPLY WITH THE ARCHITECTURAL PLANS.
SUB-SOIL	100mm DIA. UPVC AG DRAINS WITH 20mm N.S SCREENINGS BACKFILL SHALL BE INSTALLED BEHIND ALL KERBING UNLESS OTHERWISE NOTED AT MIN. GRADE OF 1:250 UNLESS OTHERWISE NOTED.

SETOUT

STORAGE AND DETENTION

12-PAVEMENTS

SAWCUTTING	ALL EXISTING PAVEMENT ADJACENT TO PROPOSED KERB OR PROPOSED JOINTS SHALL BE SAWCUT IN A NEAT LINE AND TO HAVE 300mm OVERLAP. REFER TO STANDARD DETAILS.
TRENCHING	ALL TRENCHING WORKS IN EXISTING PAVEMENTS SHALL HAVE SAWCUT EDGES AND NEW PAVEMENT REINSTATED TO NEATLY MATCH EXISTING LEVELS.
REMAINING	EXISTING PAVEMENT AREAS THAT REMAIN, WHERE CRACKING IS EVIDENT SHALL BE SEALED WITH A PROPRIETARY BITUMINOUS PRODUCT TO THE MANUFACTURERS' SPECIFICATIONS.
CONCRETE JOINTING	SAWCUT OR TOOLED CONSTRUCTION JOINTS SHALL BE PROVIDED AT MAX. 2.0m CENTRES TO ALL FOOTPATHS OR PEDESTRIAN PAVING UNLESS NOTED OTHERWISE. A 19mm EXPANSION JOINT SHALL BE PROVIDED WHENEVER RIGID PAVEMENTS ABUT FIXED STRUCTURES OR AT MAX. 15m CENTRES TO FOOTPATHS. DOWELLED SAWCUT AND CONSTRUCTION JOINTS SHALL BE PROVIDED TO ALL VEHICULAR PAVEMENTS AS DETAILED ON THE DRAWINGS, TYPICALLY NOT GREATER THAN 6.0m CENTRES AND JOINT SPACING SHALL ENSURE SLAB LENGTH (L) ≤1.5 SLAB WIDTH.

10-SERVICES

EXISTING	ALL STATUTORY AUTHORITY SERVICES MUST BE MAINTAINED AND PROTECTED BY THE CONTRACTOR AT ALL TIMES UNLESS OTHERWISE SHOWN. EXISTING SERVICE LOCATIONS SHOWN HAVE BEEN OBTAINED FROM STATUTORY AUTHORITY RECORDS AND/OR EXISTING CONDITIONS PLANS. WHERE AVAILABLE, NO GUARANTEE IS GIVEN THAT ALL EXISTING SERVICES ARE SHOWN AND ALL SERVICES SHOULD BE PROVEN ON SITE PRIOR TO THE COMMENCEMENT OF WORKS IN THEIR VICINITY.
CONTACTS	CIVIL CONTRACTOR TO CONTACT AUTHORITY FOR RELOCATION OF CABLES, U/G MAINS OR POLES WHERE REQUIRED.
ADJUSTMENTS	ALL EXISTING PITS AND SERVICE FITTINGS THAT ARE TO REMAIN WITHIN THE PAVEMENT AREA SHALL BE REBUILT TO MATCH PROPOSED LEVELS AND WHERE APPLICABLE FITTED WITH AN APPROPRIATE HEAVY DUTY, AUTHORITY APPROVED, COVER. ELSEWHERE EXISTING SERVICES SHALL BE ADJUSTED TO SUIT NEW ADJACENT LEVELS.
PROPOSED SERVICES	REFER TO SEPARATE SERVICE DRAWINGS FOR PROPOSED LOCATION OF ELECTRICAL, SEWER, WATER, GAS & TELECOMMUNICATIONS SERVICES. SERVICE TRENCHES LOCATED UNDER PROPOSED PAVEMENTS INCLUDING VEHICLE CROSSINGS AND FOOTPATHS SHALL BE BACKFILLED WITH COMPACTED CLASS 2 FCR. (TRENCHES WHICH ENCRUACH WITHIN 150mm OF THE EDGE OF PAVEMENT SHALL ALSO BE BACKFILLED WITH APPROVED FCR MATERIAL). THE BASE OF ALL SERVICE TRENCHES SHALL BE SLOPED AWAY FROM THE BUILDING. TRENCHES SHALL BE BACKFILLED WITH CLAY IN THE TOP 300mm WITHIN 1.5m OF THE BUILDING. THE CLAY USED FOR BACKFILLING SHALL BE COMPACTED. WHERE PIPES PASS UNDER THE FOOTING SYSTEM, THE TRENCH SHALL BE BACKFILLED FULL DEPTH WITH CLAY OR CONCRETE TO RESTRICT THE INGRESS OF WATER BENEATH THE FOOTING SYSTEM.

11-INSPECTIONS

GENERAL	ALL WORKS SHALL BE CARRIED OUT IN ACCORDANCE WITH THE APPROVED CONSTRUCTION PROGRAMME TO THE SATISFACTION OF THE SUPERINTENDENT. AND SUBJECT TO PERIODICAL INSPECTION AND WRITTEN STAGED APPROVAL. ADDITIONAL INSPECTIONS CAN BE REQUESTED AT 24 HOURS NOTICE.
EXTERNAL	ALL WORKS IN ROAD RESERVATIONS SHALL REQUIRE WRITTEN APPROVAL OF RELEVANT CITY COUNCIL AND ARE SUBJECT TO SEPARATE INSPECTIONS. SEVEN DAYS NOTICE TO BE GIVEN OF WORK COMMENCING. THE CONTRACTOR SHALL OBTAIN ALL NECESSARY ROAD OPENING PERMITS AND AUTHORITY APPROVALS PRIOR TO COMMENCING WORKS.

ADVERTISED
PLAN

This copied document to be made available for the sole purpose of enabling its consideration and review as part of a planning process under the Planning and Environment Act 1987. The document must not be used for any purpose which may breach any copyright

RECEIVED
Department of Environment, Land, Water
and Planning
18 November 2024







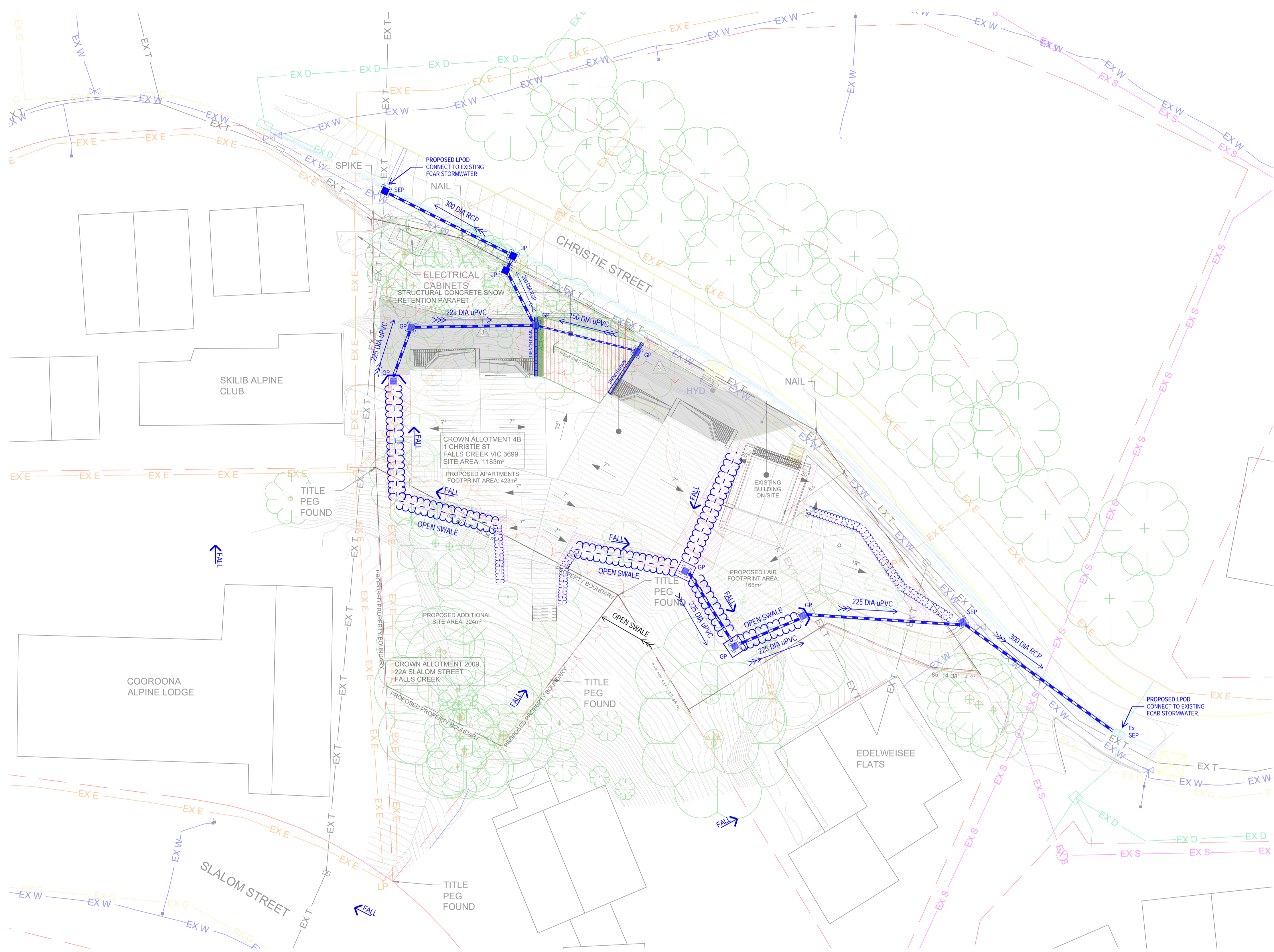

DRAWING TO BE PRINTED IN COLOUR

<p>DISCLAIMER THIS DRAWING IS NOT TO BE REPRODUCED OR COPIED AND REMAINS THE PROPERTY OF © KUSCH GROUP. THE RECIPIENT IS RESPONSIBLE FOR ENSURING THAT THEY REVIEW THE STATUS AND HAVE RECEIVED THE CURRENT REVISION PRIOR TO USE. THIS DRAWING HAS NOT BEEN PRODUCED TO A LEVEL OF DIMENSIONAL ACCURACY SUITABLE FOR FABRICATION. THE CONTRACTOR IS RESPONSIBLE FOR THE PRODUCTION OF FABRICATIONSHIP DRAWINGS WHERE THEY ARE REQUIRED. THIS DRAWING HAS BEEN PRODUCED FOR THE NAMED CLIENT FOR USE ON THIS PROJECT ONLY AND NOT TO BE USED FOR ANY OTHER PURPOSE. IT SHALL NOT BE DISTRIBUTED TO ANY OTHER PARTY WITHOUT THE APPROVAL OF KUSCH GROUP. FAILURE TO COMPLY WILL RESULT IN LEGAL ACTION.</p>				<p>PROJECT TARIS CHRISTIE STREET, FALLS CREEK</p>		<p>CLIENT SENDIT.ARCH</p> <p>DP AD 47626 PO Box 202 Pimpriwah Victoria Australia 3740 andy@sendit.arch</p>		<p>DESIGNED BY KUSCH Engineered.</p> <p>P: 1300 10 22 30 E: design@kusch.com.au</p>		<p>DRAWING TITLE CIVIL SPECIFICATION NOTES</p> <p>DRAWN: MD REVIEWED: MD DESIGNED: MD APPROVED: MD</p>		<p>PLANNING APPROVAL</p> <p>DATE: 30.10.24 SCALE: DRG No. C001 REV No. 1 PROJECT No. 24-1608 SHEET SIZE: A1</p>	
1	PLANNING APPROVAL	MD	MD	02.11.2024									
REV	DESCRIPTION	BY	APP	DATE									



LEGEND

-  SIDE ENTRY PIT - NOMINALLY 600x900
-  GRATED PIT - NOMINALLY 600x600
-  JUNCTION PIT - NOMINALLY 600x600
-  ROCK LINED V-SWALE TO CAPTURE ROOF RUNOFF. SWALES WITH SHALLOW FALL TO INCLUDE SUBSURFACE DRAINAGE (SLOTTED PIPE)
-  225 DIA RCP
STORMWATER PIPE. SIZE AND TYPE AS NOTED. PIPE SIZE CALCULATED ON A MINIMUM 1:150 FALL
-  DRIVEWAY TRENCH GRATE/DRAIN GALVANISED FINISH - CAST INTO SLAB

NOTES

- PIPES DESIGNED FOR A 1% AEP RECCURANCE INTERVAL. ASSUMING ALL OVERLAND FLOW IS CAPABLE OF BEING TRANSPORTED VIA PIPE TO APPROVED LPOD. OVERLAND FLOW INCLUDES THE LAND ABOVE THE SUBJECT SITE WHERE THE DIRECTION OF FALL IS TOWARDS THE SUBJECT SITE. IT IS ASSUMED THAT OVERLAND FLOW ABOVE AND INCLUDING SLALOM STREET IS DIRECTED DOWN SLALOM STREET.
- ALL PIPES DESIGNED FOR A MINIMUM FALL OF 1:150. TO BE CONFIRMED DURING DETAILED DESIGN
- ALL PITS TO BE REINFORCED CONCRETE, SIZED IN ACCORDANCE WITH AS3500
- PITS GREATER THAN 900 DEEP ARE TO BE MIN. 600x900 IN ACCORDANCE WITH AS3500.3
- PITS GREATER THAN 1200 DEEP ARE TO BE MIN. 900x900 IN ACCORDANCE WITH AS3500.3

This copied document to be made available for the sole purpose of enabling its consideration and review as part of a planning process under the Planning and Environment Act 1987. The document must not be used for any purpose which may breach any copyright

RECEIVED
Department of Environment, Land, Water and Planning
18 November 2024

ADVERTISED PLAN

REV	DESCRIPTION	BY	APP	DATE
1	PLANNING APPROVAL	MD	MD	02.11.2024

DISCLAIMER
THIS DRAWING IS NOT TO BE REPRODUCED OR COPIED AND REMAINS THE PROPERTY OF KUSCH GROUP. THE RECIPIENT IS RESPONSIBLE FOR ENSURING THAT THEY REVIEW THE STATUS AND HAVE RECEIVED THE CURRENT REVISION PRIOR TO USE. THIS DRAWING HAS NOT BEEN PRODUCED TO A LEVEL OF DIMENSIONAL ACCURACY SUITABLE FOR FABRICATION. THE CONTRACTOR IS RESPONSIBLE FOR THE PRODUCTION OF FABRICATION DRAWINGS WHERE THEY ARE REQUIRED. THIS DRAWING HAS BEEN PRODUCED FOR THE NAMED CLIENT FOR USE ON THIS PROJECT ONLY AND NOT TO BE USED FOR ANY OTHER PURPOSE. IT SHALL NOT BE DISTRIBUTED TO ANY OTHER PARTY WITHOUT THE APPROVAL OF KUSCH GROUP. FAILURE TO COMPLY WILL RESULT IN LEGAL ACTION.

PROJECT
TARIS
CHRISTIE STREET, FALLS CREEK

CLIENT
SENDIT.ARCHI

SP-AD-47926
PO Box 255 Peninsula
Victoria Australia 3740
and@sendit.archi

DESIGNED BY
KUSCH
Engineered.

P: 1300 10 22 30 E: design@kusch.com.au

DRAWING TITLE
CIVIL DRAINAGE PLAN

DRAWN: MD REVIEWED: MD
DESIGNED: MD APPROVED: MD

PLANNING APPROVAL

DATE: 30.10.24 SCALE: 1:200
DRG No. C002 REV No. 1
PROJECT No. 24-1608 SHEET SIZE: A1

DRAWING TO BE PRINTED IN COLOUR

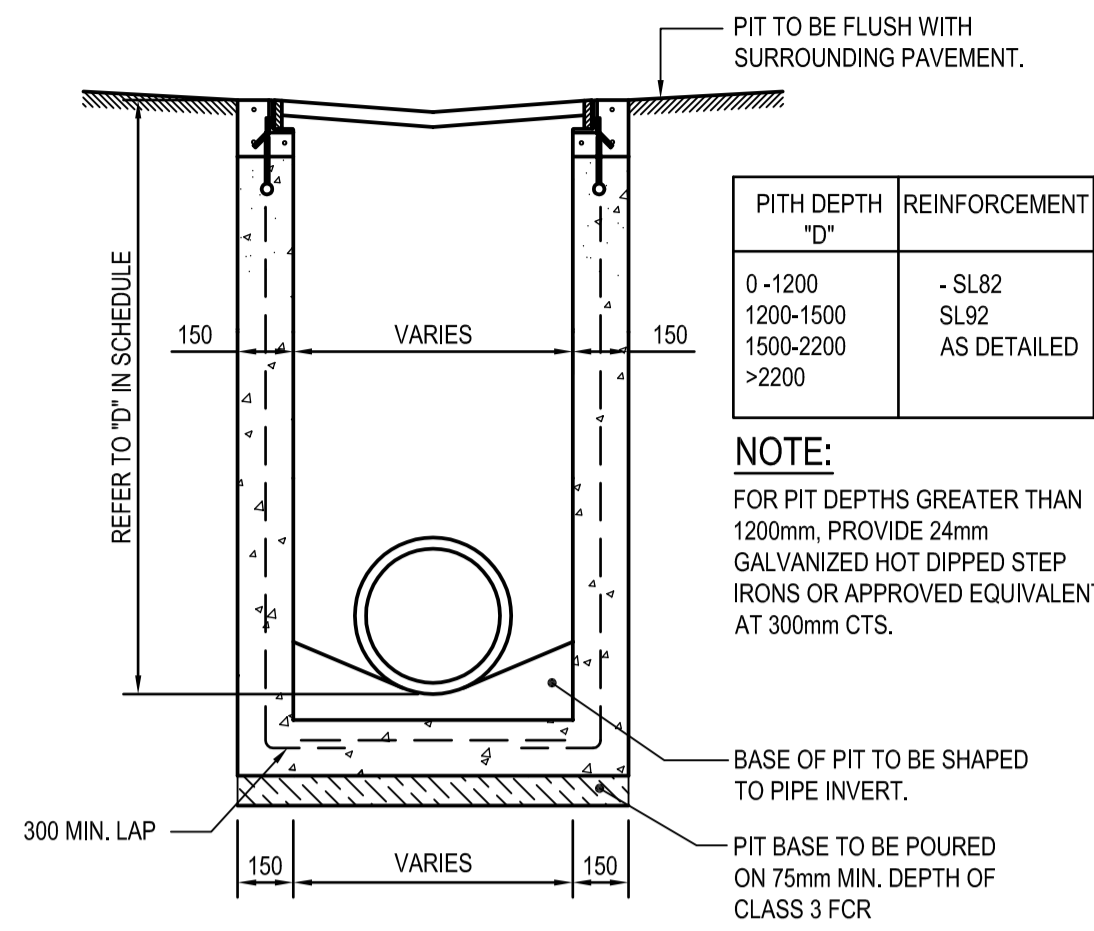

**SECTION X-X
GRATED PIT DETAIL**
SCALE 1:20

PITH DEPTH "D"	REINFORCEMENT
0-1200	-
1200-1500	- SL82
1500-2200	SL92
>2200	AS DETAILED

NOTE:
FOR PIT DEPTHS GREATER THAN 1200mm, PROVIDE 24mm GALVANIZED HOT DIPPED STEP IRONS OR APPROVED EQUIVALENT AT 300mm CTS.

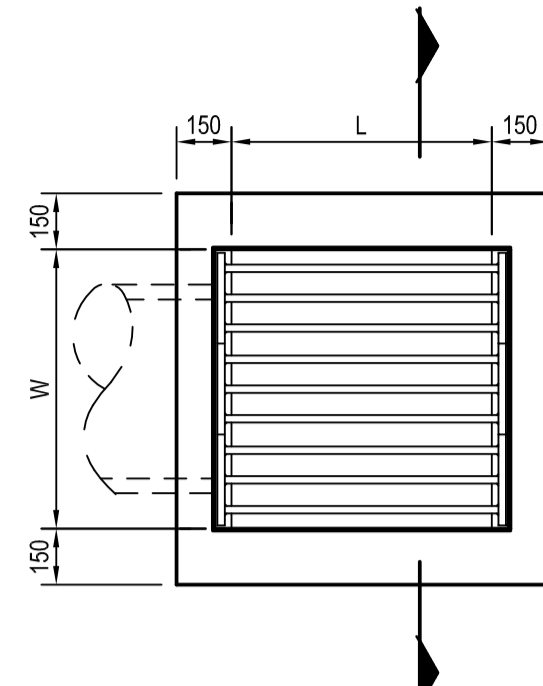

GRATED PIT PLAN VIEW
SCALE 1:20

- GRATES ARE TO COMPLY WITH AS3996.
- MANUFACTURER'S EQUIVALENT MAY BE USED IF APPROVED BY THE ENGINEER.
- ALL GRATES TO BE FABRICATED TO SUIT INVERT PROFILE OF ROADWAY.
- GRATES AND FRAMES TO BE HOT DIP GALVANISED AND SEATED WITH CORRECT ORIENTATION TO PAVEMENT GEOMETRY.
- REFER TO SCHEDULE & OR PLAN FOR PIT DIMENSIONS

FOR LENGTH AND WIDTH REFER TO PIT SCHEDULE

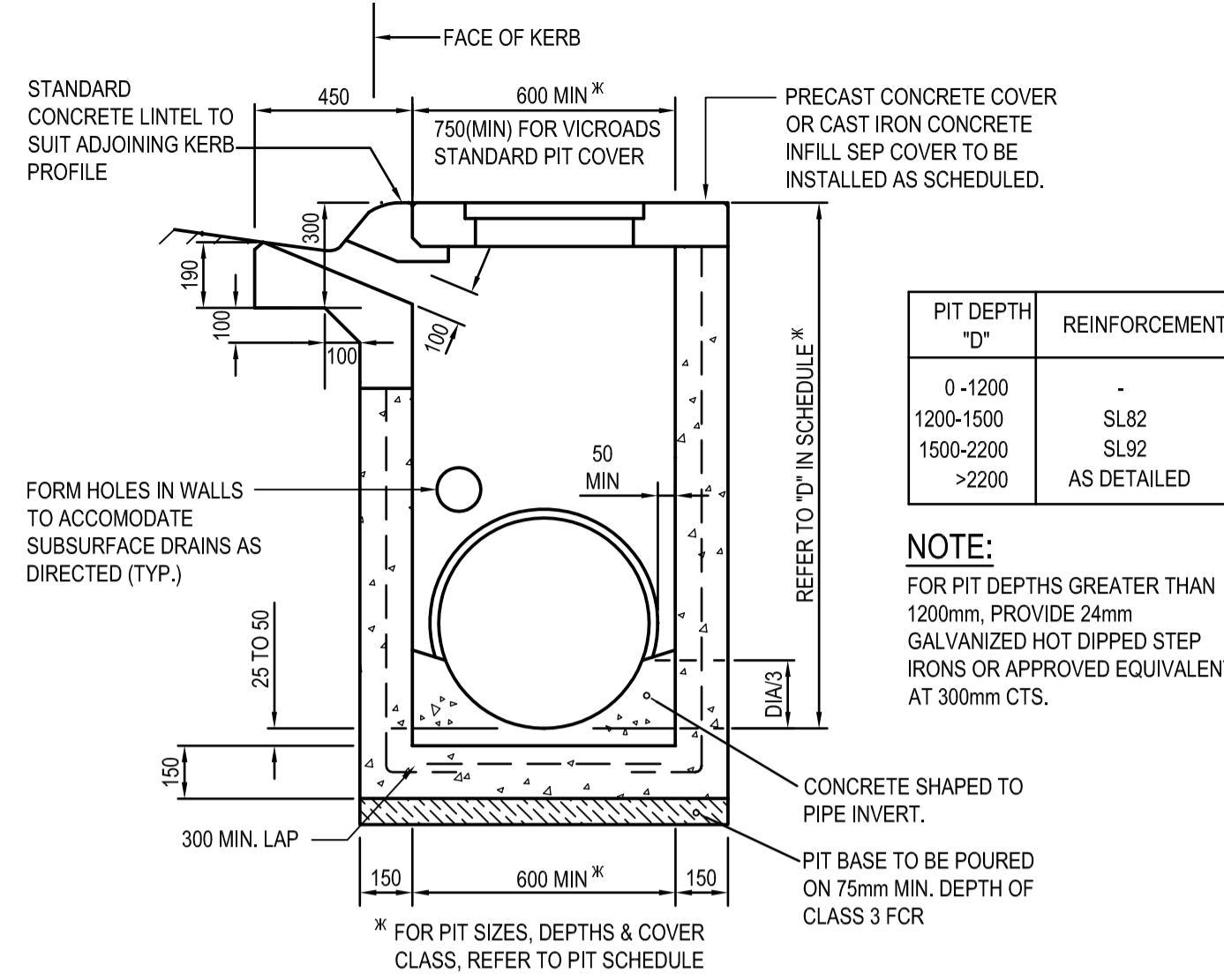

SIDE ENTRY PIT DETAIL (SM2 KERB)
SCALE 1:20

PIT DEPTH "D"	REINFORCEMENT
0-1200	-
1200-1500	SL82
1500-2200	SL92
>2200	AS DETAILED

NOTE:
FOR PIT DEPTHS GREATER THAN 1200mm, PROVIDE 24mm GALVANIZED HOT DIPPED STEP IRONS OR APPROVED EQUIVALENT AT 300mm CTS.

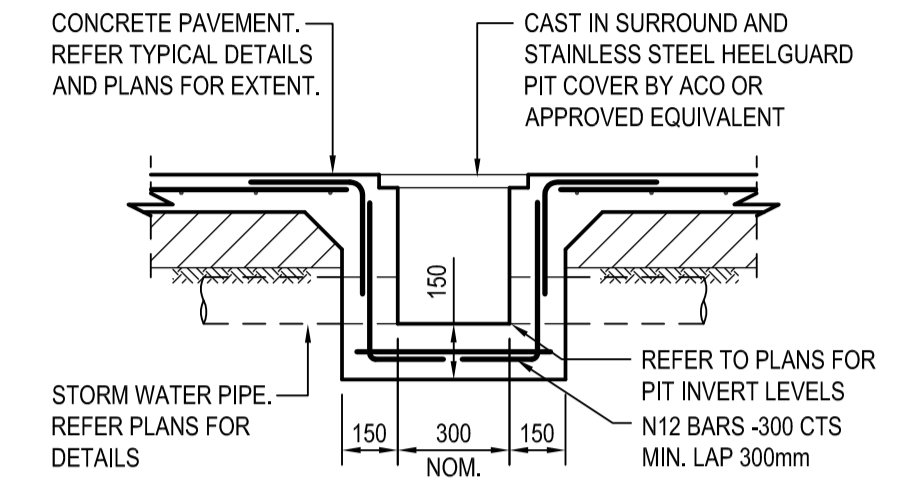

TYPICAL TRENCH GRATE DETAIL
SCALE 1:20

RECEIVED
Department of Environment, Land, Water
and Planning
18 November 2024

This copied document to be made available for the sole purpose of enabling its consideration and review as part of a planning process under the Planning and Environment Act 1987. The document must not be used for any purpose which may breach any copyright

ADVERTISED
PLAN

DRAWING TO BE PRINTED IN COLOUR

<p>DISCLAIMER THIS DRAWING IS NOT TO BE REPRODUCED OR COPIED AND REMAINS THE PROPERTY OF © KUSCH GROUP. THE RECIPIENT IS RESPONSIBLE FOR ENSURING THAT THEY REVIEW THE STATUS AND HAVE RECEIVED THE CURRENT REVISION PRIOR TO USE. THIS DRAWING HAS NOT BEEN PRODUCED TO A LEVEL OF DIMENSIONAL ACCURACY SUITABLE FOR FABRICATION. THE CONTRACTOR IS RESPONSIBLE FOR THE PRODUCTION OF FABRICATIONSHIP DRAWINGS WHERE THEY ARE REQUIRED. THIS DRAWING HAS BEEN PRODUCED FOR THE NAMED CLIENT FOR USE ON THIS PROJECT ONLY AND NOT TO BE USED FOR ANY OTHER PURPOSE. IT SHALL NOT BE DISTRIBUTED TO ANY OTHER PARTY WITHOUT THE APPROVAL OF KUSCH GROUP. FAILURE TO COMPLY WILL RESULT IN LEGAL ACTION.</p>				<p>PROJECT TARIS CHRISTIE STREET, FALLS CREEK</p>		<p>CLIENT SENDIT.ARCH</p>		<p>DESIGNED BY KUSCH Engineered.</p>		<p>DRAWING TITLE CIVIL DETAILS</p>		<p>PLANNING APPROVAL</p>	
<p>1 PLANNING APPROVAL MD MD 02.11.2024</p>				<p>DATE: 30.10.24</p>		<p>SCALE: 1</p>		<p>DRG No. C003</p>		<p>REV No. 1</p>			
<p>REV DESCRIPTION BY APP DATE</p>				<p>PROJECT No. 24-1608</p>		<p>APPROVED: MD</p>		<p>PROJECT No. 24-1608</p>		<p>SHEET SIZE: A1</p>			