



Copyright State of Victoria. No part of this publication may be reproduced except as permitted by the Copyright Act 1968 (Cth), to comply with a statutory requirement or pursuant to a written agreement. The information is only valid at the time and in the form obtained from the LANDATA REGD TM System. None of the State of Victoria, its agents or contractors, accepts responsibility for any subsequent publication or reproduction of the information.

The Victorian Government acknowledges the Traditional Owners of Victoria and pays respects to their ongoing connection to their Country, History and Culture. The Victorian Government extends this respect to their Elders, past, present and emerging.

REGISTER SEARCH STATEMENT (Title Search) Transfer of Land Act 1958
 VOLUME 08509 FOLIO 499 Security no : 124134365997G
 Produced 05/05/2026 01:40 PM

LAND DESCRIPTION
 Lot 1 on Title Plan 512876N.
 PARENT TITLE Volume 05914 Folio 782
 Created by instrument B785133 30/10/1963

REGISTERED PROPRIETOR
 Estate Fee Simple
 Sole Proprietor
 BARWON REGION WATER CORPORATION of 55-67 RYRIE STREET GEELONG VIC 3220
[AM559834D](#) 15/02/2016

ENCUMBRANCES, CAVEATS AND NOTICES

Any encumbrances created by Section 98 Transfer of Land Act 1958 or Section 24 Subdivision Act 1988 and any other encumbrances shown or entered on the plan set out under DIAGRAM LOCATION below.

DIAGRAM LOCATION
 SEE [TP512876N](#) FOR FURTHER DETAILS AND BOUNDARIES

ACTIVITY IN THE LAST 125 DAYS

NIL

-----END OF REGISTER SEARCH STATEMENT-----

Additional information: (not part of the Register Search Statement)

Street Address: 120 SCENIC ROAD HIGHTON VIC 3216

ADMINISTRATIVE NOTICES
 NIL

eCT Control 03532W BARWON REGION WATER CORPORATION
 Effective from 15/02/2016

DOCUMENT END

Home	Account: 324611		Authority Fee(GST exclusive): \$0.00 Service Fee(GST exclusive): \$0.00 GST Payable: \$0.00 Total: \$0.00	05/05/2026 01:40PM
----------------------	---------------------------	---	--	-----------------------



Imaged Document Cover Sheet

The document following this cover sheet is an imaged document supplied by LANDATA®, Secure Electronic Registries Victoria.

Document Type	plan
Document Identification	TP512876N
Number of Pages (excluding this cover sheet)	1
Document Assembled	05/05/2026 14:08

Copyright and disclaimer notice:

© State of Victoria. This publication is copyright. No part may be reproduced by any process except in accordance with the provisions of the Copyright Act 1968 (Cth) and for the purposes of Section 32 of the Sale of Land Act 1962 or pursuant to a written agreement. The information is only valid at the time and in the form obtained from the LANDATA® System. None of the State of Victoria, LANDATA®, Secure Electronic Registries Victoria Pty Ltd (ABN 86 627 986 396) as trustee for the Secure Electronic Registries Victoria Trust (ABN 83 206 746 897) accept responsibility for any subsequent release, publication or reproduction of the information.

The document is invalid if this cover sheet is removed or altered.

TITLE PLAN	EDITION 1	TP 512876N
------------	-----------	------------

<p>Location of Land</p> <p>Parish: BARRARBOOL Township: Section: 16 Crown Allotment: 6 (PT) Crown Portion:</p> <p>Last Plan Reference: Derived From: VOL 8509 FOL 499 Depth Limitation: 50 FEET</p>	<p>Notations</p> <p>ANY REFERENCE TO MAP IN THE TEXT MEANS THE DIAGRAM SHOWN ON THIS TITLE PLAN</p>
--	--

<p>Description of Land / Easement Information</p>	<p>THIS PLAN HAS BEEN PREPARED FOR THE LAND REGISTRY, LAND VICTORIA, FOR TITLE DIAGRAM PURPOSES AS PART OF THE LAND TITLES AUTOMATION PROJECT</p> <p>COMPILED: 01/06/2000 VERIFIED: CL</p>
--	---

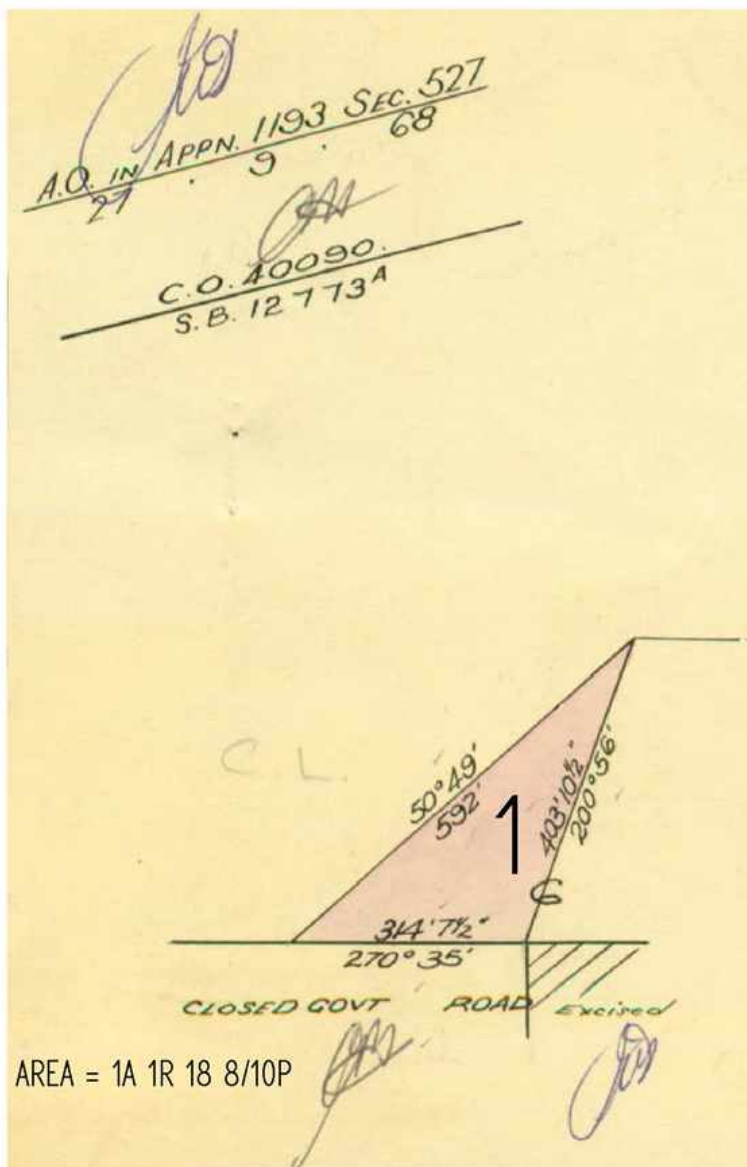

TABLE OF PARCEL IDENTIFIERS
WARNING: Where multiple parcels are referred to or shown on this Title Plan this does not imply separately disposable parcels under Section 8A of the Sale of Land Act 1962
PARCEL 1 = CA 6 (PT)

LENGTHS ARE IN FEET & INCHES	Metres = 0.3048 x Feet Metres = 0.201168 x Links	Sheet 1 of 1 sheets
------------------------------	---	---------------------