

CROWN FOLIO STATEMENT

VOLUME 11724 FOLIO 551
No Coft exists

Security no : 124104387560P
Produced 03/03/2023 12:07 PM

CROWN FOLIO

LAND DESCRIPTION

Crown Allotment 2008 Parish of Carruno.
PARENT TITLE Volume 11697 Folio 657
Created by instrument MI067084G 06/08/2016

CROWN LAND ADMINISTRATOR

ROADS CORPORATION of 60 DENMARK STREET KEW VIC 3101
MI080295S 06/08/2016

**ADVERTISED
PLAN**

STATUS, ENCUMBRANCES AND NOTICES

GOVERNMENT ROAD MI067086C 06/08/2016

DIAGRAM LOCATION

SEE CD028679K FOR FURTHER DETAILS AND BOUNDARIES

ACTIVITY IN THE LAST 125 DAYS

NIL

-----END OF CROWN FOLIO STATEMENT-----

Additional information: (not part of the Crown Folio Statement)

Street Address: "TICKET BOX - FALLS CREEK" 2597 BOGONG HIGH PLAINS ROAD FALLS
CREEK VIC 3699

DOCUMENT END

**This copied document to be made available
for the sole purpose of enabling
its consideration and review as
part of a planning process under the
Planning and Environment Act 1987.
The document must not be used for any
purpose which may breach any
copyright**



Imaged Document Cover Sheet

The document following this cover sheet is an imaged document supplied by LANDATA®, Secure Electronic Registries Victoria.

Document Type	Plan
Document Identification	CD028679K
Number of Pages (excluding this cover sheet)	1
Document Assembled	03/03/2023 12:09

Copyright and disclaimer notice:

© State of Victoria. This publication is copyright. No part may be reproduced by any process except in accordance with the provisions of the Copyright Act 1968 (Cth) and for the purposes of Section 32 of the Sale of Land Act 1962 or pursuant to a written agreement. The information is only valid at the time and in the form obtained from the LANDATA® System. None of the State of Victoria, LANDATA®, Secure Electronic Registries Victoria Pty Ltd (ABN 86 627 986 396) as trustee for the Secure Electronic Registries Victoria Trust (ABN 83 206 746 897) accept responsibility for any subsequent release, publication or reproduction of the information.

The document is invalid if this cover sheet is removed or altered.

This copied document to be made available for the sole purpose of enabling its consideration and review as part of a planning process under the Planning and Environment Act 1987. The document must not be used for any purpose which may breach any copyright

**ADVERTISED
PLAN**

CROWN DIAGRAM	CD028679K
Location of Land Parish : CARRUNO Allotment : 2008	This plan has been created to assist in locating a Crown Land parcel Warning - No warranty is given as to the accuracy or completeness of this plan Any derived dimensions are approximate
Standard Parcel Identifier (SPI) : 2008VPP2361 Vicmap Parcel PFI : 130258655	Coordinate Position MGA : 523420, 5921770 (55) Vicroads Directory Reference : 50 F7 (ed. 7)

Compiled from VICMAP cadastral mapping data
Date: 20/01/2010

This copied document to be made available for the sole purpose of enabling its consideration and review as part of a planning process under the Planning and Environment Act 1987. The document must not be used for any purpose which may breach any copyright

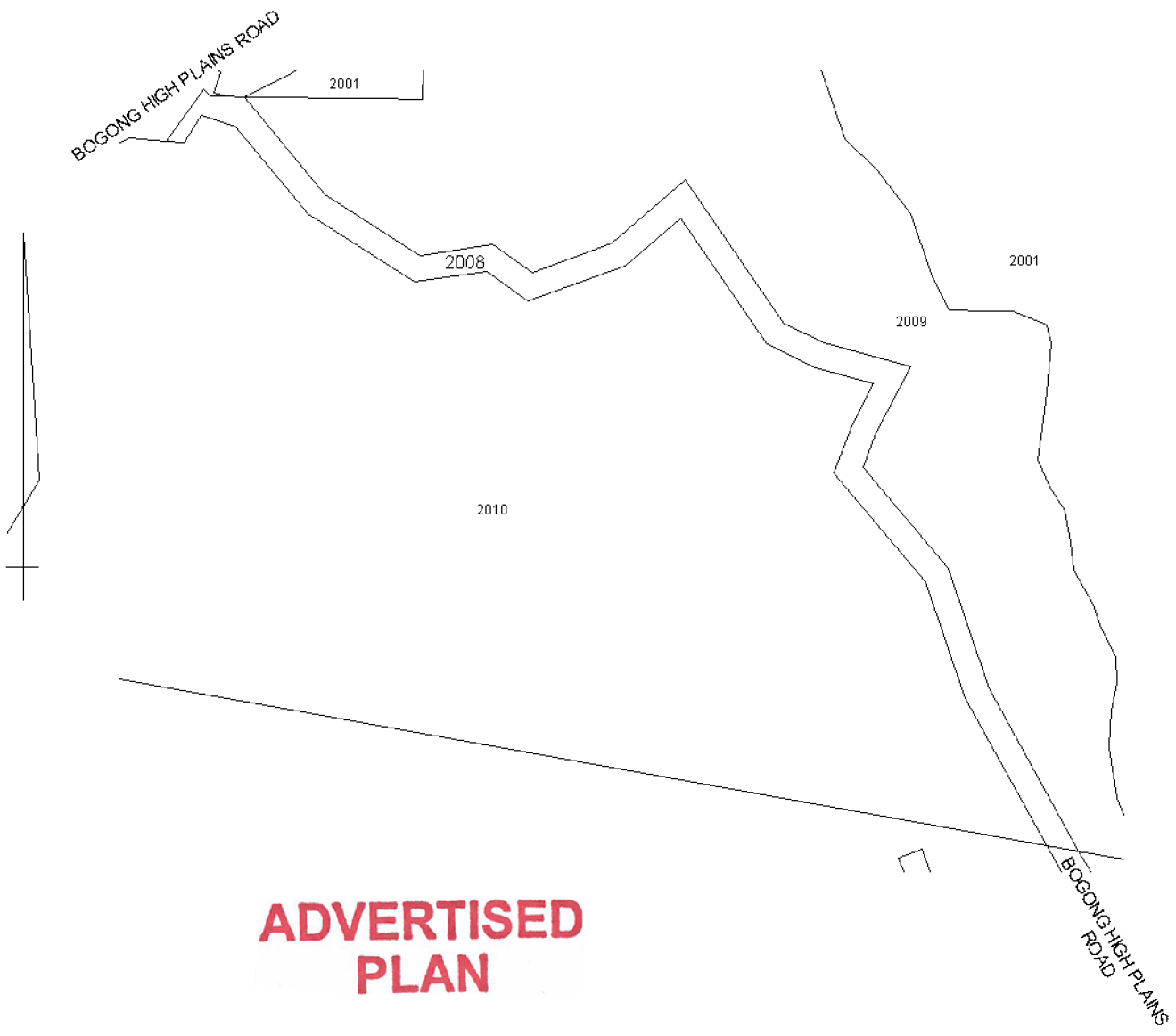

ADVERTISED PLAN

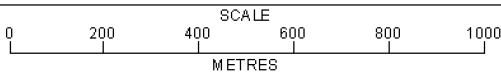

CROWN FOLIO STATEMENT

VOLUME 11724 FOLIO 556
No Coft exists

Security no : 124104387190R
Produced 03/03/2023 12:00 PM

CROWN FOLIO

LAND DESCRIPTION

Crown Allotment 2010 Parish of Carruno.
PARENT TITLE Volume 11697 Folio 657
Created by instrument MI067100M 06/08/2016

CROWN LAND ADMINISTRATOR

FALLS CREEK ALPINE RESORT MANAGEMENT BOARD of VIC
MI067100M 06/08/2016

STATUS, ENCUMBRANCES AND NOTICES

RESERVATION AQ505737V 01/12/2017
PERMANENT
FALLS CREEK ALPINE RESORT
ARA2/3

**ADVERTISED
PLAN**

DIAGRAM LOCATION

SEE CD028684S FOR FURTHER DETAILS AND BOUNDARIES

ACTIVITY IN THE LAST 125 DAYS

NIL

-----END OF CROWN FOLIO STATEMENT-----

Additional information: (not part of the Crown Folio Statement)

Street Address: BOGONG HIGH PLAINS ROAD FALLS CREEK VIC 3699

DOCUMENT END

**This copied document to be made available
for the sole purpose of enabling
its consideration and review as
part of a planning process under the
Planning and Environment Act 1987.
The document must not be used for any
purpose which may breach any
copyright**



Imaged Document Cover Sheet

The document following this cover sheet is an imaged document supplied by LANDATA®, Secure Electronic Registries Victoria.

Document Type	Plan
Document Identification	CD028684S
Number of Pages (excluding this cover sheet)	1
Document Assembled	03/03/2023 12:03

Copyright and disclaimer notice:

© State of Victoria. This publication is copyright. No part may be reproduced by any process except in accordance with the provisions of the Copyright Act 1968 (Cth) and for the purposes of Section 32 of the Sale of Land Act 1962 or pursuant to a written agreement. The information is only valid at the time and in the form obtained from the LANDATA® System. None of the State of Victoria, LANDATA®, Secure Electronic Registries Victoria Pty Ltd (ABN 86 627 986 396) as trustee for the Secure Electronic Registries Victoria Trust (ABN 83 206 746 897) accept responsibility for any subsequent release, publication or reproduction of the information.

The document is invalid if this cover sheet is removed or altered.

This copied document to be made available for the sole purpose of enabling its consideration and review as part of a planning process under the Planning and Environment Act 1987. The document must not be used for any purpose which may breach any copyright

**ADVERTISED
PLAN**

CROWN DIAGRAM	CD028684S
Location of Land Parish : CARRUNO Allotment : 2010	This plan has been created to assist in locating a Crown Land parcel Warning - No warranty is given as to the accuracy or completeness of this plan Any derived dimensions are approximate
Standard Parcel Identifier (SPI) : 2010\PP2361 Vicmap Parcel PFI : 130258652	Coordinate Position MGA : 523120, 5921740 (55) Vicroads Directory Reference : 50 F7 (ed. 7)

Compiled from VICMAP cadastral mapping data
Date: 20/01/2010

ADVERTISED PLAN

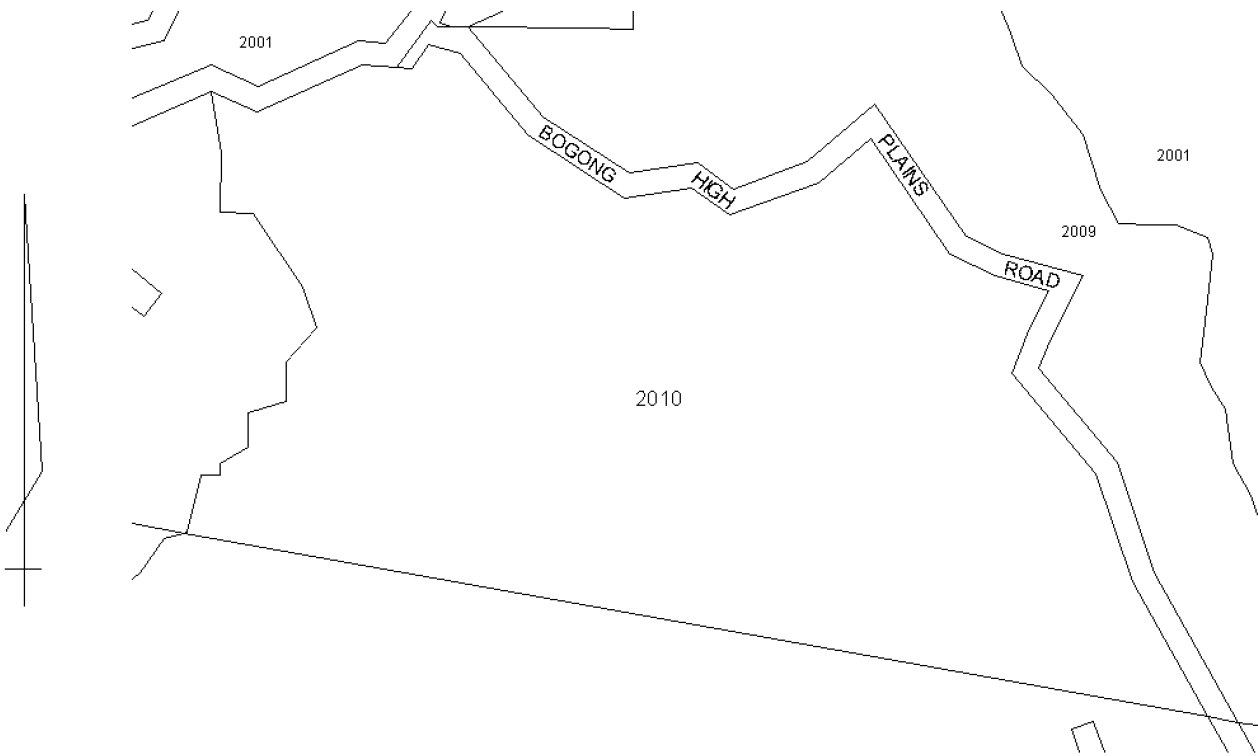

This copied document to be made available for the sole purpose of enabling its consideration and review as part of a planning process under the Planning and Environment Act 1987. The document must not be used for any purpose which may breach any copyright

