

Copyright State of Victoria. No part of this publication may be reproduced except as permitted by the Copyright Act 1968 (Cth), to comply with a statutory requirement or pursuant to a written agreement. The information is only valid at the time and in the form obtained from the LANDATA REGD TM System. None of the State of Victoria, its agents or contractors, accepts responsibility for any subsequent publication or reproduction of the information.

The Victorian Government acknowledges the Traditional Owners of Victoria and pays respects to their ongoing connection to their Country, History and Culture. The Victorian Government extends this respect to their Elders, past, present and emerging.

REGISTER SEARCH STATEMENT (Title Search) Transfer of Land Act 1958

VOLUME 10523 FOLIO 604

Security no : 124130880961P
Produced 18/12/2025 03:00 PM

LAND DESCRIPTION

Crown Allotment 2 Section 10 Parish of Darlington.
Created by Application No. 085829K 19/04/2000

REGISTERED PROPRIETOR

Estate Fee Simple
Sole Proprietor

EBARE PTY LTD of STONY POINT DARLINGTON
Application No. 085829K 19/04/2000

**ADVERTISED
PLAN**

ENCUMBRANCES, CAVEATS AND NOTICES

For details of any other encumbrances see the plan or imaged folio set out under DIAGRAM LOCATION below.

DIAGRAM LOCATION

SEE TP017513N FOR FURTHER DETAILS AND BOUNDARIES

ACTIVITY IN THE LAST 125 DAYS

NIL

-----END OF REGISTER SEARCH STATEMENT-----

Additional information: (not part of the Register Search Statement)

Street Address: "STONE POINT" 2977 HAMILTON HIGHWAY DARLINGTON VIC 3271

DOCUMENT END

Delivered from the LANDATA® System by InfoTrack Pty Ltd.

The information supplied by InfoTrack (Commercial) has been obtained from InfoTrack Pty Limited by agreement between them. The information supplied has been obtained by InfoTrack Pty Limited who is licensed by the State of Victoria to provide this information via LANDATA® System.

**This copied document to be made available
for the sole purpose of enabling
its consideration and review as
part of a planning process under the
Planning and Environment Act 1987.
The document must not be used for any
purpose which may breach any
copyright**

© State of Victoria. This publication is copyright. No part may be reproduced by any process except in accordance with the provisions of the Copyright Act 1968 (Cth) and for the purposes of Section 32 of the Sale of Land Act 1962 or pursuant to a written agreement. The information is only valid at the time and in the form obtained from the LANDATA® System. None of the State of Victoria, LANDATA®, Secure Electronic Registries Victoria Pty Ltd (ABN 86 627 986 396) as trustee for the Secure Electronic Registries Victoria Trust (ABN 83 206 746 897) accept responsibility for any subsequent release, publication or reproduction of the information.

| | | | | | |
|--|-------------------|---------------|---|-----------------------------|--|
| EDITION 1 | TITLE PLAN | | | | TP17513N |
| Location of Land Parish: DARLINGTON Township: Crown Allotment: 3 15 2 Section: 6 3 20 Crown Section: A LTO base record: SDMB-C (RURAL) Last plan Reference: Title Reference: VOL. 10518 FOL. 690 Depth Limitation: NIL | | | | | Notations |
| Easement Information E - Encumbering Easement R - Encumbering Easement (ROAD) A - Appurtenant Easement | | | | | THIS PLAN HAS BEEN PREPARED BY LAND REGISTRY, LAND VICTORIA FOR TITLE DIAGRAM PURPOSES Checked by  Date 22/5/2000 Assistant Registrar of Titles |
| Easement Reference | Purpose/Authority | Width | Origin | Land benefited/In favour of | |
| NIL | | | | | |
| <div style="border: 2px solid red; padding: 10px; margin: 0 auto; width: 80%;"> <p style="color: red; text-align: center; font-weight: bold;"> This copied document to be made available for the sole purpose of enabling its consideration and review as part of a planning process under the Planning and Environment Act 1987. The document must not be used for any purpose which may breach any copyright </p> </div> | | | | | |
| <h1 style="margin: 0;">FOR DIAGRAM SEE SHEET. 2.</h1> | | | | | |
| <h2 style="color: red; margin: 0;">ADVERTISED PLAN</h2> | | | | | |
| LENGTHS ARE IN METRES | NOT TO SCALE | SHEET SIZE A3 | DEALING No: AP85829K DEALING CODE: 14 | | |
| Sheet 1 of 2 Sheets | | | | | |

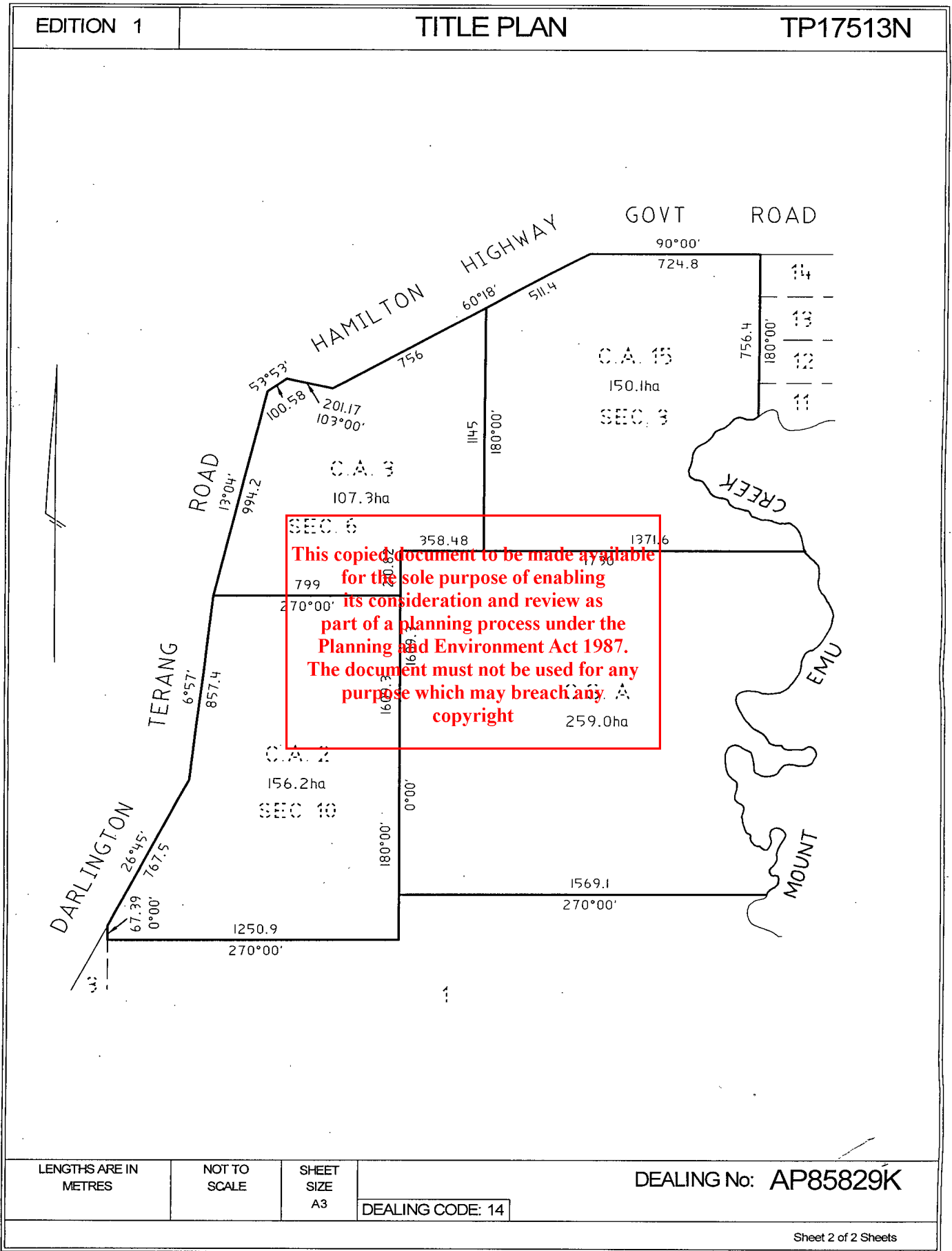

LENGTHS ARE IN METRES

NOT TO SCALE

SHEET SIZE A3

DEALING CODE: 14

DEALING No: AP85829K

ADVERTISED
 PLAN

Copyright State of Victoria. No part of this publication may be reproduced except as permitted by the Copyright Act 1968 (Cth), to comply with a statutory requirement or pursuant to a written agreement. The information is only valid at the time and in the form obtained from the LANDATA REGD TM System. None of the State of Victoria, its agents or contractors, accepts responsibility for any subsequent publication or reproduction of the information.

The Victorian Government acknowledges the Traditional Owners of Victoria and pays respects to their ongoing connection to their Country, History and Culture. The Victorian Government extends this respect to their Elders, past, present and emerging.

REGISTER SEARCH STATEMENT (Title Search) Transfer of Land Act 1958

VOLUME 10518 FOLIO 624

Security no : 124130882030B
Produced 18/12/2025 03:17 PM

LAND DESCRIPTION

Crown Allotment 1 Section 20 Parish of Darlington.
Created by Application No. 085829K 19/04/2000

REGISTERED PROPRIETOR

Estate Fee Simple
Sole Proprietor

EBARE PTY LTD of STONY POINT DARLINGTON
Application No. 085829K 19/04/2000

**ADVERTISED
PLAN**

ENCUMBRANCES, CAVEATS AND NOTICES

For details of any other encumbrances see the plan or imaged folio set out under DIAGRAM LOCATION below.

DIAGRAM LOCATION

SEE TP017517E FOR FURTHER DETAILS AND BOUNDARIES

ACTIVITY IN THE LAST 125 DAYS

NIL

-----END OF REGISTER SEARCH STATEMENT-----

Additional information: (not part of the Register Search Statement)

Street Address: "STONE POINT" 2977 HAMILTON HIGHWAY DARLINGTON VIC 3271

DOCUMENT END

Delivered from the LANDATA® System by InfoTrack Pty Ltd.

The information supplied by InfoTrack (Commercial) has been obtained from InfoTrack Pty Limited by agreement between them. The information supplied has been obtained by InfoTrack Pty Limited who is licensed by the State of Victoria to provide this information via LANDATA® System.

**This copied document to be made available
for the sole purpose of enabling
its consideration and review as
part of a planning process under the
Planning and Environment Act 1987.
The document must not be used for any
purpose which may breach any
copyright**

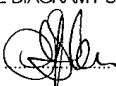
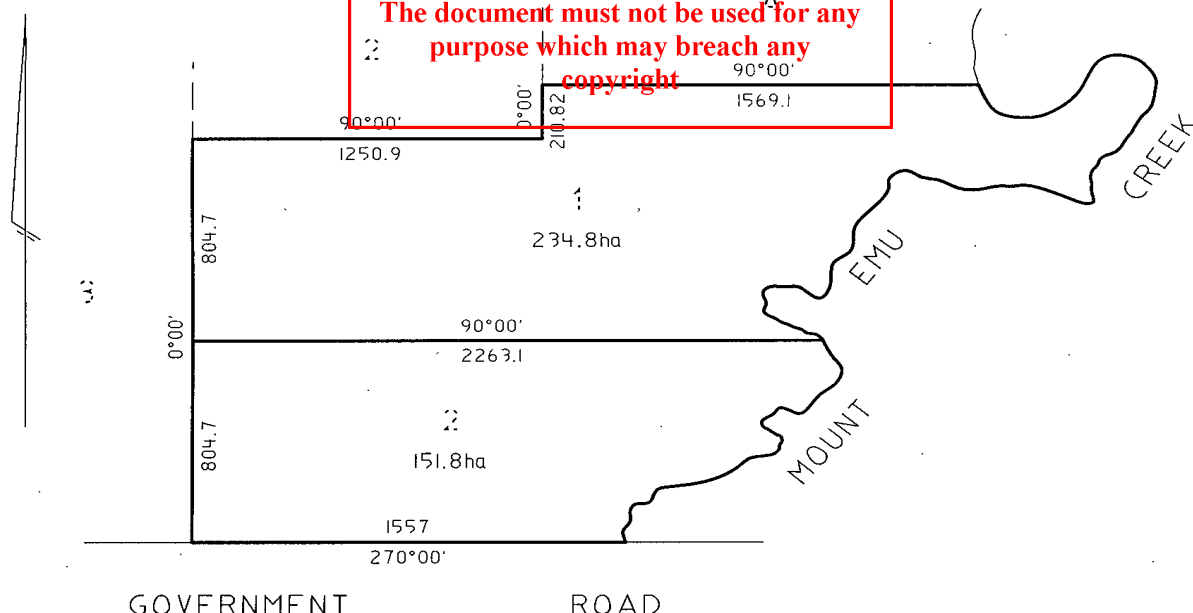
| | | | | |
|--|--|--|-----------------------------|------------------------------|
| EDITION 1 | TITLE PLAN | TP17517E | | |
| Location of Land Parish: DARLINGTON Township: Crown Allotment: 1 & 2 Section: 20 Crown Portion: - LTO base record: SDMB-C (RURAL) Last plan Reference: Title Reference: Depth Limitation: NIL | Notations <div style="font-size: 2em; color: red; font-weight: bold;">ADVERTISED PLAN</div> | | | |
| Easement Information E - Encumbering Easement R - Encumbering Easement (ROAD) A - Appurtenant Easement | | THIS PLAN HAS BEEN PREPARED BY LAND REGISTRY, LAND VICTORIA FOR TITLE DIAGRAM PURPOSES Checked by:  Date: 22/12/2000 Assistant Registrar of Titles | | |
| Easement Reference | Purpose/Authority | Width | Origin | Land benefitted/In favour of |
| NIL | | | | |
| <div style="border: 2px solid red; padding: 5px; color: red; font-weight: bold;"> This copied document to be made available for the sole purpose of enabling its consideration and review as part of a planning process under the Planning and Environment Act 1987. The document must not be used for any purpose which may breach any copyright </div> | | | | |
|  | | | | |
| LENGTHS ARE IN METRES | NOT TO SCALE | SHEET SIZE A3 | DEALING No: AP85829K | |
| | | | DEALING CODE: 14 | |
| Sheet 1 of 1 Sheets | | | | |