

ADVERTISED PLAN

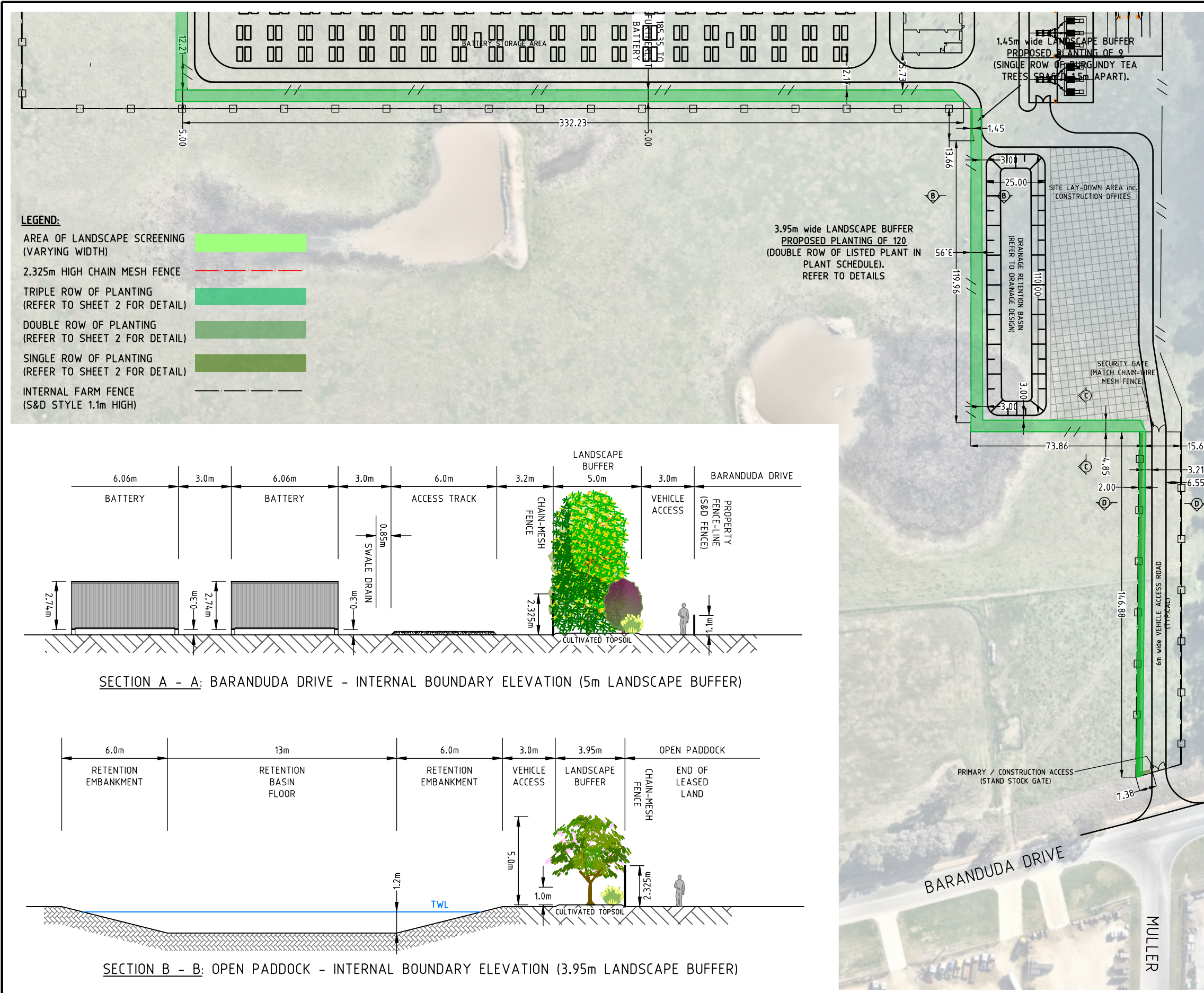

REVISION	DATE
1 Amendments as per Client	10/23

NOTE 1
BEWARE OF EXISTING OVERHEAD POWER CABLES.

WARNING
BEWARE OF UNDERGROUND SERVICES
The locations of underground services are approximate only and their exact position should be proven on site. No guarantee is given that all existing services are shown.

- NOTES:**
- REFER TO SITE PLAN BY OTHERS FOR DETAILS, LOCALITY, ELECTRICAL SPECIFICATIONS & NOTES.
 - AERIAL IMAGE: NEARMAP - FLOWN: AUGUST, 2023 (CURRENT).
 - REFER TO "2221901r0 PoEC" FOR F&L DATA BY CS&A.
 - SOME LAYERS FROM SITE PLAN HAVE BEEN TURNED OFF IN THIS VIEWPORT FOR PLAN CLARITY.
 - LANDSCAPE PLAN IS BASED ON SITE PLAN "724-EEIGN.DWG.1B01 REV. 0.1" & SWMP "22219 - D01".

This copied document to be made available for the sole purpose of enabling its consideration and review as part of a planning process under the Planning and Environment Act 1987. The document must not be used for any purpose which may breach any copyright



0 12.5 25 50m
Scale 1:2500 @ A3

Chris Smith & ASSOCIATES
PTY LTD

CIVIL ENGINEERS
URBAN & REGIONAL PLANNERS
LEVEL 1 / 135 FRYERS STREET, SHEPPARTON, VIC. 3630
PH: (03) 5820 7700 FAX: (03) 5822 4878 www.csmith.com.au

Designed Nathan Jarrett October, 2023
Drawn Nathan Jarrett October, 2023
Checked Duncan Lewis October, 2023
Approved

Birdwood Energy Pty. Ltd.
Battery Energy Storage Project
Kiewa Valley Highway
Baranduda, VIC, 3691
Landscape Maintenance Plan
Landscape Layout & Elevations
Drawing No. 22219-LS01 Rev. 4
Sheet No. 2 of 4 22219-LS01 Rev.4.dwg

© Chris Smith & Associates ABN 14 637 882 064
THIS DOCUMENT IS COPYRIGHTED AND MAY ONLY BE USED FOR THE PURPOSE FOR WHICH IT WAS COMMISSIONED. UNAUTHORIZED USE PROHIBITED. ALL DIMENSIONS AND LEVELS TO BE CHECKED ON THE PROJECT BEFORE COMMENCING ANY WORKS OR SHOP DRAWINGS.
DRAWINGS NOT TO BE SCALED.

ADVERTISED PLAN

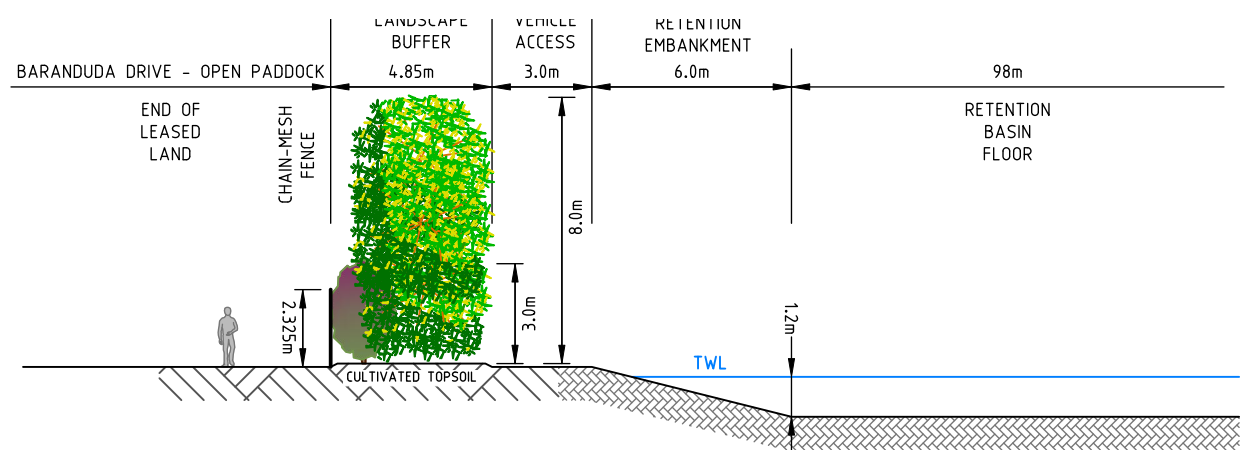

SECTION C - C: BARANDUDA DRIVE - INTERNAL BOUNDARY (4.85m LANDSCAPE BUFFER)

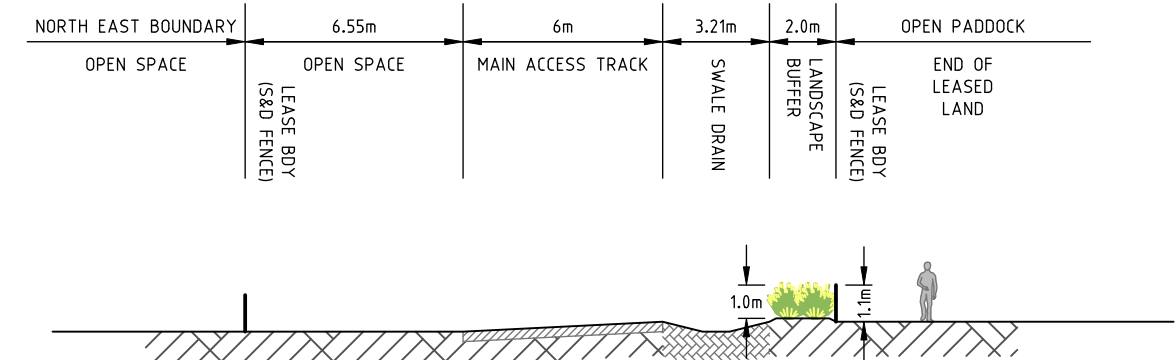

SECTION D - D: NORTH EAST BOUNDARY - INTERNAL BOUNDARY (2m LANDSCAPE BUFFER)

Plant Schedule					
Botanical Name	Common Name	Planting Size	Mature Size	Symbol	Total
Calocephalus Citreus	Lemon Beauty-Heads	50mm Tube with Bio-Guard	1.0m H x 1.0m W		445 No.
Leptospermum Morrisonii	Burgundy Tea Tree	50mm Tube with Bio-Guard	3.0m H x 2.0m W		144 No.
Callistemon Viminalis	Weeping Bottlebrush	50mm Tube with Bio-Guard	4.0m H x 4.0m W		51 No.
Lagerstroemia Indica (White)	Crepe Myrtle (White)	50mm Tube with Bio-Guard	5.0m H x 4.0m W		63 No.
Pittosporum Angustifolium	Weeping Pittosporum	50mm Tube with Bio-Guard	8.0m H x 4.0m W		33 No.
					736 No.

LANDSCAPE CONSTRUCTION NOTES:

- Landscape Construction.**
 - Contractor to ensure all measurements on site are correct & accurate.
 - All planted areas are required to have a minimum of 150mm cultivated topsoil.
 - Finished level of topsoil to be 100 - 150mm above existing surface level to ensure planted areas are free from water-logging during wet periods.
- Locate All Existing Services.**
 - Contractor to ensure a Dial Before You Dig is undertaken and are to be aware of all underground services and are located as relevant.
- Planting & Turf Areas Preparation.**
 - Eradicate broadleaf, woody & noxious weeds from all planting & turf areas using selective herbicides.
 - Contractor to ensure that appropriate surface preparation has occurred. Including aeration, topsoil, leveling & surface layering.
 - Apply fertilizers & additives at appropriate rates to appropriate areas.
- Plant Supply.**
 - All supplied plants are to be healthy & free of any pests, diseases and of an attractive natural.
 - Root systems are not to be root bound & to have a well formed root system commensurate in size with the foliage mass.
- Irrigation.**
 - Plants are to be watered as required during the "establishment" phase of plant growth (Approx. 2 years).

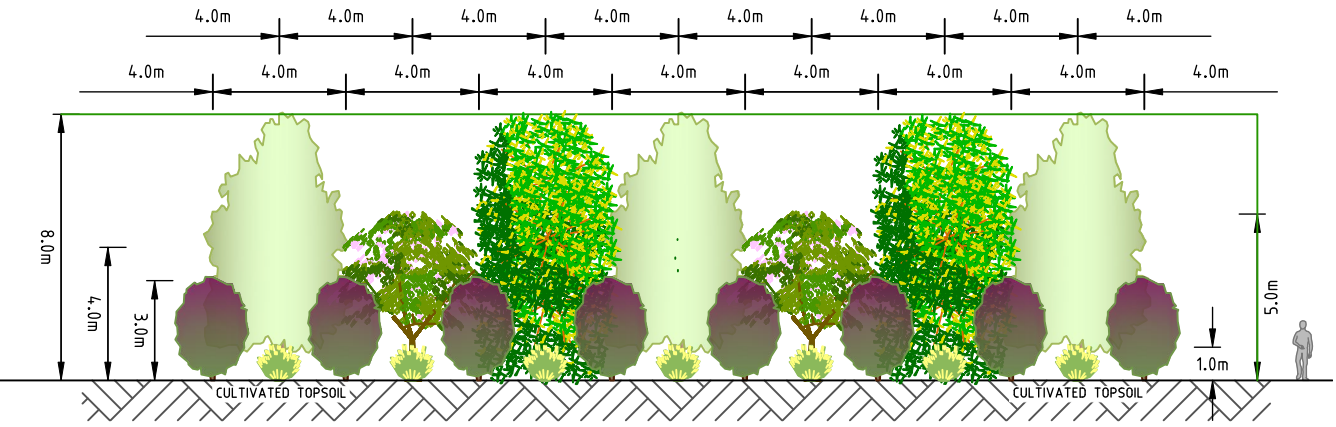

SECTION A - A: BARANDUDA DRIVE - INTERNAL BOUNDARY PLANTING (5m LANDSCAPE BUFFER)

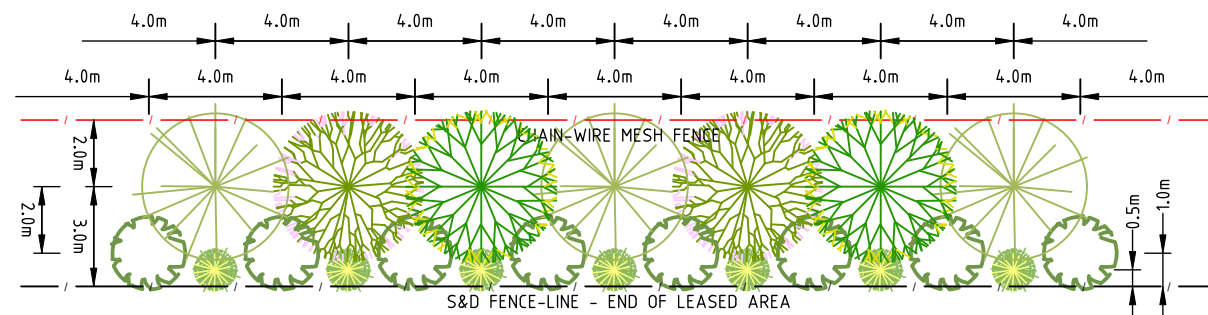

SECTION A - A: BARANDUDA DRIVE - INTERNAL BOUNDARY PLAN (5m LANDSCAPE BUFFER)

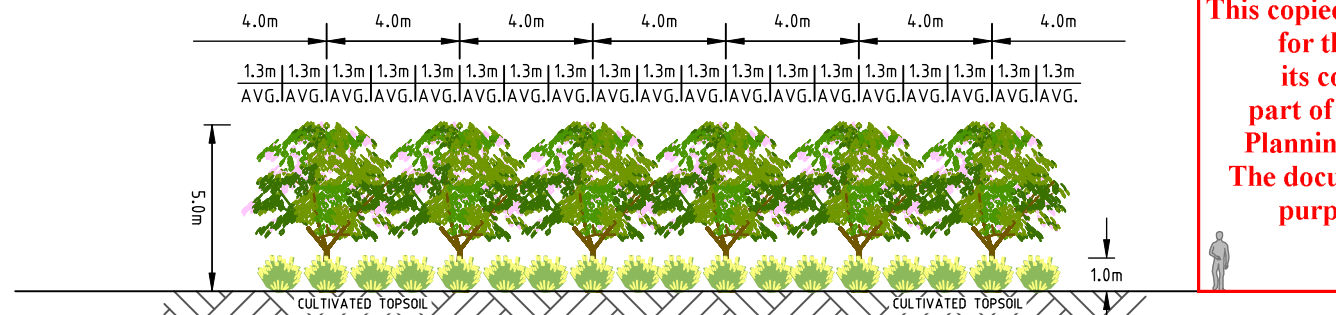

SECTION B - B: OPEN Paddock - INTERNAL BOUNDARY PLANTING (3.95m LANDSCAPE BUFFER)

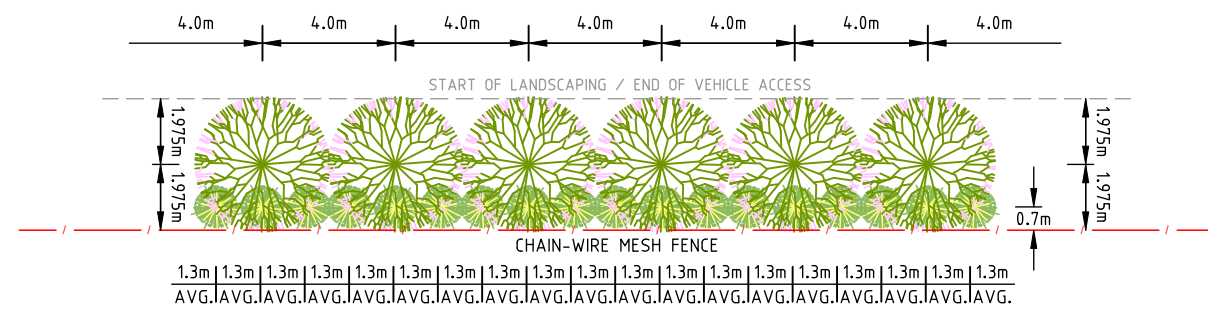

SECTION B - B: OPEN Paddock - INTERNAL BOUNDARY PLAN (3.95m LANDSCAPE BUFFER)

This copied document to be made available for the sole purpose of enabling its consideration and review as part of a planning process under the Planning and Environment Act 1987. The document must not be used for any purpose which may breach any copyright



REVISION	DATE	ZONE
1 Amendments as per Client	10/23	-

- NOTES:**
- REFER TO SITE PLAN BY OTHERS FOR DETAILS, LOCALITY, ELECTRICAL SPECIFICATIONS & NOTES.
 - AERIAL IMAGE: NEARMAP - FLOWN: AUGUST, 2023 (CURRENT).
 - REFER TO "2221901r0 PoEC" FOR F&L DATA BY CS&A.
 - SOME LAYERS FROM SITE PLAN HAVE BEEN TURNED OFF IN THIS VIEWPORT FOR PLAN CLARITY.
 - LANDSCAPE PLAN IS BASED ON SITE PLAN "724.EE1.GN.DWG.1B01 REV. 0.1" & SWMP "22219 - D01".

NOTE!
BEWARE OF EXISTING OVERHEAD POWER CABLES.

WARNING
BEWARE OF UNDERGROUND SERVICES
The locations of underground services are approximate only and their exact position should be proven on site. No guarantee is given that all existing services are shown.

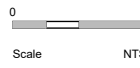

Chris Smith & Associates
PTV LTD
CIVIL ENGINEERS, URBAN & REGIONAL PLANNERS, LAND SURVEYORS, PROJECT MANAGERS
LEVEL 1/155 PRYERS STREET, SHEPPARTON, VIC. 3630
PH: (03) 5820 7700 FAX: (03) 5822 4878 www.csmith.com.au

Designed: Nathan Jarrett October, 2023
Drawn: Nathan Jarrett October, 2023
Checked: Duncan Lewis October, 2023
Approved:

Birdwood Energy Pty. Ltd.
Battery Energy Storage Project
Kiewa Valley Highway
Baranduda, VIC, 3691

Landscape Maintenance Plan
Elevations, Schedule & Notes
Drawing No. 22219-LS01 Rev. 4

Sheet No. 3 of 4 22219-LS01 Rev.4.dwg
Chris Smith & Associates ABN 14 627 882 064 A3
THIS DOCUMENT IS COPYRIGHT AND MAY ONLY BE USED FOR THE PURPOSE FOR WHICH IT WAS COMMISSIONED. UNAUTHORISED USE PROHIBITED. ALL DIMENSIONS AND LEVELS TO BE CHECKED ON THE PROJECT BEFORE COMMENCING ANY WORKS OR SHOP DRAWINGS. DRAWINGS NOT TO BE SCALED.

ADVERTISED PLAN

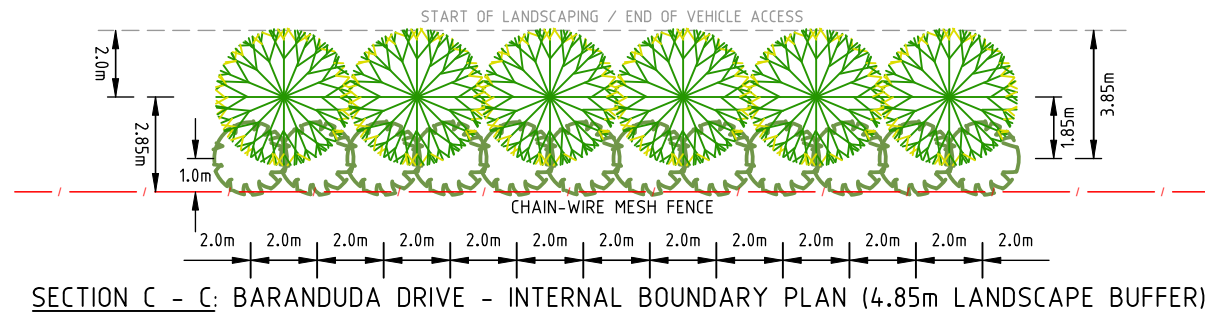
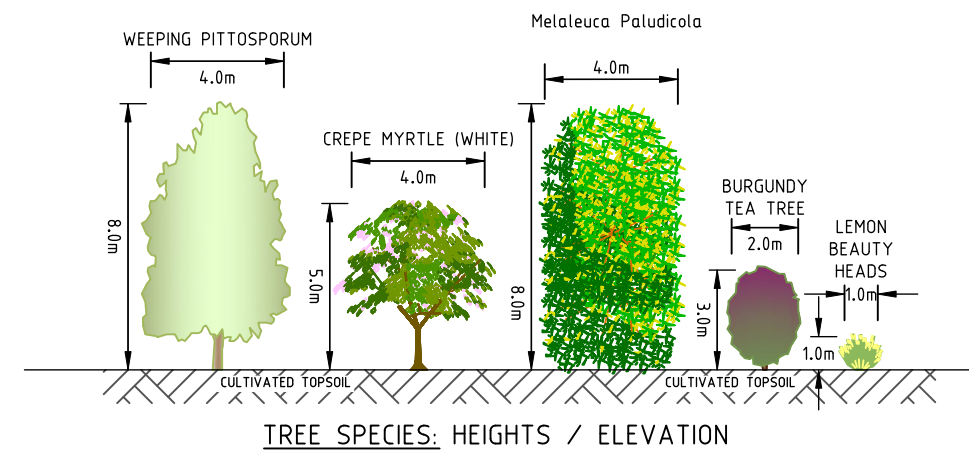
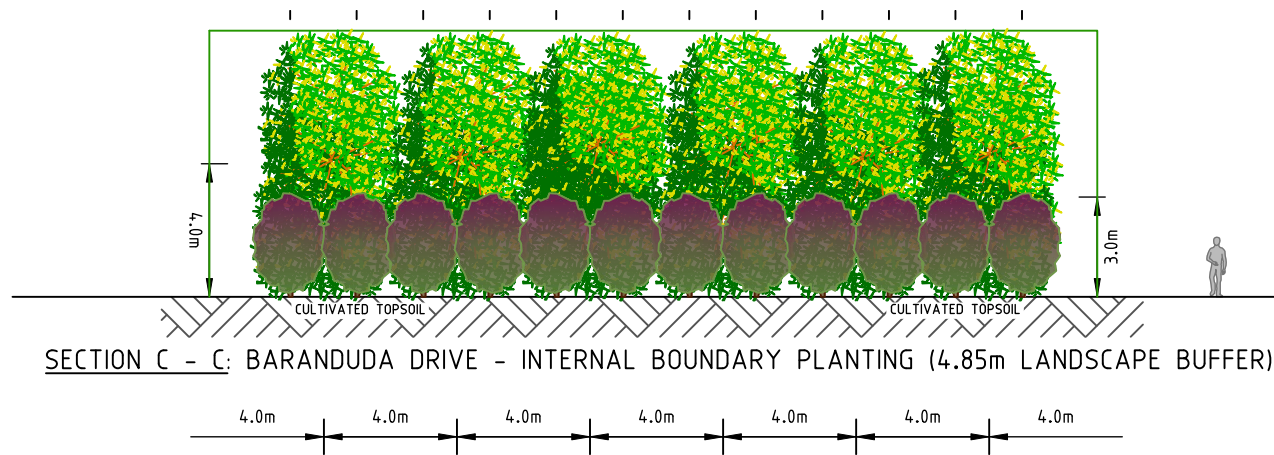

B: CALOCEPHALUS CITREUS
C: LEMON BEAUTY-HEADS

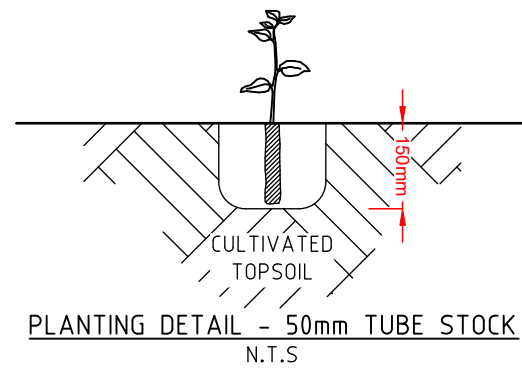

This copied document to be made available for the sole purpose of enabling its consideration and review as part of a planning process under the Planning and Environment Act 1987. The document must not be used for any purpose which may breach any copyright

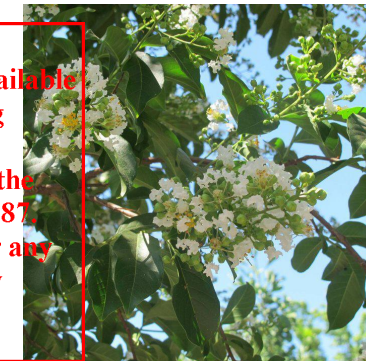
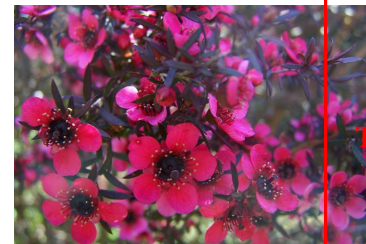

B: LEPTOSPERMUM MORRISONII
C: BURGUNDY TEA TREE

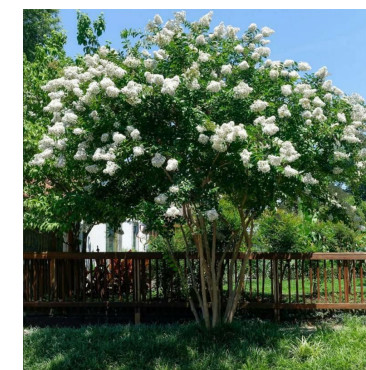

B: LAGERSTROEMIA INDICA (WHITE)
C: CREPE MYRTLE (WHITE)



B: PITTOSPORUM ANGUSTIFOLIUM
C: WEEPING PITTOSPORUM

Landscape Maintenance Plan	
Task	Time Period
Planting of local drought tolerant plants (refer Plant Schedule)	Upon construction of solar panels perimeter fence
Water at planting & then fortnightly	1st & 2nd month after planting
Maintenance (watered by rainfall or as required)	
Visual inspection once a month ensuring plants are alive	3rd to 5th month after planting
Visual inspection once every 3 months ensuring plants are alive	6th to 8th month after planting
Visual inspection once every 6 months ensuring plants are alive	9th month to 30 years after planting

Note:
 (1) Any dead, diseased or damaged plants will be replaced as soon as possible by maintenance services team.
 (2) The Landscape Maintenance Plan has been prepared in accordance with advice from Birdwood Energy P/L.

Disclaimer:
 Chris Smith & Associates P/L. take no responsibility for the implementation of the Landscape Maintenance Plan.

B & C: Melaleuca paludicola

NOTES:

- REFER TO SITE PLAN BY OTHERS FOR DETAILS, LOCALITY, ELECTRICAL SPECIFICATIONS & NOTES.
- AERIAL IMAGE: NEARMAP - FLOWN: AUGUST, 2023 (CURRENT).
- REFER TO "2221901r0 PoEC" FOR F&L DATA BY CS&A.
- SOME LAYERS FROM SITE PLAN HAVE BEEN TURNED OFF IN THIS VIEWPORT FOR PLAN CLARITY.
- LANDSCAPE PLAN IS BASED ON SITE PLAN "724.EE1.GN.DWG.1B01 REV. 0.1" & SWMP "22219 - D01".

NOTE !
BEWARE OF EXISTING OVERHEAD POWER CABLES.

WARNING
BEWARE OF UNDERGROUND SERVICES
The locations of underground services are approximate only and their exact position should be proven on site. No guarantee is given that all existing services are shown.

0
Scale NTS

Chris Smith & Associates
PTY LTD

CIVIL ENGINEERS
URBAN & REGIONAL PLANNERS
LEVEL 1 / 155 PRYERS STREET, SHEPPARTON, VIC. 3630
PH: (03) 5820 7700 FAX: (03) 5822 4878 www.csamth.com.au

DESIGNED: Nathan Jarrett October, 2023
 DRAWN: Nathan Jarrett October, 2023
 CHECKED: Duncan Lewis October, 2023
 APPROVED:

Birdwood Energy Pty. Ltd.
Battery Energy Storage Project
 Kiewa Valley Highway
 Baranduda, VIC, 3691

Landscape Maintenance Plan
Elevations, Details, Photos & Maintenance Plan
Drawing No. 22219-LS01 Rev. 4

Sheet No. 4 of 4 22219-LS01 Rev.4.dwg

© Chris Smith & Associates ABN 14 627 882 064 A3
 THIS DOCUMENT IS COPYRIGHT AND MAY ONLY BE USED FOR THE PURPOSE FOR WHICH IT WAS COMMISSIONED. UNAUTHORISED USE PROHIBITED. ALL DIMENSIONS AND LEVELS TO BE CHECKED ON THE PROJECT BEFORE COMMENCING ANY WORKS OR SHOP DRAWINGS. DRAWINGS NOT TO BE SCALED.



REVISION	DATE	ZONE
1 Amendments as per Client	10/23	-