

ADVERTISED PLAN

This copied document to be made available for the sole purpose of enabling its consideration and review as part of a planning process under the Planning and Environment Act 1987. The document must not be used for any purpose which may breach any copyright

Legend

- Major Contour (Interval 1.0m)
- Minor Contour (Interval 0.20m)
- Fence Line
- Gate
- Edge of Concrete / Concrete Kerb
- Edge of Bitumen
- Centre Line of Bitumen
- Top of Bank
- Toe of Bank
- Edge of Water
- Overhead Electricity Line
- Temporary Bench Mark (TBM)
- Tree
- Dead Tree
- Sign
- Gate
- Fence Post
- Electricity Pole with Light
- Existing Surface Level
- Bitumen Area
- Dam

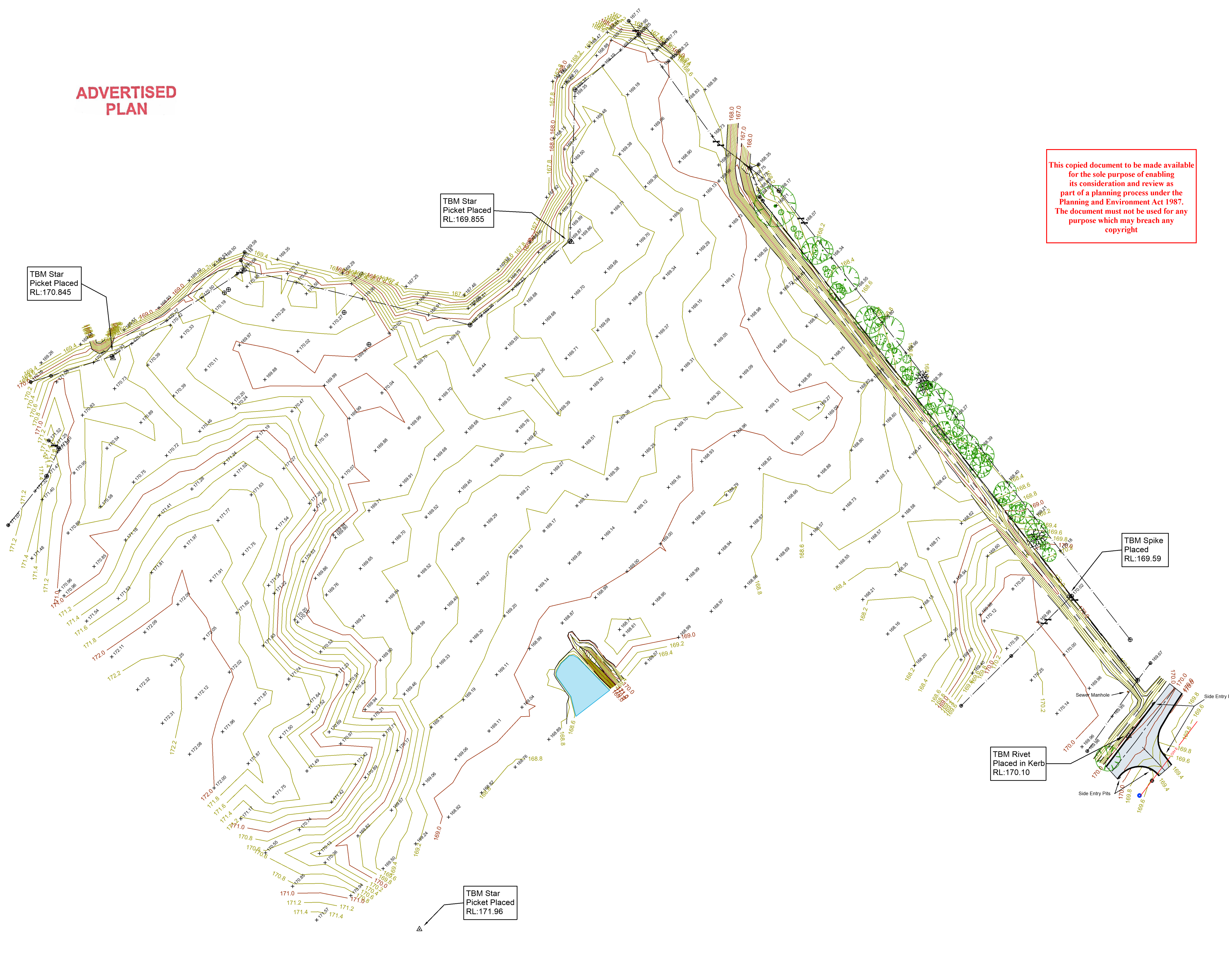

Notes

Every endeavour has been taken to locate visible services, however, there is no guarantee that all existing services are shown or located exactly on this plan. Positions and levels of these services should be proven on site before the commencement of any works.

Data is on MGA2020 Co-ordinate & Bearing datum based on GNSS observations to Baranduda PM 24 & TBM's on site. Data is on Ground Distances (not scaled).

Heights are to the Australian Height Datum (AHD) based on GNSS observations to Baranduda PM 24 (RL: 172.635).

For the purposes of plan clarity, some levels may not be displayed on this plan, however, they are visible in model space of this 'DWG'.

No responsibility is taken by Chris Smith & Associates, as to the location of underground services located in the survey. The client should investigate these matters to ensure they do not effect the possible development or project to be undertaken.

These notes are an integral part of the plan.

CONDITIONS OF USE – PROVISION OF PLAN

The provision of this plan is subject to the following conditions:

1. That this statement always remains with the plan as provided, even when it is passed onto a third party.
2. The plan is not altered in any way.
3. In the case of a plan of subdivision or consolidation, the plan provided is typically prepared in order to be certified by Council and approved by the Referral Authorities and is usually not a "registered plan" (not approved by Land Registry/Titles Office).
4. Chris Smith & Associates Pty. Ltd. accepts no responsibility whatsoever for any loss or damage suffered however to any person or corporation who may use or rely on the plan for any purpose.
5. Chris Smith & Associates Pty. Ltd. cannot accept any liability for any loss or damage however arising from future changes that may be applied to this plan. It is the responsibility of the recipient of this plan to ensure they have the most up to date version for their intended use.
6. Unless agreed in writing by our client, Chris Smith & Associates holds copyright and intellectual property rights over the product. However, our client may give written authority for "Third Parties" to use the plan for the purposes it was prepared.
7. Any use of the plan, or it's content, is on the basis that Chris Smith & Associates Pty. Ltd. is acknowledged as the author of the product and that due recognition is noted on any drawings or publications created or commissioned by the recipient of the plan.
8. That the following information is noted and accepted:
 - Where a coordinate system is used, the data may have been truncated and scaled/projected.
 - Where title boundary information is supplied, it is current as of the date of the file and is subject to variation, and should be read in conjunction with Land Registry titles and registered plans.
 - Chris Smith & Associates Pty. Ltd. accept no liability for any loss or damage however arising from future changes that may be applied to this data, or from the use of the data for purposes for which it was not intended.
 - Unless agreed in writing by our client, Chris Smith & Associates holds copyright over the product. However, our client may give written authority for the "third Parties" to use the data for the purposes it was prepared.
 - Chris Smith & Associates Pty. Ltd. is acknowledged as the author of the data.
9. Any further limitations of use that may be contained within the product itself must be accepted by the user.

REVISION	DATE	ZONE

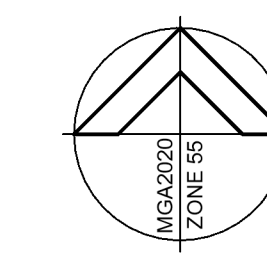

Scale 1:1500 @ A1

Chris Smith & ASSOCIATES
PTY LTD

CIVIL ENGINEERS
URBAN & REGIONAL PLANNERS
LAND SURVEYORS
PROJECT MANAGERS

LEVEL 1 / 135 FRYERS STREET, SHEPPARTON, VIC. 3630
PH: (03) 5820 7700 FAX: (03) 5822 4878 www.csmith.com.au

Designed
Checked
Approved

Nick Dunham
Nicholas Nightingale

17th March 2023
27th March 2023

Birdwood Energy Pty Ltd.
Battery Energy Storage System
Kiewa Valley Highway
Baranduda, VIC 3691

Plan of Existing Conditions
as of the 16th March 2023

Drawing No. 22219/01 Rev. 0

Sheet No. 1 of 1 2221901r0.dwg

© Chris Smith & Associates ABN 14 627 882 064
THIS DOCUMENT IS COPYRIGHT AND MAY ONLY BE USED FOR THE PURPOSE FOR WHICH IT WAS COMMISSIONED. UNAUTHORISED USE PROHIBITED. ALL DIMENSIONS AND LEVELS TO BE CHECKED ON THE PROJECT BEFORE COMMENCING ANY WORKS OR SHOP DRAWINGS. DRAWINGS NOT TO BE SCALED.