

Imaged Document Cover Sheet

The document following this cover sheet is an imaged document supplied by LANDATA®, Secure Electronic Registries Victoria.

Document Type	Plan
Document Identification	PS900052N
Number of Pages (excluding this cover sheet)	7
Document Assembled	21/05/2025 09:45

Copyright and disclaimer notice:

© State of Victoria. This publication is copyright. No part may be reproduced by any process except in accordance with the provisions of the Copyright Act 1968 (Cth) and for the purposes of Section 32 of the Sale of Land Act 1962 or pursuant to a written agreement. The information is only valid at the time and in the form obtained from the LANDATA® System. None of the State of Victoria, LANDATA®, Secure Electronic Registries Victoria Pty Ltd (ABN 86 627 986 396) as trustee for the Secure Electronic Registries Victoria Trust (ABN 83 206 746 897) accept responsibility for any subsequent release, publication or reproduction of the information.

The document is invalid if this cover sheet is removed or altered.

**This copied document to be made available
for the sole purpose of enabling
its consideration and review as
part of a planning process under the
Planning and Environment Act 1987.
The document must not be used for any
purpose which may breach any
copyright**

**ADVERTISED
PLAN**

PLAN OF SUBDIVISION				EDITION	PS 900052N /S 1	
LOCATION OF LAND				Council Name: Brimbank City Council		
PARISH: CUT PAW PAW				Council Reference Number: S143/2021		
TOWNSHIP: -				Planning Permit Reference: P559/2021		
SECTION: -				SPEAR Reference Number: S181896B		
CROWN ALLOTMENT: -				Certification		
CROWN PORTION: 18				This plan is certified under section 6 of the Subdivision Act 1988		
TITLE REFERENCE: VOL .9969 FOL.938 & VOL.10302 FOL.290				Public Open Space		
LAST PLAN REFERENCE: TP144401P & PC354530H				A requirement for public open space under section 18 or 18A of the Subdivision Act 1988 has been made and the requirement has been satisfied		
POSTAL ADDRESS: 99 DERBY ROAD, SUNSHINE 3020 (at time of subdivision)				Digitally signed by: Robert Shatford for Brimbank City Council on 15/07/2024		
MGA 94 CO-ORDINATES: E 309 200 ZONE: 55 (approx. centre of land in plan) N 5815 100				Statement of Compliance issued: 15/07/2024		
VESTING OF ROADS AND/OR RESERVES				NOTATIONS		
IDENTIFIER		COUNCIL/BODY/PERSON		STAGING THIS IS / IS NOT A STAGED SUBDIVISION PLANNING PERMIT NO.		
NIL		NIL		SURVEY THIS PLAN IS / IS NOT BASED ON SURVEY THIS SURVEY HAS BEEN CONNECTED TO PERMANENT MARKS NO(S) CUT PAW PAW PM 497 IN PROCLAIMED SURVEY AREA NO. - DEPTH LIMITATION DOES NOT APPLY		
<div>This copied document to be made available for the sole purpose of enabling its consideration and review as part of a planning process under the Planning and Environment Act 1987. The document must not be used for any purpose which may breach any copyright.</div> <div>ADVERTISED PLAN</div> <div>LOTS IN THIS PLAN MAY BE AFFECTED BY ONE OR MORE OWNERS CORPORATIONS. FOR DETAILS OF ANY OWNERS CORPORATIONS INCLUDING PURPOSE, RESPONSIBILITY, ENTITLEMENT & LIABILITY SEE OWNERS CORPORATION SEARCH REPORT, OWNERS CORPORATION ADDITIONAL INFORMATION AND IF APPLICABLE, OWNERS CORPORATION RULES</div>						
EASEMENT INFORMATION						
EASEMENTS & RIGHTS IMPLIED BY SECTION 12(2) OF THE SUBDIVISION ACT 1988 APPLIES TO THE WHOLE OF THE LAND IN THIS PLAN.						
LEGEND: E - ENCUMBERING EASEMENT, CONDITION IN CROWN GRANT IN THE NATURE OF AN EASEMENT OR OTHER ENCUMBRANCE A - APPURTENANT EASEMENT						
SUBJECT LAND	PURPOSE	WIDTH (metres)	ORIGIN	LAND BENEFITED/IN FAVOUR OF		
	SEE SHEET 2 FOR EASEMENTS					
<div>veris VERIS AUSTRALIA PTY LTD A Level 3, 1 Southbank Blvd Southbank VIC 3006 T +61 3 7019 8400 E melbourne@veris.com.au W www.veris.com.au</div>			LICENSED SURVEYOR BENJAMIN SANSOM			
			DATE 11/09/24 REFERENCE 302780		ORIGINAL SHEET SIZE A3	
			VERSION H DRAWING 302780-AH		SHEET 1 OF 6 SHEETS	
			Digitally signed by: Benjamin Sansom, Licensed Surveyor, Surveyor's Plan Version (H), 23/05/2024, SPEAR Ref: S181896B		Land Use Victoria Plan Registered 05:43 AM 12/09/2024 Assistant Registrar of Titles	

PLAN OF SUBDIVISION				PS 900052N /S 1	
EASEMENT INFORMATION					
LEGEND: E - ENCUMBERING EASEMENT, CONDITION IN CROWN GRANT IN THE NATURE OF AN EASEMENT OR OTHER ENCUMBRANCE A - APPURTENANT EASEMENT					
SUBJECT LAND	PURPOSE	WIDTH (metres)	ORIGIN	LAND BENEFITED/IN FAVOUR OF	
E-1	WAY	3.05m	INST. D672471 INST. D672472 INST. D672473 INST. D672474 INST. D672475 INST. D672476 INST. D672477 INST. D672478 INST. D672479 INST. D672480 INST. D672481 THIS PLAN	VOL 7871 FOL 066 VOL 4437 FOL 382 VOL 4721 FOL 039 & VOL 8856 FOL 546 VOL 4874 FOL 626 VOL 4402 FOL 383 VOL 4212 FOL 293 VOL 2436 FOL 022 VOL 5003 FOL 413 VOL 5128 FOL 501 VOL 4322 FOL 275 VOL 4315 FOL 862 GREATER WESTERN WATER	
E-2	SEWERAGE				
E-2	WAY	3.05m	INST. D672471 INST. D672472 INST. D672473 INST. D672474 INST. D672475 INST. D672476 INST. D672477 INST. D672478 INST. D672479 INST. D672480 INST. D672481 TR. 275042	VOL 7871 FOL 066 VOL 4437 FOL 382 VOL 4721 FOL 039 & VOL 8856 FOL 546 VOL 4874 FOL 626 VOL 4402 FOL 383 VOL 4212 FOL 293 VOL 2436 FOL 022 VOL 5003 FOL 413 VOL 5128 FOL 501 VOL 4322 FOL 275 VOL 4315 FOL 862 LAND REMAINING IN VOL 2105 FOL 898 AFTER TR.274502	
E-3	CARRIAGEWAY				
E-3	AS PROVIDED FOR IN SEC 528(2)(e) LGA	SEE DIAG.	SEC 528(2)(e) LGA	M.M.B.W., S.E.C., TELECOM AUSTRALIA, GAS & FUEL CORP. & CITY OF SUNSHINE S.E.C. & GAS & FUEL CORP.	
E-4	AS PROVIDED FOR IN SEC 528(2)(e) LGA	SEE DIAG.	SEC 528(2)(e) LGA	S.E.C.	
E-5	AS PROVIDED FOR IN SEC 528(2)(e) LGA	SEE DIAG.	SEC 528(2)(e) LGA	GAS & FUEL CORP.	
E-6	AS PROVIDED FOR IN SEC 528(2)(e) LGA	SEE DIAG.	SEC 528(2)(e) LGA	LOT S300 ON THIS PLAN	
E-7	CARRIAGEWAY - LIMITED IN DEPTH & HEIGHT TO SITE LEVEL & 2.1m ABOVE SITE LEVEL	SEE DIAG.	THIS PLAN	LOT S300 ON THIS PLAN	
E-7	LIGHT & AIR - LIMITED IN DEPTH & HEIGHT TO SITE LEVEL & 2.1m ABOVE SITE LEVEL	SEE DIAG.	THIS PLAN	LOT S300 ON THIS PLAN	
E-8	LIGHT & AIR - LIMITED IN DEPTH TO 2.1m ABOVE SITE LEVEL SEE SECTION A-A'	SEE DIAG.	THIS PLAN	LOT S300 ON THIS PLAN	
E-9	LIGHT & AIR - LIMITED IN DEPTH TO A PROJECTION OF THE TOP OF LEVEL 4 SLAB SEE SECTION B-B'	SEE DIAG.	THIS PLAN	LOT S300 ON THIS PLAN	
E-10	DRAINAGE	SEE DIAG.	THIS PLAN	BRIMBANK CITY COUNCIL	
E-11	WAY	SEE DIAG.	INST. D672471 INST. D672472 INST. D672473 INST. D672474 INST. D672475 INST. D672476 INST. D672477 INST. D672478 INST. D672479 INST. D672480 INST. D672481 TR. 275042 THIS PLAN	VOL 7871 FOL 066 VOL 4437 FOL 382 VOL 4721 FOL 039 & VOL 8856 FOL 546 VOL 4874 FOL 626 VOL 4402 FOL 383 VOL 4212 FOL 293 VOL 2436 FOL 022 VOL 5003 FOL 413 VOL 5128 FOL 501 VOL 4322 FOL 275 VOL 4315 FOL 862 LAND REMAINING IN VOL 2105 FOL 898 AFTER TR.274502 BRIMBANK CITY COUNCIL	
E-11	CARRIAGEWAY DRAINAGE				

This copied document to be made available for the sole purpose of enabling its consideration and review as part of a planning process under the Planning and Environment Act 1987. The document must not be used for any purpose which may breach any copyright

ADVERTISED PLAN

	LICENSED SURVEYOR BENJAMIN SANSOM		
	DATE 11/09/24	REFERENCE 302780	ORIGINAL SHEET SIZE A3
	VERSION H	DRAWING 302780-AH	SHEET 2
	Digitally signed by: Benjamin Sansom, Licensed Surveyor, Surveyor's Plan Version (H), 23/05/2024, SPEAR Ref: S181896B		Digitally signed by: Brimbank City Council, 15/07/2024, SPEAR Ref: S181896B

Amended by: Benjamin Sansom, Licensed Surveyor 11/09/2024.

PLAN OF SUBDIVISION

PS 900052N /S 1

ADVERTISED PLAN

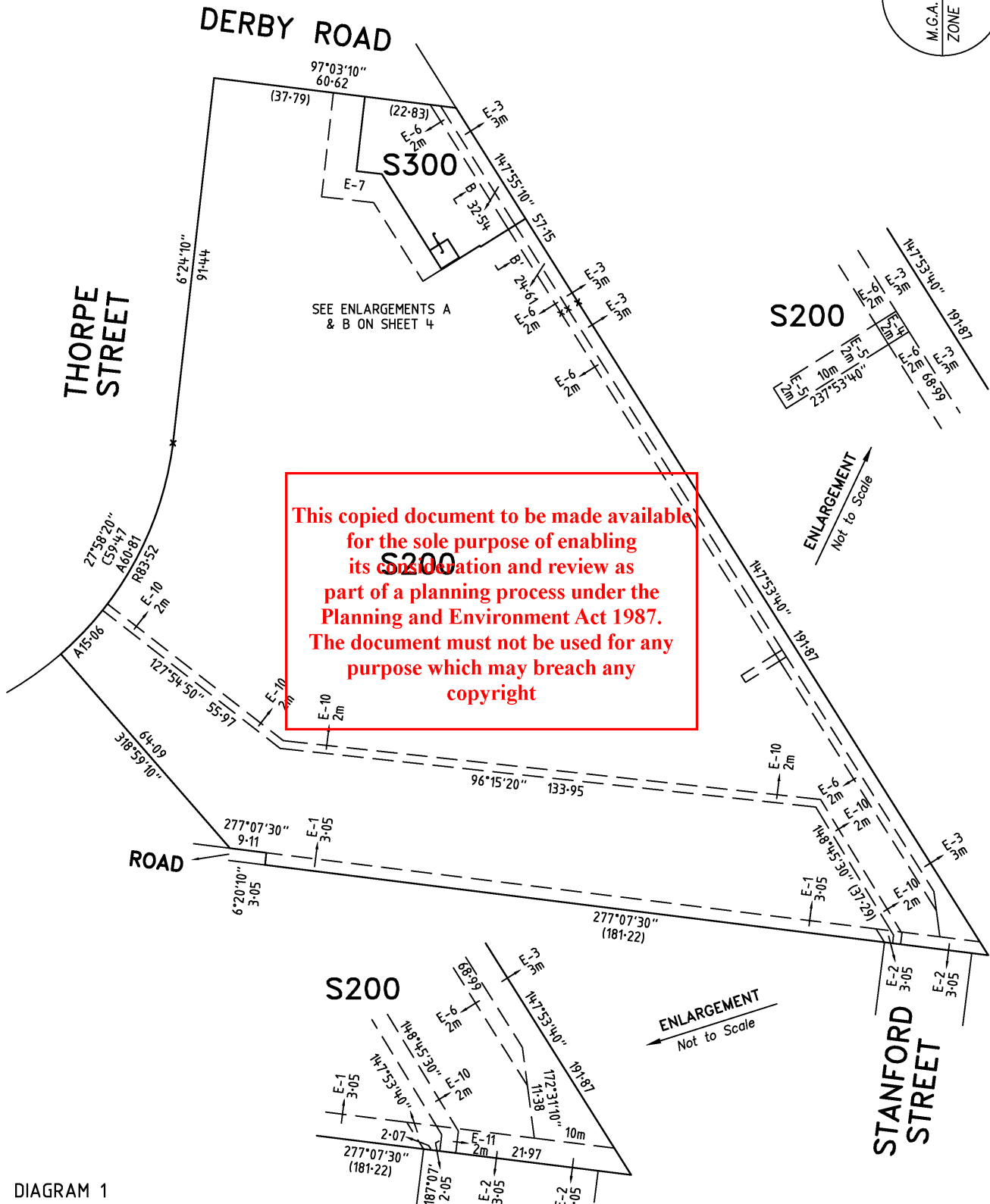
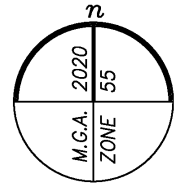

DIAGRAM 1
GROUND LEVEL AND BELOW

veris

VERIS AUSTRALIA PTY LTD
A | Level 3, 1 Southbank Blvd
Southbank VIC 3006
T | +61 3 7019 8400
E | melbourne@veris.com.au
W | www.veris.com.au

LICENSED SURVEYOR BENJAMIN SANSOM

SCALE
1:1000

10 0 20 40
LENGTHS ARE IN METRES

DATE 11/09/24

REFERENCE 302780

VERSION H

DRAWING 302780-AH

ORIGINAL SHEET SIZE A3

SHEET 3

Digitally signed by: Benjamin Sansom, Licensed Surveyor,
Surveyor's Plan Version (H),
23/05/2024, SPEAR Ref: S181896B

Digitally signed by:
Brimbank City Council,
15/07/2024,
SPEAR Ref: S181896B

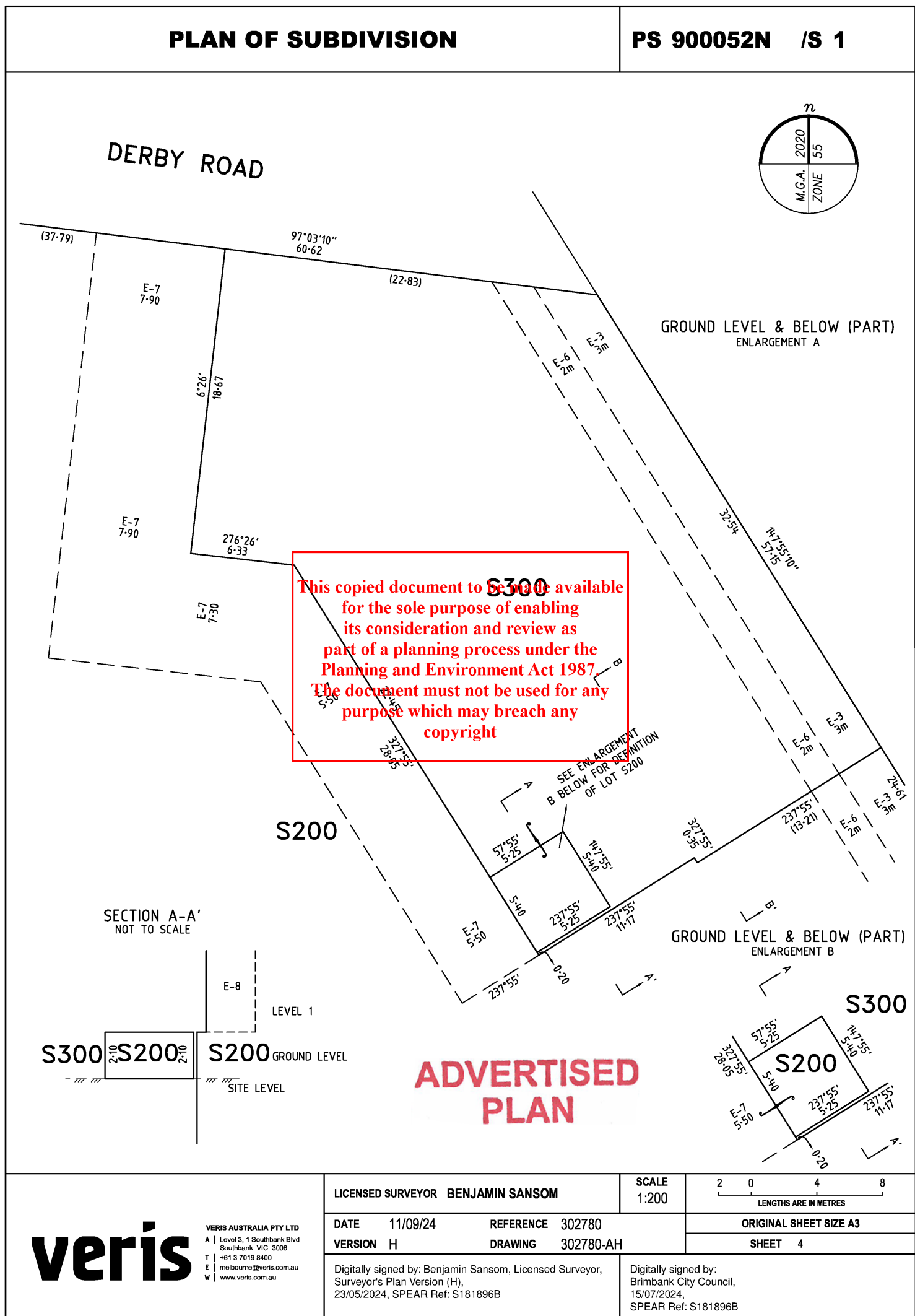

veris

VERIS AUSTRALIA PTY LTD
A | Level 3, 1 Southbank Blvd
Southbank VIC 3006
T | +61 3 7019 8400
E | melbourne@veris.com.au
W | www.veris.com.au

LICENSED SURVEYOR **BENJAMIN SANSON**

SCALE
1:200

2 0 4 8

LENGTHS ARE IN METRES

DATE 11/09/24	REFERENCE 302780
VERSION H	DRAWING 302780-AH

Digitally signed by: Benjamin Sansom, Licensed Surveyor,
Surveyor's Plan Version (H),
23/05/2024, SPEAR Ref: S181896B

Digitally signed by:
Brimbank City Council,
15/07/2024,
SPEAR Ref: S181896B

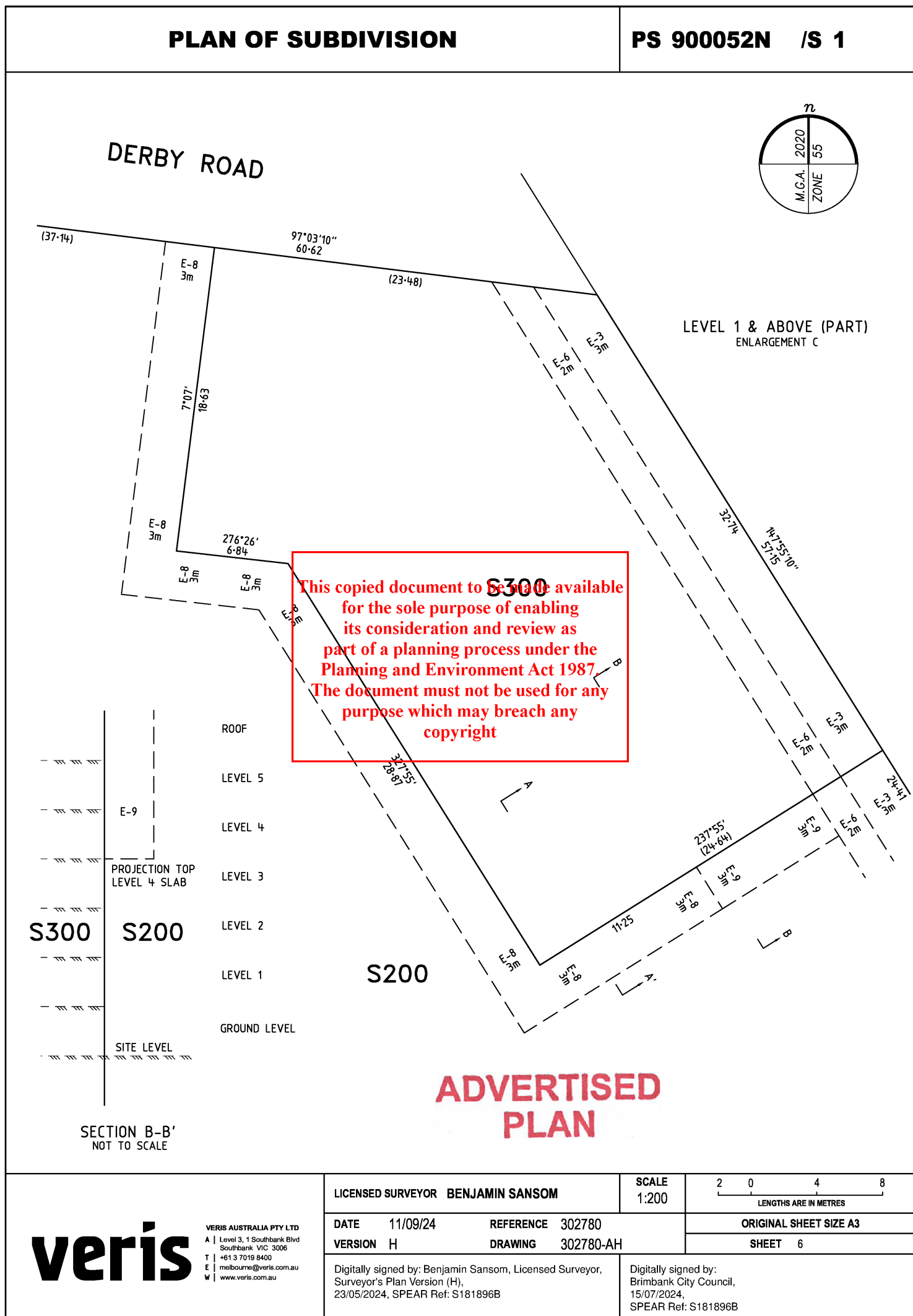

veris

VERIS AUSTRALIA PTY LTD
 A | Level 3, 1 Southbank Blvd
 Southbank VIC 3006
 T | +61 3 7019 8400
 E | melbourne@veris.com.au
 W | www.veris.com.au

