

**ADVERTISED
PLAN**

This copied document to be made available for the sole purpose of enabling its consideration and review as part of a planning process under the Planning and Environment Act 1987. The document must not be used for any purpose which may breach any copyright

NEIGHBOURHOOD & SITE DESCRIPTION
EXISTING
1:200@A1 / 1:400@A3

PRELIMINARY - NOT FOR CONSTRUCTION



Issue	TOWN PLANNING	Drawing Title	Drawing No.	Rev.
Project	SCOTCH COLLEGE CARPARK	NEIGHBOURHOOD & SITE	TP01	-
Project No.	05_24	Scale	Date	
Drawn/App.	SHI-	1:200@A1 / 1:400@A3	24.06.2024	
Client	SCOTCH COLLEGE Melbourne			

ADVERTISED PLAN



OPEN GATE/FENCE & MAX. 0.9m
HIGH VEGETATION WITHIN
DRIVEWAY VISUAL 'SPRAY' IN
ACCORDANCE WITH CLAUSE 52.06

This copied document to be made available for the sole purpose of enabling its consideration and review as part of a planning process under the Planning and Environment Act 1987. The document must not be used for any purpose which may breach any copyright

DESIGN RESPONSE
PROPOSED
1:200@A1 / 1:400@A3

PRELIMINARY - NOT FOR CONSTRUCTION

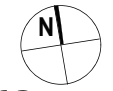

Issue	TOWN PLANNING	Drawing Title	Drawing No.	Rev.
Project	SCOTCH COLLEGE CARPARK	DESIGN RESPONSE	TP02	-
Project No.	05_24	Scale	Date	
Drawn/App.	SHI-	1:200@A1 / 1:400@A3	24.06.2024	
Client	SCOTCH COLLEGE Melbourne			

ADVERTISED PLAN

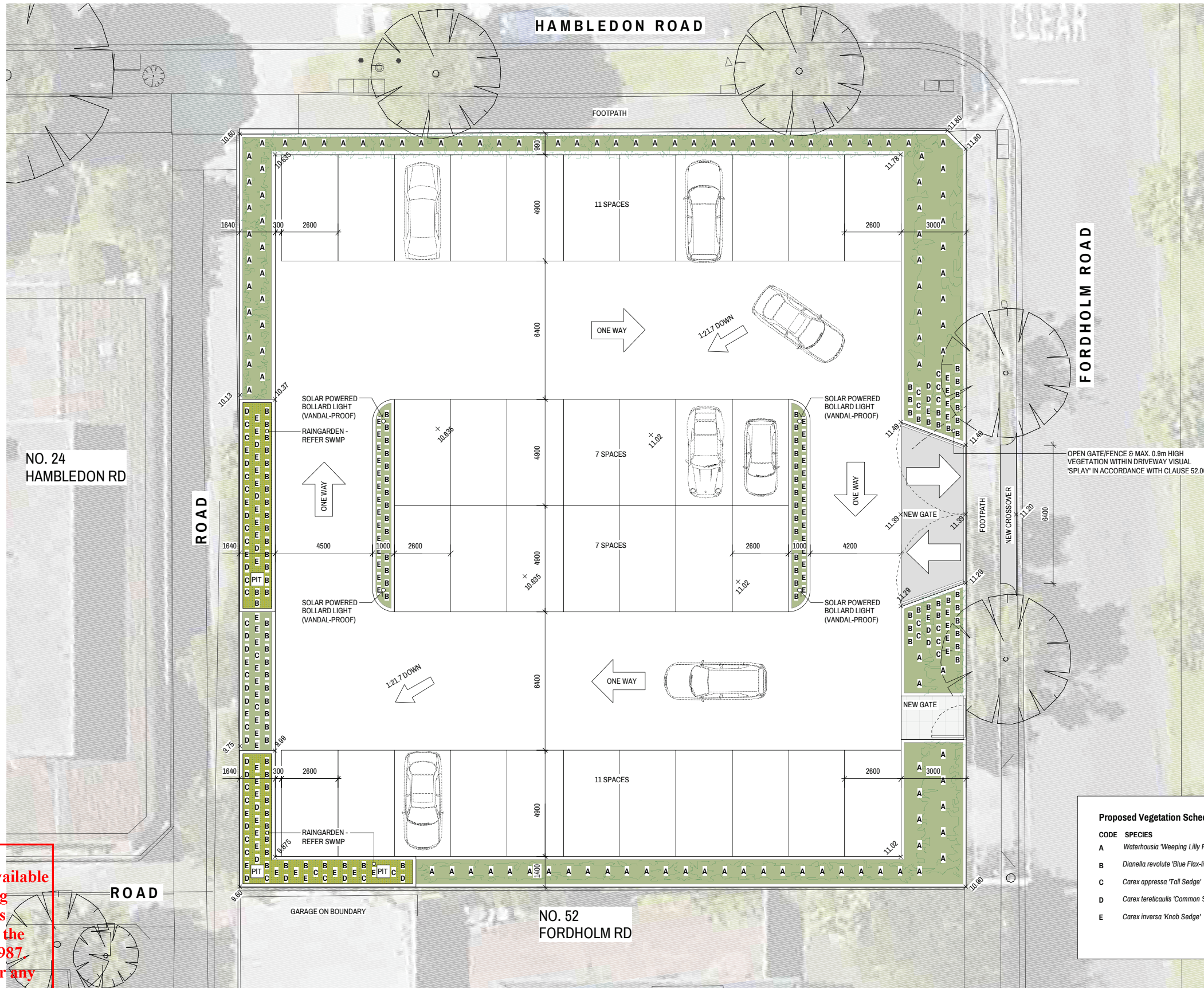

A Waterhousia 'Weeping Lilly Pilly'



B Dianella revolute 'Blue Flax-lily'



C Carex appressa 'Tall Sedge'



D Carex tereticaulis 'Common Sedge'



E Carex inversa 'Knob Sedge'

Proposed Vegetation Schedule:

CODE	SPECIES	SIZE*	NOTES
A	Waterhousia 'Weeping Lilly Pilly'	2.0-3.0m/0.4m	-
B	Dianella revolute 'Blue Flax-lily'	0.8m/0.4m	-
C	Carex appressa 'Tall Sedge'	0.5-1.2m/0.4m	-
D	Carex tereticaulis 'Common Sedge'	0.7-1.2m/0.3m	-
E	Carex inversa 'Knob Sedge'	0.3-0.8m/0.3m	-

*MATURE HEIGHT/PLANTING HEIGHT

This copied document to be made available for the sole purpose of enabling its consideration and review as part of a planning process under the Planning and Environment Act 1987. The document must not be used for any purpose which may breach any copyright.

SITE PLAN - PROPOSED
1:100@A1 / 1:200@A3

PRELIMINARY - NOT FOR CONSTRUCTION



Issue	TOWN PLANNING	Drawing Title	Drawing No.	Rev.
Project	SCOTCH COLLEGE CARPARK	SITE PLAN - PROPOSED	TP03	-
Project No.	05_24			
Drawn/App.	SHJ-	Scale	Date	
Client	SCOTCH COLLEGE Melbourne	1:100@A1 / 1:200@A3	24.06.2024	