



- LEGEND**
- TOP OF BANK
 - TOE OF BANK
 - ROCK RETAINING WALL
 - SLEEPER RETAINING WALL
 - CONCRETE RETAINING WALL
 - JP JUNCTION PIT
 - GP GRATED PIT
 - SV STOP VALVE
 - FH FIRE HYDRANT
 - UP UNCLASSIFIED PIT

- NOTES**
1. THE TITLE BOUNDARIES SHOWN ON THIS PLAN HAVE NOT BEEN DETERMINED BY THIS SURVEY. THE LOCATION OF THOSE BOUNDARIES SHOULD NOT BE RELIED UPON FOR ANY PURPOSE UNLESS THEY ARE VERIFIED BY A TITLE RE-ESTABLISHMENT SURVEY CARRIED OUT UNDER THE DIRECTION OF A LICENSED SURVEYOR.
 2. THE LOCATION OF SURFACE PITS, VALVE COVERS, ETC. SHOWN HEREON HAVE BEEN DETERMINED BY THIS SURVEY.
 3. PRIOR TO ANY DEMOLITION, EXCAVATION OR CONSTRUCTION ON THE SITE THE RELEVANT AUTHORITY SHOULD BE CONTACTED TO ASCERTAIN THE POSSIBLE LOCATIONS OF FURTHER SERVICES AND DETAILED LOCATIONS OF ALL SERVICES.
 4. LEVELS SHOWN THUS m ARE IN METRES TO THE AUSTRALIAN HEIGHT DATUM.
 5. DATUM FOR LEVELS BEING VERNING PM 77 (RL 112.5494HD).
 6. CONTOUR VERTICAL INTERVAL 0.20 METRES.
 7. MILLAR & MERRIGAN PTY. LTD. ACCEPT NO RESPONSIBILITY FOR ANY MANIPULATION OF THE DIGITAL INFORMATION ASSOCIATED WITH THIS PLAN BY OTHERS.

ADVERTISED PLAN

ALLISON CRESCENT

Initials	Date	Initials	Date
Surveyed	TCMF 03.05.2017	Drafted	SF 11.07.2023
Additional Survey	TC/SF 11.06.2019	Checked	DT 13.07.2023
Additional Survey	TC/SF 06.04.2021		
Additional Survey	SF 01.07.2021		
Additional Survey	JH 03.02.2022		
Additional Survey	SF 10.07.2023		

Millar | Merrigan

Land Development Consultants

Civil Engineering
Land Surveying
Landscape Architecture
Project Management
Town Planning
Urban Design

Millar & Merrigan Pty Ltd ACN 005 541 668
 Metro: 2120 Merindale Drive, Clayton 3136
 Regional: 156 Commercial Road, Morwell 3840
 Mail: PO Box 247 Clayton, Victoria 3136
 M (03) 8720 9500 R (03) 5134 8611
 www.millarmerrigan.com.au
 survey@millarmerrigan.com.au

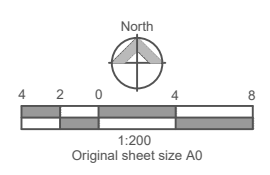

FEATURE & LEVEL PLAN
MOUNT LILYDALE COLLEGE

120 ANDERSON STREET, LILYDALE 3140
YARRA RANGES COUNCIL

12316M1
VERSION 9
SHEET 1 OF 3

FINAL PLAN

ADVERTISED PLAN

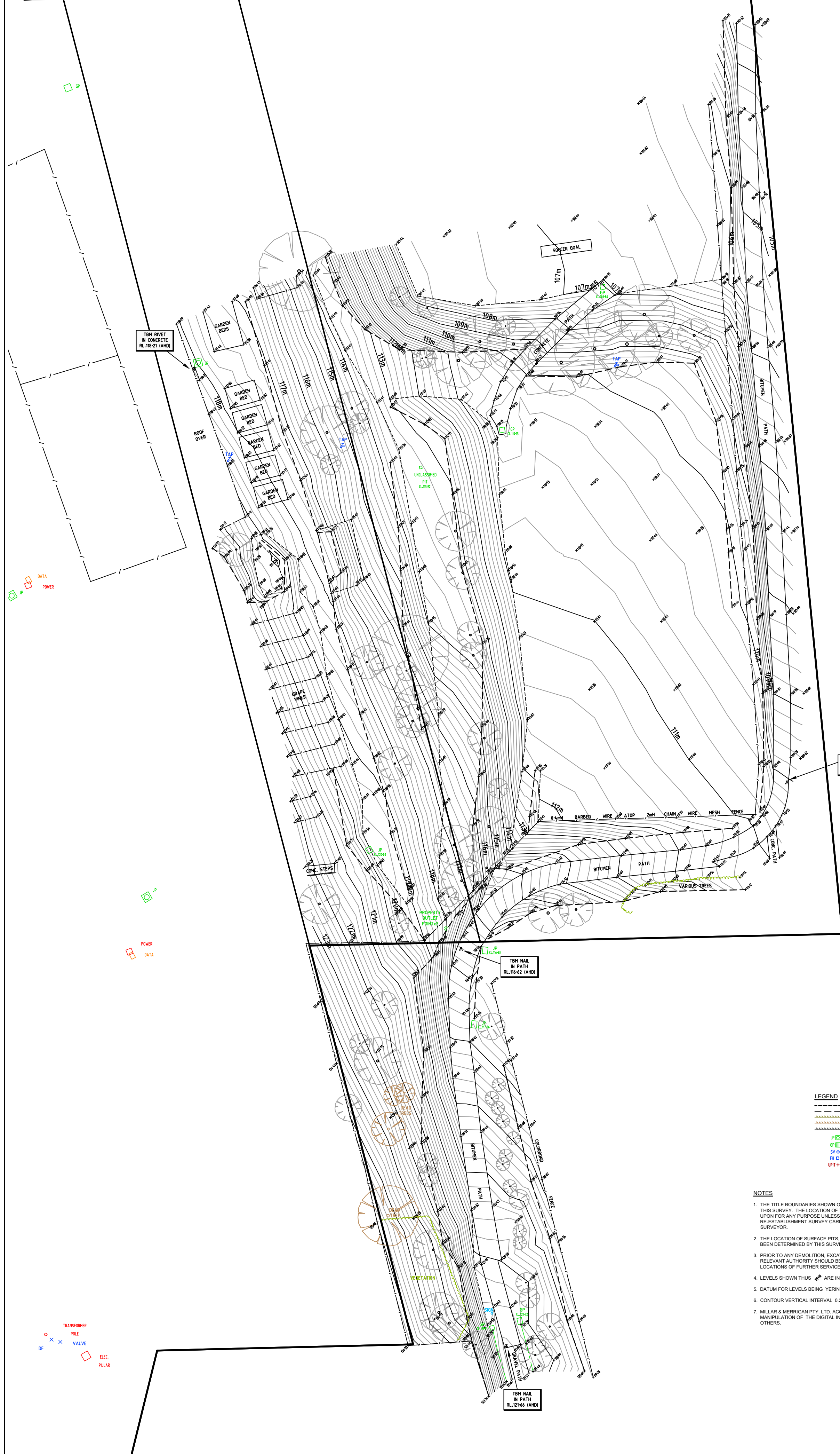

LEGEND

- TOP OF BANK
- - - TOE OF BANK
- ROCK RETAINING WALL
- SLEEPER RETAINING WALL
- CONCRETE RETAINING WALL
- ⊕ JUNCTION PIT
- ⊕ GRATED PIT
- SV STOP VALVE
- FH FIRE HYDRANT
- UPIT UNCLASSIFIED PIT

- NOTES**
1. THE TITLE BOUNDARIES SHOWN ON THIS PLAN HAVE NOT BEEN DETERMINED BY THIS SURVEY. THE LOCATION OF THOSE BOUNDARIES SHOULD NOT BE RELIED UPON FOR ANY PURPOSE UNLESS THEY ARE VERIFIED BY A TITLE RE-ESTABLISHMENT SURVEY CARRIED OUT UNDER THE DIRECTION OF A LICENSED SURVEYOR.
 2. THE LOCATION OF SURFACE PITS, VALVE COVERS, ETC. SHOWN HEREON HAVE BEEN DETERMINED BY THIS SURVEY.
 3. PRIOR TO ANY DEMOLITION, EXCAVATION OR CONSTRUCTION ON THE SITE THE RELEVANT AUTHORITY SHOULD BE CONTACTED TO ASCERTAIN THE POSSIBLE LOCATIONS OF FURTHER SERVICES AND DETAILED LOCATIONS OF ALL SERVICES.
 4. LEVELS SHOWN THUS ⊕ ARE IN METRES TO THE AUSTRALIAN HEIGHT DATUM.
 5. DATUM FOR LEVELS BEING YERING PM 77 (RL.112.549AHD).
 6. CONTOUR VERTICAL INTERVAL 0.20 METRES.
 7. MILLAR & MERRIGAN PTY. LTD. ACCEPTS NO RESPONSIBILITY FOR ANY MANIPULATION OF THE DIGITAL INFORMATION ASSOCIATED WITH THIS PLAN BY OTHERS.

FINAL PLAN

Initials	Date	Initials	Date
Surveyed	TCAF 03.05.2017	Drafted	SF 11.07.2023
Additional Survey	TCSF 11.06.2019	Checked	DT 13.07.2023
Additional Survey	TCSF 06.04.2021		
Additional Survey	SF 01.07.2021		
Additional Survey	JH 03.02.2022		
Additional Survey	SF 16.07.2023		

Millar | Merrigan
 Land Development Consultants
 Civil Engineering
 Land Surveying
 Landscape Architecture
 Project Management
 Town Planning
 Urban Design
 54 GILBERT ST. SUITE 101/103
 MILDURA VIC 3216
 Millar & Merrigan Pty Ltd ACN 005 541 668
 Metro: 2128 Merrindale Drive, Croydon 3136
 Regional: 156 Commercial Road, Monwell 3840
 Mail: PO Box 247 Croydon, Victoria 3136
 M(03) 8720 9500 R(03) 5134 8611
 www.millarmerrigan.com.au
 survey@millarmerrigan.com.au

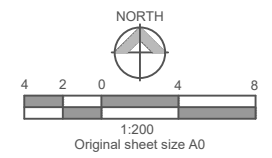

ADVERTISED PLAN

NELSON ROAD

ANDERSON STREET

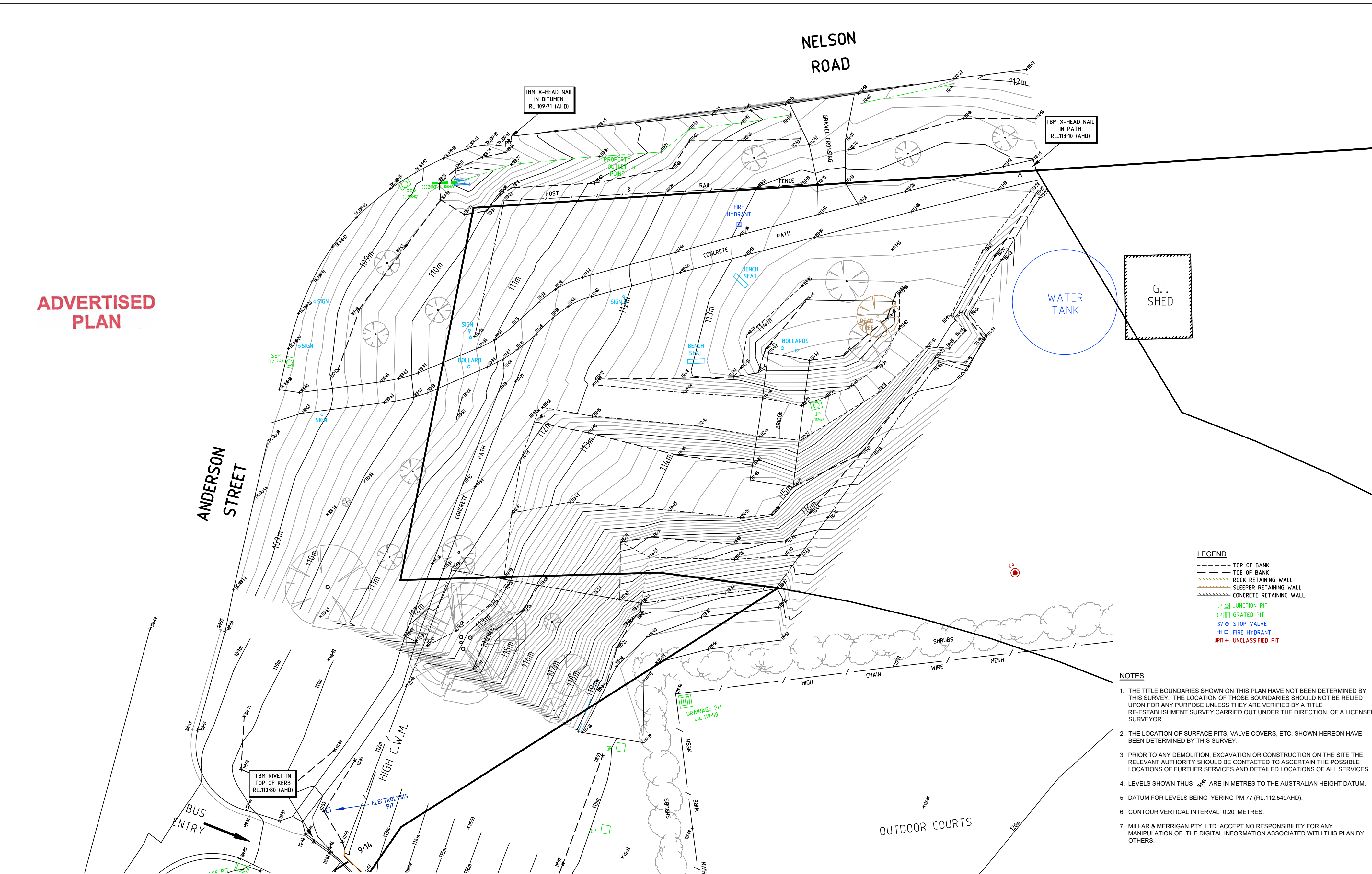

LEGEND

- TOP OF BANK
- TOE OF BANK
- ROCK RETAINING WALL
- SLEEPER RETAINING WALL
- CONCRETE RETAINING WALL
- JP [Symbol] JUNCTION PIT
- GP [Symbol] GRATED PIT
- SV [Symbol] STOP VALVE
- FH [Symbol] FIRE HYDRANT
- UPIT+ [Symbol] UNCLASSIFIED PIT

NOTES

1. THE TITLE BOUNDARIES SHOWN ON THIS PLAN HAVE NOT BEEN DETERMINED BY THIS SURVEY. THE LOCATION OF THOSE BOUNDARIES SHOULD NOT BE RELIED UPON FOR ANY PURPOSE UNLESS THEY ARE VERIFIED BY A TITLE RE-ESTABLISHMENT SURVEY CARRIED OUT UNDER THE DIRECTION OF A LICENSED SURVEYOR.
2. THE LOCATION OF SURFACE PITS, VALVE COVERS, ETC. SHOWN HEREON HAVE BEEN DETERMINED BY THIS SURVEY.
3. PRIOR TO ANY DEMOLITION, EXCAVATION OR CONSTRUCTION ON THE SITE THE RELEVANT AUTHORITY SHOULD BE CONTACTED TO ASCERTAIN THE POSSIBLE LOCATIONS OF FURTHER SERVICES AND DETAILED LOCATIONS OF ALL SERVICES.
4. LEVELS SHOWN THUS [Symbol] ARE IN METRES TO THE AUSTRALIAN HEIGHT DATUM.
5. DATUM FOR LEVELS BEING YERING PM 77 (RL.112.549AHD).
6. CONTOUR VERTICAL INTERVAL 0.20 METRES.
7. MILLAR & MERRIGAN PTY. LTD. ACCEPTS NO RESPONSIBILITY FOR ANY MANIPULATION OF THE DIGITAL INFORMATION ASSOCIATED WITH THIS PLAN BY OTHERS.

Millar & Merrigan authorize the use of this drawing only for the purpose described by the status stamp shown below. This drawing should be read in conjunction with all relevant contracts, specifications, reports & drawings.
© Millar & Merrigan Pty. Ltd.

	Initials	Date	Initials	Date	
Surveyed	TC/MF	03.05.2017	Drafted	SF	11.07.2023
Additional Survey	TC/SF	11.06.2019	Checked	DT	13.07.2023
Additional Survey	TC/SF	06.04.2021			
Additional Survey	SF	01.07.2021			
Additional Survey	JH	03.02.2022			
Additional Survey	SF	10.07.2023			

Millar | Merrigan

Land Development Consultants

Civil Engineering
Land Surveying
Landscape Architecture
Project Management
Town Planning
Urban Design
SIAI GLOBAL Quality ISO 9001

Millar & Merrigan Pty Ltd ACN 005 541 668
Metro 2/126 Merrindale Drive, Croydon 3136
Regional 156 Commercial Road, Morwell 3840
Mail PO Box 247 Croydon, Victoria 3136
M(03) 8720 9500 R(03) 5134 8611
www.millarmerrigan.com.au
survey@millarmerrigan.com.au

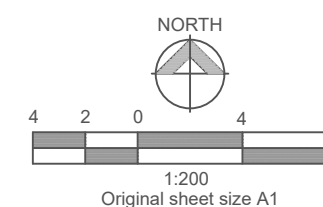

FEATURE & LEVEL PLAN
MOUNT LILYDALE COLLEGE

120 ANDERSON STREET, LILYDALE 3140
YARRA RANGES COUNCIL

12316M1

VERSION 9
SHEET 3 OF 3

FINAL PLAN