

© State of Victoria. This publication is copyright. No part may be reproduced by any process except in accordance with the provisions of the Copyright Act 1968 (Cth) and for the purposes of Section 32 of the Sale of Land Act 1962 or pursuant to a written agreement. The information is only valid at the time and in the form obtained from the LANDATA® System. None of the State of Victoria, LANDATA®, Secure Electronic Registries Victoria Pty Ltd (ABN 86 627 986 396) as trustee for the Secure Electronic Registries Victoria Trust (ABN 83 206 746 897) accept responsibility for any subsequent release, publication or reproduction of the information.

LP64732

EDITION 1

APPROVED 12/6/64.

Ref. 1679

M.

PLAN OF SUBDIVISION OF: CROWN ALLOTMENT 19 PARISH OF WARATAH SCALE CHAINS	APPROPRIATIONS
	BROWN WAY AND DRAINAGE

COLOUR CODE
R-1 = BROWN

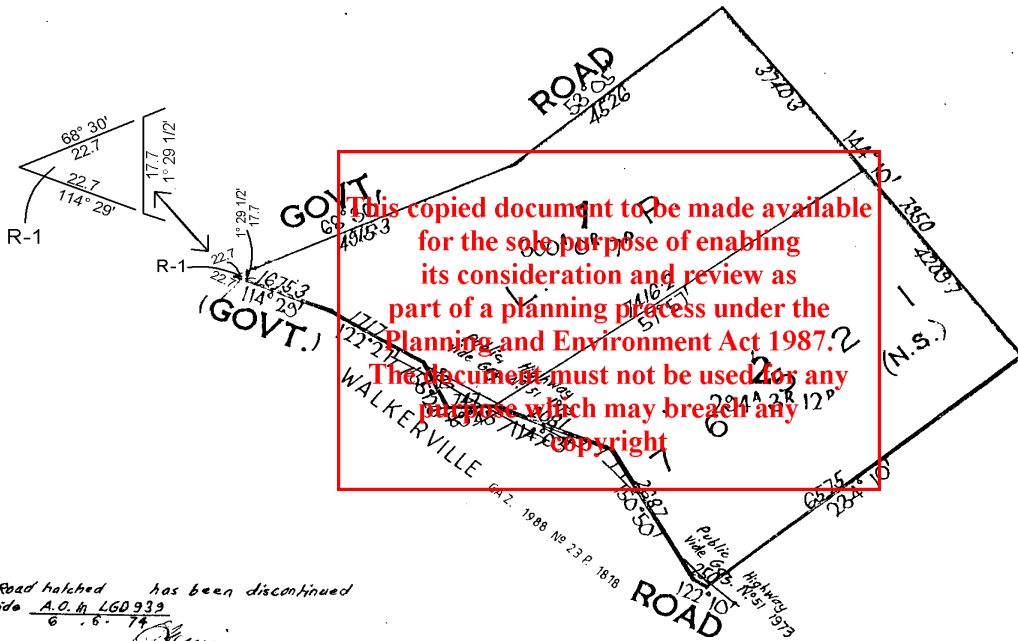

Road hatched has been discontinued
vide A.O. in LGD 932
of 1.6.74

Assistant Registrar of Titles

CONSENT OF COUNCIL	SURVEYOR'S CERTIFICATION
[Signature] S-5-61	I certify that this plan has been made by K.A. Reed and Associates and accords with title and is mathematically correct. K.A. Reed Licensed Surveyor. 29 th day of APRIL 1964

FOR APPROPRIATIONS, ETC,
SEE BACK HEREOF

**ADVERTISED
PLAN**

Copyright State of Victoria. No part of this publication may be reproduced except as permitted by the Copyright Act 1968 (Cth), to comply with a statutory requirement or pursuant to a written agreement. The information is only valid at the time and in the form obtained from the LANDATA REGD TM System. None of the State of Victoria, its agents or contractors, accepts responsibility for any subsequent publication or reproduction of the information.

The Victorian Government acknowledges the Traditional Owners of Victoria and pays respects to their ongoing connection to their Country, History and Culture. The Victorian Government extends this respect to their Elders, past, present and emerging.

REGISTER SEARCH STATEMENT (Title Search) Transfer of Land Act 1958

VOLUME 06707 FOLIO 321

Security no : 124119294688P

Produced 24/10/2024 01:07 PM

CROWN GRANT

LAND DESCRIPTION

Road R1 on Plan of Subdivision 064732.
Created by instrument LP064732 02/02/1944

REGISTERED PROPRIETOR

Estate Fee Simple
Sole Proprietor

CLIVE RICHARD GOLDSWORTHY of FLAT 8/80 CAMPBELL ROAD HAWTHORN
B750448 13/09/1963

ENCUMBRANCES, CAVEATS AND NOTICES

Any crown grant reservations exceptions conditions limitations and powers noted on the plan or imaged folio set out under DIAGRAM LOCATION below. For details of any other encumbrances see the plan or imaged folio set out under DIAGRAM LOCATION below.

Any encumbrances created by Section 98 Transfer of Land Act 1958 or Section 24 Subdivision Act 1988 and any other encumbrances shown or entered on the plan or imaged folio set out under DIAGRAM LOCATION below.

DIAGRAM LOCATION

SEE LP064732 FOR FURTHER DETAILS AND BOUNDARIES

ACTIVITY IN THE LAST 125 DAYS

NIL

DOCUMENT END

Delivered from the LANDATA® System by InfoTrack Pty Ltd.

The information supplied by InfoTrack (Major Accounts) has been obtained from InfoTrack Pty Limited by agreement between them. The information supplied has been obtained by InfoTrack Pty Limited who is licensed by the State of Victoria to provide this information via LANDATA® System.

This copied document to be made available for the sole purpose of enabling its consideration and review as part of a planning process under the Planning and Environment Act 1987. The document must not be used for any purpose which may breach any copyright

**ADVERTISED
PLAN**

© State of Victoria. This publication is copyright. No part may be reproduced by any process except in accordance with the provisions of the Copyright Act 1968 (Cth) and for the purposes of Section 32 of the Sale of Land Act 1962 or pursuant to a written agreement. The information is only valid at the time and in the form obtained from the LANDATA® System. None of the State of Victoria, LANDATA®, Secure Electronic Registries Victoria Pty Ltd (ABN 86 627 986 396) as trustee for the Secure Electronic Registries Victoria Trust (ABN 83 206 746 897) accept responsibility for any subsequent release, publication or reproduction of the information.

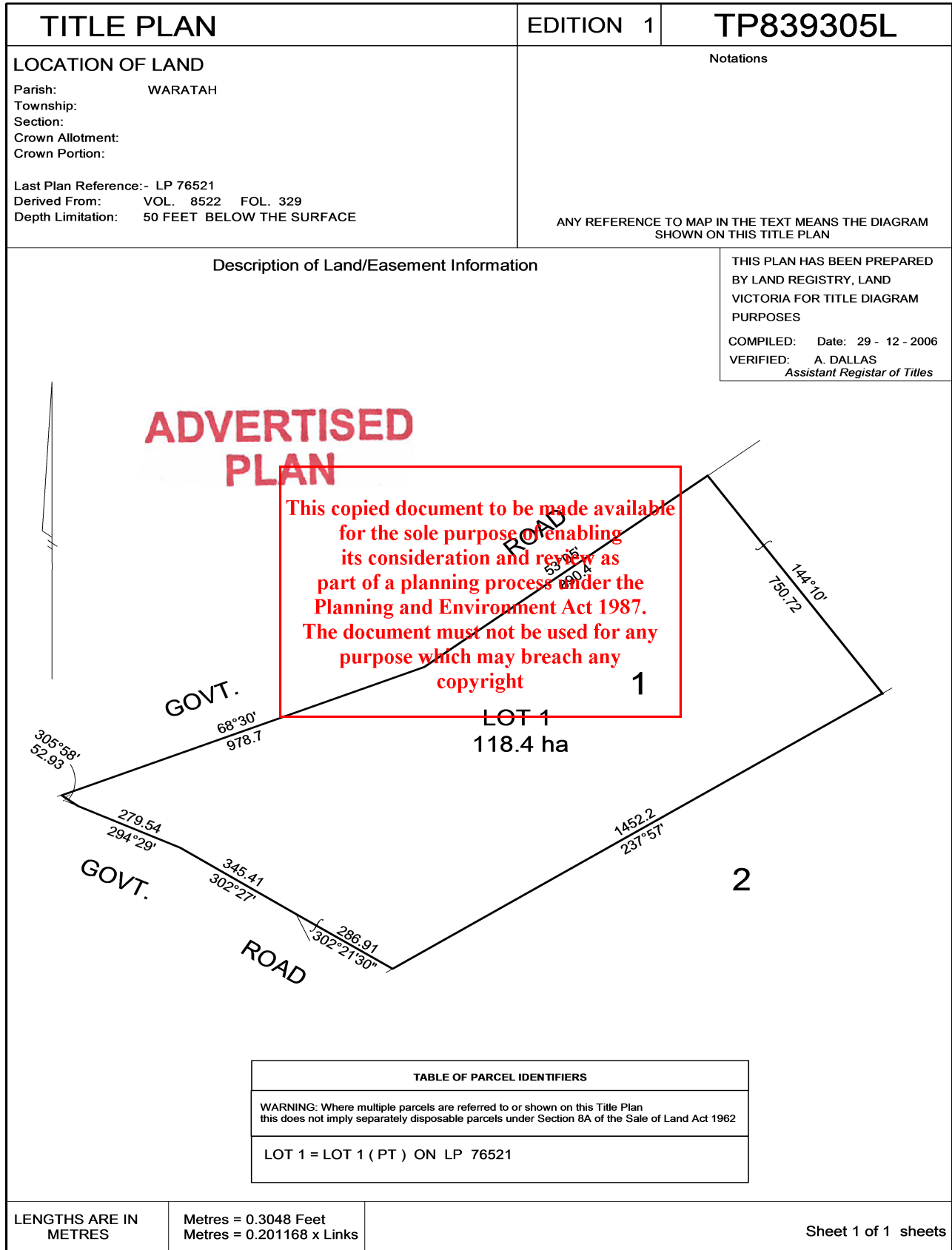

Copyright State of Victoria. No part of this publication may be reproduced except as permitted by the Copyright Act 1968 (Cth), to comply with a statutory requirement or pursuant to a written agreement. The information is only valid at the time and in the form obtained from the LANDATA REGD TM System. None of the State of Victoria, its agents or contractors, accepts responsibility for any subsequent publication or reproduction of the information.

The Victorian Government acknowledges the Traditional Owners of Victoria and pays respects to their ongoing connection to their Country, History and Culture. The Victorian Government extends this respect to their Elders, past, present and emerging.

REGISTER SEARCH STATEMENT (Title Search) Transfer of Land Act 1958

VOLUME 08522 FOLIO 329

Security no : 124119294456R

Produced 24/10/2024 01:02 PM

LAND DESCRIPTION

Lot 1 on Title Plan 839305L (formerly known as part of Lot 1 on Plan of Subdivision 076521).

PARENT TITLE Volume 06707 Folio 321

Created by instrument B999792 04/08/1964

REGISTERED PROPRIETOR

Estate Fee Simple

Sole Proprietor

TARWIN PARK PTY LTD of LEVEL 2 32 KAY STREET TRARALGON VIC 3844

AF146443J 21/06/2007

ENCUMBRANCES, CAVEATS AND NOTICES

CAVEAT AF868863H 27/05/2008

Caveator

BALD HILLS WIND FARM PTY LTD

Grounds of Claim

LEASE WITH THE FOLLOWING PARTIES AND DATE.

Parties

THE REGISTERED PROPRIETOR(S)

Date

04/08/2005

Estate or Interest

LEASEHOLD ESTATE

Prohibition

UNLESS AN INSTRUMENT IS EXPRESSED TO BE SUBJECT TO MY/OUR CLAIM

Lodged by

HERBERT SMITH FREEHILLS (68)

Notices to

BALD HILLS WIND FARM PTY LTD of LEVEL 2 765 GLENFERRIE ROAD HAWTHORN VIC

3122

AMENDMENT OF ADDRESS ON CAVEAT AF892156X 06/06/2008

Any encumbrances created by Section 98 Transfer of Land Act 1958 or Section 24 Subdivision Act 1988 and any other encumbrances shown or entered on the plan set out under DIAGRAM LOCATION below.

DIAGRAM LOCATION

SEE TP839305L FOR FURTHER DETAILS AND BOUNDARIES

ACTIVITY IN THE LAST 125 DAYS

NIL

DOCUMENT END

Delivered from the LANDATA® System by InfoTrack Pty Ltd.

The information supplied by InfoTrack (Major Accounts) has been obtained from InfoTrack Pty Limited by agreement between them. The information supplied has been obtained by InfoTrack Pty Limited who is licensed by the State of Victoria to provide this information via LANDATA® System.

**ADVERTISED
PLAN**

This copied document to be made available for the sole purpose of enabling its consideration and review as part of a planning process under the Planning and Environment Act 1987. The document must not be used for any purpose which may breach any copyright