

Copyright State of Victoria. No part of this publication may be reproduced except as permitted by the Copyright Act 1968 (Cth), to comply with a statutory requirement or pursuant to a written agreement. The information is only valid at the time and in the form obtained from the LANDATA REGD TM System. None of the State of Victoria, its agents or contractors, accepts responsibility for any subsequent publication or reproduction of the information.

The Victorian Government acknowledges the Traditional Owners of Victoria and pays respects to their ongoing connection to their Country, History and Culture. The Victorian Government extends this respect to their Elders, past, present and emerging.

REGISTER SEARCH STATEMENT (Title Search) Transfer of Land Act 1958

VOLUME 11465 FOLIO 210

Security no : 124119293978L

Produced 24/10/2024 12:51 PM

LAND DESCRIPTION

Lot 6 on Plan of Subdivision 069123.

PARENT TITLES :

Volume 10175 Folio 574 to Volume 10175 Folio 577

Created by instrument AK789467M 17/12/2013

REGISTERED PROPRIETOR

Estate Fee Simple

As to 2289 of a total of 10000 equal undivided shares

Sole Proprietor

SALLY ANN BISSETT of "TARWIN PARK" TARWIN LOWER VIC 3956

AK789467M 17/12/2013

ENCUMBRANCES, CAVEATS AND NOTICES

CAVEAT AF868820C 27/05/2008

Caveator

BALD HILLS WIND FARM PTY LTD

Grounds of Claim

LEASE WITH THE FOLLOWING PARTIES AND DATE.

Parties

THE REGISTERED PROPRIETOR(S), WIND POWER PTY LTD

Date

04/08/2005

Estate or Interest

LEASEHOLD ESTATE

Prohibition

UNLESS AN INSTRUMENT IS EXPRESSED TO BE SUBJECT TO MY/OUR CLAIM

Lodged by

HERBERT SMITH FREEHILLS (68)

Notices to

BALF HILLS WIND FARM PTY LTD of LEVEL 2 765 GLENFERRIE ROAD HAWTHORN VIC

3122

AMENDMENT OF ADDRESS ON CAVEAT AF892148W 06/06/2008

Any encumbrances created by Section 98 Transfer of Land Act 1958 or Section 24 Subdivision Act 1988 and any other encumbrances shown or entered on the plan or imaged folio set out under DIAGRAM LOCATION below.

DIAGRAM LOCATION

SEE LP069123 FOR FURTHER DETAILS AND BOUNDARIES

ACTIVITY IN THE LAST 125 DAYS

NIL

-----END OF REGISTER SEARCH STATEMENT-----

Additional information: (not part of the Register Search Statement)

OTHER TITLES WITH INTERESTS AFFECTING THIS LAND

11465/209, 11465/211, 11465/212

DOCUMENT END

Delivered from the LANDATA® System by InfoTrack Pty Ltd.

This copied document to be made available for the sole purpose of enabling its consideration and review as part of a planning process under the Planning and Environment Act 1987. The document must not be used for any purpose which may breach any copyright

**ADVERTISED
PLAN**



The information supplied by InfoTrack (Major Accounts) has been obtained from InfoTrack Pty Limited by agreement between them. The information supplied has been obtained by InfoTrack Pty Limited who is licensed by the State of Victoria to provide this information via LANDATA® System.

ADVERTISED PLAN

**This copied document to be made available
for the sole purpose of enabling
its consideration and review as
part of a planning process under the
Planning and Environment Act 1987.
The document must not be used for any
purpose which may breach any
copyright**

© State of Victoria. This publication is copyright. No part may be reproduced by any process except in accordance with the provisions of the Copyright Act 1968 (Cth) and for the purposes of Section 32 of the Sale of Land Act 1962 or pursuant to a written agreement. The information is only valid at the time and in the form obtained from the LANDATA® System. None of the State of Victoria, LANDATA®, Secure Electronic Registries Victoria Pty Ltd (ABN 86 627 986 396) as trustee for the Secure Electronic Registries Victoria Trust (ABN 83 206 746 897) accept responsibility for any subsequent release, publication or reproduction of the information.

PLAN OF SUBDIVISION
CROWN ALLOTMENTS 36, 37, 38
PARISH OF TARWIN SOUTH
COUNTY OF BULN BULN

LP69123
EDITION 2
APPROVED 13/4/166

SCALE OF CHAINS



V.8609 F.026

AS TO THE LAND MARKED E-1 - AN EASEMENT FOR POWERLINE PURPOSES IN FAVOUR OF SPI ELECTRICITY PTY LTD CREATED BY AK730535D

DEPTH LIMITATION: 50 FEET

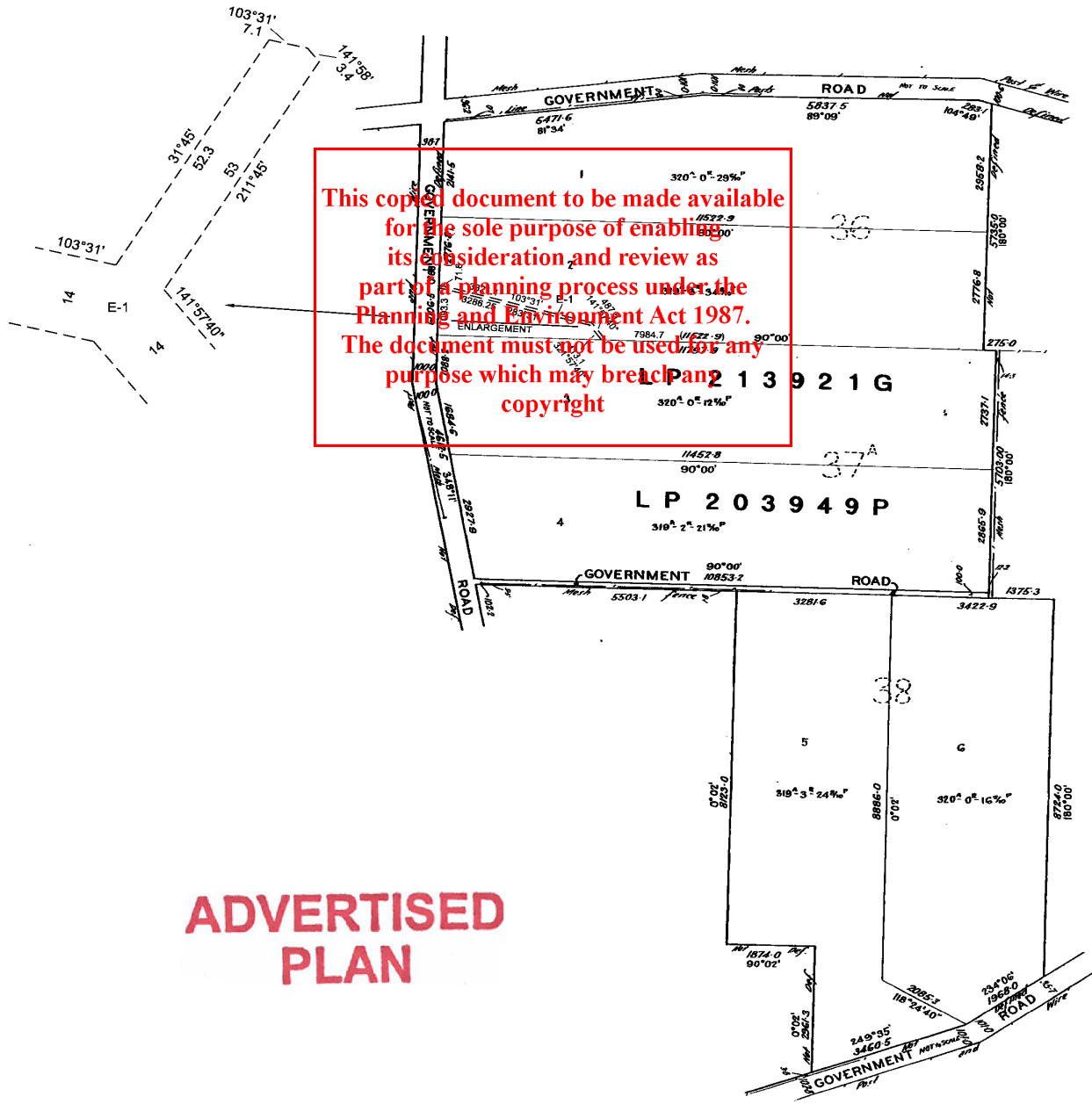

This copied document to be made available for the sole purpose of enabling its consideration and review as part of a planning process under the Planning and Environment Act 1987. The document must not be used for any purpose which may breach copyright

ADVERTISED PLAN

RECORD OF ALL ADDITIONS OR CHANGES TO THE PLAN

PLAN NUMBER
LP69123

**WARNING: THE IMAGE OF THIS DOCUMENT OF THE REGISTER HAS BEEN DIGITALLY AMENDED.
 NO FURTHER AMENDMENTS ARE TO BE MADE TO THE ORIGINAL DOCUMENT OF THE REGISTER.**

AFFECTED LAND/PARCEL	LAND/PARCEL IDENTIFIER CREATED	MODIFICATION	DEALING NUMBER	DATE	EDITION NUMBER	ASSISTANT REGISTRAR OF TITLES
LOT 2	E-1	CREATION OF EASEMENT	AK730535D	21/11/13	2	D.R.

**This copied document to be made available
 for the sole purpose of enabling
 its consideration and review as
 part of a planning process under the
 Planning and Environment Act 1987.
 The document must not be used for any
 purpose which may breach any
 copyright**

**ADVERTISED
PLAN**

Copyright State of Victoria. No part of this publication may be reproduced except as permitted by the Copyright Act 1968 (Cth), to comply with a statutory requirement or pursuant to a written agreement. The information is only valid at the time and in the form obtained from the LANDATA REGD TM System. None of the State of Victoria, its agents or contractors, accepts responsibility for any subsequent publication or reproduction of the information.

The Victorian Government acknowledges the Traditional Owners of Victoria and pays respects to their ongoing connection to their Country, History and Culture. The Victorian Government extends this respect to their Elders, past, present and emerging.

REGISTER SEARCH STATEMENT (Title Search) Transfer of Land Act 1958

VOLUME 11465 FOLIO 209

Security no : 124119293956K

Produced 24/10/2024 12:51 PM

LAND DESCRIPTION

Lot 6 on Plan of Subdivision 069123.

PARENT TITLES :

Volume 10175 Folio 574 to Volume 10175 Folio 577

Created by instrument AK789467M 17/12/2013

REGISTERED PROPRIETOR

Estate Fee Simple

As to 3133 of a total of 10000 equal undivided shares

Sole Proprietor

MELINDA JANE BENNETT of "TARWIN PARK" TARWIN LOWER VIC 3956

AK789467M 17/12/2013

ENCUMBRANCES, CAVEATS AND NOTICES

CAVEAT AF868820C 27/05/2008

Caveator

BALD HILLS WIND FARM PTY LTD

Grounds of Claim

LEASE WITH THE FOLLOWING PARTIES AND DATE.

Parties

THE REGISTERED PROPRIETOR(S), WIND POWER PTY LTD

Date

04/08/2005

Estate or Interest

LEASEHOLD ESTATE

Prohibition

UNLESS AN INSTRUMENT IS EXPRESSED TO BE SUBJECT TO MY/OUR CLAIM

Lodged by

HERBERT SMITH FREEHILLS (68)

Notices to

BALF HILLS WIND FARM PTY LTD of LEVEL 2 765 GLENFERRIE ROAD HAWTHORN VIC

3122

AMENDMENT OF ADDRESS ON CAVEAT AF892148W 06/06/2008

Any encumbrances created by Section 98 Transfer of Land Act 1958 or Section 24 Subdivision Act 1988 and any other encumbrances shown or entered on the plan or imaged folio set out under DIAGRAM LOCATION below.

DIAGRAM LOCATION

SEE LP069123 FOR FURTHER DETAILS AND BOUNDARIES

ACTIVITY IN THE LAST 125 DAYS

NIL

-----END OF REGISTER SEARCH STATEMENT-----

Additional information: (not part of the Register Search Statement)

OTHER TITLES WITH INTERESTS AFFECTING THIS LAND

11465/210, 11465/211, 11465/212

DOCUMENT END

Delivered from the LANDATA® System by InfoTrack Pty Ltd.

This copied document to be made available for the sole purpose of enabling its consideration and review as part of a planning process under the Planning and Environment Act 1987. The document must not be used for any purpose which may breach any copyright

**ADVERTISED
PLAN**

Delivered from the LANDATA® System by InfoTrack Pty Ltd

The information supplied by InfoTrack (Major Accounts) has been obtained from InfoTrack Pty Limited by agreement between them. The information supplied has been obtained by InfoTrack Pty Limited who is licensed by the State of Victoria to provide this information via LANDATA® System.

ADVERTISED PLAN

**This copied document to be made available
for the sole purpose of enabling
its consideration and review as
part of a planning process under the
Planning and Environment Act 1987.
The document must not be used for any
purpose which may breach any
copyright**

Copyright State of Victoria. No part of this publication may be reproduced except as permitted by the Copyright Act 1968 (Cth), to comply with a statutory requirement or pursuant to a written agreement. The information is only valid at the time and in the form obtained from the LANDATA REGD TM System. None of the State of Victoria, its agents or contractors, accepts responsibility for any subsequent publication or reproduction of the information.

The Victorian Government acknowledges the Traditional Owners of Victoria and pays respects to their ongoing connection to their Country, History and Culture. The Victorian Government extends this respect to their Elders, past, present and emerging.

REGISTER SEARCH STATEMENT (Title Search) Transfer of Land Act 1958

VOLUME 11465 FOLIO 211

Security no : 124119294383V

Produced 24/10/2024 01:00 PM

LAND DESCRIPTION

Lot 6 on Plan of Subdivision 069123.

PARENT TITLES :

Volume 10175 Folio 574 to Volume 10175 Folio 577

Created by instrument AK789467M 17/12/2013

REGISTERED PROPRIETOR

Estate Fee Simple

As to 2289 of a total of 10000 equal undivided shares

Sole Proprietor

ANDREW DONALD BISSETT of "TARWIN PARK" TARWIN LOWER VIC 3956

AK789467M 17/12/2013

ENCUMBRANCES, CAVEATS AND NOTICES

CAVEAT AF868820C 27/05/2008

Caveator

BALD HILLS WIND FARM PTY LTD

Grounds of Claim

LEASE WITH THE FOLLOWING PARTIES AND DATE.

Parties

THE REGISTERED PROPRIETOR(S), WIND POWER PTY LTD

Date

04/08/2005

Estate or Interest

LEASEHOLD ESTATE

Prohibition

UNLESS AN INSTRUMENT IS EXPRESSED TO BE SUBJECT TO MY/OUR CLAIM

Lodged by

HERBERT SMITH FREEHILLS (68)

Notices to

BALF HILLS WIND FARM PTY LTD of LEVEL 2 765 GLENFERRIE ROAD HAWTHORN VIC

3122

AMENDMENT OF ADDRESS ON CAVEAT AF892148W 06/06/2008

Any encumbrances created by Section 98 Transfer of Land Act 1958 or Section 24 Subdivision Act 1988 and any other encumbrances shown or entered on the plan or imaged folio set out under DIAGRAM LOCATION below.

DIAGRAM LOCATION

SEE LP069123 FOR FURTHER DETAILS AND BOUNDARIES

ACTIVITY IN THE LAST 125 DAYS

NIL

-----END OF REGISTER SEARCH STATEMENT-----

Additional information: (not part of the Register Search Statement)

OTHER TITLES WITH INTERESTS AFFECTING THIS LAND

11465/209, 11465/210, 11465/212

DOCUMENT END

Delivered from the LANDATA® System by InfoTrack Pty Ltd.

This copied document to be made available for the sole purpose of enabling its consideration and review as part of a planning process under the Planning and Environment Act 1987. The document must not be used for any purpose which may breach any copyright

**ADVERTISED
PLAN**

Delivered from the LANDATA® System by InfoTrack Pty Ltd

The information supplied by InfoTrack (Major Accounts) has been obtained from InfoTrack Pty Limited by agreement between them. The information supplied has been obtained by InfoTrack Pty Limited who is licensed by the State of Victoria to provide this information via LANDATA® System.

ADVERTISED PLAN

**This copied document to be made available
for the sole purpose of enabling
its consideration and review as
part of a planning process under the
Planning and Environment Act 1987.
The document must not be used for any
purpose which may breach any
copyright**

Copyright State of Victoria. No part of this publication may be reproduced except as permitted by the Copyright Act 1968 (Cth), to comply with a statutory requirement or pursuant to a written agreement. The information is only valid at the time and in the form obtained from the LANDATA REGD TM System. None of the State of Victoria, its agents or contractors, accepts responsibility for any subsequent publication or reproduction of the information.

The Victorian Government acknowledges the Traditional Owners of Victoria and pays respects to their ongoing connection to their Country, History and Culture. The Victorian Government extends this respect to their Elders, past, present and emerging.

REGISTER SEARCH STATEMENT (Title Search) Transfer of Land Act 1958

VOLUME 11465 FOLIO 212

Security no : 124119293962D

Produced 24/10/2024 12:51 PM

LAND DESCRIPTION

Lot 6 on Plan of Subdivision 069123.

PARENT TITLES :

Volume 10175 Folio 574 to Volume 10175 Folio 577

Created by instrument AK789467M 17/12/2013

REGISTERED PROPRIETOR

Estate Fee Simple

As to 2289 of a total of 10000 equal undivided shares

Sole Proprietor

LUCY ALEXANDRA PHILLIPS of "TARWIN PARK" TARWIN LOWER VIC 3956

AK789467M 17/12/2013

ENCUMBRANCES, CAVEATS AND NOTICES

CAVEAT AF868820C 27/05/2008

Caveator

BALD HILLS WIND FARM PTY LTD

Grounds of Claim

LEASE WITH THE FOLLOWING PARTIES AND DATE.

Parties

THE REGISTERED PROPRIETOR(S), WIND POWER PTY LTD

Date

04/08/2005

Estate or Interest

LEASEHOLD ESTATE

Prohibition

UNLESS AN INSTRUMENT IS EXPRESSED TO BE SUBJECT TO MY/OUR CLAIM

Lodged by

HERBERT SMITH FREEHILLS (68)

Notices to

BALF HILLS WIND FARM PTY LTD of LEVEL 2 765 GLENFERRIE ROAD HAWTHORN VIC

3122

AMENDMENT OF ADDRESS ON CAVEAT AF892148W 06/06/2008

Any encumbrances created by Section 98 Transfer of Land Act 1958 or Section 24 Subdivision Act 1988 and any other encumbrances shown or entered on the plan or imaged folio set out under DIAGRAM LOCATION below.

DIAGRAM LOCATION

SEE LP069123 FOR FURTHER DETAILS AND BOUNDARIES

ACTIVITY IN THE LAST 125 DAYS

NIL

-----END OF REGISTER SEARCH STATEMENT-----

Additional information: (not part of the Register Search Statement)

OTHER TITLES WITH INTERESTS AFFECTING THIS LAND

11465/209, 11465/210, 11465/211

DOCUMENT END

Delivered from the LANDATA® System by InfoTrack Pty Ltd.

This copied document to be made available for the sole purpose of enabling its consideration and review as part of a planning process under the Planning and Environment Act 1987. The document must not be used for any purpose which may breach any copyright

**ADVERTISED
PLAN**

Delivered from the LANDATA® System by InfoTrack Pty Ltd

The information supplied by InfoTrack (Major Accounts) has been obtained from InfoTrack Pty Limited by agreement between them. The information supplied has been obtained by InfoTrack Pty Limited who is licensed by the State of Victoria to provide this information via LANDATA® System.

ADVERTISED PLAN

**This copied document to be made available
for the sole purpose of enabling
its consideration and review as
part of a planning process under the
Planning and Environment Act 1987.
The document must not be used for any
purpose which may breach any
copyright**