

Copyright State of Victoria. No part of this publication may be reproduced except as permitted by the Copyright Act 1968 (Cth), to comply with a statutory requirement or pursuant to a written agreement. The information is only valid at the time and in the form obtained from the LANDATA REGD TM System. None of the State of Victoria, its agents or contractors, accepts responsibility for any subsequent publication or reproduction of the information.

The Victorian Government acknowledges the Traditional Owners of Victoria and pays respects to their ongoing connection to their Country, History and Culture. The Victorian Government extends this respect to their Elders, past, present and emerging.

REGISTER SEARCH STATEMENT (Title Search) Transfer of Land Act 1958

VOLUME 08618 FOLIO 109

Security no : 124119293864K

Produced 24/10/2024 12:49 PM

LAND DESCRIPTION

Lot 1 on Plan of Subdivision 069123.
PARENT TITLE Volume 08609 Folio 026
Created by instrument LP069123 19/05/1966

REGISTERED PROPRIETOR

Estate Fee Simple
Joint Proprietors
LINDSAY COLIN MARRIOTT
SUSAN ELIZABETH MARRIOTT both of 14 RYRIE ST HEALESVILLE
M676957J 30/01/1987

ENCUMBRANCES, CAVEATS AND NOTICES

MORTGAGE M768677C 30/03/1987
NATIONAL AUSTRALIA BANK LTD

CAVEAT AF868896R 27/05/2008

Caveator
BALD HILLS WIND FARM PTY LTD
Grounds of Claim
LEASE WITH THE FOLLOWING PARTIES AND DATE.

Parties
THE REGISTERED PROPRIETOR(S)
Date
28/08/2007

Estate or Interest
LEASEHOLD ESTATE
Prohibition

UNLESS AN INSTRUMENT IS EXPRESSED TO BE SUBJECT TO MY/OUR CLAIM

Lodged by
HERBERT SMITH FREEHILLS (68)
Notices to

BALD HILLS WIND FARM PTY LTD of LEVEL 2 765 GLENFERRIE ROAD HAWTHORN VIC
3122

AMENDMENT OF ADDRESS ON CAVEAT AF892180B 06/06/2008

Any encumbrances created by Section 98 Transfer of Land Act 1958 or Section 24 Subdivision Act 1988 and any other encumbrances shown or entered on the plan or imaged folio set out under DIAGRAM LOCATION below.

DIAGRAM LOCATION

SEE LP069123 FOR FURTHER DETAILS AND BOUNDARIES

ACTIVITY IN THE LAST 125 DAYS

NIL

-----END OF REGISTER SEARCH STATEMENT-----

Additional information: (not part of the Register Search Statement)

ADMINISTRATIVE NOTICES

NIL

eCT Control 16089P NATIONAL AUSTRALIA BANK LTD

**ADVERTISED
PLAN**

This copied document to be made available for the sole purpose of enabling its consideration and review as part of a planning process under the Planning and Environment Act 1987. The document must not be used for any purpose which may breach any copyright



Effective from 22/10/2016

DOCUMENT END

Delivered from the LANDATA® System by InfoTrack Pty Ltd.

The information supplied by InfoTrack (Major Accounts) has been obtained from InfoTrack Pty Limited by agreement between them. The information supplied has been obtained by InfoTrack Pty Limited who is licensed by the State of Victoria to provide this information via LANDATA® System.

ADVERTISED PLAN

**This copied document to be made available
for the sole purpose of enabling
its consideration and review as
part of a planning process under the
Planning and Environment Act 1987.
The document must not be used for any
purpose which may breach any
copyright**

© State of Victoria. This publication is copyright. No part may be reproduced by any process except in accordance with the provisions of the Copyright Act 1968 (Cth) and for the purposes of Section 32 of the Sale of Land Act 1962 or pursuant to a written agreement. The information is only valid at the time and in the form obtained from the LANDATA® System. None of the State of Victoria, LANDATA®, Secure Electronic Registries Victoria Pty Ltd (ABN 86 627 986 396) as trustee for the Secure Electronic Registries Victoria Trust (ABN 83 206 746 897) accept responsibility for any subsequent release, publication or reproduction of the information.

PLAN OF SUBDIVISION
CROWN ALLOTMENTS 36, 37, 38
PARISH OF TARWIN SOUTH
COUNTY OF BULN BULN

LP69123
EDITION 2
APPROVED 13/4/166

SCALE OF CHAINS



V.8609 F.026

AS TO THE LAND MARKED E-1 - AN EASEMENT FOR POWERLINE PURPOSES IN FAVOUR OF SPI ELECTRICITY PTY LTD CREATED BY AK730535D

DEPTH LIMITATION: 50 FEET

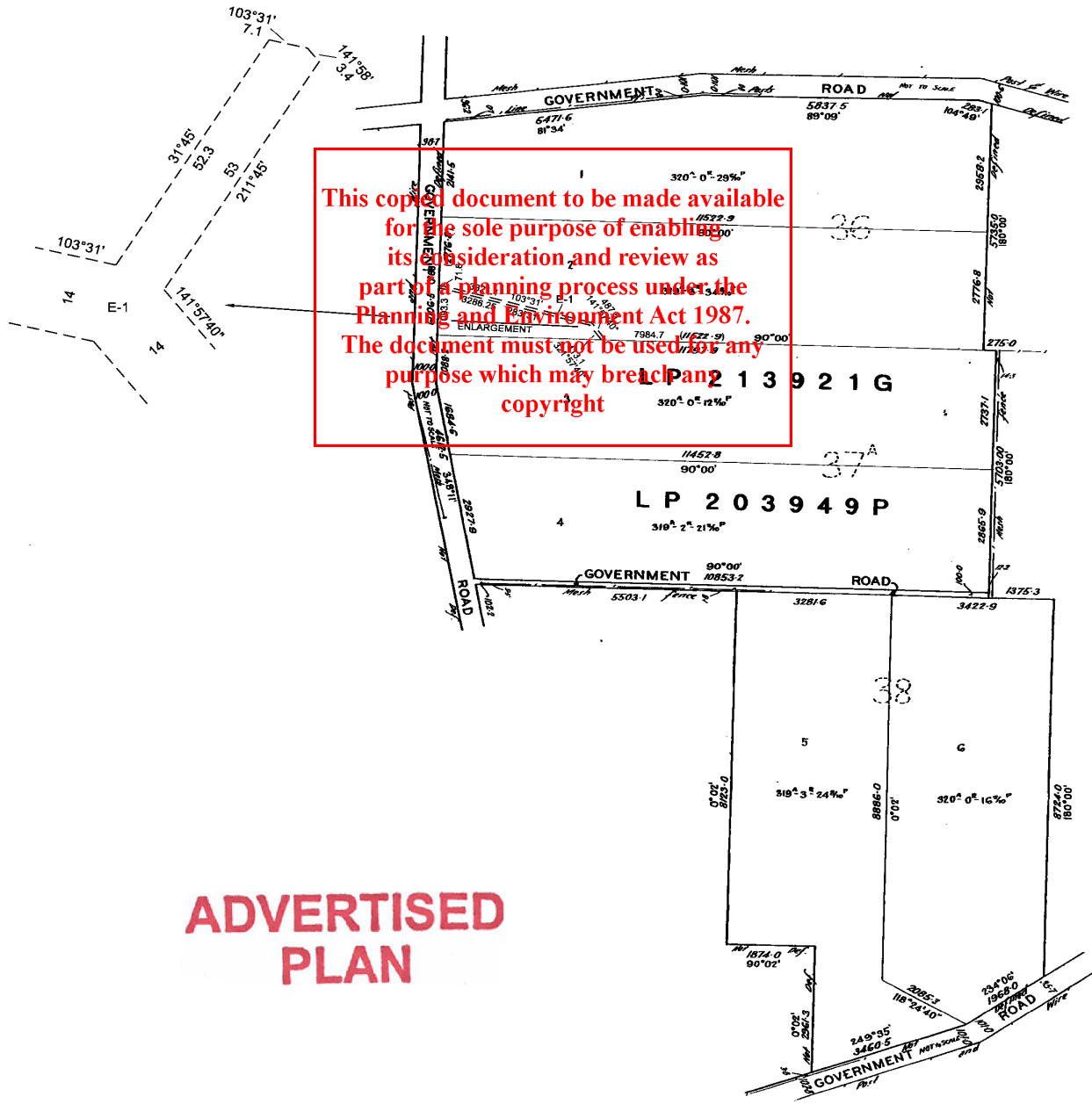

This copied document to be made available for the sole purpose of enabling its consideration and review as part of a planning process under the Planning and Environment Act 1987. The document must not be used for any purpose which may breach copyright

ADVERTISED PLAN

RECORD OF ALL ADDITIONS OR CHANGES TO THE PLAN

PLAN NUMBER

LP69123

**WARNING: THE IMAGE OF THIS DOCUMENT OF THE REGISTER HAS BEEN DIGITALLY AMENDED.
NO FURTHER AMENDMENTS ARE TO BE MADE TO THE ORIGINAL DOCUMENT OF THE REGISTER.**

AFFECTED LAND/PARCEL	LAND/PARCEL IDENTIFIER CREATED	MODIFICATION	DEALING NUMBER	DATE	EDITION NUMBER	ASSISTANT REGISTRAR OF TITLES
LOT 2	E-1	CREATION OF EASEMENT	AK730535D	21/11/13	2	D.R.

This copied document to be made available for the sole purpose of enabling its consideration and review as part of a planning process under the Planning and Environment Act 1987. The document must not be used for any purpose which may breach any copyright

ADVERTISED PLAN

Copyright State of Victoria. No part of this publication may be reproduced except as permitted by the Copyright Act 1968 (Cth), to comply with a statutory requirement or pursuant to a written agreement. The information is only valid at the time and in the form obtained from the LANDATA REGD TM System. None of the State of Victoria, its agents or contractors, accepts responsibility for any subsequent publication or reproduction of the information.

The Victorian Government acknowledges the Traditional Owners of Victoria and pays respects to their ongoing connection to their Country, History and Culture. The Victorian Government extends this respect to their Elders, past, present and emerging.

REGISTER SEARCH STATEMENT (Title Search) Transfer of Land Act 1958

VOLUME 08618 FOLIO 110

Security no : 124119293897Y

Produced 24/10/2024 12:50 PM

LAND DESCRIPTION

Lot 2 on Plan of Subdivision 069123.
PARENT TITLE Volume 08609 Folio 026
Created by instrument LP069123 19/05/1966

REGISTERED PROPRIETOR

Estate Fee Simple
Joint Proprietors
LINDSAY COLIN MARRIOTT
SUSAN ELIZABETH MARRIOTT both of 14 RYRIE ST HEALESVILLE
M676958F 30/01/1987

ENCUMBRANCES, CAVEATS AND NOTICES

MORTGAGE AH663503Q 09/12/2010
NATIONAL AUSTRALIA BANK LTD

CAVEAT AF868896R 27/05/2008

Caveator
BALD HILLS WIND FARM PTY LTD
Grounds of Claim
LEASE WITH THE FOLLOWING PARTIES AND DATE.

Parties
THE REGISTERED PROPRIETOR(S)
Date
28/08/2007

Estate or Interest
LEASEHOLD ESTATE
Prohibition

UNLESS AN INSTRUMENT IS EXPRESSED TO BE SUBJECT TO MY/OUR CLAIM

Lodged by
HERBERT SMITH FREEHILLS (68)
Notices to

BALD HILLS WIND FARM PTY LTD of LEVEL 2 765 GLENFERRIE ROAD HAWTHORN VIC
3122

AMENDMENT OF ADDRESS ON CAVEAT AF892180B 06/06/2008

Any encumbrances created by Section 98 Transfer of Land Act 1958 or Section 24 Subdivision Act 1988 and any other encumbrances shown or entered on the plan or imaged folio set out under DIAGRAM LOCATION below.

DIAGRAM LOCATION

SEE LP069123 FOR FURTHER DETAILS AND BOUNDARIES

ACTIVITY IN THE LAST 125 DAYS

NIL

-----END OF REGISTER SEARCH STATEMENT-----

Additional information: (not part of the Register Search Statement)

ADMINISTRATIVE NOTICES

NIL

eCT Control 16089P NATIONAL AUSTRALIA BANK LTD

**ADVERTISED
PLAN**

This copied document to be made available for the sole purpose of enabling its consideration and review as part of a planning process under the Planning and Environment Act 1987. The document must not be used for any purpose which may breach any copyright

Effective from 23/10/2016

DOCUMENT END

Delivered from the LANDATA® System by InfoTrack Pty Ltd.

The information supplied by InfoTrack (Major Accounts) has been obtained from InfoTrack Pty Limited by agreement between them. The information supplied has been obtained by InfoTrack Pty Limited who is licensed by the State of Victoria to provide this information via LANDATA® System.

ADVERTISED PLAN

**This copied document to be made available
for the sole purpose of enabling
its consideration and review as
part of a planning process under the
Planning and Environment Act 1987.
The document must not be used for any
purpose which may breach any
copyright**