

DRAWING INDEX

LP000	COVER SHEET
LP001	SITE PLAN
LP101	LANDSCAPE PLAN 01 GROUND FLOOR
LP102	LANDSCAPE PLAN 02 LEVEL 1
LP103	LANDSCAPE PLAN 03 LEVEL 4
LP201	ELEVATIONS 01
LP203	DETAILS 01
LP204	DETAILS 02
LP301	MATERIALS PALETTE 01
LP302	MATERIALS PALETTE 02

This copied document to be made available for the sole purpose of enabling its consideration and review as part of a planning process under the Planning and Environment Act 1987. The document must not be used for any purpose which may breach any copyright

ADVERTISED PLAN

PLANT SCHEDULE

CODE	BOTANICAL NAME	COMMON NAME	HEIGHT X WIDTH (M) (AT MATURITY)	INSTALLATION SIZE	QUANTITY
GROUND FLOOR					
AD	<i>Acacia dealbata</i>	Silver Wattle	15 x 5.0	75L	7
DC	<i>Dianella caerulea</i>	Blue Flax Lily	0.4 x 0.3	150MM	163
DV	<i>Dodonaea viscosa</i>	Wedge-leaf Hop-bush	3.0 x 3.0	150MM	23
EL	<i>Eucalyptus leucoxylon ssp. connata</i>	Yellow Gum	10 x 6	75L	7
ER	<i>Eucalyptus radiata</i>	Narrow-leaf Peppermint	10 x 4	75L	1
FN	<i>Ficinia nodosa</i>	Knobby Club Rush	0.5 x 0.15	150MM	60
GO	<i>Goodenia ovata</i>	Hop Goodenia	0.75 x 0.5	150MM	163
LF	<i>Lomandra filiformis</i>	Wattle Mat Rush	0.3 x 0.3	150MM	56
LL	<i>Lomandra longfolia</i>	Basket Grass	0.8 x 0.5	150MM	107
TERRACES					
HV	<i>Hardenbergia violacea</i>	Purple Coral Pea	3.0 CLIMB/ OVERHANG	150MM POT	110
KP	<i>Kennedia prostrata</i>	Running Postman	PROSTRATE x 1.5	150MM POT	110
TT	<i>Themeda triandra</i>	Kangaroo Grass	1.50 x 1.0	150MM POT	110

SITE IMAGE



Landscape Architects

This copied document to be made available for the sole purpose of enabling its consideration and review as part of a planning process under the Planning and Environment Act 1987. The document must not be used for any purpose which may breach any copyright

WEST STREET

ADAM STREET

BARKLY AVENUE

STAWELL STREET

BARKLY AVENUE RESERVE

CITY LINK TOLL ROAD



SITE IMAGE Landscape Architects

Melbourne | Sydney

STORHUB BURNLEY SITE PLAN

ADVERTISED PLAN



CLIENT ARCHITECT SITE IMAGE JOB NUMBER

STORHUB GRAY PUKSAND SM24635

DRAWING NUMBER ISSUE DATE

LP001 B 20.03.2026

Site Image Landscape Architects (VIC) 109/1 Wilson Avenue Brunswick VIC 3056 Australia | T +61 3 9329 4633

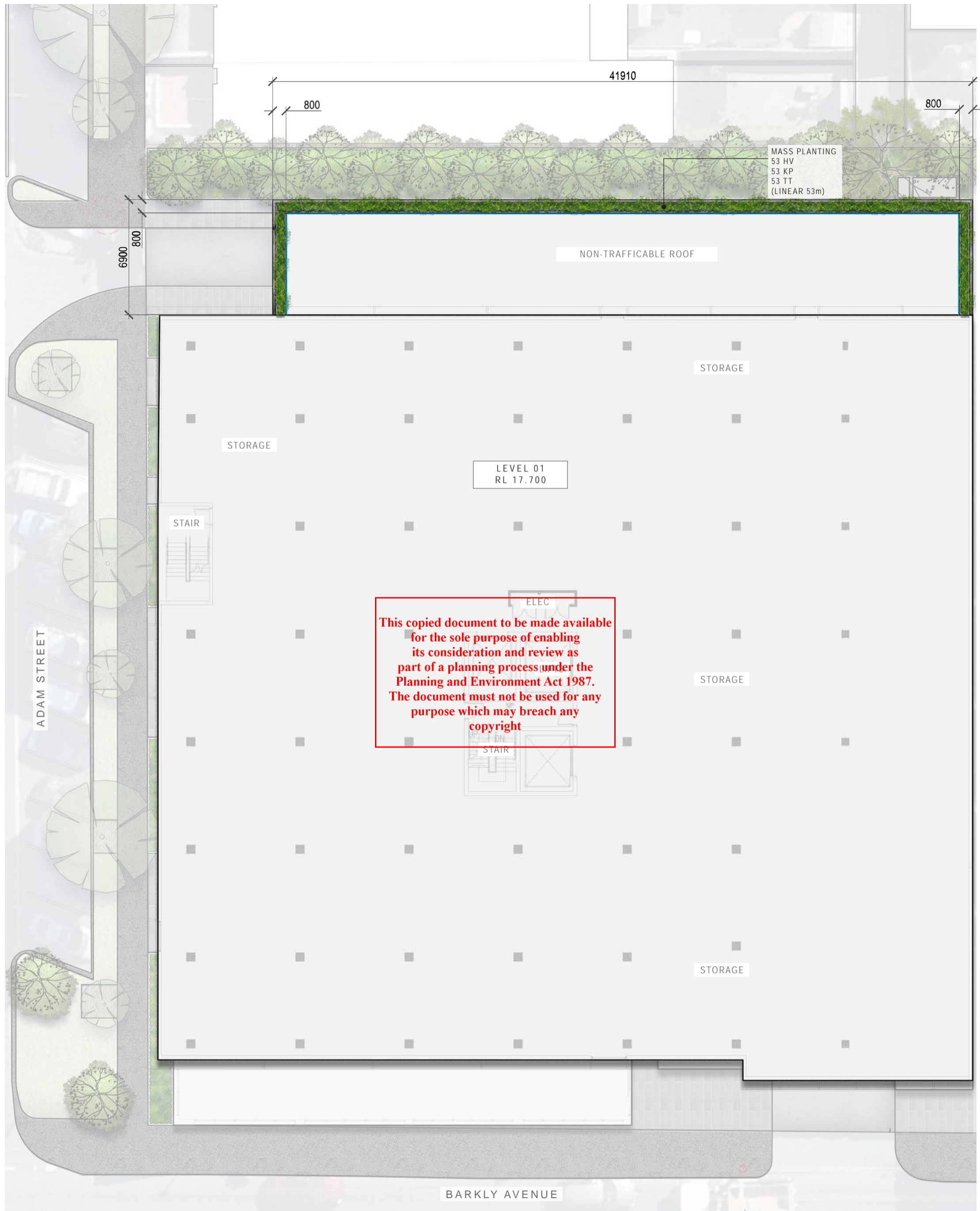

This copied document to be made available for the sole purpose of enabling its consideration and review as part of a planning process under the Planning and Environment Act 1987. The document must not be used for any purpose which may breach any copyright

MASS PLANTING
 53 HV
 53 KP
 53 TT
 (LINEAR 53m)

NON-TRAFFICABLE ROOF

LEVEL 01
 RL 17.700

STORAGE

STORAGE

STAIR

ELEC

STORAGE

UP/DN STAIR

STORAGE

BARKLY AVENUE

ADAM STREET

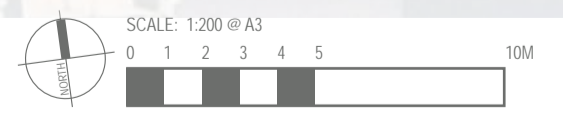

This copied document to be made available for the sole purpose of enabling its consideration and review as part of a planning process under the Planning and Environment Act 1987. The document must not be used for any purpose which may breach any copyright

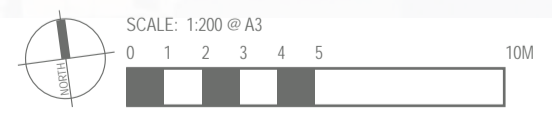

SITE BOUNDARY

SITE BOUNDARY

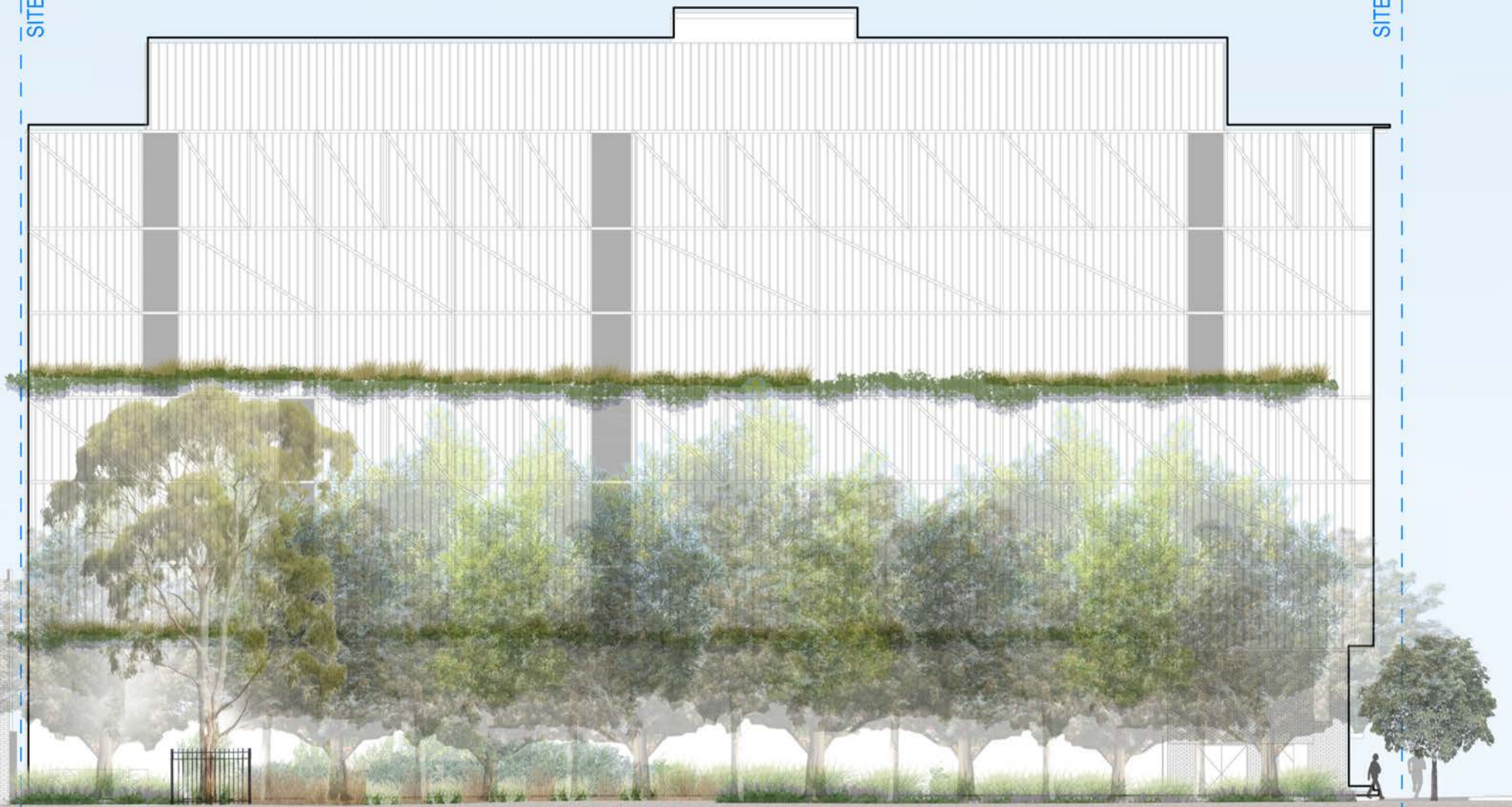

NORTH ELEVATION

SCALE: 1:200 @ A3

ADVERTISED PLAN

This copied document to be made available for the sole purpose of enabling its consideration and review as part of a planning process under the Planning and Environment Act 1987. The document must not be used for any purpose which may breach any copyright



SITE IMAGE
Landscape Architects

Melbourne | Sydney

STORHUB BURNLEY
ELEVATIONS 01

CLIENT	STORHUB	DRAWING NUMBER	LP201
ARCHITECT	GRAY PUKSAND	ISSUE	B
SITE IMAGE JOB NUMBER	SM24635	DATE	20.03.2026

Site Image Landscape Architects (VIC) 109/1 Wilson Avenue Brunswick VIC 3056 Australia | T +61 3 9329 4633

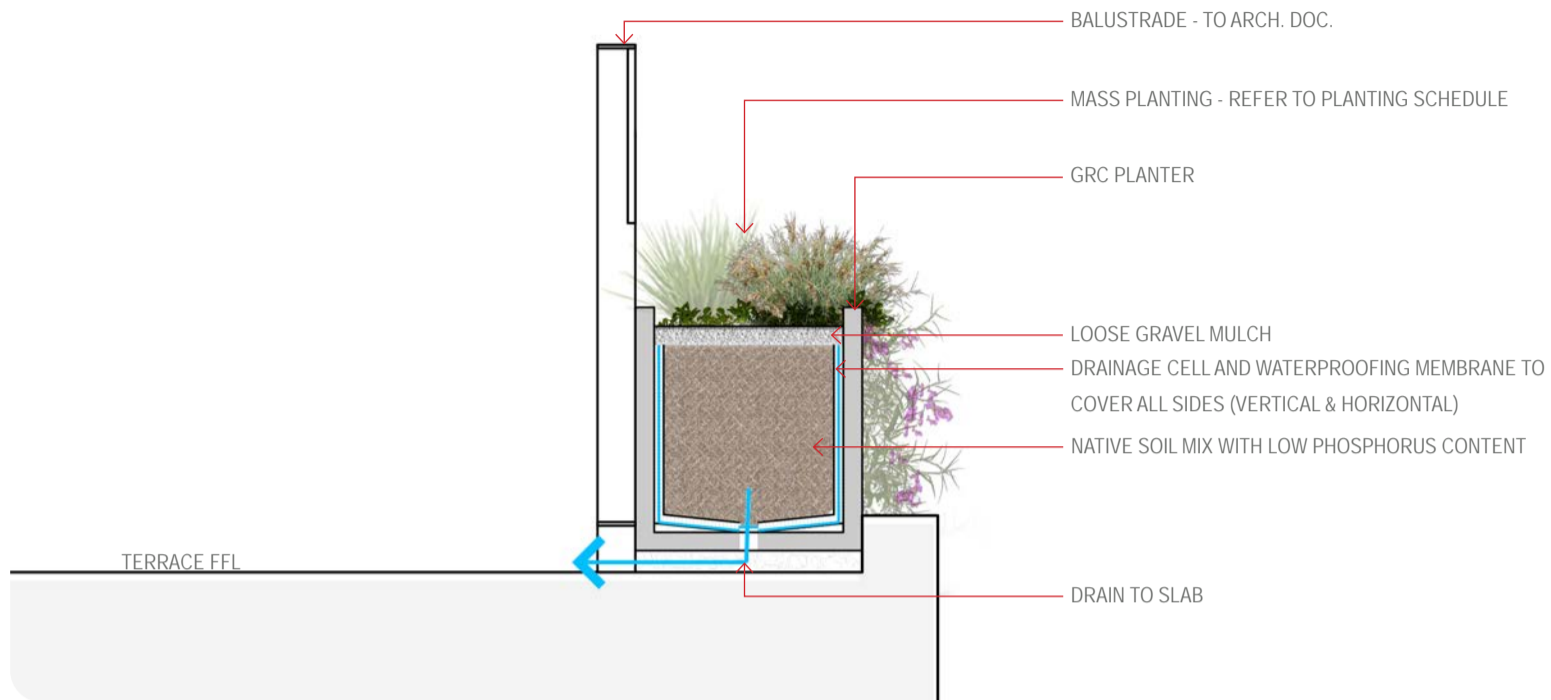

TYPICAL SECTION DETAIL 01
TERRACE PLANTER
SCALE: 1:20 @ A3

ADVERTISED PLAN

This copied document to be made available for the sole purpose of enabling its consideration and review as part of a planning process under the Planning and Environment Act 1987. The document must not be used for any purpose which may breach any copyright



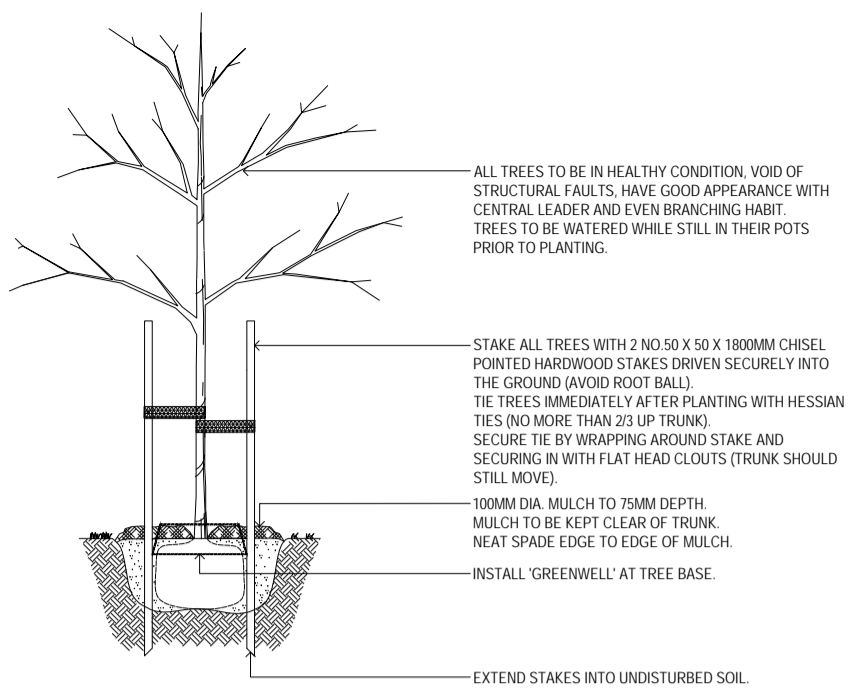

TYPICAL SECTION

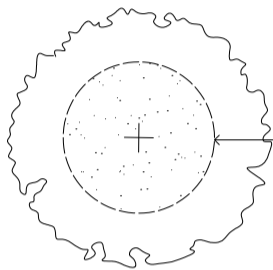

TYPICAL PLAN

NOTE:
WIDTH OF PLANTING HOLE IS 2 TIMES ROOTBALL DIAMETER. PLANTING HOLES SHALL NOT HAVE GLAZED SIDES, ROUGHEN SIDES OF HOLE AS REQUIRED. FLOOD TREE AFTER PLANTING.

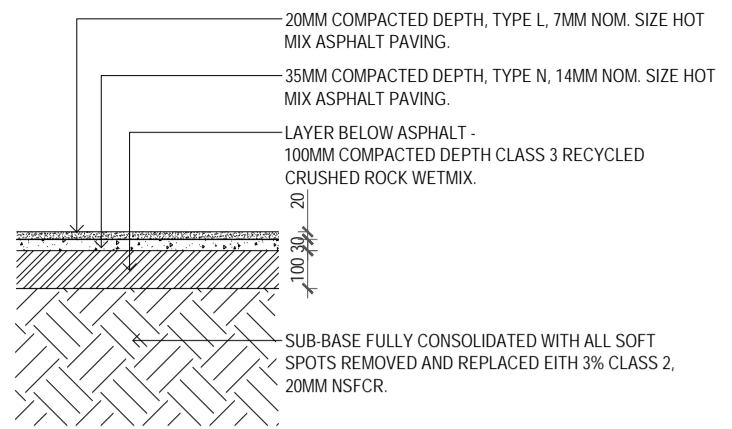

TYPICAL SECTION

NOTE:
CROSS FALLS ON FOOTPATHS SHALL BE BETWEEN 2% AND 5%.

02 ASPHALT - PEDESTRIAN (CITY OF YARRA STANDARD)
202 1:20 @ A3

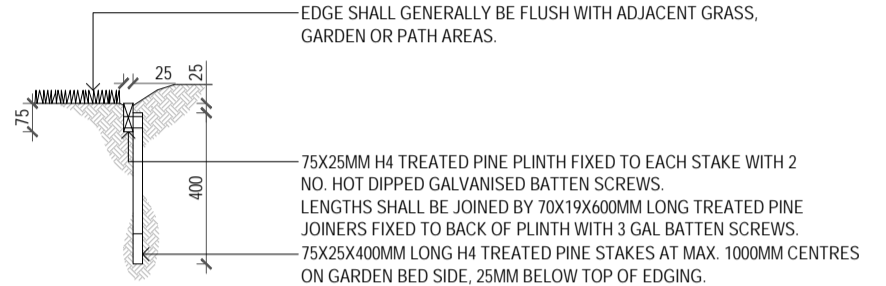

TYPICAL SECTION

NOTE:
WHERE CURVES ARE REQUIRED, SAW-CUT SLOTS TO INSIDE (CURVE) FACE OF EDGE. FOR TIGHTER CURVES, THINNER EDGING MAY BE REQUIRED - CONTACT SUPERINTENDENT FOR INSTRUCTION.

01 TREE PLANTING (CITY OF YARRA STANDARD)
202 1:50 @ A3

03 TIMBER EDGE (CITY OF YARRA STANDARD)
202 1:20 @ A3

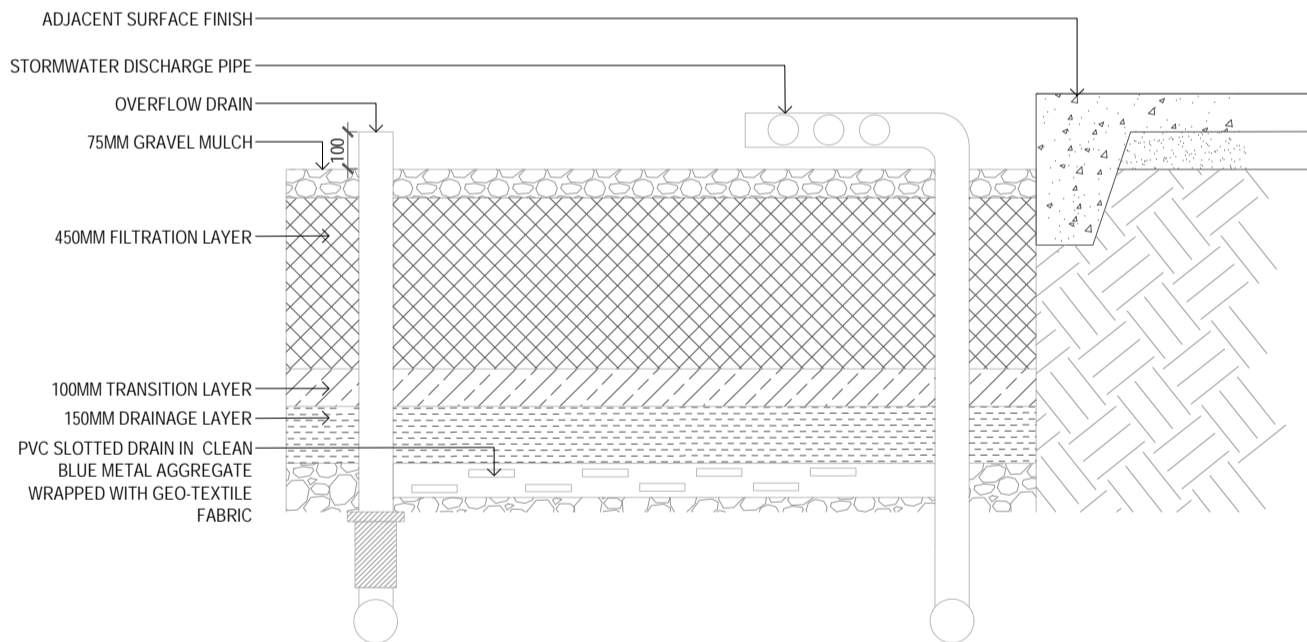

ADVERTISED PLAN

04 RAINGARDEN
202 1:20 @ A3

This copied document to be made available for the sole purpose of enabling its consideration and review as part of a planning process under the Planning and Environment Act 1987. The document must not be used for any purpose which may breach any copyright

PLANT MATERIALS

TREES | GROUND FLOOR



Acacia dealbata (AD)
SILVER WATTLE



Eucalyptus leucoxylon ssp. connata (EL)
YELLOW GUM



Eucalyptus radiata (ER)
NARROW LEAF PEPPERMINT

MASS PLANTING | GROUND FLOOR



Dianella caerulea (DC)
BLUE FLAX LILY



Dodonaea viscosa (DV)
GYMEA LILY



Goodenia ovata (GO)
HOP GOODENIA



Lomandra filiformis (LF)
WATTLE MAT RUSH



Lomandra longifolia (LL)
BASKET GRASS

MASS PLANTING | TERRACES



Hardenbergia violacea (HV)
PURPLE CORAL PEA

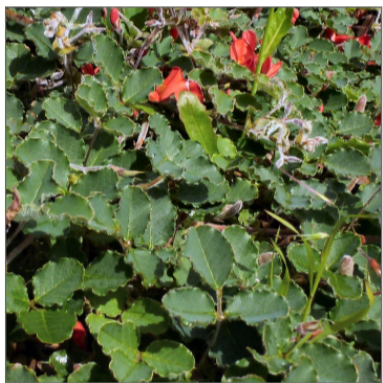

Kennedia prostrata (KP)
RUNNING POSTMAN



Themeda triandra (KP)
KANGAROO GRASS

MASS PLANTING | RAINGARDEN

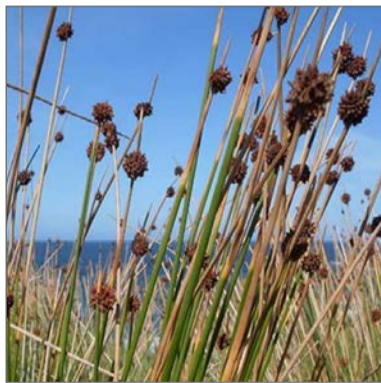

Ficinia nodosa (FN)
KNOBBY CLUB RUSH

**ADVERTISED
PLAN**

This copied document to be made available for the sole purpose of enabling its consideration and review as part of a planning process under the Planning and Environment Act 1987. The document must not be used for any purpose which may breach any copyright



SITE IMAGE
Landscape Architects

Melbourne | Sydney

STORHUB BURNLEY
MATERIALS PALETTE 01

CLIENT	STORHUB	DRAWING NUMBER	LP301
ARCHITECT	GRAY PUKSAND	ISSUE	C
SITE IMAGE JOB NUMBER	SM24635	DATE	20.03.2026

Site Image Landscape Architects (VIC) 109/1 Wilson Avenue Brunswick VIC 3056 Australia | T +61 3 9329 4633

HARDSCAPE MATERIALS

SURFACE FINISHES & FIXTURES



LOOSE GRAVEL MULCH



TIMBER BENCH SEAT



SECURE OPEN PALISADE FENCE



CONCRETE PLANTER



CONCRETE PAVEMENT

NOTE:
PAVING BETWEEN EXISTING FOOTPATH & PROPOSED BUILDING TO BE SLIP RESISTANT.

**ADVERTISED
PLAN**

**This copied document to be made available
for the sole purpose of enabling
its consideration and review as
part of a planning process under the
Planning and Environment Act 1987.
The document must not be used for any
purpose which may breach any
copyright**