

ADVERTISED PLAN

Copyright State of Victoria. No part of this publication may be reproduced except as permitted by the Copyright Act 1968 (Cth), to comply with a statutory requirement or pursuant to a written agreement. The information is only valid at the time and in the form obtained from the LANDATA REGD TM System. None of the State of Victoria, its agents or contractors, accepts responsibility for any subsequent publication or reproduction of the information.

The Victorian Government acknowledges the Traditional Owners of Victoria and pays respects to their ongoing connection to their Country, History and Culture. The Victorian Government extends this respect to their Elders, past, present and emerging.

REGISTER SEARCH STATEMENT (Title Search) Transfer of Land Act 1958

VOLUME 08685 FOLIO 098

Security no : 124131892880B
Produced 05/02/2026 09:08 AM

LAND DESCRIPTION

Crown Allotment 11 Section 99 and Crown Allotment 12 Section 99 City of South Melbourne Parish of Melbourne South.

PARENT TITLES :

Volume 04296 Folio 086 to Volume 04296 Folio 087
Volume 04715 Folio 909 Volume 04970 Folio 824
Created by instrument C814768 28/06/1967

REGISTERED PROPRIETOR

Estate Fee Simple
Sole Proprietor



This copied document to be made available for the sole purpose of enabling its consideration and review as part of a planning process under the Planning and Environment Act 1987. The document must not be used for any purpose which may breach any copyright

ENCUMBRANCES, CAVEATS AND NOTICES

For details of any other encumbrances see the plan or imaged folio set out under DIAGRAM LOCATION below.

DIAGRAM LOCATION

SEE TP422601G FOR FURTHER DETAILS AND BOUNDARIES

ACTIVITY IN THE LAST 125 DAYS

NIL

-----END OF REGISTER SEARCH STATEMENT-----

Additional information: (not part of the Register Search Statement)

ADMINISTRATIVE NOTICES

NIL

eCT Control REGISTRAR OF TITLES
Effective from 26/09/2024

DOCUMENT END

Delivered from the LANDATA® System by InfoTrack Pty Ltd.

The information supplied by InfoTrack (Commercial) has been obtained from InfoTrack Pty Limited by agreement between them. The information supplied has been obtained by InfoTrack Pty Limited who is licensed by the State of Victoria to provide this information via LANDATA® System.

Imaged Document Cover Sheet

The document following this cover sheet is an imaged document supplied by LANDATA®, Secure Electronic Registries Victoria.

Document Type	Plan
Document Identification	TP420624E
Number of Pages (excluding this cover sheet)	1
Document Assembled	17/02/2026 16:02

Copyright and disclaimer notice:

© State of Victoria. This publication is copyright. No part may be reproduced by any process except in accordance with the provisions of the Copyright Act 1968 (Cth) and for the purposes of Section 32 of the Sale of Land Act 1962 or pursuant to a written agreement. The information is only valid at the time and in the form obtained from the LANDATA® System. None of the State of Victoria, LANDATA®, Secure Electronic Registries Victoria Pty Ltd (ABN 86 627 986 396) as trustee for the Secure Electronic Registries Victoria Trust (ABN 83 206 746 897) accept responsibility for any subsequent release, publication or reproduction of the information.

The document is invalid if this cover sheet is removed or altered.

This copied document to be made available for the sole purpose of enabling its consideration and review as part of a planning process under the Planning and Environment Act 1987. The document must not be used for any purpose which may breach any copyright

TITLE PLAN		EDITION 1	TP 420624E
-------------------	--	------------------	-------------------

Location of Land

Parish: CITY OF SOUTH MELBOURNE PARISH OF MELBOURNE SOUTH
 Township:
 Section: 99
 Crown Allotment: 9, 10 (PT)
 Crown Portion:

Last Plan Reference:
 Derived From: VOL 8835 FOL 344
 Depth Limitation: NIL

Notations

ANY REFERENCE TO MAP IN THE TEXT MEANS THE DIAGRAM SHOWN ON THIS TITLE PLAN

Description of Land / Easement Information

ALL THAT piece of land delineated and coloured red and blue on the map in the margin being Crown Allotment 9 and part of Crown Allotment 10 Section 99- - - City of South Melbourne Parish of Melbourne South County of Bourke- - - - As to the land coloured blue Together with the use and enjoyment of the half of a party wall which half was on the 30th day of July 1912 standing on the-- land coloured yellow on the said map- - - - -

THIS PLAN HAS BEEN PREPARED FOR THE LAND REGISTRY, LAND VICTORIA, FOR TITLE DIAGRAM PURPOSES AS PART OF THE LAND TITLES AUTOMATION PROJECT

COMPILED: 01/05/2000
 VERIFIED: HG

COLOUR CODE
 R = RED Y = YELLOW BL = BLUE

ENCUMBRANCES REFERRED TO
 As to the land coloured blue- - - -
THE PARTY WALL EASEMENT reserved by Transfer 689622- - - - -

This copied document to be made available for the sole purpose of enabling its consideration and review as part of a planning process under the Planning and Environment Act 1987. The document must not be used for any purpose which may breach any copyright

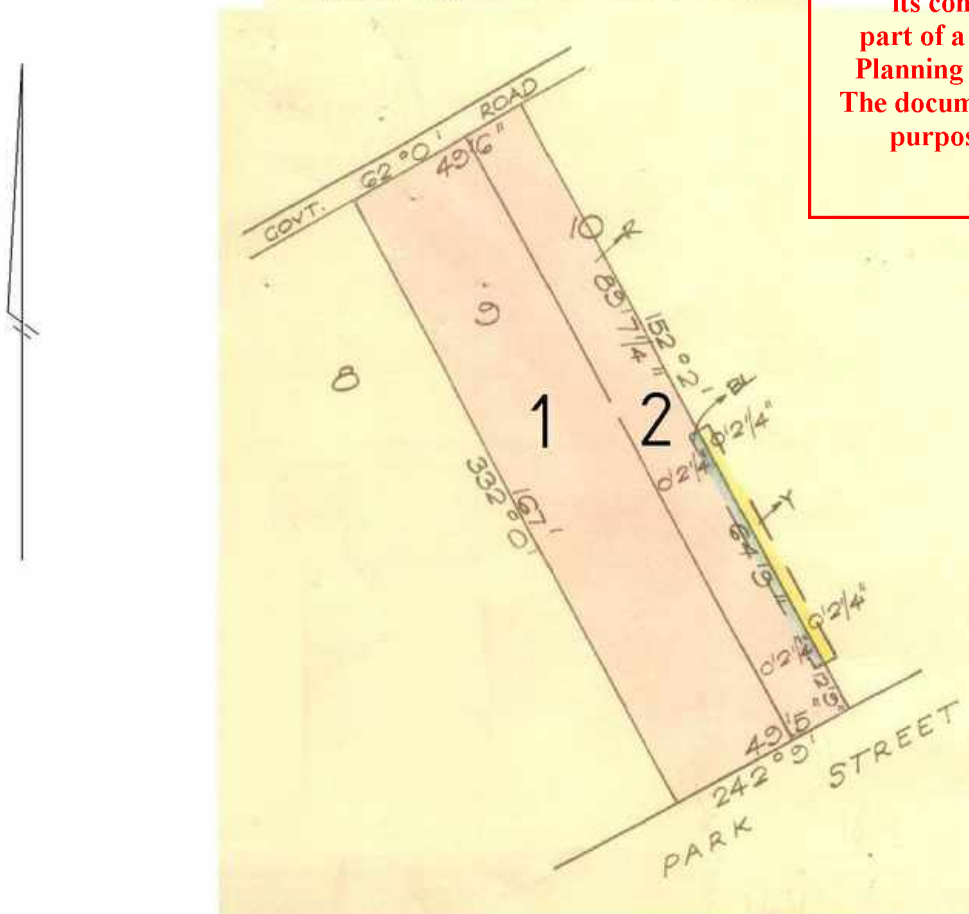

TABLE OF PARCEL IDENTIFIERS
WARNING: Where multiple parcels are referred to or shown on this Title Plan this does not imply separately disposable parcels under Section 8A of the Sale of Land Act 1962
PARCEL 1 = CA 9
PARCEL 2 = CA 10 (PT)

Copyright State of Victoria. No part of this publication may be reproduced except as permitted by the Copyright Act 1968 (Cth), to comply with a statutory requirement or pursuant to a written agreement. The information is only valid at the time and in the form obtained from the LANDATA REGD TM System. None of the State of Victoria, its agents or contractors, accepts responsibility for any subsequent publication or reproduction of the information.

The Victorian Government acknowledges the Traditional Owners of Victoria and pays respects to their ongoing connection to their Country, History and Culture. The Victorian Government extends this respect to their Elders, past, present and emerging.

REGISTER SEARCH STATEMENT (Title Search) Transfer of Land Act 1958

VOLUME 11105 FOLIO 057

Security no : 124131892884X
Produced 05/02/2026 09:08 AM

LAND DESCRIPTION

Lot 1 on Title Plan 942889D.
PARENT TITLE Volume 04094 Folio 611
Created by Application No. 125882M 31/10/2008

REGISTERED PROPRIETOR

Estate Fee Simple
Sole Proprietor



ENCUMBRANCES, CAVEATS AND NOTICES



CAVEAT AY325956Q 21/08/2024

Caveator
PARK AND WELLS LAND PTY LTD ACN: 678198082
Grounds of Claim
PURCHASERS' CONTRACT WITH THE FOLLOWING PARTIES AND DATE.
Parties
THE REGISTERED PROPRIETOR(S)
Date
30/07/2024
Estate or Interest
FREEHOLD ESTATE
Prohibition
ABSOLUTELY
Lodged by
TISHER LINER FC LAW
Notices to
JONATHAN TISHER of LEVEL 2 333 QUEEN STREET MELBOURNE VIC 3000

Any encumbrances created by Section 98 Transfer of Land Act 1958 or Section 24 Subdivision Act 1988 and any other encumbrances shown or entered on the plan set out under DIAGRAM LOCATION below.

DIAGRAM LOCATION

SEE TP942889D FOR FURTHER DETAILS AND BOUNDARIES

ACTIVITY IN THE LAST 125 DAYS

NIL

-----END OF REGISTER SEARCH STATEMENT-----

Additional information: (not part of the Register Search Statement)

Street Address: 68 PARK STREET SOUTH MELBOURNE VIC 3205

ADMINISTRATIVE NOTICES

NIL

This copied document to be made available for the sole purpose of enabling its consideration and review as part of a planning process under the Planning and Environment Act 1987. The document must not be used for any purpose which may breach any copyright

eCT Control 20381U COMMONWEALTH BANK OF AUSTRALIA
Effective from 22/09/2025

DOCUMENT END

Delivered from the LANDATA® System by InfoTrack Pty Ltd.

The information supplied by InfoTrack (Commercial) has been obtained from InfoTrack Pty Limited by agreement between them. The information supplied has been obtained by InfoTrack Pty Limited who is licensed by the State of Victoria to provide this information via LANDATA® System.

**This copied document to be made available
for the sole purpose of enabling
its consideration and review as
part of a planning process under the
Planning and Environment Act 1987.
The document must not be used for any
purpose which may breach any
copyright**

Imaged Document Cover Sheet

The document following this cover sheet is an imaged document supplied by LANDATA®, Secure Electronic Registries Victoria.

Document Type	Plan
Document Identification	TP942889D
Number of Pages (excluding this cover sheet)	1
Document Assembled	17/02/2026 16:04

Copyright and disclaimer notice:

© State of Victoria. This publication is copyright. No part may be reproduced by any process except in accordance with the provisions of the Copyright Act 1968 (Cth) and for the purposes of Section 32 of the Sale of Land Act 1962 or pursuant to a written agreement. The information is only valid at the time and in the form obtained from the LANDATA® System. None of the State of Victoria, LANDATA®, Secure Electronic Registries Victoria Pty Ltd (ABN 86 627 986 396) as trustee for the Secure Electronic Registries Victoria Trust (ABN 83 206 746 897) accept responsibility for any subsequent release, publication or reproduction of the information.

The document is invalid if this cover sheet is removed or altered.

This copied document to be made available for the sole purpose of enabling its consideration and review as part of a planning process under the Planning and Environment Act 1987. The document must not be used for any purpose which may breach any copyright

TITLE PLAN	EDITION 1	TP942889D
-------------------	-----------	------------------

LOCATION OF LAND PARISH: MELBOURNE SOUTH TOWNSHIP: - SECTION: 99 CROWN ALLOTMENT: 10 (PART) CROWN PORTION: - LAST PLAN REFERENCE: TP746654B DERIVED FROM: VOL.11105 FOL. 057 DEPTH LIMITATION: NIL	NOTATIONS
---	------------------

EASEMENT INFORMATION					THIS PLAN HAS BEEN PREPARED BY LAND REGISTRY, LAND VICTORIA, FOR TITLE DIAGRAM PURPOSES Checked by: RH Date: 27/11/2008 Assistant Registrar of Titles
E - ENCUMBERING EASEMENT. R - ENCUMBERING EASEMENT (ROAD). A - APPURTENANT EASEMENT.					
Easement Reference	Purpose / Authority	Width (Metres)	Origin	Land benefited / In favour of	
E-1 A-1	PARTY WALL PARTY WALL	0.06 0.06	INST. 689622 INST. 689622	VOL. 8835 FOL. 344 LAND HEREIN	

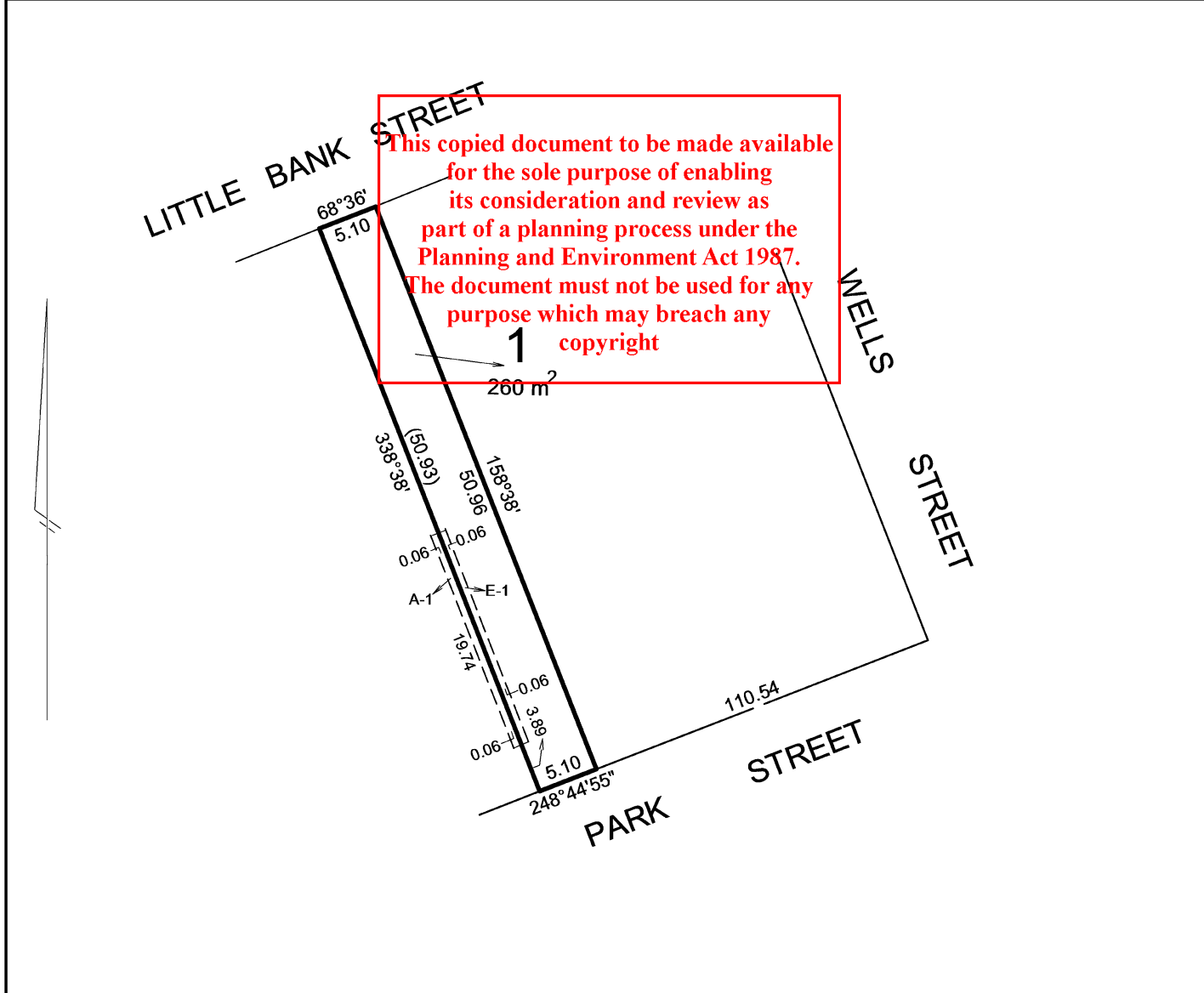

Copyright State of Victoria. No part of this publication may be reproduced except as permitted by the Copyright Act 1968 (Cth), to comply with a statutory requirement or pursuant to a written agreement. The information is only valid at the time and in the form obtained from the LANDATA REGD TM System. None of the State of Victoria, its agents or contractors, accepts responsibility for any subsequent publication or reproduction of the information.

The Victorian Government acknowledges the Traditional Owners of Victoria and pays respects to their ongoing connection to their Country, History and Culture. The Victorian Government extends this respect to their Elders, past, present and emerging.

REGISTER SEARCH STATEMENT (Title Search) Transfer of Land Act 1958

VOLUME 11273 FOLIO 269

Security no : 124131892883Y
Produced 05/02/2026 09:08 AM

LAND DESCRIPTION

Lots 1 and 2 on Title Plan 420624E.

PARENT TITLES :

Volume 11273 Folio 152 to Volume 11273 Folio 153

Created by instrument AH976618B 27/05/2011

REGISTERED PROPRIETOR

Estate Fee Simple

ENCUMBRANCES, CAVEATS AND NOTICES

Any encumbrances created by Section 98 Transfer of Land Act 1958 or Section 24 Subdivision Act 1988 and any other encumbrances shown or entered on the plan set out under DIAGRAM LOCATION below.

DIAGRAM LOCATION

SEE TP420624E FOR FURTHER DETAILS AND BOUNDARIES

ACTIVITY IN THE LAST 125 DAYS

NIL

DOCUMENT END

Delivered from the LANDATA® System by InfoTrack Pty Ltd.

The information supplied by InfoTrack (Commercial) has been obtained from InfoTrack Pty Limited by agreement between them. The information supplied has been obtained by InfoTrack Pty Limited who is licensed by the State of Victoria to provide this information via LANDATA® System.

**This copied document to be made available
for the sole purpose of enabling
its consideration and review as
part of a planning process under the
Planning and Environment Act 1987.
The document must not be used for any
purpose which may breach any
copyright**

Imaged Document Cover Sheet

The document following this cover sheet is an imaged document supplied by LANDATA®, Secure Electronic Registries Victoria.

Document Type	Plan
Document Identification	TP422601G
Number of Pages (excluding this cover sheet)	1
Document Assembled	17/02/2026 16:01

Copyright and disclaimer notice:

© State of Victoria. This publication is copyright. No part may be reproduced by any process except in accordance with the provisions of the Copyright Act 1968 (Cth) and for the purposes of Section 32 of the Sale of Land Act 1962 or pursuant to a written agreement. The information is only valid at the time and in the form obtained from the LANDATA® System. None of the State of Victoria, LANDATA®, Secure Electronic Registries Victoria Pty Ltd (ABN 86 627 986 396) as trustee for the Secure Electronic Registries Victoria Trust (ABN 83 206 746 897) accept responsibility for any subsequent release, publication or reproduction of the information.

The document is invalid if this cover sheet is removed or altered.

This copied document to be made available for the sole purpose of enabling its consideration and review as part of a planning process under the Planning and Environment Act 1987. The document must not be used for any purpose which may breach any copyright

TITLE PLAN	EDITION 1	TP 422601G
------------	-----------	------------

Location of Land Parish: CITY OF SOUTH MELBOURNE PARISH OF MELBOURNE SOUTH Township: Section: 99 Crown Allotment: 11, 12 Crown Portion: Last Plan Reference: Derived From: VOL 8685 FOL 098 Depth Limitation: NIL	Notations ANY REFERENCE TO MAP IN THE TEXT MEANS THE DIAGRAM SHOWN ON THIS TITLE PLAN
--	---

Description of Land / Easement Information	THIS PLAN HAS BEEN PREPARED FOR THE LAND REGISTRY, LAND VICTORIA, FOR TITLE DIAGRAM PURPOSES AS PART OF THE LAND TITLES AUTOMATION PROJECT COMPILED: 01-05-2000 VERIFIED: A.D.
---	--

