

TITLE PLAN	EDITION 1	TP 381888F
------------	-----------	------------

Location of Land

Parish: TURKEETH
 Township:
 Section:
 Crown Allotment: 15 16 17 18 19 20 21 22
 Crown Portion:
 SUBDIVISION B, A(PT) B, A(PT) B, A(PT) B, A(PT) B, A(PT) B, A(PT) B, A(PT)
 Last Plan Reference:
 Derived From: VOL 3197 FOL 346
 Depth Limitation: NIL

Notations

ANY REFERENCE TO MAP IN THE TEXT MEANS THE DIAGRAM SHOWN ON THIS TITLE PLAN

Description of Land / Easement Information

THIS PLAN HAS BEEN PREPARED FOR THE LAND REGISTRY, LAND VICTORIA, FOR TITLE DIAGRAM PURPOSES AS PART OF THE LAND TITLES AUTOMATION PROJECT
 COMPILED: 05/10/2000
 VERIFIED: MP

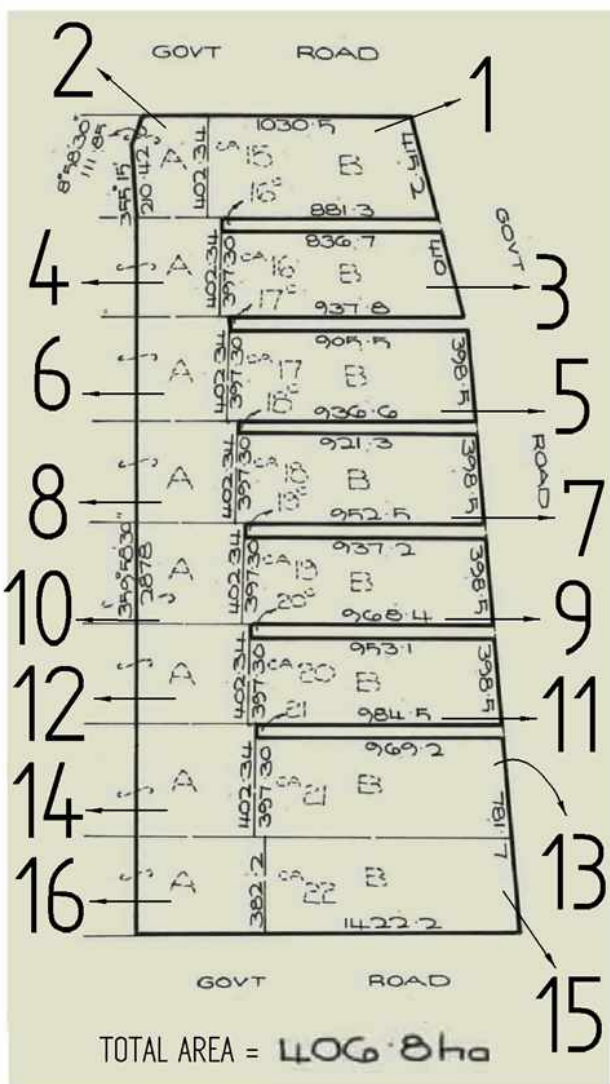

ADVERTISED PLAN

TABLE OF PARCEL IDENTIFIERS

WARNING: Where multiple parcels are referred to or shown on this Title Plan this does not imply separately disposable parcels under Section 8A of the Sale of Land Act 1962

PARCEL 1 = SUBDIVISION B CA 15
PARCEL 2 = SUBDIVISION A (PT) CA 15
PARCEL 3 = SUBDIVISION B CA 16
PARCEL 4 = SUBDIVISION A (PT) CA 16
PARCEL 5 = SUBDIVISION B CA 17
PARCEL 6 = SUBDIVISION A (PT) CA 17
PARCEL 7 = SUBDIVISION B CA 18
PARCEL 8 = SUBDIVISION A (PT) CA 18
PARCEL 9 = SUBDIVISION B CA 19
PARCEL 10 = SUBDIVISION A (PT) CA 19
PARCEL 11 = SUBDIVISION B CA 20
PARCEL 12 = SUBDIVISION A (PT) CA 20
PARCEL 13 = SUBDIVISION B CA 21
PARCEL 14 = SUBDIVISION A (PT) CA 21
PARCEL 15 = SUBDIVISION B CA 22
PARCEL 16 = SUBDIVISION A (PT) CA 22

This copied document to be made available for the sole purpose of enabling its consideration and review as part of a planning process under the Planning and Environment Act 1987. The document must not be used for any purpose which may breach any copyright

LENGTHS ARE IN METRES	Metres = 0.3048 x Feet Metres = 0.201168 x Links	Sheet 1 of 1 sheets
-----------------------	---	---------------------

**REGISTER SEARCH STATEMENT (Title Search) Transfer of
Land Act 1958**

VOLUME 11571 FOLIO 433

Security no : 124123562980R
Produced 09/04/2025 03:15 PM

LAND DESCRIPTION

Lot 1 on Title Plan 381888F.
PARENT TITLES :
Volume 10949 Folio 964 Volume 10950 Folio 041
Created by instrument AL897231G 20/05/2015

REGISTERED PROPRIETOR

Estate Fee Simple
Sole Proprietor
TURKEITH HOMESTEAD PTY LTD of 715 MOOLERIC ROAD BIRREGURRA VIC 3242
AL780894G 27/03/2015

ENCUMBRANCES, CAVEATS AND NOTICES

MORTGAGE AL780899V 27/03/2015
NATIONAL AUSTRALIA BANK LTD

Any encumbrances created by Section 98 Transfer of Land Act 1958 or Section 24 Subdivision Act 1988 and any other encumbrances shown or entered on the plan set out under DIAGRAM LOCATION below.

DIAGRAM LOCATION

SEE TP381888F FOR FURTHER DETAILS AND BOUNDARIES

ACTIVITY IN THE LAST 125 DAYS

NIL

-----END OF REGISTER SEARCH STATEMENT-----

Additional information: (not part of the Register Search Statement)

ADMINISTRATIVE NOTICES

NIL

eCT Control 16089P NATIONAL AUSTRALIA BANK LTD
Effective from 23/10/2016

DOCUMENT END

This copied document to be made available for the sole purpose of enabling its consideration and review as part of a planning process under the Planning and Environment Act 1987. The document must not be used for any purpose which may breach any copyright

**ADVERTISED
PLAN**

**REGISTER SEARCH STATEMENT (Title Search) Transfer of
Land Act 1958**

VOLUME 11571 FOLIO 434

Security no : 124123554356Q
Produced 09/04/2025 01:31 PM

LAND DESCRIPTION

Lot 2 on Title Plan 381888F.
PARENT TITLES :
Volume 10949 Folio 965 Volume 10950 Folio 042
Created by instrument AL897231G 20/05/2015

REGISTERED PROPRIETOR

Estate Fee Simple
Sole Proprietor
TURKEITH HOMESTEAD PTY LTD of 715 MOOLERIC ROAD BIRREGURRA VIC 3242
AL780894G 27/03/2015

ENCUMBRANCES, CAVEATS AND NOTICES

MORTGAGE AL780899V 27/03/2015
NATIONAL AUSTRALIA BANK LTD

Any encumbrances created by Section 98 Transfer of Land Act 1958 or Section 24 Subdivision Act 1988 and any other encumbrances shown or entered on the plan set out under DIAGRAM LOCATION below.

DIAGRAM LOCATION

SEE TP381888F FOR FURTHER DETAILS AND BOUNDARIES

ACTIVITY IN THE LAST 125 DAYS

NIL

-----END OF REGISTER SEARCH STATEMENT-----

Additional information: (not part of the Register Search Statement)

ADMINISTRATIVE NOTICES

NIL

eCT Control 16089P NATIONAL AUSTRALIA BANK LTD
Effective from 23/10/2016

DOCUMENT END

This copied document to be made available for the sole purpose of enabling its consideration and review as part of a planning process under the Planning and Environment Act 1987. The document must not be used for any purpose which may breach any copyright

**ADVERTISED
PLAN**

**REGISTER SEARCH STATEMENT (Title Search) Transfer of
Land Act 1958**

VOLUME 11571 FOLIO 435

Security no : 124123553778T
Produced 09/04/2025 01:27 PM

LAND DESCRIPTION

Lot 3 on Title Plan 381888F.

PARENT TITLES :

Volume 10949 Folio 966 Volume 10950 Folio 043

Created by instrument AL897231G 20/05/2015

REGISTERED PROPRIETOR

Estate Fee Simple

Sole Proprietor

TURKEITH HOMESTEAD PTY LTD of 715 MOOLERIC ROAD BIRREGURRA VIC 3242
AL780894G 27/03/2015

ENCUMBRANCES, CAVEATS AND NOTICES

MORTGAGE AL780899V 27/03/2015
NATIONAL AUSTRALIA BANK LTD

Any encumbrances created by Section 98 Transfer of Land Act 1958 or Section 24 Subdivision Act 1988 and any other encumbrances shown or entered on the plan set out under DIAGRAM LOCATION below.

DIAGRAM LOCATION

SEE TP381888F FOR FURTHER DETAILS AND BOUNDARIES

ACTIVITY IN THE LAST 125 DAYS

NIL

-----END OF REGISTER SEARCH STATEMENT-----

Additional information: (not part of the Register Search Statement)

ADMINISTRATIVE NOTICES

NIL

eCT Control 16089P NATIONAL AUSTRALIA BANK LTD
Effective from 23/10/2016

DOCUMENT END

This copied document to be made available for the sole purpose of enabling its consideration and review as part of a planning process under the Planning and Environment Act 1987. The document must not be used for any purpose which may breach any copyright

**ADVERTISED
PLAN**

**REGISTER SEARCH STATEMENT (Title Search) Transfer of
Land Act 1958**

VOLUME 11571 FOLIO 436

Security no : 124123556907S
Produced 09/04/2025 02:04 PM

LAND DESCRIPTION

Lot 4 on Title Plan 381888F.
PARENT TITLES :
Volume 10949 Folio 967 Volume 10950 Folio 044
Created by instrument AL897231G 20/05/2015

REGISTERED PROPRIETOR

Estate Fee Simple
Sole Proprietor
TURKEITH HOMESTEAD PTY LTD of 715 MOOLERIC ROAD BIRREGURRA VIC 3242
AL780894G 27/03/2015

ENCUMBRANCES, CAVEATS AND NOTICES

MORTGAGE AL780899V 27/03/2015
NATIONAL AUSTRALIA BANK LTD

Any encumbrances created by Section 98 Transfer of Land Act 1958 or Section 24 Subdivision Act 1988 and any other encumbrances shown or entered on the plan set out under DIAGRAM LOCATION below.

DIAGRAM LOCATION

SEE TP381888F FOR FURTHER DETAILS AND BOUNDARIES

ACTIVITY IN THE LAST 125 DAYS

NIL

-----END OF REGISTER SEARCH STATEMENT-----

Additional information: (not part of the Register Search Statement)

ADMINISTRATIVE NOTICES

NIL

eCT Control 16089P NATIONAL AUSTRALIA BANK LTD
Effective from 23/10/2016

DOCUMENT END

This copied document to be made available for the sole purpose of enabling its consideration and review as part of a planning process under the Planning and Environment Act 1987. The document must not be used for any purpose which may breach any copyright

**ADVERTISED
PLAN**

**REGISTER SEARCH STATEMENT (Title Search) Transfer of
Land Act 1958**

VOLUME 11571 FOLIO 437

Security no : 124123556430L
Produced 09/04/2025 01:59 PM

LAND DESCRIPTION

Lot 5 on Title Plan 381888F.
PARENT TITLES :
Volume 10949 Folio 968 Volume 10950 Folio 045
Created by instrument AL897231G 20/05/2015

REGISTERED PROPRIETOR

Estate Fee Simple
Sole Proprietor
TURKEITH HOMESTEAD PTY LTD of 715 MOOLERIC ROAD BIRREGURRA VIC 3242
AL780894G 27/03/2015

ENCUMBRANCES, CAVEATS AND NOTICES

MORTGAGE AL780899V 27/03/2015
NATIONAL AUSTRALIA BANK LTD

Any encumbrances created by Section 98 Transfer of Land Act 1958 or Section 24 Subdivision Act 1988 and any other encumbrances shown or entered on the plan set out under DIAGRAM LOCATION below.

DIAGRAM LOCATION

SEE TP381888F FOR FURTHER DETAILS AND BOUNDARIES

ACTIVITY IN THE LAST 125 DAYS

NIL

-----END OF REGISTER SEARCH STATEMENT-----

Additional information: (not part of the Register Search Statement)

ADMINISTRATIVE NOTICES

NIL

eCT Control 16089P NATIONAL AUSTRALIA BANK LTD
Effective from 23/10/2016

DOCUMENT END

This copied document to be made available for the sole purpose of enabling its consideration and review as part of a planning process under the Planning and Environment Act 1987. The document must not be used for any purpose which may breach any copyright

**ADVERTISED
PLAN**

**REGISTER SEARCH STATEMENT (Title Search) Transfer of
Land Act 1958**

VOLUME 11571 FOLIO 438

Security no : 124123562776N
Produced 09/04/2025 03:12 PM

LAND DESCRIPTION

Lot 6 on Title Plan 381888F.
PARENT TITLES :
Volume 10949 Folio 969 Volume 10950 Folio 046
Created by instrument AL897231G 20/05/2015

REGISTERED PROPRIETOR

Estate Fee Simple
Sole Proprietor
TURKEITH HOMESTEAD PTY LTD of 715 MOOLERIC ROAD BIRREGURRA VIC 3242
AL780894G 27/03/2015

ENCUMBRANCES, CAVEATS AND NOTICES

MORTGAGE AL780899V 27/03/2015
NATIONAL AUSTRALIA BANK LTD

Any encumbrances created by Section 98 Transfer of Land Act 1958 or Section 24 Subdivision Act 1988 and any other encumbrances shown or entered on the plan set out under DIAGRAM LOCATION below.

DIAGRAM LOCATION

SEE TP381888F FOR FURTHER DETAILS AND BOUNDARIES

ACTIVITY IN THE LAST 125 DAYS

NIL

-----END OF REGISTER SEARCH STATEMENT-----

Additional information: (not part of the Register Search Statement)

ADMINISTRATIVE NOTICES

NIL

eCT Control 16089P NATIONAL AUSTRALIA BANK LTD
Effective from 23/10/2016

DOCUMENT END

This copied document to be made available for the sole purpose of enabling its consideration and review as part of a planning process under the Planning and Environment Act 1987. The document must not be used for any purpose which may breach any copyright

**ADVERTISED
PLAN**

**REGISTER SEARCH STATEMENT (Title Search) Transfer of
Land Act 1958**

VOLUME 11571 FOLIO 439

Security no : 124123561934D
Produced 09/04/2025 03:02 PM

LAND DESCRIPTION

Lot 7 on Title Plan 381888F.
PARENT TITLES :
Volume 10949 Folio 970 Volume 10950 Folio 047
Created by instrument AL897231G 20/05/2015

REGISTERED PROPRIETOR

Estate Fee Simple
Sole Proprietor
TURKEITH HOMESTEAD PTY LTD of 715 MOOLERIC ROAD BIRREGURRA VIC 3242
AL780894G 27/03/2015

ENCUMBRANCES, CAVEATS AND NOTICES

MORTGAGE AL780899V 27/03/2015
NATIONAL AUSTRALIA BANK LTD

Any encumbrances created by Section 98 Transfer of Land Act 1958 or Section 24 Subdivision Act 1988 and any other encumbrances shown or entered on the plan set out under DIAGRAM LOCATION below.

DIAGRAM LOCATION

SEE TP381888F FOR FURTHER DETAILS AND BOUNDARIES

ACTIVITY IN THE LAST 125 DAYS

NIL

-----END OF REGISTER SEARCH STATEMENT-----

Additional information: (not part of the Register Search Statement)

ADMINISTRATIVE NOTICES

NIL

eCT Control 16089P NATIONAL AUSTRALIA BANK LTD
Effective from 23/10/2016

DOCUMENT END

This copied document to be made available for the sole purpose of enabling its consideration and review as part of a planning process under the Planning and Environment Act 1987. The document must not be used for any purpose which may breach any copyright

**ADVERTISED
PLAN**

**REGISTER SEARCH STATEMENT (Title Search) Transfer of
Land Act 1958**

VOLUME 11571 FOLIO 440

Security no : 124123553256L
Produced 09/04/2025 01:20 PM

LAND DESCRIPTION

Lot 8 on Title Plan 381888F.
PARENT TITLES :
Volume 10949 Folio 971 Volume 10950 Folio 048
Created by instrument AL897231G 20/05/2015

REGISTERED PROPRIETOR

Estate Fee Simple
Sole Proprietor
TURKEITH HOMESTEAD PTY LTD of 715 MOOLERIC ROAD BIRREGURRA VIC 3242
AL780894G 27/03/2015

ENCUMBRANCES, CAVEATS AND NOTICES

MORTGAGE AL780899V 27/03/2015
NATIONAL AUSTRALIA BANK LTD

Any encumbrances created by Section 98 Transfer of Land Act 1958 or Section 24 Subdivision Act 1988 and any other encumbrances shown or entered on the plan set out under DIAGRAM LOCATION below.

DIAGRAM LOCATION

SEE TP381888F FOR FURTHER DETAILS AND BOUNDARIES

ACTIVITY IN THE LAST 125 DAYS

NIL

-----END OF REGISTER SEARCH STATEMENT-----

Additional information: (not part of the Register Search Statement)

ADMINISTRATIVE NOTICES

NIL

eCT Control 16089P NATIONAL AUSTRALIA BANK LTD
Effective from 23/10/2016

DOCUMENT END

This copied document to be made available for the sole purpose of enabling its consideration and review as part of a planning process under the Planning and Environment Act 1987. The document must not be used for any purpose which may breach any copyright

**ADVERTISED
PLAN**

**REGISTER SEARCH STATEMENT (Title Search) Transfer of
Land Act 1958**

VOLUME 11571 FOLIO 441

Security no : 124123552759C
Produced 09/04/2025 01:14 PM

LAND DESCRIPTION

Lot 9 on Title Plan 381888F.
PARENT TITLES :
Volume 10949 Folio 972 Volume 10950 Folio 049
Created by instrument AL897231G 20/05/2015

REGISTERED PROPRIETOR

Estate Fee Simple
Sole Proprietor
TURKEITH HOMESTEAD PTY LTD of 715 MOOLERIC ROAD BIRREGURRA VIC 3242
AL780894G 27/03/2015

ENCUMBRANCES, CAVEATS AND NOTICES

MORTGAGE AL780899V 27/03/2015
NATIONAL AUSTRALIA BANK LTD

Any encumbrances created by Section 98 Transfer of Land Act 1958 or Section 24 Subdivision Act 1988 and any other encumbrances shown or entered on the plan set out under DIAGRAM LOCATION below.

DIAGRAM LOCATION

SEE TP381888F FOR FURTHER DETAILS AND BOUNDARIES

ACTIVITY IN THE LAST 125 DAYS

NIL

-----END OF REGISTER SEARCH STATEMENT-----

Additional information: (not part of the Register Search Statement)

ADMINISTRATIVE NOTICES

NIL

eCT Control 16089P NATIONAL AUSTRALIA BANK LTD
Effective from 23/10/2016

DOCUMENT END

This copied document to be made available for the sole purpose of enabling its consideration and review as part of a planning process under the Planning and Environment Act 1987. The document must not be used for any purpose which may breach any copyright

**ADVERTISED
PLAN**

**REGISTER SEARCH STATEMENT (Title Search) Transfer of
Land Act 1958**

VOLUME 11571 FOLIO 442

Security no : 124123556119Y
Produced 09/04/2025 01:54 PM

LAND DESCRIPTION

Lot 10 on Title Plan 381888F.
PARENT TITLES :
Volume 10949 Folio 973 Volume 10950 Folio 050
Created by instrument AL897231G 20/05/2015

REGISTERED PROPRIETOR

Estate Fee Simple
Sole Proprietor
TURKEITH HOMESTEAD PTY LTD of 715 MOOLERIC ROAD BIRREGURRA VIC 3242
AL780894G 27/03/2015

ENCUMBRANCES, CAVEATS AND NOTICES

MORTGAGE AL780899V 27/03/2015
NATIONAL AUSTRALIA BANK LTD

Any encumbrances created by Section 98 Transfer of Land Act 1958 or Section 24 Subdivision Act 1988 and any other encumbrances shown or entered on the plan set out under DIAGRAM LOCATION below.

DIAGRAM LOCATION

SEE TP381888F FOR FURTHER DETAILS AND BOUNDARIES

ACTIVITY IN THE LAST 125 DAYS

NIL

-----END OF REGISTER SEARCH STATEMENT-----

Additional information: (not part of the Register Search Statement)

ADMINISTRATIVE NOTICES

NIL

eCT Control 16089P NATIONAL AUSTRALIA BANK LTD
Effective from 23/10/2016

DOCUMENT END

This copied document to be made available for the sole purpose of enabling its consideration and review as part of a planning process under the Planning and Environment Act 1987. The document must not be used for any purpose which may breach any copyright

**ADVERTISED
PLAN**

**REGISTER SEARCH STATEMENT (Title Search) Transfer of
Land Act 1958**

VOLUME 11571 FOLIO 443

Security no : 124123555523W
Produced 09/04/2025 01:47 PM

LAND DESCRIPTION

Lot 11 on Title Plan 381888F.
PARENT TITLES :
Volume 10949 Folio 974 Volume 10950 Folio 051
Created by instrument AL897231G 20/05/2015

REGISTERED PROPRIETOR

Estate Fee Simple
Sole Proprietor
TURKEITH HOMESTEAD PTY LTD of 715 MOOLERIC ROAD BIRREGURRA VIC 3242
AL780894G 27/03/2015

ENCUMBRANCES, CAVEATS AND NOTICES

MORTGAGE AL780899V 27/03/2015
NATIONAL AUSTRALIA BANK LTD

Any encumbrances created by Section 98 Transfer of Land Act 1958 or Section 24 Subdivision Act 1988 and any other encumbrances shown or entered on the plan set out under DIAGRAM LOCATION below.

DIAGRAM LOCATION

SEE TP381888F FOR FURTHER DETAILS AND BOUNDARIES

ACTIVITY IN THE LAST 125 DAYS

NIL

-----END OF REGISTER SEARCH STATEMENT-----

Additional information: (not part of the Register Search Statement)

ADMINISTRATIVE NOTICES

NIL

eCT Control 16089P NATIONAL AUSTRALIA BANK LTD
Effective from 23/10/2016

DOCUMENT END

This copied document to be made available for the sole purpose of enabling its consideration and review as part of a planning process under the Planning and Environment Act 1987. The document must not be used for any purpose which may breach any copyright

**ADVERTISED
PLAN**

**REGISTER SEARCH STATEMENT (Title Search) Transfer of
Land Act 1958**

VOLUME 11571 FOLIO 444

Security no : 124123559743K
Produced 09/04/2025 02:36 PM

LAND DESCRIPTION

Lot 12 on Title Plan 381888F.
PARENT TITLES :
Volume 10949 Folio 975 Volume 10950 Folio 052
Created by instrument AL897231G 20/05/2015

REGISTERED PROPRIETOR

Estate Fee Simple
Sole Proprietor
TURKEITH HOMESTEAD PTY LTD of 715 MOOLERIC ROAD BIRREGURRA VIC 3242
AL780894G 27/03/2015

ENCUMBRANCES, CAVEATS AND NOTICES

MORTGAGE AL780899V 27/03/2015
NATIONAL AUSTRALIA BANK LTD

Any encumbrances created by Section 98 Transfer of Land Act 1958 or Section 24 Subdivision Act 1988 and any other encumbrances shown or entered on the plan set out under DIAGRAM LOCATION below.

DIAGRAM LOCATION

SEE TP381888F FOR FURTHER DETAILS AND BOUNDARIES

ACTIVITY IN THE LAST 125 DAYS

NIL

-----END OF REGISTER SEARCH STATEMENT-----

Additional information: (not part of the Register Search Statement)

ADMINISTRATIVE NOTICES

NIL

eCT Control 16089P NATIONAL AUSTRALIA BANK LTD
Effective from 23/10/2016

DOCUMENT END

This copied document to be made available for the sole purpose of enabling its consideration and review as part of a planning process under the Planning and Environment Act 1987. The document must not be used for any purpose which may breach any copyright

**ADVERTISED
PLAN**

**REGISTER SEARCH STATEMENT (Title Search) Transfer of
Land Act 1958**

VOLUME 11571 FOLIO 445

Security no : 124123559127E
Produced 09/04/2025 02:29 PM

LAND DESCRIPTION

Lot 13 on Title Plan 381888F.
PARENT TITLES :
Volume 10949 Folio 976 Volume 10950 Folio 053
Created by instrument AL897231G 20/05/2015

REGISTERED PROPRIETOR

Estate Fee Simple
Sole Proprietor
TURKEITH HOMESTEAD PTY LTD of 715 MOOLERIC ROAD BIRREGURRA VIC 3242
AL780894G 27/03/2015

ENCUMBRANCES, CAVEATS AND NOTICES

MORTGAGE AL780899V 27/03/2015
NATIONAL AUSTRALIA BANK LTD

Any encumbrances created by Section 98 Transfer of Land Act 1958 or Section 24 Subdivision Act 1988 and any other encumbrances shown or entered on the plan set out under DIAGRAM LOCATION below.

DIAGRAM LOCATION

SEE TP381888F FOR FURTHER DETAILS AND BOUNDARIES

ACTIVITY IN THE LAST 125 DAYS

NIL

-----END OF REGISTER SEARCH STATEMENT-----

Additional information: (not part of the Register Search Statement)

ADMINISTRATIVE NOTICES

NIL

eCT Control 16089P NATIONAL AUSTRALIA BANK LTD
Effective from 23/10/2016

DOCUMENT END

This copied document to be made available for the sole purpose of enabling its consideration and review as part of a planning process under the Planning and Environment Act 1987. The document must not be used for any purpose which may breach any copyright

**ADVERTISED
PLAN**

**REGISTER SEARCH STATEMENT (Title Search) Transfer of
Land Act 1958**

VOLUME 11571 FOLIO 446

Security no : 124123552392A
Produced 09/04/2025 01:08 PM

LAND DESCRIPTION

Lot 14 on Title Plan 381888F.
PARENT TITLES :
Volume 10949 Folio 977 Volume 10950 Folio 054
Created by instrument AL897231G 20/05/2015

REGISTERED PROPRIETOR

Estate Fee Simple
Sole Proprietor
TURKEITH HOMESTEAD PTY LTD of 715 MOOLERIC ROAD BIRREGURRA VIC 3242
AL780894G 27/03/2015

ENCUMBRANCES, CAVEATS AND NOTICES

MORTGAGE AL780899V 27/03/2015
NATIONAL AUSTRALIA BANK LTD

Any encumbrances created by Section 98 Transfer of Land Act 1958 or Section 24 Subdivision Act 1988 and any other encumbrances shown or entered on the plan set out under DIAGRAM LOCATION below.

DIAGRAM LOCATION

SEE TP381888F FOR FURTHER DETAILS AND BOUNDARIES

ACTIVITY IN THE LAST 125 DAYS

NIL

-----END OF REGISTER SEARCH STATEMENT-----

Additional information: (not part of the Register Search Statement)

ADMINISTRATIVE NOTICES

NIL

eCT Control 16089P NATIONAL AUSTRALIA BANK LTD
Effective from 23/10/2016

DOCUMENT END

This copied document to be made available for the sole purpose of enabling its consideration and review as part of a planning process under the Planning and Environment Act 1987. The document must not be used for any purpose which may breach any copyright

**ADVERTISED
PLAN**

**REGISTER SEARCH STATEMENT (Title Search) Transfer of
Land Act 1958**

VOLUME 11571 FOLIO 447

Security no : 124123551351G
Produced 09/04/2025 12:52 PM

LAND DESCRIPTION

Lot 15 on Title Plan 381888F.
PARENT TITLES :
Volume 10949 Folio 978 Volume 10950 Folio 055
Created by instrument AL897231G 20/05/2015

REGISTERED PROPRIETOR

Estate Fee Simple
Sole Proprietor
TURKEITH HOMESTEAD PTY LTD of 715 MOOLERIC ROAD BIRREGURRA VIC 3242
AL780894G 27/03/2015

ENCUMBRANCES, CAVEATS AND NOTICES

MORTGAGE AL780899V 27/03/2015
NATIONAL AUSTRALIA BANK LTD

Any encumbrances created by Section 98 Transfer of Land Act 1958 or Section 24 Subdivision Act 1988 and any other encumbrances shown or entered on the plan set out under DIAGRAM LOCATION below.

DIAGRAM LOCATION

SEE TP381888F FOR FURTHER DETAILS AND BOUNDARIES

ACTIVITY IN THE LAST 125 DAYS

NIL

-----END OF REGISTER SEARCH STATEMENT-----

Additional information: (not part of the Register Search Statement)

ADMINISTRATIVE NOTICES

NIL

eCT Control 16089P NATIONAL AUSTRALIA BANK LTD
Effective from 23/10/2016

DOCUMENT END

This copied document to be made available for the sole purpose of enabling its consideration and review as part of a planning process under the Planning and Environment Act 1987. The document must not be used for any purpose which may breach any copyright

**ADVERTISED
PLAN**

**REGISTER SEARCH STATEMENT (Title Search) Transfer of
Land Act 1958**

VOLUME 11570 FOLIO 918

Security no : 124123555167J
Produced 09/04/2025 01:42 PM

LAND DESCRIPTION

Lot 16 on Title Plan 381888F.
PARENT TITLES :
Volume 10949 Folio 979 Volume 10950 Folio 056
Created by instrument AL893107E 18/05/2015

REGISTERED PROPRIETOR

Estate Fee Simple
Sole Proprietor
TURKEITH HOMESTEAD PTY LTD of 715 MOOLERIC ROAD BIRREGURRA VIC 3242
AL780894G 27/03/2015

ENCUMBRANCES, CAVEATS AND NOTICES

MORTGAGE AL780895E 27/03/2015
NATIONAL AUSTRALIA BANK LTD

Any encumbrances created by Section 98 Transfer of Land Act 1958 or Section 24 Subdivision Act 1988 and any other encumbrances shown or entered on the plan set out under DIAGRAM LOCATION below.

DIAGRAM LOCATION

SEE TP381888F FOR FURTHER DETAILS AND BOUNDARIES

ACTIVITY IN THE LAST 125 DAYS

NIL

-----END OF REGISTER SEARCH STATEMENT-----

Additional information: (not part of the Register Search Statement)

ADMINISTRATIVE NOTICES

NIL

eCT Control 16089P NATIONAL AUSTRALIA BANK LTD
Effective from 23/10/2016

DOCUMENT END

This copied document to be made available for the sole purpose of enabling its consideration and review as part of a planning process under the Planning and Environment Act 1987. The document must not be used for any purpose which may breach any copyright

**ADVERTISED
PLAN**