

TITLE PLAN		EDITION 1	TP 273590L
Location of Land Parish: BIRREGURRA Township: Section: Crown Allotment: 50A Crown Portion: Last Plan Reference: Derived From: VOL 5218 FOL 577 Depth Limitation: NIL		Notations ADVERTISED PLAN ANY REFERENCE TO MAP IN THE TEXT MEANS THE DIAGRAM SHOWN ON THIS TITLE PLAN	
Description of Land / Easement Information E-1 = EASEMENT TO STATE ELECTRICITY COMMISSION OF VICTORIA CREATED BY C/E A325855		THIS PLAN HAS BEEN PREPARED FOR THE LAND REGISTRY, LAND VICTORIA, FOR TITLE DIAGRAM PURPOSES AS PART OF THE LAND TITLES AUTOMATION PROJECT COMPILED: 17/01/2000 VERIFIED: C.L.	
<p>This copied document to be made available for the sole purpose of enabling its consideration and review as part of a planning process under the Planning and Environment Act 1987. The document must not be used for any purpose which may breach any copyright</p>			
LENGTHS ARE IN LINKS	Metres = 0.3048 x Feet Metres = 0.201168 x Links	Sheet 1 of 1 sheets	

Copyright State of Victoria. No part of this publication may be reproduced except as permitted by the Copyright Act 1968 (Cth), to comply with a statutory requirement or pursuant to a written agreement. The information is only valid at the time and in the form obtained from the LANDATA REGD TM System. None of the State of Victoria, its agents or contractors, accepts responsibility for any subsequent publication or reproduction of the information.

The Victorian Government acknowledges the Traditional Owners of Victoria and pays respects to their ongoing connection to their Country, History and Culture. The Victorian Government extends this respect to their Elders, past, present and emerging.

REGISTER SEARCH STATEMENT (Title Search) Transfer of Land Act 1958

VOLUME 05218 FOLIO 577

Security no : 124125929225L
Produced 04/07/2025 10:18 AM

LAND DESCRIPTION

Crown Allotment 50A Parish of Birregurra.
PARENT TITLE Volume 00976 Folio 124
Created by instrument 1298855 21/12/1926

REGISTERED PROPRIETOR

Estate Fee Simple
Joint Proprietors
HAROLD RUSSELL BEACH
BARBARA ANN BEACH both of 30 MOOLERIC ROAD BIRREGURRA VIC 3242
AF165227H 28/06/2007

ENCUMBRANCES, CAVEATS AND NOTICES

For details of any other encumbrances see the plan or imaged folio set out under DIAGRAM LOCATION below.

DIAGRAM LOCATION

SEE TP273590L FOR FURTHER DETAILS AND BOUNDARIES

ACTIVITY IN THE LAST 125 DAYS

NIL

-----END OF REGISTER SEARCH STATEMENT-----

Additional information: (not part of the Register Search Statement)

Street Address: 45 MOOLERIC ROAD BIRREGURRA VIC 3242

DOCUMENT END

Delivered from the LANDATA® System by InfoTrack Pty Ltd.

The information supplied by InfoTrack (Major Accounts) has been obtained from InfoTrack Pty Limited by agreement between them. The information supplied has been obtained by InfoTrack Pty Limited who is licensed by the State of Victoria to provide this information via LANDATA® System.

This copied document to be made available for the sole purpose of enabling its consideration and review as part of a planning process under the Planning and Environment Act 1987. The document must not be used for any purpose which may breach any copyright

**ADVERTISED
PLAN**

J.V.
A325855.
*****2--0-0 F R T T

A325855

10-22 3 19 3 2 6 APR 30-57 No. G.T. 86

**STATE ELECTRICITY COMMISSION OF VICTORIA.
VICTORIA.**

GWB

CREATION OF EASEMENT

v/ I, HAROLD EDWIN BEACH
of "The Plains", Birregurra, Grazier,

(hereinafter referred to as "the Owner") being registered or entitled to be registered as the proprietor of an estate in fee simple in the land secondly hereinafter described subject to the encumbrances notified hereunder in consideration of the sum of Thirty-five Pounds paid to me by the **STATE ELECTRICITY COMMISSION OF VICTORIA** (hereinafter called "the Commission") DO HEREBY TRANSFER AND GRANT unto the Commission and its successors and transferees the registered proprietor or proprietors for the time being of ALL THAT piece of land being part of Crown Allotment 1 Section 9 City of Geelong Parish of Corio County of Grant and being the whole

Handwritten mark

Handwritten mark

Handwritten mark

Handwritten mark

of the land comprised in Certificate of Title entered in the Register Book of the Office of Titles volume 5904 folio 643 ALL THAT the full and free right and liberty to sit on and upon the land hereinafter described and to lay and erect thereon not more than one tower shall be erected at such times as the Commission or its officers shall deem advisable and at such places as the Commission shall within twenty-one years from the date hereof select) and such wires and other apparatus and appliances as the Commission may require or desire (all of which wires apparatus and appliances are hereinafter referred to as "the said appliances") for the transmission of electricity (but so always that the poles and towers shall be erected on the land hereinafter described for the purposes of the transmission of electricity the lowest point of such line shall be at least twenty-two (22) feet above the surface of such land) AND ALSO to clear the land hereinafter described of obstructions including any buildings whatsoever and to carry out thereon such digging cutting and excavating as may be reasonably necessary for the bases or foundations of the said appliances and keeping the said bases or foundations free of the injurious accumulation of water AND ALSO from time to time to go pass and repass for all purposes aforesaid either with or without horses or other animals carts or other carriages through over and along ALL THAT piece of land delineated and coloured red on the plan drawn hereon being part of Crown Allotment 50A

This copied document to be made available for the sole purpose of enabling its consideration and use as part of a planning process under the Planning and Environment Act 1987. The document must not be used for any purpose which may breach any copyright

to Parish of Birregurra
5904 whole.
643

Handwritten notes:
29.8.57
J.R. Webb
29/8/57

(which land is hereinafter referred to as the "servient tenement") AND ALSO to use the servient tenement and the said appliances for all purposes of and incidental to transmitting electricity AND ALSO to keep the servient tenement free of any buildings whatsoever and of obstructions (including any trees more than ~~feet in height~~ or any structures more than ~~feet in height~~) to transmitting electricity safely and economically across the servient tenement at any time hereafter AND ALSO to maintain

Handwritten notes:
30.8.57
Handwritten signature

Fsc. G-3, R1.

6 MAY 1957



**ADVERTISED
PLAN**

and to remove the said appliances PROVIDED ALWAYS that in the exercise of the foregoing powers of the Commission to maintain and to remove the said appliances the Commission shall do as little damage as may be and shall if required within two years from the exercise of the same make full compensation to the owner his heirs executors administrators or transferees for any damage sustained by him or them in consequence of such exercise of such powers such damage to be determined in default of agreement in manner provided in the *Lands Compensation Act 1928* AND PROVIDED FURTHER that the Commission will at all times hereafter keep indemnified the owner his heirs executors administrators and transferees from and against all damage injury or nuisance which may be caused or occasioned by the transmission of electricity on to or over the servient tenement through over or along the said appliances if such damage arise from any failure of the Commission to erect and maintain the said appliances in and according to a proper and safe manner and design in the light of present day knowledge or any cause being *vis major* the act of God or the act or neglect of any employee or agent or contractor of the Commission acting in the scope of his employment or in accordance with his authority AND PROVIDED FURTHER that nothing herein shall be deemed in any way to restrict limit or detract from any right power or authority of the Commission or its assigns under the State Electricity Commission Acts or any other Acts which now or hereafter may confer any rights duties powers or authorities on the Commission or its assigns.

Dated the *1st* day of *April* one thousand nine hundred and *forty seven*
Signed Sealed and Delivered by the said HAROLD EDWIN BEACH in the State of Victoria in the presence of *H. E. Beach*

This copied document to be made available for the sole purpose of enabling its consideration and review as part of a planning process under the Planning and Environment Act 1987. The document must not be used for any purpose which may breach any copyright

Bank Manager

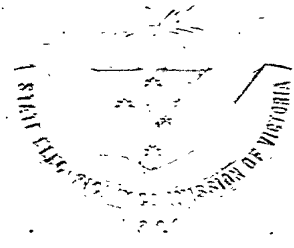

The Common Seal of the State Electricity Commission of Victoria was hereto affixed by authority of the Commission in the presence of—

W. G. Gurnall Chairman.
R. Dennis Secretary.

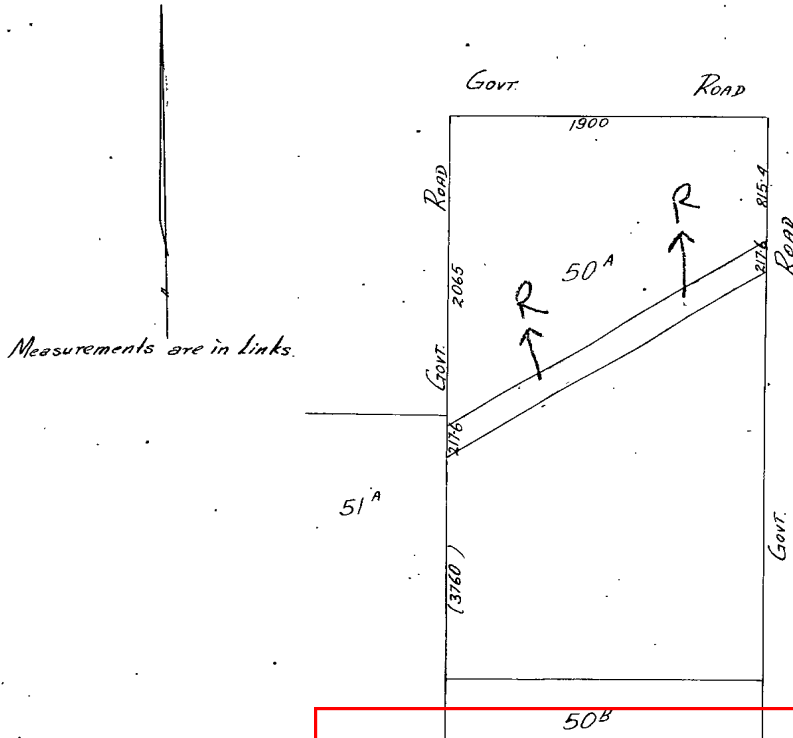

ENCUMBRANCES REFERRED TO—
Nil

ADVERTISED PLAN



This copied document to be made available for the sole purpose of enabling its consideration and review as part of a planning process under the Planning and Environment Act 1987. The document must not be used for any purpose which may breach any copyright

COLOUR CODE

Y=Yellow O=Orange BR=Brown
G=Green R=Red BL=Blue P=Purple
H=Hatched CH=Cross Hatched



DA325835-2-6

**ADVERTISED
PLAN**

A memorandum of the within instrument
has been entered in the Register Book
Vol. 5218 Fol. 57

Jones
Assistant Registrar of Titles

AB

Dated the _____ day of _____ 19____

No. C.P. 86

STATE ELECTRICITY COMMISSION
OF VICTORIA.

FSC 63-88/01
By Authority:
I. J. Gentry, Gen. Mgr., M&A

H. E. BEACH
to the
STATE ELECTRICITY COMMISSION
OF VICTORIA
CREATION OF EASEMENT
(No Track)

This copied document to be made available
for the sole purpose of enabling
its consideration and review as
part of a planning process under the
Planning and Environment Act 1987.
The document must not be used for any
purpose which may breach any
copyright

Nature of Instrument.	Time of its Production for Registration.	To Whom Given.	Number or Symbol Thereon.
Creation of Easement	The _____ day of _____ 19____	State Electricity Commission of Victoria	
<i>Assistant Registrar of Titles.</i>			
<p>3 certify that a Memorial of the within instrument was entered, at the time last mentioned, in the Register Book, Vol. _____ Folio _____</p>			
<i>Assistant Registrar of Titles.</i>			

**ADVERTISED
PLAN**