

LP 65810
EDITION 1
 APPROVED 03/08/65

PLAN OF SUBDIVISION
 SUBDIVISIONS A, B & C OF CROWN ALLOTMENTS 25, 27, 28, 29, 32, 34, 36, 40, 41, 42, 43 & 44
 SUBDIVISIONS A & B OF CROWN ALLOTMENTS 23, 24, 26, 30, 31, 33, 35, 37, 38, 39 & 45
 AND PART OF SUBDIVISIONS A OF CROWN ALLOTMENTS 15, 16, 17, 18, 19, 20, 21 & 22

PARISH OF TURKEETH
 COUNTY OF GRENVILLE
 VOL. 7551 FOL. 200

Measurements are in Links
 Conversion Factor
 LINKS x 0.201168 = METRES

WARRACBARUNAH

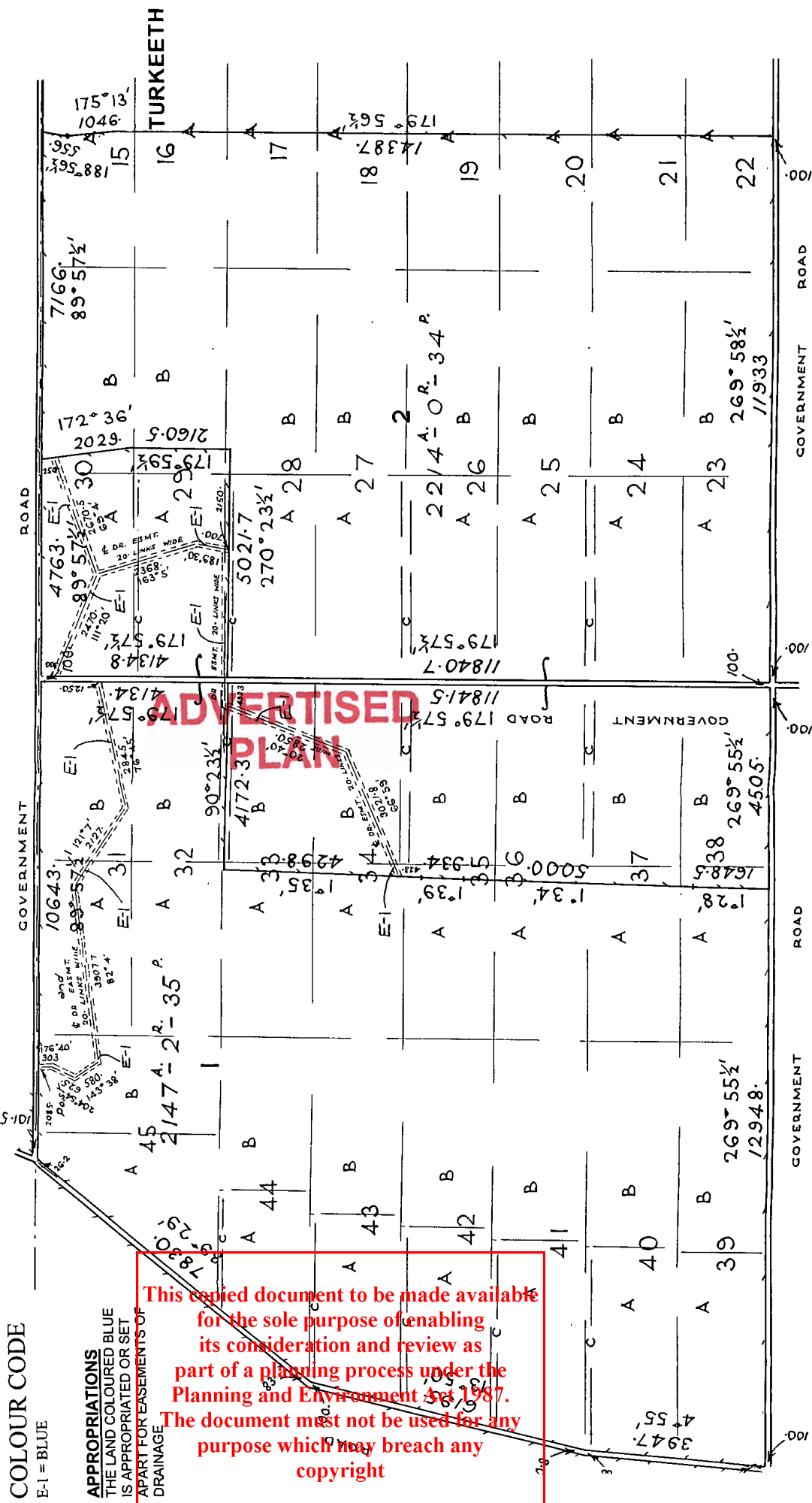

COLOUR CODE
 E-1 = BLUE

APPROPRIATIONS
 THE LAND COLOURED BLUE
 IS APPROPRIATED OR SET
 APART FOR EASEMENTS OF
 DRAINAGE

This copied document to be made available for the sole purpose of enabling its consideration and review as part of a planning process under the Planning and Environment Act 1987. The document must not be used for any purpose which may breach any copyright

SEE FIELD NOTES FOR DATUM, REFERENCE MARKS AND PERMANENT MARKS.

TITLE PLAN		EDITION 1	TP 634103R
Location of Land Parish: TURKEETH Township: Section: Crown Allotment: Crown Portion: Last Plan Reference: LP65810 Derived From: VOL 8576 FOL 336 Depth Limitation: 50 FEET (AS THE LAND COLOUR PURPLE & GREEN)		Notations ANY REFERENCE TO MAP IN THE TEXT MEANS THE DIAGRAM SHOWN ON THIS TITLE PLAN	
Description of Land / Easement Information <div style="background-color: #ffffcc; padding: 5px;"> <p>A Drainage easement appurtenant to the within Land has been reserved by - Transfer C288450 - - - - -</p> <p>A Drainage easement appurtenant to the within Land has been reserved by - - - Transfer C288451 - - - - -</p> <p style="text-align: center;">ENCUMBRANCES REFERRED TO</p> <p>As to any land coloured blue or green</p> <p><u>ANY EASEMENTS</u> implied under Section 98 of the Transfer of Land Act - - - - -</p> </div>		THIS PLAN HAS BEEN PREPARED FOR THE LAND REGISTRY, LAND VICTORIA, FOR TITLE DIAGRAM PURPOSES AS PART OF THE LAND TITLES AUTOMATION PROJECT COMPILED: 26/09/2000 VERIFIED: MP	
SEE SHEET 2 FOR DIAGRAM			
<div style="border: 2px solid red; padding: 10px; width: fit-content; margin: 0 auto;"> <p style="color: red; font-weight: bold; text-align: center;">This copied document to be made available for the sole purpose of enabling its consideration and review as part of a planning process under the Planning and Environment Act 1987. The document must not be used for any purpose which may breach any copyright</p> </div>			
<h1 style="color: red; margin: 0;">ADVERTISED PLAN</h1>			
LENGTHS ARE IN LINKS	Metres = 0.3048 x Feet Metres = 0.201168 x Links	Sheet 1 of 2 sheets	

**REGISTER SEARCH STATEMENT (Title Search) Transfer of
Land Act 1958**

Page 1 of 1

VOLUME 08576 FOLIO 336

Security no : 124123531859T
Produced 08/04/2025 05:10 PM

LAND DESCRIPTION

Lot 2 on Plan of Subdivision 065810.
PARENT TITLE Volume 08564 Folio 747
Created by instrument LP065810 07/09/1965

REGISTERED PROPRIETOR

Estate Fee Simple
Sole Proprietor
KATWIL PTY LTD of 79 GHERINGHAP STREET GEELONG VIC 3220
AC990111B 19/07/2004

ENCUMBRANCES, CAVEATS AND NOTICES

MORTGAGE AF108443Y 04/06/2007
COMMONWEALTH BANK OF AUSTRALIA

Any encumbrances created by Section 98 Transfer of Land Act 1958 or Section 24 Subdivision Act 1988 and any other encumbrances shown or entered on the plan or imaged folio set out under DIAGRAM LOCATION below.

DIAGRAM LOCATION

SEE TP634103R FOR FURTHER DETAILS AND BOUNDARIES

ACTIVITY IN THE LAST 125 DAYS

NIL

-----END OF REGISTER SEARCH STATEMENT-----

Additional information: (not part of the Register Search Statement)

ADMINISTRATIVE NOTICES

NIL

eCT Control 15940N COMMONWEALTH BANK OF AUSTRALIA
Effective from 23/10/2016

DOCUMENT END

This copied document to be made available for the sole purpose of enabling its consideration and review as part of a planning process under the Planning and Environment Act 1987. The document must not be used for any purpose which may breach any copyright

**ADVERTISED
PLAN**

10-12 304200 AUG 13-65

C288450

C288450

13

? NEW TITLE RE 7551/200
No. C288450 (OF 14660)

McNAB & McNAB
VICTORIA
TRANSFER OF LAND

REGD 5810
1/10/65
X

WE, COLIN JAMES BARCLAY of "Mingawalla" Beec Grazier, THOMAS BARCLAY of "Tarana" Beec Grazier and CAMPBELL BARCLAY of "Kirkcaldy" Beec Grazier being registered as the proprietors as tenants in common in equal shares of an estate in fee simple in the land hereinafter described subject to the encumbrances notified hereunder in consideration of two transfers of land under the operation of the Transfer of Land

an agreement to partition the said land and other land and, in further consideration of the same, 27/10/65

Acts of even date herewith and two Conveyances of Land under the General Law of even date herewith all made between the parties hereto the sum of FIFTY THREE POUNDS FOURTEEN SHILLINGS

This copied document to be made available for the sole purpose of enabling its consideration and review as part of a planning process under the Planning and Environment Act 1987. The document must not be used for any purpose which may breach any copyright

AND THE sum of ONE HUNDRED AND FORTY FIVE POUNDS to the said Colin James Barclay by the said Thomas Barclay and the sum of ONE HUNDRED AND FORTY FIVE POUNDS to the said Colin James Barclay by the said Campbell Barclay for equality of partition DO HEREBY TRANSFER to the said THOMAS BARCLAY all our estate and interest in ALL that piece of land being the whole of the land particularly described in Certificate of Title entered in the Register Book Volume 7551 Folio 200 save and except thereout All those

PRIMARY INSTRUMENT STAMPED WITH DUTY £ 1.5.8 ON 24-7-65
A.G. Richardson
CONTROLLER OF STAMPS
VICTORIA

NO CERT TO ISSUE ON C 288441 W 1/10/65
91.636/167 W
2839/772 W
2627/221 W
For setting out see page 3
6570/222 W
8576/336 W

pieces of land being Lots One and Two on Plan of Subdivision Number 65810 lodged in the Office of Titles and also all those pieces of land being the whole of the land described in Certificates of Title Volume 636 Folio 167, Volume 2839 Folio 772, and Volume 2687 Folio 234 together with all registered appurtenant and reserved easements and together with full and free right and liberty for the transferee, his executors administrators and transferees the registered proprietor or proprietors for the time being of that part of the land described in Certificate of Title Volume 7551 Folio 200 hereby transferred or any part thereof to use at all times hereafter in common with the transferors and the registered proprietor or proprietors for the time being of the whole of the land included in the said Plan of Subdivision or any part thereof for drainage purposes all the land colored purple on the said Plan of Subdivision RESERVING unto the transferors and the

13697
AMENDED with Form 10
Solicitors for Paul Parker P. 29.9.65

25 MAR 1966
6/4/66
20.9.65



ADVERTISED PLAN

Barclay

registered proprietor or proprietors for the time being of the land or any part thereof included in the said Plan of Sub-division full and free right and liberty to use the land delineated and colored ^{blue} ~~purple~~ on the map endorsed hereon being part of the land described in the said Certificate of Title Volume 7551 Folio 200 for drainage purposes.

DATED the 20th day of September 1964.

SIGNED by the said COLIN JAMES BARCLAY in Victoria in the presence of:

Colin Barclay

Colin Barclay

SIGNED by the said THOMAS BARCLAY in Victoria in the presence of:

T. Barclay

Colin Barclay

SIGNED by the said CAMPBELL BARCLAY in Victoria in the presence of:

C. Barclay

Colin Barclay

This copied document to be made available for the sole purpose of enabling its consideration and review as part of a planning process under the Planning and Environment Act 1987. The document must not be used for any purpose which may breach any copyright

ENCUMBRANCES REFERRED TO: The Encumbrances (if any) as set out in the said Certificates of Title.

ADVERTISED PLAN

ADVERTISED PLAN

SKETCH PLAN FOR CREATION OF EASEMENT
OUT OF SUBD. A of 100 & A of 99

PARISH OF WARRACBARUNAH

Scale = 3 Chains to an Inch.



DC288450-2-4

PT OF C/T 7751/200

COLOUR CODE

Y=Yellow O=Orange BR=Brown
G=Green R=Red BL=Blue P=Purple
H=Hatched CH=Cross Hatched

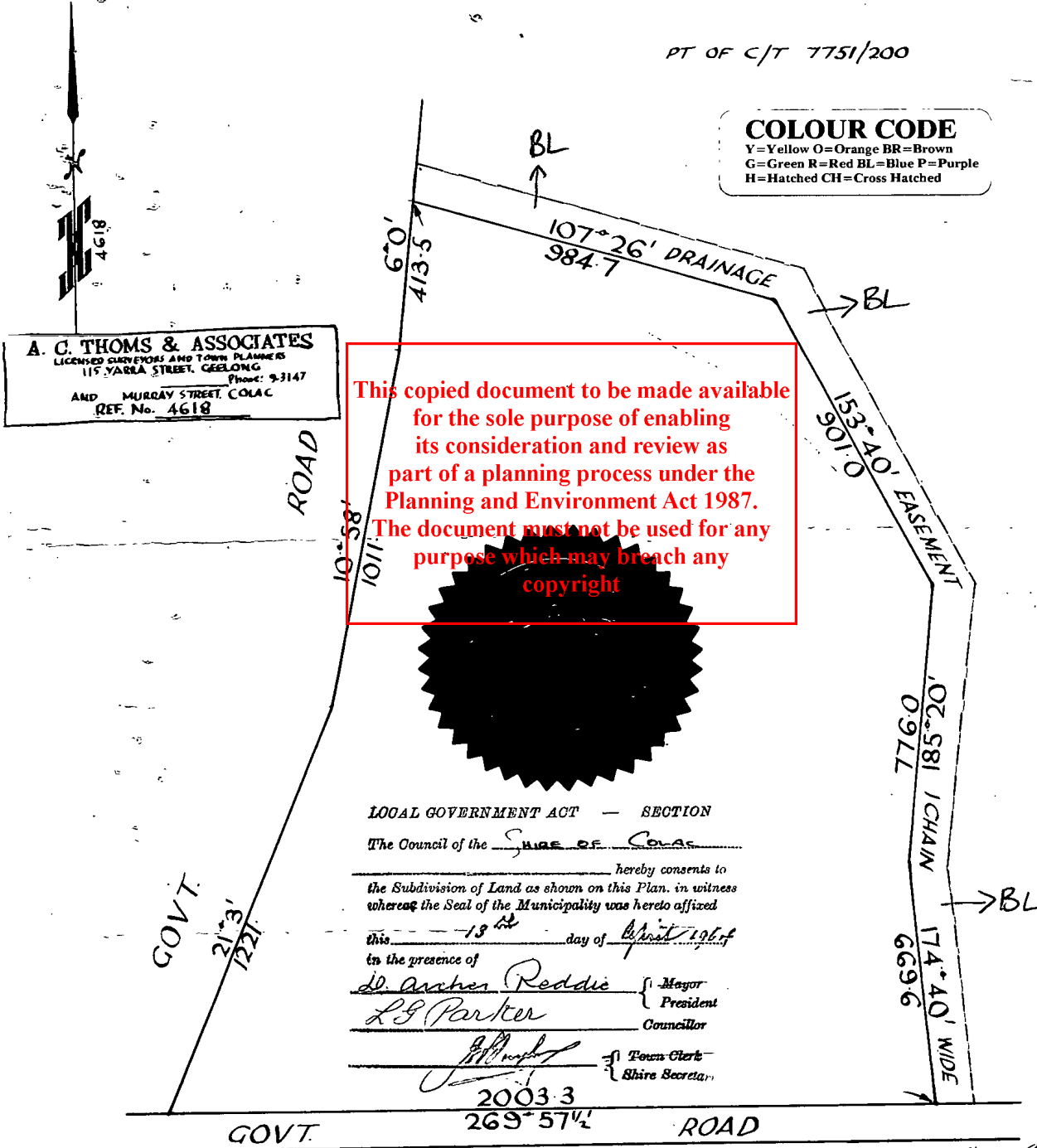

A. C. THOMS & ASSOCIATES
LICENSED SURVEYORS AND TOWN PLANNERS
115 YARRA STREET, GEELONG Phone: 9-3147
AND MURRAY STREET, COLAC
REF. No. 4618

This copied document to be made available for the sole purpose of enabling its consideration and review as part of a planning process under the Planning and Environment Act 1987. The document must not be used for any purpose which may breach any copyright

LOCAL GOVERNMENT ACT — SECTION
The Council of the SHIRE OF COLAC
hereby consents to
the Subdivision of Land as shown on this Plan, in witness
whereof the Seal of the Municipality was hereto affixed
this 18th day of August 1967
in the presence of
D. Archer Reddie } Mayor
L. S. Parker } President
Councillor
[Signature] } Town Clerk
Shire Secretary

2003-3

J. H. Harman, L.S.
S.A.C.T.

ADVERTISED PLAN

Delivered by LANDATA®, timestamp 12/09/2025 16:02 Page 4 of 6

 **Natural Resources and Environment**
AGRICULTURE • RESOURCES • CONSERVATION • LAND MANAGEMENT

**INTENTIONALLY
BLANK**

**This copied document to be made available
for the sole purpose of enabling
its consideration and review as
part of a planning process under the
Planning and Environment Act 1987.
The document must not be used for any
purpose which may breach any
copyright**

Page 3.

PURPLE & BLUE HATCHED (50%)
FEE: RED, BLUE & GREEN

C/T TO ISSUE ON
C. 288449 Wh @ Revh

AREA: 1712A 3R 7P.
Being Subdivisions A, B and C
of Cr. Allots 100, 102, 103,
104, 118 and 120 and
Subdivisions A and B
of Cr. Allots 99, 101, 105,
117 and 119 and
part of Subdivisions A and B
of Crown Allot. 121

Parish of Nannucharunah

County of Grenville

L.P. 65810

This copied document to be made available
for the sole purpose of enabling
its consideration and review as
part of a planning process under the
Planning and Environment Act 1987

The document must not be used for any
purpose which may breach any
copyright

NO COPY - As to Others

cf. 8576/-335 } C/E
8576/-336 } C/E

[Signature]

27/4/66

[Signature]
13/4/66



DC288450-3-1

ADVERTISED
PLAN

DATED 20th September 1964

C.J. BARCLAY, T. BARCLAY
and C. BARCLAY

-to-

J. BARCLAY

TRANSFER OF LAND

McnAB & McNAB,
17 Queen Street,
MELBOURNE, C.I.
Solicitors

**This copied document to be made available
for the sole purpose of enabling
its consideration and review as
part of a planning process under the
Planning and Environment Act 1987.
The document must not be used for any
purpose which may breach any**

A memorandum ^{copyright} within instrument
has been entered in the Register Book



8613-394
2687-234
2839-772
636-167
8576-335/6

**ADVERTISED
PLAN**

C288451

10-12 C288451 AUG13-65

B

McNAB & McNAB

REGD.

VICTORIA

TRANSFER OF LAND

NEW TITLE

P. No Cert

We, COLIN JAMES BARCLAY of "Mingawalla" Beeac THOMAS BARCLAY of "Tarana" Beeac and CAMPBELL BARCLAY of "Kirkcaldy" Beeac

Graziers being registered as the proprietors as tenants in common in equal shares of an estate in fee simple in the land hereinafter described subject to the encumbrances notified hereunder in consideration of two transfers of land under the operation of the Transfer of Land Acts of even date herewith and two Conveyances of Land under the General Law of even date herewith all made between the parties hereto

Case 29/9/65

are agreement to partition the said land and other land in further consideration hereunder in consideration of two transfers of land under the operation of the Transfer of Land Acts of even date herewith and two Conveyances of Land under the General Law of even date herewith all made between the parties hereto

NOT CHARGEABLE WITH STAMP DUTY 22 JUL 1965 D. G. RICHARDS, Comptroller of Stamp Duties VICTORIA

This copy of this document is made available for the sole purpose of enabling its consideration and review as part of a planning process under the Planning and Environment Act 1987. The document must not be used for any purpose which may breach that copyright.

the sum of FIFTY THREE POUNDS AND FIVE PENCE having been paid to the said Colin James Barclay by the said Thomas Barclay and the sum of ONE HUNDRED AND FORTY FIVE POUNDS AND FIVE PENCE to the said Colin James Barclay by the said Campbell Barclay for equality of partition DO HEREBY TRANSFER to the said COLIN JAMES BARCLAY

all our estate and interest in that piece of land being Lot One on Plan of Subdivision Number 65810 lodged in the Office of Titles being part of the land more particularly described in Certificate of Title entered in the Register Book Volume 7551 Folio 200 together with all registered appurtenant and reserved easements and together with full and free right and liberty for the transferee his executors administrators and transferees the registered proprietor or proprietors for the time being of the land hereby transferred or any part thereof to use at all times hereafter in common with the transferors and the registered proprietor or proprietors for the time being of the land described in the said Certificate of Title other than the land hereby transferred or any part thereof for drainage purposes all the land being that part of Lot Two on the said Plan of Subdivision colored purple thereon and also the land delineated and colored purple on the map endorsed hereon and being part of the land described in the said Certificate of Title RESERVING unto the transferors and the registered proprietor or proprietors for the time being of the whole or any part of the

No Cert.

Gr. 8576/335 Wh + Res

Gr. 8576/336 Gr

25 MAR 1966 JTC 6/4/66

*N.B. Blue on Plan Room Copy.

29/9/65

nothing being paid by the said Colin James Barclay

3043

AMENDEP Solicitors for families

8576/336

21/10/65



DC288451-1-2

ADVERTISED PLAN

8524336
Stalew
2/19/65
6
2/28/85
325

Lot 2 on the Plan of Subdivision No 65870
~~land described in the said Certificate of Title other than the~~
~~land hereby transferred~~ full and free right and liberty to use
the land being that part of the said Lot One colored ^{blue} purple
on the said Plan of Subdivision for drainage purposes.

DATED the 20th day of September 1964.

SIGNED by the said COLIN JAMES BARCLAY } *Colin Barclay*
in Victoria in the presence of: } *Colin Barclay*

SIGNED by the said THOMAS BARCLAY } *T. Barclay*
in Victoria in the presence of: } *Thomas Barclay*

SIGNED by the said CAMPBELL BARCLAY } *C. Barclay*
in Victoria in the presence of: } *Campbell Barclay*

This copied document to be made available
for the sole purpose of enabling
its consideration and review as
part of a planning process under the
Planning and Environment Act 1987.
The document must not be used for any
purpose which may breach any
copyright

ENCUMBRANCES REFERRED TO:
The encumbrances (if any)
as set out in the said
Certificate of Title.

**This copied document to be made available
for the sole purpose of enabling
its consideration and review as
part of a planning process under the
Planning and Environment Act 1987.
The document must not be used for any
purpose which may breach any
copyright**



DC288451-2-9

**ADVERTISED
PLAN**

DATED 20th September 1964

C.J. BARCLAY, T. BARCLAY
and C. BARCLAY

-to-

C.J. BARCLAY

TRANSFER OF LAND

McNAB & McNAB,
17 Queen Street,
MELBOURNE, C.I.
Solicitors

This copied document to be made available for the sole purpose of enabling its consideration and review as part of a planning process under the Planning and Environment Act 1987. The document must not be used for any purpose which may breach any copyright

A memorandum of the within instrument has been entered in the Register Book



ADVERTISED
PLAN