

**REGISTER SEARCH STATEMENT (Title Search) Transfer of
Land Act 1958**

Page 1 of 1

VOLUME 07015 FOLIO 852

Security no : 124089683013S
Produced 04/05/2021 02:47 PM

LAND DESCRIPTION

Crown Allotment 13B and Crown Allotment 18A Parish of Mangalore.
PARENT TITLE Volume 04239 Folio 642
Created by instrument 2085792 09/07/1947

REGISTERED PROPRIETOR

Estate Fee Simple
Sole Proprietor
MICHAEL JOSEPH O'CONNOR of 101 COOMBS ROAD MANGALORE VIC 3663
AF829073K 08/05/2008

ENCUMBRANCES, CAVEATS AND NOTICES

For details of any other encumbrances see the plan or imaged folio set out under DIAGRAM LOCATION below.

DIAGRAM LOCATION

SEE TP303384C FOR FURTHER DETAILS AND BOUNDARIES

ACTIVITY IN THE LAST 125 DAYS

NIL

DOCUMENT END

**This copied document to be made available
for the sole purpose of enabling
its consideration and review as
part of a planning process under the
Planning and Environment Act 1987.
The document must not be used for any
purpose which may breach any
copyright**

**ADVERTISED
PLAN**



Imaged Document Cover Sheet

The document following this cover sheet is an imaged document supplied by LANDATA®, Victorian Land Registry Services.

Document Type	Plan
Document Identification	TP303384C
Number of Pages (excluding this cover sheet)	1
Document Assembled	04/05/2021 15:11

Copyright and disclaimer notice:

© State of Victoria. This publication is copyright. No part may be reproduced by any process except in accordance with the provisions of the Copyright Act 1968 (Cth) and for the purposes of Section 32 of the Sale of Land Act 1962 or pursuant to a written agreement. The information is only valid at the time and in the form obtained from the LANDATA® System. None of the State of Victoria, LANDATA®, Victorian Land Registry Services Pty. Ltd. ABN 86 627 986 396 as trustee for the Victorian Land Registry Services Trust ABN 83 206 746 897 accept responsibility for any subsequent release, publication or reproduction of the information.

The document is invalid if this cover sheet is removed or altered.

**ADVERTISED
PLAN**

This copied document to be made available for the sole purpose of enabling its consideration and review as part of a planning process under the Planning and Environment Act 1987. The document must not be used for any purpose which may breach any copyright

TITLE PLAN	EDITION 1	TP 303384C
------------	-----------	------------

<p>Location of Land</p> <p>Parish: MANGALORE Township: Section: Crown Allotment: 13B, 18A Crown Portion:</p> <p>Last Plan Reference: Derived From: VOL 7015 FOL 852 Depth Limitation: NIL</p>	<p>Notations</p> <p>ANY REFERENCE TO MAP IN THE TEXT MEANS THE DIAGRAM SHOWN ON THIS TITLE PLAN</p>
--	--

Description of Land / Easement Information

This copied document to be made available for the sole purpose of enabling its consideration and review as part of a planning process under the Planning and Environment Act 1987. The document must not be used for any purpose which may breach any copyright

THIS PLAN HAS BEEN PREPARED FOR THE LAND REGISTRY, LAND VICTORIA, FOR TITLE DIAGRAM PURPOSES AS PART OF THE LAND TITLES AUTOMATION PROJECT

COMPILED: 07-02-2000
 VERIFIED: AD

ADVERTISED PLAN

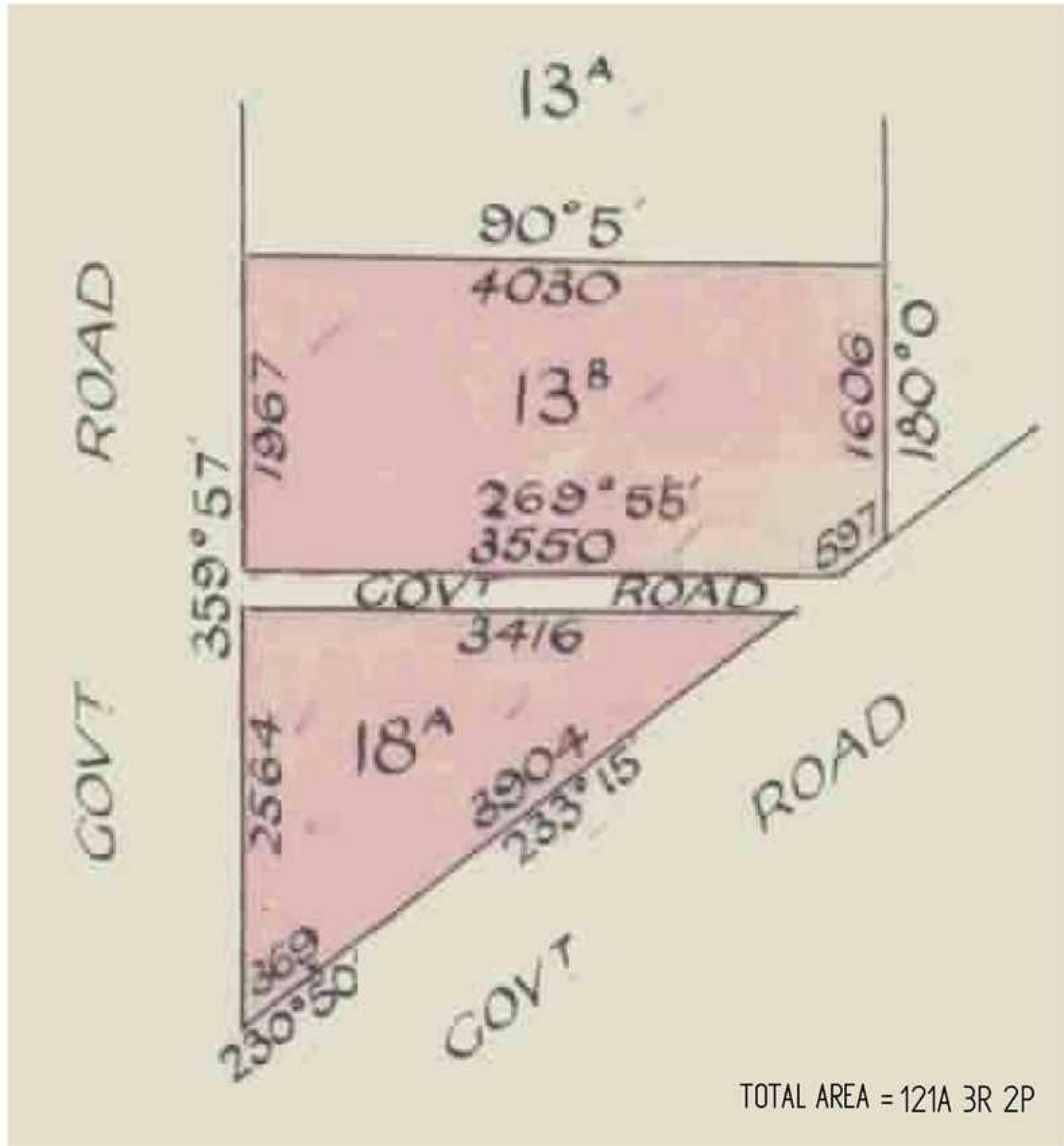

CROWN FOLIO STATEMENT

VOLUME 11751 FOLIO 521
No Coft exists

Security no : 124089723554C
Produced 06/05/2021 09:15 AM

CROWN FOLIO

LAND DESCRIPTION

Crown Allotment 40A Parish of Mangalore.
Created by instrument MI140560T 06/08/2016

CROWN LAND ADMINISTRATOR

VICTORIAN RAIL TRACK of LEVEL 8 1010 LA TROBE STREET DOCKLANDS VIC 3008
MI140560T 06/08/2016

STATUS, ENCUMBRANCES AND NOTICES

DIAGRAM LOCATION

SEE CD055622N FOR FURTHER DETAILS AND BOUNDARIES

ACTIVITY IN THE LAST 125 DAYS

NIL

-----END OF CROWN FOLIO STATEMENT-----

Additional information: (not part of the Crown Folio Statement)

Street Address: SEYMOUR-AVENEL ROAD SEYMOUR VIC 3660

DOCUMENT END

**ADVERTISED
PLAN**

**This copied document to be made available
for the sole purpose of enabling
its consideration and review as
part of a planning process under the
Planning and Environment Act 1987.
The document must not be used for any
purpose which may breach any
copyright**



Imaged Document Cover Sheet

The document following this cover sheet is an imaged document supplied by LANDATA®, Victorian Land Registry Services.

Document Type	Plan
Document Identification	CD055629X
Number of Pages (excluding this cover sheet)	1
Document Assembled	04/05/2021 14:25

Copyright and disclaimer notice:

© State of Victoria. This publication is copyright. No part may be reproduced by any process except in accordance with the provisions of the Copyright Act 1968 (Cth) and for the purposes of Section 32 of the Sale of Land Act 1962 or pursuant to a written agreement. The information is only valid at the time and in the form obtained from the LANDATA® System. None of the State of Victoria, LANDATA®, Victorian Land Registry Services Pty. Ltd. ABN 86 627 986 396 as trustee for the Victorian Land Registry Services Trust ABN 83 206 746 897 accept responsibility for any subsequent release, publication or reproduction of the information.

The document is invalid if this cover sheet is removed or altered.

This copied document to be made available for the sole purpose of enabling its consideration and review as part of a planning process under the Planning and Environment Act 1987. The document must not be used for any purpose which may breach any copyright

**ADVERTISED
PLAN**

CROWN DIAGRAM

CD055629X

Location of Land

Parish : MANGALORE
Allotment : 68J

This plan has been created to assist in locating a Crown land parcel
Warning: No warranty is given as to the accuracy or completeness of this plan
Any derived dimensions are approximate

Standard Parcel Identifier (SPI) : 68JPP3053
Vicmap Parcel PFI : 52516228

Coordinate Position
MGA : 335820, 5903770 (55)
Vicroads Directory Reference : 46 D9 (ed. 6)

Compiled from VICMAP cadastral mapping data

Date: 22/05/2009

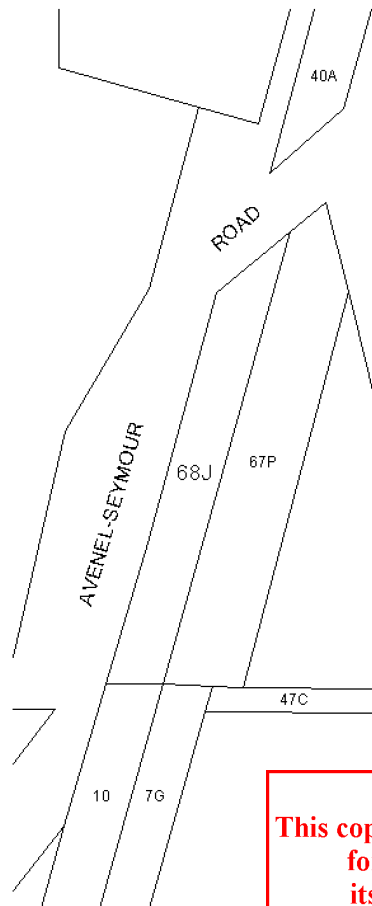

ADVERTISED PLAN

This copied document to be made available for the sole purpose of enabling its consideration and review as part of a planning process under the Planning and Environment Act 1987. The document must not be used for any purpose which may breach any copyright

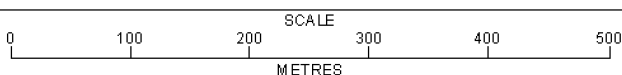

**REGISTER SEARCH STATEMENT (Title Search) Transfer of
Land Act 1958**

VOLUME 09508 FOLIO 904

Security no : 124089681225L
Produced 04/05/2021 02:14 PM

LAND DESCRIPTION

Lots 1,2,3,4,5,6,7,8,9,10,11,12,13,14,15,16,17 and 18 on Title Plan 097266B (formerly known as part of Crown Allotment 15F, part of Crown Allotment 16, Crown Allotments 16A,16B and 16C, part of Crown Allotment 16D, part of Crown Allotment 16E, part of Crown Allotment 16F, Crown Allotments 17,18,19A,19B and 20, part of Crown Allotment 20A, part of Crown Allotment 42B, Crown Allotment 45E, part of Crown Allotment 45F, Crown Allotment 45G Parish of Mangalore).

PARENT TITLES :

Volume 07404 Folio 639
Volume 09011 Folio 877 to Volume 09011 Folio 878
Created by instrument K200492 16/10/1980

REGISTERED PROPRIETOR

Estate Fee Simple
Sole Proprietor
THE COMMONWEALTH OF AUSTRALIA
K200492 16/10/1980

ENCUMBRANCES, CAVEATS AND NOTICES

Any encumbrances created by Section 98 Transfer of Land Act 1958 or Section 24 Subdivision Act 1988 and any other encumbrances shown or entered on the plan set out under DIAGRAM LOCATION below.

DIAGRAM LOCATION

SEE TP097266B FOR FURTHER DETAILS AND BOUNDARIES

**ADVERTISED
PLAN**

ACTIVITY IN THE LAST 125 DAYS

NIL

DOCUMENT END

This copied document to be made available for the sole purpose of enabling its consideration and review as part of a planning process under the Planning and Environment Act 1987. The document must not be used for any purpose which may breach any copyright

Imaged Document Cover Sheet

The document following this cover sheet is an imaged document supplied by LANDATA®, Victorian Land Registry Services.

Document Type	Plan
Document Identification	TP097266B
Number of Pages (excluding this cover sheet)	2
Document Assembled	04/05/2021 14:29

Copyright and disclaimer notice:

© State of Victoria. This publication is copyright. No part may be reproduced by any process except in accordance with the provisions of the Copyright Act 1968 (Cth) and for the purposes of Section 32 of the Sale of Land Act 1962 or pursuant to a written agreement. The information is only valid at the time and in the form obtained from the LANDATA® System. None of the State of Victoria, LANDATA®, Victorian Land Registry Services Pty. Ltd. ABN 86 627 986 396 as trustee for the Victorian Land Registry Services Trust ABN 83 206 746 897 accept responsibility for any subsequent release, publication or reproduction of the information.

The document is invalid if this cover sheet is removed or altered.

This copied document to be made available for the sole purpose of enabling its consideration and review as part of a planning process under the Planning and Environment Act 1987. The document must not be used for any purpose which may breach any copyright

**ADVERTISED
PLAN**

	TITLE PLAN	EDITION 1	TP 97266B
--	-------------------	------------------	------------------

<p>Location of Land</p> <p>Parish: MANGALORE</p> <p>Crown Allotment: 16A, 16B, 16C, 17, 18, 19A, 19B, 20, 45E, 45G, 15F(PT), 16(P,T), 16D(PT), 16E(PT), 16F(PT), 20A(PT), 42B(PT), 45F(PT)</p> <p>Derived From: VOL 9508 FOL 904</p> <p>Depth Limitation: 15.24 m (CA16E(PT)) 45.72 m (CA16A, CA45G, CA16F(PT)) 75.00m (CA15F(PT), CA42B(PT))</p>	<p style="text-align: center;">Notations</p> <p>ANY REFERENCE TO MAP IN THE TEXT MEANS THE DIAGRAM SHOWN ON THIS TITLE PLAN</p>
---	--

<p style="text-align: center;">Description of Land / Easement Information</p> <p style="text-align: center;">all those pieces of - -</p> <p>land in the Parish of Mangalore County of Anglesey being Crown - - - - - Allotments 16^A 16^B 16^C 17 18 19^A 19^B 20 45^E and 45^G and part of Crown - - - Allotments 15^F 16 16^D 16^E 16^F 20^A 42^B and 45^F which land is shown enclosed by continuous lines on the map on sheet 2 The said part - of Crown Allotment 16^E being limited to so much as lies above the depth -- of 15.24 METRES below the surface and the said Crown - - - - - Allotments 16^A and 45^G and part of Crown Allotment 16^F being limited to so much as lies above the depth of 45.72 METRES below the surface and the - - said part of Crown Allotments 15^F and 42^B being limited to so much as - - lies above the depth of 75 METRES below the surface TOGETHER WITH - - - - Crown Allotments 16^A 16^B 16^C 17 18 19^A 19^B 20 45^E and 45^G and part of - - Crown Allotments 16 16^D 16^E 16^F 20^A and 45^F TOGETHER WITH a right to use - the cable way easement shown marked X - - - - -</p>	<p>THIS PLAN HAS BEEN PREPARED FOR THE LAND REGISTRY, LAND VICTORIA, FOR TITLE DIAGRAM PURPOSES AS PART OF THE LAND TITLES AUTOMATION PROJECT</p> <p>COMPILED: 05/08/1999 VERIFIED: BC</p>
---	--

SEE SHEET 2 FOR DIAGRAM

This copied document to be made available for the sole purpose of enabling its consideration and review as part of a planning process under the Planning and Environment Act 1987. The document must not be used for any purpose which may breach any copyright

TABLE OF PARCEL IDENTIFIERS
WARNING: Where multiple parcels are referred to or shown on this Title Plan this does not imply separately disposable parcels under Section 8A of the Sale of Land Act 1962
PARCEL 1 = CA 16A
PARCEL 2 = CA 16B
PARCEL 3 = CA 16C
PARCEL 4 = CA 17
PARCEL 5 = CA 18
PARCEL 6 = CA 19A
PARCEL 7 = CA 19B
PARCEL 8 = CA 20
PARCEL 9 = CA 45E
PARCEL 10 = CA 45G
PARCEL 11 = CA 15F (PT)
PARCEL 12 = CA 16 (PT)
PARCEL 13 = CA 16D (PT)
PARCEL 14 = CA 16E (PT)
PARCEL 15 = CA 16F (PT)
PARCEL 16 = CA 20A (PT)
PARCEL 17 = CA 42B (PT)
PARCEL 18 = CA 45F (PT)

ADVERTISED PLAN

TITLE PLAN

TP 97266B

ADVERTISED PLAN

This copied document to be made available for the sole purpose of enabling its consideration and review as part of a planning process under the Planning and Environment Act 1987. The document must not be used for any purpose which may breach any copyright

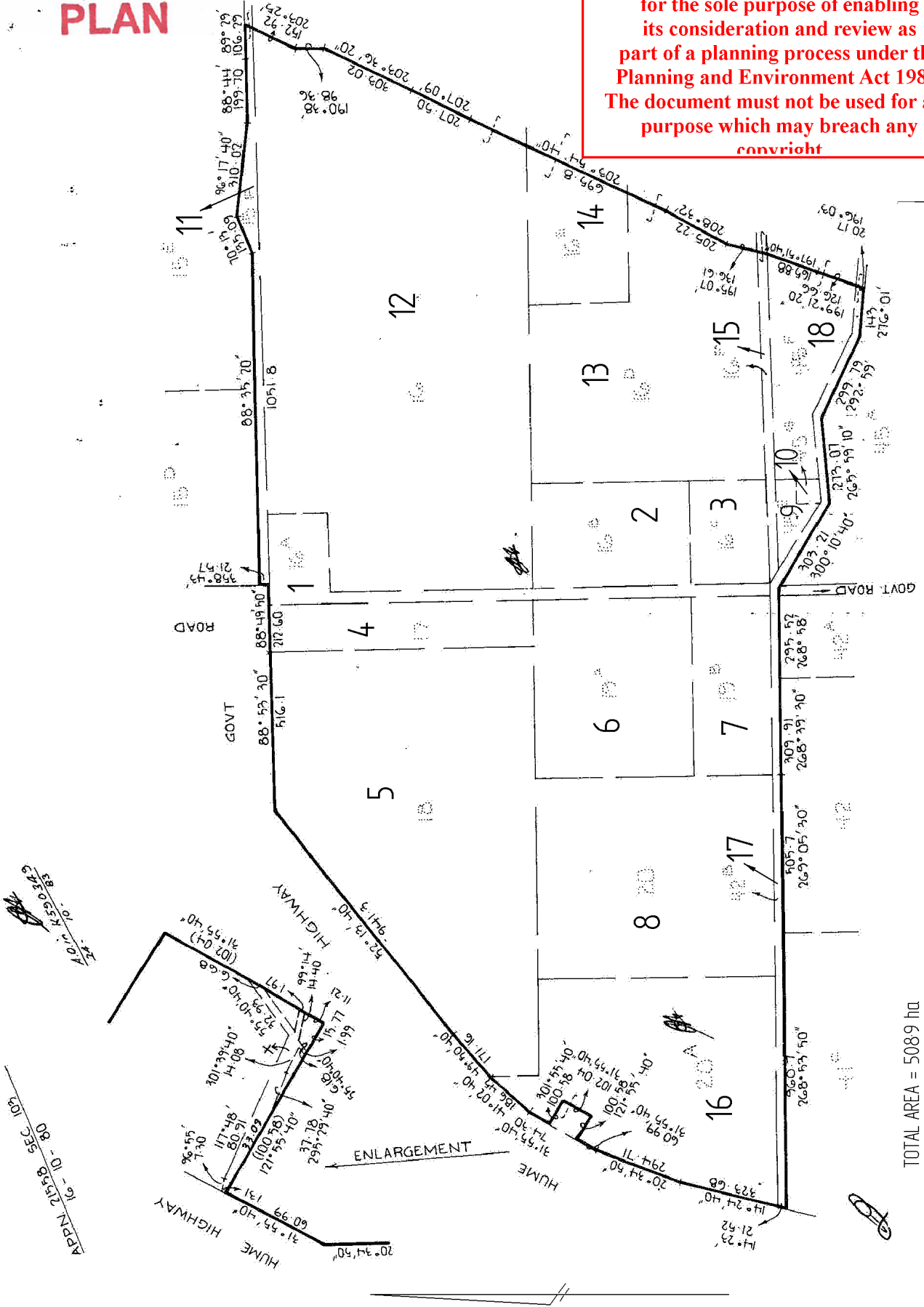

TOTAL AREA = 508.9 ha

LENGTHS ARE IN METRES

Metres = 0.3048 x Feet
Metres = 0.201168 x Links

Sheet 2 of 2 sheets