

Copyright State of Victoria. No part of this publication may be reproduced except as permitted by the Copyright Act 1968 (Cth), to comply with a statutory requirement or pursuant to a written agreement. The information is only valid at the time and in the form obtained from the LANDATA REGD TM System. None of the State of Victoria, its agents or contractors, accepts responsibility for any subsequent publication or reproduction of the information.

The Victorian Government acknowledges the Traditional Owners of Victoria and pays respects to their ongoing connection to their Country, History and Culture. The Victorian Government extends this respect to their Elders, past, present and emerging.

REGISTER SEARCH STATEMENT (Title Search) Transfer of Land Act 1958

VOLUME 10333 FOLIO 573

Security no : 124129324173A
Produced 24/10/2025 04:57 PM

LAND DESCRIPTION

Lot 3 on Plan of Subdivision 409088E.
PARENT TITLES :
Volume 09516 Folio 511 Volume 09585 Folio 839
Created by instrument PS409088E 23/06/1997

REGISTERED PROPRIETOR

Estate Fee Simple
Sole Proprietor
AUSTRALIAN BLUEGUM PLANTATIONS PTY LTD of MINTER ELLISON LEVEL 23 535
COLLINS STREET MELBOURNE VIC 3000
AG859436V 10/11/2009

ENCUMBRANCES, CAVEATS AND NOTICES

MORTGAGE AG865136Y 12/11/2009
AUSTRALIA AND NEW ZEALAND BANKING GROUP LTD

CAVEAT AZ620836W 23/09/2025

Caveator
MEH SUBCO PTY LTD ACN: 686683214
Grounds of Claim
AGREEMENT WITH THE FOLLOWING PARTIES AND DATE.
Parties
THE REGISTERED PROPRIETOR(S), MEHSUBCOPTYLTD ACN: 686683214
Date
22/08/2025
Estate or Interest
EXECUTORY OR CONTINGENT INTEREST
Prohibition
ABSOLUTELY
Lodged by
CORRS CHAMBERS WESTGARTH
Notices to
SIMON CHIARELLI of LEVEL 22 567 COLLINS STREET MELBOURNE VIC 3000

Any encumbrances created by Section 98 Transfer of Land Act 1958 or Section 24 Subdivision Act 1988 and any other encumbrances shown or entered on the plan set out under DIAGRAM LOCATION below.

DIAGRAM LOCATION

SEE PS409088E FOR FURTHER DETAILS AND BOUNDARIES

ACTIVITY IN THE LAST 125 DAYS

NUMBER	STATUS	DATE
AZ620836W (E)	CAVEAT Registered	23/09/2025

-----END OF REGISTER SEARCH STATEMENT-----

Additional information: (not part of the Register Search Statement)

Street Address: CONNEWARREN LANE MORTLAKE VIC 3272

ADMINISTRATIVE NOTICES

NIL

This copied document to be made available for the sole purpose of enabling its consideration and review as part of a planning process under the Planning and Environment Act 1987. The document must not be used for any purpose which may breach any copyright

ADVERTISED PLAN

eCT Control 20596W AUSTRALIA AND NEW ZEALAND BANKING GROUP LIMITED
Effective from 11/10/2019

DOCUMENT END

Delivered from the LANDATA® System by Dye & Durham Solutions Pty Ltd

ADVERTISED PLAN

**This copied document to be made available
for the sole purpose of enabling
its consideration and review as
part of a planning process under the
Planning and Environment Act 1987.
The document must not be used for any
purpose which may breach any
copyright**



Department of Environment, Land, Water & Planning

Electronic Instrument Statement

Copyright State of Victoria. No part of this publication may be reproduced except as permitted by the Copyright Act 1968 (Cth), to comply with a statutory requirement or pursuant to a written agreement. The information is only valid at the time and in the form obtained from the LANDATA REGD TM System. None of the State of Victoria, its agents or contractors, accepts responsibility for any subsequent publication or reproduction of the information.

The Victorian Government acknowledges the Traditional Owners of Victoria and pays respects to their ongoing connection to their Country, History and Culture. The Victorian Government extends this respect to their Elders, past, present and emerging.

Produced 24/10/2025 04:58:06 PM

Status	Registered	Dealing Number	AZ620836W
Date and Time Lodged	23/09/2025 10:31:27 AM		

Lodger Details

Lodger Code	19207U
Name	CORRS CHAMBERS WESTGARTH
Address	
Lodger Box	
Phone	
Email	
Reference	9207095/06-MEH Cav3

This copied document to be made available for the sole purpose of enabling its consideration and review as part of a planning process under the Planning and Environment Act 1987. The document must not be used for any purpose which may breach any copyright.

CAVEAT

Jurisdiction VICTORIA

Privacy Collection Statement

The information in this form is collected under statutory authority and used for the purpose of maintaining publicly searchable registers and indexes.

Land Title Reference

10333/573

Caveator

Name	MEH SUBCO PTY LTD
ACN	686683214

Grounds of claim

Agreement with the following Parties and Date.

Parties

The Registered Proprietor(s)

Name	MEHSUBCOPTYLTD
ACN	686683214

Date

22/08/2025

ADVERTISED
PLAN

Estate or Interest claimed

Executory or Contingent Interest

Prohibition

Absolutely





Department of Environment, Land, Water & Planning

Electronic Instrument Statement

Name and Address for Service of Notice

Simon Chiarelli

Address

Floor Type	LEVEL
Floor Number	22
Street Number	567
Street Name	COLLINS
Street Type	STREET
Locality	MELBOURNE
State	VIC
Postcode	3000

The caveator claims the estate or interest specified in the land described on the grounds set out. This caveat forbids the registration of any instrument affecting the estate or interest to the extent specified.

Execution

1. The Certifier has taken reasonable steps to verify the identity of the caveator or his, her or its administrator or attorney.
2. The Certifier has retained the evidence supporting this Registry Instrument or Document.
3. The Certifier has taken reasonable steps to ensure that this Registry Instrument or Document is correct and compliant with relevant law and any Prescribed Requirement.

Executed on behalf of	MEH SUBCO PTY LTD
Signer Name	DAVID ELLENBY
Signer Organisation	CORRS CHAMBERS WESTGARTH
Signer Role	AUSTRALIAN LEGAL PRACTITIONER
Execution Date	23 SEPTEMBER 2025

File Notes:

NIL

This is a representation of the digitally signed Electronic Instrument or Document certified by Land Use Victoria.

Statement End.

**ADVERTISED
PLAN**

This copied document to be made available for the sole purpose of enabling its consideration and review as part of a planning process under the Planning and Environment Act 1987. The document must not be used for any purpose which may breach any copyright

PLAN OF SUBDIVISION	STAGE No. <hr/>	LTO USE ONLY EDITION 3	PLAN NUMBER PS 409088E
----------------------------	--------------------	-----------------------------------	-----------------------------------

LOCATION OF LAND

PARISH: CONNEWARREN

TOWNSHIP:

SECTION: 8

CROWN ALLOTMENT: PART 8

CROWN PORTION:

LTO BASE RECORD:

TITLE REFERENCES: Vol. 9585 Fol. 839
Vol. 9516 Fol. 511

LAST PLAN REFERENCE/S: Lot 1 on LP 134811
Lot 2 on LP 135944

POSTAL ADDRESS: BOONERAH ESTATE RD.
(At time of subdivision) MORTLAKE

AMG Co-ordinates
(of approx centre of land in plan) E 650 600 ZONE: 54
N 5 786 600

COUNCIL CERTIFICATION AND ENDORSEMENT

COUNCIL NAME: MOYNE SHIRE COUNCIL REF: 510/97

- This plan is certified under Section 6 of the Subdivision Act 1988.
- ~~This plan is certified under Section 11(7) of the Subdivision Act 1988. Date of original certification under Section 6, / /~~
- This is a statement of compliance issued under Section 21 of the Subdivision Act 1988.

OPEN SPACE

(i) A requirement for public open space under Section 18 of the Subdivision Act 1988 has/has not been made.

(ii) ~~The requirement has been satisfied.~~

(iii) ~~The requirement is to be satisfied in stage~~

Council Delegate
~~Council Seal~~
Date 16 / 4 / 97

Re-certified under Section 11(7) of the Subdivision Act 1988.

Council Delegate
Council Seal
Date / /

VESTING OF ROADS AND/OR RESERVES

IDENTIFIER	COUNCIL/BODY/PERSON
NIL	NIL

NOTATIONS
<p>STAGING This is/ is not a staged subdivision. Planning permit No. 9701511</p> <p>DEVELOPMENT</p> <p>NOTES</p> <p>LOTS 2 & 3 ARE THE SUBJECT OF THIS SURVEY.</p>

This copied document to be made available for the sole purpose of enabling its consideration and review as part of a planning process under the Planning and Environment Act 1987. The document must not be used for any purpose which may breach any copyright

ADVERTISED
PLAN

SURVEY. THIS PLAN IS/IS NOT BASED ON SURVEY IN PART
 THIS SURVEY HAS BEEN CONNECTED TO PERMANENT MARKS No.(s)
 IN PROCLAIMED SURVEY AREA No.

EASEMENT INFORMATION

LEGEND	A-Appurtenant Easement	E-Encumbering Easement	R-Encumbering Easement (Road)	
Easement Reference	Purpose	Width (Metres)	Origin	Land Benefited/In Favour Of
E - 1	TRANSMISSION OF ELECTRICITY	60	K 444957	STATE ELECTRICITY COMMISSION OF VICTORIA
E - 2	ELELCTRICITY SUPPLY	SEE DIAG.	THIS PLAN	POWERCOR
E - 3	TRANSMISSION OF ELECTRICITY	60	SECTION 103 STATE ELECTRICITY COMMISSION ACT 1958 SECTION 49 LANDS COMPENSATION ACT K 444943	S.E.C.V.
E-4	TRANSMISSION OF ELECTRICITY	60	AS468005A	AUSNET TRANSMISSION GROUP PTY LTD
E-5	TRANSMISSION OF ELECTRICITY	50	AS453269W	AUSNET TRANSMISSION GROUP PTY LTD

LTO USE ONLY

STATEMENT OF COMPLIANCE/
EXEMPTION STATEMENT

RECEIVED

DATE: 4 / 6 / 97

LTO USE ONLY

PLAN REGISTERED
TIME 1.30 PM
DATE 23 / 6 / 97

John D Teenan
Assistant Registrar of Titles

SHEET 1 OF 2 SHEETS

LAND MANAGEMENT SURVEYS (MELB)
2 SMALL STREET
HAMPTON 3188
Ph : 9597 0101 Fax : 9598 4323

LICENSED SURVEYOR(PRINT) PHILLIP JOSEPH DOOLEY

SIGNATURE DATE 7 / 4 / 97

REF 8369 VERSION 04

DATE 16 / 4 / 97

COUNCIL DELEGATE SIGNATURE

ORIGINAL SHEET SIZE A3

PLAN OF SUBDIVISION	STAGE No.	PLAN NUMBER
	/	PS 409088E

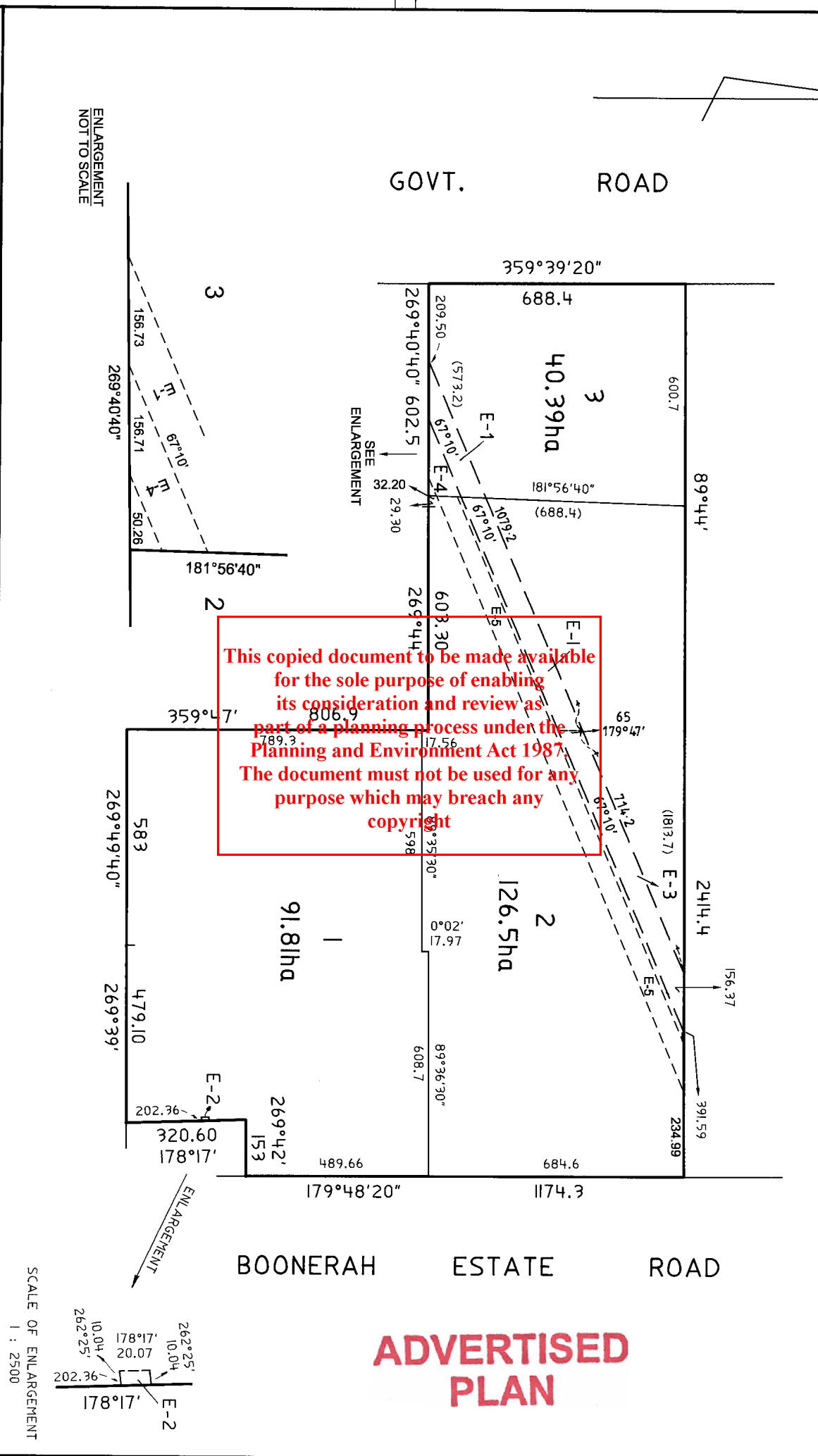

ADVERTISED PLAN

LAND MANAGEMENT SURVEYS (MELB)
 2 SMALL STREET
 HAMPTON 3188
 Ph : 9597 0101 Fax : 9598 4323

SCALE
 100 0 100 200 300 400 500
 LENGTHS ARE IN METRES

ORIGINAL SCALE 1:10000
 SHEET SIZE A3
 LICENSED SURVEYOR(PRINT) PHILLIP JOSEPH DOOLEY
 SIGNATURE REF 8369
 DATE / /
 VERSION 04

SHEET 2 OF 2 SHEETS
 DATE / /
 COUNCIL DELEGATE SIGNATURE

SCALE OF ENLARGEMENT 1 : 2500

ENLARGEMENT NOT TO SCALE

ENLARGEMENT NOT TO SCALE

