

Imaged Document Cover Sheet

The document following this cover sheet is an imaged document supplied by LANDATA®, Secure Electronic Registries Victoria.

Document Type	Plan
Document Identification	TP247098N
Number of Pages (excluding this cover sheet)	1
Document Assembled	15/01/2026 16:31

Copyright and disclaimer notice:

© State of Victoria. This publication is copyright. No part may be reproduced by any process except in accordance with the provisions of the Copyright Act 1968 (Cth) and for the purposes of Section 32 of the Sale of Land Act 1962 or pursuant to a written agreement. The information is only valid at the time and in the form obtained from the LANDATA® System. None of the State of Victoria, LANDATA®, Secure Electronic Registries Victoria Pty Ltd (ABN 86 627 986 396) as trustee for the Secure Electronic Registries Victoria Trust (ABN 83 206 746 897) accept responsibility for any subsequent release, publication or reproduction of the information.

The document is invalid if this cover sheet is removed or altered.

This copied document to be made available for the sole purpose of enabling its consideration and review as part of a planning process under the Planning and Environment Act 1987. The document must not be used for any purpose which may breach any copyright

**ADVERTISED
PLAN**

TITLE PLAN	EDITION 1	TP 247098N
-------------------	------------------	-------------------

Location of Land Parish: NUNAWADING Township: Section: Crown Allotment: Crown Portion: 115 (PT) Last Plan Reference: Derived From: VOL 4057 FOL 282 Depth Limitation: NIL	Notations ANY REFERENCE TO MAP IN THE TEXT MEANS THE DIAGRAM SHOWN ON THIS TITLE PLAN
--	---

Description of Land / Easement Information E-1 = EASEMENT CREATED BY C/E E973115	THIS PLAN HAS BEEN PREPARED FOR THE LAND REGISTRY, LAND VICTORIA, FOR TITLE DIAGRAM PURPOSES AS PART OF THE LAND TITLES AUTOMATION PROJECT COMPILED: 11/01/2000 VERIFIED: CP
--	--

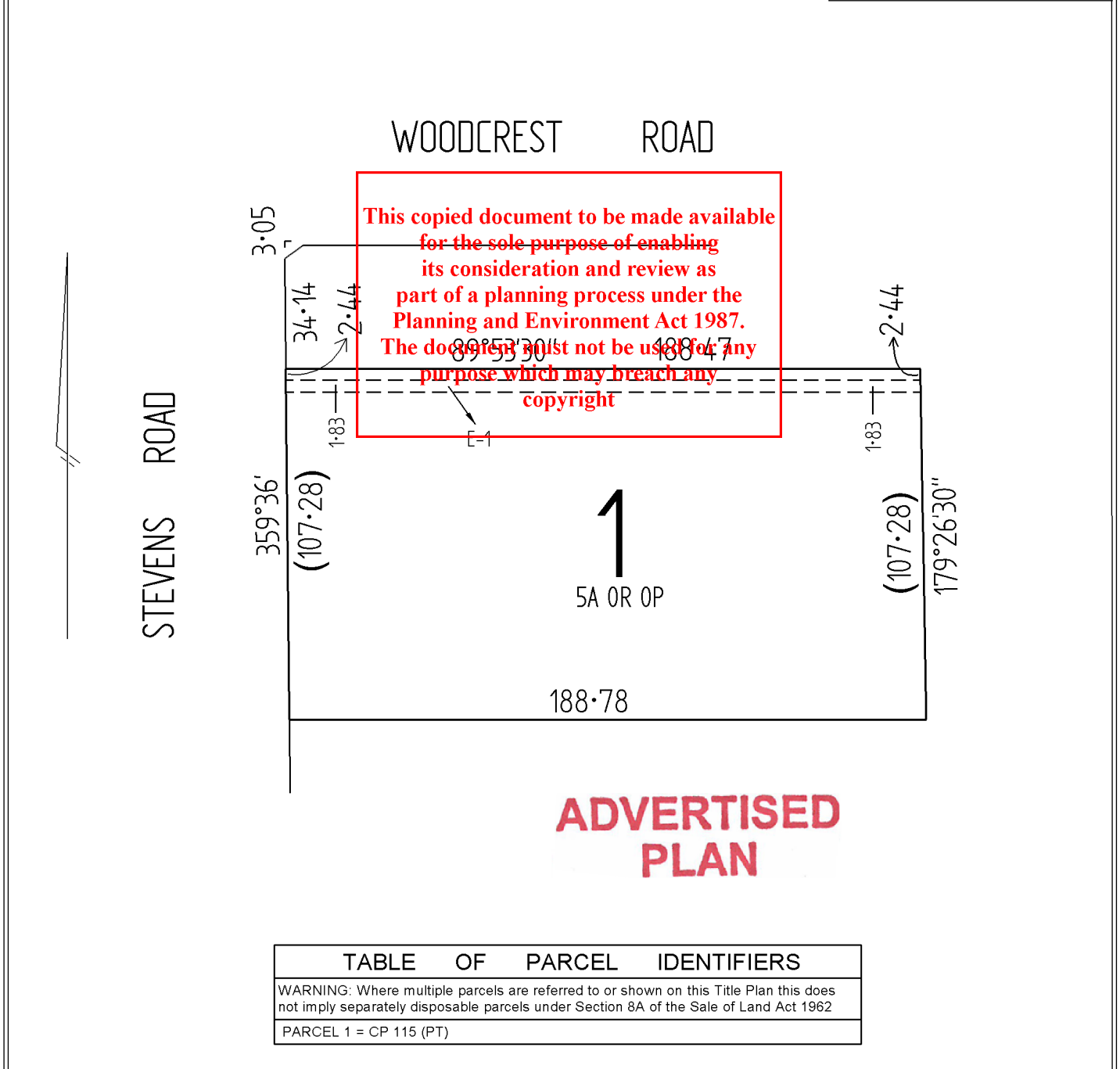

LENGTHS ARE IN METRES	Metres = 0.3048 x Feet Metres = 0.201168 x Links	Sheet 1 of 1 sheets
-----------------------	---	---------------------

**REGISTER SEARCH STATEMENT (Title Search) Transfer of
Land Act 1958**

VOLUME 04057 FOLIO 282

Security no : 124131369792C
Produced 15/01/2026 04:31 PM

LAND DESCRIPTION

Lot 1 on Title Plan 247098N (formerly known as part of Portion 115 Parish of Nunawading).
PARENT TITLE Volume 01796 Folio 006
Created by instrument 0831619 31/07/1917

REGISTERED PROPRIETOR

Estate Fee Simple
Sole Proprietor
THE ROMAN CATHOLIC TRUSTS CORPORATION FOR THE DIOCESE OF MELBOURNE of
CATHEDRAL PLACE EAST MELBOURNE
A890444 13/01/1960

ENCUMBRANCES, CAVEATS AND NOTICES

Any encumbrances created by Section 98 Transfer of Land Act 1958 or Section 24 Subdivision Act 1988 and any other encumbrances shown or entered on the plan set out under DIAGRAM LOCATION below.

DIAGRAM LOCATION

SEE TP247098N FOR FURTHER DETAILS AND BOUNDARIES

ACTIVITY IN THE LAST 125 DAYS

NIL

-----END OF REGISTER SEARCH STATEMENT-----

Additional information: (not part of the Register Search Statement)

Street Address: 17-23 STEVENS ROAD VERMONT VIC 3133

DOCUMENT END

**ADVERTISED
PLAN**

This copied document to be made available for the sole purpose of enabling its consideration and review as part of a planning process under the Planning and Environment Act 1987. The document must not be used for any purpose which may breach any copyright