

ADVERTISED PLAN

This copied document to be made available for the sole purpose of enabling its consideration and review as part of a planning process under the Planning and Environment Act 1987. The document must not be used for any purpose which may breach any copyright

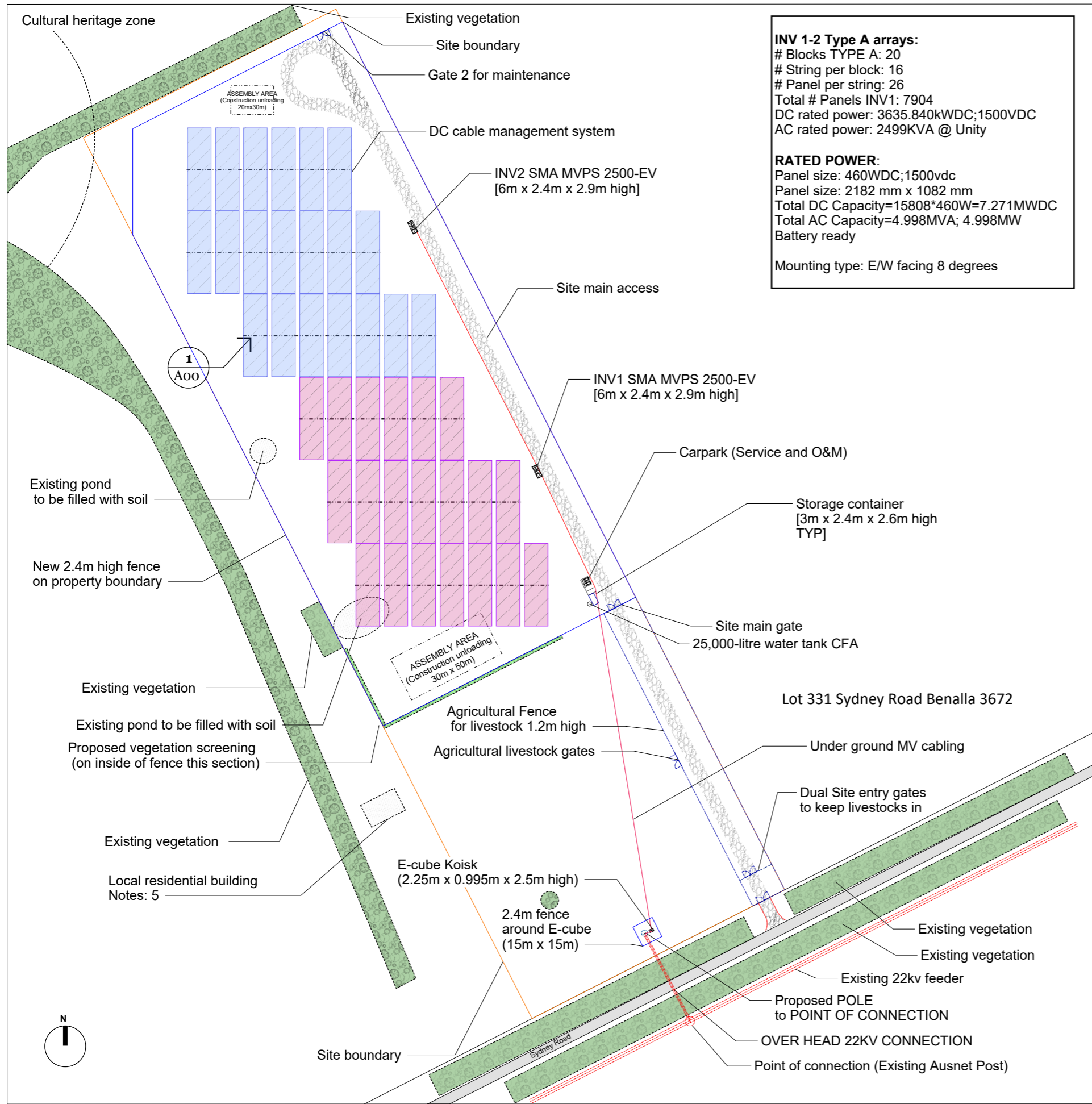

INV 1-2 Type A arrays:
 # Blocks TYPE A: 20
 # String per block: 16
 # Panel per string: 26
 Total # Panels INV1: 7904
 DC rated power: 3635.840kWDC; 1500VDC
 AC rated power: 2499KVA @ Unity

RATED POWER:
 Panel size: 460WDC; 1500vdc
 Panel size: 2182 mm x 1082 mm
 Total DC Capacity=15808*460W=7.271MWDC
 Total AC Capacity=4.998MVA; 4.998MW
 Battery ready

Mounting type: E/W facing 8 degrees

1 Elevation A
 A00 Scale: 1mm=200mm

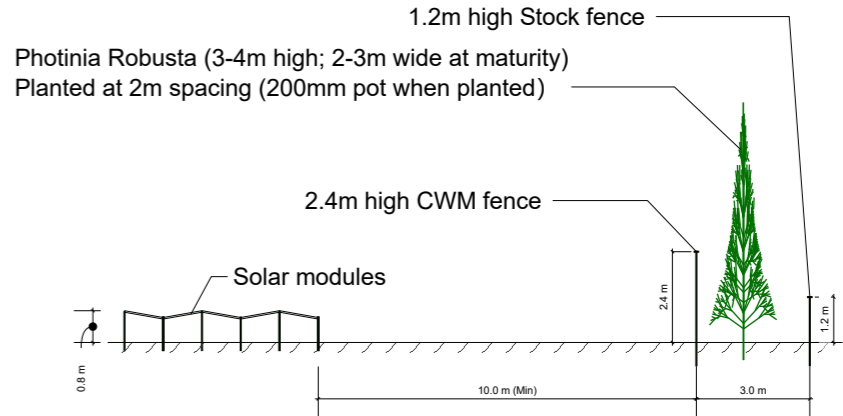

1 Block close up view
 A00 Scale: 1mm=500mm

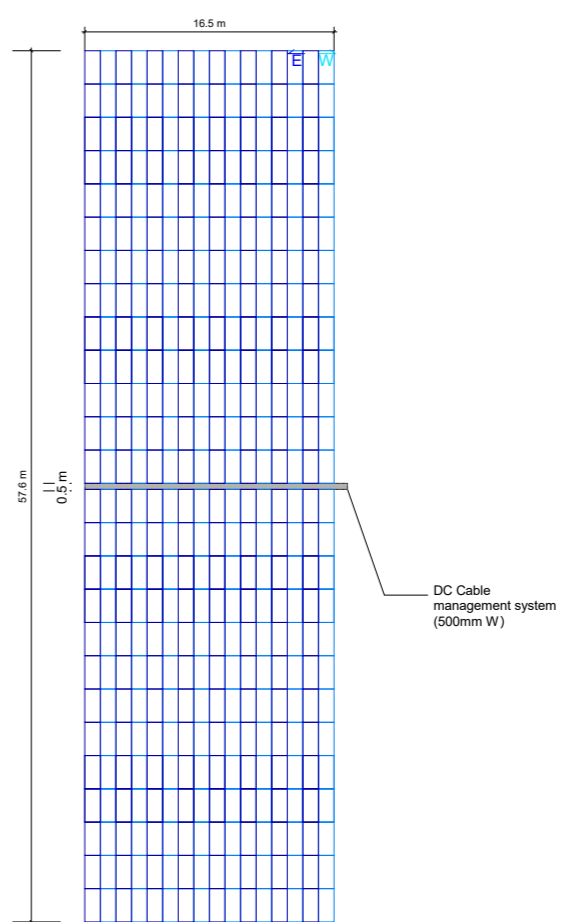

LEGEND	
///	2 PHASE OR DC (+VE, -VE)
////	3 PHASE
[Symbol]	CIRCUIT BREAKER
[Symbol]	ISOLATOR (ON LOAD)
[Symbol]	ISOLATOR (OFF LOAD)
[Symbol]	MCB / MCCB
[Symbol]	FUSE
[Symbol]	CT METERING
[Symbol]	SOLAR PANEL
[Symbol]	SURGE PROTECTION DEVICE
[Symbol]	BUS DUCK
[Symbol]	STREET POLE
[Symbol]	NETWORK POINT OF CONNECT
[Symbol]	TRANSFORMER
[Symbol]	EARTH
[Symbol]	PLUG & SOCKET
[Symbol]	TEST LINK
[Symbol]	MOTOR
[Symbol]	CONTACTOR
[Symbol]	SOLAR INVERTER
[Symbol]	DISTRIBUTION BOARDS
[Symbol]	MAIN SWITCH BOARD
[Symbol]	CURRENT TRANSFORMER (CT)
[Symbol]	EARTH SWITCH

SSE AUSTRALIA
 7888 BURWOOD RD
 HAWTHORN EAST VIC 3123
 1300 13 03 03

CLIENTS
 RenewableAge

DRAW BY
 DS A8146379

PROJECT
 RAC54 BENALLA Solar Farm

SHEET TITLE
 BENALLA Solar Farm LAYOUT General arrangement

SHEET NAME
 SSE_BENALLA_SF_L_1

NOTES
 1. All works shall comply with: AS3000, AS3008, AS5033, AS4777, CEC Guidelines, Supply Authority Service & Installation Rules and local authority guidelines.
 2. Ensure system is labelled to AS5033, AS4777-1, CEC guidelines and relevant state requirements.
 3. POC design and material supply should be inline with DNSP connection agreement.
 4. Fence set back 10m from the boundary to avoid overlap with Cultural heritage zone
 5. No solar farm component includes panels, inverter or electrical switch boards are within 50m radius of near residents
 6. E-cube Kiosk is unmanned PCC (locked for access)

SCALE
 1:3000

COORDINATION
 [Legend for coordination symbols]

NO	DATE	DESCRIPTION
19/8		Change to PEG system
28/8		Major updates
4/10		Minor updates
30/1		Major updates

REVISION
 V 5.3
 A3 PAGE 1

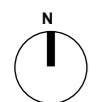

ADVERTISED PLAN

This copied document to be made available for the sole purpose of enabling its consideration and review as part of a planning process under the Planning and Environment Act 1987. The document must not be used for any purpose which may breach any copyright

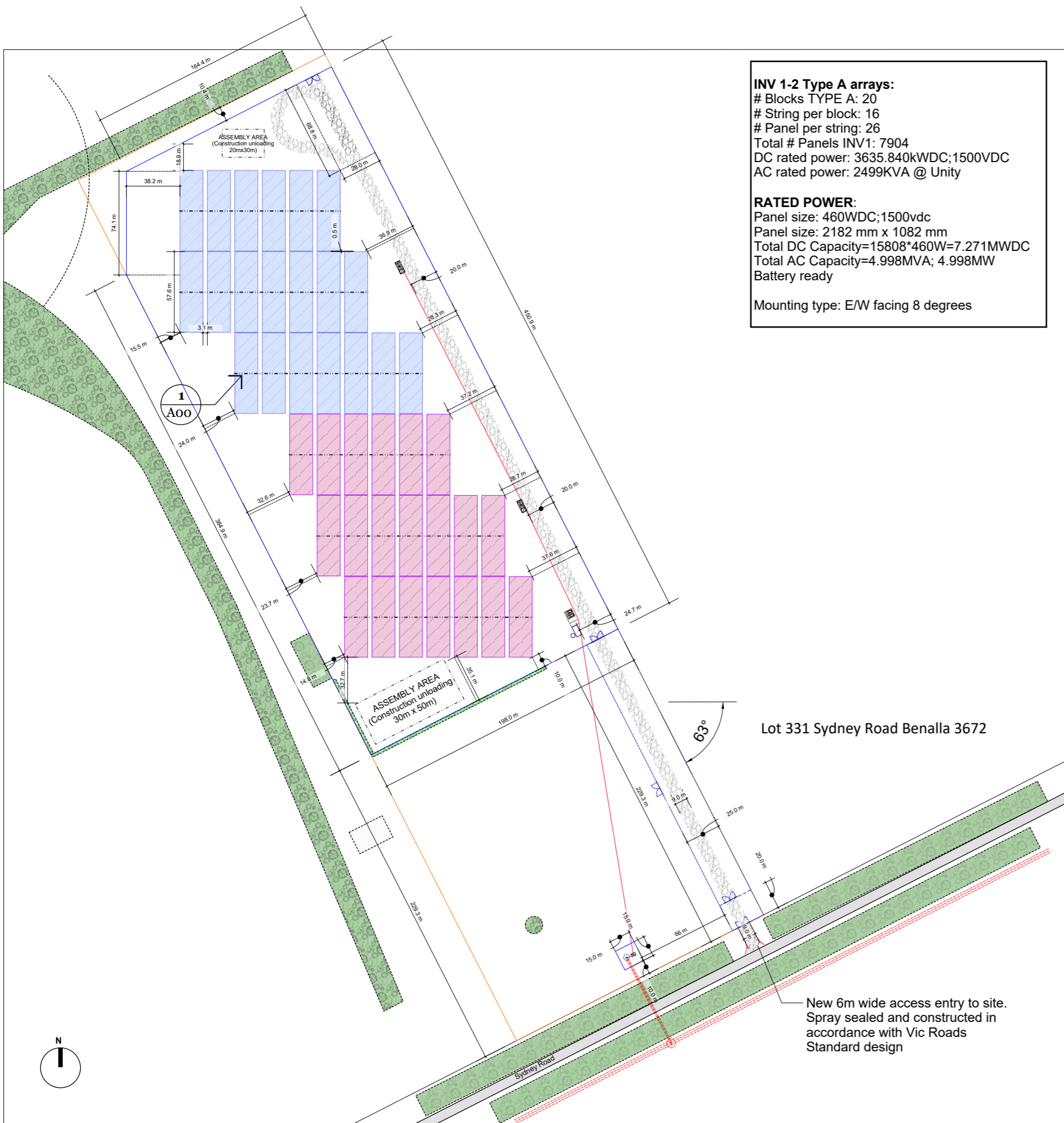

1 Elevation A
 A00 Scale: 1mm=200mm

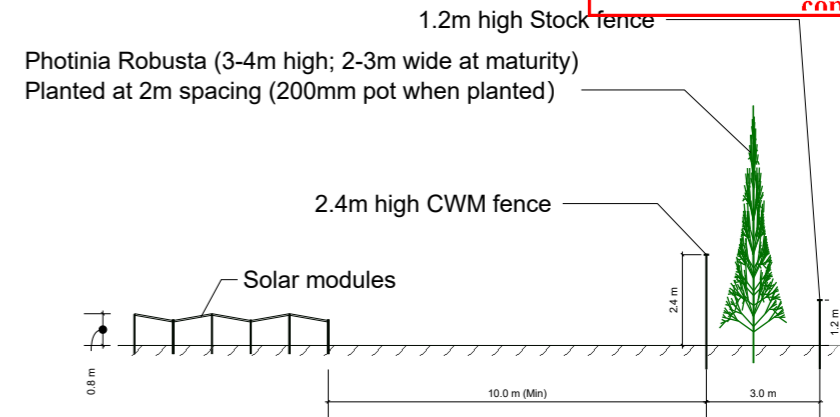

1 Block close up view
 A00 Scale: 1mm=500mm

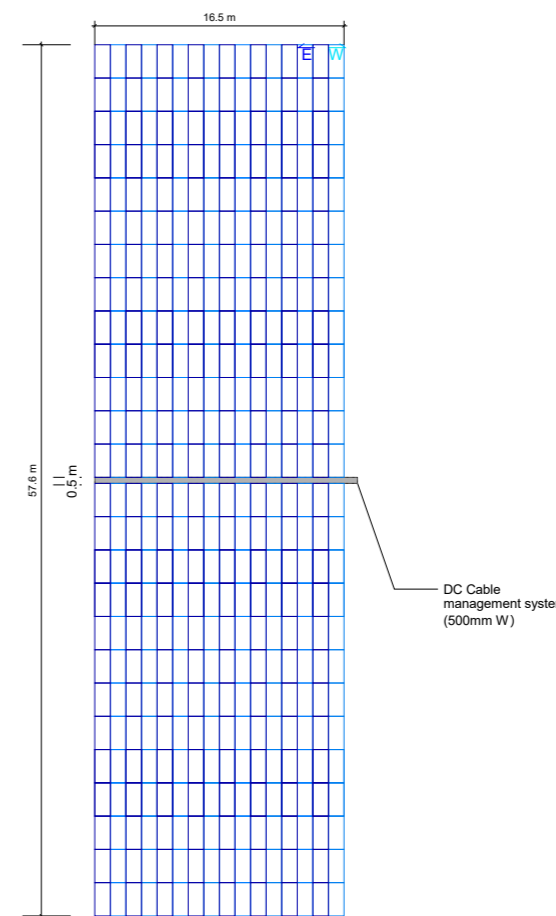

LEGEND	
///	2 PHASE OR DC (+VE, -VE)
////	3 PHASE
[Symbol]	CIRCUIT BREAKER
[Symbol]	ISOLATOR (ON LOAD)
[Symbol]	ISOLATOR (OFF LOAD)
[Symbol]	MCB / MCCB
[Symbol]	FUSE
[Symbol]	CT METERING
[Symbol]	SOLAR PANEL
[Symbol]	SURGE PROTECTION DEVICE
[Symbol]	BUS DUCK
[Symbol]	STREET POLE
[Symbol]	NETWORK POINT OF CONNECT
[Symbol]	TRANSFORMER
[Symbol]	EARTH
[Symbol]	PLUG & SOCKET
[Symbol]	TEST LINK
[Symbol]	MOTOR
[Symbol]	CONTACTOR
[Symbol]	SOLAR INVERTER
[Symbol]	DISTRIBUTION BOARDS
[Symbol]	MAIN SWITCH BOARD
[Symbol]	CURRENT TRANSFORMER (CT)
[Symbol]	EARTH SWITCH

SSE AUSTRALIA
 7188 BURWOOD RD
 HAWTHORN EAST VIC 3123
 1300 13 03 03

CLIENTS

DRAW BY
 DS A8146379

PROJECT
 RAC54 BENALLA Solar Farm

SHEET TITLE
 BENALLA Solar Farm LAYOUT
 General arrangement with dimensions

SHEET NAME
 SSE_BENALLA_SF_L_2

- NOTES
- All works shall comply with: AS3000, AS3008, AS5033, AS4777, CEC Guidelines, Supply Authority Service & Installation Rules and local authority guidelines.
 - Ensure system is labelled to AS5033, AS4777-1, CEC guidelines and relevant state requirements.
 - PCC design and material supply should be in line with DNSP connection agreement.
 - Fence set back 10 m from the boundary to avoid overlap with Cultural heritage zone
 - No solar farm component includes panels, inverter or electrical switch boards are within 50m radius of near residents
 - Ecube Kiosk is unmanned PCC (locked for access)

SCALE
 1:3000

COORDINATION
 Existing New Other
 FOR CONSTRUCTION
 PROGRESS DRAWING

NO	DATE	DESCRIPTION
19/8		Change to PEG system
28/8		Major updates
4/10		Minor updates
30/1		Major updates

REVISION
 V 5.3
 A3 PAGE 1

ADVERTISED PLAN

This copied document to be made available for the sole purpose of enabling its consideration and review as part of a planning process under the Planning and Environment Act 1987. The document must not be used for any purpose which may breach any copyright

0 Elevation A (View from West boundary With Veg screening)
A00 Scale: 1:50

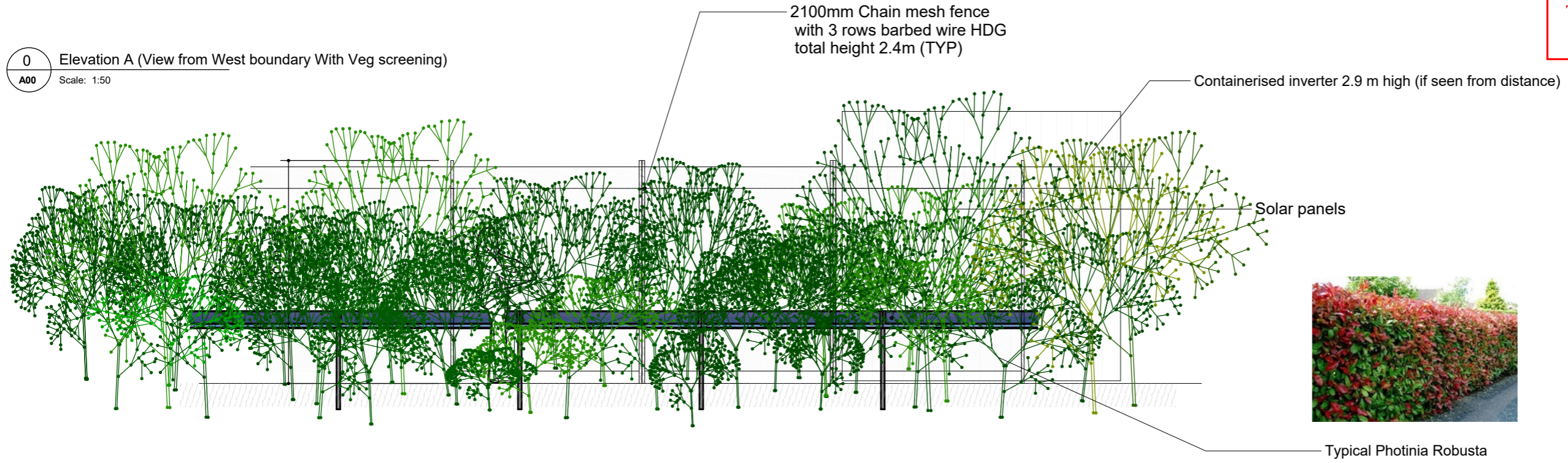

Image of SMA MVPS2475 power station inverter (6058mm x 2438mm x 2891mm high)

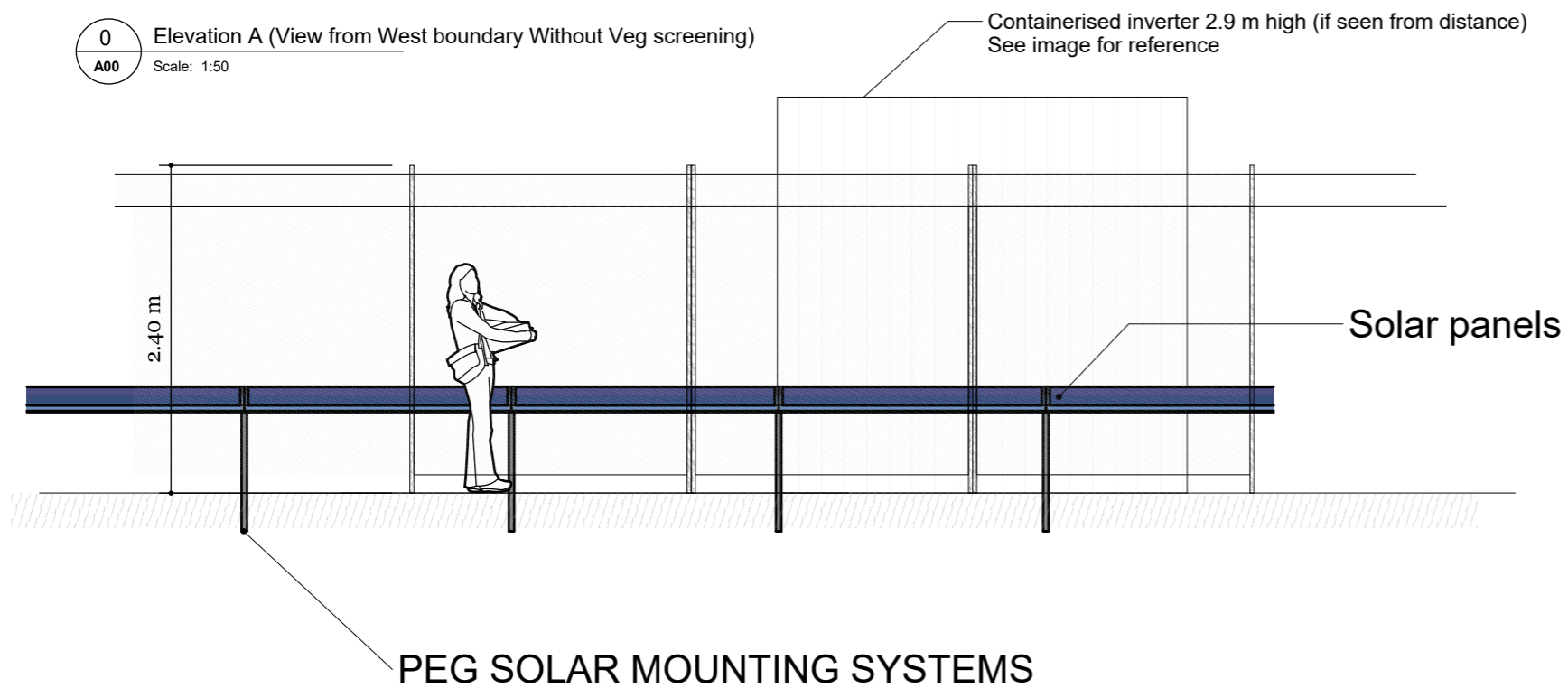

Image of E-Cube kiosk (2250mm x 995mm x 2500mm high)



Image of typical storage shed (3m x 2.4m x 2.6m high)

0 Elevation A (View from West boundary Without Veg screening)
A00 Scale: 1:50



SSE AUSTRALIA
7888 BURWOOD RD
HAWTHORN EAST VIC 3123
1300 13 03 03

CLIENTS

DRAW BY

DS A8146379

PROJECT

RAC54 BENALLA
Solar Farm

SHEET TITLE

BENALLA Solar Farm
LAYOUT
General arrangement
-Side elevation

SHEET NAME

SSE_BENALLA_SF_L_3

NOTES

- All works shall comply with: AS3000, AS3008, AS5033, AS4777, CEC Guidelines, Supply Authority Service & Installation Rules and local authority guidelines.
- Ensure system is labelled to AS5033, AS4777-1, CEC guidelines and relevant state requirements.
- POC design and material supply should be inline with DNSP connection agreement.
- Fence set back 10 m from the boundary to avoid overlap with Cultural heritage zone
- No solar farm component includes panels, inverter or electrical switch boards are within 50m radius of near residents
- Ecube Kiosk is unattended PCC (locked for access)

SCALE

1:50

COORDINATION

Design Memos Other

Structure Data

FOR CONSTRUCTION

PROGRESS DRAWING

NO	DATE	DESCRIPTION
19/8		Change to PEG system
28/8		Major updates
4/10		Minor updates
30/1		Major updates

DESIGN	DS	APPROVAL	AA

REVISION
V 5.3

A3 PAGE 1