

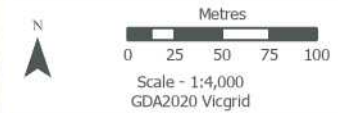
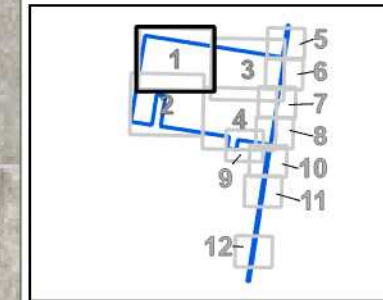

Figure 2.1: Native vegetation removal plan

Project No: 20138.04
Project: Hopkins Rd, Fulham
Date: 5/08/2024

-  Site
-  Cadastre
-  Proposed layout
-  DELWP wetland
- Native vegetation**
-  Plains Grassy Woodland (EVC 55)
- Vegetation removal**
-  Native vegetation to be removed



PO Box 337, Camberwell, VIC 3124, Australia
www.natureadvisory.com.au
03 9815 2111 - info@natureadvisory.com.au

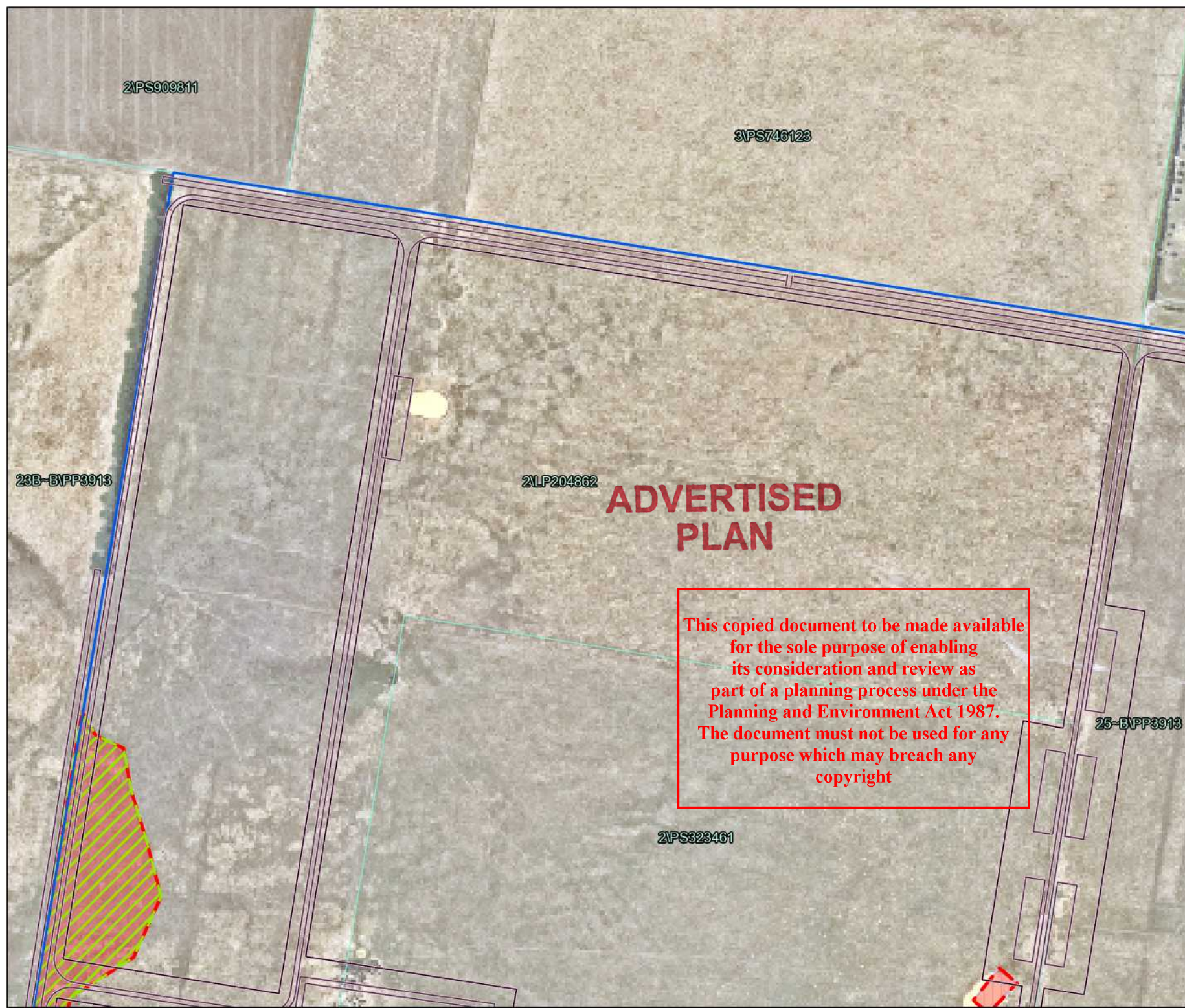







Figure 2.2: Native vegetation removal plan

Project No: 20138.04
Project: Hopkins Rd, Fulham
Date: 5/08/2024

-  Site
-  Cadastre
-  Proposed layout
-  DELWP wetland
- Native vegetation**
 -  Plains Grassy Woodland (EVC 55)
- Vegetation removal**
 -  Native vegetation to be removed

This copied document to be made available for the sole purpose of enabling its consideration and review as part of a planning process under the Planning and Environment Act 1987. The document must not be used for any purpose which may breach any copyright

ADVERTISED PLAN

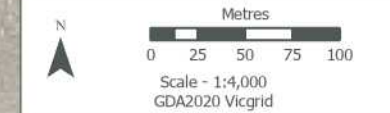
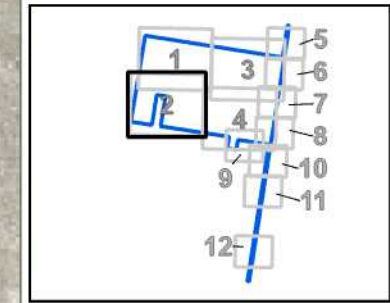

PO Box 337, Camberwell, VIC 3124, Australia
www.natureadvisory.com.au
03 9815 2111 - info@natureadvisory.com.au

Figure 2.3: Native vegetation removal plan

Project No: 20138.04
Project: Hopkins Rd, Fulham
Date: 5/08/2024

- Site
- Cadastre
- Proposed layout
- DELWP wetland

Native vegetation

- Plains Grassy Wetland (EVC 125)
- Plains Grassy Woodland (EVC 55)

Vegetation removal

- Native vegetation to be removed

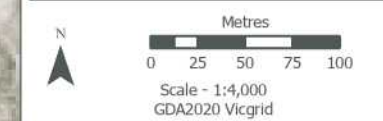
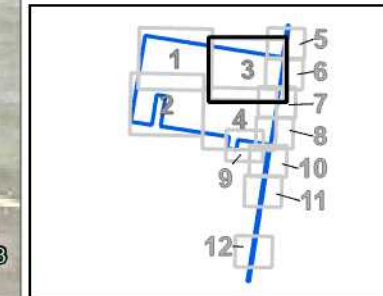
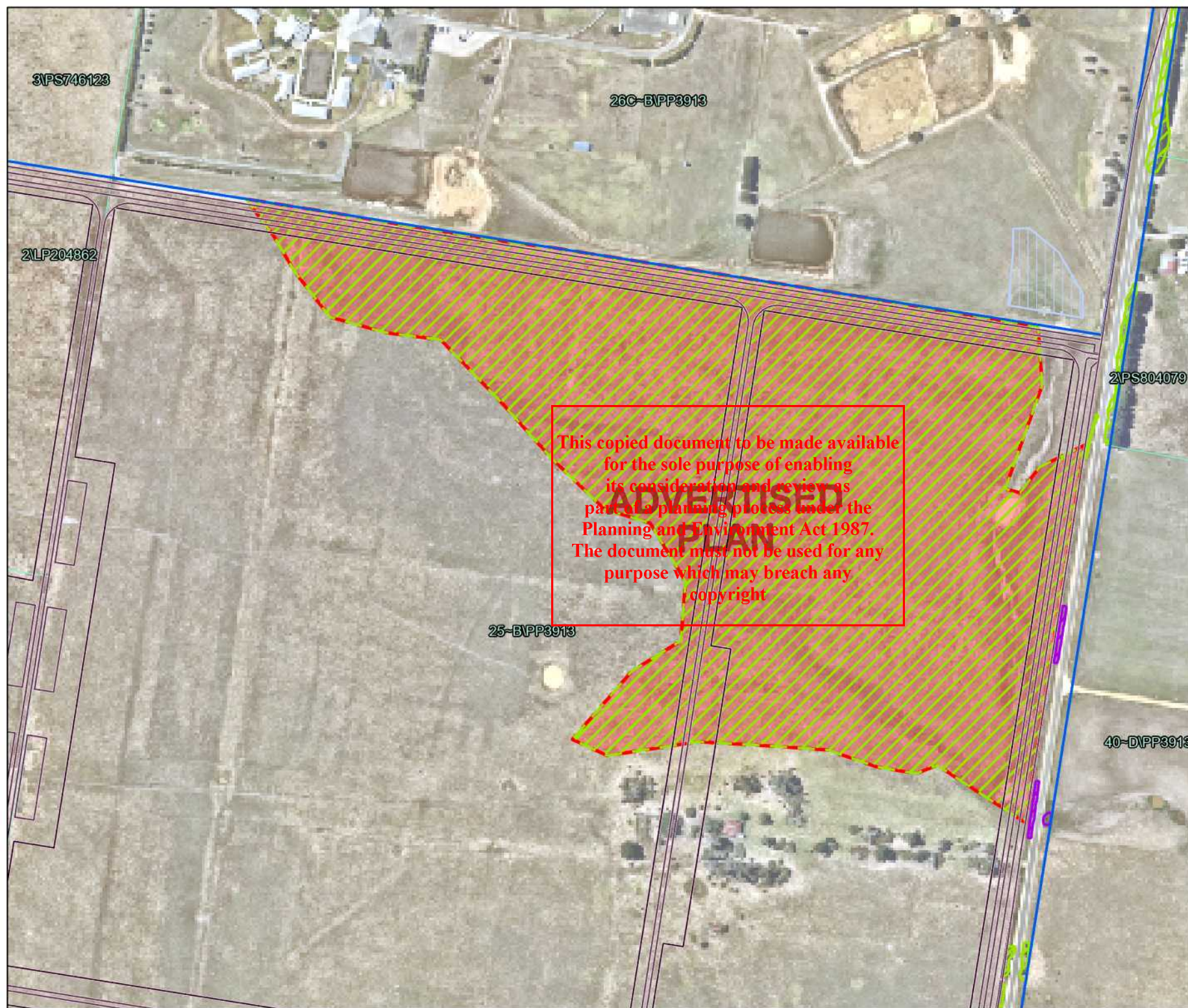

PO Box 337, Camberwell, VIC 3124, Australia
www.natureadvisory.com.au
03 9815 2111 - info@natureadvisory.com.au

Figure 2.4: Native vegetation removal plan

Project No: 20138.04
 Project: Hopkins Rd, Fulham
 Date: 5/08/2024

-  Site
 -  Cadastre
 -  Proposed layout
 -  DELWP wetland
- Native vegetation**
-  Plains Grassland - Heavier-soils (EVC 132_61)
 -  Plains Grassy Wetland (EVC 125)
 -  Plains Grassy Woodland (EVC 55)
 -  Swamp Scrub (EVC 53)
- Vegetation removal**
-  Native vegetation to be removed
 -  Native vegetation removal exempt under 2.33

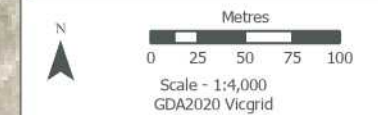
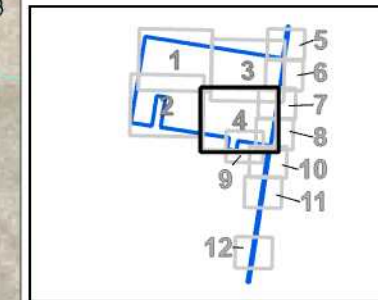

PO Box 337, Camberwell, VIC 3124, Australia
 www.natureadvisory.com.au
 03 9815 2111 - info@natureadvisory.com.au

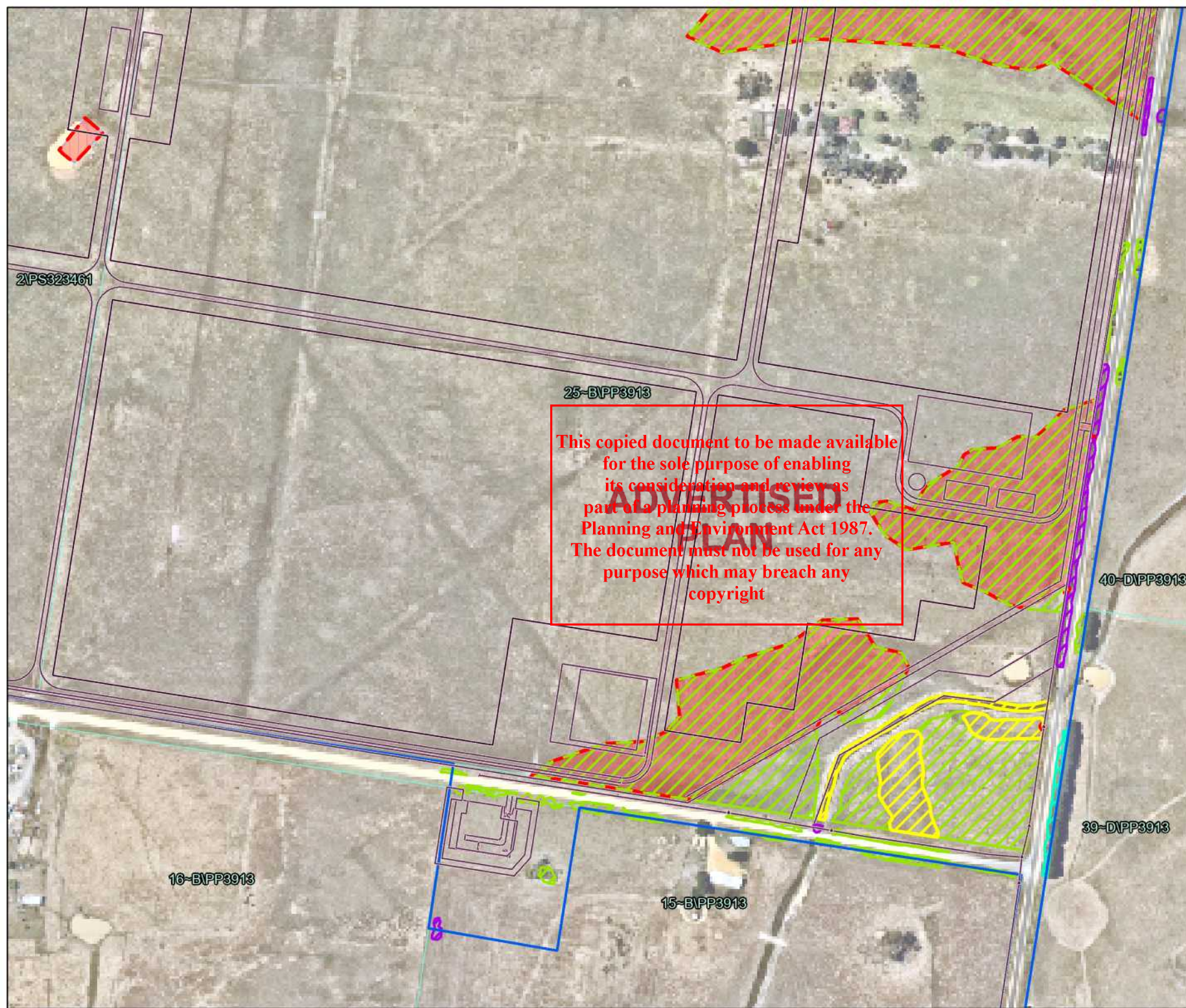



Figure 2.5: Native vegetation removal plan

Project No: 20138.04
Project: Hopkins Rd, Fulham
Date: 5/08/2024

-  Site
-  Cadastre
-  Proposed layout
-  DELWP wetland
- Native vegetation**
-  Plains Grassy Woodland (EVC 55)
- Vegetation removal**
-  Native vegetation to be removed

26C-BPP3913

This copied document to be made available for the sole purpose of enabling its consideration and review as part of a planning process under the Planning and Environment Act 1987. The document must not be used for any purpose which may breach any copyright

2/PS804079



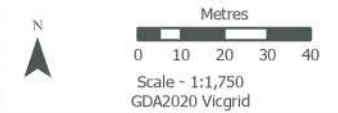
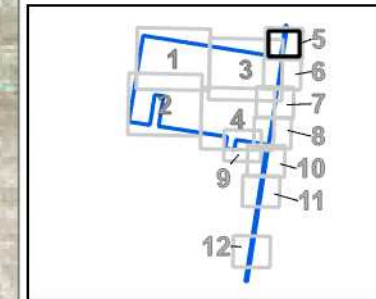



25-BPP3913



Nature Advisory
 PO Box 337, Camberwell, VIC 3124, Australia
www.natureadvisory.com.au
 03 9815 2111 - info@natureadvisory.com.au

Figure 2.6: Native vegetation removal plan

Project No: 20138.04
Project: Hopkins Rd, Fulham
Date: 5/08/2024

-  Site
-  Cadastre
-  Proposed layout
- Native vegetation**
 -  Plains Grassy Wetland (EVC 125)
 -  Plains Grassy Woodland (EVC 55)
- Vegetation removal**
 -  Native vegetation to be removed



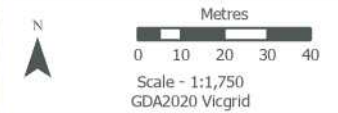
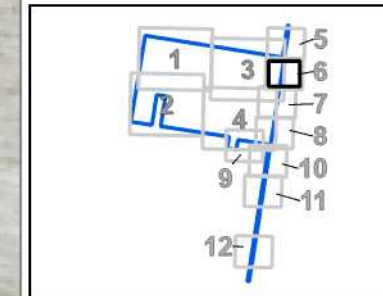



This copied document to be made available for the sole purpose of enabling its consideration and review as part of a planning process under the Planning and Environment Act 1987. The document must not be used for any purpose which may breach any copyright



PO Box 337, Camberwell, VIC 3124, Australia
www.natureadvisory.com.au
03 9815 2111 - info@natureadvisory.com.au

Figure 2.7: Native vegetation removal plan

Project No: 20138.04
Project: Hopkins Rd, Fulham
Date: 5/08/2024

-  Site
-  Cadastre
-  Proposed layout
- Native vegetation**
 -  Plains Grassy Wetland (EVC 125)
 -  Plains Grassy Woodland (EVC 55)
- Vegetation removal**
 -  Native vegetation to be removed

25-DVPP3913

This copied document to be made available for the sole purpose of enabling its consideration and review as part of a planning process under the Planning and Environment Act 1987. The document must not be used for any purpose which may breach any copyright.

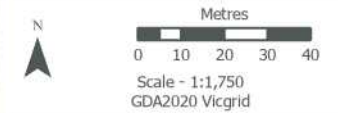
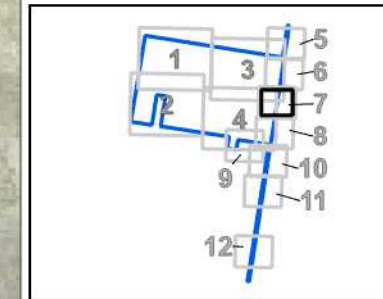

40-DVPP3913



PO Box 337, Camberwell, VIC 3124, Australia
www.natureadvisory.com.au
03 9815 2111 - info@natureadvisory.com.au

Figure 2.8: Native vegetation removal plan

Project No: 20138.04
Project: Hopkins Rd, Fulham
Date: 5/08/2024

-  Site
-  Cadastre
-  Proposed layout
- Native vegetation**
 -  Plains Grassland - Heavier-soils (EVC 132_61)
 -  Plains Grassy Wetland (EVC 125)
 -  Plains Grassy Woodland (EVC 55)
 -  Swamp Scrub (EVC 53)
- Vegetation removal**
 -  Native vegetation to be removed

This copied document to be made available for the sole purpose of enabling its consideration and review as part of a planning process under the Planning and Environment Act 1987. The document must not be used for any purpose which may breach any copyright

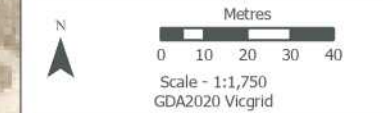
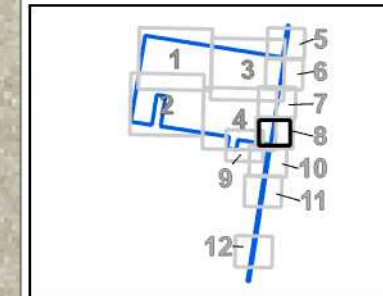

PO Box 337, Camberwell, VIC 3124, Australia
www.natureadvisory.com.au
03 9815 2111 - info@natureadvisory.com.au

Figure 2.9: Native vegetation removal plan

Project No: 20138.04
Project: Hopkins Rd, Fulham
Date: 5/08/2024

-  Site
-  Cadastre
-  Proposed layout
- Native vegetation**
 -  Plains Grassy Wetland (EVC 125)
 -  Plains Grassy Woodland (EVC 55)
 -  Swamp Scrub (EVC 53)
- Vegetation removal**
 -  Native vegetation to be removed
 -  Native vegetation removal exempt under 2.33



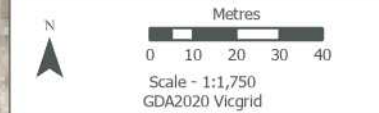
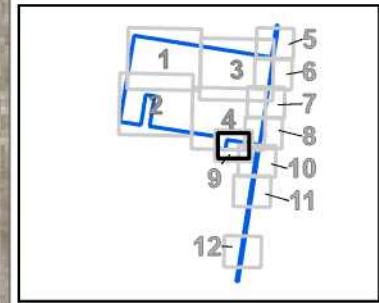

This copied document to be made available for the sole purpose of enabling its consideration and review as part of a planning process under the Planning and Environment Act 1987. The document must not be used for any purpose which may breach any copyright



PO Box 337, Camberwell, VIC 3124, Australia
www.natureadvisory.com.au
03 9815 2111 - info@natureadvisory.com.au

Figure 2.10: Native vegetation removal plan

Project No: 20138.04
Project: Hopkins Rd, Fulham
Date: 5/08/2024

-  Site
-  Cadastre
-  Proposed layout
- Native vegetation**
-  Plains Grassland - Heavier-soils (EVC 132_61)

15-DVPP3913

This copied document to be made available for the sole purpose of enabling its consideration and review as part of a planning process under the Planning and Environment Act 1987. The document must not be used for any purpose which may breach any copyright.

ADVERTISED PLAN

39-DVPP3913

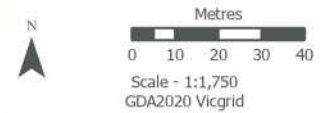
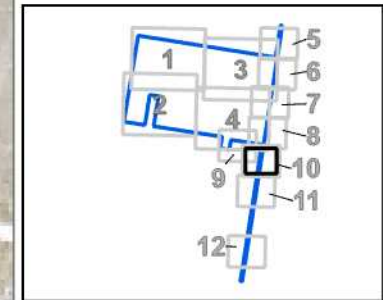

PO Box 337, Camberwell, VIC 3124, Australia
www.natureadvisory.com.au
03 9815 2111 - info@natureadvisory.com.au

Figure 2.11: Native vegetation removal plan

Project No: 20138.04
Project: Hopkins Rd, Fulham
Date: 5/08/2024

-  Site
-  Cadastre
-  Proposed layout
-  DELWP wetland
- Native vegetation**
-  Plains Grassland - Heavier-soils (EVC 132_61)

This copied document to be made available for the sole purpose of enabling its consideration and review as part of a planning process under the Planning and Environment Act 1987. The document must not be used for any purpose which may breach any copyright

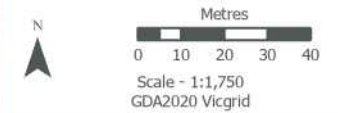
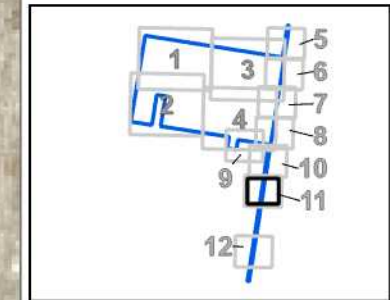

PO Box 337, Camberwell, VIC 3124, Australia
www.natureadvisory.com.au
03 9815 2111 - info@natureadvisory.com.au

Figure 2.12: Native vegetation removal plan

Project No: 20138.04
Project: Hopkins Rd, Fulham
Date: 5/08/2024

-  Site
-  Cadastre
-  Proposed layout
- Native vegetation**
 -  Plains Grassland - Heavier-soils (EVC 132_61)
 -  Plains Grassy Wetland (EVC 125)
- Vegetation removal**
 -  Native vegetation to be removed

15-BVPP3913

This copied document to be made available for the sole purpose of enabling its consideration and review as part of a planning process under the Planning and Environment Act 1987. The document must not be used for any purpose which may breach any copyright

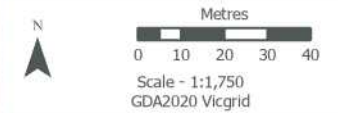
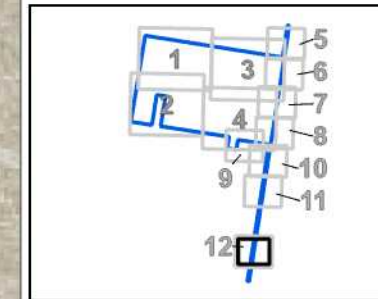

PO Box 337, Camberwell, VIC 3124, Australia
www.natureadvisory.com.au
03 9815 2111 - info@natureadvisory.com.au