

<h1 style="margin:0;">PLAN OF CONSOLIDATION</h1>	EDITION 1	PC 383205F
--	-----------	------------

LOCATION OF LAND

PARISH: MOOLAP
TOWNSHIP:
SECTION: 4
CROWN ALLOTMENT: 3 (PART)
CROWN PORTION: -
TITLE REFERENCE: VOL.11024 FOL.463, VOL.10340 FOL.164,
VOL.12299 FOL.389
LAST PLAN REFERENCE: PC369874P, TP961D (LOT 12),
TP968710E (LOT 1)
POSTAL ADDRESS: 25-33 OXFORD STREET
(at time of subdivision) WHITTINGTON, 3219
MGA CO-ORDINATES: E: 271 110 ZONE: 55
(of approx centre of land GDA 2020
in plan) N: 5 771 645

Council Name: City of Greater Geelong
Council Reference Number: 16880
Planning Permit Reference: Planning permit not required
SPEAR Reference Number: S252348J

Certification

This plan is certified under section 6 of the Subdivision Act 1988

Public Open Space

A requirement for public open space under section 18 or 18A of the Subdivision Act 1988 has not been made

Digitally signed by: Vickie Dolder for City of Greater Geelong on 02/01/2026

**ADVERTISED
PLAN**

VESTING OF ROADS AND/OR RESERVES	
IDENTIFIER	COUNCIL/BODY/PERSON
NIL	NIL
NOTATIONS	
DEPTH LIMITATION Does not apply	
<p>SURVEY: This plan is based on survey.</p> <p>STAGING: This is not a staged subdivision. Planning Permit No. PP-892-2006/A</p> <p>This survey has been connected to permanent marks No(s). PM85, PM345, PM346 & PM347</p>	

NOTATIONS

This copied document to be made available for the sole purpose of enabling its consideration and review as part of a planning process under the Planning and Environment Act 1987. The document must not be used for any purpose which may breach any copyright

EASEMENT INFORMATION

LEGEND: A - Appurtenant Easement E - Encumbering Easement R - Encumbering Easement (Road)

Easement Reference	Purpose	Width (Metres)	Origin	Land Benefited/In Favour Of
E-1 & E-2	DRAINAGE	1.83	Y2292K (BOOK 649 No.834)	SEE Y2292K
E-2	DRAINAGE	1.83	Y2293G (BOOK 660 No.601)	SEE Y2293G
E-3	DRAINAGE	1.83	BOOK 671 No.535	LOTS 14-20 (B.I) ON TP961D
E-1,E-3 & E-4	SEWERAGE	SEE PLAN	THIS PLAN	BARWON REGION WATER AUTHORITY
E-5	DRAINAGE (If any)	1.83	GENERAL LAW SUBDIVISION No.658	UNSPECIFIED
E-5	DRAINAGE	1.83	BOOK 656 No.577	SEE BOOK. 656 NO.577
E-6	DRAINAGE	1.83	Y9583Y (BOOK 675 No.871)	SEE Y9583Y

PC 383205F

TRUSCOTT STREET

STREET

97°21'
84.75

ADVERTISED PLAN

186°56'10" (38.66)

MGA2020
ZONE 55

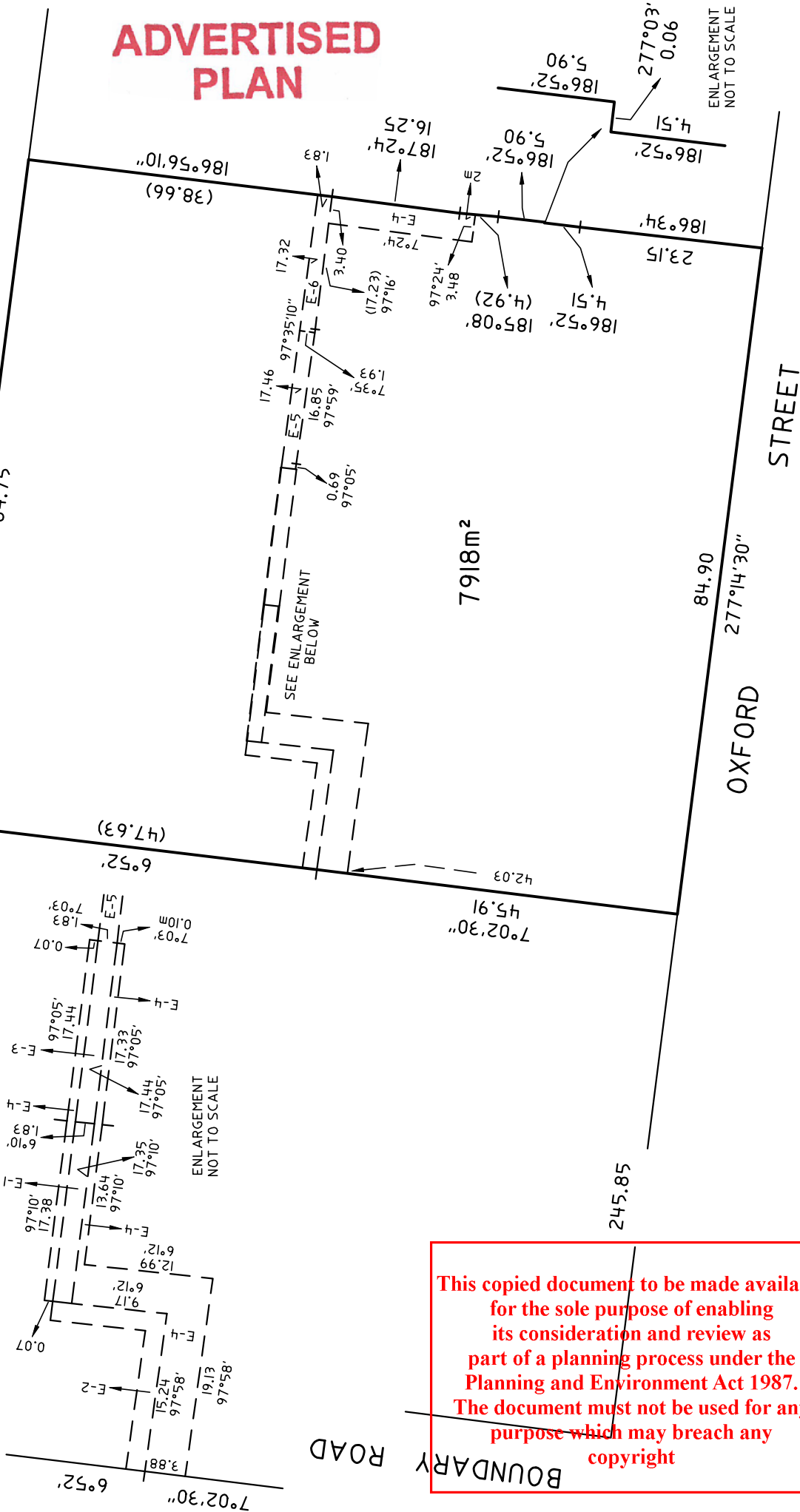

7918m²

84.90

277°14'30"

OXFORD STREET

245.85

BOUNDARY ROAD

This copied document to be made available for the sole purpose of enabling its consideration and review as part of a planning process under the Planning and Environment Act 1987. The document must not be used for any purpose which may breach any copyright

SCALE 1:500

LENGTHS ARE IN METRES



SHEET SIZE: A3

REF: 18536

V01

SHEET 2

Digitally signed by: Greg Thompson, Licensed Surveyor,
 Surveyor's Plan Version (V02),
 19/11/2025, SPEAR Ref: S252348J

Digitally signed by:
 City of Greater Geelong,
 02/01/2026,
 SPEAR Ref: S252348J



St. Quentin