

**REGISTER SEARCH STATEMENT (Title Search) Transfer of
Land Act 1958**

VOLUME 08145 FOLIO 290

Security no : 124089300165G
Produced 15/04/2021 12:11 PM

LAND DESCRIPTION

Lot 1 on Title Plan 802489E.
PARENT TITLE Volume 05041 Folio 156
Created by instrument A275634 10/01/1957

REGISTERED PROPRIETOR

Estate Fee Simple
Sole Proprietor
TRUSTEES OF EDMUND RICE EDUCATION AUSTRALIA of 9 THE VAUCLUSE RICHMOND VIC
3121
AL972028L 22/06/2015

ENCUMBRANCES, CAVEATS AND NOTICES

CAVEAT as to part K846964 14/03/1984
Caveator
MELBOURNE AND METROPOLITAN BOARD OF WORKS
Grounds of Claim
UNREGISTERED EASEMENT
Estate or Interest
INTEREST AS A GRANTEE OF AN EASEMENT
Prohibition
UNLESS AN INSTRUMENT IS EXPRESSED TO BE SUBJECT TO MY/OUR CLAIM
Lodged by
MELBOURNE AND METROPOLITAN BOARD OF WORKS
Notices to
MELBOURNE AND METROPOLITAN BOARD OF WORKS of 100 WELLINGTON PARADE EAST
MELBOURNE VIC 3002

Any encumbrances created by Section 98 Transfer of Land Act 1958 or Section 24 Subdivision Act 1988 and any other encumbrances shown or entered on the plan set out under DIAGRAM LOCATION below.

DIAGRAM LOCATION

SEE TP802489E FOR FURTHER DETAILS AND BOUNDARIES

ACTIVITY IN THE LAST 125 DAYS

NIL

-----END OF REGISTER SEARCH STATEMENT-----

Additional information: (not part of the Register Search Statement)

Street Address: 41 ROSEHILL ROAD ESSENDON WEST VIC 3040

DOCUMENT END

**REGISTER SEARCH STATEMENT (Title Search) Transfer of
Land Act 1958**

VOLUME 08224 FOLIO 898

Security no : 124089300166F
Produced 15/04/2021 12:11 PM

LAND DESCRIPTION

Lot 1 on Title Plan 249349D.
PARENT TITLE Volume 02140 Folio 947
Created by instrument A785905 09/10/1959

REGISTERED PROPRIETOR

Estate Fee Simple
Sole Proprietor
TRUSTEES OF EDMUND RICE EDUCATION AUSTRALIA of 9 THE VAUCLUSE RICHMOND VIC
3121
AL972028L 22/06/2015

ENCUMBRANCES, CAVEATS AND NOTICES

Any encumbrances created by Section 98 Transfer of Land Act 1958 or Section 24 Subdivision Act 1988 and any other encumbrances shown or entered on the plan set out under DIAGRAM LOCATION below.

DIAGRAM LOCATION

SEE TP249349D FOR FURTHER DETAILS AND BOUNDARIES

ACTIVITY IN THE LAST 125 DAYS

NIL

-----END OF REGISTER SEARCH STATEMENT-----

Additional information: (not part of the Register Search Statement)

Street Address: 41 ROSEHILL ROAD ESSENDON WEST VIC 3040

DOCUMENT END



Imaged Document Cover Sheet

The document following this cover sheet is an imaged document supplied by LANDATA®, Victorian Land Registry Services.

Document Type	Plan
Document Identification	TP802489E
Number of Pages (excluding this cover sheet)	2
Document Assembled	15/04/2021 12:13

Copyright and disclaimer notice:

© State of Victoria. This publication is copyright. No part may be reproduced by any process except in accordance with the provisions of the Copyright Act 1968 (Cth) and for the purposes of Section 32 of the Sale of Land Act 1962 or pursuant to a written agreement. The information is only valid at the time and in the form obtained from the LANDATA® System. None of the State of Victoria, LANDATA®, Victorian Land Registry Services Pty. Ltd. ABN 86 627 986 396 as trustee for the Victorian Land Registry Services Trust ABN 83 206 746 897 accept responsibility for any subsequent release, publication or reproduction of the information.

The document is invalid if this cover sheet is removed or altered.



Imaged Document Cover Sheet

The document following this cover sheet is an imaged document supplied by LANDATA®, Victorian Land Registry Services.

Document Type	Plan
Document Identification	TP249349D
Number of Pages (excluding this cover sheet)	1
Document Assembled	15/04/2021 12:13

Copyright and disclaimer notice:

© State of Victoria. This publication is copyright. No part may be reproduced by any process except in accordance with the provisions of the Copyright Act 1968 (Cth) and for the purposes of Section 32 of the Sale of Land Act 1962 or pursuant to a written agreement. The information is only valid at the time and in the form obtained from the LANDATA® System. None of the State of Victoria, LANDATA®, Victorian Land Registry Services Pty. Ltd. ABN 86 627 986 396 as trustee for the Victorian Land Registry Services Trust ABN 83 206 746 897 accept responsibility for any subsequent release, publication or reproduction of the information.

The document is invalid if this cover sheet is removed or altered.

TITLE PLAN	EDITION 1	TP 249349D
-------------------	------------------	-------------------

<p>Location of Land</p> <p>Parish: DOUTTA GALLA Township: Section: Crown Allotment: Crown Portion: 12(PT)</p> <p>Last Plan Reference: Derived From: VOL 8224 FOL 898 Depth Limitation: NIL</p>	<p style="text-align: center;">Notations</p> <p>ANY REFERENCE TO MAP IN THE TEXT MEANS THE DIAGRAM SHOWN ON THIS TITLE PLAN</p>
---	--

<p>Description of Land / Easement Information</p>	<p>THIS PLAN HAS BEEN PREPARED FOR THE LAND REGISTRY, LAND VICTORIA, FOR TITLE DIAGRAM PURPOSES AS PART OF THE LAND TITLES AUTOMATION PROJECT</p> <p>COMPILED: 22/06/2000 VERIFIED: AC</p>
--	---

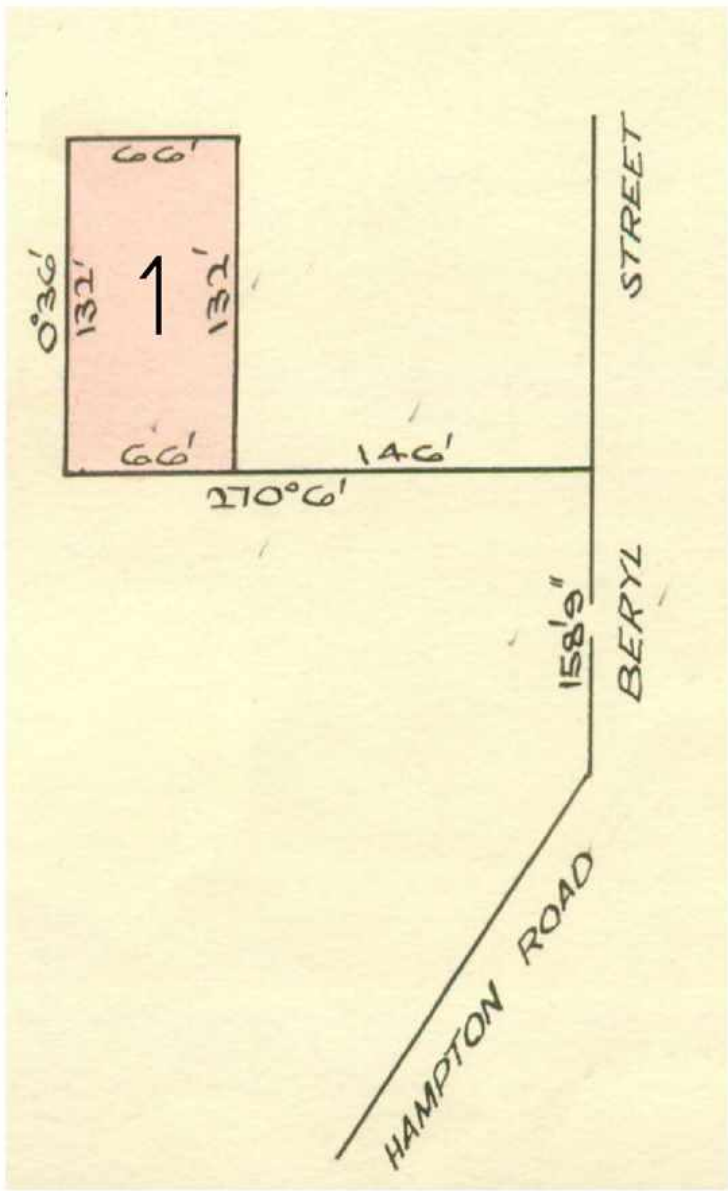

TABLE OF PARCEL IDENTIFIERS
WARNING: Where multiple parcels are referred to or shown on this Title Plan this does not imply separately disposable parcels under Section 8A of the Sale of Land Act 1962
PARCEL 1 = CP 12 (PT)