

Imaged Document Cover Sheet

The document following this cover sheet is an imaged document supplied by LANDATA®, Victorian Land Registry Services.

| | |
|---|-------------------------|
| Document Type | Plan |
| Document Identification | TP785125K |
| Number of Pages (excluding this cover sheet) | 1 |
| Document Assembled | 04/02/2020 15:48 |

Copyright and disclaimer notice:

© State of Victoria. This publication is copyright. No part may be reproduced by any process except in accordance with the provisions of the Copyright Act 1968 (Cth) and for the purposes of Section 32 of the Sale of Land Act 1962 or pursuant to a written agreement. The information is only valid at the time and in the form obtained from the LANDATA® System. None of the State of Victoria, LANDATA®, Victorian Land Registry Services Pty. Ltd. ABN 86 627 986 396 as trustee for the Victorian Land Registry Services Trust ABN 83 206 746 897 accept responsibility for any subsequent release, publication or reproduction of the information.

The document is invalid if this cover sheet is removed or altered.

This copied document to be made available for the sole purpose of enabling its consideration and review as part of a planning process under the Planning and Environment Act 1987. The document must not be used for any purpose which may breach any copyright

**ADVERTISED
PLAN**

| | | | |
|------------|--|-----------|------------|
| TITLE PLAN | | EDITION 1 | TP 785125K |
|------------|--|-----------|------------|

| | |
|---|--|
| <p>Location of Land</p> <p>Parish: BREWSTER Township: Section: B Crown Allotment: 1 Crown Portion:</p> <p>Last Plan Reference: Derived From: VOL.8790 FOL.959 & VOL.9672 FOL.603 Depth Limitation: 50 FEET</p> | <p style="text-align: center;">Notations</p> <p>ANY REFERENCE TO MAP IN THE TEXT MEANS THE DIAGRAM SHOWN ON THIS TITLE PLAN</p> |
|---|--|

Description of Land / Easement Information

This copied document to be made available for the sole purpose of enabling its consideration and review as part of a planning process under the Planning and Environment Act 1987. The document must not be used for any purpose which may breach any copyright

THIS PLAN HAS BEEN PREPARED FOR THE LAND REGISTRY, LAND VICTORIA, FOR TITLE DIAGRAM PURPOSES AS PART OF THE LAND TITLES AUTOMATION PROJECT

COMPILED: 16/09/2003
 VERIFIED: CP

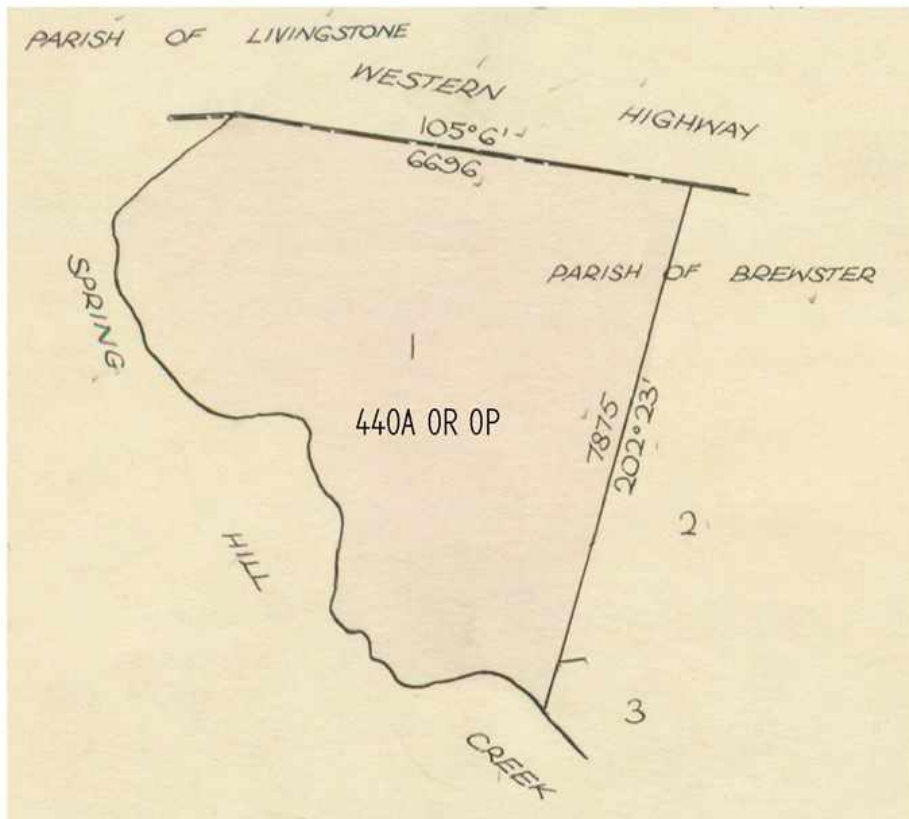

ADVERTISED PLAN

| | | | |
|----------------------|---|--|---------------------|
| LENGTHS ARE IN LINKS | Metres = 0.3048 x Feet Metres = 0.201168 x Links | | Sheet 1 of 1 sheets |
|----------------------|---|--|---------------------|