

## Engineers Advice

*Rocky Valley Ski Club*

Slalom Street Retaining Wall

21-580-EA-S001

14 October 2024

To: Mountain Creek Architecture      Helen Mathew      helen@mountaincreekarch.com  
Cc:

Dear Helen

As requested by Falls Creek Alpine Resort please find attached retaining wall detail for reinstatement of the Slalom Street retaining wall following removal of the access stairs to Rocky Valley Ski Club.

As requested, the retaining wall detail is generally in accordance with the typical retaining walls adopted by FCAR throughout the Falls Creek village. We anticipate further clarification may be sought from FCAR to confirm finishing details of facing rockwork.

Existing stairs, footings & returns on existing retaining walls are to be demolished as part of the works and new retaining wall footings to be founded on undisturbed natural ground.

Where possible and/or present, existing drainage behind retaining walls should be connected.

Should you wish to discuss any of the above or require any further information do not hesitate in contacting us.

Kind regards,



Michael Dayment  
Engineer

## ADVERTISED PLAN

**This copied document to be made available for the sole purpose of enabling its consideration and review as part of a planning process under the Planning and Environment Act 1987. The document must not be used for any purpose which may breach any copyright**



# RETAINING WALL DETAIL

## ROCKY VALLEY SKI CLUB



**KUSCH**  
Engineered.

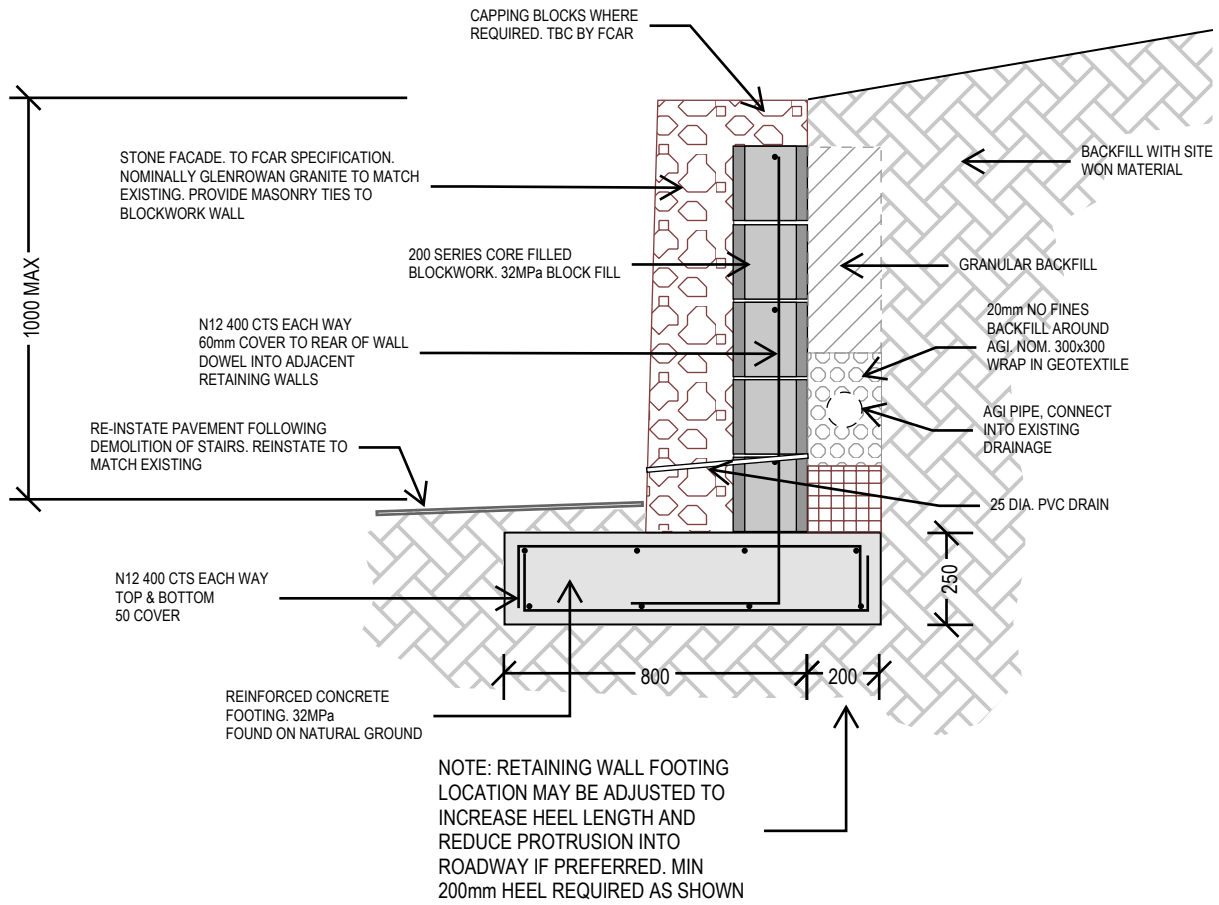

**This copied document to be made available for the sole purpose of enabling its consideration and review as part of a planning process under the Planning and Environment Act 1987. The document must not be used for any purpose which may breach any copyright**

**ADVERTISED  
PLAN**