

LEGEND

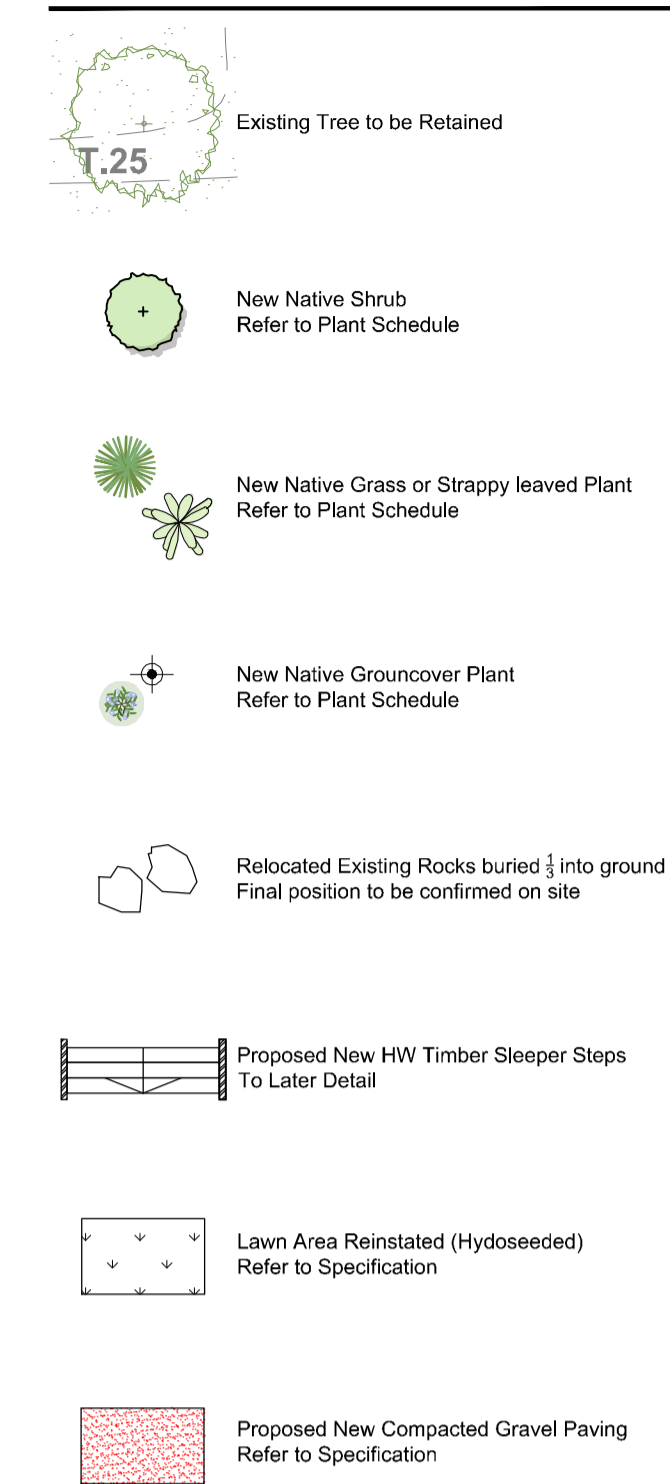

PLANT SCHEDULE

SYM	BOTANICAL NAME	COMMON NAME	DE/IN	HEIGHT X WIDTH AT MATURITY	MIN SUPPLY SIZE	AREA	QTY	
SHRUBS								
Ca	<i>Correa alba</i>	White Correa	EN	1-1.5 x 1-1.5m	140mm pot	B	7	
							TOTAL	7
GROUNDCOVERS								
Bm	<i>Brachyscome multifida</i>	Cut-leaf Daisy	EN	0.4 x 0.4m	140mm pot	A & B	30	
Cr	<i>Carpobrotus rossii</i>	Karkalla	EN	Spreading	140mm pot	A	7	
DIEA	<i>Dianella lasmanica</i> 'Emerald Arch'	Emerald Arch Flax Lily	EN	0.45 x 0.45m	140mm pot	A & B	20	
DXT	<i>Dianella lasmanica</i> 'Tasred'	Tasred Flax Lily	EN	0.4 x 0.4m	140mm pot	A & B	44	
GFRM	<i>Grevillea</i> 'Porinda Royal Mantle'	Groundcover Grevillea	EN	0.3 x 4m	140mm pot	A	2	
HVM	<i>Hardenbergia violacea</i> 'Meema'	Meema Purple Coral Pea	EN	0.3-0.45 x 1-2m	140mm pot	A & B	3	
LKD	<i>Lomandra longifolia</i> 'Katrinus Deluxe'	Katrinus Deluxe Mat-rush	EN	0.8 x 0.8m	140mm pot	A & B	22	
LIN	<i>Lomandra longifolia</i> 'Nyalla'	Nyalla Mat-rush	EN	0.8-0.9 x 0.8-0.9m	140mm pot	A & B	17	
LIT	<i>Lomandra longifolia</i> 'Tanka'	Tanka Mat-rush	EN	0.50-0.6 x 0.65m	140mm pot	A & B	3	
							TOTAL	148

*DE = Deciduous/Evergreen
IN = Indigenous/Native

SPECIFICATION NOTES

Soil Preparation
Crushed rock, concrete spillage and any other material restrictive to plant growth (e.g. large rocks) shall be removed from the site of any planting beds. All trees to be removed shall be stump ground and all rubbish/vegetative spoil is to be removed from site. Existing top soil in planting areas is to be preserved so that it does not receive additional compaction from site machinery and so that no rubble or building supplies are stored in these areas.

No imported top soil is to be used within the root zones of trees to be protected. Any preparation of existing soil for planting within these areas is to be done by hand only. Holes (e.g. as the result of plant removal) and uneven soil levels may be patched using topsoil as specified below.

Weed Removal
All weeds shall be thoroughly removed. All vegetative material, including roots and rhizomes of non-woody perennials and woody suckering weeds, is to be removed or appropriately controlled using chemical means. The stumps of non-suckering woody perennials are to be stump ground. All vegetative material shall be appropriately disposed of off site in a manner which will not allow their re-establishment elsewhere. Any chemical controls are to be used in accordance with manufacturer's instructions and standard occupational health and safety procedures.

Care must be taken to ensure that all trees to be retained are not damaged during weed removal. This also implies that any herbicides used are suitable for use around the vegetation to be retained.

Planting
Planting shall be carried out using accepted horticultural practices with all plants conforming to the species, size and quantities indicated on the Landscape Plan and Plant Schedule. Plants shall be thoroughly soaked through immersion in water prior to planting and if the planting soil is very dry then the planting hole is also to be filled with water and allowed to drain completely.

All plants shall be appropriately hardened off in the nursery. Use plants with the following characteristics: Large healthy root systems with no evidence of root curl or pot bound restriction or damage, vigorous, well established, free from disease and pests and of good form, consistent with the species or variety.

Planting holes for shrubs and groundcovers are to be of minimum size 75mm larger than the planting pot in all directions. All plants are to be thoroughly watered after planting and slow release fertiliser added at the quantities specified by the manufacturer.

Mulch
Eucalyptus Mulch is to be supplied to all garden beds and is to be laid to a minimum depth of 75mm. Mulch shall be free of damaging matter such as soil, debris and sticks and is to be stockpiled and thoroughly weathered prior to delivery. Mulch is to be kept back 100mm from the stems of all plants to prevent collar rot.

Granitic Gravel Surface
Granitic gravel is to be installed where shown comprising of a 50mm layer of gravel (Tuscan Toppings or similar) over a base course of 75mm deep gently compacted Fine Crushed Rock. Each layer, including the subgrade is to be appropriately compacted.

Timber Edges
Provide 75 x 25mm treated pine edges to all borders between gravel mulch paths, garden beds & lawns using 75x25x300mm long treated pine stakes at 1200mm maximum centres. An additional stake is to be provided at joins in the plinth.

Repair/Restoration of damaged Lawn Areas
Lawn areas are to be restored to current grades with any depressions filled with topsoil to specifications above and lightly compacted in 150mm layers. Areas are then to be re-seeded using an appropriate and matching turf type and the area fenced off to allow the re-establishment of lawn. Re-seeded areas are to be well irrigated and the area supplied with a slow release fertiliser at the quantities recommended by the manufacturer. Any areas of lawn which have failed to germinate (achieve an evenly green 95% covering of a consistent height) are to be re-seeded within one month of original sowing date.

Plant Establishment Period
There shall be a 13 weeks Plant Establishment Period following the approval of Practical Completion by the responsible authority. During this period the landscape contractor shall make good all defects in his/her scope of works. Maintenance and Establishment means the care and maintenance of the contract area by accepted horticultural practices, as well as rectifying any defects that become apparent in the work under normal use. This shall include, but shall not be limited to watering, fertilising, weeding, pruning, pest and disease control, cultivation, re-staking and replacement of any plants that fall with plants of the same species and size.

LANDSCAPE WORKS SUMMARY

- Area A**
 - DEMOLISH EXISTING GARDEN BED & PRESERVE & REUSE EXISTING TOPSOIL.
 - REMOVE ALL WEEDS, SMALL STONES & DEBRIS FROM TOPSOIL BEFORE STOCKPILING.
 - PRESERVE NATIVE GRASS PLANTS IN GOOD CONDITION BY REPOTTING TILL THEY ARE REPLANTED.
 - REUSE ROCKS TO STABILISE NEW SLOPE & CREATE PLANTING POCKETS.
 - CONSTRUCT NEW TIMBER SLEEPER STEPS B/W GARDEN BED & PORTABLE BLDG.
 - SUPPLY & PLANT NEW NATIVE/INDIGENOUS GRASSES & GROUNDCOVERS (REFER TO PLANT SCHEDULE).
 - SUPPLY & INSTALL EUCA MULCH TO A DEPTH OF 75-100mm TO GARDEN BED.
- Area B**
 - DEMOLISH EXISTING LAWN & PRESERVE & REUSE EXISTING TOPSOIL.
 - REMOVE ALL WEEDS, SMALL STONES & DEBRIS FROM TOPSOIL BEFORE STOCKPILING.
 - CONSTRUCT NEW TIMBER SLEEPER RETAINING WALLS AS SPECIFIED BY ARCHITECTS.
 - SUPPLY & PLANT NEW NATIVE/INDIGENOUS GRASSES & GROUNDCOVERS (REFER TO PLANT SCHEDULE).
 - SUPPLY & INSTALL EUCA MULCH TO A DEPTH OF 75-100mm TO GARDEN BED.
- Area C**
 - INSTALL PROTECTIVE FENCING AROUND EXISTING GARDEN BED & TREES PRIOR TO COMMENCEMENT OF DEMOLITION & CONSTRUCTION WORKS.
 - SUPPLY & INSTALL EUCA MULCH TO A DEPTH OF 75-100mm TO GARDEN BED.
 - SUPPLY & PLANT NEW NATIVE/INDIGENOUS GRASSES & GROUNDCOVERS IN ANY BARE AREAS WITHIN BED (REFER TO PLANT SCHEDULE).

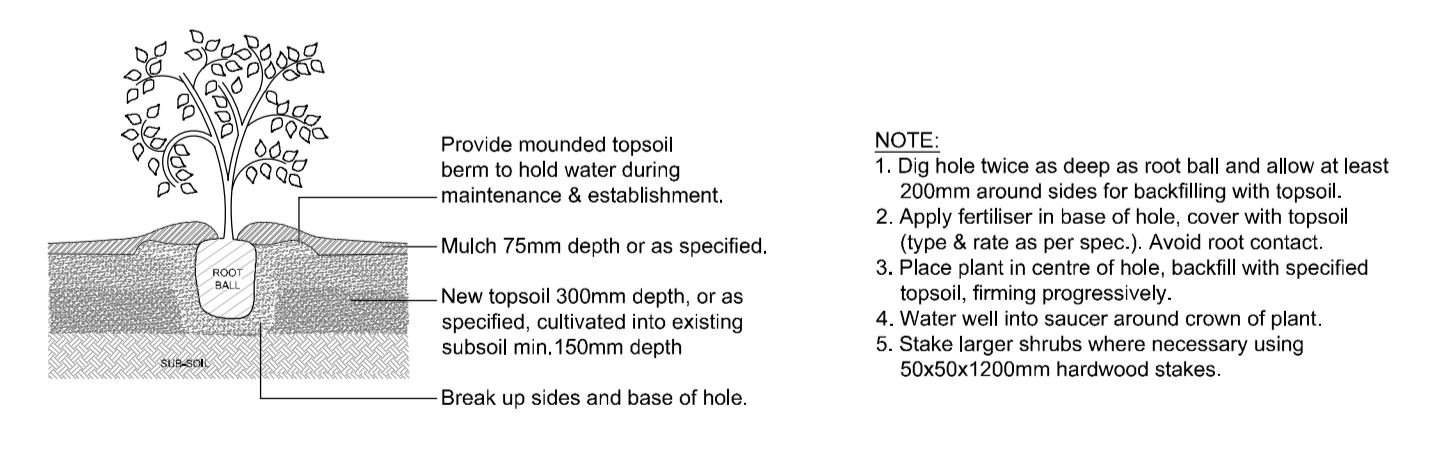
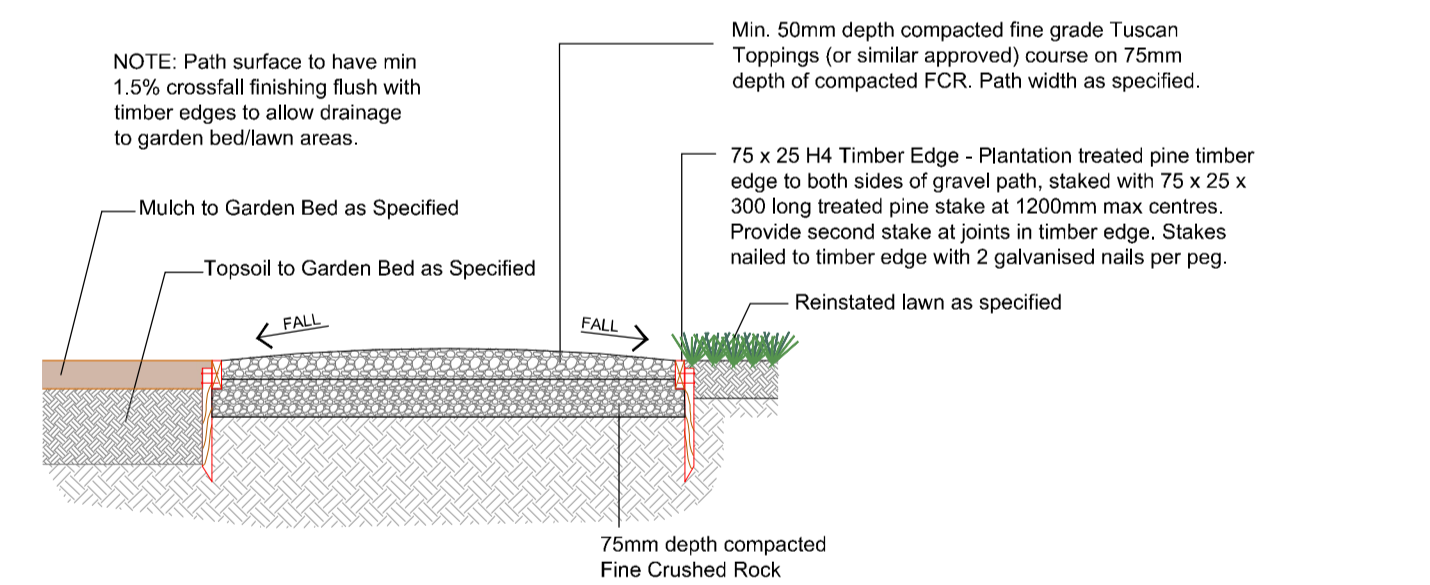

Landscape Plan
1:100 @A1 1:200 @A3

COPYRIGHT
This drawing must not be copied in whole or in part without the consent of John Patrick Landscape Architects Pty Ltd
Do not scale off drawings
NOT FOR CONSTRUCTION

This copied document to be made available for the sole purpose of enabling its consideration and review as part of a planning process under the Planning and Environment Act 1987. The document must not be used for any purpose which may breach any copyright

ADVERTISED PLAN



JOHN PATRICK LANDSCAPE ARCHITECTS PTY LTD
324 Victoria Street, Richmond, VIC 3121
T +61 3 9429 4855
F +61 3 9429 8211
admin@johnpatrick.com.au
www.johnpatrick.com.au

CLIENT
CEM
PROJECT
ST BERNADETTE'S PRIMARY SCHOOL
1264 MOUNTAIN HWY, THE BASIN, VIC. 3154

DRAWING
Concept Landscape Plan for Town Planning

SCALE 1:100 @A1
DATE FEB 2021
DRAWN
CHECKED BM
JOB NO 21-061L
DWG NO TP01
CAD FILE 21-061L.dwg