

NOTES

1. ACTUAL DIMENSIONS AND CLEARANCES MAY VARY SUBJECT TO SITE CONDITIONS.
2. DIMENSIONS OF ELECTRICAL EQUIPMENT ARE INDICATIVE ONLY. ACTUAL DIMENSIONS TO BE CONFIRMED.
3. LOCATION OF POWERCOR 22kV OVERHEAD LINE AND SYSTEM CONNECTION POINT TO BE CONFIRMED.
4. FIVE NON-NATIVE TREES NEAR WESTERN BOUNDARY ARE TO BE REMOVED.
5. PLANTED NATIVE TREES TO BE REMOVED. OTHER NATIVE VEGETATION ONSITE WILL BE KEPT.
6. POWERCOR CONNECTION POINT ALONG NARING HALL ROAD. FINAL LOCATION TBC.
7. INTERNAL ROAD INDICATIVE ONLY AND WILL ONLY BE BUILT IF REQUIRED DURING CONSTRUCTION.
8. SITE STORAGE AND AMENITY FACILITIES TO BE ON SITE ONLY DURING CONSTRUCTION PHASE. NO PERMANENT BUILDINGS TO BE KEPT ON SITE AFTER CONSTRUCTION COMPLETED.

LEGEND

- PROPOSED PV ARRAY
- SECURITY FENCE
- PROPERTY BOUNDARY

FOR INFORMATION

This copied document to be made available for the sole purpose of enabling its consideration and review as part of a planning process under the Planning and Environment Act 1987. The document must not be used for any purpose which may breach any *conditions*

ADVERTISED PLAN

No	DATE	DRN	CHK	ENG	Q.A.	PROJECT	DESCRIPTION	NUMBER	TITLE
B	04/09/20	ACE	ACE	ACE	ACE	574	REVISED FOR DELWP RFI		
A	23/04/20	ACE	ACE	ACE	ACE	574	PRELIMINARY ISSUE		
REVISION							REFERENCE DRAWINGS		



574 HENDYS ROAD, NUMURKAH VIC 4.95 MW PV EXPORT SYSTEM SITE LOCATION PLAN									
DATE: 04/09/20	DRN: ACE	CHK: ACE	ENG: ACE	Q.A: ACE	SCALE: NTS				
PROJ No: 574	DRG No:								REV B

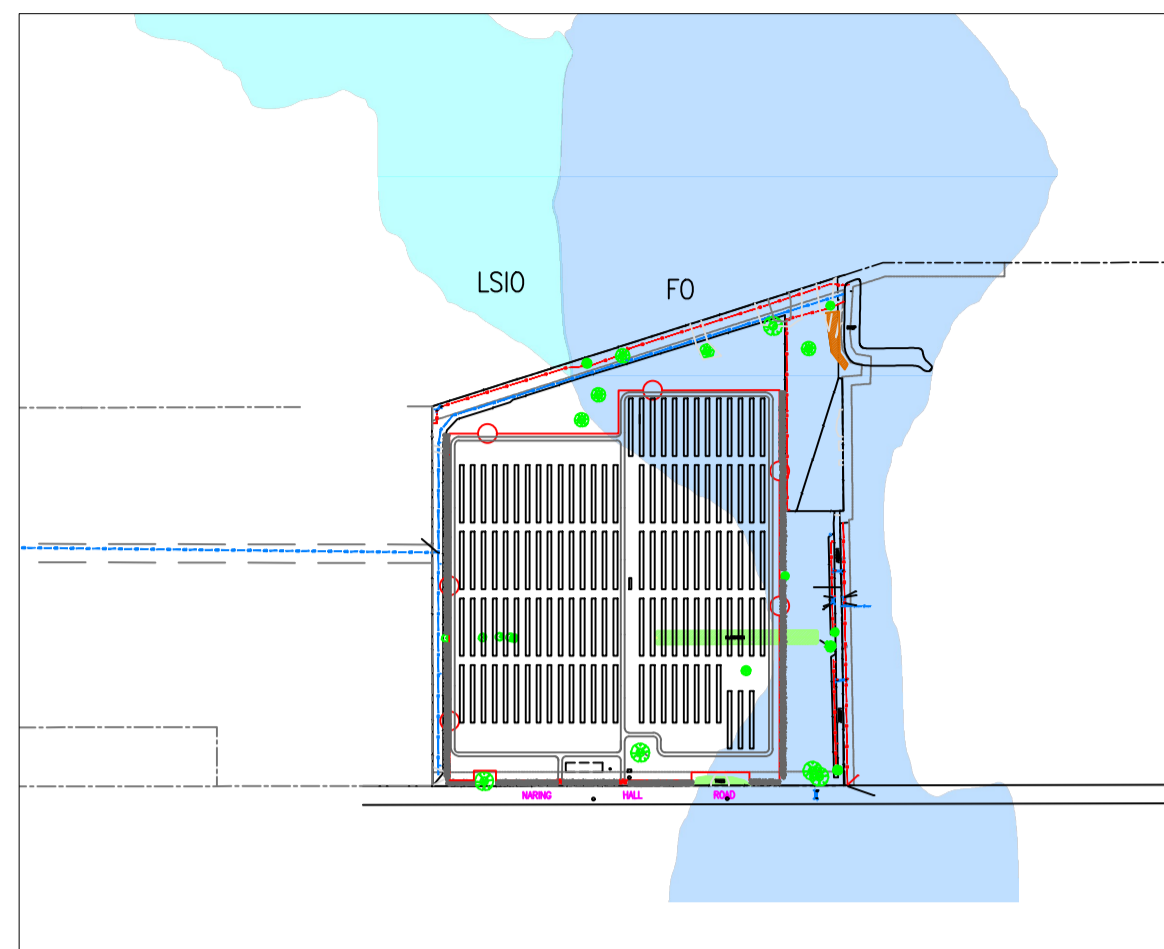
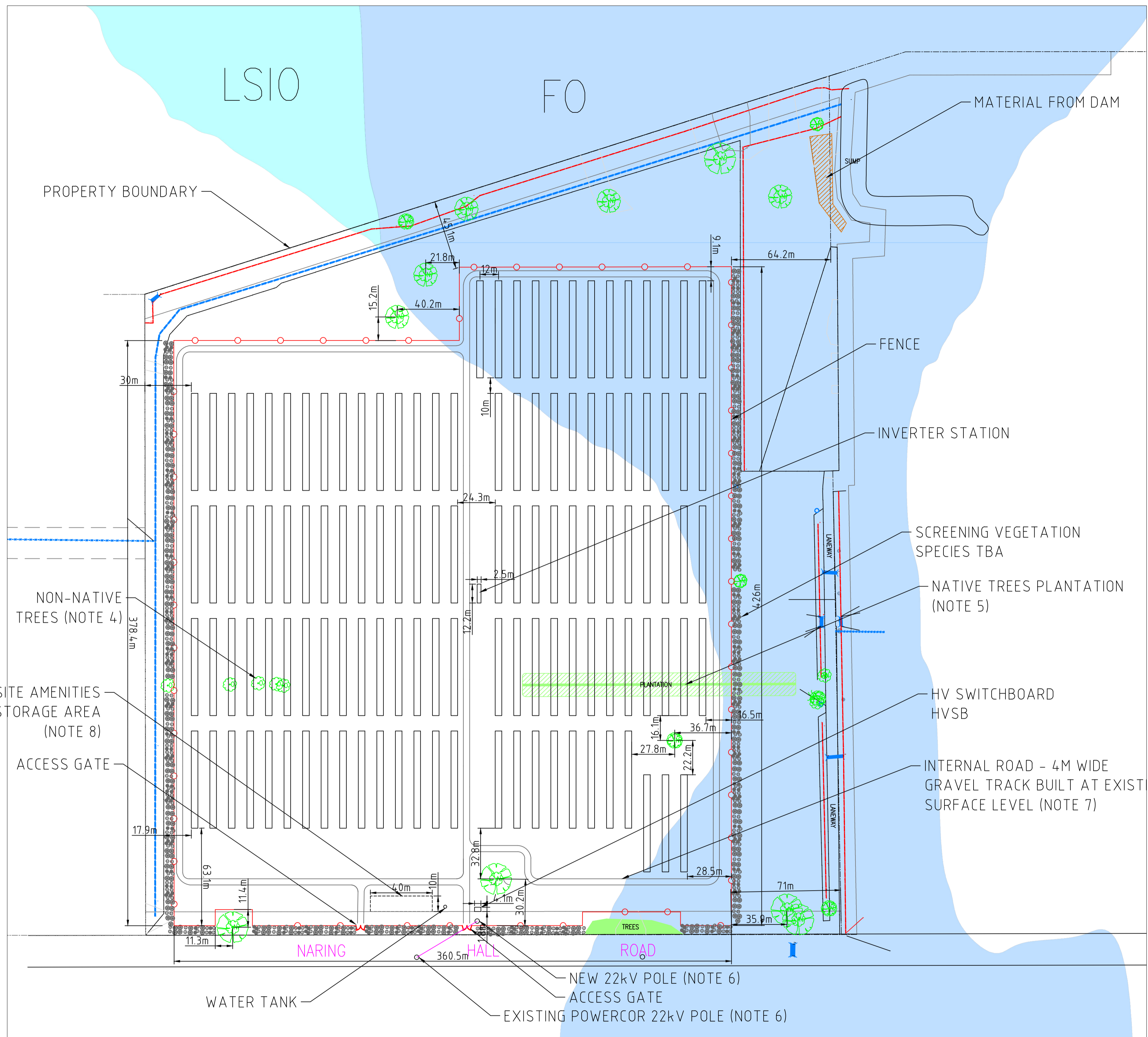
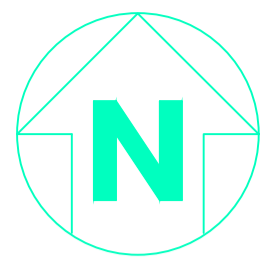

NOTES

1. ACTUAL DIMENSIONS AND CLEARANCES MAY VARY SUBJECT TO SITE CONDITIONS.
2. DIMENSIONS OF ELECTRICAL EQUIPMENT ARE INDICATIVE ONLY. ACTUAL DIMENSIONS TO BE CONFIRMED.
3. LOCATION OF POWERCOR 22kV OVERHEAD LINE AND SYSTEM CONNECTION POINT TO BE CONFIRMED.
4. FIVE NON-NATIVE TREES NEAR WESTERN BOUNDARY ARE TO BE REMOVED.
5. PLANTED NATIVE TREES TO BE REMOVED. OTHER NATIVE VEGETATION ONSITE WILL BE KEPT.
6. POWERCOR CONNECTION POINT ALONG NARING HALL ROAD. PROJECT CONNECTION TO POWERCOR 22kV NETWORK ASSUMED TO BE VIA A NEW POLE LOCATED ON SITE. FINAL CONNECTION ARRANGEMENT TO BE ADVISED BY POWERCOR.
7. INTERNAL ROAD INDICATIVE ONLY AND WILL ONLY BE BUILT IF REQUIRED DURING CONSTRUCTION.
8. SITE STORAGE AND AMENITY FACILITIES TO BE ON SITE ONLY DURING CONSTRUCTION PHASE. NO PERMANENT BUILDINGS TO BE KEPT ON SITE AFTER CONSTRUCTION COMPLETED. STORAGE AREA TO BECOME CAR PARKING POST-CONSTRUCTION.

LEGEND

- PROPOSED PV ARRAY
- SECURITY FENCE
- PROPERTY BOUNDARY
- FENCE LINE
- PROPOSED 22kV O/H LINE
- RURAL FLOODWAY
- FD FARM DRAIN
- 450 PIPELINE & SIZE
- FC FARM CHANNEL
- TREES (NATIVE, OTHER, DEAD)
- CULVERTS
- LAND SUBJECT TO INUNDATION

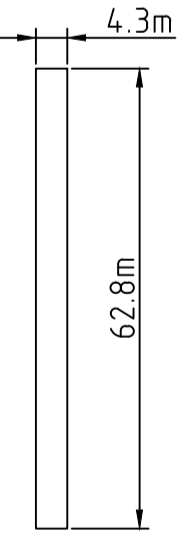

FOR INFORMATION

This copied document to be made available for the sole purpose of enabling its consideration and review as part of a planning process under the Planning and Environment Act 1987. The document must not be used for any purpose which may breach any provisions.

ADVERTISED PLAN

No	DATE	DRN	CHK	ENG	Q.A.	PROJECT	DESCRIPTION	NUMBER	TITLE
L	19/11/20	ACE	ACE	ACE	ACE	574	UPDATED LEGEND AS PER DELWP RFI		
K	04/09/20	ACE	ACE	ACE	ACE	574	ADDED NOTES AND WATER TANK		
J	02/07/20	ACE	ACE	ACE	ACE	574	MINOR UPDATE		
I	25/06/20	ACE	ACE	ACE	ACE	574	UPDATED INVERTER STATION		
H	23/04/20	ACE	ACE	ACE	ACE	574	UPDATED LAYOUT DESIGN		
G	15/04/20	ACE	ACE	ACE	ACE	574	DRAWING UPDATE		
							REVISION		REFERENCE DRAWINGS



574 HENDYS ROAD, NUMURKAH VIC 4.95 MW PV EXPORT SYSTEM SITE PLAN NO AERIAL IMAGE									
DATE: 19/11/20	DRN: ACE	CHK: ACE	ENG: ACE	Q.A: ACE	SCALE: 1:1500				
PROJ No: 574	DRG No:								REV L

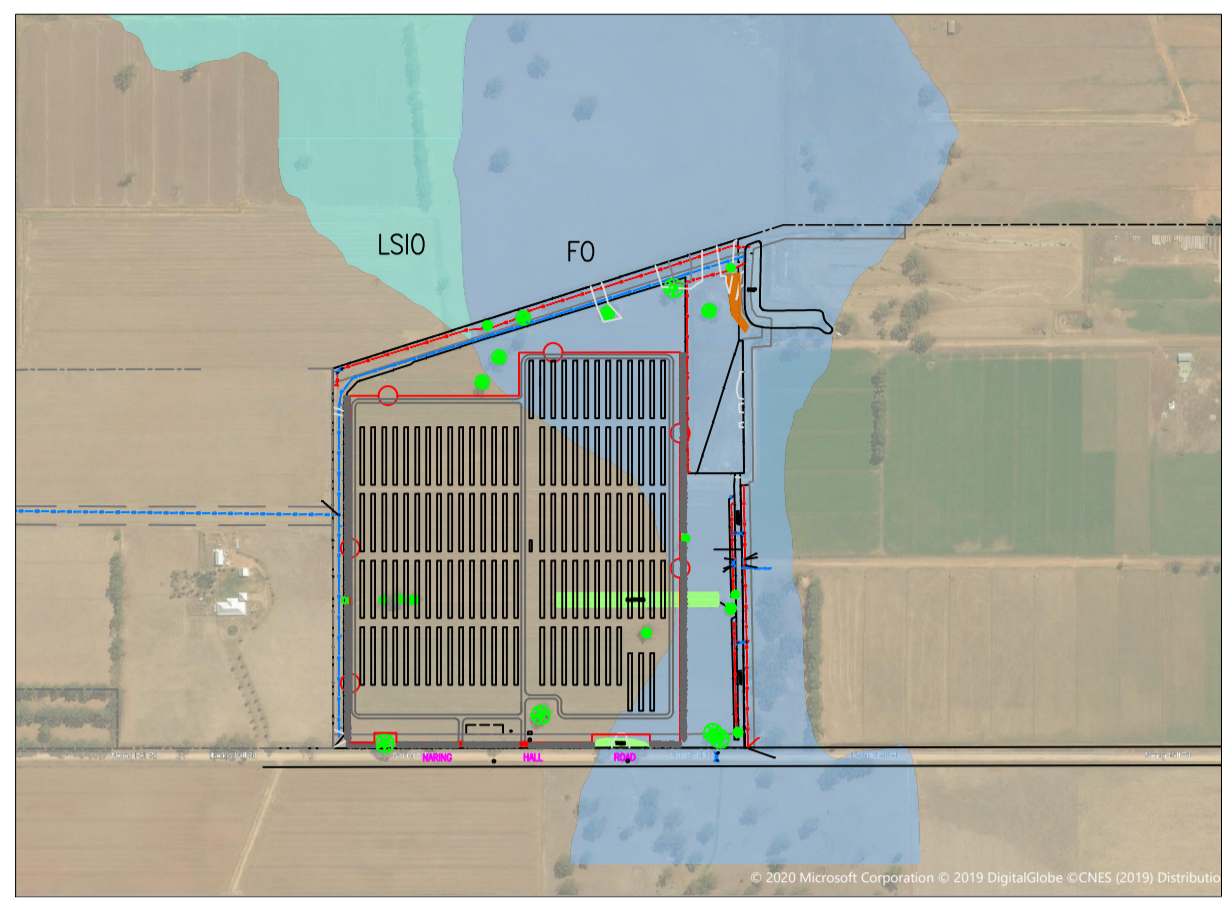
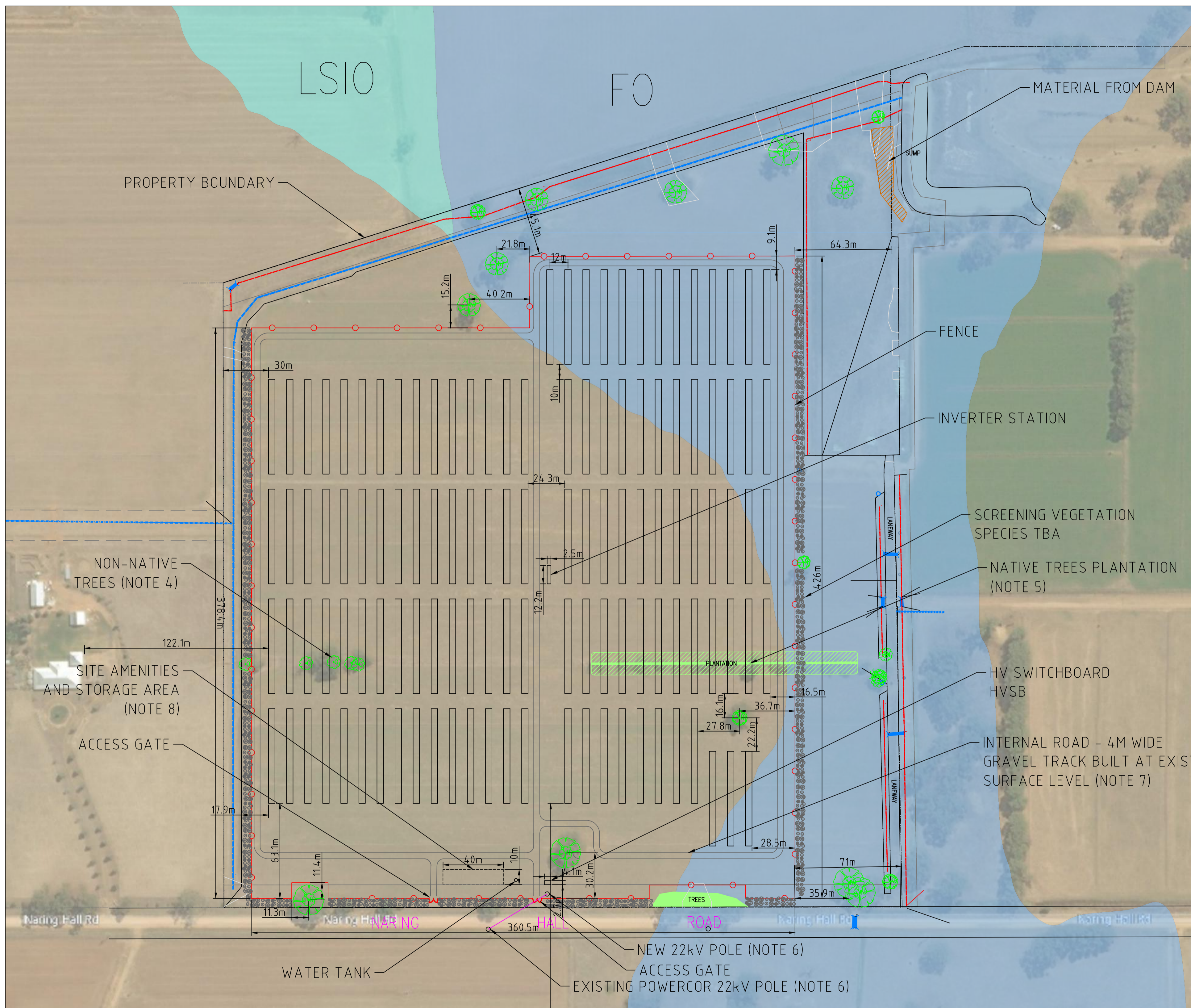
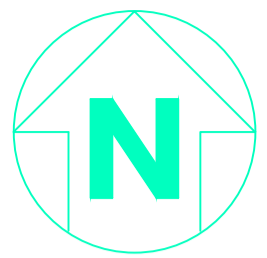

LOCATION PLAN (N.T.S)

NOTES

1. ACTUAL DIMENSIONS AND CLEARANCES MAY VARY SUBJECT TO SITE CONDITIONS.
2. DIMENSIONS OF ELECTRICAL EQUIPMENT ARE INDICATIVE ONLY. ACTUAL DIMENSIONS TO BE CONFIRMED.
3. LOCATION OF POWERCOR 22kV OVERHEAD LINE AND SYSTEM CONNECTION POINT TO BE CONFIRMED.
4. FIVE NON-NATIVE TREES NEAR WESTERN BOUNDARY ARE TO BE REMOVED.
5. PLANTED NATIVE TREES TO BE REMOVED. OTHER NATIVE VEGETATION ONSITE WILL BE KEPT.
6. POWERCOR CONNECTION POINT ALONG NARING HALL ROAD. PROJECT CONNECTION TO POWERCOR 22kV NETWORK ASSUMED TO BE VIA A NEW POLE LOCATED ON SITE. FINAL CONNECTION ARRANGEMENT TO BE ADVISED BY POWERCOR.
7. INTERNAL ROAD INDICATIVE ONLY AND WILL ONLY BE BUILT IF REQUIRED DURING CONSTRUCTION.
8. SITE STORAGE AND AMENITY FACILITIES TO BE ON SITE ONLY DURING CONSTRUCTION PHASE. NO PERMANENT BUILDINGS TO BE KEPT ON SITE AFTER CONSTRUCTION COMPLETED. STORAGE AREA TO BECOME CAR PARKING POST-CONSTRUCTION.

LEGEND

- PROPOSED PV ARRAY
- SECURITY FENCE
- PROPERTY BOUNDARY
- FENCE LINE
- PROPOSED 22kV O/H LINE
- RURAL FLOODWAY
- FD FARM DRAIN
- 450 PIPELINE & SIZE
- FC FARM CHANNEL
- TREES (NATIVE, OTHER, DEAD)
- CULVERTS
- LAND SUBJECT TO INUNDATION

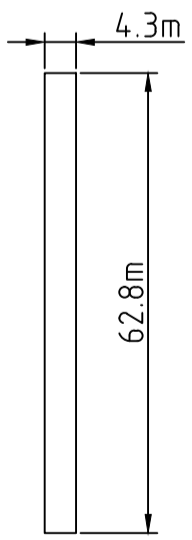

FOR INFORMATION

This copied document to be made available for the sole purpose of enabling its consideration and review as part of a planning process under the Planning and Environment Act 1987. The document must not be used for any purpose which may breach any copyright.

ADVERTISED PLAN

No	DATE	DRN	CHK	ENG	Q.A.	PROJECT	DESCRIPTION	NUMBER	TITLE
L	19/11/20	ACE	ACE	ACE	ACE	574	UPDATED DETAILS AS PER DELWP RFI		
K	04/09/20	ACE	ACE	ACE	ACE	574	ADDED NOTES AND WATER TANK		
J	02/07/20	ACE	ACE	ACE	ACE	574	MINOR UPDATE		
I	25/06/20	ACE	ACE	ACE	ACE	574	UPDATED INVERTER STATION		
H	23/04/20	ACE	ACE	ACE	ACE	574	UPDATED LAYOUT DESIGN		
G	15/04/20	ACE	ACE	ACE	ACE	574	DRAWING UPDATE		
							REVISION		REFERENCE DRAWINGS



574 HENDYS ROAD, NUMURKAH VIC
4.95 MW PV EXPORT SYSTEM
SITE PLAN

DATE: 19/11/20	DRN: ACE	CHK: ACE	ENG: ACE	Q.A: ACE	SCALE: 1:1500
PROJ No: 574	DRG No:				REV L

EDITED BY	DATE	REVISION	NOTES
GK		A	INITIAL RELEASE

MODULE RAIL SPACING

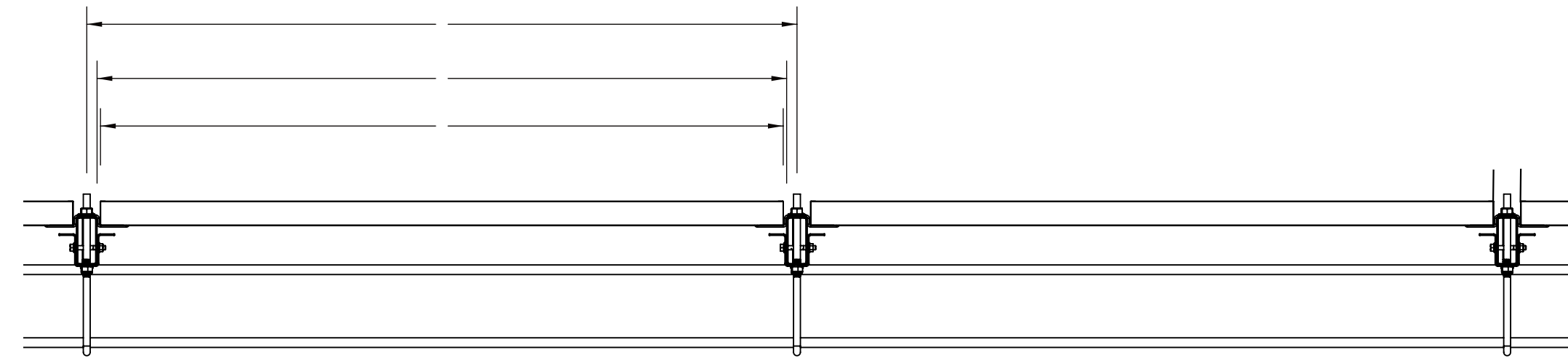

POWER MODULE DETAIL

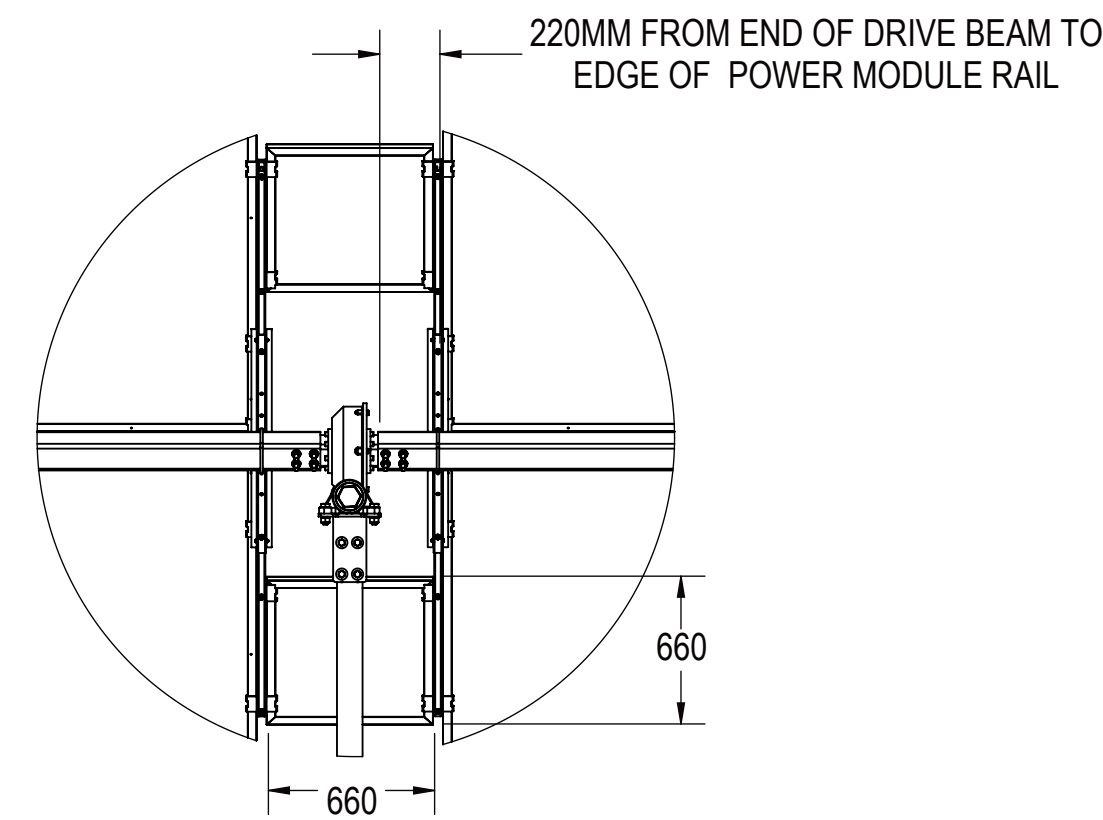

SECTION VIEW: MODULE RAIL - POWARCINCH

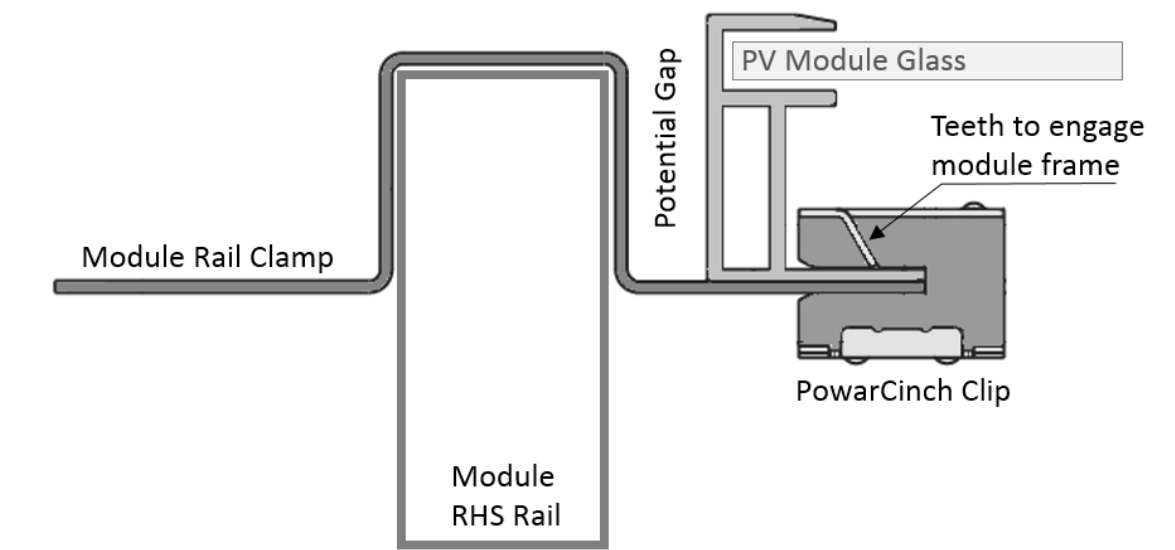

MECHANICAL LAYOUT

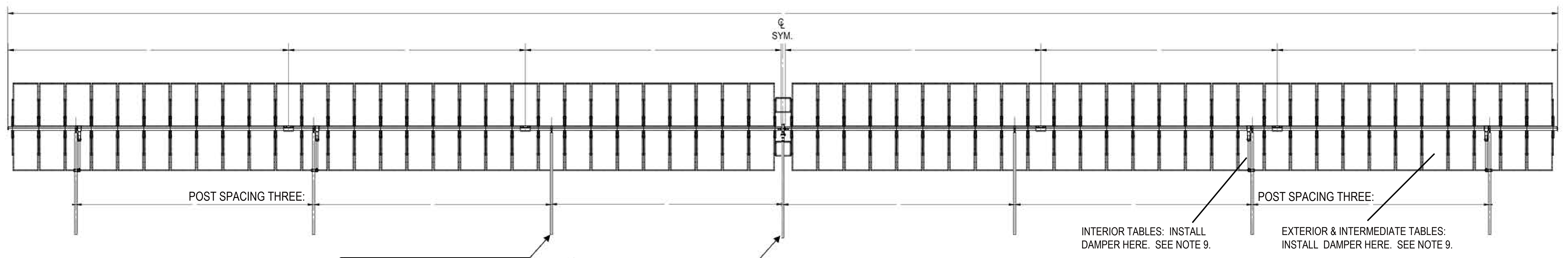

ELEVATION VIEWS

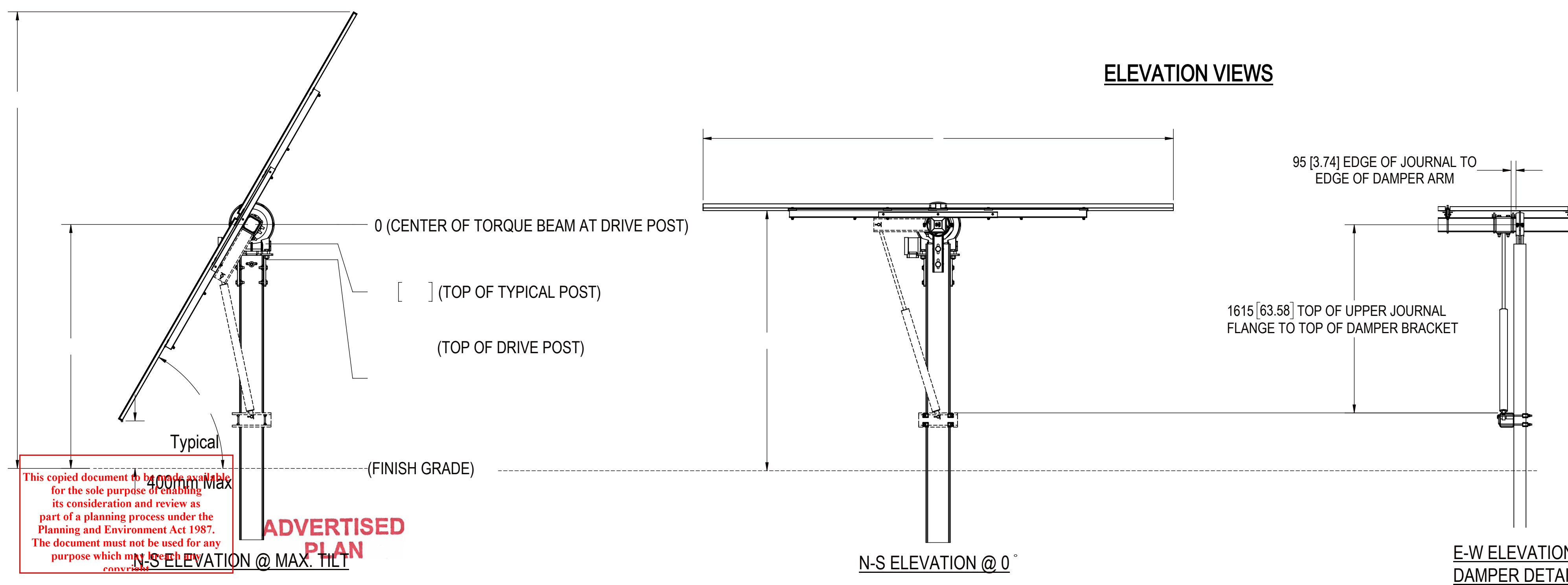

SYSTEM SPECIFICATIONS

PROJECT:	
SYSTEM VOLTAGE:	
STRING SIZE:	
# STRINGS:	
# MODULES / ROW:	
# POWARCINCH / MODULE:	

PROJECT DESIGN NOTES:

1. APPLICABLE DESIGN CODES:	AS1170
2. SITE WIND SPEED:	
3. STOW FLAT :	WIND SPEED > 33 MPH.
4. GROUND SNOW:	
5. SYSTEM VOLTAGE:	
6. MODULE TYPE:	
7. GROUND COVERAGE RATIO (GCR):	
8. CORROSION CATEGORY	
9. EXTERIOR AND INTERMEDIATE ROWS: 4 DAMPERS	
INTERIOR ROWS: 2 DAMPERS. ALL FACE TOWARD SLEW DRIVE.	

DRAWING #:

This copied document to be made available for the sole purpose of enabling its consideration and review as part of a planning process under the Planning and Environment Act 1987. The document must not be used for any purpose which may be prohibited by the Act.

ADVERTISED PLAN

TYPICAL HIGH VOLTAGE SWITCHBOARD ENCLOSURE ELEVATION DETAILS

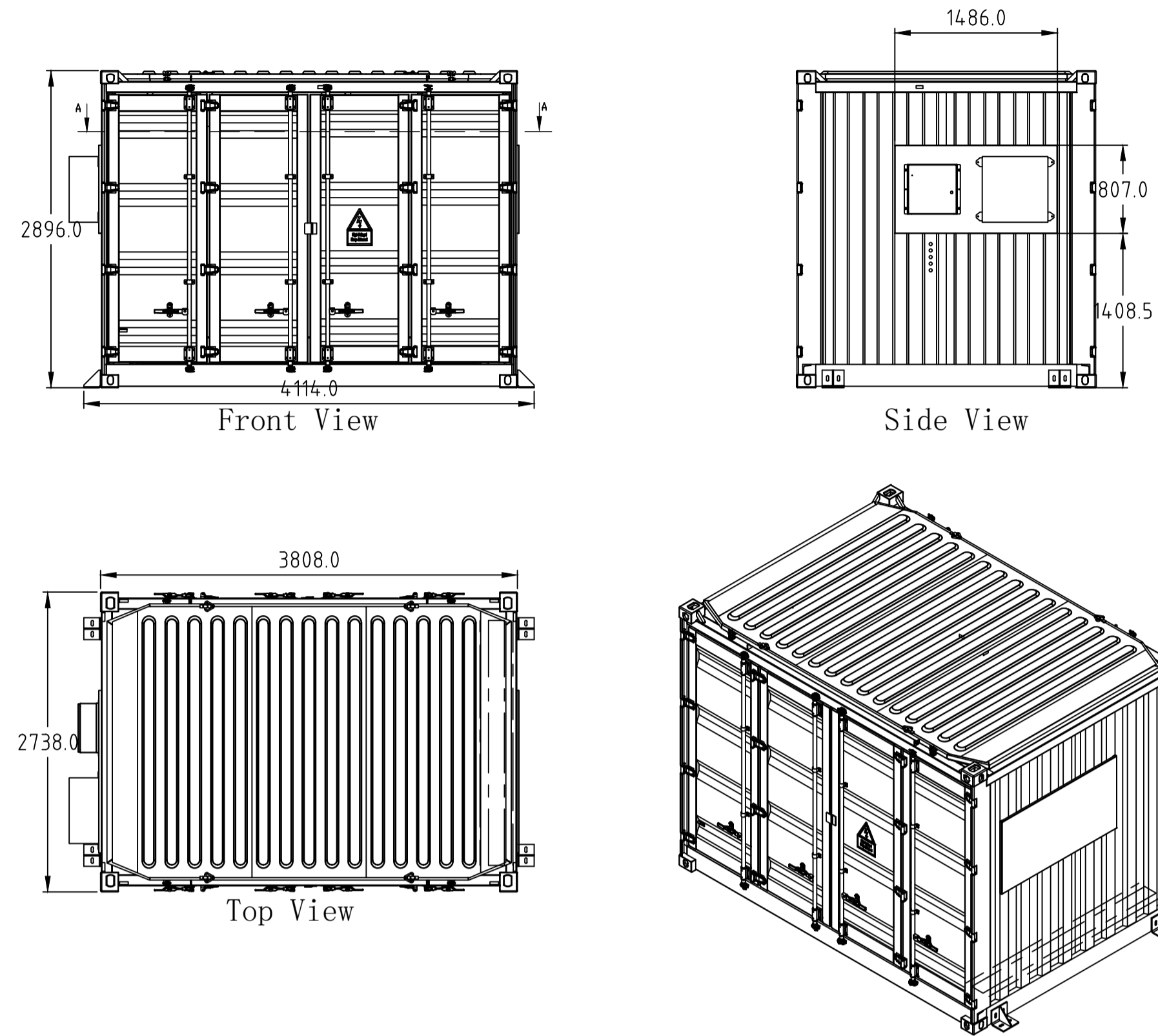

TYPICAL INVERTER STATION ELEVATION DETAILS

(containing inverters and inverter transformer)

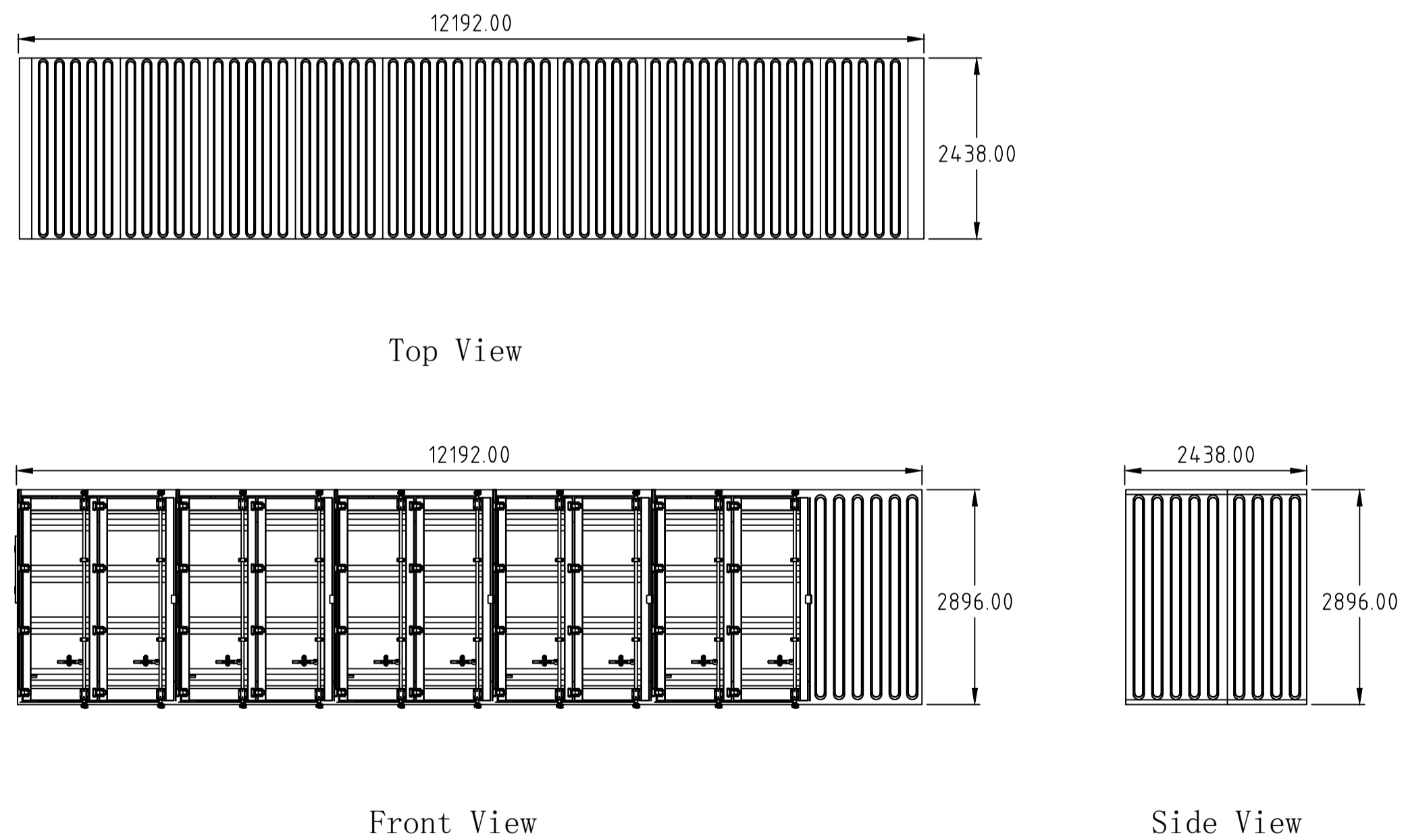

NOTE:

1. ALL DIMENSIONS ARE IN MILLIMETRES UNLESS OTHERWISE NOTED.
2. ACTUAL DIMENSIONS OF THE EQUIPMENT MAY VARY BASED ON THE SPECIFICATIONS OF EQUIPMENT MANUFACTURERS.

FOR INFORMATION

This copied document to be made available for the sole purpose of enabling its consideration and review as part of a planning process under the Planning and Environment Act 1987. The document must not be used for any purpose which may breach any copyright.

ADVERTISED PLAN

No	DATE	DRN	CHK	ENG	Q.A.	PROJECT	DESCRIPTION	NUMBER	TITLE
B	20/11/20	ACE	ACE	ACE	ACE		UPDATED INVERTER STATION		
A	13/03/20	ACE	ACE	ACE	ACE		PRELIMINARY ISSUE		
REVISION							REFERENCE DRAWINGS		



GENERAL SOLAR FARM
ELECTRICAL EQUIPMENT ELEVATIONS

DATE: 13/03/20	DRN: ACE	CHK: ACE	ENG: ACE	Q.A: ACE	SCALE: NTS
PROJ No	DRG No				REV B

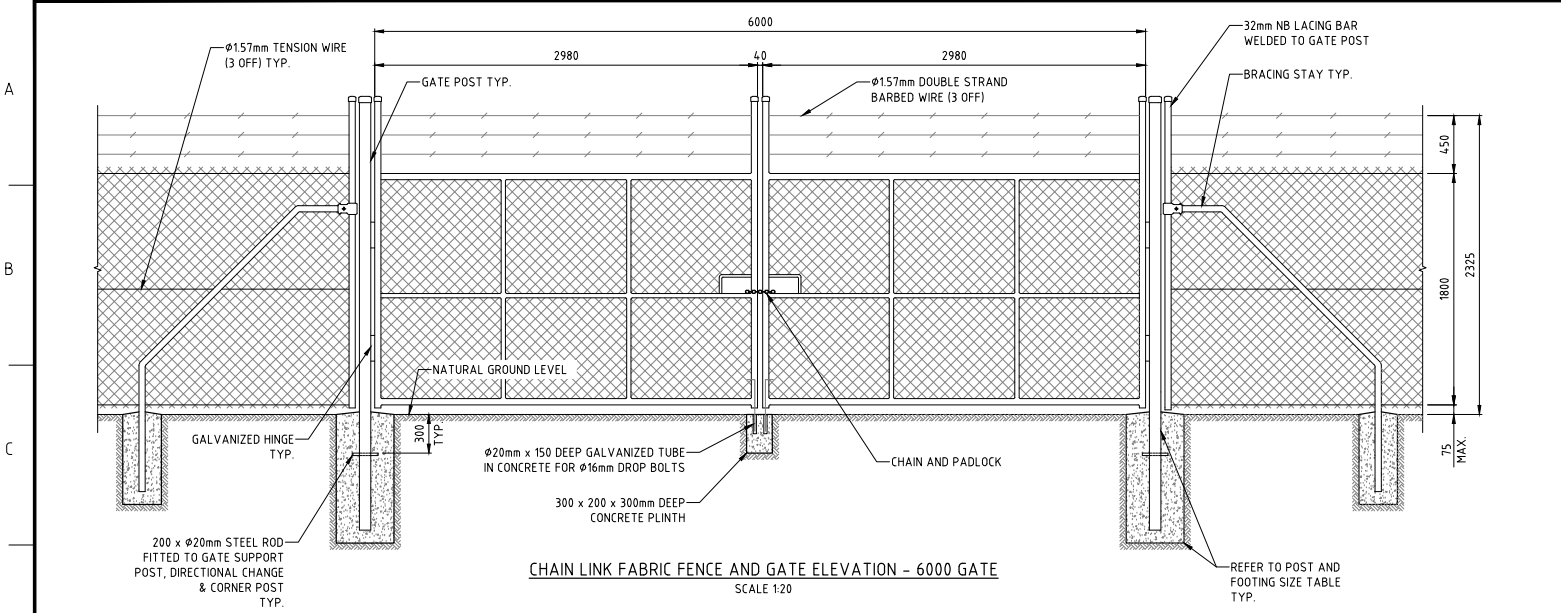

CHAIN LINK FABRIC FENCE AND GATE ELEVATION - 6000 GATE
SCALE 1:20

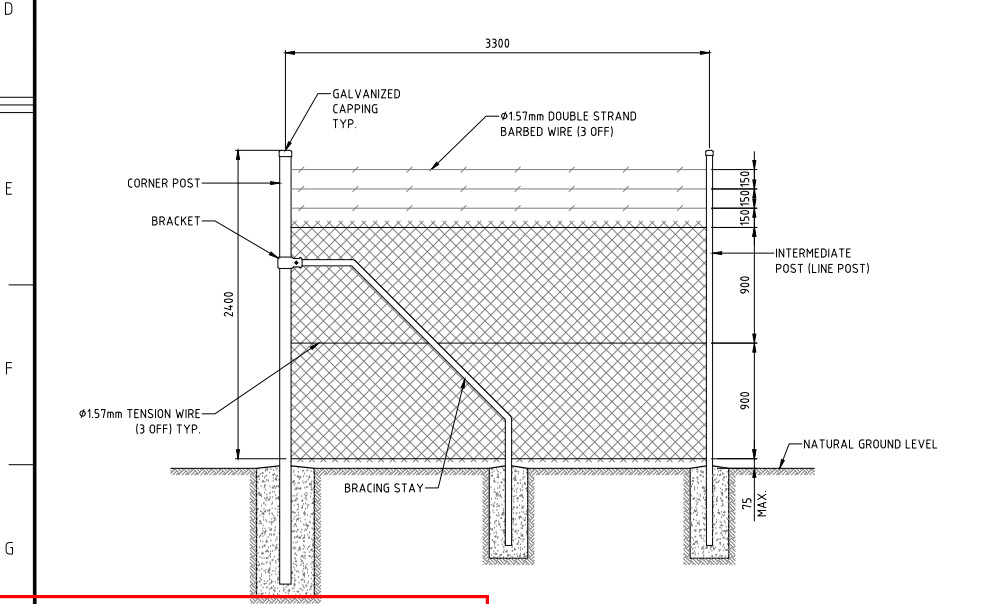

TYPICAL CHAIN MESH FENCE PANEL
SCALE 1:20

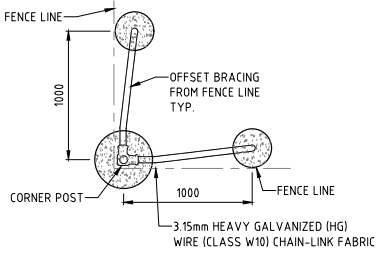

CORNER POST FOOTING PLAN (<=90°)
SCALE 1:20

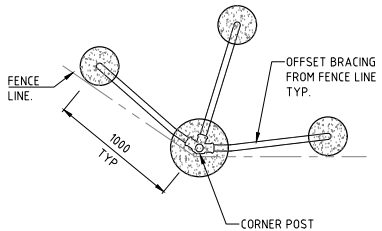

CORNER POST FOOTING PLAN (>90°)
SCALE 1:20

- NOTES**
- CHAIN LINK FABRIC FENCE TO BE CLASS 1 TYPE 1-R-L/B-T AS PER AS1725.1 WITH BARBED TOP.
 - CHAIN LINK FABRIC TO BE ZINC/ALUMINIUM-ALLOY 3.15mm (HEAVY DUTY) WIRE WITH 50mm NOMINAL PITCH MESH (OR SIMILAR APPROVED).
 - CHAIN LINK FABRIC TO BE LACED WITH 2mm ZINC/ALUMINIUM-ALLOY WIRE (OR SIMILAR APPROVED).
 - SUPPORT CABLE TO BE 4mm ZINC/ALUMINIUM-ALLOY HELICOIL CABLE WIRE (OR SIMILAR APPROVED) INSTALLED MID-PANEL, TOP AND BOTTOM.
 - CHAIN LINK FABRIC AND SUPPORT CABLES TO BE TENSIONED AS PER AS 1725.1.
 - ALL MEMBERS INCLUDING: POSTS, STAYS, RAILS AND GATES TO BE GALVANIZED MEDIUM QUALITY PIPES TO AS1163 OR AS1074 U.N.O. DAMAGED SURFACES TO BE TOUCHED UP WITH THREE DOUBLE COATS OF AEROSOL COLD GALVANIZED PRIMER.
 - ALL POSTS ARE TO BE FITTED WITH CAPS.
 - POST FITTINGS SHALL BE GALVANIZED SPLIT CLAMP TYPE.
 - FASTENERS SHALL BE HOT-DIP GALVANIZED METRIC COARSE THREAD, WITH NUTS FITTED INSIDE THE FENCE.
 - CONCRETE FOOTINGS SHALL BE IN ACCORDANCE WITH AS3600, AND NOT LESS THAN THE MINIMUM SIZES SPECIFIED ON THIS DRAWING.
 - CONCRETE SHALL HAVE A CHARACTERISTIC COMPRESSIVE STRENGTH AT 28 DAYS OF 20MPa.
 - GATES SHALL BE DESIGNED TO SWING OUTWARDS ONLY.
 - A GALVANIZED, TAMPER RESISTANT ENCLOSED PAD BOLT SHALL BE WELDED TO EACH GATE OR PAIR OF GATES AT 1100mm ABOVE FSL, SUITABLE FOR A PADLOCK WITH A 9.5mm SHACKLE.
 - FOR GATE PAIRS, HEAVY DUTY GALVANIZED DROP BOLTS SHALL BE WELDED TO EACH GATE, SUITABLE FOR THE DROP BOLT FOOTING SPECIFIED ON THIS DRAWING.
 - FOR GENERAL CIVIL & CONCRETE NOTES REFER TO DRAWING 19887-11-40-022.
 - FOR GENERAL STRUCTURAL STEELWORK NOTES REFER TO DRAWING 19887-11-90-005.
 - THIS DRAWING IS TO BE READ IN CONJUNCTION WITH AS 1725.1 AND PLC FENCING DESIGN DOCUMENTS AND DRAWINGS.
 - FENCE AND GATE DETAILS PROVIDED ON THIS DRAWING ARE TO BE USED AS AN ALTERNATIVE TO THE DETAILS PROVIDED ON DRG. 19887-11-40-012.

TYPE	POST		FOOTING SIZE	
	O.D	WALL	φ DIA.	DEPTH
CORNER/END	88.9	4.88	300	900
INTERMEDIATE	48.3	4.0	250	650
BRACING STRUTS	48.3	4.0	-	-
BRACING STAY	48.3	4.0	250	750

WIDTH OF GATE OPENING	DOUBLE SWING GATES			
	GATE POST		MIN. SIZE OF FOOTING	
	O.D	WALL THICKNESS	φ DIA.	DEPTH
6000	88.9	4.88	400	1200

ISSUED FOR CONSTRUCTION

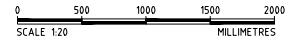

This copied document to be made available for the sole purpose of enabling its consideration and review as part of a planning process under the Planning and Environment Act 1987. The document must not be used for any purpose which may breach any copyright

REVISION	DATE	DRN	CHK	ENG	Q.A.	PROJECT	DESCRIPTION	NUMBER	TITLE
0	03/04/20	GPA	AM	YMT	RHL	19887	ISSUED FOR CONSTRUCTION		



www.gpaeng.com.au

GOLDEN INVEST										
CHAIN WIRE MESH SECURITY FENCE & GATE FENCING STANDARD DETAILS (TYPE B)										
DATE: 03/04/20	DRN: GPA	CHK: AM	ENG: YMT	Q.A: RHL	SCALE: NTS					
PROJ No: 19887	DRG No: 19887-11-40-025									REV 0

1 2 3 4 5 6 7 8 9 10 11 12

A

B

C

D

E

F

G

H

A

B

C

D

E

F

G

H

PROPOSED POWERCOR
22kV OVERHEAD LINE

PROPOSED POWERCOR
22kV POLE

PROPOSED FENCE

10.3m

10.3m

3.8m

2.9m

2.7m

NARING HALL ROAD

6m

EXISTING POWERCOR
22kV POLE

PROPOSED HVSB AND
CONNECTION TO GRID (NOTE 1)

PROPOSED SCREENING
VEGETATION SITE BOUNDARY
VEGETATION

NOTES

1. DIMENSIONS OF THE PROPOSED HVSB TO BE APPROX. 3.8m(W) x 2.9m(H) x 2.7m(D). FINAL DIMENSIONS TBA DURING DETAILED DESIGN.
2. DIMENSIONS OF INVERTER STATION TO BE APPROX. 12m(W) x 2.9m(H) x 2.4m(D) AS PER MANUFACTURER DATASHEET.

This copied document to be made available for the sole purpose of enabling its consideration and review as part of a planning process under the Planning and Environment Act 1987. The document must not be used for any purpose which may breach any provisions

**ADVERTISED
PLAN**

FOR INFORMATION

No	DATE	DRN	CHK	PROJECT	DESCRIPTION
B	19/11/20	ACE	ACE	574	UPDATED AS PER DELWP RFI
A	04/09/20	ACE	ACE	574	FOR INFORMATION
REVISION					



574 HENDYS ROAD, NUMURKAH VIC
4.95W PV EXPORT SYSTEM
NETOWRK CONNECTION ELEVATION PLAN

DATE: 19/11/20	DRN: ACE	CHK: ACE	SCALE: NTS
DRG No			REV B