

CO-ORDINATE INFORMATION	PROPOSED POLE CENTRE	G.D.A.	LATITUDE (S) 36.98345°
	AHD RL. 1754 (APPROX)	M.G.A. ZONE 55	LONGITUDE (E) 147.14291°
COORDINATE SOURCE: L.R.S. DATUM GDA 2020			E: 512718.3
Surveyed ±0.05m			N: 5906953.9

**WARNING**

ONLY VISIBLE SERVICES ARE DEPICTED ON THIS PLAN.  
THIS IS FOR PLANNING PURPOSES ONLY.

PERSONS EXCAVATING THIS SITE MAY BE HELD FINANCIALLY RESPONSIBLE IF SERVICES ARE DAMAGED. MINIMISE THIS RISK BY CONTACTING "DIAL BEFORE YOU DIG" CALL 1100.

SERVICES ON PRIVATE PROPERTY MAY NOT BE ON PUBLIC RECORD. THE SITE OWNER MUST BE CONTACTED FOR THIS INFORMATION.

**LEGEND**

FENCE ON BOUNDARY	
FENCE OFF BOUNDARY	
GATE	
ELECTRICITY ABOVE	
ELECTRICITY U/GROUND	
TELEPHONE ABOVE	
TELEPHONE U/GROUND	
OPTIC FIBRE CABLE	
GAS	
WATER	
SEWER	
STORMWATER	
U/G WAVEGUIDE	
EARTH STRAP	
<b>TREE DETAILS</b>	
SP - SPREAD	
TRØ - TRUNK DIAMETER	
H - HEIGHT	

**FOR CONSTRUCTION**

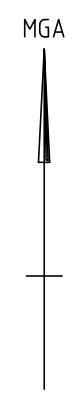

**ADVERTISED PLAN**

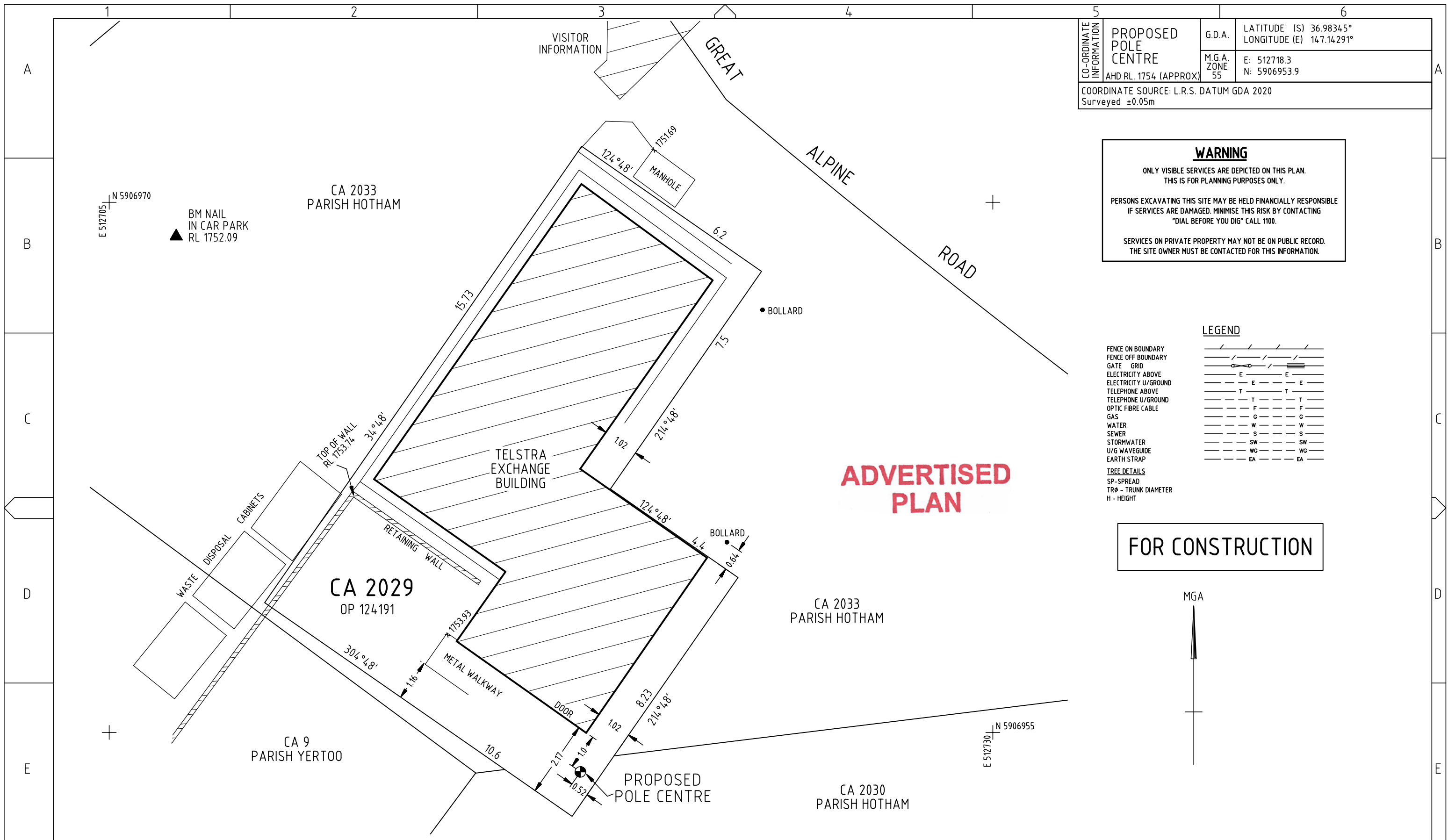

**NOTES**

1. All additions and amendments to this plan must be fixed by survey.

2. For Boundary information see

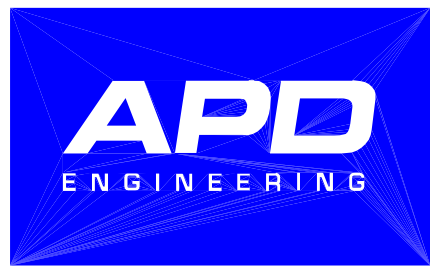

ORDER	DRAWN	CHKD	AMENDMENT	EXAM	APPD	DATE	ISS
VT23421.01	KM	CW	Original	SEJ	JM	22/6/22	1

**Telstra**

SMALL CELL SITE  
HOTHAM VILLAGE EXCHANGE  
SITE DETAIL PLAN  
34A GREAT ALPINE RD, HOTHAM HEIGHTS, VIC 3741

DWG NO. **SG22213** SHT NO. **G2** INDEX