

Copyright State of Victoria. No part of this publication may be reproduced except as permitted by the Copyright Act 1968 (Cth), to comply with a statutory requirement or pursuant to a written agreement. The information is only valid at the time and in the form obtained from the LANDATA REGD TM System. None of the State of Victoria, its agents or contractors, accepts responsibility for any subsequent publication or reproduction of the information.

The Victorian Government acknowledges the Traditional Owners of Victoria and pays respects to their ongoing connection to their Country, History and Culture. The Victorian Government extends this respect to their Elders, past, present and emerging.

REGISTER SEARCH STATEMENT (Title Search) Transfer of Land Act 1958

VOLUME 08303 FOLIO 787

Security no : 124128580116H
Produced 01/10/2025 03:03 PM

LAND DESCRIPTION

Lot 1 on Plan of Subdivision 130932.
PARENT TITLE Volume 06123 Folio 414
Created by instrument B149849 06/02/1961

REGISTERED PROPRIETOR

Estate Fee Simple
Sole Proprietor
PARED VICTORIA LTD of 20 A'BECKETT ROAD NARRE WARREN NORTH VIC 3804
AR513178C 03/10/2018

ENCUMBRANCES, CAVEATS AND NOTICES

MORTGAGE AT966774N 20/01/2021
THE ROMAN CATHOLIC TRUSTS CORPORATION FOR THE DIOCESE OF MELBOURNE

Any encumbrances created by Section 98 Transfer of Land Act 1958 or Section 24 Subdivision Act 1988 and any other encumbrances shown or entered on the plan or imaged folio set out under DIAGRAM LOCATION below.

DIAGRAM LOCATION

SEE LP130932 FOR FURTHER DETAILS AND BOUNDARIES

ACTIVITY IN THE LAST 125 DAYS

NIL

-----END OF REGISTER SEARCH STATEMENT-----

Additional information: (not part of the Register Search Statement)

Street Address: 19-23 HORSWOOD ROAD NARRE WARREN NORTH VIC 3804

ADMINISTRATIVE NOTICES

NIL

eCT Control 16667Y GADENS LAWYERS
Effective from 20/01/2021

DOCUMENT END

Delivered from the LANDATA System by Dye & Durham Terrain Pty Ltd

**ADVERTISED
PLAN**

LP130932

EDITION 2
APPROVED 2/8/79

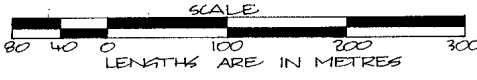
<p>PLAN OF SUBDIVISION OF PART OF CROWN ALLOTMENT I, SECTION 21</p> <p>PARISH OF NARREE WORRAN COUNTY OF MORNINGTON</p>  <p>SCALE LENGTHS ARE IN METRES</p>	<p>APPROPRIATIONS</p> <p>BLUE - ELECTRICITY SUPPLY PURPOSES.</p> <p>GREEN - EASEMENT FOR PIPELINE, CHANNEL AND CARRIAGEWAY PURPOSES PURSUANT TO SEC.17^A OF THE DANDENONG VALLEY AUTHORITY ACT 1963.</p>	<p>ENCUMBRANCES & NOTATIONS</p> <p>YELLOW - APPURTENANT EASEMENT OF WAY VIDE F.34084.</p>
	<p>PARISH OF SHIP CHART II</p> <p>COLOUR CONVERSION BLUE = E-1 GREEN = E-2 YELLOW = A-1</p>	

V.8303 F.787

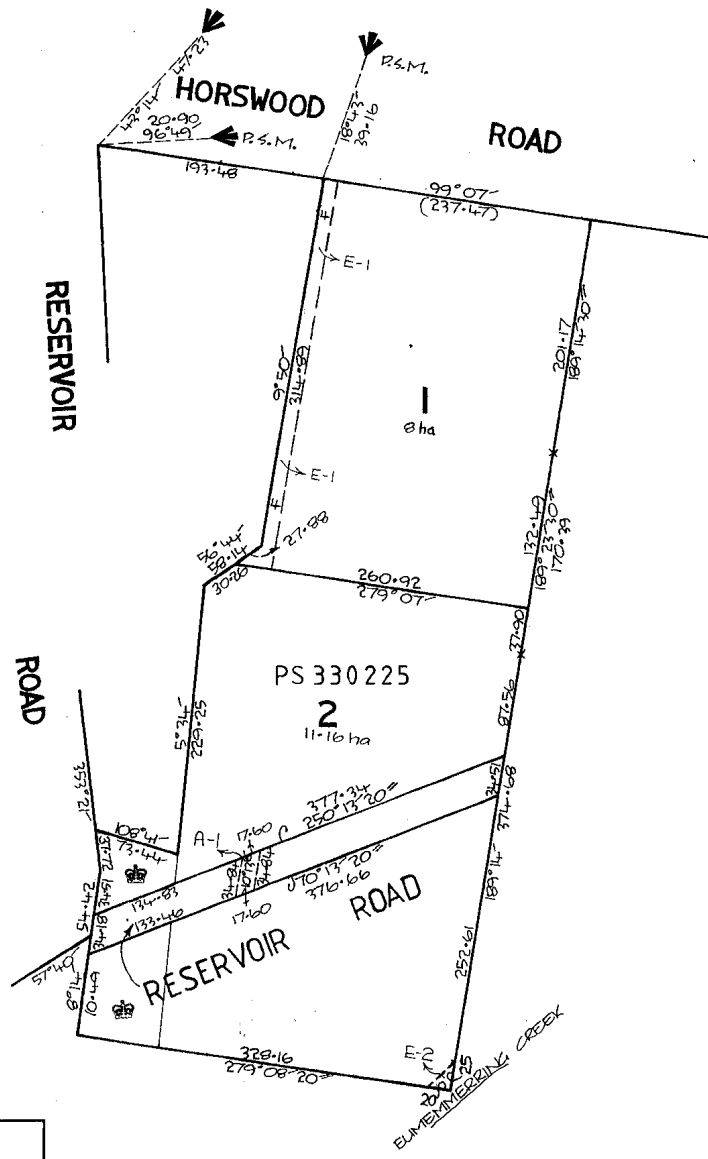

LIST OF MODIFICATIONS				
LAND	MODIFICATION	DEALING No:	A.R.T.	NEW EDN.
LOT 2 PART	TRANSFER TO THE CROWN	JB38702		2
LOT 1	RECTIFICATION	S.B.13259B		2
-	ROAD NAME CHANGE	GAZ 85 P 3441		2