

**REGISTER SEARCH STATEMENT (Title Search) Transfer of
Land Act 1958**

VOLUME 08697 FOLIO 016

Security no : 124130372134M
Produced 01/12/2025 03:04 PM

LAND DESCRIPTION

Lot 1 on Plan of Subdivision 044474.
PARENT TITLE Volume 08343 Folio 868
Created by instrument C902324 05/10/1967

**ADVERTISED
PLAN**

REGISTERED PROPRIETOR

Estate Fee Simple
Sole Proprietor

THE ROMAN CATHOLIC TRUSTS CORPORATION FOR THE DIOCESE OF MELBOURNE of
CATHEDRAL PLACE EAST MELBOURNE
D162038 15/08/1968

ENCUMBRANCES, CAVEATS AND NOTICES

Any encumbrances created by Section 98 Transfer of Land Act 1958 or Section 24 Subdivision Act 1988 and any other encumbrances shown or entered on the plan or imaged folio set out under DIAGRAM LOCATION below.

DIAGRAM LOCATION

SEE LP044474 FOR FURTHER DETAILS AND BOUNDARIES

ACTIVITY IN THE LAST 125 DAYS

NIL

-----END OF REGISTER SEARCH STATEMENT-----

Additional information: (not part of the Register Search Statement)

Street Address: 35 WILLIAM STREET GLENROY VIC 3046

DOCUMENT END

**This copied document to be made available
for the sole purpose of enabling
its consideration and review as
part of a planning process under the
Planning and Environment Act 1987.
The document must not be used for any
purpose which may breach any
copyright**

Imaged Document Cover Sheet

The document following this cover sheet is an imaged document supplied by LANDATA®, Secure Electronic Registries Victoria.

Document Type	Plan
Document Identification	LP044474
Number of Pages (excluding this cover sheet)	1
Document Assembled	01/12/2025 15:04

Copyright and disclaimer notice:

© State of Victoria. This publication is copyright. No part may be reproduced by any process except in accordance with the provisions of the Copyright Act 1968 (Cth) and for the purposes of Section 32 of the Sale of Land Act 1962 or pursuant to a written agreement. The information is only valid at the time and in the form obtained from the LANDATA® System. None of the State of Victoria, LANDATA®, Secure Electronic Registries Victoria Pty Ltd (ABN 86 627 986 396) as trustee for the Secure Electronic Registries Victoria Trust (ABN 83 206 746 897) accept responsibility for any subsequent release, publication or reproduction of the information.

The document is invalid if this cover sheet is removed or altered.

This copied document to be made available for the sole purpose of enabling its consideration and review as part of a planning process under the Planning and Environment Act 1987. The document must not be used for any purpose which may breach any copyright

**ADVERTISED
PLAN**

LP 44474

ADVERTISED
PLAN

PLAN OF SUBDIVISION OF

EDITION 1
PLAN MAY BE LODGED 2013 159

PART OF CROWN PORTION 1

PARISH OF WILL WILL ROOK

COUNTY OF BOURKE

SCALE: 20 FEET TO AN INCH

THE LAND COLOURED YELLOW AND BLUE
IS APPROPRIATED
OR SET APART FOR
EASEMENTS OF PARTY WALL

√.8050	F. 406
√.8153	F. 992
√.8173	F. 950

COLOUR CONVERSION
E-1 = BLUE
E-2 = YELLOW

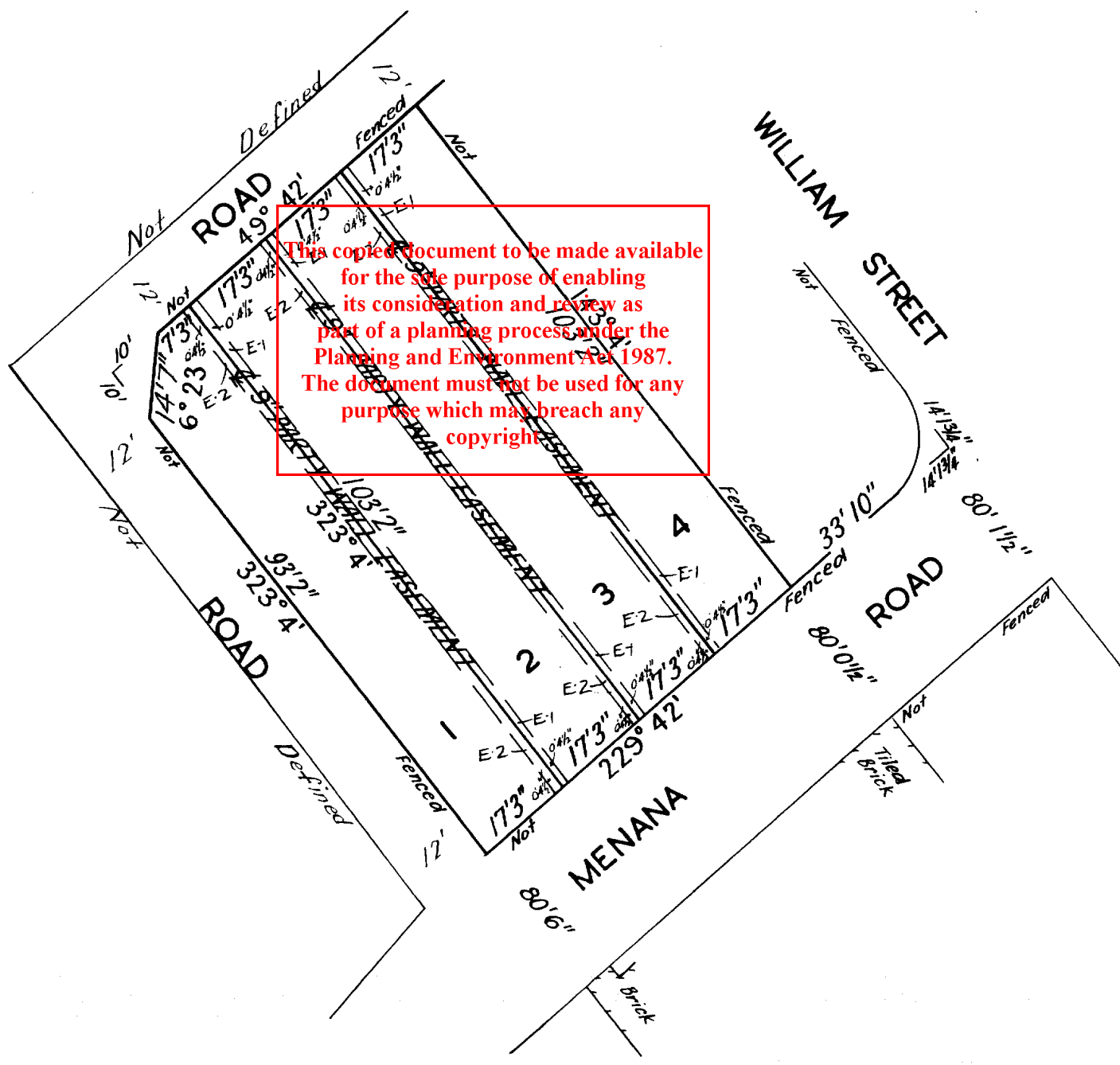
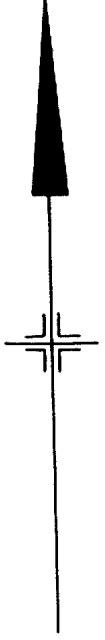

**REGISTER SEARCH STATEMENT (Title Search) Transfer of
Land Act 1958**

VOLUME 08305 FOLIO 036

Security no : 124130372138H
Produced 01/12/2025 03:04 PM

LAND DESCRIPTION

Lot 2 on Plan of Subdivision 044474.
PARENT TITLE Volume 08305 Folio 035
Created by instrument A757577 16/06/1959

**ADVERTISED
PLAN**

REGISTERED PROPRIETOR

Estate Fee Simple
Sole Proprietor

THE ROMAN CATHOLIC TRUSTS CORPORATION FOR THE DIOCESE OF MELBOURNE of
CATHEDRAL PLACE EAST MELBOURNE
D162039 15/08/1968

ENCUMBRANCES, CAVEATS AND NOTICES

Any encumbrances created by Section 98 Transfer of Land Act 1958 or Section 24 Subdivision Act 1988 and any other encumbrances shown or entered on the plan or imaged folio set out under DIAGRAM LOCATION below.

DIAGRAM LOCATION

SEE LP044474 FOR FURTHER DETAILS AND BOUNDARIES

ACTIVITY IN THE LAST 125 DAYS

NIL

-----END OF REGISTER SEARCH STATEMENT-----

Additional information: (not part of the Register Search Statement)

Street Address: 35 WILLIAM STREET GLENROY VIC 3046

DOCUMENT END

**This copied document to be made available
for the sole purpose of enabling
its consideration and review as
part of a planning process under the
Planning and Environment Act 1987.
The document must not be used for any
purpose which may breach any
copyright**



Imaged Document Cover Sheet

The document following this cover sheet is an imaged document supplied by LANDATA®, Secure Electronic Registries Victoria.

Document Type	Plan
Document Identification	LP044474
Number of Pages (excluding this cover sheet)	1
Document Assembled	01/12/2025 15:04

Copyright and disclaimer notice:

© State of Victoria. This publication is copyright. No part may be reproduced by any process except in accordance with the provisions of the Copyright Act 1968 (Cth) and for the purposes of Section 32 of the Sale of Land Act 1962 or pursuant to a written agreement. The information is only valid at the time and in the form obtained from the LANDATA® System. None of the State of Victoria, LANDATA®, Secure Electronic Registries Victoria Pty Ltd (ABN 86 627 986 396) as trustee for the Secure Electronic Registries Victoria Trust (ABN 83 206 746 897) accept responsibility for any subsequent release, publication or reproduction of the information.

The document is invalid if this cover sheet is removed or altered.

This copied document to be made available for the sole purpose of enabling its consideration and review as part of a planning process under the Planning and Environment Act 1987. The document must not be used for any purpose which may breach any copyright

**ADVERTISED
PLAN**

LP 44474

**ADVERTISED
PLAN**

PLAN OF SUBDIVISION OF

EDITION 1
PLAN MAY BE LODGED 2013 159

PART OF CROWN PORTION 1

PARISH OF WILL WILL ROOK

COUNTY OF BOURKE

SCALE: 20 FEET TO AN INCH

THE LAND COLOURED YELLOW AND BLUE
IS APPROPRIATED
OR SET APART FOR
EASEMENTS OF PARTY WALL

√.8050	F. 406
√.8153	F. 992
√.8173	F. 950

COLOUR CONVERSION
E-1 = BLUE
E-2 = YELLOW

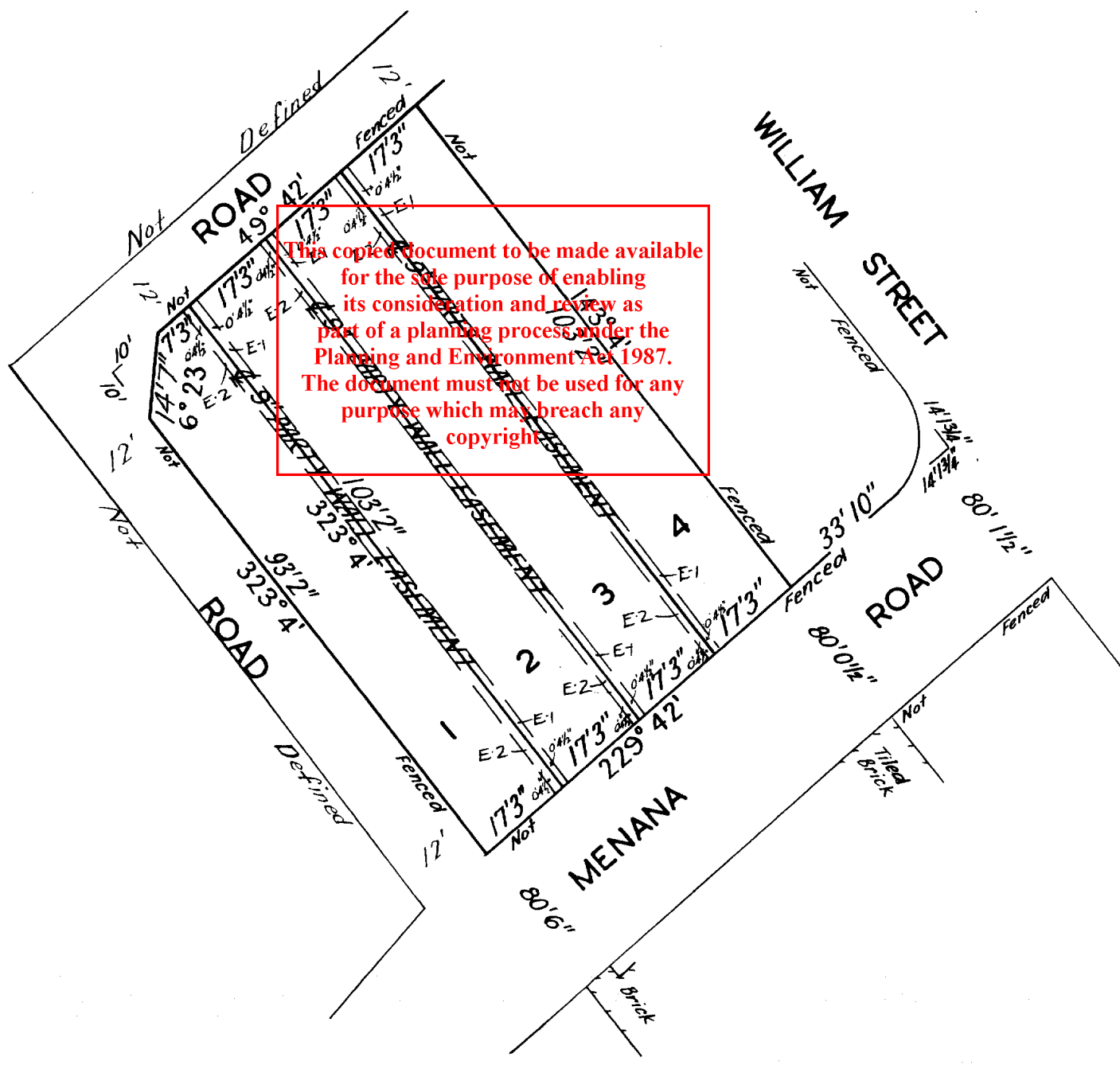
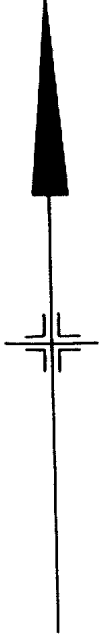

**REGISTER SEARCH STATEMENT (Title Search) Transfer of
Land Act 1958**

Page 1 of 1

VOLUME 08305 FOLIO 037

Security no : 124130372126V
Produced 01/12/2025 03:04 PM

LAND DESCRIPTION

Lot 3 on Plan of Subdivision 044474.
PARENT TITLE Volume 08305 Folio 035
Created by instrument A818103 16/09/1959

**ADVERTISED
PLAN**

REGISTERED PROPRIETOR

Estate Fee Simple
Sole Proprietor

THE ROMAN CATHOLIC TRUSTS CORPORATION FOR THE DIOCESE OF MELBOURNE of
CATHEDRAL PLACE EAST MELBOURNE
D162040 15/08/1968

ENCUMBRANCES, CAVEATS AND NOTICES

COVENANT 2627759

Any encumbrances created by Section 98 Transfer of Land Act 1958 or Section 24 Subdivision Act 1988 and any other encumbrances shown or entered on the plan or imaged folio set out under DIAGRAM LOCATION below.

DIAGRAM LOCATION

SEE LP044474 FOR FURTHER DETAILS AND BOUNDARIES

ACTIVITY IN THE LAST 125 DAYS

NIL

-----END OF REGISTER SEARCH STATEMENT-----

Additional information: (not part of the Register Search Statement)

Street Address: 35 WILLIAM STREET GLENROY VIC 3046

DOCUMENT END

**This copied document to be made available
for the sole purpose of enabling
its consideration and review as
part of a planning process under the
Planning and Environment Act 1987.
The document must not be used for any
purpose which may breach any
copyright**

Imaged Document Cover Sheet

The document following this cover sheet is an imaged document supplied by LANDATA®, Secure Electronic Registries Victoria.

Document Type	Plan
Document Identification	LP044474
Number of Pages (excluding this cover sheet)	1
Document Assembled	01/12/2025 15:04

Copyright and disclaimer notice:

© State of Victoria. This publication is copyright. No part may be reproduced by any process except in accordance with the provisions of the Copyright Act 1968 (Cth) and for the purposes of Section 32 of the Sale of Land Act 1962 or pursuant to a written agreement. The information is only valid at the time and in the form obtained from the LANDATA® System. None of the State of Victoria, LANDATA®, Secure Electronic Registries Victoria Pty Ltd (ABN 86 627 986 396) as trustee for the Secure Electronic Registries Victoria Trust (ABN 83 206 746 897) accept responsibility for any subsequent release, publication or reproduction of the information.

The document is invalid if this cover sheet is removed or altered.

This copied document to be made available for the sole purpose of enabling its consideration and review as part of a planning process under the Planning and Environment Act 1987. The document must not be used for any purpose which may breach any copyright

**ADVERTISED
PLAN**

LP 44474

**ADVERTISED
PLAN**

PLAN OF SUBDIVISION OF

EDITION 1
PLAN MAY BE LODGED 2013 159

PART OF CROWN PORTION 1

PARISH OF WILL WILL ROOK

COUNTY OF BOURKE

SCALE: 20 FEET TO AN INCH

THE LAND COLOURED YELLOW AND BLUE
IS APPROPRIATED
OR SET APART FOR
EASEMENTS OF PARTY WALL

√.8050	F. 406
√.8153	F. 992
√.8173	F. 950

COLOUR CONVERSION
E-1 = BLUE
E-2 = YELLOW

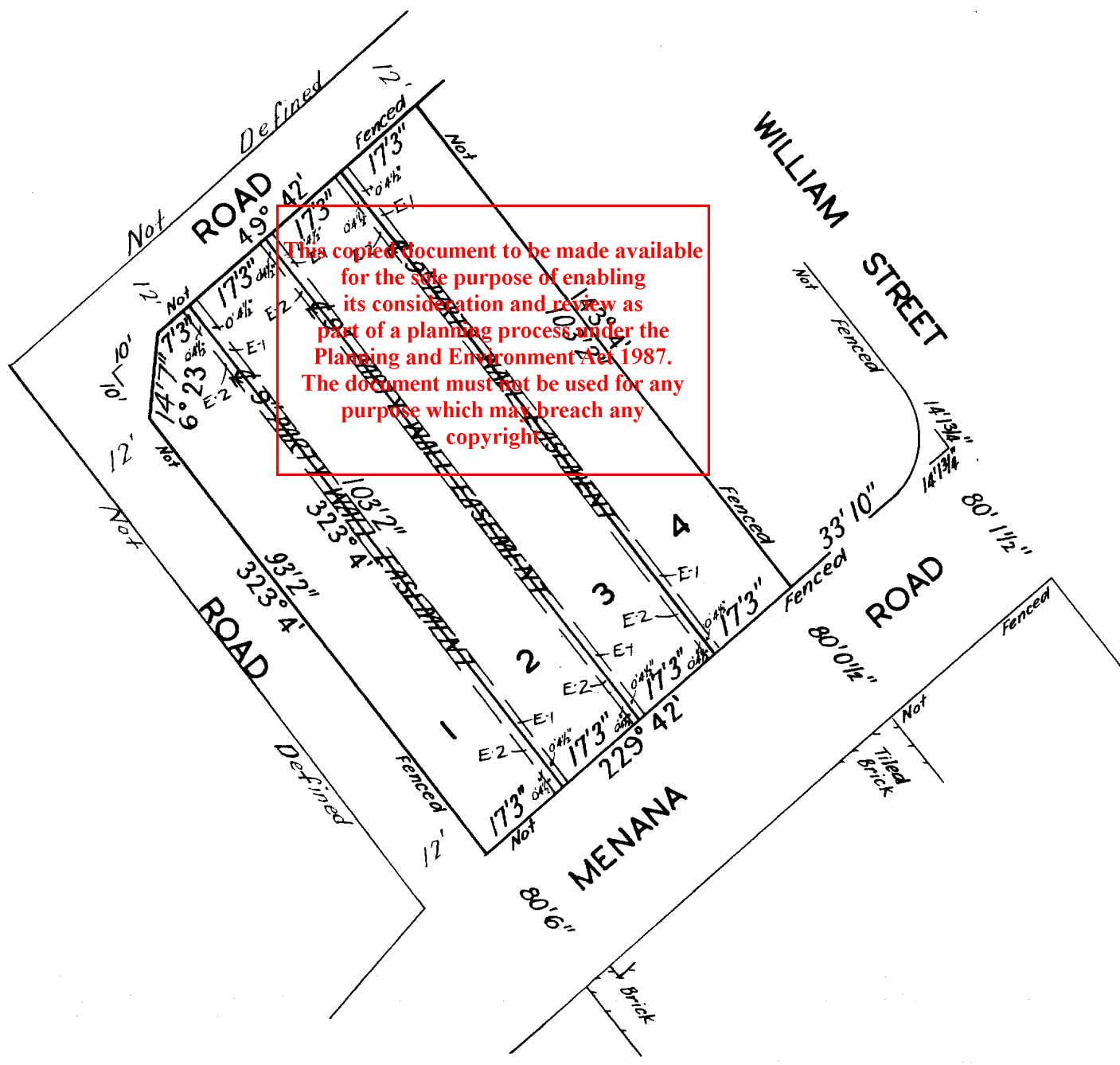
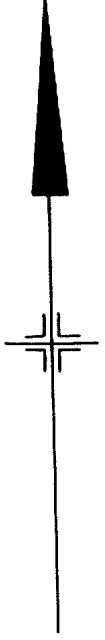

This copied document to be made available
for the sole purpose of enabling
its consideration and review as
part of a planning process under the
Planning and Environment Act 1987.
The document must not be used for any
purpose which may breach any
copyright.

**REGISTER SEARCH STATEMENT (Title Search) Transfer of
Land Act 1958**

Page 1 of 1

VOLUME 08756 FOLIO 166

Security no : 124130372137J
Produced 01/12/2025 03:04 PM

LAND DESCRIPTION

Lot 4 on Plan of Subdivision 044474.
PARENT TITLE Volume 08343 Folio 868
Created by instrument D162037 15/08/1968

**ADVERTISED
PLAN**

REGISTERED PROPRIETOR

Estate Fee Simple
Sole Proprietor

THE ROMAN CATHOLIC TRUSTS CORPORATION FOR THE DIOCESE OF MELBOURNE of
CATHEDRAL PLACE EAST MELBOURNE
D162037 15/08/1968

ENCUMBRANCES, CAVEATS AND NOTICES

COVENANT 2627759

Any encumbrances created by Section 98 Transfer of Land Act 1958 or Section 24 Subdivision Act 1988 and any other encumbrances shown or entered on the plan or imaged folio set out under DIAGRAM LOCATION below.

DIAGRAM LOCATION

SEE LP044474 FOR FURTHER DETAILS AND BOUNDARIES

ACTIVITY IN THE LAST 125 DAYS

NIL

-----END OF REGISTER SEARCH STATEMENT-----

Additional information: (not part of the Register Search Statement)

Street Address: 35 WILLIAM STREET GLENROY VIC 3046

DOCUMENT END

**This copied document to be made available
for the sole purpose of enabling
its consideration and review as
part of a planning process under the
Planning and Environment Act 1987.
The document must not be used for any
purpose which may breach any
copyright**



Imaged Document Cover Sheet

The document following this cover sheet is an imaged document supplied by LANDATA®, Secure Electronic Registries Victoria.

Document Type	Plan
Document Identification	LP044474
Number of Pages (excluding this cover sheet)	1
Document Assembled	01/12/2025 15:04

Copyright and disclaimer notice:

© State of Victoria. This publication is copyright. No part may be reproduced by any process except in accordance with the provisions of the Copyright Act 1968 (Cth) and for the purposes of Section 32 of the Sale of Land Act 1962 or pursuant to a written agreement. The information is only valid at the time and in the form obtained from the LANDATA® System. None of the State of Victoria, LANDATA®, Secure Electronic Registries Victoria Pty Ltd (ABN 86 627 986 396) as trustee for the Secure Electronic Registries Victoria Trust (ABN 83 206 746 897) accept responsibility for any subsequent release, publication or reproduction of the information.

The document is invalid if this cover sheet is removed or altered.

This copied document to be made available for the sole purpose of enabling its consideration and review as part of a planning process under the Planning and Environment Act 1987. The document must not be used for any purpose which may breach any copyright

**ADVERTISED
PLAN**

LP 44474

**ADVERTISED
PLAN**

PLAN OF SUBDIVISION OF

EDITION 1
PLAN MAY BE LODGED 2013 159

PART OF CROWN PORTION 1

PARISH OF WILL WILL ROOK

COUNTY OF BOURKE

SCALE: 20 FEET TO AN INCH

THE LAND COLOURED YELLOW AND BLUE
IS APPROPRIATED
OR SET APART FOR
EASEMENTS OF PARTY WALL

√.8050	F. 406
√.8153	F. 992
√.8173	F. 950

COLOUR CONVERSION
E-1 = BLUE
E-2 = YELLOW

