



# Imaged Document Cover Sheet

The document following this cover sheet is an imaged document supplied by LANDATA®, Secure Electronic Registries Victoria.

Document Type	<b>Plan</b>
Document Identification	<b>PS619541P</b>
Number of Pages (excluding this cover sheet)	<b>2</b>
Document Assembled	<b>13/12/2022 11:34</b>

**Copyright and disclaimer notice:**

© State of Victoria. This publication is copyright. No part may be reproduced by any process except in accordance with the provisions of the Copyright Act 1968 (Cth) and for the purposes of Section 32 of the Sale of Land Act 1962 or pursuant to a written agreement. The information is only valid at the time and in the form obtained from the LANDATA® System. None of the State of Victoria, LANDATA®, Secure Electronic Registries Victoria Pty Ltd (ABN 86 627 986 396) as trustee for the Secure Electronic Registries Victoria Trust (ABN 83 206 746 897) accept responsibility for any subsequent release, publication or reproduction of the information.

The document is invalid if this cover sheet is removed or altered.

**ADVERTISED  
PLAN**

# ADVERTISED PLAN

<b>PLAN OF SUBDIVISION</b>	Stage No. <hr style="width: 50px; margin: 0 auto;"/>	LR use only  EDITION 1	<b>PS 619541 P</b>	
<p><b>Location of Land</b>  <b>Parish:</b> WANGOOM  <b>Township:</b> _____  <b>Section:</b> _____  <b>Crown Allotment:</b> 120 (PART)  <b>Crown Portion:</b> _____</p> <p><b>Title References:</b>                  Vol 2644 Fol 685 &amp;                  Vol 10664 Fol 780</p> <p><b>Last Plan Reference:</b> TP 515573R &amp; PS 448253V  <b>Postal Address:</b> HOPETOUN ROAD                  WARRNAMBOOL 3280</p> <p><b>MGA Co-ordinates:</b> E 628 860                  (Of approx. centre of plan) N 5 752 070 Zone 54</p>	<p style="text-align: center;"><b>Council Certification and Endorsement</b></p> <p><b>Council Name:</b> WARRNAMBOOL CITY COUNCIL     <b>Ref:</b> S 47 / 08</p> <p>1. This plan is certified under section 6 of the Subdivision Act 1988.  <del>2. This plan is certified under section 11 (7) of the Subdivision Act 1988.</del>  <del>_____ Date of original certification under section 6 _____</del>  <del>3. This is a statement of compliance issued under section 21 of the _____</del>  <del>_____ Subdivision Act 1988.</del></p> <p><b>Open Space</b></p> <p>(i) A requirement for public open space under section 18 Subdivision Act 1988  <del>has/ has not been made.</del>                  (ii) <del>The requirement has been satisfied.</del>                  (iii) <del>The requirement is to be satisfied in Stage _____</del></p> <p>Council Delegate  <del>Council seal</del>                   Date                  18/6/2010</p>			
<b>Vesting of Roads or Reserves</b>				
Identifier	Council/Body/Person			
Nil	Nil			
<b>Notations</b>				
Depth Limitation: Does not apply	Staging     This is not a staged subdivision Planning Permit No.     P 2008 - 284			
<p>Survey:-     This plan is based on partial survey. Lot 1 is the subject of this survey.                  Lot 2 has been deduced from titles. See Abstract of Field Records for detail.</p> <p>To be completed where applicable.</p> <p>This survey has been connected to permanent marks no(s). WANGOOM 165, 376, 567                  In proclaimed Survey Area no.     23 WARRNAMBOOL</p>				
<b>Easement Information</b>				
<b>Legend:</b>		LR use only		
E - Encumbering Easement or Condition in Crown Grant in Nature of an Easement A - Appurtenant Easement		Statement of Compliance / Exemption Statement		
		Received <input checked="" type="checkbox"/>		
		Date 23 / 12 / 2010		
Subject Land	Purpose	Width (Metres)	Origin	Lard Benefited/In Favour Of
E-1	SEWERAGE	2	C/E S861928H	CITY OF WARRNAMBOOL WANNON REGION WATER CORPORATION SOUTH WEST WATER AUTHORITY CITY OF WARRNAMBOOL WANNON REGION WATER CORPORATION WANNON REGION WATER CORPORATION LOT 1 THIS PLAN POWERCOR AUSTRALIA LTD
E-1	SEWERAGE	2	THIS PLAN	
E-2	SEWERAGE	2	PS 448253V	
E-3	SEWERAGE	2	C/E S861929E	
E-4	SEWERAGE	SEE DIAG.	THIS PLAN	
E-5	SEWERAGE	2	THIS PLAN	
E-6	POWERLINE	5	THIS PLAN: SECTION 88 ELECTRICITY INDUSTRY ACT 2000	
<b>ALAN H. SIMPSON</b>		LICENCED SURVEYOR (PRINT)     ALAN HALSTEAD SIMPSON		_____ DATE 18/6/2010 COUNCIL DELEGATE SIGNATURE
● LAND SURVEYOR ● A.C.N. 062 912 510 P.O.BOX 421, WARRNAMBOOL 3280 PHONE (03) 55611846 FAX (03) 55621775		SIGNATURE      DATE 05 / 05 / 2010 REF 1737     1737_V2_PS1.DWG     VERSION 2 1737.SEE		Sheet 1 of 2 sheets Original sheet size <b>A3</b>

# ADVERTISED PLAN

## PLAN OF SUBDIVISION

Stage No.

Plan Number

**PS 619541P**

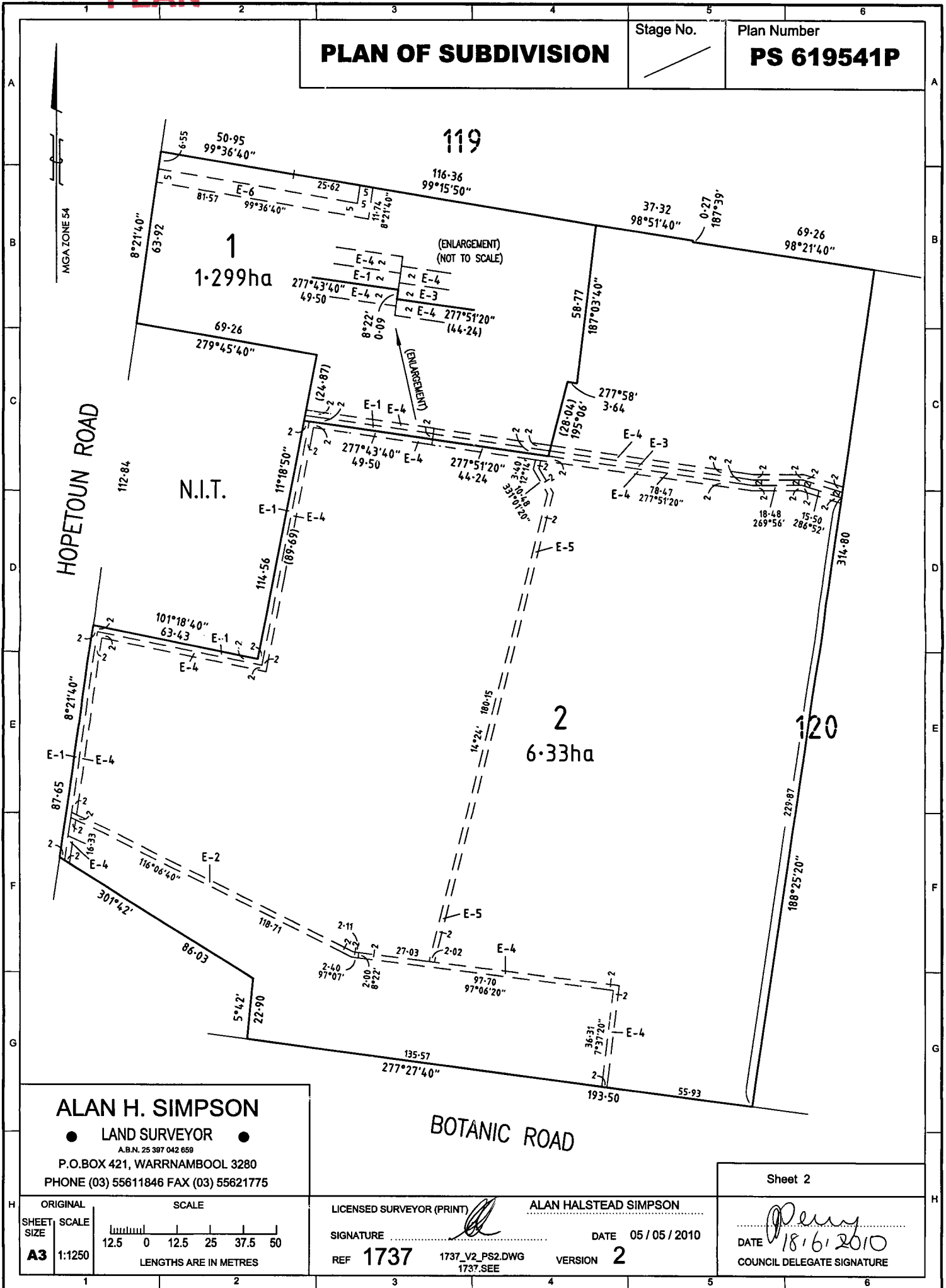

**ALAN H. SIMPSON**

● LAND SURVEYOR ●

A.B.N. 25 397 042 659

P.O. BOX 421, WARRNAMBOOL 3280

PHONE (03) 55611846 FAX (03) 55621775

BOTANIC ROAD

Sheet 2

ORIGINAL	SCALE
SHEET SIZE	SCALE
<b>A3</b>	1:1250
LENGTHS ARE IN METRES	

LICENSED SURVEYOR (PRINT)

ALAN HALSTEAD SIMPSON

SIGNATURE

DATE 05/05/2010

REF 1737

1737\_V2\_PS2.DWG  
1737.SEE

VERSION 2

DATE *18/6/2010*  
COUNCIL DELEGATE SIGNATURE