

Copyright State of Victoria. No part of this publication may be reproduced except as permitted by the Copyright Act 1968 (Cth), to comply with a statutory requirement or pursuant to a written agreement. The information is only valid at the time and in the form obtained from the LANDATA REGD TM System. None of the State of Victoria, its agents or contractors, accepts responsibility for any subsequent publication or reproduction of the information.

The Victorian Government acknowledges the Traditional Owners of Victoria and pays respects to their ongoing connection to their Country, History and Culture. The Victorian Government extends this respect to their Elders, past, present and emerging.

REGISTER SEARCH STATEMENT (Title Search) Transfer of Land Act 1958

VOLUME 08144 FOLIO 803

Security no : 124111376440F
Produced 18/12/2023 02:14 PM

LAND DESCRIPTION

Lot 6 on Plan of Subdivision 034419.
PARENT TITLE Volume 08144 Folio 766
Created by instrument A096770 10/01/1956

REGISTERED PROPRIETOR

Estate Fee Simple
Sole Proprietor

THE ROMAN CATHOLIC TRUSTS CORPORATION FOR THE DIOCESE OF MELBOURNE of 383
ALBERT STREET EAST MELBOURNE VIC 3002
H915168 21/03/1980

ENCUMBRANCES, CAVEATS AND NOTICES

Any encumbrances created by Section 98 Transfer of Land Act 1958 or Section 24 Subdivision Act 1988 and any other encumbrances shown or entered on the plan or imaged folio set out under DIAGRAM LOCATION below.

DIAGRAM LOCATION

SEE TP061305V FOR FURTHER DETAILS AND BOUNDARIES

ACTIVITY IN THE LAST 125 DAYS

NIL

-----END OF REGISTER SEARCH STATEMENT-----

Additional information: (not part of the Register Search Statement)

Street Address: 824 CENTRE ROAD BENTLEIGH EAST VIC 3165

DOCUMENT END

Delivered from the LANDATA® System by GlobalX Pty Ltd

This copied document to be made available for the sole purpose of enabling its consideration and review as part of a planning process under the Planning and Environment Act 1987. The document must not be used for any purpose which may breach any copyright

**ADVERTISED
PLAN**



Department of Environment, Land, Water & Planning

Electronic Instrument Statement

Copyright State of Victoria. No part of this publication may be reproduced except as permitted by the Copyright Act 1968 (Cth), to comply with a statutory requirement or pursuant to a written agreement. The information is only valid at the time and in the form obtained from the LANDATA REGD TM System. None of the State of Victoria, its agents or contractors, accepts responsibility for any subsequent publication or reproduction of the information.

The Victorian Government acknowledges the Traditional Owners of Victoria and pays respects to their ongoing connection to their Country, History and Culture. The Victorian Government extends this respect to their Elders, past, present and emerging.

Produced: 18/12/2023 02:15:04 PM

Dealing Number: AG663543L

Rectification Date: 30/07/2009
Rectification Category: Propr: Name/Address
Status: Registered

RECTIFICATION

Raised By: REGISTRAR OF TITLES
DX 250639 MELBOURNE

| Folio Affected | CofT Supplied | Controlling Party |
|----------------|---------------|-------------------|
|----------------|---------------|-------------------|

| | | |
|----------|----|--|
| 3808/524 | No | |
| 5020/971 | No | |
| 6464/763 | No | |
| 6860/955 | No | |
| 7933/042 | No | |
| 8144/803 | No | |
| 8447/785 | No | |
| 8674/084 | No | |
| 9065/126 | No | |
| 9788/372 | No | |

**ADVERTISED
PLAN**

Details of Rectification

THE ROMAN CATHOLIC TRUSTS' CORPORATION FOR THE DIOCESE OF MELBOURNE
REMOVE '.

Statement End.

This copied document to be made available for the sole purpose of enabling its consideration and review as part of a planning process under the Planning and Environment Act 1987. The document must not be used for any purpose which may breach any copyright

1596

#102

H915168

H915168

REGD

***102.00 G RT T

2-21 185998 MAR21-80
W. J. MORLEY

VICTORIA

TRANSFER OF LAND

I, HEATHER ABERDEEN FISHER of 824 Centre Road East Bentleigh Chemist being registered as the proprietor of an estate in fee simple in the land hereinafter described subject to the encumbrances notified hereunder in consideration of the sum of FORTY-THREE THOUSAND DOLLARS paid to me by THE ROMAN CATHOLIC TRUSTS' CORPORATION FOR THE DIOCESE OF MELBOURNE of 383 Albert Street East Melbourne HEREBY TRANSFER to the said The Roman Catholic Trusts' Corporation for the Diocese of Melbourne all my estate and interest in ALL THAT piece of land being the whole of the land described in Certificate of Title Volume 8144 Folio 803.

NOT CHARGEABLE WITH STAMP DUTY 28 FEB 1980 R. H. PHIBBS Comptroller of Stamps VICTORIA

DATED the 11th day of December 1979.

SIGNED by the said HEATHER ABERDEEN FISHER in Victoria in the presence of:

Heather A. Fisher

Mr. Webb

THE COMMON SEAL of THE ROMAN CATHOLIC TRUSTS' CORPORATION FOR THE DIOCESE OF MELBOURNE was hereunto affixed by its order in the presence of:

ADVERTISED PLAN



T. Little
R.J. Deal
A. Jones
Corporation Trustees

This copied document to be made available for the sole purpose of enabling its consideration and review as part of a planning process under the Planning and Environment Act 1987. The document must not be used for any purpose which may breach any copyright

ENCUMBRANCES REFERRED TO

The encumbrances noted at the foot of the said Certificate of Title.

MADE IN AUSTRALIA
A memorandum of the within instrument has been entered in the Register Book.



HAN 11/19/80

H. A. FISHER

to

THE ROMAN CATHOLIC TRUSTS'
CORPORATION FOR THE DIOCESE
OF MELBOURNE

TRANSFER OF LAND

W. J. MORLEY,
Solicitor,
749 Centre Road,
EAST BENTLEIGH, 3165

ADVERTISED PLAN

This copied document to be made available for the sole purpose of enabling its consideration and review as part of a planning process under the Planning and Environment Act 1987. The document must not be used for any purpose which may breach any copyright

| | | | |
|------------|--|-----------|------------|
| TITLE PLAN | | EDITION 1 | TP 061305V |
|------------|--|-----------|------------|

| | |
|---|--|
| <p>Location of Land</p> <p>Parish: MOORABBIN Township: Section: Crown Allotment: Crown Portion: 58(PT)</p> <p>Last Plan Reference: LP 34419 Derived From: VOL 8144 FOL 803 Depth Limitation: NIL</p> | <p style="text-align: center;">Notations</p> <p>ANY REFERENCE TO MAP IN THE TEXT MEANS THE DIAGRAM SHOWN ON THIS TITLE PLAN</p> |
|---|--|

| | |
|---|---|
| <p style="text-align: center;">Description of Land / Easement Information</p> <div style="background-color: #ffffcc; padding: 5px; border: 1px solid black;"> <p style="text-align: center;">ENCUMBRANCES REFERRED TO</p> <p>As to the land coloured blue -----</p> <p><u>ANY EASEMENTS</u> affecting the same - - - -</p> </div> | <p>THIS PLAN HAS BEEN PREPARED FOR THE LAND REGISTRY, LAND VICTORIA, FOR TITLE DIAGRAM PURPOSES AS PART OF THE LAND TITLES AUTOMATION PROJECT</p> <p>COMPILED: 21/05/2002 VERIFIED: BP</p> |
|---|---|

This copied document to be made available for the sole purpose of enabling its consideration and review as part of a planning process under the Planning and Environment Act 1987. The document must not be used for any purpose which may breach any copyright

COLOUR CODE
BL=BLUE

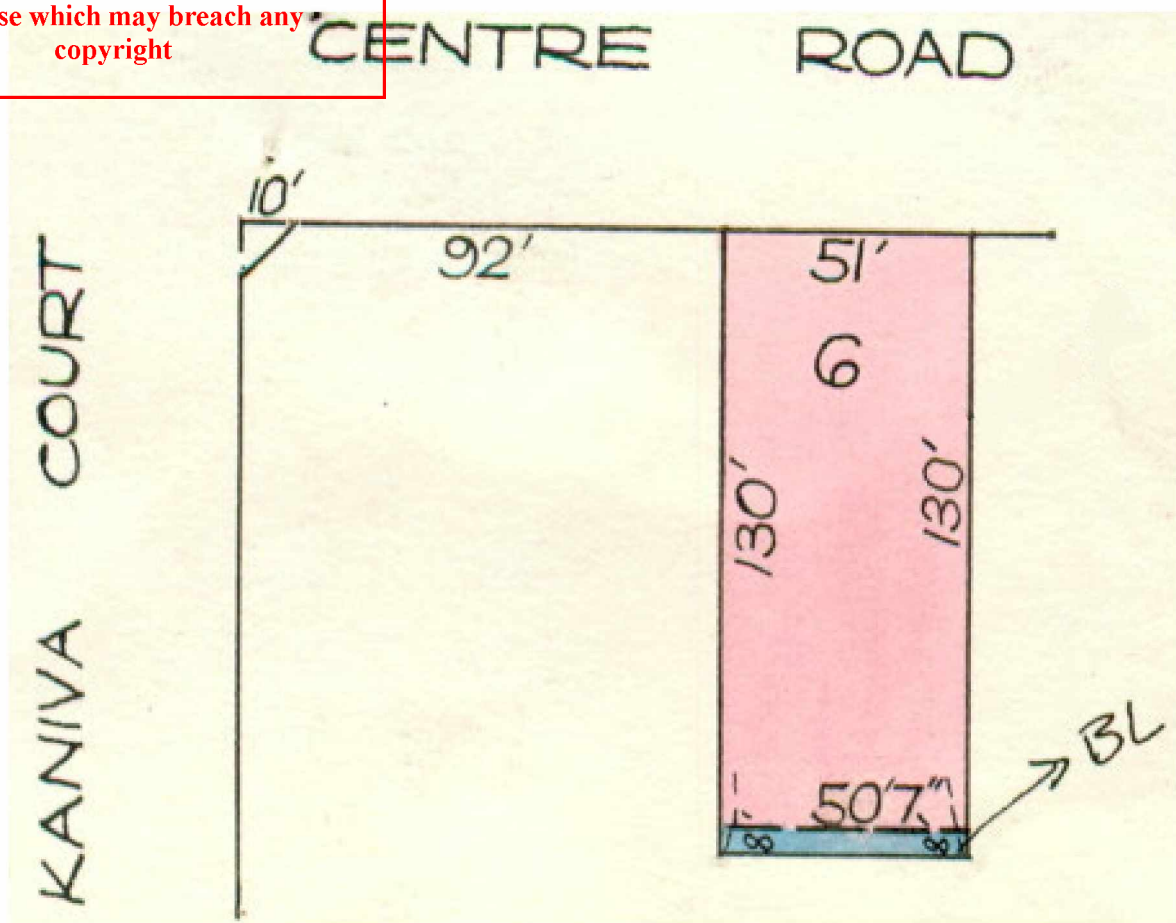

ADVERTISED
PLAN