

Copyright State of Victoria. No part of this publication may be reproduced except as permitted by the Copyright Act 1968 (Cth), to comply with a statutory requirement or pursuant to a written agreement. The information is only valid at the time and in the form obtained from the LANDATA REGD TM System. None of the State of Victoria, its agents or contractors, accepts responsibility for any subsequent publication or reproduction of the information.

The Victorian Government acknowledges the Traditional Owners of Victoria and pays respects to their ongoing connection to their Country, History and Culture. The Victorian Government extends this respect to their Elders, past, present and emerging.

REGISTER SEARCH STATEMENT (Title Search) Transfer of Land Act 1958

VOLUME 01117 FOLIO 342

Security no : 124130452960H  
Produced 03/12/2025 03:00 PM

## ADVERTISED PLAN

CROWN GRANT

LAND DESCRIPTION

Crown Allotment 16A Section 7 Parish of Turrumberry North.

REGISTERED PROPRIETOR

Estate Fee Simple

Sole Proprietor

JOHN MCKINNON of TURRUMBERRY

ENCUMBRANCES, CAVEATS AND NOTICES

MORTGAGE 0033725 18/09/1879

RICHARD WILLIAM PENNEFATHER

**This copied document to be made available  
for the sole purpose of enabling  
its consideration and review as  
part of a planning process under the  
Planning and Environment Act 1987.  
The document must not be used for any  
purpose which may breach any  
copyright**

Any crown grant reservations exceptions conditions limitations and powers noted on the plan or imaged folio set out under DIAGRAM LOCATION below. For details of any other encumbrances see the plan or imaged folio set out under DIAGRAM LOCATION below.

DIAGRAM LOCATION

SEE TP556180F FOR FURTHER DETAILS AND BOUNDARIES

ACTIVITY IN THE LAST 125 DAYS

NIL

-----END OF REGISTER SEARCH STATEMENT-----

Additional information: (not part of the Register Search Statement)

Street Address: 2952 MURRAY VALLEY HIGHWAY TORRUMBARRY VIC 3562

DOCUMENT END

Delivered from the LANDATA System by Dye & Durham Terrain Pty Ltd



# Imaged Document Cover Sheet

The document following this cover sheet is an imaged document supplied by LANDATA®, Secure Electronic Registries Victoria.

Document Type	<b>Plan</b>
Document Identification	<b>TP556180F</b>
Number of Pages (excluding this cover sheet)	<b>2</b>
Document Assembled	<b>03/12/2025 16:27</b>

**Copyright and disclaimer notice:**

© State of Victoria. This publication is copyright. No part may be reproduced by any process except in accordance with the provisions of the Copyright Act 1968 (Cth) and for the purposes of Section 32 of the Sale of Land Act 1962 or pursuant to a written agreement. The information is only valid at the time and in the form obtained from the LANDATA® System. None of the State of Victoria, LANDATA®, Secure Electronic Registries Victoria Pty Ltd (ABN 86 627 986 396) as trustee for the Secure Electronic Registries Victoria Trust (ABN 83 206 746 897) accept responsibility for any subsequent release, publication or reproduction of the information.

The document is invalid if this cover sheet is removed or altered.

TITLE PLAN		EDITION 1	TP 556180F
------------	--	-----------	------------

<p><b>Location of Land</b></p> <p>Parish: TURREMBERRY NORTH</p> <p>Township:</p> <p>Section: 7</p> <p>Crown Allotment: 16A</p> <p>Crown Portion:</p> <p>Last Plan Reference:</p> <p>Derived From: VOL 1117 FOL 342</p> <p>Depth Limitation: NIL</p>	<p><b>Notations</b></p> <p>SUBJECT TO THE RESERVATIONS EXCEPTIONS CONDITIONS AND POWERS CONTAINED IN CROWN GRANT VOL. 1117 FOL. 342 AND NOTED ON SHEET 2 OF THIS PLAN</p> <p>ANY REFERENCE TO MAP IN THE TEXT MEANS THE DIAGRAM SHOWN ON THIS TITLE PLAN</p>
---	--

<p><b>Description of Land / Easement Information</b></p>	<p>THIS PLAN HAS BEEN PREPARED FOR THE LAND REGISTRY, LAND VICTORIA, FOR TITLE DIAGRAM PURPOSES AS PART OF THE LAND TITLES AUTOMATION PROJECT</p> <p>COMPILED: 05/07/2000</p> <p>VERIFIED: MP</p>
--	---

**COLOUR CODE**  
Y=YELLOW

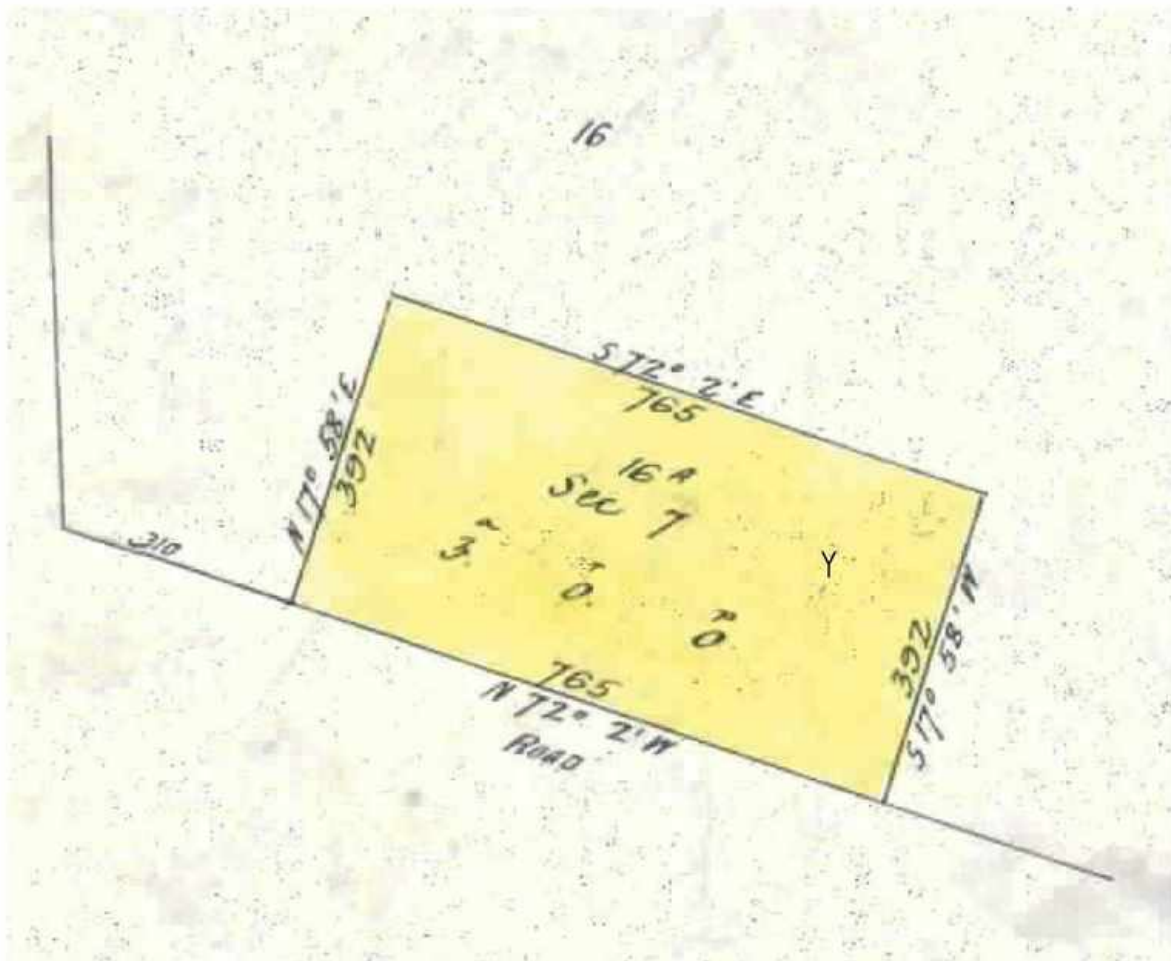

<p>LENGTHS ARE IN LINKS</p>	<p>Metres = 0.3048 x Feet</p> <p>Metres = 0.201168 x Links</p>		<p>Sheet 1 of 2 sheets</p>
-----------------------------	--	--	----------------------------

TITLE PLAN

TP 556180F

LAND DESCRIPTION INCLUDING RESERVATIONS EXCEPTIONS  
CONDITIONS AND POWERS SHOWN ON THE CROWN GRANT

All THAT PIECE OF LAND in the said Colony containing *three acres more or less being allotment sixteen A of Section Seven in the Parish of Turrumberry North County of Gunbouver*

delimited with the measurements and abuttals thereof in the map drawn in the margin of these presents and therein colored yellow

EXCEPTING however unto us our heirs and successors all gold and auriferous earth or stone and all mines containing gold within the boundaries of the said land AND ALSO reserving to us our heirs and successors free liberty and authority for us our heirs and successors and our and their agents and servants at any time or times hereafter to enter upon the said land and to search and mine therein for gold and to extract and remove therefrom any gold and any auriferous earth or stone and for the purposes aforesaid to sink shafts erect machinery carry on any works and do any other things which may be necessary or usual in mining PROVIDED ALWAYS that it shall be lawful for us our heirs and successors at any time on paying full compensation to the said GRANTEE

his heirs executors administrators or assigns for the full value other than auriferous of the said piece of land or so much thereof as may be resumed as hereinafter mentioned and of the improvements upon the said piece of land or the part so resumed such value in case of disagreement to be ascertained by arbitration to resume the said piece of land or any part thereof for mining purposes

AND THAT the terms conditions and events upon which such land may be resumed and the manner in which such arbitration may be conducted may be determined by regulations in such manner as the Governor in Council may from time to time direct or if at any time no such regulations shall be in force then by the regulations concerning the resumption of land for mining purposes in force at the date of this Grant unless Parliament shall otherwise determine

LENGTHS ARE IN  
LINKS

Metres = 0.3048 x Feet

Metres = 0.201168 x Links

Sheet 2 of 2 sheets

Copyright State of Victoria. No part of this publication may be reproduced except as permitted by the Copyright Act 1968 (Cth), to comply with a statutory requirement or pursuant to a written agreement. The information is only valid at the time and in the form obtained from the LANDATA REGD TM System. None of the State of Victoria, its agents or contractors, accepts responsibility for any subsequent publication or reproduction of the information.

The Victorian Government acknowledges the Traditional Owners of Victoria and pays respects to their ongoing connection to their Country, History and Culture. The Victorian Government extends this respect to their Elders, past, present and emerging.

REGISTER SEARCH STATEMENT (Title Search) Transfer of Land Act 1958

VOLUME 08056 FOLIO 004

Security no : 124130452956M  
Produced 03/12/2025 03:00 PM

LAND DESCRIPTION

Crown Allotment 12 Section 7, Crown Allotment 12A Section 7, Crown Allotment 16 Section 7, Crown Allotment 18 Section 7 and Crown Allotment 19 Section 7 Parish of Turrumberry North.

PARENT TITLES :

Volume 05949 Folio 676      Volume 06553 Folio 445  
Created by instrument 2664260 06/08/1954

REGISTERED PROPRIETOR

Estate Fee Simple  
Sole Proprietor

MCLEAN FARMS AUSTRALIA PTY LTD of 385 FELTON ROAD PITTSWORTH QLD 4356  
AZ324062G 27/06/2025

ENCUMBRANCES, CAVEATS AND NOTICES

MORTGAGE AZ324064C 27/06/2025  
NATIONAL AUSTRALIA BANK LTD

For details of any other encumbrances see the plan or imaged folio set out under DIAGRAM LOCATION below.

AGREEMENT Section 173 Planning and Environment Act 1987  
AF231794D 26/07/2007

DIAGRAM LOCATION

SEE TP805559T FOR FURTHER DETAILS AND BOUNDARIES

ACTIVITY IN THE LAST 125 DAYS

NUMBER		STATUS	DATE
AZ324060L (E)	DISCHARGE OF MORTGAGE	Registered	13/08/2025
AZ324062G (E)	TRANSFER	Registered	13/08/2025
AZ324064C (E)	MORTGAGE	Registered	13/08/2025
AZ506528W (E)	TRANSFER CONTROL OF ECT	Completed	20/08/2025

-----END OF REGISTER SEARCH STATEMENT-----

Additional information: (not part of the Register Search Statement)

See MI308568T for WATER FRONTAGE LICENCE details

ADMINISTRATIVE NOTICES

NIL

eCT Control 16089P NATIONAL AUSTRALIA BANK LTD  
Effective from 20/08/2025

DOCUMENT END

Delivered from the LANDATA System by Dye & Durham Terrain Pty Ltd



# Imaged Document Cover Sheet

The document following this cover sheet is an imaged document supplied by LANDATA®, Secure Electronic Registries Victoria.

Document Type	<b>Plan</b>
Document Identification	<b>TP805559T</b>
Number of Pages (excluding this cover sheet)	<b>1</b>
Document Assembled	<b>03/12/2025 16:16</b>

**Copyright and disclaimer notice:**

© State of Victoria. This publication is copyright. No part may be reproduced by any process except in accordance with the provisions of the Copyright Act 1968 (Cth) and for the purposes of Section 32 of the Sale of Land Act 1962 or pursuant to a written agreement. The information is only valid at the time and in the form obtained from the LANDATA® System. None of the State of Victoria, LANDATA®, Secure Electronic Registries Victoria Pty Ltd (ABN 86 627 986 396) as trustee for the Secure Electronic Registries Victoria Trust (ABN 83 206 746 897) accept responsibility for any subsequent release, publication or reproduction of the information.

The document is invalid if this cover sheet is removed or altered.





**AF231794D**

26/07/2007 \$97 173



LODGED BY: Cosgriff Orchard Legal  
PHONE: (03) 5480 6344  
ADDRESS: 250 Anstruther Street Echuca 3564  
CODE: 3287H

**APPLICATION FOR RECORDING OF AN AGREEMENT  
SECTION 181(1) PLANNING & ENVIRONMENT ACT 1987.**

Application by Council for the making of a recording of an agreement Section 181(1) Planning and Environment Act 1987.

The Authority or Council having made an agreement requires a recording to be made in the Register for the land.

Land: Volume 8056 Folio 004

Authority or Council: Shire of Campaspe of Shire Offices, Heygarth Street, Echuca 3564

Section and Act under which agreement made: Section 173 Planning and Environment Act 1987.

A copy of the agreement is attached to this application.

Date: 19 / 06 / 2007.

Signed:   
.....  
KEITH L. BAILLIE  
Chief Executive Officer  
Shire of Campaspe  
Cnr Hare & Heygarth Streets  
ECHUCA 3564

**AF231794D**

26/07/2007 \$97 173

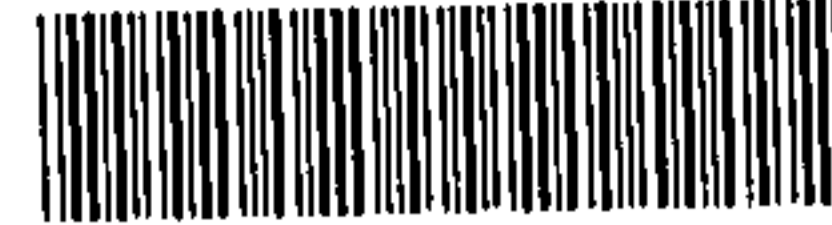

This AGREEMENT is made on the 19 day of June 2007

**BETWEEN**

**SHIRE OF CAMPASPE** of Heygarth Street, Echuca in the State of Victoria ("The Council")

and

**THE SECRETARY TO THE DEPARTMENT OF SUSTAINABILITY AND ENVIRONMENT** of 8 Nicholson Street, East Melbourne in the State of Victoria, ("The Secretary")

and

**WARWICK FARM (AUSTRALIA) PTY L TD** of 288 Headworks Road Torrumbarry in the State of Victoria ("The Owner")

#### **RECITALS**

- A. The Council is the responsible authority pursuant to the Planning and Environment Act 1987 ("the Act") administering the Shire of Campaspe Planning Scheme ("The Scheme")
- B. The Owner is the registered proprietor of land described in Certificate of Title Volume 8056 Folio 004 and being Crown Allotments 12, 12A, 14, 16, 18 and 19 Section 7 Parish of Torrumbarry North and the address of which is 2952 Murray Valley Highway Torrumbarry 3562 ("The Land")
- C. The Secretary is, within the meaning of sub-section 173(2) of the Act, a joint party with the Council to this Agreement.
- D. In accordance with the Planning Permit issued by the Council on 22nd November 1999, the Owner has agreed to enter into this Agreement with the Council and the Secretary pursuant to Section 173 of the Act in respect of specified conditions relating to the ongoing use by the Owner of part of the land and it is further agreed that this Agreement may be registered on the Title to the land.

#### **NOW IT IS AGREED**

#### **COMMENCEMENT OF AGREEMENT**

- 1 This Agreement shall come into effect immediately it is executed by the parties

#### **TERMS OF AGREEMENT**

- 2 The Owner covenants with the Council in respect of the cross hatched areas of the land on the survey plan dated 2nd September 2002

**AF231794D**

26/07/2007 \$97 173

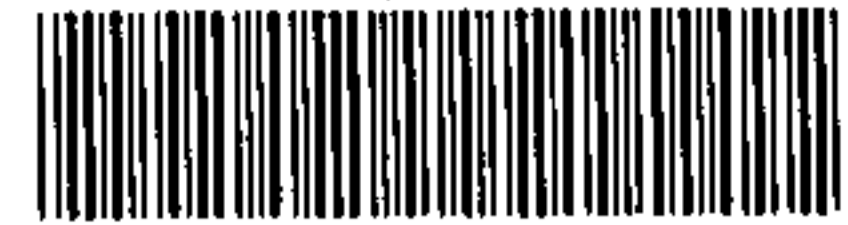

prepared by Rich River Irrigation Developments Pty Ltd attached hereto as the first schedule ("the cross hatched areas of the land")

- 2.1 The owner will not harvest timber or make any commercial use of dead standing or living trees, shrubs or ground cover plants on the cross hatched areas of the land without the prior written permission of the Council and the Secretary.
- 2.2 The Owner must consult the Council regarding any activity such as fire break construction, grazing or burning off or other land management activity on the land of the land owner which may impact on the cross hatched of the land.
- 2.3 The owner must fence off at his own expense the cross hatched areas of the land to prohibit grazing by stock on them.

**3 COVENANTS AND REGISTRATION**

The Owner covenants with the Council that the obligations and responsibilities which it has assumed under this Agreement are made on its own behalf and on behalf of the occupiers for the time being of the cross hatched areas of the land and will take effect as separate and severable covenants which will be annexed to and run with the cross hatched areas of the land pursuant to section 182 of the Act or otherwise at law or in equity to bind the Owner and each successor or assignee or transferee of the Owner and the registered proprietor or proprietors for the time being of all and every part of the cross hatched areas of the land.

4. The Owner acknowledges that following the execution of this Agreement the Council will forthwith make application pursuant to Section 181 of the Act to register this Agreement under the Transfer of Land Act 1958 against the Title to the cross hatched areas of the land with the intention that the covenants contained in this Agreement will run with the cross hatched areas of the land and that the Council and the Secretary will have powers to enforce those covenants against any person subsequently deriving Title to the cross hatched areas of the land from the Owner.
5. The Owner acknowledges and covenants with the Council and with the Secretary that:
  - (a) with the exception of number 5 of the cross hatched areas of the land on the survey plan it is registered as the proprietor and beneficial owner of the cross hatched areas of the land;
  - (b) there are no mortgages, liens, charges or other encumbrances or leases or any rights inherent in any person other than the Owner affecting the cross hatched areas of the land other than those disclosed by the usual searches or notified to the Council; and
  - (c) the Owner must not sell, transfer, dispose of, assign, mortgage or part with possession of the cross hatched areas of the land or any part thereof, without first disclosing to any intended purchaser, transferee, assignee or mortgagee the existence and nature of this agreement.

**AF231794D**

26/07/2007 \$97 173

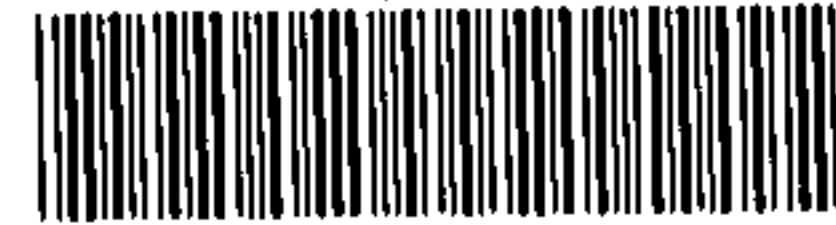

**DEFAULT**

- 6. In the event that the Owner defaults or fails to perform any of its obligations under this Agreement and such default or failure is not remedied by the Owner within fourteen days after receipt of notice from the Council requiring such default to be remedied, then the Council may without further notice and without prejudice to any other remedies it or they may have, enter onto the cross hatched areas of the land and rectify such default or failure and in those circumstances the reasonable costs incurred by Council shall be payable by the Owner to Council on demand, and if not paid shall be capable of recovery by Council in any Court of competent jurisdiction as a civil debt. A certificate signed by the Chief Executive Officer of the Council shall be prima facie proof of the cost of remedying such default or failure.
- 7. It is acknowledged by the Owner that nothing in clause 6 hereof imposes any obligations or responsibility on the Council or the Secretary to maintain the fences referred to in sub clause 2.5 hereof in any condition whatsoever.

**INDEMNITY**

- 8. The owner indemnifies the Council in respect of any loss, damages, expenses and for any costs incurred by the Council resulting whether directly or indirectly from any breach by the Owner of its obligations under this Agreement.

**LEGAL COSTS AND EXPENSES**

- 9. Each party shall bear its own legal costs and disbursements in relation to the preparation, execution and registration of this Agreement and the Council shall pay the relevant registration fee.

DATED the 19 day of June 2007.

The Common Seal of **Shire of Campaspe** was hereunto affixed on the day of 2007 in the presence of

*RS*  
..... COUNCILLOR

*Robert Hill*  
..... COUNCILLOR

*Vern Bauer*  
..... CHIEF EXECUTIVE OFFICER

By Authority the Seal of the Secretary to the Department of Sustainability and Environment was affixed to this document



on 7 March 2007

by [Signature] Secretary

AF231794D

26/07/2007 \$97 173



The Common Seal of WARWICK FARM (AUSTRALIA) PTY LTD was herewith affixed in accordance with its Articles of Association and in the presence of

Executed by Warwick Farms (Aust) Pty LTD in accordance with Article 127 of the Corporations Act 2001

JAMES AUSTIN WILKINS Director

288 Headworks Rd TORRENTBARRI VIC 3562

DONNA MAREE WILKINS Secretary

[Signature] 288 Headworks Rd TORRENTBARRI VIC 3562

AF231794D

26/07/2007 \$97

173

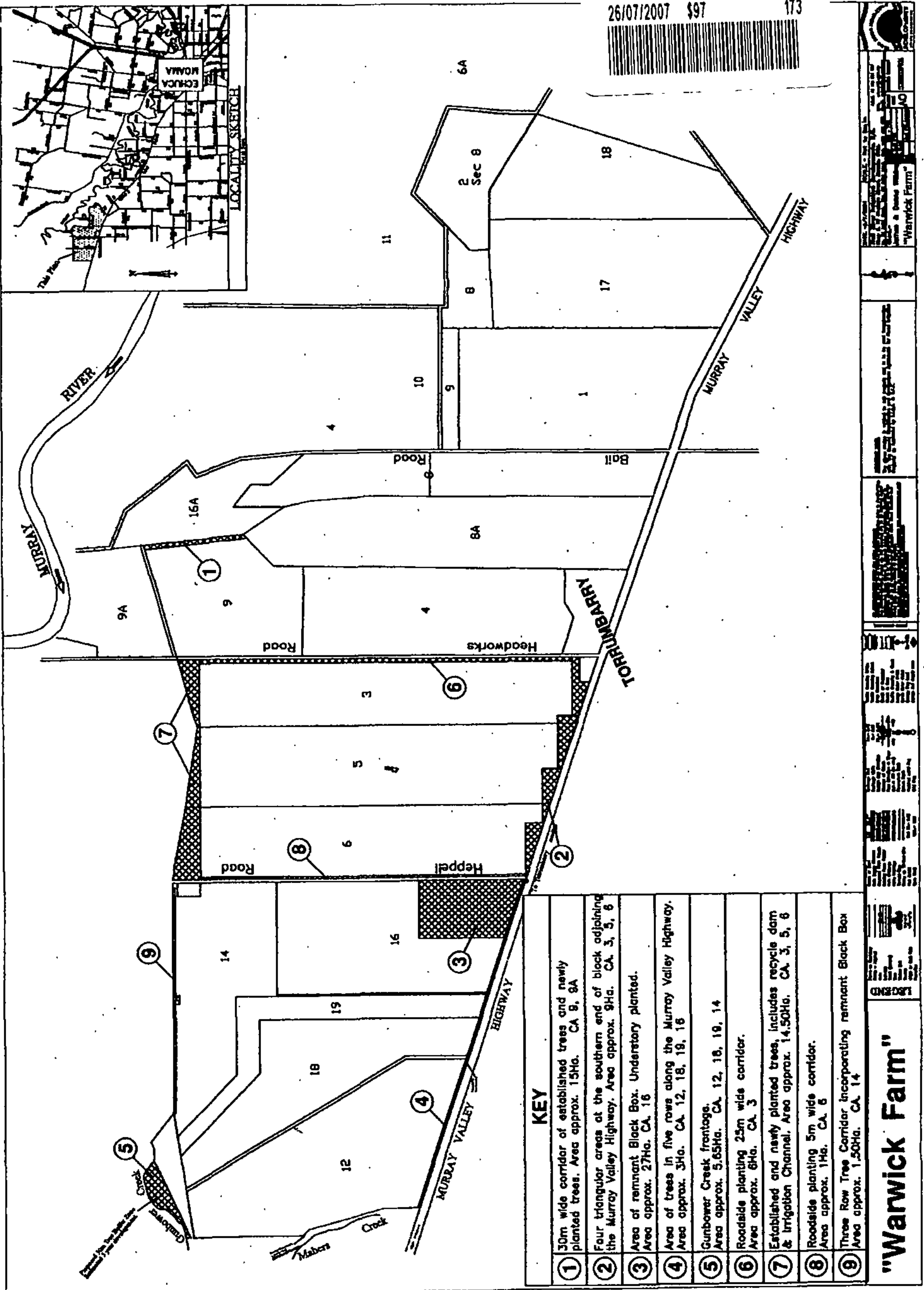

**KEY**

①	30m wide corridor of established trees and newly planted trees. Area approx. 15Ha. CA 9, 9A
②	Four triangular areas at the southern end of block adjoining the Murray Valley Highway. Area approx. 9Ha. CA 3, 5, 6
③	Area of remnant Black Box. Understorey planted. Area approx. 27Ha. CA 16
④	Area of trees in five rows along the Murray Valley Highway. Area approx. 3Ha. CA 12, 18, 19, 16
⑤	Gunbower Creek frontage. Area approx. 5.65Ha. CA 12, 18, 19, 14
⑥	Roadside planting 25m wide corridor. Area approx. 6Ha. CA 3
⑦	Established and newly planted trees, includes recycle dam & Irrigation Channel. Area approx. 14.50Ha. CA 3, 5, 6
⑧	Roadside planting 5m wide corridor. Area approx. 1Ha. CA 6
⑨	Three Row Tree Corridor Incorporating remnant Black Box Area approx. 1.50Ha. CA 14

**"Warwick Farm"**

WARWICK FARM  
 257 258 259 260 261 262 263 264 265 266 267 268 269 270 271 272 273 274 275 276 277 278 279 280 281 282 283 284 285 286 287 288 289 290 291 292 293 294 295 296 297 298 299 300 301 302 303 304 305 306 307 308 309 310 311 312 313 314 315 316 317 318 319 320 321 322 323 324 325 326 327 328 329 330 331 332 333 334 335 336 337 338 339 340 341 342 343 344 345 346 347 348 349 350 351 352 353 354 355 356 357 358 359 360 361 362 363 364 365 366 367 368 369 370 371 372 373 374 375 376 377 378 379 380 381 382 383 384 385 386 387 388 389 390 391 392 393 394 395 396 397 398 399 400 401 402 403 404 405 406 407 408 409 410 411 412 413 414 415 416 417 418 419 420 421 422 423 424 425 426 427 428 429 430 431 432 433 434 435 436 437 438 439 440 441 442 443 444 445 446 447 448 449 450 451 452 453 454 455 456 457 458 459 460 461 462 463 464 465 466 467 468 469 470 471 472 473 474 475 476 477 478 479 480 481 482 483 484 485 486 487 488 489 490 491 492 493 494 495 496 497 498 499 500 501 502 503 504 505 506 507 508 509 510 511 512 513 514 515 516 517 518 519 520 521 522 523 524 525 526 527 528 529 530 531 532 533 534 535 536 537 538 539 540 541 542 543 544 545 546 547 548 549 550 551 552 553 554 555 556 557 558 559 560 561 562 563 564 565 566 567 568 569 570 571 572 573 574 575 576 577 578 579 580 581 582 583 584 585 586 587 588 589 590 591 592 593 594 595 596 597 598 599 600 601 602 603 604 605 606 607 608 609 610 611 612 613 614 615 616 617 618 619 620 621 622 623 624 625 626 627 628 629 630 631 632 633 634 635 636 637 638 639 640 641 642 643 644 645 646 647 648 649 650 651 652 653 654 655 656 657 658 659 660 661 662 663 664 665 666 667 668 669 670 671 672 673 674 675 676 677 678 679 680 681 682 683 684 685 686 687 688 689 690 691 692 693 694 695 696 697 698 699 700 701 702 703 704 705 706 707 708 709 710 711 712 713 714 715 716 717 718 719 720 721 722 723 724 725 726 727 728 729 730 731 732 733 734 735 736 737 738 739 740 741 742 743 744 745 746 747 748 749 750 751 752 753 754 755 756 757 758 759 760 761 762 763 764 765 766 767 768 769 770 771 772 773 774 775 776 777 778 779 780 781 782 783 784 785 786 787 788 789 790 791 792 793 794 795 796 797 798 799 800 801 802 803 804 805 806 807 808 809 810 811 812 813 814 815 816 817 818 819 820 821 822 823 824 825 826 827 828 829 830 831 832 833 834 835 836 837 838 839 840 841 842 843 844 845 846 847 848 849 850 851 852 853 854 855 856 857 858 859 860 861 862 863 864 865 866 867 868 869 870 871 872 873 874 875 876 877 878 879 880 881 882 883 884 885 886 887 888 889 890 891 892 893 894 895 896 897 898 899 900 901 902 903 904 905 906 907 908 909 910 911 912 913 914 915 916 917 918 919 920 921 922 923 924 925 926 927 928 929 930 931 932 933 934 935 936 937 938 939 940 941 942 943 944 945 946 947 948 949 950 951 952 953 954 955 956 957 958 959 960 961 962 963 964 965 966 967 968 969 970 971 972 973 974 975 976 977 978 979 980 981 982 983 984 985 986 987 988 989 990 991 992 993 994 995 996 997 998 999 1000

Copyright State of Victoria. No part of this publication may be reproduced except as permitted by the Copyright Act 1968 (Cth), to comply with a statutory requirement or pursuant to a written agreement. The information is only valid at the time and in the form obtained from the LANDATA REGD TM System. None of the State of Victoria, its agents or contractors, accepts responsibility for any subsequent publication or reproduction of the information.

The Victorian Government acknowledges the Traditional Owners of Victoria and pays respects to their ongoing connection to their Country, History and Culture. The Victorian Government extends this respect to their Elders, past, present and emerging.

REGISTER SEARCH STATEMENT (Title Search) Transfer of Land Act 1958

VOLUME 10695 FOLIO 360

Security no : 124130452958K  
Produced 03/12/2025 03:00 PM

LAND DESCRIPTION

Lot 2 on Plan of Subdivision 429220U.  
PARENT TITLES :  
Volume 10122 Folio 672 to Volume 10122 Folio 673  
Created by instrument PS429220U 11/12/2002

REGISTERED PROPRIETOR

Estate Fee Simple  
Sole Proprietor  
MCLEAN FARMS AUSTRALIA PTY LTD of 385 FELTON ROAD PITTSWORTH QLD 4356  
AZ324062G 27/06/2025

ENCUMBRANCES, CAVEATS AND NOTICES

MORTGAGE AZ324064C 27/06/2025  
NATIONAL AUSTRALIA BANK LTD

Any encumbrances created by Section 98 Transfer of Land Act 1958 or Section 24 Subdivision Act 1988 and any other encumbrances shown or entered on the plan set out under DIAGRAM LOCATION below.

DIAGRAM LOCATION

SEE PS429220U FOR FURTHER DETAILS AND BOUNDARIES

ACTIVITY IN THE LAST 125 DAYS

NUMBER		STATUS	DATE
AZ324060L (E)	DISCHARGE OF MORTGAGE	Registered	13/08/2025
AZ324062G (E)	TRANSFER	Registered	13/08/2025
AZ324064C (E)	MORTGAGE	Registered	13/08/2025
AZ506528W (E)	TRANSFER CONTROL OF ECT	Completed	20/08/2025

-----END OF REGISTER SEARCH STATEMENT-----

Additional information: (not part of the Register Search Statement)

Street Address: 2952 MURRAY VALLEY HIGHWAY TORRUMBARRY VIC 3562

ADMINISTRATIVE NOTICES

NIL

eCT Control 16089P NATIONAL AUSTRALIA BANK LTD  
Effective from 20/08/2025

DOCUMENT END

Delivered from the LANDATA System by Dye & Durham Terrain Pty Ltd



# Imaged Document Cover Sheet

The document following this cover sheet is an imaged document supplied by LANDATA®, Secure Electronic Registries Victoria.

Document Type	<b>Plan</b>
Document Identification	<b>PS429220U</b>
Number of Pages (excluding this cover sheet)	<b>2</b>
Document Assembled	<b>03/12/2025 16:28</b>

**Copyright and disclaimer notice:**

© State of Victoria. This publication is copyright. No part may be reproduced by any process except in accordance with the provisions of the Copyright Act 1968 (Cth) and for the purposes of Section 32 of the Sale of Land Act 1962 or pursuant to a written agreement. The information is only valid at the time and in the form obtained from the LANDATA® System. None of the State of Victoria, LANDATA®, Secure Electronic Registries Victoria Pty Ltd (ABN 86 627 986 396) as trustee for the Secure Electronic Registries Victoria Trust (ABN 83 206 746 897) accept responsibility for any subsequent release, publication or reproduction of the information.

The document is invalid if this cover sheet is removed or altered.

<b>PLAN OF SUBDIVISION</b>	STAGE No. —	LTO USE ONLY EDITION <b>1</b>	<b>PS 429220U</b>
----------------------------	----------------	----------------------------------	-------------------

**LOCATION OF LAND**  
 PARISH: TURRUMBERRY NORTH  
 SECTION 7  
 CROWN ALLOTMENT 14 (PART)

LTO BASE RECORD: LITHO 1 (3663)  
 TITLE REFERENCE: C/T.'s VOL.10122 FOL.672  
 & VOL.10122 FOL.673

LAST PLAN REFERENCE:  
 PS 317473N, LOTS 2 & 3  
 POSTAL ADDRESS: HEPELL ROAD,  
 TORRUMBARRY 3562

AMG CO-ORDINATES: E 273900  
 (OF APPROX. CENTRE OF PLAN) N 6012600      ZONE 55

**COUNCIL CERTIFICATION AND ENDORSEMENT**

COUNCIL NAME: CAMPASPE SHIRE      REF: 82-99-383

1. THIS PLAN IS CERTIFIED UNDER SECTION 6 OF THE SUBDIVISION ACT 1988.  
~~2. THIS PLAN IS CERTIFIED UNDER SECTION 11(7) OF THE SUBDIVISION ACT 1988.~~  
~~DATE OF ORIGINAL CERTIFICATION UNDER SECTION 6.~~

~~3. THIS IS A STATEMENT OF COMPLIANCE ISSUED UNDER SECTION 21 OF THE SUBDIVISION ACT 1988.~~

**OPEN SPACE**

(I) A REQUIREMENT FOR PUBLIC OPEN SPACE UNDER SECTION 18 SUBDIVISION ACT 1988 ~~HAS~~ / HAS NOT BEEN MADE.  
~~(II) THE REQUIREMENT HAS BEEN SATISFIED.~~  
~~(III) THE REQUIREMENT IS TO BE SATISFIED IN STAGE.~~

COUNCIL DELEGATE  
~~COUNCIL SEAL~~

DATE **27-10-99**

VESTING OF ROADS OR RESERVES	
IDENTIFIER	COUNCIL/BODY/PERSON
NIL	NIL

**NOTATIONS**

**DEPTH LIMITATION:** 15.24 METRES BELOW THE SURFACE.  
 APPLIES TO ALL THE LAND IN THE PLAN.

**STAGING:** THIS IS NOT A STAGED PLAN OF SUBDIVISION.  
 PLANNING PERMIT No. **82-99-383**

**WATERWAY NOTATION:**  
 LOT 2 IN THIS PLAN MAY ABUT CROWN LAND THAT MAY BE SUBJECT TO A CROWN LICENCE TO USE

**SURVEY:-** THIS PLAN IS BASED ON SURVEY.  
 LOT ONE AND THE CONNECTION 358°27', 153.70 IS THE RESULT OF THIS SURVEY.

TO BE COMPLETED WHERE APPLICABLE.  
 THIS SURVEY HAS BEEN CONNECTED TO PERMANENT MARKS No(s). 5, 8 71  
 IN PROCLAIMED SURVEY AREA No. -

**EASEMENT INFORMATION**

**LEGEND:** E - ENCUMBERING EASEMENT OR CONDITION IN CROWN GRANT IN THE NATURE OF AN EASEMENT  
 A - APPURTENANT EASEMENT      R - ENCUMBERING EASEMENT (ROAD)

EASEMENT REFERENCE	PURPOSE	WIDTH (METRES)	ORIGIN	LAND BENEFITED/IN FAVOUR OF

**LTO USE ONLY**

STATEMENT OF COMPLIANCE / EXEMPTION STATEMENT

RECEIVED

DATE **29-11-02**

**LTO USE ONLY**

PLAN REGISTERED  
 TIME **8:45am**  
 DATE **11/12/02**  
  
 ASSISTANT REGISTRAR OF TITLES

SHEET 1 OF 2 SHEETS

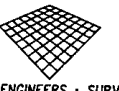

**CMM | Fisher Stewart**  
 ENGINEERS • SURVEYORS • PLANNERS • BUILDING & ENVIRONMENTAL CONSULTANTS

108 WYNDHAM STREET,  
 P.O. BOX 777,  
 SHEPPARTON VIC. 3632  
 TEL: (03) 5831 8777  
 FAX: (03) 5831 2228

LICENSED SURVEYOR      PATRICK RICE

SIGNATURE \_\_\_\_\_ DATE \_\_\_\_\_

REF 2099154/01      VERSION 1

DATE \_\_\_\_\_  
 COUNCIL DELEGATE SIGNATURE \_\_\_\_\_  
 ORIGINAL SHEET SIZE **A3**

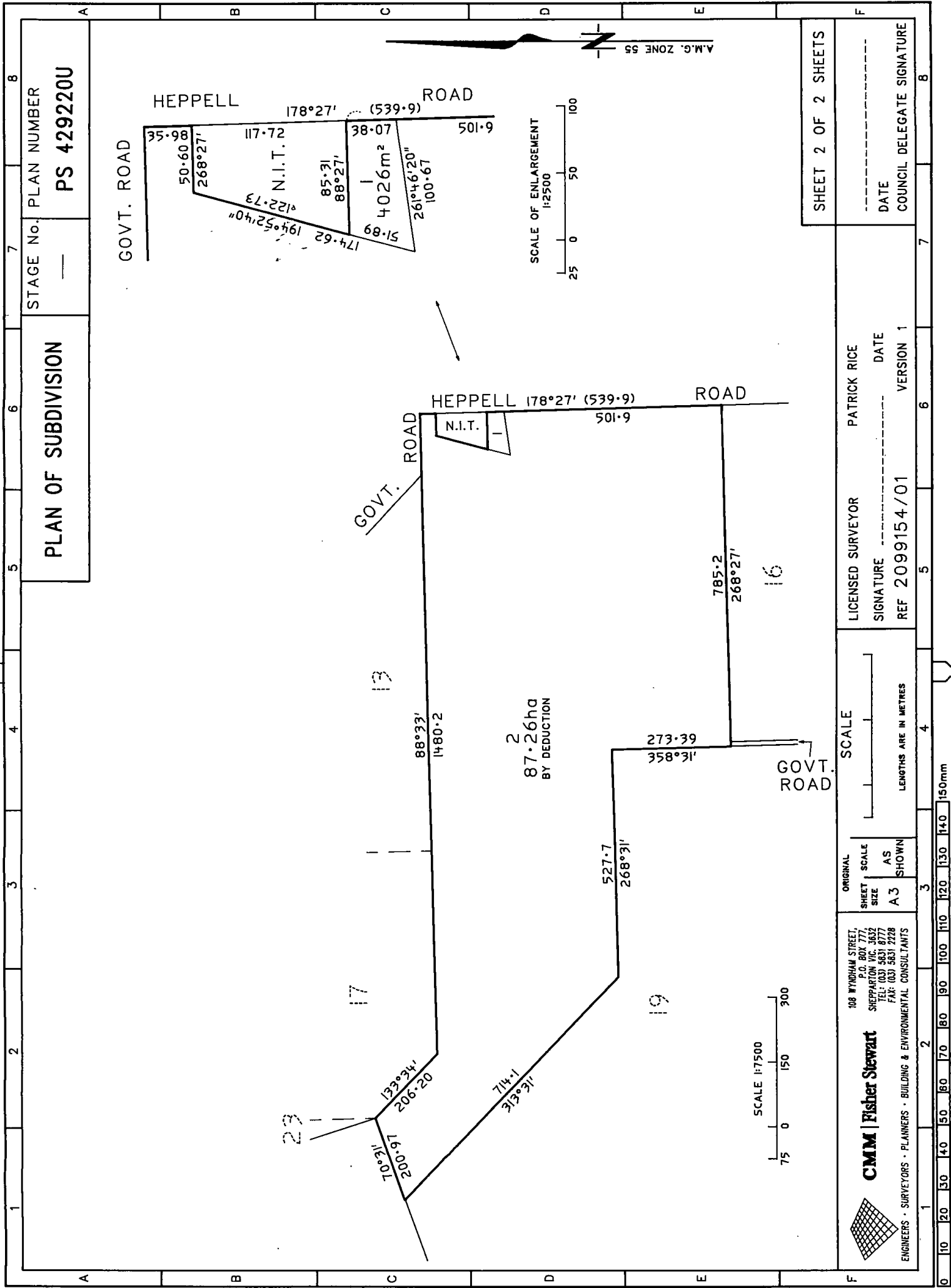

PLAN OF SUBDIVISION

STAGE No. PLAN NUMBER  
— PS 429220U

SHEET 2 OF 2 SHEETS  
DATE  
COUNCIL DELEGATE SIGNATURE

LICENSED SURVEYOR  
SIGNATURE PATRICK RICE  
DATE  
REF 2099154/01 VERSION 1

SCALE  
LENGTHS ARE IN METRES

ORIGINAL SHEET SIZE  
A3 AS SHOWN

**CMM | Fisher Stewart**  
ENGINEERS · SURVEYORS · PLANNERS · BUILDING & ENVIRONMENTAL CONSULTANTS  
108 WYNDHAM STREET,  
P.O. BOX 777  
SHEPPARTON VIC 3632  
TEL: (03) 5631 8777  
FAX: (03) 5631 2728

0 10 20 30 40 50 60 70 80 90 100 110 120 130 140 150mm