

The arboricultural reports have been prepared in stages.

The following reports provides the final assessment of the impacts on trees:

- *Swale Drain Arboricultural Impact Assessment, 19 September 2024*
- *Arboricultural Impact Assessment, 535-537 Maroondah Highway Coldstream VIC 3770, 4 April 2023*

The following reports have been included in the submission as they provide background information about the health and condition of trees that are impacted and avoided by the project:

- *Access Road, Design Review (7 June 2022)*
- *Bridge, Preliminary Tree Assessment & Design Review (7 June 2022)*
- *Signalised Intersection, Preliminary Tree Assessment & Arboricultural Impact Assessment (7 June 2022)*
- *Ingram Road Intersection, Preliminary Tree Assessment & Arboricultural Impact Assessment (23 June 2022)*

Table 1 provides a summary of each tree that is impacted by the project. To identify the location of the tree, refer to the 'Area' and then the 'ID Number' in order to locate it in Figure 1.

ADVERTISED PLAN

**This copied document to be made available
for the sole purpose of enabling
its consideration and review as
part of a planning process under the
Planning and Environment Act 1987.
The document must not be used for any
purpose which may breach any
copyright**

Table 1 Tree Impacts

Area	ID Number	Genus	Species	Origin	Height (m)	DBH (cm)	Health	Structure	Visual Amenity Value	Retention Value	Encroachment	Remove / Retain	Permit required if removed (Yes/No/NA)				Permit required for removal (1 or more triggers)	
													ES01	SLO2	51.03	52.17		
Drain (Area 1)	3/158	Acacia	melanoxylon	Indigenous	7	40 14	Good	Good	Low	Moderate	Minor	Retain	NA	Yes	NA	No	No	No
Drain (Area 1)	4/155	Eucalyptus	melliodora	Planted Victorian	23	115	Good	Good	High	High	Minor	Retain	NA	No (planted)	NA	No (planted)	No	No
Drain (Area 1)	6/151	Eucalyptus	melliodora	Planted Victorian	25	115	Good	Fair	High	High	Minor	Retain	NA	No (planted)	NA	No (planted)	No	No
Drain (Area 1)	7	Eucalyptus	botryoides	Planted Victorian	10	75	Good	Good	High	High	Major	Remove	NA	No (planted)	NA	No (planted)	No	No
Drain (Area 1)	8	Eucalyptus	botryoides	Planted Victorian	18	90	Fair	Good	High	High	Major/Within	Remove	NA	No (planted)	NA	No (planted)	No	No
Drain (Area 1)	9	Acacia	melanoxylon	Indigenous	10	45	Fair	Fair	Moderate	Moderate	Major/Within	Remove	Yes	Yes	NA	Yes	Yes	
Drain (Area 1)	10	Acacia	melanoxylon	Indigenous	6	10	Good	Good	Moderate	Moderate	Major/Within	Remove	Yes	Yes	NA	Yes	Yes	
Drain (Area 1)	11	Eucalyptus	ovata	Indigenous	12	55	Good	Good	High	High	Major/Within	Remove	Yes	Yes	NA	Yes	Yes	
Drain (Area 1)	12	Hesperocyparis	macrocarpa	Planted exotic	14	20	Dead	Poor	Low	Low	Major/Within	Remove	No (exotic)	No (dead)	NA	NA	No	
Drain (Area 1)	13	Eucalyptus	sp.	Indigenous	9	40	Dead	Poor	Low	Low	Major/Within	Remove	Yes	No (dead)	NA	Yes	Yes	
Drain (Area 1)	14	Hesperocyparis	macrocarpa	Planted exotic	14	120	Dead	Poor	Low	Low	Major/Within	Remove	No (exotic)	No (dead)	NA	NA	No	
Drain (Area 1)	15	Acacia	sp.	Indigenous	4	40	Dead	Poor	Low	Low	Major/Within	Remove	Yes	No (dead)	NA	Yes	Yes	
Drain (Area 1)	16	Acacia	melanoxylon	Indigenous	5	14	Good	Poor	Low	Low	Major/Within	Remove	Yes	Yes	NA	Yes	Yes	
Drain (Area 1)	17	Acacia	sp.	Indigenous	8	50	Dead	Poor	Low	Low	Major/Within	Remove	Yes	No (dead)	NA	Yes	Yes	
Drain (Area 1)	18	Eucalyptus	ovata	Indigenous	9	18	Good	Good	Moderate	Moderate	Major/Within	Remove	Yes	Yes	NA	Yes	Yes	
Drain (Area 1)	19	Eucalyptus	ovata	Indigenous	8	25 20	Good	Fair	Moderate	Moderate	Major/Within	Remove	Yes	Yes	NA	Yes	Yes	
Drain (Area 1)	20	Eucalyptus	ovata	Indigenous	10	55	Good	Fair	Moderate	Moderate	Minor	Retain	Yes	Yes	NA	No	No	
Drain (Area 1)	21	Eucalyptus	ovata	Indigenous	6	10 11 10 12	Good	Good	Moderate	Moderate	Major/Within	Remove	Yes	Yes	NA	Yes	Yes	
Drain (Area 1)	22	Eucalyptus	ovata	Indigenous	6	40	Good	Fair	Moderate	Moderate	Major/Within	Remove	Yes	Yes	NA	Yes	Yes	
Drain (Area 1)	23	Eucalyptus	sp.	Indigenous	7	35	Dead	Poor	Low	Low	Major/Within	Remove	No (dead)	No (dead)	NA	No (dead)	No	
Drain (Area 1)	24	Hesperocyparis	macrocarpa	Planted exotic	4	50	Good	Good	Moderate	High	Major/Within	Remove	No (exotic)	No (planted)	NA	NA	No	
Drain (Area 1)	25	Hesperocyparis	macrocarpa	Planted exotic	3	120	Dead	Poor	Low	Low	Major/Within	Remove	No (exotic)	No (dead)	NA	NA	No	
Drain (Area 1)	26	Hesperocyparis	macrocarpa	Planted exotic	8	120	Dead	Poor	Low	Low	Major/Within	Remove	No (exotic)	No (dead)	NA	NA	No	
Drain (Area 1)	27	Eucalyptus	botryoides	Planted Victorian	8	55	Good	Poor	Moderate	High	Major/Within	Remove	No (planted)	No (planted)	NA	No (planted)	No	
Drain (Area 1)	28	Quercus	palustris	Planted exotic	20	80	Good	Good	High	High	Major/within	Remove	No (exotic)	Yes	NA	NA	Yes	
Drain (Area 1)	118	Hesperocyparis	macrocarpa	Exotic	16	120	Good	Poor	Moderate	Low	Minor	Retain	NA	Yes	NA	NA	No	
Drain (Area 1)	127	Hesperocyparis	macrocarpa	Exotic	18	90	Poor	Poor	Moderate	Low	Minor	Retain	NA	Yes	NA	NA	No	
Drain (Area 1)	129	Hesperocyparis	macrocarpa	Exotic	18	100	Poor	Poor	Low	Low	Minor	Retain	NA	Yes	NA	NA	No	
Drain (Area 1)	130	Hesperocyparis	macrocarpa	Exotic	16	80	Poor	Fair	Low	Low	Minor	Retain	NA	Yes	NA	NA	No	
Drain (Area 1)	133	Quercus	palustris	Exotic	23	75	Good	Fair	High	High	Minor	Retain	NA	Yes	NA	NA	No	
Drain (Area 1)	138	Quercus	palustris	Exotic	24	85	Good	Good	High	High	Major	Retain	NA	Yes	NA	NA	No	
Drain (Area 1)	139	Quercus	palustris	Exotic	25	93	Good	Good	High	High	Major	Retain	NA	Yes	NA	NA	No	
Drain (Area 1)	140	Quercus	palustris	Exotic	25	76	Good	Fair	High	High	Major	Retain	No (exotic)	Yes	NA	NA	Major	
Drain (Area 1)	141	Hesperocyparis	macrocarpa	Exotic	17	90	Poor	Fair	Low	Low	Major	Remove	No (exotic)	Yes	NA	NA	Yes	
Drain (Area 1)	143	Eucalyptus	robusta	Planted Australian	8	75	Good	Poor	Low	Low	Major	Retain	No (planted)	No (planted)	NA	No	No	
Drain (Area 1)	144	Hesperocyparis	macrocarpa	Exotic	12	100	Dead	Poor	Low	Low	Major	Remove	No (exotic)	No (dead)	NA	NA	No	
Drain (Area 1)	145	Eucalyptus	sp.	Planted Victorian	17	65	Dead	Fair	Low	Low	Major	Retain	NA	No (dead)	NA	No (planted)	No	
Drain (Area 1)	146	Eucalyptus	botryoides	Planted Victorian	16	90	Good	Fair	Moderate	Moderate	Major	Retain	NA	No (planted)	NA	No (planted)	No	
Drain (Area 1)	149	Eucalyptus	melliodora	Planted Victorian	25	90	Good	Fair	High	High	Minor	Retain	NA	No (planted)	NA	No (planted)	No	
Drain (Area 1)	150	Eucalyptus	melliodora	Planted Victorian	19	85	Good	Fair	High	High	Minor	Retain	NA	No (planted)	NA	No (planted)	No	
Rail Trail (Area 2)	48	Acacia	melanoxylon	Indigenous	6	18	Good	Good	Low	Low	Major/Within	Remove	NA	Yes	NA	Yes (patch)	Yes	
Rail Trail (Area 2)	49	Acacia	melanoxylon	Indigenous	7	24	Dead	Poor	Low	Low	Major/Within	Remove	NA	No (dead)	NA	Yes (patch)	Yes	
Rail Trail (Area 2)	50	Acacia	melanoxylon	Indigenous	6	18	Dead	Poor	Low	Low	Major/Within	Remove	NA	No (dead)	NA	Yes (patch)	Yes	
Rail Trail (Area 2)	51	Acacia	melanoxylon	Indigenous	3	14	Good	Good	Low	Low	Major/Within	Remove	NA	Yes	NA	Yes (patch)	Yes	
Rail Trail (Area 2)	60	Acacia	melanoxylon	Indigenous	3	12	Fair	Poor	Low	Low	Major/Within	Remove	NA	Yes	NA	Yes (patch)	Yes	
Rail Trail (Area 2)	61	Acacia	melanoxylon	Indigenous	3	16	Dead	Fair	Low	Low	Major/Within	Remove	NA	No (dead)	NA	Yes (patch)	Yes	
Highway (Area 3)	36	Acacia	sp.	Indigenous	5	36	Dead	Poor	Low	Low	Major/Within	Remove	No (exempt)	No (dead)	NA	Yes (patch)	Yes	
Highway (Area 3)	37	Eucalyptus	radiata	Australian	12	75 70	Fair	Poor	High	High	Major/Within	Remove	Yes	Yes	NA	No (non-native)	Yes	
Highway (Area 3)	38	Pinus	radiata	Environmental weed	3	15	Good	Fair	Low	Low	Major/Within	Remove	No	No	NA	No (weed)	No	
Highway (Area 3)	39	Acacia	sp.	Indigenous	3	22	Dead	Poor	Low	Low	Major/Within	Remove	No (exempt)	No (dead)	NA	Yes (patch)	Yes	
Highway (Area 3)	40	Melaleuca	stypelioides	Australian	4	26	Good	Good	Moderate	Low	Major/Within	Remove	Yes	No	NA	No (non-native)	Yes	
Highway (Area 3)	41	Acacia	longifolia	Environmental weed	3	4 4 2 3	Good	Fair	Low	Low	Major/Within	Remove	No	No	NA	No (weed)	No	
Highway (Area 3)	42	Acacia	longifolia	Environmental weed	2	2 2 3 2	Good	Poor	Low	Low	Major/Within	Remove	No	No	NA	No (weed)	No	
Highway (Area 3)	43	Acacia	saligna	Environmental weed	7	26 22	Good	Poor	Low	Low	Major/Within	Remove	No	No	NA	No (weed)	No	
Highway (Area 3)	44	Acacia	saligna	Environmental weed	7	50	Fair	Poor	Low	Low	Major/Within	Remove	No	No	NA	No (weed)	No	
Highway (Area 3)	45	Acacia	dealbata	Indigenous	3	6	Good	Good	Low	High	Major/Within	Remove	Yes	Yes	NA	Yes	Yes	
Highway (Area 3)	46	Acacia	dealbata	Indigenous	3	8	Good	Good	Low	High	Major/Within	Remove	Yes	Yes	NA	Yes	Yes	
Highway (Area 3)	47	Acacia	dealbata	Indigenous	2	2	Good	Good	Low	High	Major/Within	Remove	Yes	Yes	NA	Yes	Yes	
Highway (Area 3)	48	Acacia	dealbata	Indigenous	3	6	Good	Fair	Low	High	Major/Within	Remove	Yes	Yes	NA	Yes	Yes	
Highway (Area 3)	49	Acacia	dealbata	Indigenous	4	10 6	Good	Poor	Low	High	Major/Within	Remove	Yes	Yes	NA	Yes	Yes	
Highway (Area 3)	50	Acacia	dealbata	Indigenous	4	6	Good	Poor	Low	High	Major/Within	Remove	Yes	Yes	NA	Yes	Yes	
Highway (Area 3)	51	Acacia	dealbata	Indigenous	5	14 5 11	Fair	Poor	Low	High	Major/Within	Remove	Yes	Yes	NA	Yes	Yes	
Highway (Area 3)	52	Acacia	saligna	Environmental weed	2	5	Good	Poor	Low	Low	Major/Within	Remove	No	No	NA	No (weed)	No	
Highway (Area 3)	53	Melaleuca	stypelioides	Australian	5	26 28	Good	Poor	Low	Low	Major/Within	Remove	Yes	No	NA	No (non-native)	Yes	
Highway (Area 3)	54	Acacia	saligna	Environmental weed	8	28 30 60	Poor	Poor	Low	Low	Major/Within	Remove	No	No	NA	No (weed)	No	
Highway (Area 3)	55	Acacia	longifolia	Environmental weed	1	1 1 1 1	Good	Good	Low	Low	Major/Within	Remove	No	No	NA	No (weed)	No	
Highway (Area 3)	56	Acacia	longifolia	Environmental weed	2	2 2 1 1	Good	Fair	Low	Low	Major/Within	Remove	No	No	NA	No (weed)	No	
Highway (Area 3)	57	Allocasuarina	littoralis	Indigenous	3	4 3 3 2	Good	Poor	Low	High	Major/Within	Remove	Yes	Yes	NA	Yes	Yes	
Highway (Area 3)	58	Allocasuarina	littoralis	Indigenous	6	12 15 18 15	Good	Poor	Moderate	High	Major/Within	Remove	Yes	Yes	NA	Yes	Yes	
Highway (Area 3)	59	Acacia	longifolia	Environmental weed	4	8 8	Fair	Poor	Low	Low	Major/Within	Remove	No	No (weed)	NA	No (weed)	No	
Highway (Area 3)	60	Acacia	longifolia	Environmental weed	1	2 1 2 1	Good	Good	Low	Low	Major/Within	Remove	No	No (weed)	NA	No (weed)	No	
Highway (Area 3)	61	Acacia	longifolia	Environmental weed	3	8	Fair	Fair	Low	Low	Major/Within	Remove	No	No (weed)	NA	No (weed)	No	
Highway (Area 3)	62	Acacia	longifolia	Environmental weed	4	10 6	Poor	Fair	Low	Low	Major/Within	Remove	No	No (weed)	NA	No (weed)	No	
Highway (Area 3)	63	Acacia	longifolia	Environmental weed	4	5 8 6 10	Poor	Poor	Low	Low	Major/Within	Remove	No	No (weed)	NA	No (weed)	No	
Highway (Area 3)	64	Acacia	longifolia	Environmental weed	5	5 8 8 6	Fair	Poor	Low	Low	Major/Within	Remove	No	No (weed)	NA	No (weed)	No	
Highway (Area 3)	65	Allocasuarina	littoralis	Indigenous	3	5	Fair	Poor	Low	High	Major/Within	Remove	Yes	Yes	NA	Yes	Yes	
Highway (Area 3)	66	Acacia	saligna	Environmental weed	7	10 6 14 16	Fair	Fair	Low	Low	Major/Within	Remove	No	No	NA	No (weed)	No	
Highway (Area 3)	98	Eucalyptus	sp.	Indigenous	7	25	Dead	Poor	Low	Low	Major/Within	Remove	No (exempt)	No (dead)	NA	Yes (patch)	Yes	
Highway (Area 3)	99	Eucalyptus	sp.	Indigenous	7	9	Dead	Poor	Low	Low	Major/Within	Remove	No (exempt)	No (dead)	NA	Yes (patch)	Yes	
Highway (Area 3)	100	Prunus	domestica	Environmental weed	6	14 12 10	Good	Good	Low	Low	Major/Within	Remove	No	No	NA	No (weed)	No	
Highway (Area 3)	103	Acacia	melanoxylon	Indigenous	8	22	Fair	Fair	Low	Low	Minor	Retain	Yes	Yes	NA	Yes	No	
Highway (Area 3)	104	Eucalyptus	yarraensis	Indigenous	17	91	Good	Good	High	High	Minor	Retain	Yes	No	NA	Yes	No	

This copied document to be made available for the sole purpose of enabling its consideration and review as part of a planning process under the Planning and Environment Act 1987. The document must not be used for any purpose which may breach any copyright

ADVERTISED PLAN

Figure 1 Location of Trees Impacted

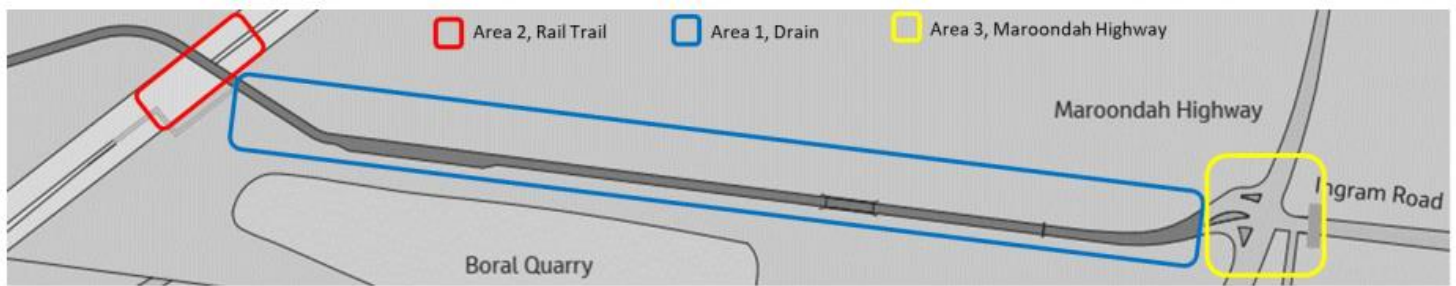

Area 1 Drain

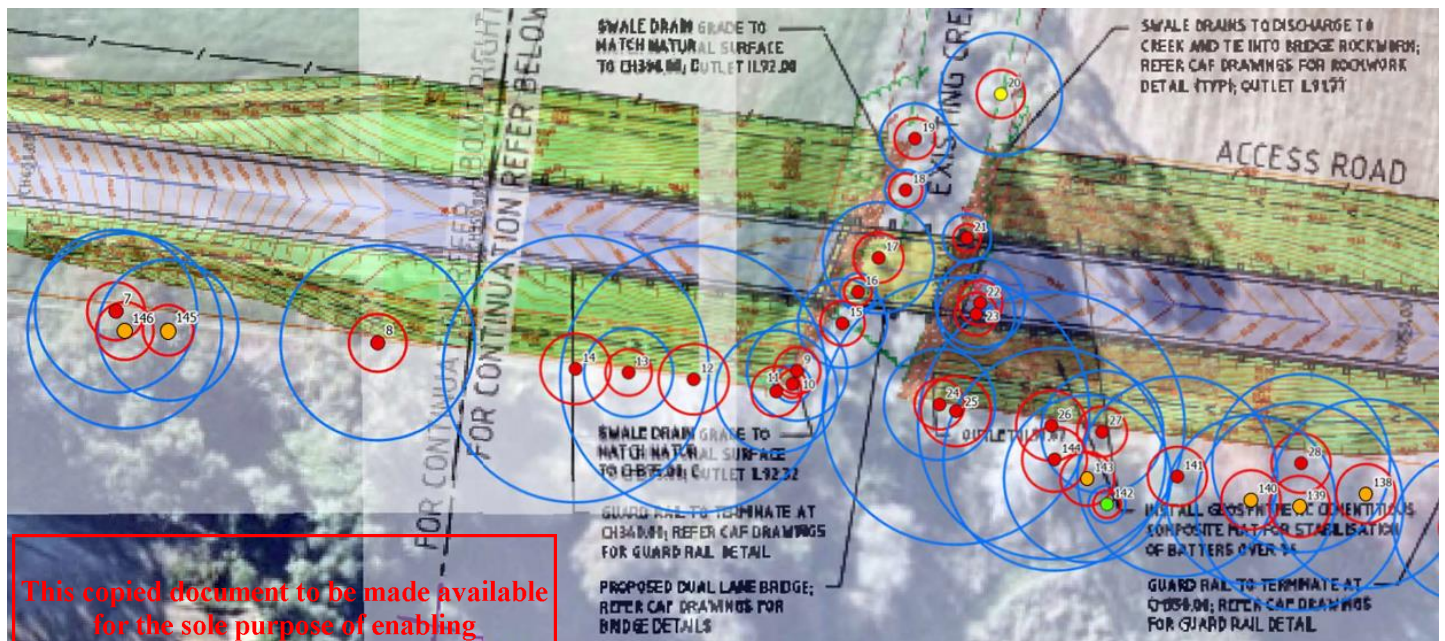

This copied document to be made available for the sole purpose of enabling its consideration and review as part of a planning process under the Planning and Environment Act 1987. The document must not be used for any purpose which may breach any copyright.

Area 3 Maroondah Highway

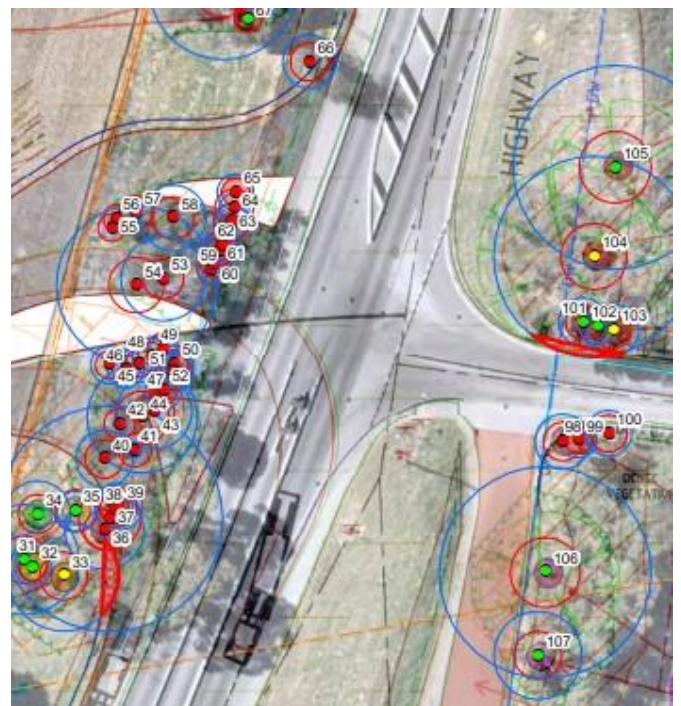

Note: The tree numbers in Area 2 Rail Trail and Maroondah Highway have been duplicated (i.e. Tree No.s 48, 49, 50, 51, 60 and 61 appear in both). The record of each tree in the spreadsheet is identifiable by the location name and then the tree number)

**ADVERTISED
PLAN**