

7 SEBASTOPOL ROAD, MARYBOROUGH

SEBASTOPOL ROAD UNIT TRUST

CENTRAL GOLDFIELDS SHIRE COUNCIL

FUNCTIONAL LAYOUT PLANS

CONSTRUCTION NOTES

SITE MANAGEMENT

- A1. Prior to commencement of works on site, the contractor must ensure that all matters relating to the Occupational Health & Safety Act 2004, including all relevant regulations, have been addressed. In particular, the required notifications must be conveyed to the Worksafe Victoria - Health & Safety division with respect to trenching operations. Details of the contractors occupational health & safety procedures must be lodged with the superintendent prior to commencement of works.
- A2. All native trees & shrubs to be retained unless road construction necessitates their removal or removal is directed by the engineer. A town planning permit is required for the removal of native trees & / or vegetation. The removal or retention of any existing trees must be in accordance with the approved landscape plan, or else approval will be required from the CENTRAL GOLDFIELDS SHIRE COUNCIL landscape approvals officer.
- A3. Existing dam or watercourses to be excavated to a firm base & backfilled as specified. Consulting engineer to be notified when the dam or watercourses are excavated to a firm base. No filling is to be placed prior to dams being inspected & levels taken. Backfilling is to be carried out to the satisfaction of the Council supervising engineer.
- A4. Prior to commencement of works, the contractor must submit a Site Management Plan (SMP) to the consultant for approval. The contractor must comply with the recommendations of the Environment Protection Authority publication No.275 "Construction techniques for sediment pollution control". Appropriate siltation control is to be maintained throughout the construction & maintenance period of the works.
- A5. Provide temporary safety barrier fence (Farm Fence as per MW Std Dwg 7251/08/203) along extent of outfall drain where the drain is greater than 1.5m in depth & side slopes are steeper than 1 in 3. Safety fence to remain until permanent underground drainage is installed.
- A6. A temporary fence shall be erected & maintained around existing trees, nominated to be retained, at all times during construction. (For fencing details & construction works within the "Tree protection zone" refer to the arboricultural inspection report).
- A7. Contractor to remove existing irrigation & drainage pipes & pits encountered on site. Trenches to be backfilled in accordance with notes C2 & C3.

GENERAL

- B1. All works to be carried out in accordance with AS2124-1992 general conditions of contract & the CENTRAL GOLDFIELDS SHIRE COUNCIL current specification & standard drawings & to the satisfaction of the CENTRAL GOLDFIELDS SHIRE COUNCIL works supervisor.
- B2. Council to be notified two (2) clear days prior to commencement of works.
- B3. Before commencement of works on trenches in excess of 1.5m deep, the civil contractors construction supervisor must give notice in writing of such proposals to Worksafe Victoria in accordance with Part 5.1, Division 4 of the Occupational Health & Safety regulations (2017) & undertake safety precautions in trenching operations in accordance with Worksafe Compliance Code - Excavations Edition 2, December 2019.
- B4. On completion the contractor is responsible for the removal of all rubbish & spoil from site. No surplus trees, vegetation or other material is to be burnt on site.
- B5. Reserves to be free draining & to be left in a condition satisfactory to the CENTRAL GOLDFIELDS SHIRE COUNCIL works supervisor.
- B6. Where works are in the vicinity of existing services these services are to be located & the various authorities notified prior to the commencement of works.
- B7. All TBM's & control points are to be maintained & protected at all times during construction. Should any marks be disturbed, the contractor will immediately notify the consultant to arrange re-instatement at the contractors expense.
- B8. Provide painted paling fence along any boundary common to lots & municipal reserves as per Council Std. Dwg. Palings to be on the reserve side.

ROADWORKS

- C1. 100% agricultural pipe drains IDM standard drawing to be placed behind all kerb & channel & buffer pitches & where directed by the engineer.
- C2. Filling in all properties & road reserves is to be carried out using approved clay fill. Top soil & all vegetable matter to be stripped from site prior to filling. All filling to be carried out in accordance with AS3798-2007 and the geotechnical report. Level 1 inspection and testing to be carried out in accordance with AS3798-2007 Section 8.2. A fill report must be submitted to the Consultant, showing from a NATA registered soil testing laboratory.
- C3. Importing Fill- All imported fill must be tested by a NATA approved laboratory to ensure it is suitable for use on site, & any contaminants are within accepted levels. Under no circumstances should fill material enter or leave the site without the permission of the supervising engineer & Council works supervisor, prior to it being appropriately tested. All vehicles transporting fill material to & from the site must have appropriate measures in place to ensure that material does not get onto roads & into stormwater systems & natural waterways.
- C4. Batters to be 1 in 5 for fill & 1 in 3 for cut unless noted otherwise.
- C5. Cut batters are to be grassed & mulched with a mixture of chopped grass, straw & bitumen emulsion.
- C6. Where cut batters exceed 700mm an additional 300mm berm shall be formed behind footpath.
- C7. Access ramps are to be constructed where cut batters exceed 1.0m. They are to be graded 1 in 10 for the first 2.5m from the back of path & then at a maximum of 1 in 4 to natural surface.

- C8. The water conduit offset from the lot boundary is given on the water reticulation plan. The contractor must construct conduits to accord with the given offset & ensure that the concrete marks the kerb & footpath exactly above the conduit.
- C9. Irrigation conduits are to be DN100 DWV PVC installed beneath the pavement and/or capping layer, if present. Locations are to be marked using a green dot spray painted on the top of kerb.
- C10. All footpaths are to be 125mm thick 25MPa concrete with SL72 mesh centrally located in accordance with the IDM standard drawing.
- C11. NBN Co to be notified seven (7) days prior to concrete works being placed.
- C12. Electrical distribution pits within footpaths are to be a minimum of 300mm within the edge of the path. Concrete is to be placed around distribution pits to a minimum depth of 200mm.
- C13. All street signs to be constructed & erected to current CENTRAL GOLDFIELDS SHIRE COUNCIL standards including logo. Court street names are to show court name only.
- C14. Traffic control signs, markings & delineators to be installed in accordance with AS1742.2. All line marking is to be long life road marking, with longitudinal lines in thermoplastic & transverse markings in cold applied.
- C15. Driveways to be constructed in accordance with the IDM standard drawings. Single driveways to be a minimum 3m wide & to be offset 0.75m from side boundary or easement unless otherwise shown.
- C16. Kerb transition to take place in the minor street over a 2.0m length from either the tangent point or TP pit.
- C17. Existing road works to be reconstructed as required to provide, without discontinuity, a connection in accordance with design levels & grades.
- C18. Provide 2.5m wide shared footpath through reserves as shown on a curvilinear alignment to the satisfaction of the engineer.
- C19. Tactile ground surface indicators (TGS) are to be installed at all pram crossings & pedestrian cross points in accordance with AS1428.4.1 : 2009 & IDM standard drawing.

DRAINAGE

- D1. Drainage & pits to be set out from offsets shown rather than from centreline pipe chainages.
- D2. Lightweight fibreglass type pit lids are required for all drainage pits & all grates for pits are to be Class D, to comply with AS3996 - 2019 unless otherwise shown. All drainage works are to be constructed to council specifications.
- D3. All pipes up to and including 750mm in diameter shall be rubber ring jointed (RRJ). Pipes above this size may be flush jointed with external sealing bands. For pipes greater than 900mm and changes in direction between 2 connecting pipes exceeding 10° construct segmented curves using splayed pipes with bandage joints, having deflections within the manufacturer's specification.
- D4. All pipes to be Class 'Z' R.C. unless noted otherwise. PVC pipes to be Class SH unless specified.
- D5. Pipe trenches beneath the road pavement, footpath or within 150mm of the kerb & channel to be backfilled with 20mm Class 3 FCR in 150mm layers.
- D6. Property inlets to be constructed as per standard drawing in the IDM.
- D7. All proposed drainage stubs to be blanked off at end of pipe with timber planks to the satisfaction of the supervising engineer.

PAVEMENT

- E1. Modification of the pavement requires approval by the CENTRAL GOLDFIELDS SHIRE COUNCIL works supervisor.



SITE PLAN
NOT TO SCALE

**ADVERTISED
PLAN**

This copied document to be made available for the sole purpose of enabling its consideration and review as part of a planning process under the Planning and Environment Act 1987. The document must not be used for any purpose which may breach any copyright

PRELIMINARY PRINT
NOT FOR CONSTRUCTION

REV	DESCRIPTION	DATE	DRN.	APP.	REV	DESCRIPTION	DATE	DRN.	APP.
P4	MAJOR AMENDMENTS TO 34 UNITS	29.05.25	JS	MJ					
P3	CARPARKS ADDED TO COMMON PROPERTY	14.02.25	JS	MJ					
P2	LOT LAYOUT AMENDED	05.02.25	JS	MJ					
P1	COMMON PROPERTY AMENDED	18.12.24	JS	MJ	P6	MINOR CHANGES	18.07.25	JS	MJ
P0	ISSUED FOR INFORMATION	15.08.24	JS	MJ	P5	LOT LEVEL AMENDMENT AND KERB ADDED TO SEBASTOPOL RD	04.07.25	JS	MJ



SCALE 1:5000 AT A1 SIZE

Designed	J.SPARK
Date	15.08.2024
Drawn	J.SPARK
Checked	M.JOHNSON
Date	08.11.2024
Approved	M.JOHNSON
Reg. No.	PE0005673
Date	08.11.2024
PS Number	



SUITE 3, 180 ELEANOR DRIVE
LUCAS VIC 3350
ph: 03 5327 2000
www.beveridgewilliams.com.au

Project Details	7 SEBASTOPOL ROAD, MARYBOROUGH FUNCTIONAL LAYOUT PLANS CENTRAL GOLDFIELDS SHIRE COUNCIL
Drawing Title	COVER SHEET

Sheet 01 of 07

Scale 1:5000 @ A1

Project Ref	Stage No	Drawing No	Rev
2401300	00	900	P6

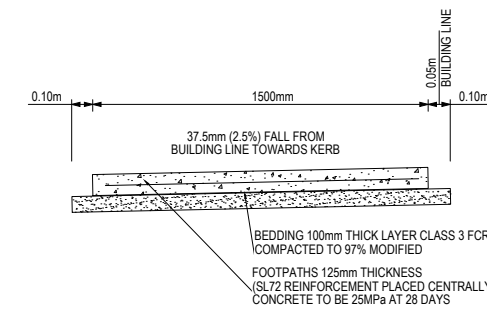
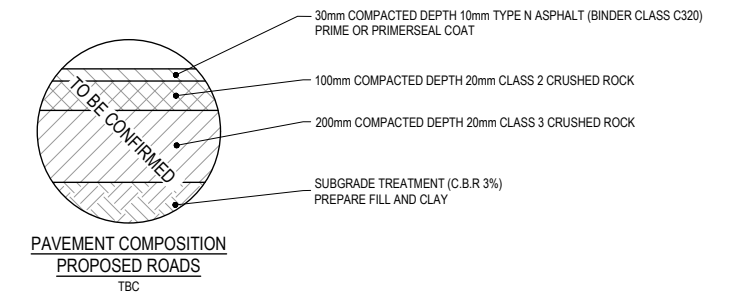
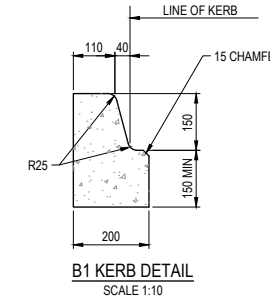
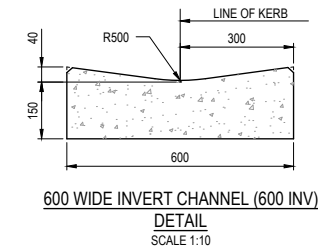
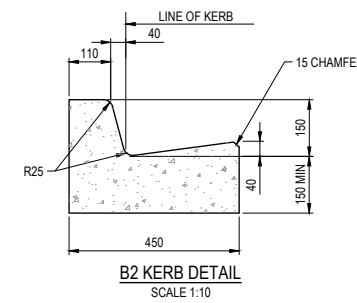
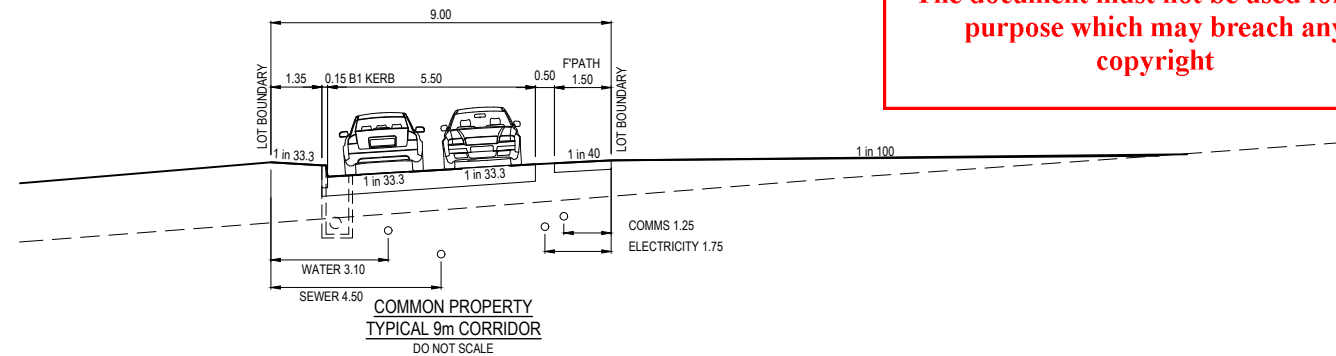
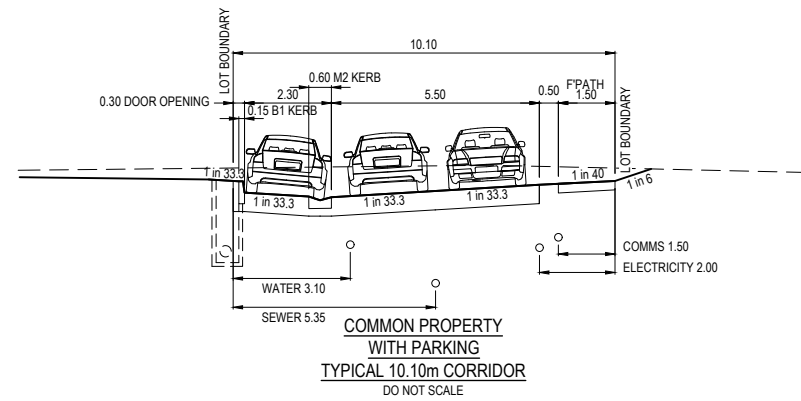
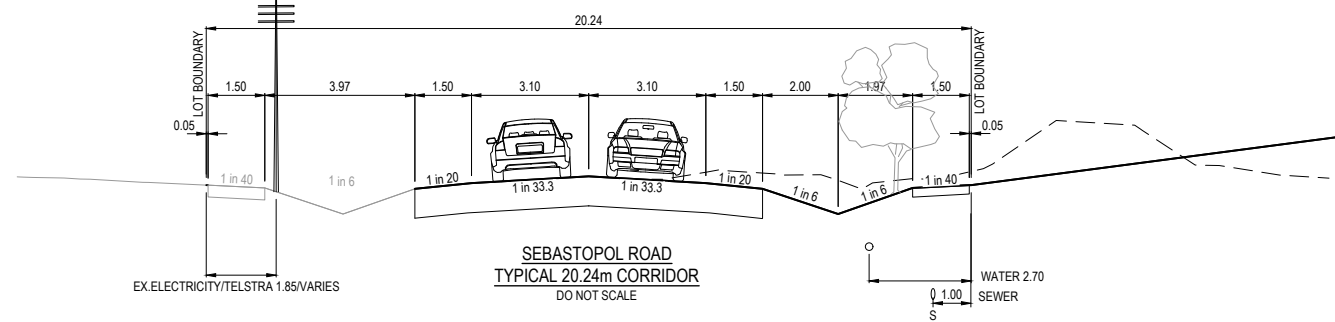
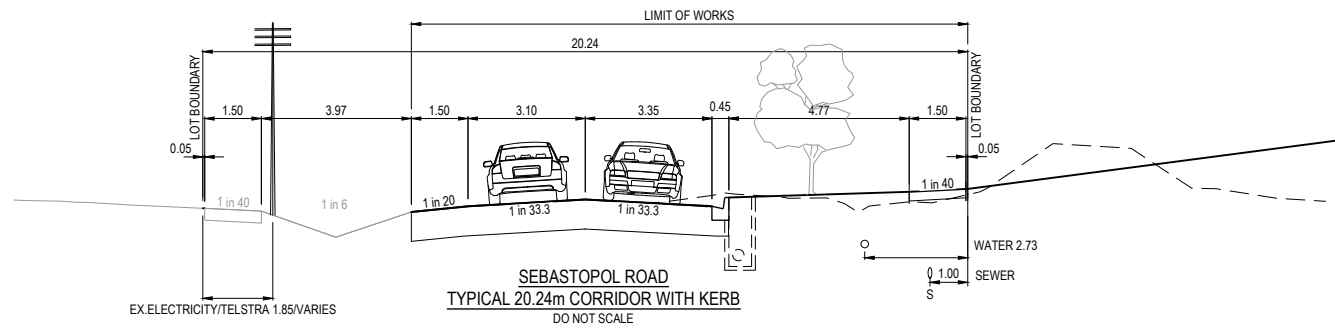

EXPANSION JOINTS TO BE CONSTRUCTED WITH BITUMINOUS JOINTING STRIP OR EQUIVALENT. THEY SHALL BE PLACED EVERY 12 METRES, AT BOTH SIDES OF DRIVEWAYS AND WHERE PEDESTRIAN LAYBACKS ARE CONSTRUCTED. WEAKENED PLANE JOINTS AT 1.2 METRES SPACINGS. WHERE REQUIRED STARTER BARS TO BE USED TO TIE INTO EXISTING PAVING.

FOOTPATH DETAIL
REFER IDM SD 205
NOT TO SCALE

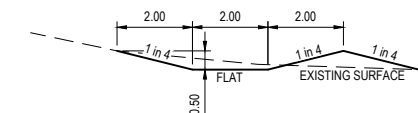

A-A RESERVE WESTERN
EASEMENT SWALE CROSS
SECTION
NOT TO SCALE

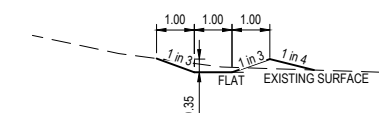

B-B RESERVE SOUTHERN
EASEMENT SWALE CROSS
SECTION
NOT TO SCALE

ADVERTISED PLAN

This copied document to be made available for the sole purpose of enabling its consideration and review as part of a planning process under the Planning and Environment Act 1987. The document must not be used for any purpose which may breach any copyright

PRELIMINARY PRINT
NOT FOR CONSTRUCTION

© COPYRIGHT All rights reserved
Beveridge Williams & Co. Pty Ltd has granted a licence to the principle to use this document for its intended purpose.
No unauthorised copying is permitted

REV	DESCRIPTION	DATE	DRN.	APP.	REV	DESCRIPTION	DATE	DRN.	APP.
P4	MAJOR AMENDMENTS TO 34 UNITS	29.05.25	JS	MJ					
P3	CARPARKS ADDED TO COMMON PROPERTY	14.02.25	JS	MJ					
P2	LOT LAYOUT AMENDED	05.02.25	JS	MJ					
P1	COMMON PROPERTY AMENDED	18.12.24	JS	MJ	P6	MINOR CHANGES	18.07.25	JS	MJ
P0	ISSUED FOR INFORMATION	15.08.24	JS	MJ	P5	LOT LEVEL AMENDMENT AND KERB ADDED TO SEBASTOPOL RD	04.07.25	JS	MJ

Designed J.SPARK
Date 15.08.2024
Drawn J.SPARK
Checked M.JOHNSON
Date 08.11.2024
Approved M.JOHNSON
Reg. No. PE0005575
Date 08.11.2024
PS Number

BW Beveridge Williams
Development & Infrastructure Consultants
SUITE 3, 180 ELEANOR DRIVE
LUCAS VIC 3350
ph: 03 5327 2000
www.beveridgewilliams.com.au

Project Details
7 SEBASTOPOL ROAD, MARYBOROUGH
FUNCTIONAL LAYOUT PLANS
CENTRAL GOLDFIELDS SHIRE COUNCIL
Drawing Title
TYPICAL ROAD CROSS SECTIONS
& DETAILS

Sheet 02 of 07

Scale AS SHOWN

Project Ref 2401300
Stage No 00
Drawing No 901
Rev P6

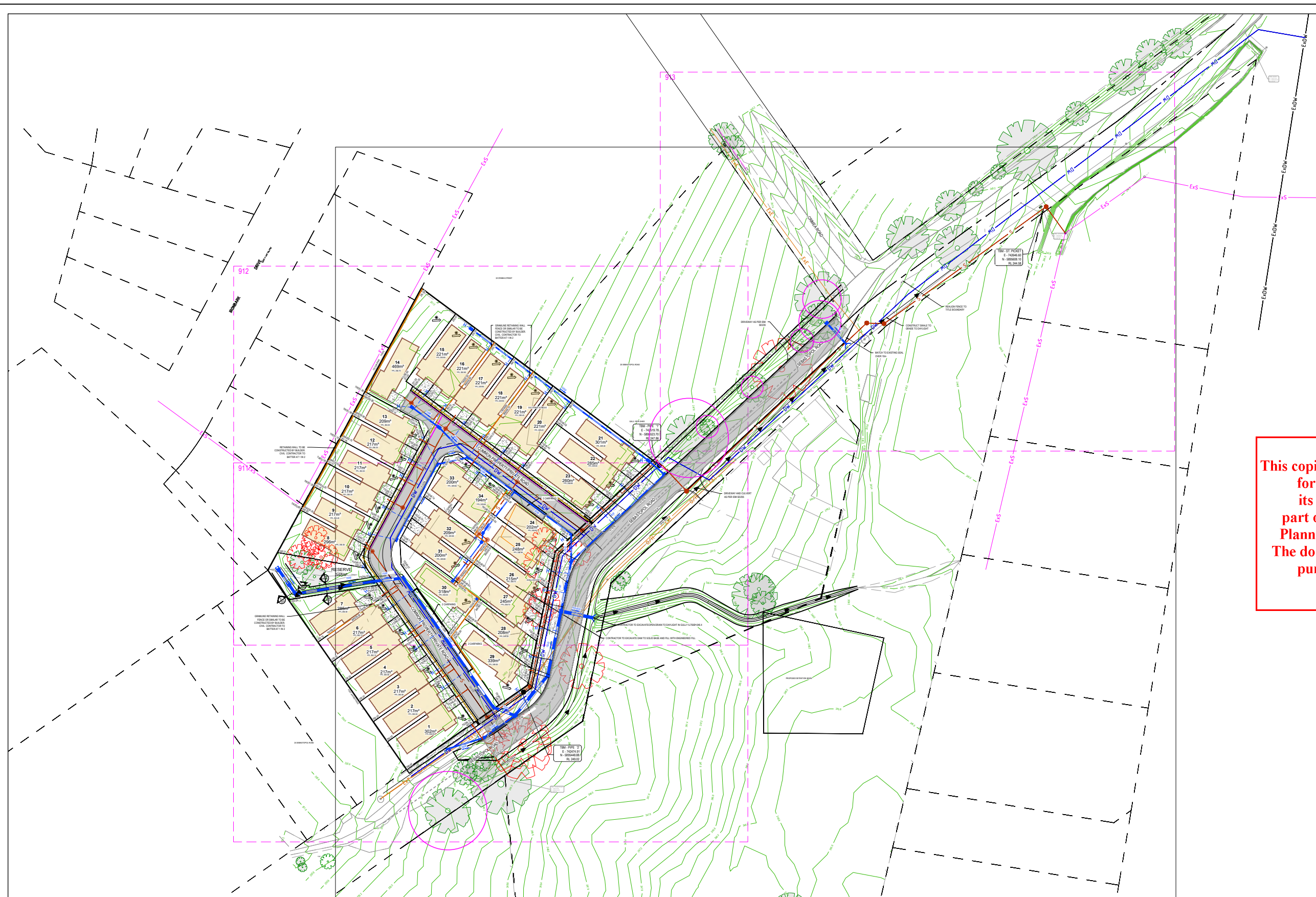

- LEGEND - FUNCTIONAL LAYOUT PLAN**
- ELECTRICITY (UNDERGROUND)
 - OPTIC FIBRE
 - TELECOMMUNICATION
 - GAS
 - DW WATER
 - NDW RECYCLED WATER
 - S D STORMWATER DRAIN, PIT & PROPERTY INLET
 - M D MELBOURNE WATER DRAIN & PIT
 - SW D SWALE DRAIN
 - S S SEWER & MAINTENANCE STRUCTURES
 - H H HOUSE DRAIN
 - S C SERVICE CONDUITS
 - T P TACTILE PAVERS (INDICATIVE ONLY)
 - Ex E EXISTING ELECTRICITY (UNDERGROUND)
 - OH E EXISTING ELECTRICITY (OVERHEAD)
 - Ex G EXISTING GAS
 - Ex T EXISTING TELECOMMUNICATION
 - Ex DW EXISTING WATER
 - Ex NDW EXISTING RECYCLED WATER
 - Ex S D EXISTING STORMWATER DRAIN
 - Ex S EXISTING SEWER
 - Ex H EXISTING HOUSE DRAIN
 - Ex SW D EXISTING SWALE DRAIN
 - Z L ZERO LOT LINES
 - P T PAVEMENT TREATMENT
 - D F DIRECTION OF FALL
 - O F OVERLAND FLOW
 - A G ALLOTMENT TO BE GRADED EVENLY IN DIRECTION OF FALL TO LEVELS INDICATED
 - C E CONCRETE EDGE STRIP WITH SUBSOIL DRAIN
 - "NO ROAD" SIGN & BARRIER
 - L O W LIMIT OF WORKS
 - E T EXISTING TREE TO BE REMOVED
 - E R EXISTING TREE TO BE RETAINED
 - R L RIDGE LINE
 - R W RETAINING WALL
 - T P Z TREE PROTECTION ZONE (TPZ)

This copied document to be made available for the sole purpose of enabling its consideration and review as part of a planning process under the Planning and Environment Act 1987. The document must not be used for any purpose which may breach any copyright

SERVICE OFFSET TABLE

Location	Gas		ND - Water		Water		Electricity		Telecommunication		Sewer	
	Side	Offset (m)	Side	Offset (m)	Side	Offset (m)	Side	Offset (m)	Side	Offset (m)	Side	Offset (m)
SEBASTOPOL ROAD	NA	NA	NA	NA	N	2.7	VARIES	VARIES	VARIES	VARIES	N	1.0
CRIMEA ROAD	NA	NA	NA	NA	W	2.36	W	1.7	NA	NA	NA	NA
COMMON PROPERTY	NA	NA	NA	NA	VARIES	3.1	VARIES	1.25	VARIES	0.75	VARIES	5.35

NOTE: STREET TREES ARE TO BE PLANTED IN THE CENTRE OF ALL NATURE STRIPS

ADVERTISED PLAN

WARNING
BWARE OF UNDERGROUND SERVICES
The locations of underground services are approximate only and their exact position should be proven on site. No guarantee is given that all existing services are shown. Locate all underground services before commencement of works
BEFORE YOU DIG
www.byda.com.au

PRELIMINARY PRINT
NOT FOR CONSTRUCTION

REV	DESCRIPTION	DATE	DRN.	APP.	REV	DESCRIPTION	DATE	DRN.	APP.	
P4	MAJOR AMENDMENTS TO 34 UNITS	29.05.25	JS	MJ						
P3	CARPARKS ADDED TO COMMON PROPERTY	14.02.25	JS	MJ						
P2	LOT LAYOUT AMENDED	05.02.25	JS	MJ						
P1	COMMON PROPERTY AMENDED	18.12.24	JS	MJ	P6	MINOR CHANGES		18.07.25	JS	MJ
P0	ISSUED FOR INFORMATION	15.08.24	JS	MJ	P5	LOT LEVEL AMENDMENT AND KERB ADDED TO SEBASTOPOL RD		04.07.25	JS	MJ

DESIGNED	DATE	DRAWN	CHECKED	DATE	APPROVED	DATE
J.SPARK	15.08.2024	J.SPARK	M.JOHNSON	08.11.2024	M.JOHNSON	08.11.2024

BW Beveridge Williams
Development & Infrastructure Consultants
SUITE 3, 180 ELEANOR DRIVE, LUCAS VIC 3350
ph: 03 5327 2000
www.beveridgewilliams.com.au

Project Details
7 SEBASTOPOL ROAD, MARYBOROUGH
FUNCTIONAL LAYOUT PLANS
CENTRAL GOLDFIELDS SHIRE COUNCIL

Drawing Title
FUNCTIONAL LAYOUT PLAN
SHEET 1 OF 4

Sheet **03 of 07**

Scale **NOT TO SCALE**

Project Ref: **2401300** Stage No: **00** Drawing No: **910** Rev: **P6**

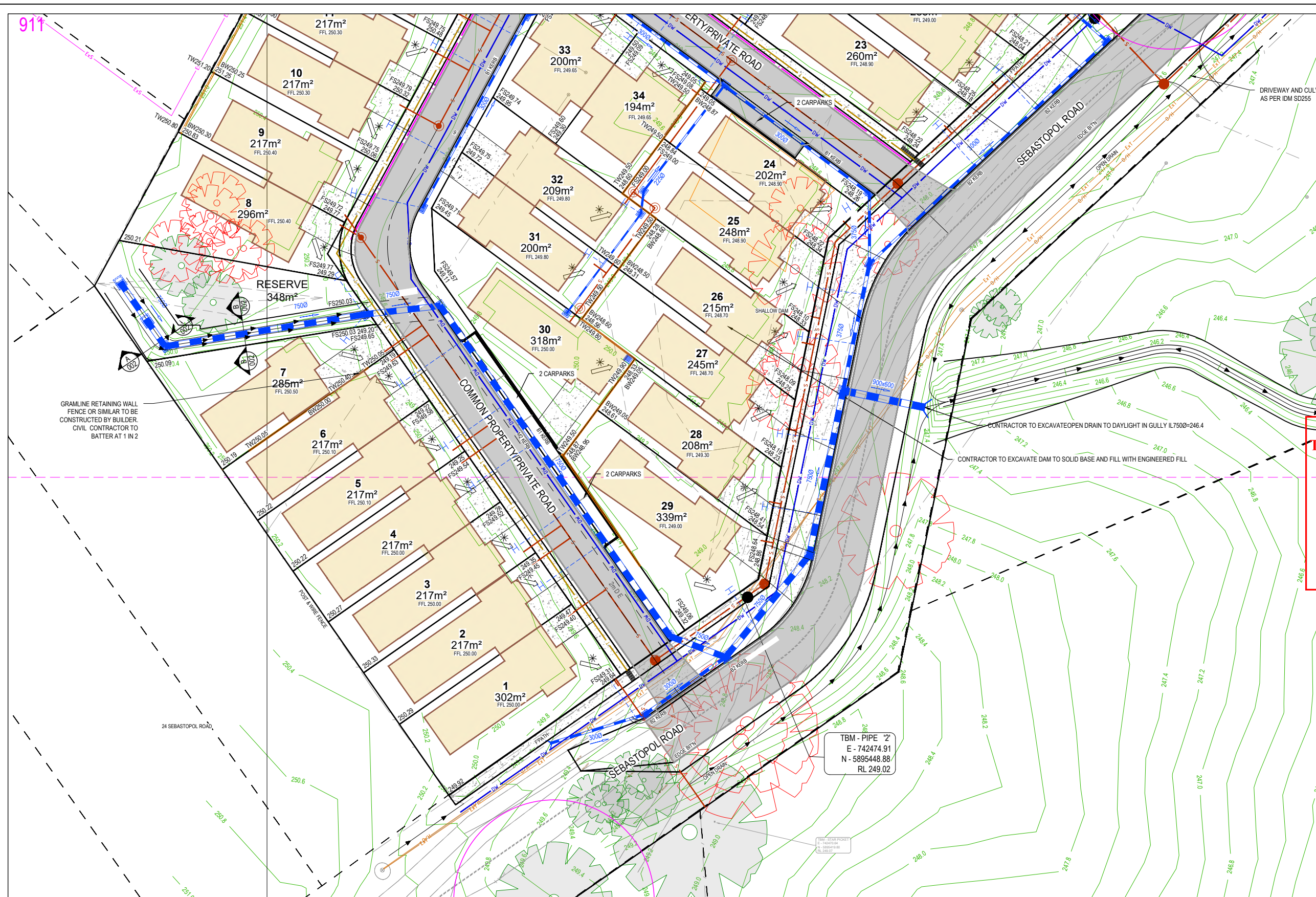

- LEGEND - FUNCTIONAL LAYOUT PLAN**
- ELECTRICITY (UNDERGROUND)
 - OPTIC FIBRE
 - TELECOMMUNICATION
 - GAS
 - WATER
 - RECYCLED WATER
 - STORMWATER DRAIN, PIT & PROPERTY INLET
 - MELBOURNE WATER DRAIN & PIT
 - SWALE DRAIN
 - SEWER & MAINTENANCE STRUCTURES
 - HOUSE DRAIN
 - SERVICE CONDUITS
 - TACTILE PAVERS (INDICATIVE ONLY)
 - EXISTING ELECTRICITY (UNDERGROUND)
 - EXISTING ELECTRICITY (OVERHEAD)
 - EXISTING GAS
 - EXISTING TELECOMMUNICATION
 - EXISTING WATER
 - EXISTING RECYCLED WATER
 - EXISTING STORMWATER DRAIN
 - EXISTING SEWER
 - EXISTING HOUSE DRAIN
 - EXISTING SWALE DRAIN
 - ZERO LOT LINES
 - PAVEMENT TREATMENT
 - DIRECTION OF FALL
 - * OVERLAND FLOW
 - * ALLOTMENT TO BE GRADED EVENLY IN DIRECTION OF FALL TO LEVELS INDICATED
 - CONCRETE EDGE STRIP WITH SUBSOIL DRAIN, "NO ROAD" SIGN & BARRIER
 - LIMIT OF WORKS
 - ⊗ EXISTING TREE TO BE REMOVED
 - ⊗ EXISTING TREE TO BE RETAINED
 - RIDGE LINE
 - RETAINING WALL
 - TREE PROTECTION ZONE (TPZ)

This copied document to be made available for the sole purpose of enabling its consideration and review as part of a planning process under the Planning and Environment Act 1987. The document must not be used for any purpose which may breach any copyright

GRAMLINE RETAINING WALL FENCE OR SIMILAR TO BE CONSTRUCTED BY BUILDER. CIVIL CONTRACTOR TO BATTER AT 1 IN 2

CONTRACTOR TO EXCAVATE OPEN DRAIN TO DAYLIGHT IN GULLY IL7500=246.4
 CONTRACTOR TO EXCAVATE DAM TO SOLID BASE AND FILL WITH ENGINEERED FILL

TBM - PIPE '2'
 E - 742474.91
 N - 5895448.88
 RL 249.02

SERVICE OFFSET TABLE

Location	Gas		ND - Water		Water		Electricity		Telecommunication		Sewer	
	Side	Offset (m)	Side	Offset (m)	Side	Offset (m)	Side	Offset (m)	Side	Offset (m)	Side	Offset (m)
SEBASTOPOL ROAD	NA	NA	NA	NA	N	2.7	VARIABLES	VARIABLES	VARIABLES	VARIABLES	N	1.0
CRIMEA ROAD	NA	NA	NA	NA	W	2.36	W	1.7	NA	NA	NA	NA
COMMON PROPERTY	NA	NA	NA	NA	VARIABLES	3.1	VARIABLES	1.25	VARIABLES	0.75	VARIABLES	5.35

NOTE: STREET TREES ARE TO BE PLANTED IN THE CENTRE OF ALL NATURE STRIPS

ADVERTISED PLAN

WARNING
 BEWARE OF UNDERGROUND SERVICES

The locations of underground services are approximate only and their exact position should be proven on site. No guarantee is given that all existing services are shown. Locate all underground services before commencement of works

BEFORE YOU DIG

www.byda.com.au

PRELIMINARY PRINT
 NOT FOR CONSTRUCTION

REV	DESCRIPTION	DATE	DRN.	APP.	REV	DESCRIPTION	DATE	DRN.	APP.
P4	MAJOR AMENDMENTS TO 34 UNITS	29.05.25	JS	MJ					
P3	CARPARKS ADDED TO COMMON PROPERTY	14.02.25	JS	MJ					
P2	LOT LAYOUT AMENDED	05.02.25	JS	MJ					
P1	COMMON PROPERTY AMENDED	18.12.24	JS	MJ	P6	MINOR CHANGES	18.07.25	JS	MJ
P0	ISSUED FOR INFORMATION	15.08.24	JS	MJ	P5	LOT LEVEL AMENDMENT AND KERB ADDED TO SEBASTOPOL RD	04.07.25	JS	MJ

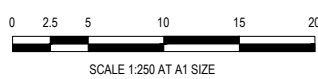

Designed: J.SPARK
 Date: 15.08.2024
 Drawn: J.SPARK
 Checked: M.JOHNSON
 Date: 08.11.2024
 Approved: M.JOHNSON
 Reg. No.: PE000575
 Date: 08.11.2024
 PS Number:

BW Beveridge Williams
 Development & Infrastructure Consultants
 SUITE 3, 180 ELEANOR DRIVE
 LUCAS VIC 3350
 ph: 03 5327 2000
 www.beveridgewilliams.com.au

Project Details
 7 SEBASTOPOL ROAD, MARYBOROUGH
 FUNCTIONAL LAYOUT PLANS
 CENTRAL GOLDFIELDS SHIRE COUNCIL

Project Ref: 2401300
 Stage No: 00
 Drawing No: 911
 Rev: P6

Sheet 04 of 07
 Scale 1:250 @ A1
 Project Ref: 2401300
 Stage No: 00
 Drawing No: 911
 Rev: P6

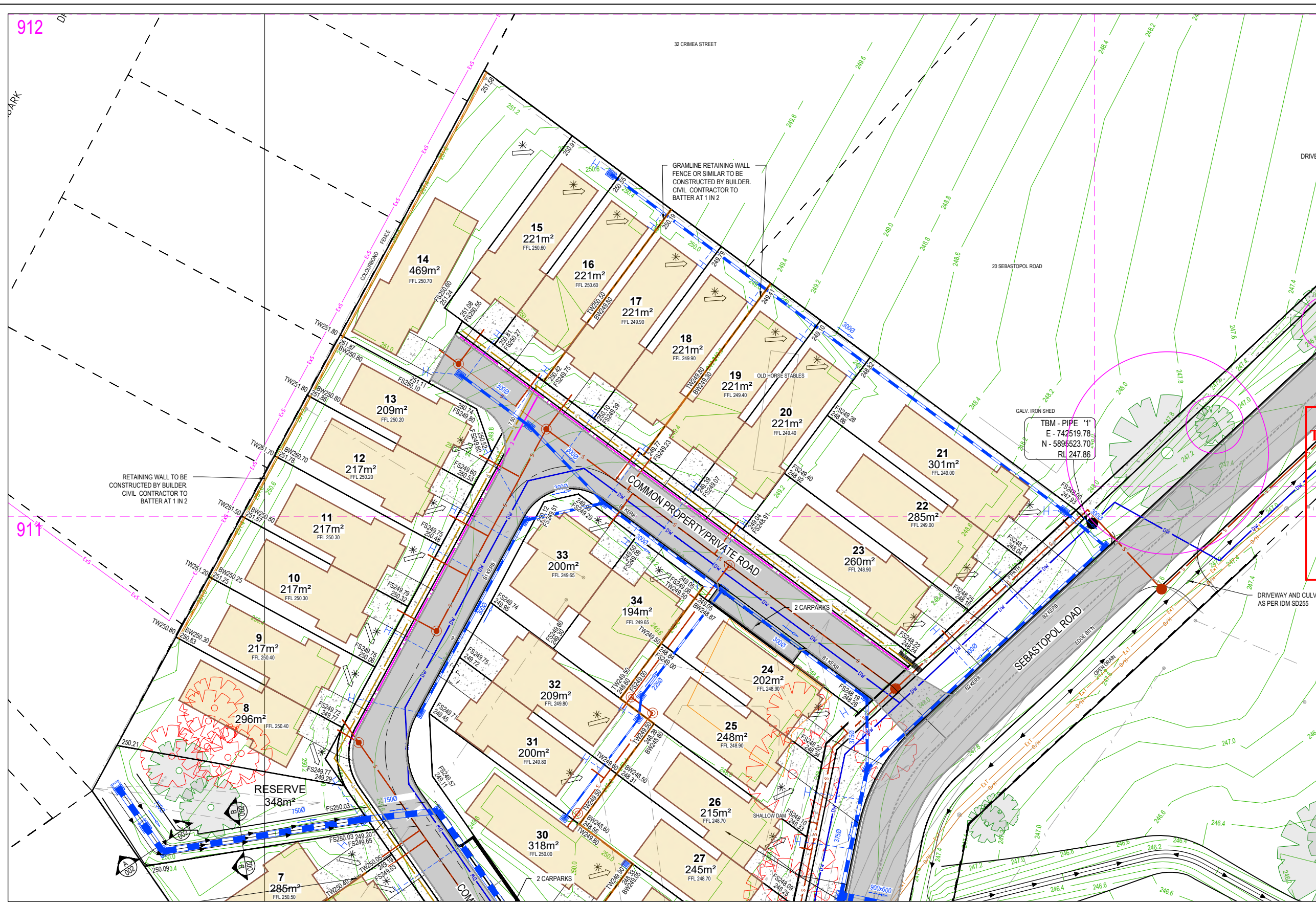

- LEGEND - FUNCTIONAL LAYOUT PLAN**
- E — ELECTRICITY (UNDERGROUND)
 - OF — OPTIC FIBRE
 - T — TELECOMMUNICATION
 - G — GAS
 - W — WATER
 - RW — RECYCLED WATER
 - SD — STORMWATER DRAIN, PIT & PROPERTY INLET
 - MWD — MELBOURNE WATER DRAIN & PIT
 - SWD — SWALE DRAIN
 - S — SEWER & MAINTENANCE STRUCTURES
 - HD — HOUSE DRAIN
 - SC — SERVICE CONDUITS
 - TP — TACTILE PAVERS (INDICATIVE ONLY)
 - Ex E — EXISTING ELECTRICITY (UNDERGROUND)
 - OH E — EXISTING ELECTRICITY (OVERHEAD)
 - Ex G — EXISTING GAS
 - Ex T — EXISTING TELECOMMUNICATION
 - Ex W — EXISTING WATER
 - Ex RW — EXISTING RECYCLED WATER
 - Ex SD — EXISTING STORMWATER DRAIN
 - Ex S — EXISTING SEWER
 - Ex HD — EXISTING HOUSE DRAIN
 - Ex SWD — EXISTING SWALE DRAIN
 - Z — ZERO LOT LINES
 - P — PAVEMENT TREATMENT
 - D — DIRECTION OF FALL
 - OF — OVERLAND FLOW
 - G — ALLOTMENT TO BE GRADED EVENLY IN DIRECTION OF FALL TO LEVELS INDICATED
 - C — CONCRETE EDGE STRIP WITH SUBSOIL DRAIN
 - S — "NO ROAD" SIGN & BARRIER
 - L — LIMIT OF WORKS
 - T — EXISTING TREE TO BE REMOVED
 - R — EXISTING TREE TO BE RETAINED
 - RL — RIDGE LINE
 - RW — RETAINING WALL
 - TPZ — TREE PROTECTION ZONE (TPZ)

This copied document to be made available for the sole purpose of enabling its consideration and review as part of a planning process under the Planning and Environment Act 1987. The document must not be used for any purpose which may breach any copyright

SERVICE OFFSET TABLE

Location	Gas		ND - Water		Water		Electricity		Telecommunication		Sewer	
	Side	Offset (m)	Side	Offset (m)	Side	Offset (m)	Side	Offset (m)	Side	Offset (m)	Side	Offset (m)
SEBASTOPOL ROAD	NA	NA	NA	NA	N	2.7	VARIABLES	VARIABLES	VARIABLES	VARIABLES	N	1.0
CRIMEA ROAD	NA	NA	NA	NA	W	2.36	W	1.7	NA	NA	NA	NA
COMMON PROPERTY	NA	NA	NA	NA	VARIABLES	3.1	VARIABLES	1.25	VARIABLES	0.75	VARIABLES	5.35

NOTE: STREET TREES ARE TO BE PLANTED IN THE CENTRE OF ALL NATURE STRIPS

ADVERTISED PLAN

WARNING
BWARE OF UNDERGROUND SERVICES
The locations of underground services are approximate only and their exact position should be proven on site. No guarantee is given that all existing services are shown. Locate all underground services before commencement of works
BEFORE YOU DIG
www.byda.com.au

PRELIMINARY PRINT
NOT FOR CONSTRUCTION

REV	DESCRIPTION	DATE	DRN.	APP.	REV	DESCRIPTION	DATE	DRN.	APP.
P4	MAJOR AMENDMENTS TO 34 UNITS	29.05.25	JS	MJ					
P3	CARPARKS ADDED TO COMMON PROPERTY	14.02.25	JS	MJ					
P2	LOT LAYOUT AMENDED	05.02.25	JS	MJ					
P1	COMMON PROPERTY AMENDED	18.12.24	JS	MJ	P6	MINOR CHANGES	18.07.25	JS	MJ
P0	ISSUED FOR INFORMATION	15.08.24	JS	MJ	P5	LOT LEVEL AMENDMENT AND KERB ADDED TO SEBASTOPOL RD	04.07.25	JS	MJ

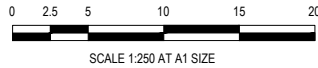

Designed: J.SPARK
Date: 15.08.2024
Drawn: J.SPARK

Checked: M.JOHNSON
Date: 08.11.2024

Approved: M.JOHNSON
Reg. No.: P50005793
Date: 08.11.2024

PS Number:

BW Beveridge Williams
Development & Infrastructure Consultants
SUITE 3, 180 ELEANOR DRIVE
LUCAS VIC 3350
ph: 03 5327 2000
www.beveridgewilliams.com.au

Project Details: 7 SEBASTOPOL ROAD, MARYBOROUGH
FUNCTIONAL LAYOUT PLANS
CENTRAL GOLDFIELDS SHIRE COUNCIL

Drawing Title: FUNCTIONAL LAYOUT PLAN
SHEET 3 OF 4

Sheet 05 of 07

Scale: 1:250 @ A1

Project Ref: 2401300
Stage No: 00
Drawing No: 912
Rev: P6

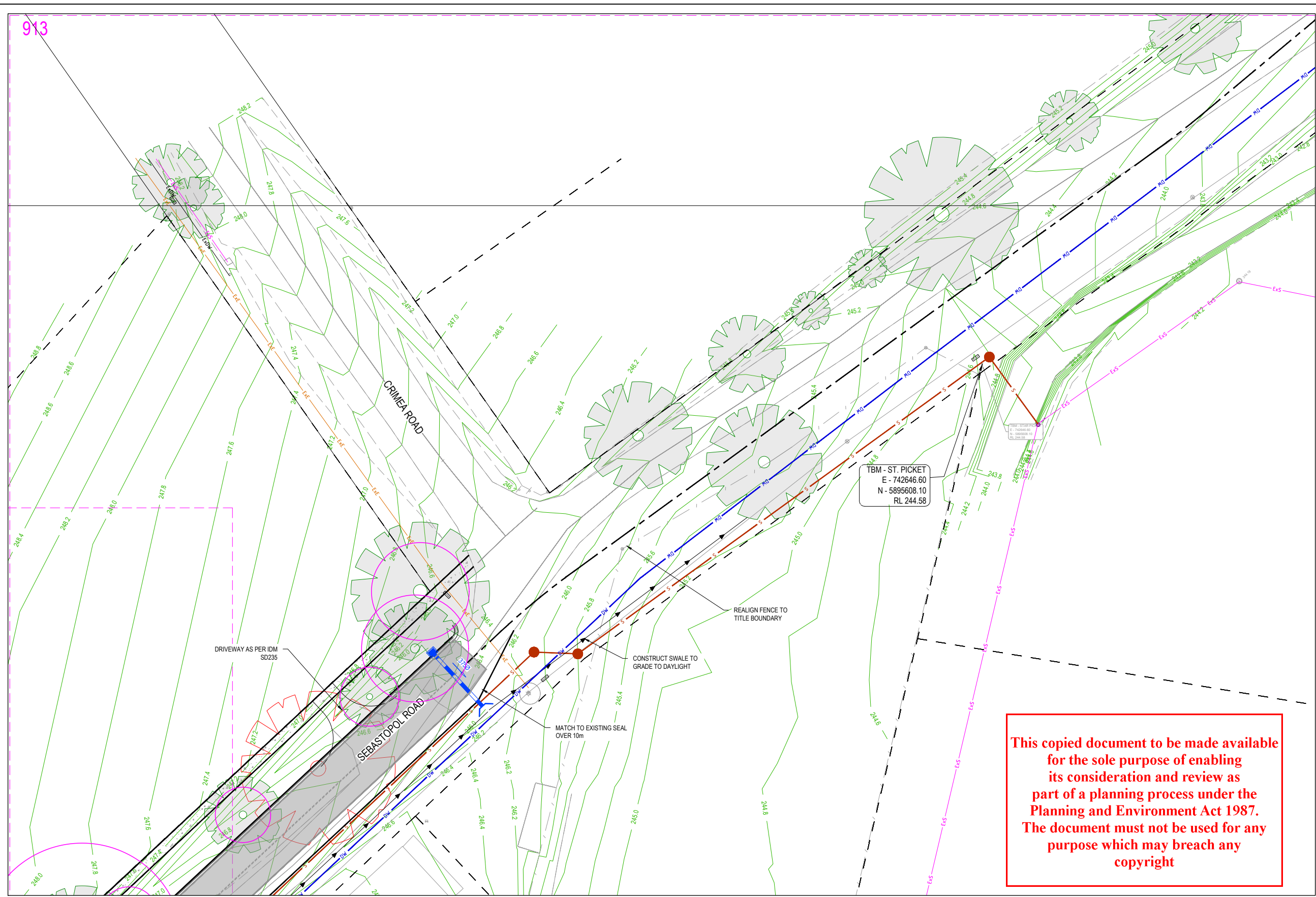

- LEGEND - FUNCTIONAL LAYOUT PLAN**
- E — ELECTRICITY (UNDERGROUND)
 - OF — OPTIC FIBRE
 - T — TELECOMMUNICATION
 - G — GAS
 - DW — WATER
 - NDW — RECYCLED WATER
 - D — STORMWATER DRAIN, PIT & PROPERTY INLET
 - MD — MELBOURNE WATER DRAIN & PIT
 - SW — SWALE DRAIN
 - S — SEWER & MAINTENANCE STRUCTURES
 - H — HOUSE DRAIN
 - GW — SERVICE CONDUITS
 - TP — TACTILE PAVERS (INDICATIVE ONLY)
 - Ex E — EXISTING ELECTRICITY (UNDERGROUND)
 - OH E — EXISTING ELECTRICITY (OVERHEAD)
 - Ex G — EXISTING GAS
 - Ex T — EXISTING TELECOMMUNICATION
 - Ex DW — EXISTING WATER
 - Ex NDW — EXISTING RECYCLED WATER
 - Ex D — EXISTING STORMWATER DRAIN
 - Ex S — EXISTING SEWER
 - Ex H — EXISTING HOUSE DRAIN
 - Ex SW — EXISTING SWALE DRAIN
 - Z — ZERO LOT LINES
 - P — PAVEMENT TREATMENT
 - F — DIRECTION OF FALL
 - OF — ALLOTMENT TO BE GRADED EVENLY IN DIRECTION OF FALL TO LEVELS INDICATED
 - C — CONCRETE EDGE STRIP WITH SUBSOIL DRAIN
 - S — "NO ROAD" SIGN & BARRIER
 - L — LIMIT OF WORKS
 - T — EXISTING TREE TO BE REMOVED
 - R — EXISTING TREE TO BE RETAINED
 - RL — RIDGE LINE
 - RW — RETAINING WALL
 - TPZ — TREE PROTECTION ZONE (TPZ)

This copied document to be made available for the sole purpose of enabling its consideration and review as part of a planning process under the Planning and Environment Act 1987. The document must not be used for any purpose which may breach any copyright

SERVICE OFFSET TABLE

Location	Gas		ND - Water		Water		Electricity		Telecommunication		Sewer	
	Side	Offset (m)	Side	Offset (m)	Side	Offset (m)	Side	Offset (m)	Side	Offset (m)	Side	Offset (m)
SEBASTOPOL ROAD	NA	NA	NA	NA	N	2.7	VARIES	VARIES	VARIES	VARIES	N	1.0
CRIMEA ROAD	NA	NA	NA	NA	W	2.36	W	1.7	NA	NA	NA	NA
COMMON PROPERTY	NA	NA	NA	NA	VARIES	3.1	VARIES	1.25	VARIES	0.75	VARIES	5.35

NOTE: STREET TREES ARE TO BE PLANTED IN THE CENTRE OF ALL NATURE STRIPS

ADVERTISED PLAN

WARNING
BWARE OF UNDERGROUND SERVICES
The locations of underground services are approximate only and their exact position should be proven on site. No guarantee is given that all existing services are shown. Locate all underground services before commencement of works
BEFORE YOU DIG
www.byda.com.au

PRELIMINARY PRINT
NOT FOR CONSTRUCTION

REV	DESCRIPTION	DATE	DRN.	APP.	REV	DESCRIPTION	DATE	DRN.	APP.
P4	MAJOR AMENDMENTS TO 34 UNITS	29.05.25	JS	MJ					
P3	CARPARKS ADDED TO COMMON PROPERTY	14.02.25	JS	MJ					
P2	LOT LAYOUT AMENDED	05.02.25	JS	MJ					
P1	COMMON PROPERTY AMENDED	18.12.24	JS	MJ	P6	MINOR CHANGES	18.07.25	JS	MJ
P0	ISSUED FOR INFORMATION	15.08.24	JS	MJ	P5	LOT LEVEL AMENDMENT AND KERB ADDED TO SEBASTOPOL RD	04.07.25	JS	MJ

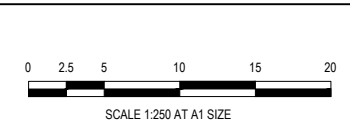

Designed: J.SPARK
Date: 15.08.2024
Drawn: J.SPARK
Checked: M.JOHNSON
Date: 08.11.2024
Approved: M.JOHNSON
Reg. No. PE000575
Date: 08.11.2024
PS Number: [blank]

BW Beveridge Williams
Development & Infrastructure Consultants
SUITE 3, 180 ELEANOR DRIVE
LUCAS VIC 3350
ph: 03 5327 2000
www.beveridgewilliams.com.au

Project Details: 7 SEBASTOPOL ROAD, MARYBOROUGH
FUNCTIONAL LAYOUT PLANS
CENTRAL GOLDFIELDS SHIRE COUNCIL

Project Title: FUNCTIONAL LAYOUT PLAN
SHEET 4 OF 4

Sheet 06 of 07
Scale: 1:250 @ A1

Project Ref: 2401300
Stage No: 00
Drawing No: 913
Rev: P6

X:\2401300 - 7 Sebastopol Rd, Eng, General Drawings\2401300-00-913-FLP.dwg

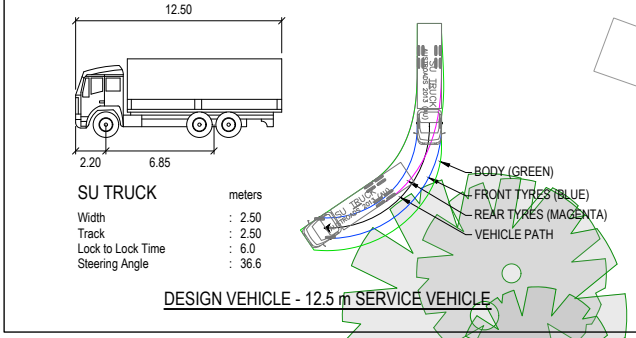
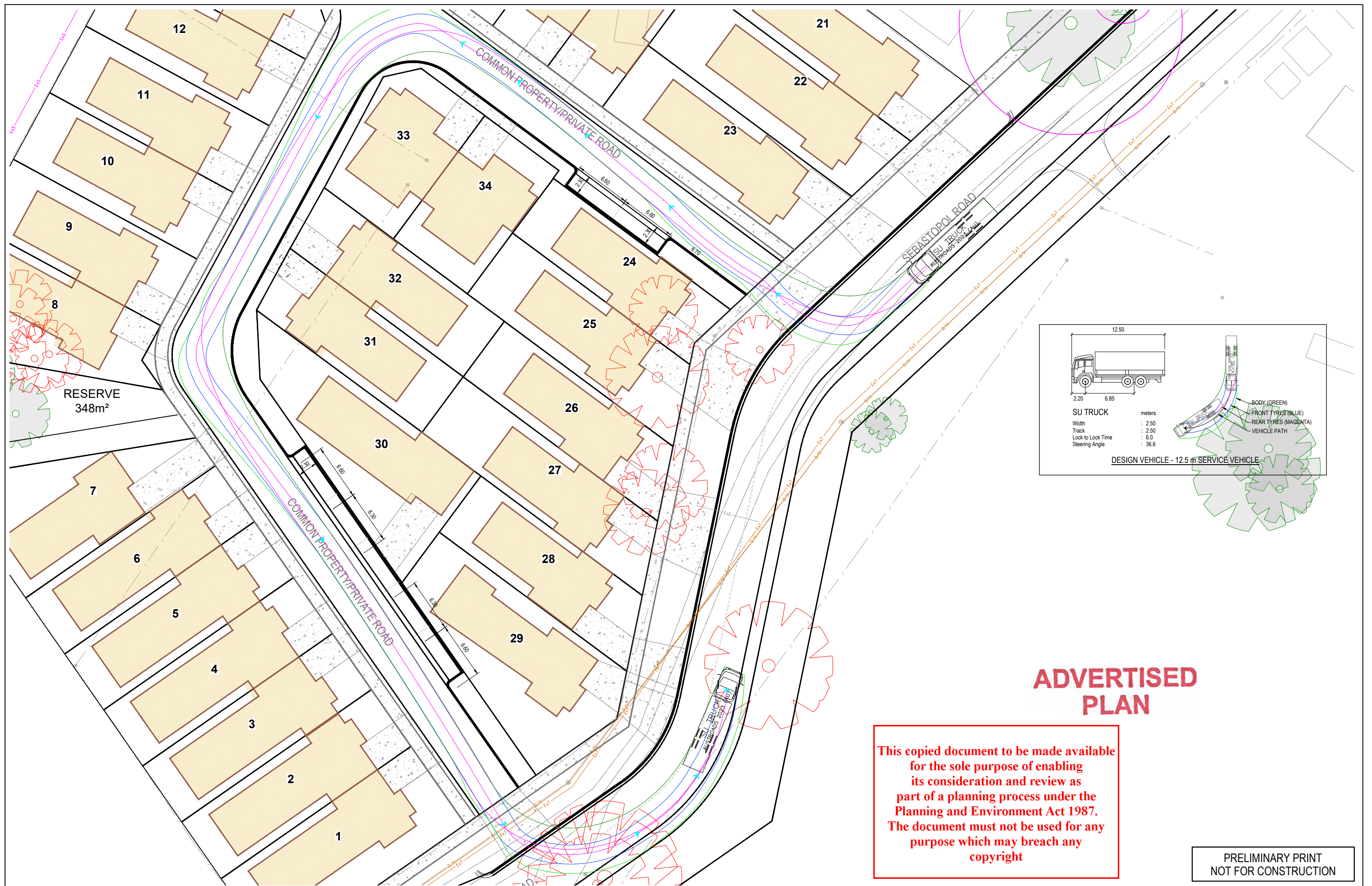

REV	DESCRIPTION	DATE	DRN.	APP.	REV	DESCRIPTION	DATE	DRN.	APP.
P4	MAJOR AMENDMENTS TO 34 UNITS	29.05.25	JS	MJ					
P3	CARPARKS ADDED TO COMMON PROPERTY	14.02.25	JS	MJ					
P2	LOT LAYOUT AMENDED	05.02.25	JS	MJ					
P1	COMMON PROPERTY AMENDED	18.12.24	JS	MJ	P6	MINOR CHANGES	18.07.25	JS	MJ
P0	ISSUED FOR INFORMATION	15.08.24	JS	MJ	P5	LOT LEVEL AMENDMENT AND KERB ADDED TO SEBASTOPOL RD	04.07.25	JS	MJ



Designed J.SPARK
Date 15.08.2024
Drawn J.SPARK
Checked M.JOHNSON
Date 08.11.2024
Approved M.JOHNSON
Reg. No. P63005793
Date 08.11.2024
PS Number

BW Beveridge Williams
Development & Infrastructure Consultants
SUITE 3, 180 ELEANOR DRIVE
LUCAS VIC 3350
ph: 03 5327 2000
www.beveridgewilliams.com.au

Project Details
7 SEBASTOPOL ROAD, MARYBOROUGH
FUNCTIONAL LAYOUT PLANS
CENTRAL GOLDFIELDS SHIRE COUNCIL
Drawing Title
TURNING MOVEMENT PLAN
SHEET 1 OF 1

Sheet 07 of 07
Scale 1:200 @ A1
Project Ref 2401300 Stage No 00 Drawing No 940 Rev P6

PRELIMINARY PRINT
NOT FOR CONSTRUCTION

