

# PLAN OF CONSOLIDATION

EDITION 1

## PC 379469S

### LOCATION OF LAND

COUNTY OF BOURKE

PARISH: DOUTTA GALLA

SECTION: 6

CROWN ALLOTMENT: A (PART)

TITLE REFERENCE: VOL.1828 FOL.495, VOL.5972 FOL.289, VOL.6037 FOL.211,  
VOL.8161 FOL.843, VOL.9300 FOL.665, VOL.9677 FOL.204,  
VOL.10091 FOL.826, VOL.10370 FOL.459, VOL.10438 FOL.701 &  
VOL.11639 FOL.478

LAST PLAN REFERENCE: TP554090S, TP663534X, TP370851S, & LOT 1 ON TP856847A  
LOT 15 ON LP1075, TP173354G, TP644293B, TP457177V,  
LOT A ON TP10481M, TP13398G & TP958764L

POSTAL ADDRESS: 2 LESLIE ROAD,  
(at time of subdivision) ESSENDON, 3040

MGA CO-ORDINATES: E: 316 260 ZONE: 55  
(of approx centre of land N: 5 819 060 GDA 94  
in plan)

COUNCIL NAME: MOONEE VALLEY CITY COUNCIL

### NOTATIONS

Depth Limitation: Does Not Apply.

Survey:- This plan is not based on survey.

### Easement Information

Legend: A - Appurtenant Easement E - Encumbering Easement R - Encumbering Easement (Road)

Easement Reference	Purpose	Width (Metres)	Origin	Land Benefited/In Favour Of
E-1	SEWERAGE	1.53	INSTR. L732661X	CITY OF ESSENDON
E-1	AS PROVIDED FOR IN SECTION 528(2)(E) OF THE LOCAL GOVERNMENT ACT 1958	1.53	SECTION 528(2)(E) OF THE LOCAL GOVERNMENT ACT 1958	M.M.B.W.
E-2	SEWERAGE	SEE PLAN	INSTR. K847785G	CITY OF ESSENDON
E-2	AS PROVIDED FOR IN SECTION 528(2)(E) OF THE LOCAL GOVERNMENT ACT 1958	SEE PLAN	SECTION 528(2)(E) OF THE LOCAL GOVERNMENT ACT 1958	M.M.B.W.
E-3	GAS & FUEL	SEE PLAN	TP457177V	GAS & FUEL CORPORAION

SEE SHEET 2 FOR DETAIL OF PLAN

BUCKLEY STREET

LORRAINE STREET

LESLIE STREET

STANLEY STREET

1.641ha

96°31'  
181.05

7°45'  
55.32

39.62  
276°31'

(1.53)  
E-1  
96°31'  
1.39

7°45'  
15.24

1.53  
E-2  
276°31'

34.22  
43.82

7°45'

63°19'30"  
A11.99  
C10.79  
R7.62  
E-3  
108°25'  
4.79  
108°20'30"  
22.59

1.16  
1.44 6.99  
275°28'20" 277°48'  
3.67  
187°45'

276°03'

96.67

131.34

STANLEY STREET

100.18  
187°50'20"



DRAFT

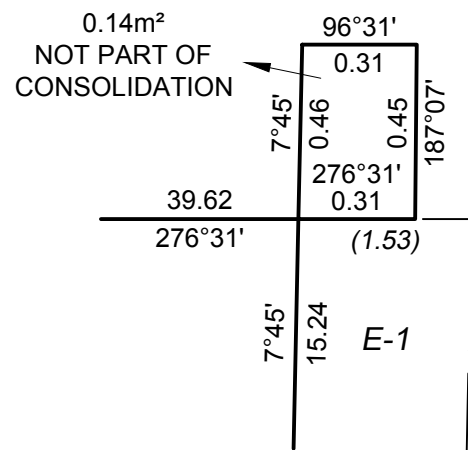

SEE  
ENLARGEMENT