

**REGISTER SEARCH STATEMENT (Title Search) Transfer of
Land Act 1958**

VOLUME 10139 FOLIO 037

Security no : 124095705134J
Produced 23/02/2022 12:28 PM

CROWN GRANT

LAND DESCRIPTION

Crown Allotment 13 Section 25 Parish of Holden.

REGISTERED PROPRIETOR

Estate Fee Simple
Sole Proprietor

MINISTER FOR PLANNING of LEVEL 7 1 SPRING STREET MELBOURNE VIC 3000
AR762719B 14/12/2018

**This copied document to be made available
for the sole purpose of enabling
its consideration and review as
part of a planning process under the
Planning and Environment Act 1987.
The document must not be used for any
purpose which may breach any
copyright**

ENCUMBRANCES, CAVEATS AND NOTICES

Any crown grant reservations exceptions conditions limitations and powers noted on the plan or imaged folio set out under DIAGRAM LOCATION below. For details of any other encumbrances see the plan or imaged folio set out under DIAGRAM LOCATION below.

DIAGRAM LOCATION

SEE TP305367R FOR FURTHER DETAILS AND BOUNDARIES

ACTIVITY IN THE LAST 125 DAYS

NIL

-----END OF REGISTER SEARCH STATEMENT-----

Additional information: (not part of the Register Search Statement)

**ADVERTISED
PLAN**

ADMINISTRATIVE NOTICES

AR732129T NOMINATION TO PAPER INST. 06/12/2018
eCT Nominated to Transfer TO Minister for Planning

eCT Control 21290S DEPARTMENT OF JUSTICE AND COMMUNITY SAFETY
Effective from 14/12/2018

DOCUMENT END

TITLE PLAN	EDITION 1	TP 305367R
------------	-----------	------------

Location of Land

Parish: HOLDEN
 Township:
 Section: 25
 Crown Allotment: 13
 Crown Portion:

Last Plan Reference:
 Derived From: VOL 10139 FOL 037
 Depth Limitation: 15 m

Notations
 SUBJECT TO THE RESERVATIONS EXCEPTIONS CONDITIONS AND POWERS CONTAINED IN CROWN GRANT VOL. 10139 FOL. 037 AND NOTED ON SHEET 2 OF THIS PLAN

ANY REFERENCE TO MAP IN THE TEXT MEANS THE DIAGRAM SHOWN ON THIS TITLE PLAN

ADVERTISED PLAN

Description of Land / Easement Information

THIS PLAN HAS BEEN PREPARED FOR THE LAND REGISTRY, LAND VICTORIA, FOR TITLE DIAGRAM PURPOSES AS PART OF THE LAND TITLES AUTOMATION PROJECT

COMPILED: 04/02/2000
 VERIFIED: AA

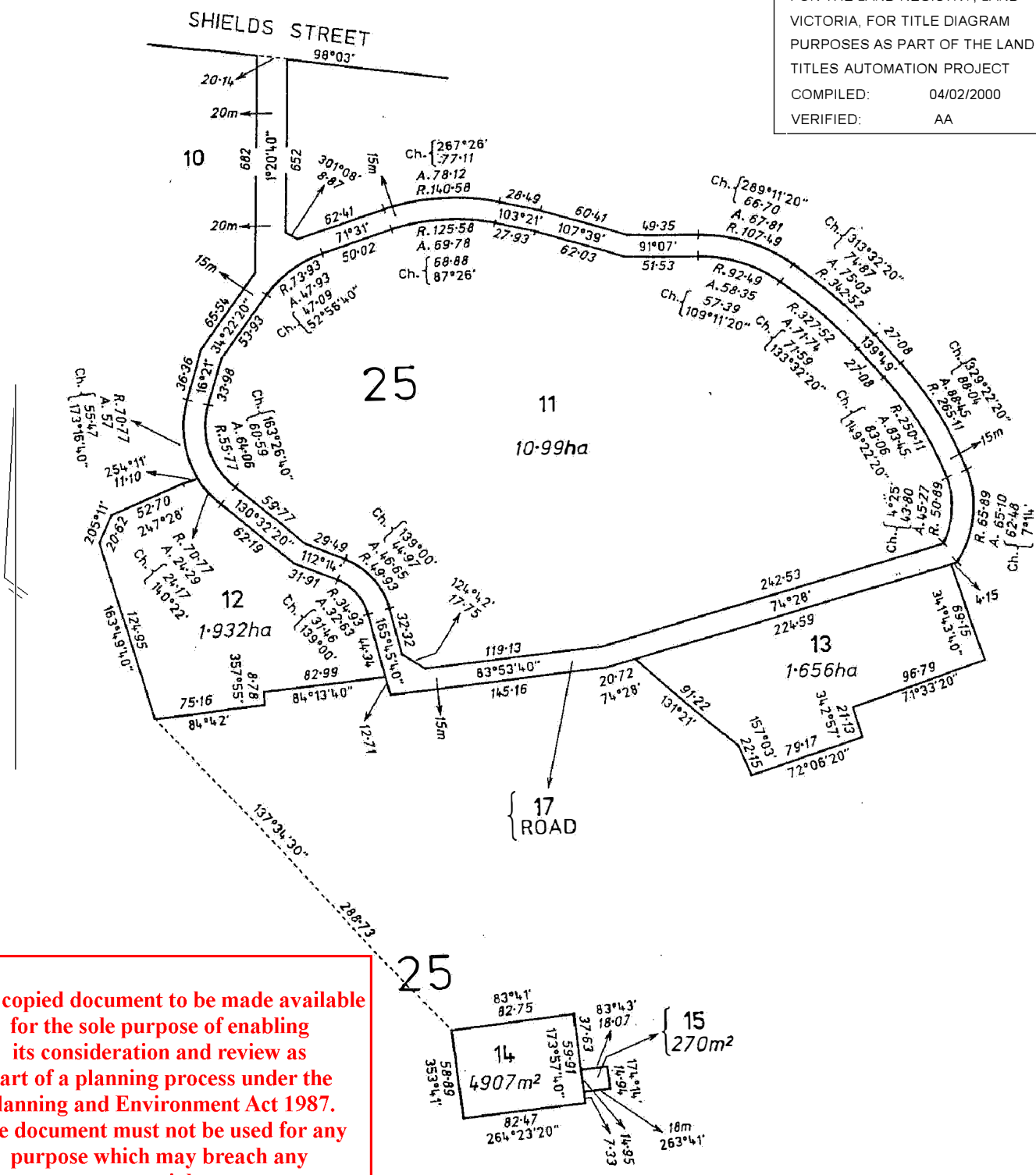

This copied document to be made available for the sole purpose of enabling its consideration and review as part of a planning process under the Planning and Environment Act 1987. The document must not be used for any purpose which may breach any copyright

TITLE PLAN

TP 305367R

LAND DESCRIPTION INCLUDING RESERVATIONS EXCEPTIONS
 CONDITIONS AND POWERS SHOWN ON THE CROWN GRANT

all that piece of land in the said State being Allotment THIRTEEN of Section TWENTY-FIVE in the PARISH OF HOLDEN County of Bourke and being the land shown enclosed by continuous lines in the map and identified by that allotment number

PROVIDED that this Grant is made subject to -

(a) the reservation to Us Our heirs and successors of -

(i) any minerals within the meaning of the *Mineral Resources Development Act 1990* and petroleum within the meaning of the *Petroleum Act 1958* (hereinafter called "the reserved minerals");

(ii) rights of access for the purpose of searching for and obtaining the reserved minerals in any part of the said land;

(iii) rights for access and for pipe-lines works and other purposes necessary for obtaining and conveying on and from the said land any of the reserved minerals which is obtained in any part of the said land;

(b) the right to resume the said land for mining purposes pursuant to section 205 of the *Land Act 1958*;

(c) the right of any person being a licensee under the *Mineral Resources Development Act 1990* or any corresponding previous enactment to enter on the said land and to do work within the meaning of that Act and to erect and occupy mining plant or machinery thereon in the same manner and under the same conditions and provisions as those under which such a person has now the right to do such work in and upon Crown lands provided that compensation as prescribed by Part 8 of that Act is paid for surface damage to be done to the said land by reason of doing such work on it.

**ADVERTISED
 PLAN**

This copied document to be made available for the sole purpose of enabling its consideration and review as part of a planning process under the Planning and Environment Act 1987. The document must not be used for any purpose which may breach any copyright