

REGISTER SEARCH STATEMENT (Title Search) Transfer of Land Act 1958

Page 1 of 1

VOLUME 02069 FOLIO 790

Security no : 124121260396A
Produced 16/01/2025 11:57 AM

LAND DESCRIPTION

Lot 1 on Title Plan 613597E.

PARENT TITLES :

Volume 01169 Folio 782 Volume 01214 Folio 656 Volume 01367 Folio 232
Created by instrument 0228041 22/08/1888

REGISTERED PROPRIETOR

Estate Fee Simple

Sole Proprietor

VICTORIAN RAIL TRACK of LEVEL 8 1010 LA TROBE STREET DOCKLANDS VIC 3008
AN236454H 02/11/2016

ENCUMBRANCES, CAVEATS AND NOTICES

Any encumbrances created by Section 98 Transfer of Land Act 1958 or Section 24 Subdivision Act 1988 and any other encumbrances shown or entered on the plan set out under DIAGRAM LOCATION below.

DIAGRAM LOCATION

SEE TP613597E FOR FURTHER DETAILS AND BOUNDARIES

ACTIVITY IN THE LAST 125 DAYS

NIL

-----END OF REGISTER SEARCH STATEMENT-----

Additional information: (not part of the Register Search Statement)

Street Address: PRINCES HIGHWAY GARVOC VIC 3265

ADMINISTRATIVE NOTICES

NIL

eCT Control 14410A VICTORIAN RAIL TRACK
Effective from 02/11/2016

DOCUMENT END

**This copied document to be made available
for the sole purpose of enabling
its consideration and review as
part of a planning process under the
Planning and Environment Act 1987.
The document must not be used for any
purpose which may breach any
copyright**

**ADVERTISED
PLAN**

Imaged Document Cover Sheet

The document following this cover sheet is an imaged document supplied by LANDATA®, Secure Electronic Registries Victoria.

Document Type	Plan
Document Identification	TP613597E
Number of Pages (excluding this cover sheet)	1
Document Assembled	16/01/2025 11:57

Copyright and disclaimer notice:

© State of Victoria. This publication is copyright. No part may be reproduced by any process except in accordance with the provisions of the Copyright Act 1968 (Cth) and for the purposes of Section 32 of the Sale of Land Act 1962 or pursuant to a written agreement. The information is only valid at the time and in the form obtained from the LANDATA® System. None of the State of Victoria, LANDATA®, Secure Electronic Registries Victoria Pty Ltd (ABN 86 627 986 396) as trustee for the Secure Electronic Registries Victoria Trust (ABN 83 206 746 897) accept responsibility for any subsequent release, publication or reproduction of the information.

The document is invalid if this cover sheet is removed or altered.

**This copied document to be made available
for the sole purpose of enabling
its consideration and review as
part of a planning process under the
Planning and Environment Act 1987.
The document must not be used for any
purpose which may breach any
copyright**

**ADVERTISED
PLAN**

TITLE PLAN		EDITION 1	TP 613597E
<div>Location of Land</div> <div>Parish: GARVOC</div> <div>Township:</div> <div>Section:</div> <div>Crown Allotment: 1(PT)</div> <div>Crown Portion:</div> <div>Last Plan Reference:</div> <div>Derived From: VOL 2069 FOL 790</div> <div>Depth Limitation: NIL</div>		<div>Notations</div> <div>ANY REFERENCE TO MAP IN THE TEXT MEANS THE DIAGRAM SHOWN ON THIS TITLE PLAN</div>	
<div>Description of Land / Easement Information</div> <div>ADVERTISED PLAN</div>		<div>THIS PLAN HAS BEEN PREPARED FOR THE LAND REGISTRY, LAND VICTORIA, FOR TITLE DIAGRAM PURPOSES AS PART OF THE LAND TITLES AUTOMATION PROJECT</div> <div>COMPILED: 25/08/2000</div> <div>VERIFIED: A.D.</div>	
<div></div>			
<div><div>TABLE OF PARCEL IDENTIFIERS</div><div>WARNING: Where multiple parcels are referred to or shown on this Title Plan this does not imply separately disposable parcels under Section 8A of the Sale of Land Act 1962</div><div>PARCEL 1 = CA 1 (PT)</div></div>			
<div>LENGTHS ARE IN LINKS</div>		<div>Metres = 0.3048 x Feet</div> <div>Metres = 0.201168 x Links</div>	<div>Sheet 1 of 1 sheets</div>

REGISTER SEARCH STATEMENT (Title Search) Transfer of Land Act 1958

Page 1 of 1

VOLUME 02683 FOLIO 599

Security no : 124121256524J
Produced 16/01/2025 10:41 AM

LAND DESCRIPTION

Lots 1 and 2 on Title Plan 612899S (formerly known as part of Crown Allotment 8A, part of Crown Allotment 9A Parish of Garvoc).
PARENT TITLE Volume 02059 Folio 695
Created by instrument D519408 01/10/1969

REGISTERED PROPRIETOR

Estate Fee Simple
TENANTS IN COMMON
As to 1 of a total of 2 equal undivided shares
Sole Proprietor
MICHAEL HENRY HOOPER of 305 BARTONS ROAD ALLANSFORD VIC 3277
As to 1 of a total of 2 equal undivided shares
Sole Proprietor
GERALDINE MARGARET HOOPER of 305 BARTONS ROAD ALLANSFORD VIC 3277
AB451299V 30/07/2002

ENCUMBRANCES, CAVEATS AND NOTICES

COVENANT AN040924M 23/08/2016

Any encumbrances created by Section 98 Transfer of Land Act 1958 or Section 24 Subdivision Act 1988 and any other encumbrances shown or entered on the plan set out under DIAGRAM LOCATION below.

DIAGRAM LOCATION

SEE TP612899S FOR FURTHER DETAILS AND BOUNDARIES

ACTIVITY IN THE LAST 125 DAYS

NIL

DOCUMENT END

**This copied document to be made available
for the sole purpose of enabling
its consideration and review as
part of a planning process under the
Planning and Environment Act 1987.
The document must not be used for any
purpose which may breach any
copyright**

**ADVERTISED
PLAN**

Imaged Document Cover Sheet

The document following this cover sheet is an imaged document supplied by LANDATA®, Secure Electronic Registries Victoria.

Document Type	Plan
Document Identification	TP612899S
Number of Pages (excluding this cover sheet)	2
Document Assembled	16/01/2025 10:41

Copyright and disclaimer notice:

© State of Victoria. This publication is copyright. No part may be reproduced by any process except in accordance with the provisions of the Copyright Act 1968 (Cth) and for the purposes of Section 32 of the Sale of Land Act 1962 or pursuant to a written agreement. The information is only valid at the time and in the form obtained from the LANDATA® System. None of the State of Victoria, LANDATA®, Secure Electronic Registries Victoria Pty Ltd (ABN 86 627 986 396) as trustee for the Secure Electronic Registries Victoria Trust (ABN 83 206 746 897) accept responsibility for any subsequent release, publication or reproduction of the information.

The document is invalid if this cover sheet is removed or altered.

**This copied document to be made available
for the sole purpose of enabling
its consideration and review as
part of a planning process under the
Planning and Environment Act 1987.
The document must not be used for any
purpose which may breach any
copyright**

**ADVERTISED
PLAN**

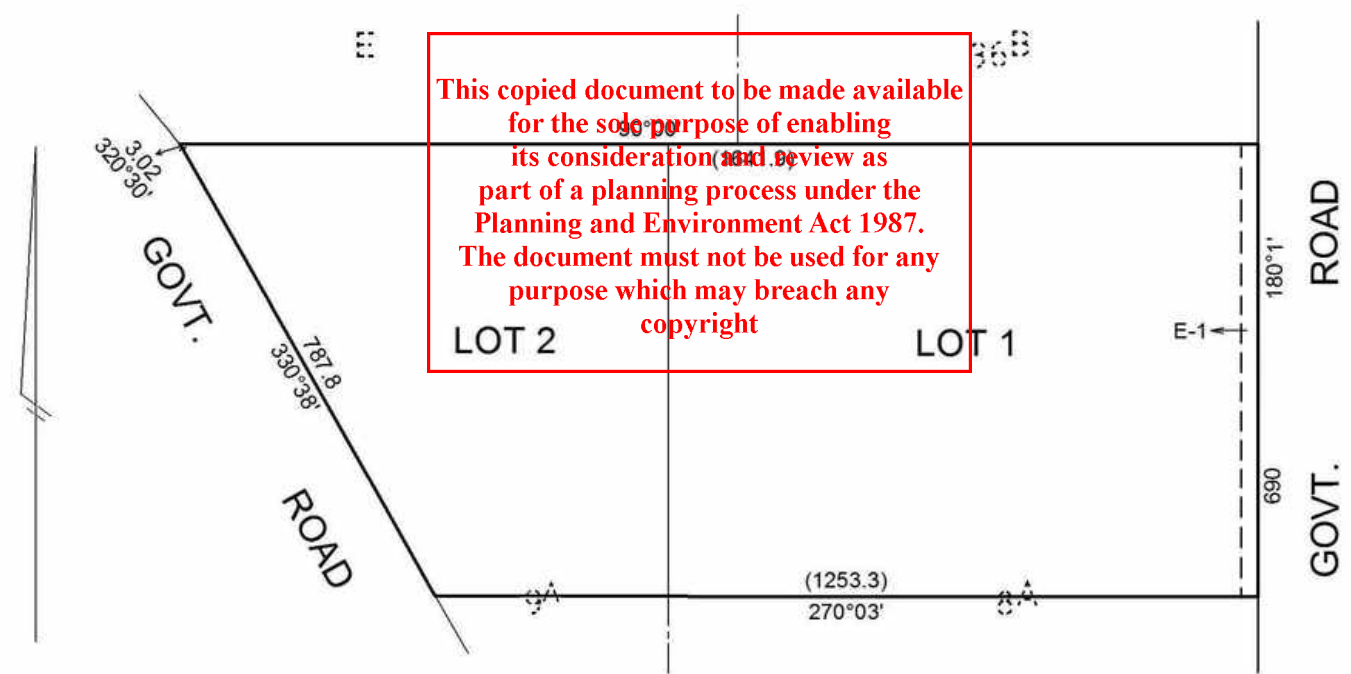
TITLE PLAN		EDITION 3		TP 612899S									
Location of Land Parish: GARVOC Township: Section: Crown Allotment: 8A (PT), 9A (PT) Crown Portion: Last Plan Reference: Derived From: VOL 2683 FOL 599 Depth Limitation: NIL			Notations ANY REFERENCE TO MAP IN THE TEXT MEANS THE DIAGRAM SHOWN ON THIS TITLE PLAN										
EASEMENT INFORMATION					THIS PLAN HAS BEEN PREPARED FOR THE LAND REGISTRY, LAND VICTORIA, FOR TITLE DIAGRAM PURPOSES AS PART OF THE LAND TITLES AUTOMATION PROJECT COMPILED: 24/08/2000 VERIFIED: MP								
Legend: A - Appurtenant Easement E - Encumbering Easement R- Encumbering Easement (Road)													
Easement Reference	Purpose	Width (Metres)	Origin	Land Benefitted / In Favour Of									
E-1	GAS SUPPLY PIPELINE	25	AJ403802R	SOUTH EAST AUSTRALIA GAS (MORTLAKE) PTY LTD (AN040924M)									
													
ADVERTISED PLAN					TOTAL AREA = 99.78ha								
<table border="1"><thead><tr><th colspan="2">TABLE OF PARCEL IDENTIFIERS</th></tr></thead><tbody><tr><td colspan="2">WARNING: Where multiple parcels are referred to or shown on this Title Plan this does not imply separately disposable parcels under Section 8A of the Sale of Land Act 1962</td></tr><tr><td colspan="2">PARCEL 1 = CA 8A (PT)</td></tr><tr><td colspan="2">PARCEL 2 = CA 9A (PT)</td></tr></tbody></table>						TABLE OF PARCEL IDENTIFIERS		WARNING: Where multiple parcels are referred to or shown on this Title Plan this does not imply separately disposable parcels under Section 8A of the Sale of Land Act 1962		PARCEL 1 = CA 8A (PT)		PARCEL 2 = CA 9A (PT)	
TABLE OF PARCEL IDENTIFIERS													
WARNING: Where multiple parcels are referred to or shown on this Title Plan this does not imply separately disposable parcels under Section 8A of the Sale of Land Act 1962													
PARCEL 1 = CA 8A (PT)													
PARCEL 2 = CA 9A (PT)													
LENGTHS ARE IN METRES		Metres = 0.3048 x Feet Metres = 0.201168 x Links		Sheet 1 of 1 sheets									

This copied document to be made available for the sole purpose of enabling its consideration and review as part of a planning process under the Planning and Environment Act 1987. The document must not be used for any purpose which may breach any copyright

REGISTER SEARCH STATEMENT (Title Search) Transfer of Land Act 1958

Page 1 of 1

VOLUME 03289 FOLIO 684

Security no : 124121259291C
Produced 16/01/2025 11:35 AM

LAND DESCRIPTION

Crown Allotment 7A Parish of Garvoc.
PARENT TITLE Volume 03041 Folio 093
Created by instrument 0577646 13/08/1908

REGISTERED PROPRIETOR

Estate Fee Simple
Sole Proprietor
TIA SAYE PTY LTD of 87 COYLES LANE TERANG VIC 3264
AG030391P 15/08/2008

**This copied document to be made available
for the sole purpose of enabling
its consideration and review as
part of a planning process under the
Planning and Environment Act 1987.
The document must not be used for any
purpose which may breach any
copyright**

ENCUMBRANCES, CAVEATS AND NOTICES

MORTGAGE AT496536Y 07/08/2020
COMMONWEALTH BANK OF AUSTRALIA

For details of any other encumbrances see the plan or imaged folio set out
under DIAGRAM LOCATION below.

DIAGRAM LOCATION

SEE TP397995Q FOR FURTHER DETAILS AND BOUNDARIES

ACTIVITY IN THE LAST 125 DAYS

NIL

-----END OF REGISTER SEARCH STATEMENT-----

Additional information: (not part of the Register Search Statement)

ADMINISTRATIVE NOTICES

NIL

eCT Control 20381U COMMONWEALTH BANK OF AUSTRALIA
Effective from 07/08/2020

DOCUMENT END

**ADVERTISED
PLAN**

Imaged Document Cover Sheet

The document following this cover sheet is an imaged document supplied by LANDATA®, Secure Electronic Registries Victoria.

Document Type	Plan
Document Identification	TP397995Q
Number of Pages (excluding this cover sheet)	1
Document Assembled	16/01/2025 11:35

Copyright and disclaimer notice:

© State of Victoria. This publication is copyright. No part may be reproduced by any process except in accordance with the provisions of the Copyright Act 1968 (Cth) and for the purposes of Section 32 of the Sale of Land Act 1962 or pursuant to a written agreement. The information is only valid at the time and in the form obtained from the LANDATA® System. None of the State of Victoria, LANDATA®, Secure Electronic Registries Victoria Pty Ltd (ABN 86 627 986 396) as trustee for the Secure Electronic Registries Victoria Trust (ABN 83 206 746 897) accept responsibility for any subsequent release, publication or reproduction of the information.

The document is invalid if this cover sheet is removed or altered.

**This copied document to be made available
for the sole purpose of enabling
its consideration and review as
part of a planning process under the
Planning and Environment Act 1987.
The document must not be used for any
purpose which may breach any
copyright**

**ADVERTISED
PLAN**

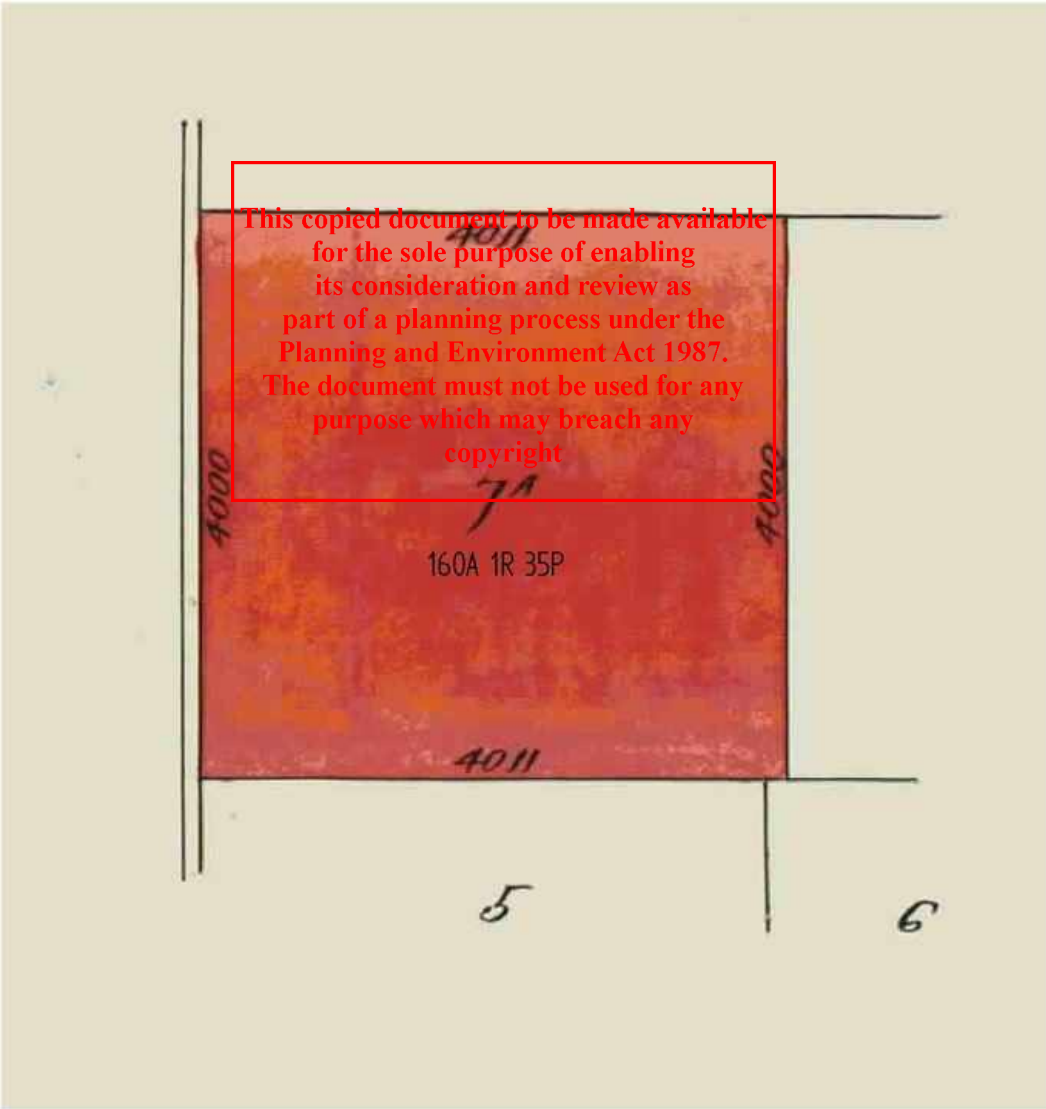
TITLE PLAN		EDITION 1	TP 397995Q
Location of Land Parish: GARVOC Township: Section: Crown Allotment: 7A Crown Portion: Last Plan Reference: Derived From: VOL 3289 FOL 684 Depth Limitation: NIL		Notations ANY REFERENCE TO MAP IN THE TEXT MEANS THE DIAGRAM SHOWN ON THIS TITLE PLAN	
Description of Land / Easement Information			THIS PLAN HAS BEEN PREPARED FOR THE LAND REGISTRY, LAND VICTORIA, FOR TITLE DIAGRAM PURPOSES AS PART OF THE LAND TITLES AUTOMATION PROJECT COMPILED: 12/04/2000 VERIFIED: AD
<div style="text-align: center;">  <p style="color: red; font-weight: bold;">This copied document to be made available for the sole purpose of enabling its consideration and review as part of a planning process under the Planning and Environment Act 1987. The document must not be used for any purpose which may breach any copyright</p> </div>			
<h2 style="color: red;">ADVERTISED PLAN</h2>			
LENGTHS ARE IN LINKS		Metres = 0.3048 x Feet Metres = 0.201168 x Links	Sheet 1 of 1 sheets

REGISTER SEARCH STATEMENT (Title Search) Transfer of Land Act 1958

Page 1 of 1

VOLUME 07793 FOLIO 164

Security no : 124121257682A
Produced 16/01/2025 11:05 AM

LAND DESCRIPTION

Lot 46 on 000505.
PARENT TITLES :
Volume 01935 Folio 909 to Volume 01935 Folio 910
Created by instrument 2502554 09/07/1952

REGISTERED PROPRIETOR

Estate Fee Simple
Joint Proprietors
MICHAEL HENRY HOOPER
GERALDINE MARGARET HOOPER both of 305 BARTONS ROAD ALLANSFORD VIC 3277
AG870760W 16/11/2009

ENCUMBRANCES, CAVEATS AND NOTICES

COVENANT AN040924M 23/08/2016

Any encumbrances created by Section 98 Transfer of Land Act 1958 or Section 24 Subdivision Act 1988 and any other encumbrances shown or entered on the plan or imaged folio set out under DIAGRAM LOCATION below.

DIAGRAM LOCATION

SEE TP810771R FOR FURTHER DETAILS AND BOUNDARIES

ACTIVITY IN THE LAST 125 DAYS

NIL

-----END OF REGISTER SEARCH STATEMENT-----

Additional information: (not part of the Register Search Statement)

Street Address: 160 SISTERS-GARVOC ROAD GARVOC VIC 3265

DOCUMENT END

**ADVERTISED
PLAN**

**This copied document to be made available
for the sole purpose of enabling
its consideration and review as
part of a planning process under the
Planning and Environment Act 1987.
The document must not be used for any
purpose which may breach any
copyright**

Imaged Document Cover Sheet

The document following this cover sheet is an imaged document supplied by LANDATA®, Secure Electronic Registries Victoria.

Document Type	Plan
Document Identification	TP810771R
Number of Pages (excluding this cover sheet)	2
Document Assembled	16/01/2025 11:05

Copyright and disclaimer notice:

© State of Victoria. This publication is copyright. No part may be reproduced by any process except in accordance with the provisions of the Copyright Act 1968 (Cth) and for the purposes of Section 32 of the Sale of Land Act 1962 or pursuant to a written agreement. The information is only valid at the time and in the form obtained from the LANDATA® System. None of the State of Victoria, LANDATA®, Secure Electronic Registries Victoria Pty Ltd (ABN 86 627 986 396) as trustee for the Secure Electronic Registries Victoria Trust (ABN 83 206 746 897) accept responsibility for any subsequent release, publication or reproduction of the information.

The document is invalid if this cover sheet is removed or altered.

**This copied document to be made available
for the sole purpose of enabling
its consideration and review as
part of a planning process under the
Planning and Environment Act 1987.
The document must not be used for any
purpose which may breach any
copyright**

**ADVERTISED
PLAN**

TITLE PLAN		EDITION 4		TP 810771R	
Location of Land Parish : GARVOC Township : - Crown Allotment : 8A (PT), 8B (PT), 9A (PT) & 9B (PT) Crown Portion : - Section : - Base record : DCMB Last Plan Reference : LOT 46 ON LP 505A Derived From : VOL. 7793 FOL. 164 Depth Limitation : NIL				Notations ANY REFERENCE TO MAP IN THE TEXT MEANS THE DIAGRAM SHOWN ON THIS TITLE PLAN	
EASEMENT INFORMATION					
Legend: A - Appurtenant Easement E - Encumbering Easement R- Encumbering Easement (Road)					
Easement Reference	Purpose	Width (Metres)	Origin	Land Benefitted / In Favour Of	
A-1	WATER SUPPLY PIPELINE	3.05	A369166	C/T V.7793 F.164	
E-1	GAS SUPPLY PIPELINE	25	AJ403802R	SOUTH EAST AUSTRALIA GAS (MORTLAKE) PTY LTD (AN040924M)	
<div style="float: right; border: 2px solid red; padding: 10px; width: 30%; color: red; font-weight: bold; text-align: center;"> This copied document to be made available for the sole purpose of enabling its consideration and review as part of a planning process under the Planning and Environment Act 1987. The document must not be used for any purpose which may breach any copyright </div> <div style="clear: both;"></div>					

MODIFICATION TABLE

RECORD OF ALL ADDITIONS OR CHANGES TO THE PLAN

PLAN NUMBER

TP810771R

**WARNING: THE IMAGE OF THIS DOCUMENT OF THE REGISTER HAS BEEN DIGITALLY AMENDED.
NO FURTHER AMENDMENTS ARE TO BE MADE TO THE ORIGINAL DOCUMENT OF THE REGISTER.**

[illegible]

This copied document to be made available for the sole purpose of enabling its consideration and review as part of a planning process under the Planning and Environment Act 1987. The document must not be used for any purpose which may breach any copyright

REGISTER SEARCH STATEMENT (Title Search) Transfer of Land Act 1958

Page 1 of 1

VOLUME 08926 FOLIO 682

Security no : 124121256879X
Produced 16/01/2025 10:47 AM

LAND DESCRIPTION

Lots 1,2 and 3 on Title Plan 840880R.
PARENT TITLE Volume 07667 Folio 094
Created by instrument E361511 18/04/1972

REGISTERED PROPRIETOR

Estate Fee Simple
Sole Proprietor
TIA SAYE PTY LTD of 1051 RAGLAN PARADE WARRNAMBOOL 3280
W738400R 19/04/2000

ENCUMBRANCES, CAVEATS AND NOTICES

MORTGAGE AT496536Y 07/08/2020
COMMONWEALTH BANK OF AUSTRALIA

Any encumbrances created by Section 98 Transfer of Land Act 1958 or Section 24 Subdivision Act 1988 and any other encumbrances shown or entered on the plan set out under DIAGRAM LOCATION below.

DIAGRAM LOCATION

SEE TP840880R FOR FURTHER DETAILS AND BOUNDARIES

ACTIVITY IN THE LAST 125 DAYS

NIL

-----END OF REGISTER SEARCH STATEMENT-----

Additional information: (not part of the Register Search Statement)

ADMINISTRATIVE NOTICES

NIL

eCT Control 20381U COMMONWEALTH BANK OF AUSTRALIA
Effective from 07/08/2020

DOCUMENT END

**ADVERTISED
PLAN**

**This copied document to be made available
for the sole purpose of enabling
its consideration and review as
part of a planning process under the
Planning and Environment Act 1987.
The document must not be used for any
purpose which may breach any
copyright**

Imaged Document Cover Sheet

The document following this cover sheet is an imaged document supplied by LANDATA®, Secure Electronic Registries Victoria.

Document Type	Plan
Document Identification	TP840880R
Number of Pages (excluding this cover sheet)	1
Document Assembled	16/01/2025 10:47

Copyright and disclaimer notice:

© State of Victoria. This publication is copyright. No part may be reproduced by any process except in accordance with the provisions of the Copyright Act 1968 (Cth) and for the purposes of Section 32 of the Sale of Land Act 1962 or pursuant to a written agreement. The information is only valid at the time and in the form obtained from the LANDATA® System. None of the State of Victoria, LANDATA®, Secure Electronic Registries Victoria Pty Ltd (ABN 86 627 986 396) as trustee for the Secure Electronic Registries Victoria Trust (ABN 83 206 746 897) accept responsibility for any subsequent release, publication or reproduction of the information.

The document is invalid if this cover sheet is removed or altered.

**This copied document to be made available
for the sole purpose of enabling
its consideration and review as
part of a planning process under the
Planning and Environment Act 1987.
The document must not be used for any
purpose which may breach any
copyright**

**ADVERTISED
PLAN**

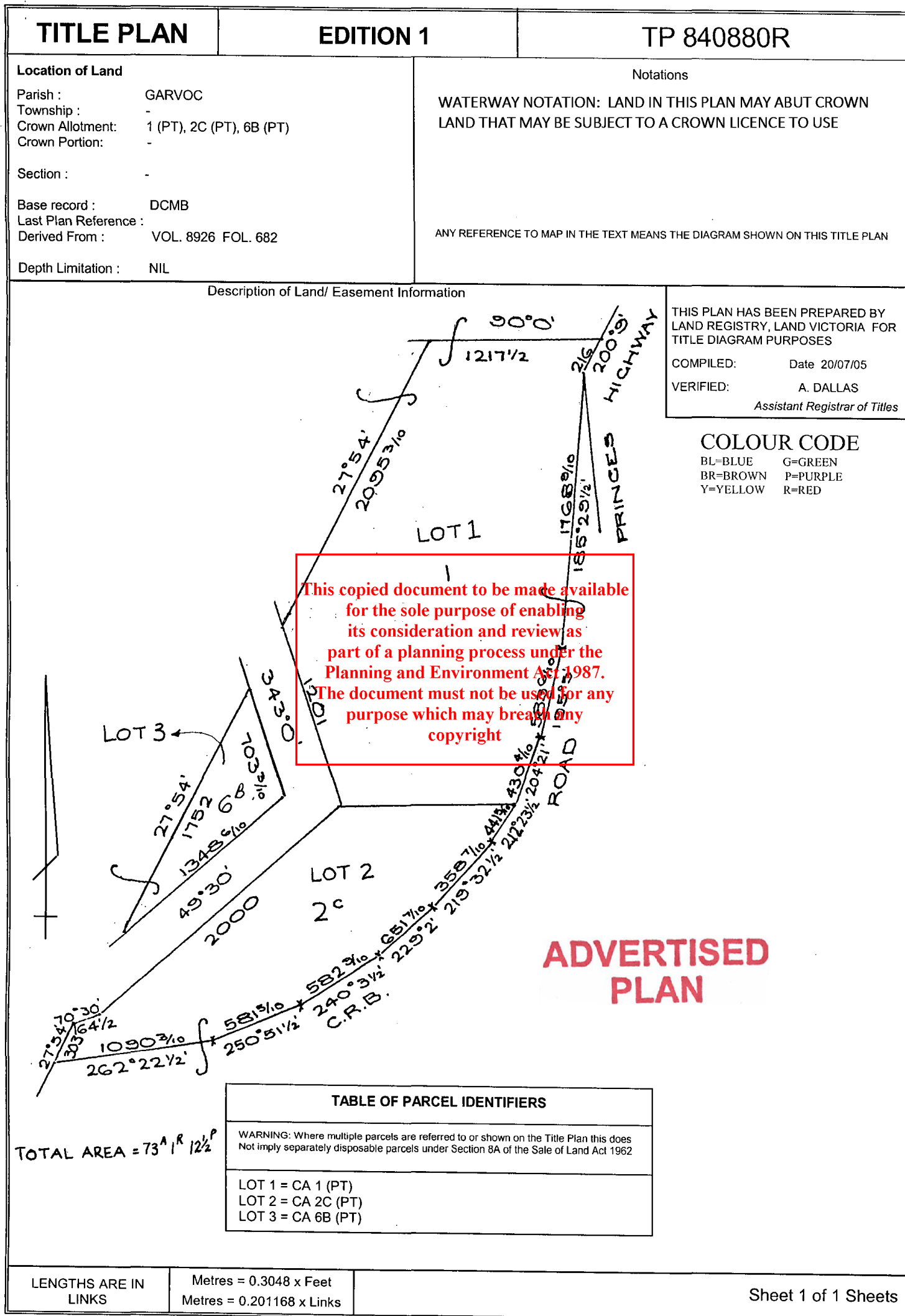

REGISTER SEARCH STATEMENT (Title Search) Transfer of Land Act 1958

Page 1 of 1

VOLUME 09044 FOLIO 676

Security no : 124121255567Y
Produced 16/01/2025 10:26 AM

LAND DESCRIPTION

Lot 1 on Plan of Subdivision 111320.
PARENT TITLE Volume 05611 Folio 051
Created by instrument LP111320 13/09/1974

REGISTERED PROPRIETOR

Estate Fee Simple
Joint Proprietors

MICHAEL HENRY HOOPER of 160 THE SISTERS- GARVOC ROAD GARVOC VIC 3265
GERALDINE MARGARET HOOPER of 160 THE SISTERS-GARVOC ROAD GARVOC VIC 3265
AJ614101W 20/04/2012

ENCUMBRANCES, CAVEATS AND NOTICES

COVENANT AN040924M 23/08/2016

Any encumbrances created by Section 98 Transfer of Land Act 1958 or Section 24 Subdivision Act 1988 and any other encumbrances shown or entered on the plan or imaged folio set out under DIAGRAM LOCATION below.

DIAGRAM LOCATION

SEE LP111320 FOR FURTHER DETAILS AND BOUNDARIES

ACTIVITY IN THE LAST 125 DAYS

NIL

-----END OF REGISTER SEARCH STATEMENT-----

Additional information: (not part of the Register Search Statement)

Street Address: SISTERS-GARVOC ROAD GARVOC VIC 3265

DOCUMENT END

**ADVERTISED
PLAN**

This copied document to be made available
for the sole purpose of enabling
its consideration and review as
part of a planning process under the
Planning and Environment Act 1987.
The document must not be used for any
purpose which may breach any
copyright

Imaged Document Cover Sheet

The document following this cover sheet is an imaged document supplied by LANDATA®, Secure Electronic Registries Victoria.

Document Type	Plan
Document Identification	LP111320
Number of Pages (excluding this cover sheet)	3
Document Assembled	16/01/2025 10:26

Copyright and disclaimer notice:

© State of Victoria. This publication is copyright. No part may be reproduced by any process except in accordance with the provisions of the Copyright Act 1968 (Cth) and for the purposes of Section 32 of the Sale of Land Act 1962 or pursuant to a written agreement. The information is only valid at the time and in the form obtained from the LANDATA® System. None of the State of Victoria, LANDATA®, Secure Electronic Registries Victoria Pty Ltd (ABN 86 627 986 396) as trustee for the Secure Electronic Registries Victoria Trust (ABN 83 206 746 897) accept responsibility for any subsequent release, publication or reproduction of the information.

The document is invalid if this cover sheet is removed or altered.

**This copied document to be made available
for the sole purpose of enabling
its consideration and review as
part of a planning process under the
Planning and Environment Act 1987.
The document must not be used for any
purpose which may breach any
copyright**

**ADVERTISED
PLAN**

ADVERTISED PLAN

LP111320

EDITION 4

APPROVED 30/7/74

PLAN OF SUBDIVISION OF
CROWN ALLOTMENTS 11^A & 11^B & 12^C
AND PART OF CROWN ALLOTMENT 8^B
PARISH OF GARVOC
COUNTY OF HAMPDEN

Distances are in metres. Not to scale.

APPROPRIATIONS

GREEN — Easements of Way

EASEMENTS

**E-1 – Gas supply easement in favour of
SOUTH EAST AUSTRALIA GAS (MORTLAKE)
PTY LTD (AN040924M)
created vide AJ092978D**

E-2- Gas supply easement in favour of
SOUTH EAST AUSTRALIA GAS (MORTLAKE)
PTY LTD (ANQ40924M)
created vide AJ403766S

NOTE. SEE COPY OF FIELD NOTES FOR
DATUM & REFERENCE MARKS.
DIMENSIONS UNDERLINED ARE DEDUCED OR
TAKEN FROM C/T. V.5611 F.051.

NOTATIONS

WATERWAY NOTATION:
LOT 2 IN THIS PLAN MAY
ABUT CROWN LAND THAT
MAY BE SUBJECT TO A
CROWN LICENCE TO USE

COLOUR CONVERSION

R1 = GREEN

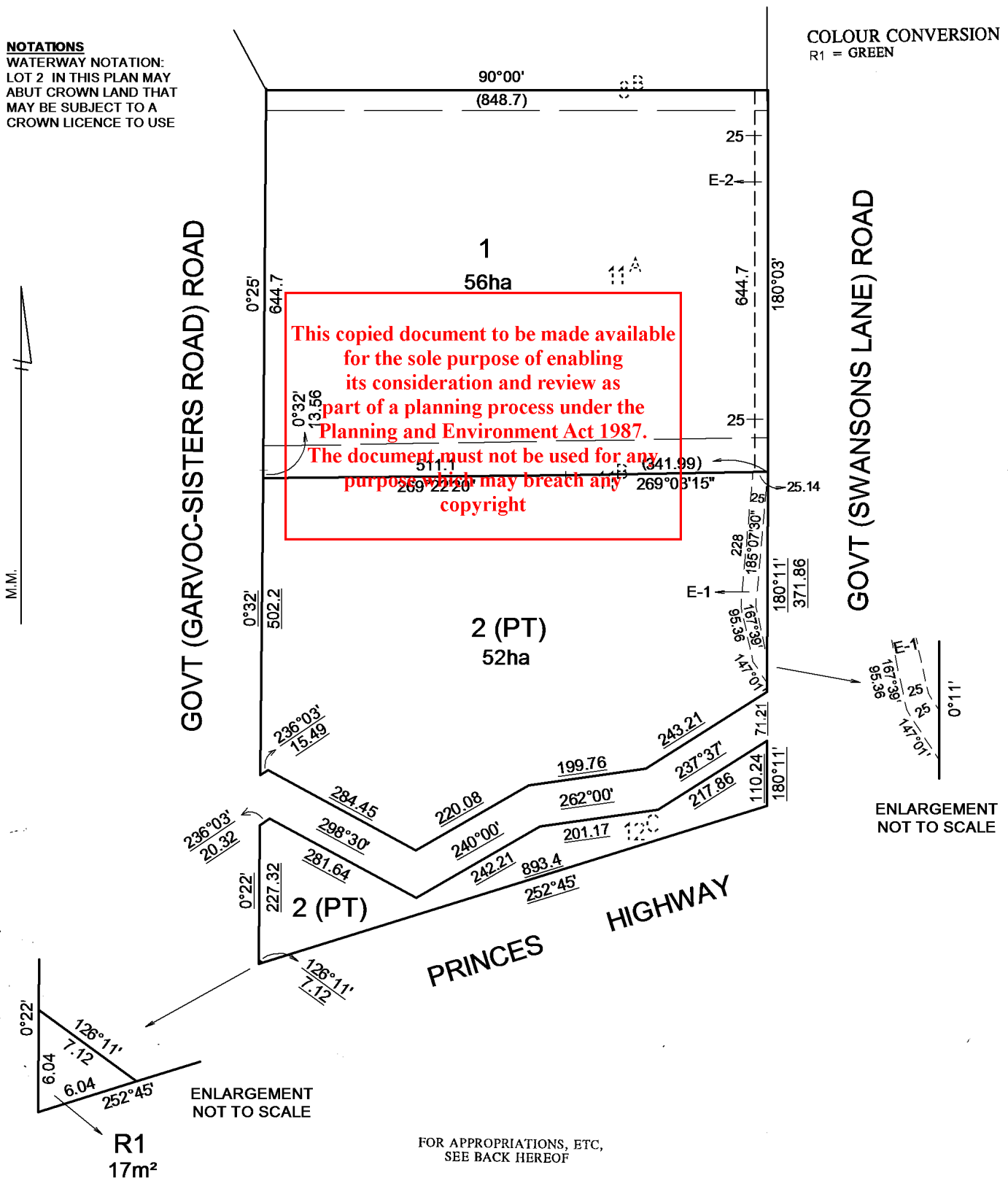

SUBDIVISIONAL
CERTIFICATE OF TITLE V. 5611 F. 051

~~FOR TITLE REFERENCES TO LOTS~~
~~SEE PARCELS INDEX~~

LODGED BY DOYLE & KERR

DEALING No. DATE 25 / 1 / 74

DECLARED BY H. ROONEY

ON 27 / 8 / 73

COUNCIL SHIRE OF WARRNAMBOOL

DATE OF CONSENT 9 / 1 / 74

PLAN MAY BE LODGED / /

PLAN APPROVED. DATE 30 / 7 / 74 TIME 4.20 a.m.
p.m.

THE LAND COLOURED **GREEN**
IS APPROPRIATED
OR SET APART FOR
EASEMENTS OF **WAY**.

LP 111320
BACK OF SHEET 1

This copied document to be made available
for the sole purpose of enabling
its consideration and review as
part of a planning process under the
Planning and Environment Act 1987.
The document must not be used for any
purpose which may breach any
copyright

**ADVERTISED
PLAN**

[illegible]

REGISTER SEARCH STATEMENT (Title Search) Transfer of Land Act 1958

Page 1 of 1

VOLUME 10017 FOLIO 387

Security no : 124121256106N
Produced 16/01/2025 10:33 AM

LAND DESCRIPTION

Lots 1,2 and 3 on Title Plan 601284U.
PARENT TITLE Volume 06532 Folio 399
Created by instrument R272819M 25/03/1991

REGISTERED PROPRIETOR

Estate Fee Simple
Sole Proprietor
TIA SAYE PTY LTD of 1051 RAGLAN PARADE WARRNAMBOOL VIC
R272819M 25/03/1991

ENCUMBRANCES, CAVEATS AND NOTICES

MORTGAGE AT496536Y 07/08/2020
COMMONWEALTH BANK OF AUSTRALIA

Any encumbrances created by Section 98 Transfer of Land Act 1958 or Section 24 Subdivision Act 1988 and any other encumbrances shown or entered on the plan set out under DIAGRAM LOCATION below.

DIAGRAM LOCATION

SEE TP601284U FOR FURTHER DETAILS AND BOUNDARIES

ACTIVITY IN THE LAST 125 DAYS

NIL

-----END OF REGISTER SEARCH STATEMENT-----

Additional information: (not part of the Register Search Statement)

ADMINISTRATIVE NOTICES

NIL

eCT Control 15940N COMMONWEALTH BANK OF AUSTRALIA
Effective from 05/08/2024

DOCUMENT END

**ADVERTISED
PLAN**

**This copied document to be made available
for the sole purpose of enabling
its consideration and review as
part of a planning process under the
Planning and Environment Act 1987.
The document must not be used for any
purpose which may breach any
copyright**

Imaged Document Cover Sheet

The document following this cover sheet is an imaged document supplied by LANDATA®, Secure Electronic Registries Victoria.

Document Type	Plan
Document Identification	TP601284U
Number of Pages (excluding this cover sheet)	2
Document Assembled	16/01/2025 10:33

Copyright and disclaimer notice:

© State of Victoria. This publication is copyright. No part may be reproduced by any process except in accordance with the provisions of the Copyright Act 1968 (Cth) and for the purposes of Section 32 of the Sale of Land Act 1962 or pursuant to a written agreement. The information is only valid at the time and in the form obtained from the LANDATA® System. None of the State of Victoria, LANDATA®, Secure Electronic Registries Victoria Pty Ltd (ABN 86 627 986 396) as trustee for the Secure Electronic Registries Victoria Trust (ABN 83 206 746 897) accept responsibility for any subsequent release, publication or reproduction of the information.

The document is invalid if this cover sheet is removed or altered.

**This copied document to be made available
for the sole purpose of enabling
its consideration and review as
part of a planning process under the
Planning and Environment Act 1987.
The document must not be used for any
purpose which may breach any
copyright**

**ADVERTISED
PLAN**

TITLE PLAN		EDITION 2	TP 601284U										
Location of Land Parish: GARVOC Township: Section: Crown Allotment: 7B, 7C, 1(PT) Crown Portion: Last Plan Reference: Derived From: VOL 10017 FOL 387 Depth Limitation: 15.24 m (CA 7C)		Notations ADVERTISED PLAN ANY REFERENCE TO MAP IN THE TEXT MEANS THE DIAGRAM SHOWN ON THIS TITLE PLAN											
Description of Land / Easement Information ENCUMBRANCES REFERRED TO AS TO THE LAND SHOWN MARKED "E-1" THE EASEMENT TO STATE RIVERS AND WATER SUPPLY COMMISSION CREATED BY INSTRUMENT 1716018 AS TO THE LAND SHOWN MARKED E-2 POWER SUPPLY (UNDERGROUND) EASEMENT IN FAVOUR OF POWERCOR AUSTRALIA LTD CREATED IN INST. AY239459K.		THIS PLAN HAS BEEN PREPARED FOR THE LAND REGISTRY, LAND VICTORIA, FOR TITLE DIAGRAM PURPOSES AS PART OF THE LAND TITLES AUTOMATION PROJECT COMPILED: 16/08/2000 VERIFIED: BH											
<p>1</p> <p>2</p> <p>3 (2 PIECES)</p> <p>3 (2 PIECES)</p> <p>RAILWAY</p> <p>ROAD</p> <p>GOVT.</p> <p>E-1</p> <p>E-2</p> <p>SEE ENLARGEMENT</p> <p>TOTAL AREA: 135.8 ha</p> <p>ENLARGEMENT NOT TO SCALE</p>													
<table border="1"><thead><tr><th colspan="2">TABLE OF PARCEL IDENTIFIERS</th></tr></thead><tbody><tr><td colspan="2">WARNING: Where multiple parcels are referred to or shown on this Title Plan this does not imply separately disposable parcels under Section 8A of the Sale of Land Act 1962</td></tr><tr><td colspan="2">PARCEL 1 = CA 7B</td></tr><tr><td colspan="2">PARCEL 2 = CA 7C</td></tr><tr><td colspan="2">PARCEL 3 = CA 1 (PTS)</td></tr></tbody></table>				TABLE OF PARCEL IDENTIFIERS		WARNING: Where multiple parcels are referred to or shown on this Title Plan this does not imply separately disposable parcels under Section 8A of the Sale of Land Act 1962		PARCEL 1 = CA 7B		PARCEL 2 = CA 7C		PARCEL 3 = CA 1 (PTS)	
TABLE OF PARCEL IDENTIFIERS													
WARNING: Where multiple parcels are referred to or shown on this Title Plan this does not imply separately disposable parcels under Section 8A of the Sale of Land Act 1962													
PARCEL 1 = CA 7B													
PARCEL 2 = CA 7C													
PARCEL 3 = CA 1 (PTS)													
LENGTHS ARE IN METRES	Metres = 0.3048 x Feet Metres = 0.201168 x Links	Sheet 1 of 1 sheets											

This copied document to be made available for the sole purpose of enabling its consideration and review as part of a planning process under the Planning and Environment Act 1987. The document must not be used for any purpose which may breach any copyright

REGISTER SEARCH STATEMENT (Title Search) Transfer of Land Act 1958

Page 1 of 1

VOLUME 10756 FOLIO 778

Security no : 124121259534M
Produced 16/01/2025 11:39 AM

LAND DESCRIPTION

Land in Plan of Consolidation 365133G.

PARENT TITLES :

Volume 10229 Folio 207 Volume 10696 Folio 551

Created by instrument PC365133G 10/10/2003

REGISTERED PROPRIETOR

Estate Fee Simple

Sole Proprietor

TIA SAYE PTY LTD of 1051 RAGLAN PARADE WARRNAMBOOL 3280

PC365133G 10/10/2003

ENCUMBRANCES, CAVEATS AND NOTICES

MORTGAGE AT496536Y 07/08/2020

COMMONWEALTH BANK OF AUSTRALIA

Any encumbrances created by Section 98 Transfer of Land Act 1958 or Section 24 Subdivision Act 1988 and any other encumbrances shown or entered on the plan set out under DIAGRAM LOCATION below.

DIAGRAM LOCATION

SEE PC365133G FOR FURTHER DETAILS AND BOUNDARIES

ACTIVITY IN THE LAST 125 DAYS

NIL

-----END OF REGISTER SEARCH STATEMENT-----

Additional information: (not part of the Register Search Statement)

ADMINISTRATIVE NOTICES

NIL

eCT Control 20381U COMMONWEALTH BANK OF AUSTRALIA
Effective from 07/08/2020

DOCUMENT END

**ADVERTISED
PLAN**

**This copied document to be made available
for the sole purpose of enabling
its consideration and review as
part of a planning process under the
Planning and Environment Act 1987.
The document must not be used for any
purpose which may breach any
copyright**

Imaged Document Cover Sheet

The document following this cover sheet is an imaged document supplied by LANDATA®, Secure Electronic Registries Victoria.

Document Type	Plan
Document Identification	PC365133G
Number of Pages (excluding this cover sheet)	1
Document Assembled	16/01/2025 11:39

Copyright and disclaimer notice:

© State of Victoria. This publication is copyright. No part may be reproduced by any process except in accordance with the provisions of the Copyright Act 1968 (Cth) and for the purposes of Section 32 of the Sale of Land Act 1962 or pursuant to a written agreement. The information is only valid at the time and in the form obtained from the LANDATA® System. None of the State of Victoria, LANDATA®, Secure Electronic Registries Victoria Pty Ltd (ABN 86 627 986 396) as trustee for the Secure Electronic Registries Victoria Trust (ABN 83 206 746 897) accept responsibility for any subsequent release, publication or reproduction of the information.

The document is invalid if this cover sheet is removed or altered.

**This copied document to be made available
for the sole purpose of enabling
its consideration and review as
part of a planning process under the
Planning and Environment Act 1987.
The document must not be used for any
purpose which may breach any
copyright**

**ADVERTISED
PLAN**

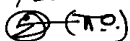
PLAN OF CONSOLIDATION		LTO use only EDITION 1	Plan Number PC 365133G															
Location of Land Parish: GARVOC Township: _____ Section: _____ Crown Allotment: 1, 6A, 6B (PARTS), 5A (PART) Crown Portion: _____ LTO Base Record: D.C.M.B. (RURAL) Title Reference: C/T.VOL.10229.FOL- 207 C/T.VOL.10696.FOL.551 Last Plan Reference: PS511734D (LOT 2) Postal Address: AND PC 351694R (at time of consolidation) GARVOC 3265 AMG Co-ordinates E 661 000 (of approx. centre of land N 5 760 750 in plan) Zone: 54		Council Certification Council Name: CORANGAMITE SHIRE COUNCIL Ref: 02/123 1. This plan is certified under section 6 of the subdivision Act 1988. 2. This plan is certified under section 11(7) of the Subdivision Act 1988. Date of original certification under section 6 / / 3. This is a statement of compliance issued under section 21 of the Subdivision Act 1988. Council Delegate Council Seal Date 20 / 10 / 2002 Re-certified under section 11(7) of the Subdivision Act 1988 Council Delegate Council Seal Date / /																
		LTO use only Statement of Compliance/ Exemption Statement Received <input type="checkbox"/> Date / /																
		LTO use only PLAN REGISTERED TIME 9:37 am DATE 10 / 10 / 2003  Assistant Registrar of Titles																
		Notations																
		Depth Limitation: DOES NOT APPLY.																
Easement Information Legend: E - Encumbering Easement, Condition in Crown Grant in the Nature of an Easement or other Encumbrance A - Appurtenant Easement R - Encumbering Easement (Road)		SECTION 12 (2) OF THE SUBDIVISION ACT 1988 APPLIES TO ALL THE LAND IN THE PLAN.																
<table><thead><tr><th>Subject Land</th><th>Purpose</th><th>Width (Metres)</th><th>Origin</th><th>Land Benefited/In Favour Of</th></tr></thead><tbody><tr><td>E-1</td><td>WATER SUPPLY</td><td>10.06m</td><td>INST. 1716018</td><td>S.R. AND W.S.C.</td></tr><tr><td>E-2</td><td>WATER SUPPLY</td><td>10.06m</td><td>INST. 1761181</td><td>S.R. AND W.S.C.</td></tr></tbody></table>	Subject Land	Purpose	Width (Metres)	Origin	Land Benefited/In Favour Of	E-1	WATER SUPPLY	10.06m	INST. 1716018	S.R. AND W.S.C.	E-2	WATER SUPPLY	10.06m	INST. 1761181	S.R. AND W.S.C.	Survey This plan is/is not based on survey This survey has been connected to permanent marks no(s) In proclaimed Survey Area No.		
Subject Land	Purpose	Width (Metres)	Origin	Land Benefited/In Favour Of														
E-1	WATER SUPPLY	10.06m	INST. 1716018	S.R. AND W.S.C.														
E-2	WATER SUPPLY	10.06m	INST. 1761181	S.R. AND W.S.C.														
<div>This copied document to be made available for the sole purpose of enabling its consideration and review as part of a planning process under the Planning and Environment Act 1987. The document must not be used for any purpose which may breach any copyright</div>																		

REGISTER SEARCH STATEMENT (Title Search) Transfer of Land Act 1958

Page 1 of 1

VOLUME 10872 FOLIO 899

Security no : 124121257540E
Produced 16/01/2025 11:01 AM

LAND DESCRIPTION

Crown Allotment 36B Parish of Keilambete.
PARENT TITLE Volume 06398 Folio 485
Created by instrument AD539147Q 05/04/2005

**ADVERTISED
PLAN**

REGISTERED PROPRIETOR

Estate Fee Simple
TENANTS IN COMMON
As to 1 of a total of 2 equal undivided shares
Sole Proprietor
MICHAEL HENRY HOOPER of 305 BARTONS ROAD ALLANSFORD VIC 3277
As to 1 of a total of 2 equal undivided shares
Sole Proprietor
GERALDINE MARGARET HOOPER of 305 BARTONS ROAD ALLANSFORD VIC 3277
AD539147Q 05/04/2005

ENCUMBRANCES, CAVEATS AND NOTICES

MORTGAGE AF846913T 15/05/2008
AUSTRALIA AND NEW ZEALAND BANKING GROUP LTD

COVENANT AN040924M 23/08/2016

For details of any other encumbrances see the plan or imaged folio set out
under DIAGRAM LOCATION below.

DIAGRAM LOCATION

SEE TP379707B FOR FURTHER DETAILS AND BOUNDARIES

ACTIVITY IN THE LAST 125 DAYS

NIL

-----END OF REGISTER SEARCH STATEMENT-----

Additional information: (not part of the Register Search Statement)

Street Address: SWANSONS LANE GARVOC VIC 3265

ADMINISTRATIVE NOTICES

NIL

eCT Control 16165A AUSTRALIA AND NEW ZEALAND BANKING GROUP LIMITED
Effective from 23/10/2016

DOCUMENT END

**This copied document to be made available
for the sole purpose of enabling
its consideration and review as
part of a planning process under the
Planning and Environment Act 1987.
The document must not be used for any
purpose which may breach any
copyright**

Imaged Document Cover Sheet

The document following this cover sheet is an imaged document supplied by LANDATA®, Secure Electronic Registries Victoria.

Document Type	Plan
Document Identification	TP379707B
Number of Pages (excluding this cover sheet)	2
Document Assembled	16/01/2025 11:01

Copyright and disclaimer notice:

© State of Victoria. This publication is copyright. No part may be reproduced by any process except in accordance with the provisions of the Copyright Act 1968 (Cth) and for the purposes of Section 32 of the Sale of Land Act 1962 or pursuant to a written agreement. The information is only valid at the time and in the form obtained from the LANDATA® System. None of the State of Victoria, LANDATA®, Secure Electronic Registries Victoria Pty Ltd (ABN 86 627 986 396) as trustee for the Secure Electronic Registries Victoria Trust (ABN 83 206 746 897) accept responsibility for any subsequent release, publication or reproduction of the information.

The document is invalid if this cover sheet is removed or altered.

**This copied document to be made available
for the sole purpose of enabling
its consideration and review as
part of a planning process under the
Planning and Environment Act 1987.
The document must not be used for any
purpose which may breach any
copyright**

**ADVERTISED
PLAN**

MODIFICATION TABLE

RECORD OF ALL ADDITIONS OR CHANGES TO THE PLAN

PLAN NUMBER

TP 379707B

**WARNING: THE IMAGE OF THIS DOCUMENT OF THE REGISTER HAS BEEN DIGITALLY AMENDED.
NO FURTHER AMENDMENTS ARE TO BE MADE TO THE ORIGINAL DOCUMENT OF THE REGISTER.**

[illegible]

This copied document to be made available for the sole purpose of enabling its consideration and review as part of a planning process under the Planning and Environment Act 1987. The document must not be used for any purpose which may breach any copyright

REGISTER SEARCH STATEMENT (Title Search) Transfer of Land Act 1958

Page 1 of 1

VOLUME 10872 FOLIO 900

Security no : 124121257118N
Produced 16/01/2025 10:53 AM

LAND DESCRIPTION

Crown Allotment 36A Parish of Keilambete.
PARENT TITLE Volume 06398 Folio 485
Created by instrument AD539148N 05/04/2005

REGISTERED PROPRIETOR

Estate Fee Simple
Sole Proprietor
HODAN PTY LTD of 160 THE SISTERS-GARVOC ROAD GARVOC VIC 3265
AN167584B 11/10/2016

**This copied document to be made available
for the sole purpose of enabling
its consideration and review as
part of a planning process under the
Planning and Environment Act 1987.
The document must not be used for any
purpose which may breach any
copyright**

ENCUMBRANCES, CAVEATS AND NOTICES

COVENANT AN040924M 23/08/2016

For details of any other encumbrances see the plan or imaged folio set out
under DIAGRAM LOCATION below.

DIAGRAM LOCATION

SEE TP379707B FOR FURTHER DETAILS AND BOUNDARIES

ACTIVITY IN THE LAST 125 DAYS

NIL

-----END OF REGISTER SEARCH STATEMENT-----

Additional information: (not part of the Register Search Statement)

Street Address: COYLES ROAD GARVOC VIC 3265

ADMINISTRATIVE NOTICES

NIL

eCT Control 19570Y SEWELLS LAWYERS
Effective from 31/07/2024

DOCUMENT END

**ADVERTISED
PLAN**

Imaged Document Cover Sheet

The document following this cover sheet is an imaged document supplied by LANDATA®, Secure Electronic Registries Victoria.

Document Type	Plan
Document Identification	TP379707B
Number of Pages (excluding this cover sheet)	2
Document Assembled	16/01/2025 10:53

Copyright and disclaimer notice:

© State of Victoria. This publication is copyright. No part may be reproduced by any process except in accordance with the provisions of the Copyright Act 1968 (Cth) and for the purposes of Section 32 of the Sale of Land Act 1962 or pursuant to a written agreement. The information is only valid at the time and in the form obtained from the LANDATA® System. None of the State of Victoria, LANDATA®, Secure Electronic Registries Victoria Pty Ltd (ABN 86 627 986 396) as trustee for the Secure Electronic Registries Victoria Trust (ABN 83 206 746 897) accept responsibility for any subsequent release, publication or reproduction of the information.

The document is invalid if this cover sheet is removed or altered.

**This copied document to be made available
for the sole purpose of enabling
its consideration and review as
part of a planning process under the
Planning and Environment Act 1987.
The document must not be used for any
purpose which may breach any
copyright**

**ADVERTISED
PLAN**

[illegible]

CROWN FOLIO STATEMENT

Page 1 of 1

VOLUME 11735 FOLIO 678
No Coft exists

Security no : 124121258569L
Produced 16/01/2025 11:22 AM

CROWN FOLIO

LAND DESCRIPTION

Crown Allotment 6C Parish of Garvoc.
Created by instrument MI097316S 06/08/2016

CROWN LAND ADMINISTRATOR

SECRETARY TO THE DEPARTMENT OF ENVIRONMENT, LAND, WATER AND PLANNING of 8
NICHOLSON STREET EAST MELBOURNE VIC 3002
MI097316S 06/08/2016

STATUS, ENCUMBRANCES AND NOTICES

DIAGRAM LOCATION

SEE CD039795V FOR FURTHER DETAILS AND BOUNDARIES

ACTIVITY IN THE LAST 125 DAYS

NIL

-----END OF CROWN FOLIO STATEMENT-----

Additional information: (not part of the Crown Folio Statement)

Street Address: TRIGGS WEST ROAD TERANG VIC 3264

DOCUMENT END

**ADVERTISED
PLAN**

**This copied document to be made available
for the sole purpose of enabling
its consideration and review as
part of a planning process under the
Planning and Environment Act 1987.
The document must not be used for any
purpose which may breach any
copyright**

CROWN FOLIO STATEMENT

Page 1 of 1

VOLUME 11735 FOLIO 679
No Coft exists

Security no : 124121258568M
Produced 16/01/2025 11:22 AM

CROWN FOLIO

LAND DESCRIPTION

Crown Allotment 6D Parish of Garvoc.
Created by instrument MI097318N 06/08/2016

CROWN LAND ADMINISTRATOR

SECRETARY TO THE DEPARTMENT OF ENVIRONMENT, LAND, WATER AND PLANNING of 8
NICHOLSON STREET EAST MELBOURNE VIC 3002
MI097318N 06/08/2016

STATUS, ENCUMBRANCES AND NOTICES

DIAGRAM LOCATION

SEE CD039796T FOR FURTHER DETAILS AND BOUNDARIES

ACTIVITY IN THE LAST 125 DAYS

NIL

DOCUMENT END

**This copied document to be made available
for the sole purpose of enabling
its consideration and review as
part of a planning process under the
Planning and Environment Act 1987.
The document must not be used for any
purpose which may breach any
copyright**

**ADVERTISED
PLAN**



ASIC

Australian Securities & Investments Commission

Current Company Extract

Name: HODAN PTY LTD

ACN: 091 033 653

Date/Time: 29 January 2025 AEST 12:45:10 PM

This extract contains information derived from the Australian Securities and Investments Commission's (ASIC) database under section 1274A of the Corporations Act 2001.

Please advise ASIC of any error or omission which you may identify.

EXTRACT

**ADVERTISED
PLAN**

This copied document to be made available for the sole purpose of enabling its consideration and review as part of a planning process under the Planning and Environment Act 1987. The document must not be used for any purpose which may breach any copyright

Organisation Details	Document Number
Current Organisation Details	
Name: HODAN PTY LTD	0E3917396
ACN: 091 033 653	
ABN: 99091033653	
Registered in: Victoria	
Registration date: 23/12/1999	
Next review date: 23/12/2025	
Name start date: 23/12/1999	
Status: Registered	
Company type: Australian Proprietary Company	
Class: Limited By Shares	
Subclass: Proprietary Company	

This copied document to be made available for the sole purpose of enabling its consideration and review as part of a planning process under the Planning and Environment Act 1987. The document must not be used for any purpose which may breach any copyright

Address Details	Document Number
Current	
Registered address: 199 Koroit Street, WARRNAMBOOL VIC 3280	2E0109948
Start date: 14/01/2014	
Principal Place Of Business address: 160 Sisters Garvoc Road, GARVOC VIC 3265	5E2311876
Start date: 28/01/2010	

Contact Address
Section 146A of the Corporations Act 2001 states 'A contact address is the address to which communications and notices are sent from ASIC to the company'.
Current
Address: PO BOX 677, WARRNAMBOOL VIC 3280
Start date: 12/04/2010

Officeholders and Other Roles	Document Number
Director	
Name: GERALDINE MARGARET HOOPER	5E2311877
Address: 160 Sisters Garvoc Road, GARVOC VIC 3265	
Born: 24/01/1961, WARRNAMBOOL, VIC	
Appointment date: 23/12/1999	
Name: MICHAEL HENRY HOOPER	5E2311877
Address: 160 Sisters Garvoc Road, GARVOC VIC 3265	
Born: 30/04/1957, WARRNAMBOOL, VIC	
Appointment date: 23/12/1999	
Secretary	
Name: GERALDINE MARGARET HOOPER	5E2311877
Address: 160 Sisters Garvoc Road, GARVOC VIC 3265	
Born: 24/01/1961, WARRNAMBOOL, VIC	
Appointment date: 23/12/1999	
Name: MICHAEL HENRY HOOPER	5E2311877

Address: 160 Sisters Garvoc Road, GARVOC VIC 3265
 Born: 30/04/1957, WARRNAMBOOL, VIC
 Appointment date: 23/12/1999

Share Information**Share Structure**

Class	Description	Number issued	Total amount paid	Total amount unpaid	Document number
ORD1	ORDINARY SHARES	2	2.00	0.00	0E4134101

Members

Note: For each class of shares issued by a proprietary company, ASIC records the details of the top twenty members of the class (based on shareholdings). The details of any other members holding the same number of shares as the twentieth ranked member will also be recorded by ASIC on the database. Where available, historical records show that a member has ceased to be ranked amongst the top twenty members. This may, but does not necessarily mean, that they have ceased to be a member of the company.

Name: GERALDINE MARGARET HOOPER
 Address: 160 Sisters Garvoc Road, GARVOC VIC 3265

Class	Number held	Beneficially held	Paid	Document number
ORD1	1	yes	FULLY	5E2311877

Name: MICHAEL HENRY HOOPER
 Address: 160 Sisters Garvoc Road, GARVOC VIC 3265

Class	Number held	Beneficially held	Paid	Document number
ORD1	1	yes	FULLY	5E2311877

End of Extract of 2 Pages

**ADVERTISED
PLAN**

This copied document to be made available for the sole purpose of enabling its consideration and review as part of a planning process under the Planning and Environment Act 1987. The document must not be used for any purpose which may breach any copyright



ASIC

Australian Securities & Investments Commission

Current Company Extract

Name: TIA SAYE PTY. LTD.

ACN: 006 360 416

Date/Time: 29 January 2025 AEST 12:45:11 PM

This extract contains information derived from the Australian Securities and Investments Commission's (ASIC) database under section 1274A of the Corporations Act 2001.

Please advise ASIC of any error or omission which you may identify.

EXTRACT

**ADVERTISED
PLAN**

This copied document to be made available for the sole purpose of enabling its consideration and review as part of a planning process under the Planning and Environment Act 1987. The document must not be used for any purpose which may breach any copyright

Organisation Details	Document Number
Current Organisation Details	
Name: TIA SAYE PTY. LTD.	0636041A
ACN: 006 360 416	
Registered in: Victoria	
Registration date: 12/12/1984	
Next review date: 12/12/2025	
Name start date: 12/12/1984	
Previous state number: C0235971N	
Status: Registered	
Company type: Australian Proprietary Company	
Class: Limited By Shares	
Subclass: Proprietary Company	

This copied document to be made available for the sole purpose of enabling its consideration and review as part of a planning process under the Planning and Environment Act 1987. The document must not be used for any purpose which may breach any copyright

Address Details	Document Number
Current	
Registered address: 87 Coyles Lane, TERANG VIC 3264	1F0528863
Start date: 18/12/2014	
Principal Place Of Business address: 'Princess Highway' Rmb 1722, GARVOC VIC 3265	1E6785760
Start date: 18/08/2010	

Contact Address
Section 146A of the Corporations Act 2001 states 'A contact address is the address to which communications and notices are sent from ASIC to the company'.
Current
Address: PO BOX 1444, GEELONG VIC 3220
Start date: 14/11/2014

Officeholders and Other Roles	Document Number
Director	
Name: BONITA ROSALIE JOHNSTONE	0E8529075
Address: RMB 1722, Princes Highway, GARVOC VIC 3265	
Born: 07/10/1962, , INDIA	
Appointment date: 26/10/1993	
Secretary	
Name: BONITA ROSALIE JOHNSTONE	0E9800303
Address: RMB 1722, Princes Highway, GARVOC VIC 3265	
Born: 07/10/1962, , INDIA	
Appointment date: 20/04/2004	

Share Information
Share Structure

Class	Description	Number issued	Total amount paid	Total amount unpaid	Document number
ORD	ORDINARY SHARES	12	12.00	0.00	0636041A

Members

Note: For each class of shares issued by a proprietary company, ASIC records the details of the top twenty members of the class (based on shareholdings). The details of any other members holding the same number of shares as the twentieth ranked member will also be recorded by ASIC on the database. Where available, historical records show that a member has ceased to be ranked amongst the top twenty members. This may, but does not necessarily mean, that they have ceased to be a member of the company.

Name: WAYNE FRANCIS JOHNSTONE
Address: Princes Highway, GARVOC VIC 3265

Class	Number held	Beneficially held	Paid	Document number
ORD	6	yes	FULLY	0636041A

Name: BONITA ROSALIE JOHNSTONE
Address: Princes Highway, GARVOC VIC 3265

Class	Number held	Beneficially held	Paid	Document number
ORD	6	yes	FULLY	00636041L

End of Extract of 2 Pages

**ADVERTISED
PLAN**

This copied document to be made available for the sole purpose of enabling its consideration and review as part of a planning process under the Planning and Environment Act 1987. The document must not be used for any purpose which may breach any copyright

Imaged Document Cover Sheet

The document following this cover sheet is an imaged document supplied by LANDATA®, Secure Electronic Registries Victoria.

Document Type	Instrument
Document Identification	AN040924M
Number of Pages (excluding this cover sheet)	3
Document Assembled	25/03/2025 16:43

Copyright and disclaimer notice:

© State of Victoria. This publication is copyright. No part may be reproduced by any process except in accordance with the provisions of the Copyright Act 1968 (Cth) and for the purposes of Section 32 of the Sale of Land Act 1962 or pursuant to a written agreement. The information is only valid at the time and in the form obtained from the LANDATA® System. None of the State of Victoria, LANDATA®, Secure Electronic Registries Victoria Pty Ltd (ABN 86 627 986 396) as trustee for the Secure Electronic Registries Victoria Trust (ABN 83 206 746 897) accept responsibility for any subsequent release, publication or reproduction of the information.

The document is invalid if this cover sheet is removed or altered.

**This copied document to be made available
for the sole purpose of enabling
its consideration and review as
part of a planning process under the
Planning and Environment Act 1987.
The document must not be used for any
purpose which may breach any
copyright**

**ADVERTISED
PLAN**

Transfer of easement

Section 45(1) Transfer of Land Act 1958

AN040924M

23/08/2016 \$92.70 45TE



Lodged by

Name:

Phone:

Address:

Reference:

Customer Code:

KING & WOOD MALLESONS

Code : 1177B

The transferor transfers to the transferee the easement for the consideration expressed subject to the encumbrances affecting the land including any created by dealings lodged for registration before the lodging of this transfer.

Land:

Refer to column 2 in Schedule A

Easement No.:

Refer to column 1 in Schedule A

Consideration:

\$346,000.00

Transferor:

Origin Energy Resources Limited (ABN 66 007 845 338) of 264 - 278 George Street, Sydney, New South Wales 2000

Transferee:

South East Australia Gas (Mortlake) Pty Ltd (ACN 612 210 447) of Level 4, 70 Hindmarsh Square, Adelaide, South Australia 5001 **PURSUANT TO SECTION 97 OF THE PIPELINES ACT 2005 (VIC) AND ACQUIRED UNDER PART 6 DIVISION 2 OF THE ACT FOR THE CONSTRUCTION AND OPERATION OF A PIPELINE AS AN EASEMENT IN GROSS**

Date:

18 August 2016

For execution, refer to page 2

AMENDED

RP

31 OCT 2016

With consent of
Australian Legal Practitioner/
~~Licensed Conveyancer~~ for **APPLICANTS**

This copied document to be made available for the sole purpose of enabling its consideration and review as part of a planning process under the Planning and Environment Act 1987. The document must not be used for any purpose which may breach any copyright

**ADVERTISED
PLAN**

This is page 2 of 3

AN040924M

23/08/2016 \$92.70 45TE



SIGNED by BEN BOLOT)
)
as attorney for **ORIGIN**)
ENERGY RESOURCES)
LIMITED (ACN 660 078 453)
338) under power of attorney)
dated 17 May 2016)

in the presence of:

Signature of witness

KATRINA HILL
Name of witness (block letters)

By executing this document the attorney states that the attorney has received no notice of revocation of the power of attorney

**This copied document to be made available
for the sole purpose of enabling
its consideration and review as
part of a planning process under the
Planning and Environment Act 1987.
The document must not be used for any
purpose which may breach any
copyright**

SIGNED by **JEFF COOKE**
as attorney for **SOUTH EAST AUSTRALIA GAS (MORTLAKE) PTY LTD (ACN 612 210 447)** under power of attorney dated **16 May 2016**
in the presence of:

Signature of witness

NICOLE WIERINGA
Name of witness (block letters)

By executing this document the attorney states that the attorney has received no notice of revocation of the power of attorney

ADVERTISED PLAN

This is page 3 of 3

Schedule A

AN040924M

23/08/2016

\$92.70 45TE



	Easement	Land	Plan
1	AJ092978D	Affecting Certificate of Title Volume 08808 Folio 993	TP613910D
2	AJ092978D	Affecting Certificate of Title Volume 08808 Folio 994	TP445401L
3	AJ092978D AJ403766S	Affecting Certificate of Title Volume 09044 Folio 677	PS111320 LP*
4	AJ092978D AJ403766S	Affecting Certificate of Title Volume 09044 Folio 676	PS111320 LP*
5	AJ403802R	Affecting Certificate of Title Volume 07793 Folio 164	TP810771R
6	AJ403802R	Affecting Certificate of Title Volume 02683 Folio 599	TP612899S
7	AJ403802R AL693464T	Affecting Certificate of Title Volume 10872 Folio 899	TP379707B
8	AJ403802R AL693464T	Affecting Certificate of Title Volume 10872 Folio 900	TP379707B
9*	AG844933P	Affecting Certificate of Title Volume 10554 Folio 374	PS437890A
10	AJ403662F	Affecting Certificate of Title Volume 04399 Folio 777	TP404399A

* amended at lodging party's
request on 5/12/16

**ADVERTISED
PLAN**

This copied document to be made available
for the sole purpose of enabling
its consideration and review as
part of a planning process under the
Planning and Environment Act 1987.
The document must not be used for any
purpose which may breach any
copyright