

**REGISTER SEARCH STATEMENT (Title Search) Transfer of
Land Act 1958**

VOLUME 08631 FOLIO 393

Security no : 124109053403V
Produced 13/09/2023 12:02 PM

LAND DESCRIPTION

Lot 812 on Plan of Subdivision 059045.

PARENT TITLES :

Volume 08183 Folio 093 Volume 08267 Folio 649

Created by instrument A330150 15/08/1966

REGISTERED PROPRIETOR

Estate Fee Simple

Sole Proprietor

THE ROMAN CATHOLIC TRUSTS CORPORATION FOR THE DIOCESE OF MELBOURNE of
CATHEDRAL PLACE EAST MELBOURNE
C427446 22/02/1966

ENCUMBRANCES, CAVEATS AND NOTICES

Any encumbrances created by Section 98 Transfer of Land Act 1958 or Section 24 Subdivision Act 1988 and any other encumbrances shown or entered on the plan or imaged folio set out under DIAGRAM LOCATION below.

DIAGRAM LOCATION

SEE LP059045 FOR FURTHER DETAILS AND BOUNDARIES

ACTIVITY IN THE LAST 125 DAYS

NIL

-----END OF REGISTER SEARCH STATEMENT-----

Additional information: (not part of the Register Search Statement)

Street Address: 15 GIBSON STREET BROADMEADOWS VIC 3047

DOCUMENT END



Imaged Document Cover Sheet

The document following this cover sheet is an imaged document supplied by LANDATA®, Secure Electronic Registries Victoria.

Document Type	Plan
Document Identification	LP059045
Number of Pages (excluding this cover sheet)	1
Document Assembled	13/09/2023 12:04

Copyright and disclaimer notice:

© State of Victoria. This publication is copyright. No part may be reproduced by any process except in accordance with the provisions of the Copyright Act 1968 (Cth) and for the purposes of Section 32 of the Sale of Land Act 1962 or pursuant to a written agreement. The information is only valid at the time and in the form obtained from the LANDATA® System. None of the State of Victoria, LANDATA®, Secure Electronic Registries Victoria Pty Ltd (ABN 86 627 986 396) as trustee for the Secure Electronic Registries Victoria Trust (ABN 83 206 746 897) accept responsibility for any subsequent release, publication or reproduction of the information.

The document is invalid if this cover sheet is removed or altered.

LP59045
EDITION 1
PLAN MAYBE LODGED 16/5/66

CAMP ROAD

HOUSING COMMISSION OF VICTORIA
BROADMEADOWS ESTATE.
PLAN OF SUBDIVISION
OF PART OF CROWN PORTION 6
PARISH OF WILL WILL ROOK
COUNTY OF BOURKE
SCALE OF FEET



√8267 F 649
√8183 F 093

COLOUR CODE
E-1=BLUE
E-2=GREEN

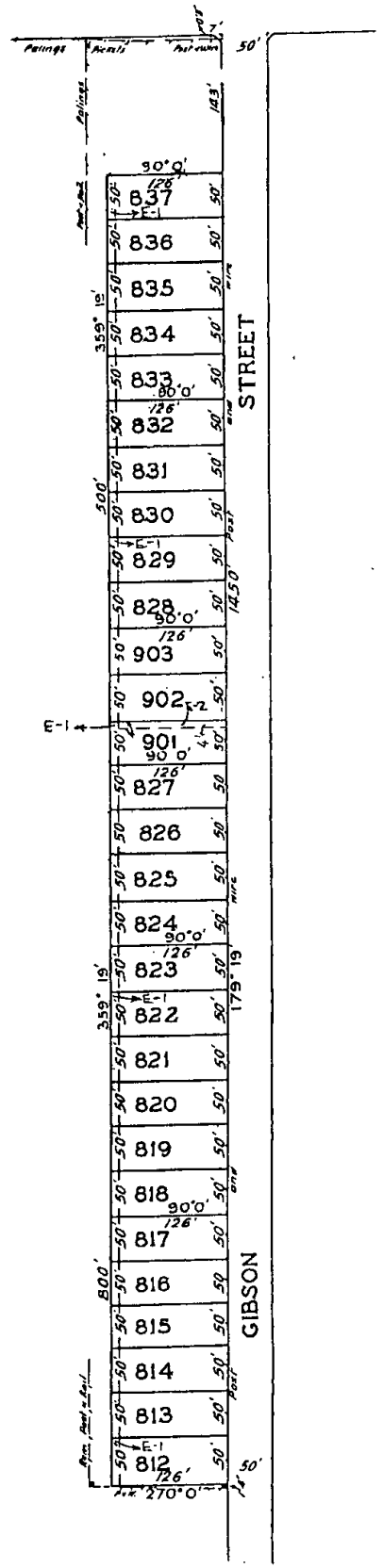

Note :- The land coloured blue is set aside for Sewerage and Drainage purposes, and is 8' wide

THE LAND COLOURED GREEN IS ENCUMBERED
VIDE CERTIFICATATE OF TITLE VOL 8183 FOL 093