

Copyright State of Victoria. No part of this publication may be reproduced except as permitted by the Copyright Act 1968 (Cth), to comply with a statutory requirement or pursuant to a written agreement. The information is only valid at the time and in the form obtained from the LANDATA REGD TM System. None of the State of Victoria, its agents or contractors, accepts responsibility for any subsequent publication or reproduction of the information.

The Victorian Government acknowledges the Traditional Owners of Victoria and pays respects to their ongoing connection to their Country, History and Culture. The Victorian Government extends this respect to their Elders, past, present and emerging.

REGISTER SEARCH STATEMENT (Title Search) Transfer of Land Act 1958

VOLUME 09784 FOLIO 845

Security no : 124111508424U
Produced 22/12/2023 10:48 AM

LAND DESCRIPTION

Land in Plan of Consolidation 166589J.
PARENT TITLES :
Volume 03603 Folio 451 Volume 09747 Folio 928
Created by instrument CP166589J 15/12/1987

**ADVERTISED
PLAN**

REGISTERED PROPRIETOR

Estate Fee Simple
Sole Proprietor
TIMOTHY JOHN PRICE of 126 SACKVILLE STREET KEW VIC 3101
AV085222Y 02/12/2021

**This copied document to be made available
for the sole purpose of enabling
its consideration and review as
part of a planning process under the
Planning and Environment Act 1987.
The document must not be used for any
purpose which may breach any
copyright**

ENCUMBRANCES, CAVEATS AND NOTICES

MORTGAGE AV085223W 02/12/2021
NATIONAL AUSTRALIA BANK LTD

Any encumbrances created by Section 98 Transfer of Land Act 1958 or Section 24 Subdivision Act 1988 and any other encumbrances shown or entered on the plan or imaged folio set out under DIAGRAM LOCATION below.

DIAGRAM LOCATION

SEE CP166589J FOR FURTHER DETAILS AND BOUNDARIES

ACTIVITY IN THE LAST 125 DAYS

NIL

-----END OF REGISTER SEARCH STATEMENT-----

Additional information: (not part of the Register Search Statement)

Street Address: 28 HOPE STREET GLEN IRIS VIC 3146

ADMINISTRATIVE NOTICES

NIL

eCT Control 16089P NATIONAL AUSTRALIA BANK LTD
Effective from 02/12/2021

DOCUMENT END

Delivered from the LANDATA® System by GlobalX Pty Ltd

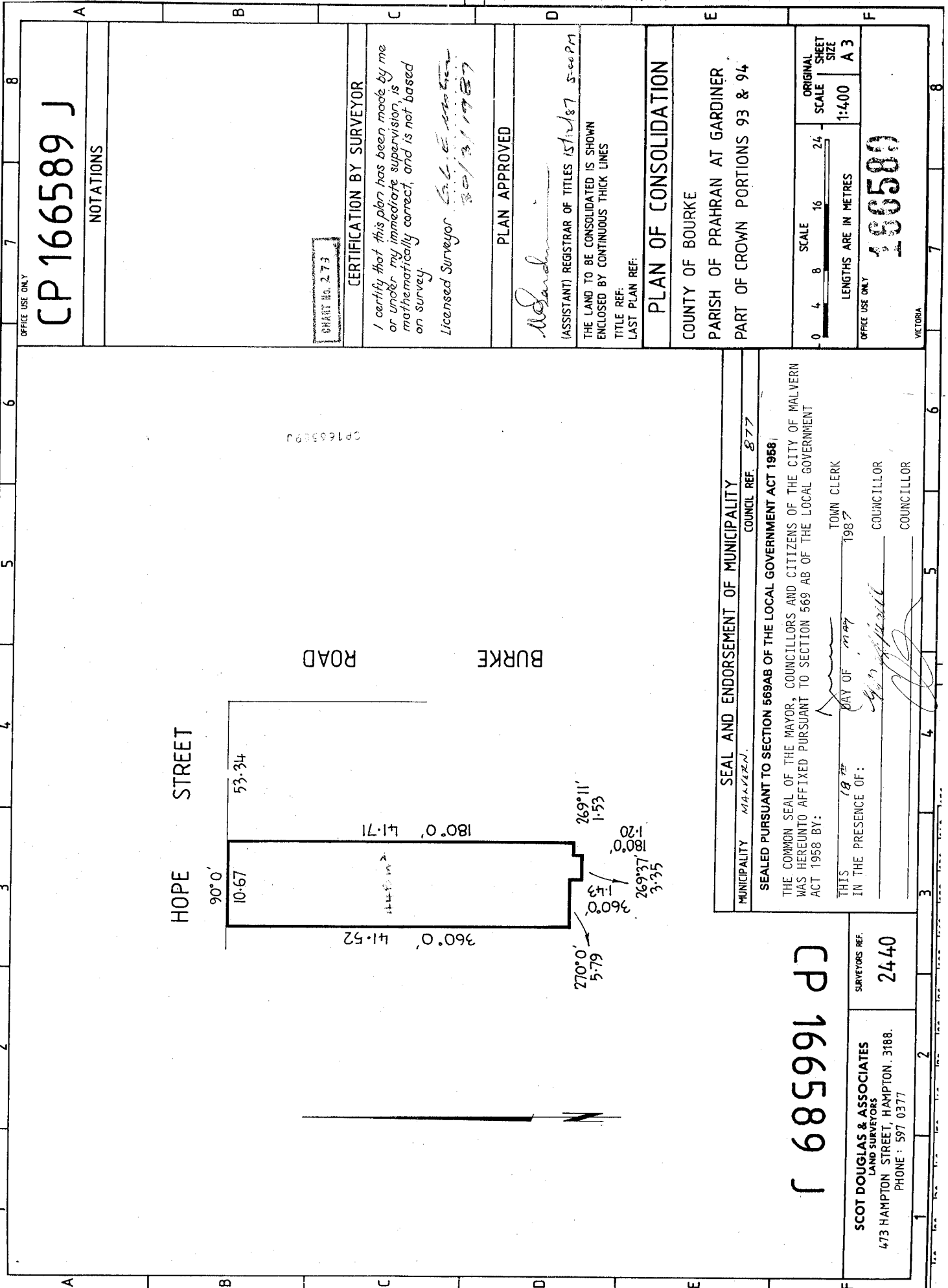

OFFICE USE ONLY
CP 166589 J

NOTATIONS

CHART NO. 273

CERTIFICATION BY SURVEYOR

I certify that this plan has been made by me or under my immediate supervision, is mathematically correct, and is not based on survey.

Licensed Surveyor G.L.E. Robinson
30/3/1987

PLAN APPROVED

G. Gardiner
(ASSISTANT) REGISTRAR OF TITLES 15/11/87 5:00 PM

THE LAND TO BE CONSOLIDATED IS SHOWN ENCLOSED BY CONTINUOUS THICK LINES
TITLE REF.
LAST PLAN REF.

PLAN OF CONSOLIDATION

COUNTY OF BOURKE
PARISH OF PRAHRAN AT GARDINER
PART OF CROWN PORTIONS 93 & 94

SCALE 1:400
LENGTHS ARE IN METRES
ORIGINAL SHEET SIZE A 3

166589 J

OFFICE USE ONLY
VICTORIA

SEAL AND ENDORSEMENT OF MUNICIPALITY

MUNICIPALITY MALVERN. COUNCIL REF. 877

SEALED PURSUANT TO SECTION 569AB OF THE LOCAL GOVERNMENT ACT 1958:

THE COMMON SEAL OF THE MAYOR, COUNCILLORS AND CITIZENS OF THE CITY OF MALVERN WAS HEREBY AFFIXED PURSUANT TO SECTION 569 AB OF THE LOCAL GOVERNMENT ACT 1958 BY:

THIS 18TH DAY OF MAY 1987 TOMN CLERK

IN THE PRESENCE OF: *John Marshall* COUNCILLOR

[Signature] COUNCILLOR

CP 166589 J

SCOT DOUGLAS & ASSOCIATES
LAND SURVEYORS
473 HAMPTON STREET, HAMPTON. 3188.
PHONE : 597 0377

SURVEYORS REF. 2440